

* Your shades will come with metal clips for the plastic trim of the window.

1.

The metal clips included will allow the magnets in the border of the shade to attach to the plastic trim around the frame. This graphic shows approximately where all the magnets in your shade should line up to the plastic trim.

The clips should easily slide onto the inner edge of the plastic trim with the flat, broad side facing up.

! Tip: You can feel the magnets in the border and mark where the clips should line up with masking tape as you test fit. !

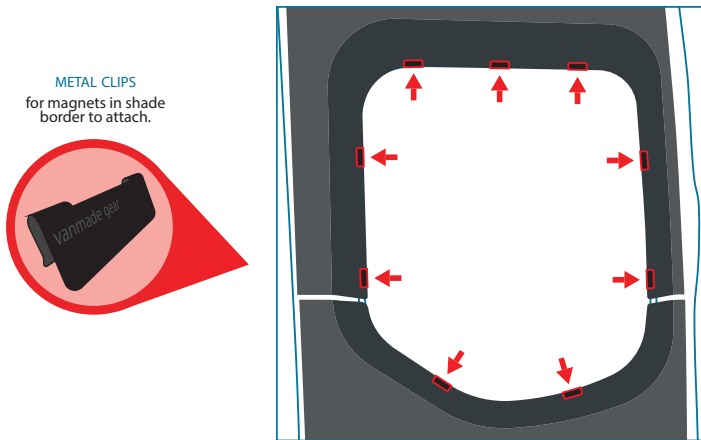

2.

Now you should be able to easily mount and unmount your shades. It can be folded down as shown or up from the bottom for partial shade.

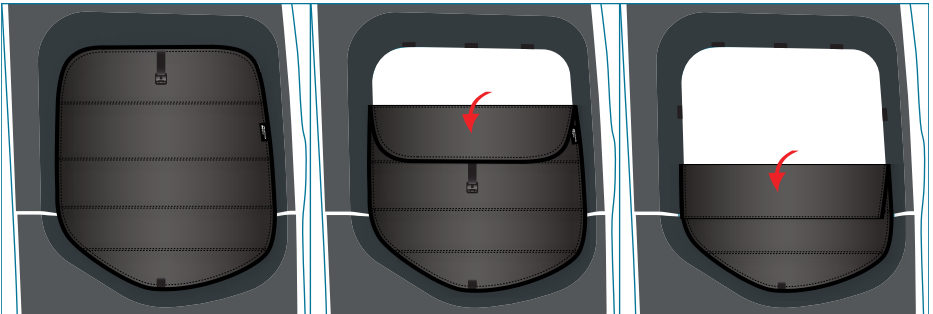

YOU DID IT!