



PALMER SAFETY

• Fall Protection • Competent Training • Netting • PPE

TECHSHEETS

TECHNICAL SPECIFICATIONS

Concrete Anchor Strap (Various Lengths)

Disposable concrete anchor point, strap is attached to a structure capable of supporting 5000 lbs. 1 - 3/4" wide with various length options and large D-Ring, full length wear pad. Red strap. Meets or Exceeds ANSI Z359.1-2007 and OSHA.

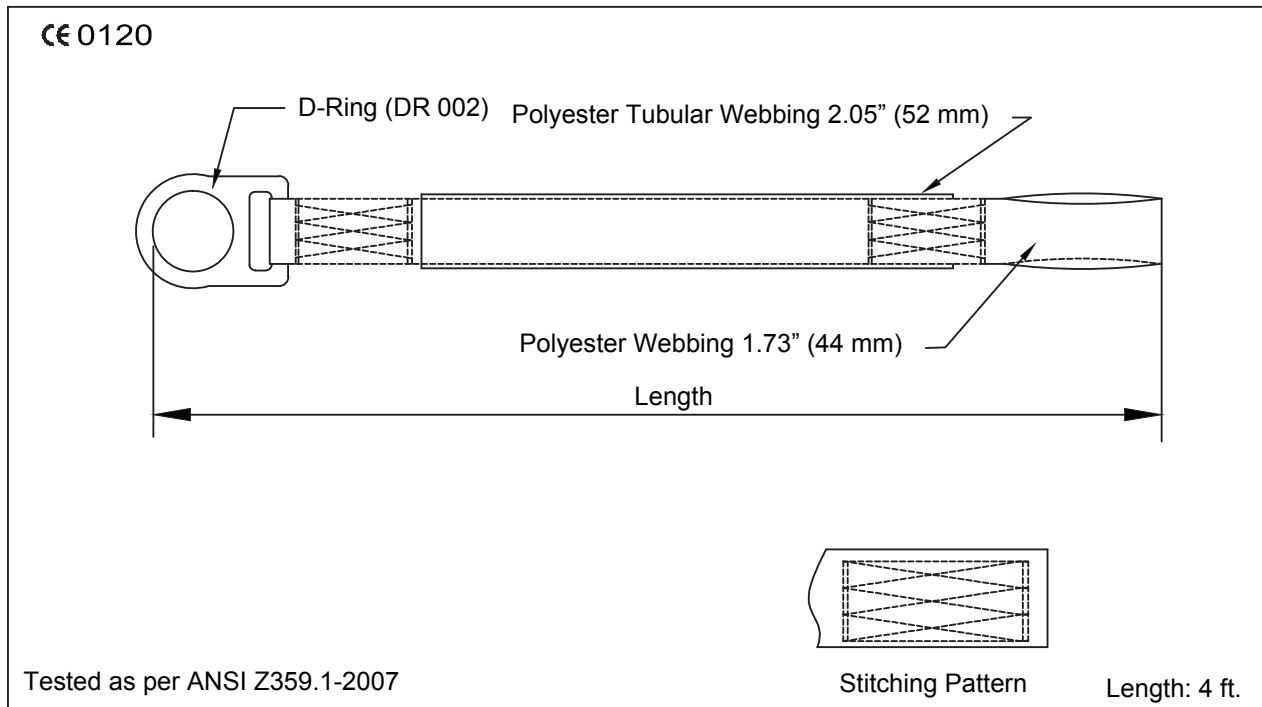

DESIGN: 1.73" wide polyester webbing with one end having a textile loop and the other side a D-ring (DR-002).

WEBBING: Material: Polyester
 Width: 1.73" ± .04"
 Breaking Strength: 25 kN (Min)

STITCHING THREAD: Material: High-tenacity polyester
 Color: White

D-RING: Material: Steel
 Plating: Electro deposited Zinc
 Finish: Deburred & polished

Part #	Length
A4125000	4'
A6125000	6'
A8125000	8'
A10125000	10'

VITAL TEST COMPLIANCE: Static Strength: 10 kN for 3 Minutes
 Dynamic Strength: Free fall from 8.2 ft. height with test mass 220 lbs.

WEIGHT: 4.92 ft.: 0.78 lbs. ± 10%

PN: A345000



• Fall Protection • Competent Training • Netting • PPE

Phone: (504) 733-1808
Fax: (504) 733-2996
PalmerSafetyUS.com

TECHNICAL SPECIFICATIONS

3/4" Reusable Concrete Anchor 5000 lbs.

Reusable Concrete Anchor 3/4" Hole. 5000 lbs. Conforms to ANSI Z359.1-2007.

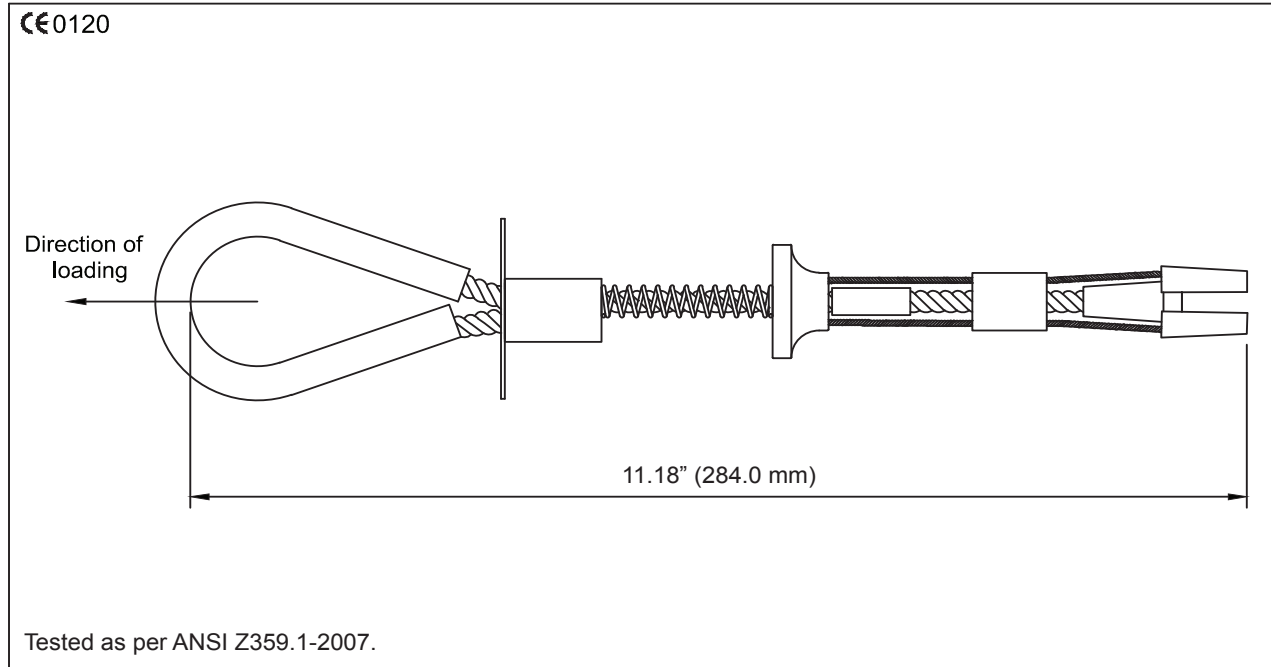

- DESIGN:**
- Anchor is capable of being installed on a concrete wall having minimum thickness of 5.9" through a predefined hole of 0.75" diameter.
 - Easy to install on a concrete structure using a single hand.

MATERIAL: Cable: Galvanized steel 0.24" diameter
Clamping Jaws: Stainless steel

MINIMUM BREAKING STRENGTH: 15 kN

CONFORM TO NORM: ANSI Z359.1-2007

WEIGHT: 0.33 lbs. ± 0.02 lbs.

TECHNICAL SPECIFICATIONS

Temporary 4 Man Rope HLL Lifeline.

Horizontal Life line system up to four workers. Covers span length of 15 ft. to 100 ft. Min Breaking Strength 5620 lbs. Kernmantle rope of 5/8" diameter. Comes complete with carabiners, rope tensioner and carrying bag. Conforms to ANSI Z359.1-2007.

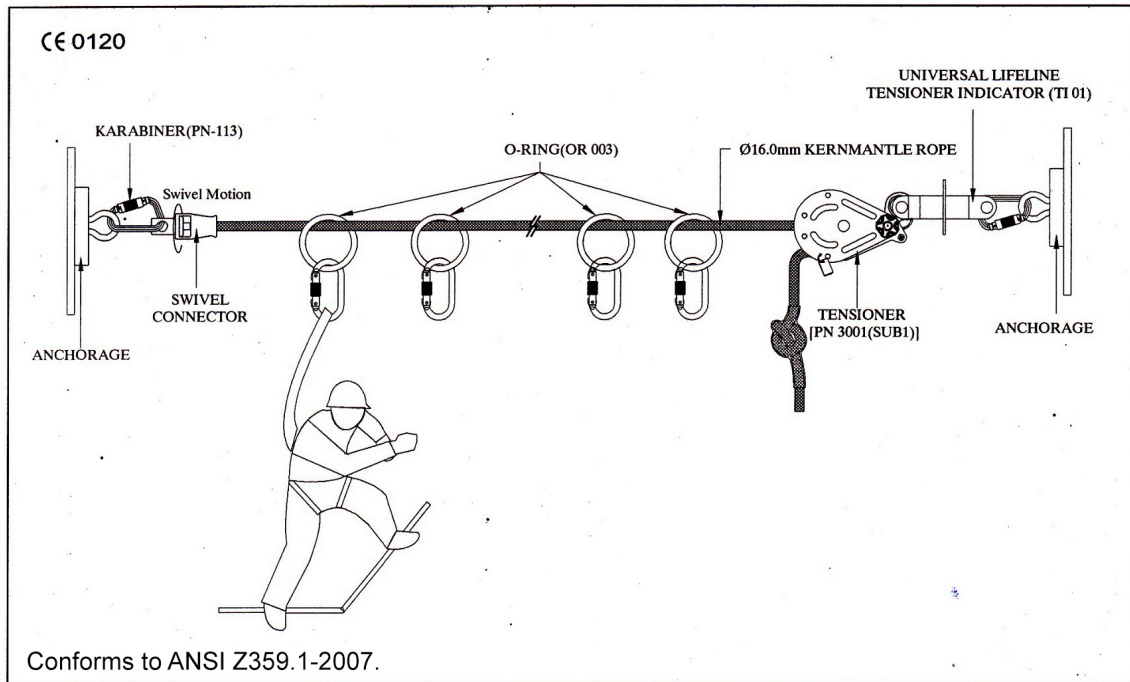

- DESIGN:**
- Temporary horizontal lifeline consisting of 0.63" diameter Kernmantle rope having a swivel brass connector at one end of the lifeline and a specially designed tensioner at the other end.
 - Provided with forged steel O Rings to be used as mobile anchors for the workers to connect to the lifeline permanently.

SPAN LENGTH: Minimum: 16.40 ft. | Maximum: 82.02 ft.

MATERIAL: O Ring: Forged alloy steel
 Tensioner: Aluminum alloy & stainless steel

MINIMUM BREAKING STRENGTH: 25 kN

SYSTEM WEIGHT: 20.46 lbs. ± 0.22 lbs.

TECHNICAL SPECIFICATIONS

Anchor Lifeline Cable HLL System

Horizontal Lifeline system. Max Span Length 60 ft. System Breaking Strength 5000 lbs. Load indicator small hooks. Two person approved system. Meets ANSI Z359.1-2007.

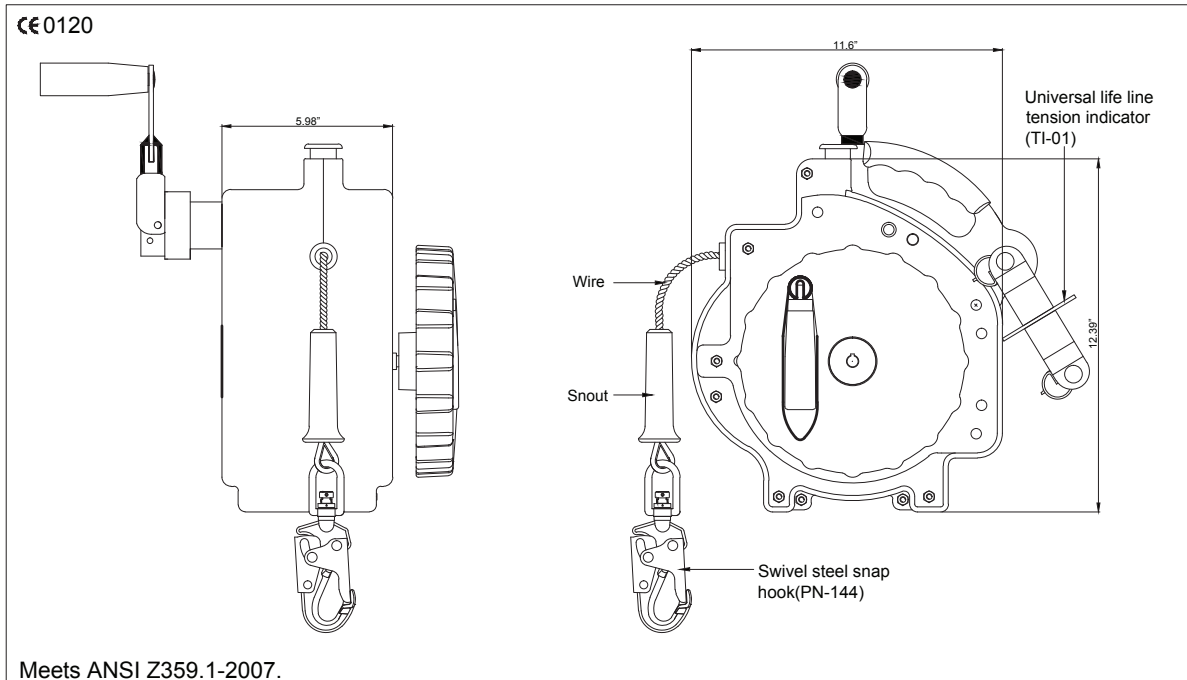

DESIGN:

- Housing made up of durable & high strength polymer.
- Horizontal lifeline system easy to install, remove and store.
- Light weight and portable design.
- Inbuilt shock absorption mechanism to limit the impact forces during fall arrest.
- Molded handle for easy carry on job sites.
- Lifeline made of Galvanized steel wire rope of 0.24 in. diameter.
- Comes with Tension Indicator for correct amount of tension in lifeline.

WIRE ROPE: Construction: 7 X 19 galvanized steel wire
 Minimum breaking strength: 22 kN

MAXIMUM SPAN LENGTH: 59.06 ft.

NUMBER OF USERS: 02

SYSTEM STRENGTH: Greater than 24 kN

CONFORMS TO: Meets ANSI Z359.1-2007

WEIGHT: 28.88 lbs. ± 0.22 lbs.

TECHNICAL SPECIFICATIONS

Anchor Stanchion

Stanchion for Anchor Lifeline Cable HLL System (A400160) off set.

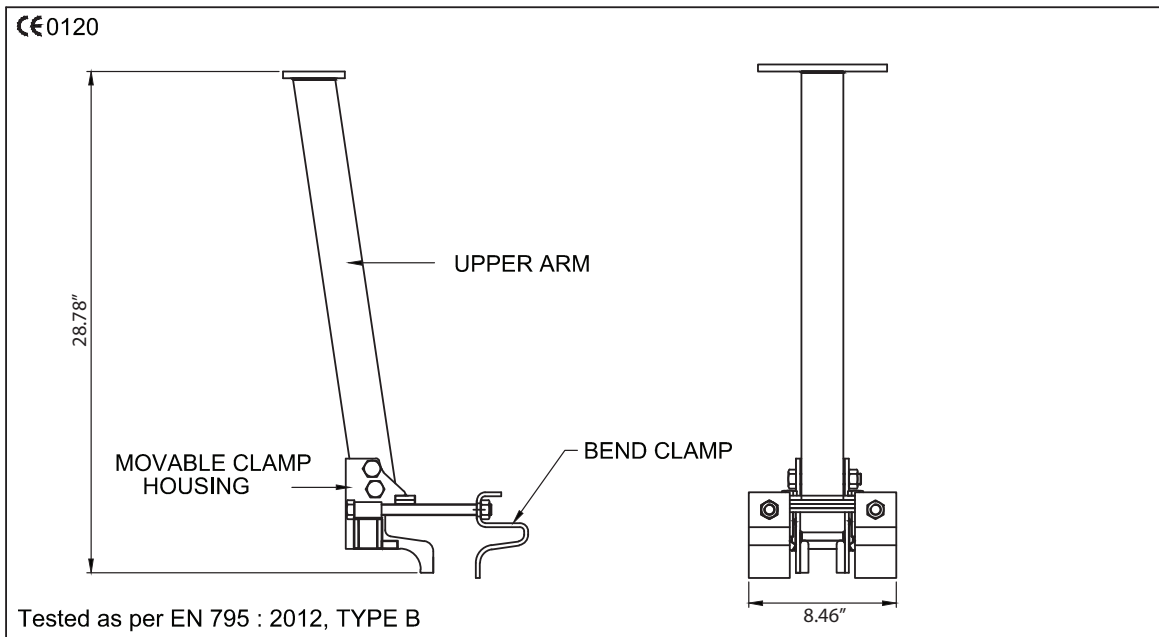

- DESIGN:**
- Anchor post designed to be installed on metal I-Beam.
 - In addition, can be used as a stand-alone anchor post. It can also be used to form a horizontal lifeline along the length of I-Beam depending upon the requirement of site.
 - Span lengths are adjustable with help of intermediates.
 - Compatible with Palmer Safety universal extremity plate PN4000(09) and intermediate PN4000(10).
 - Compatible with 8.66 in. width of I-Beam.

MATERIAL: High strength alloy steel

FINISH: Hot dip galvanized

MINIMUM BREAKING STRENGTH: 12 kN

CONFORMS TO: EN 795:2012, Type 'B'

VITAL TEST COMPLIANCE: Static Strength: 12 kN for 3 minutes.
 Dynamic Strength & Integrity Test: When tested dynamically with a rigid mass of 220.46 lbs., the test mass arrested and anchor holds an increased mass of 661.39 lbs. for 3 minutes.

WEIGHT: 28.22 lbs. ± 0.22 lbs.

TECHNICAL SPECIFICATIONS

Anchor Door Jam

Door Jam Anchor, Aluminum construction. Min breaking strength 5000 lbs. Conforms to ANSI Z359.1-2007.

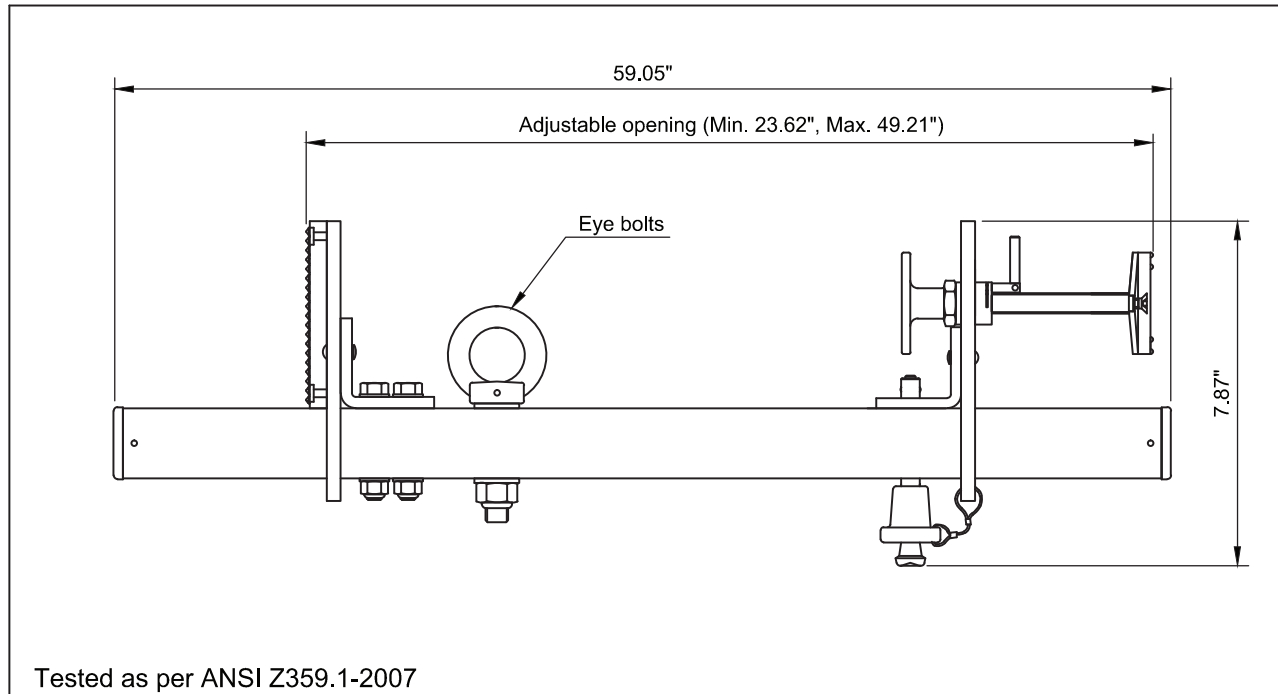

- DESIGN:**
- Door/window anchor is compressed against the door or window frame "jamming" itself between the two vertical sides.
 - Made up of high strength aluminum alloy.
 - Light weight & portable.

MINIMUM OPENING: 23.62"

MAXIMUM OPENING: 49.21"

MATERIAL: High strength aluminum alloy

FINISH: Anodized

MINIMUM BREAKING STRENGTH: 5000 lbs.

CONFORM TO THE NORM: ANSI Z359.1-2007

WEIGHT: 12.47 lbs. ± 0.53 lbs.

TECHNICAL SPECIFICATIONS

Anchor Cross Arm Strap (Various Lengths)

3" strap in various lengths with large D-ring pass-through and small D-ring. Meets or Exceeds ANSI Z359.1-2007 and OSHA.

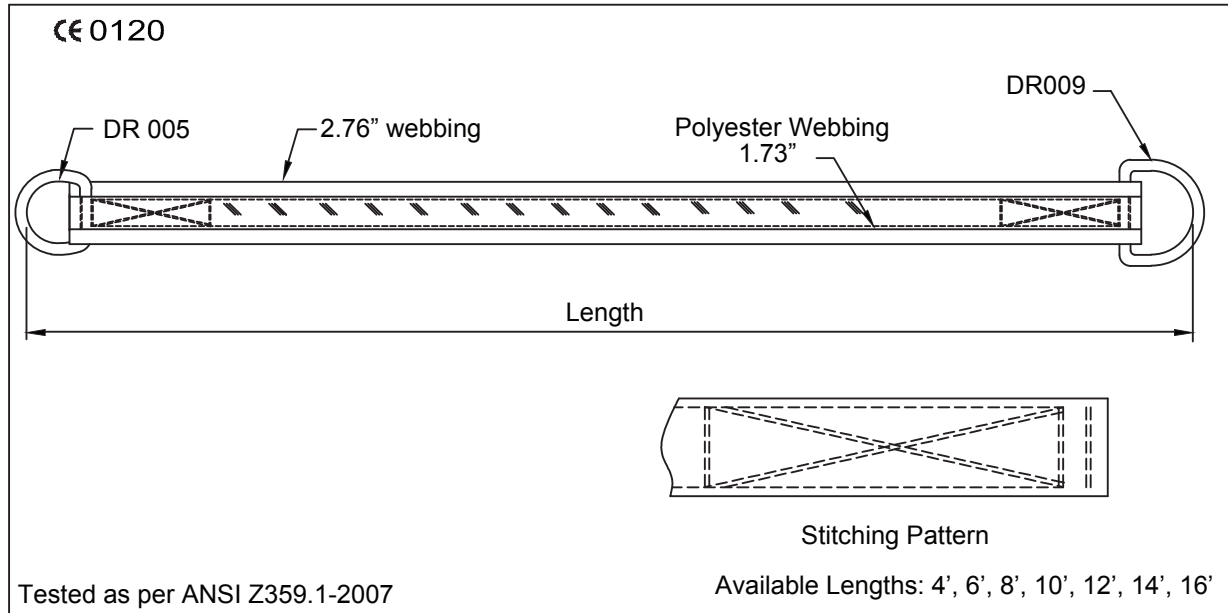

DESIGN: 1.73 in. wide polyester webbing stitched with 2.76 in. webbing on the back for extra protection.

WEBBING: Material: Polyester
 Width: 1.73 in. \pm 0.04 in. and 2.76 in. \pm 0.04 in.
 Breaking Strength: 5000 lbs.

STITCHING THREAD: Material: High-tenacity polyester

METAL COMPONENT: Material: Alloy Steel
 Finish: Golden Yellow Galvanized
 Breaking Strength: 5000 lbs.

VITAL TEST COMPLIANCE: Static Strength: 18 kN for 3 Minutes
 Dynamic Strength: Free fall from 4.92 ft. height with test mass of 220.46 lbs.

WEIGHT: 3.28 ft.: 0.99 lbs. \pm 0.02 lbs.
 4.92 ft.: 1.10 lbs. \pm 0.02 lbs.
 6.56 ft.: 1.21 lbs. \pm 0.02 lbs.

Part #	Length
A48806	4'
A72806	6'
A96806	8'
A120806	10'
A144806	12'
A168806	14'
A192806	16'

TECHNICAL SPECIFICATIONS

Reusable Roof Anchor

Reusable Roof Anchor. Galvanized Steel with stamped D-ring. Min breaking strength 5000 lbs., conforms to ANSI Z359.1-2007.

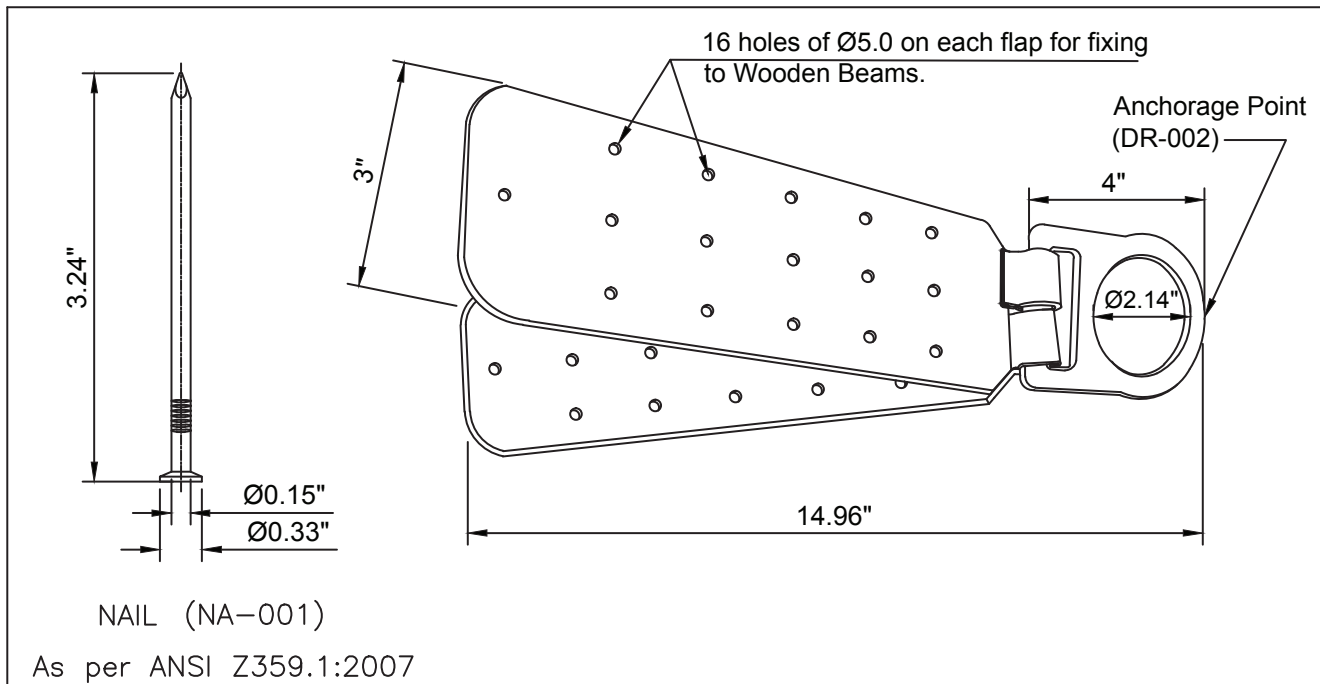

- DESIGN:**
- An ideal anchorage device to be fixed on wooden beams used in roofing.
 - Consists of two steel flaps each having 16 holes which can be fitted on the two sides of a wooden beam by means of nails inserted in the holes.
 - The D-ring can be safely used as an anchor point.

MATERIAL: High strength alloy steel

FINISH: Powder coated or Zinc plated

MINIMUM BREAKING STRENGTH: 5000 lbs.

WEIGHT: 2.39 lbs. ± 0.02 lbs.

TECHNICAL SPECIFICATIONS

Parapet Anchor

Parapet Anchor. Galvanized Steel. 2.36" - 14.17" parapet range. Min breaking strength 5000 lbs. Meets ANSI Z359.1-2007.

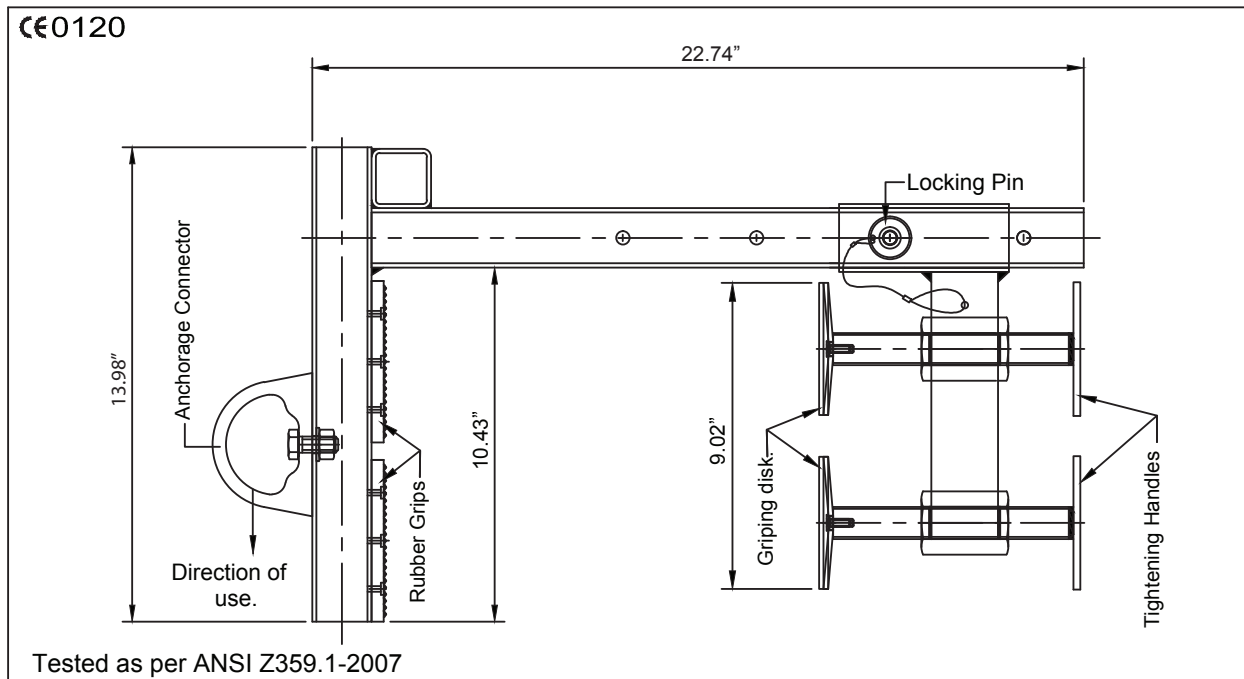

- DESIGN:**
- Anchor suitable to be installed on the parapet of a building such that the anchor point lies at the top on the outside facade of the building.
 - Suitable to be installed on varying thicknesses of a parapet. Width adjustment feature provided.
 - Tightening on to the parapet by use of rubber disks.

MIN. WIDTH OF THE PARAPET ON WHICH INSTALLATION IS POSSIBLE: 2.36 in.

MIN. WIDTH OF THE PARAPET ON WHICH INSTALLATION IS POSSIBLE: 14.17 in.

MATERIAL: High strength alloy steel

FINISH: Silver/golden yellow galvanized

SYSTEM STRENGTH: Greater than 25 kN

CONFORM TO NORM: ANSI Z359.1-2007

WEIGHT: 19.84 lbs. ± 0.22 lbs.

PN: A3145000



• Fall Protection • Competent Training • Netting • PPE

Phone: (504) 733-1808
Fax: (504) 733-2996
PalmerSafetyUS.com

TECHNICAL SPECIFICATIONS

Anchor Sliding Beamer

Aluminum Sliding Beam Anchor, 3.5" - 14" flange adjustable. Min breaking strength 5000 lbs. Conforms to ANSI Z359.1-2007.

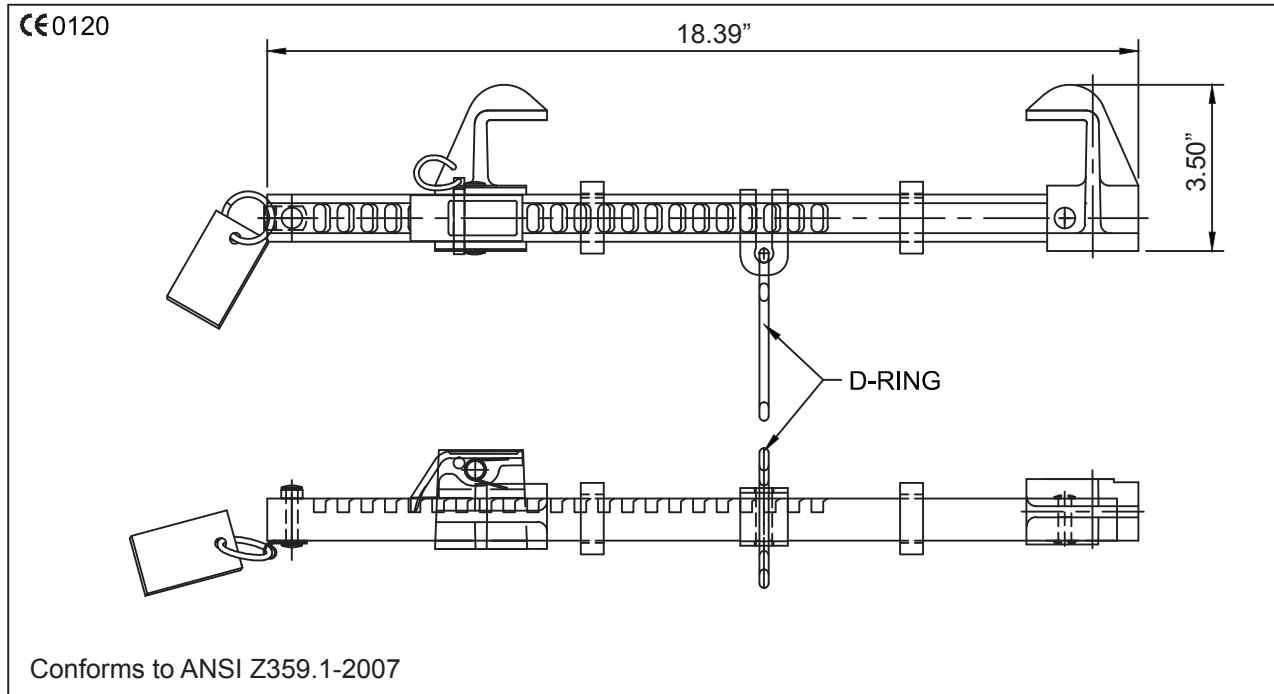

DESIGN: Anchor capable of being installed on flange of beams. Adjustment of the jaw to variable positions enables it to be installed to varying flange widths.

COMPATIBLE WITH MIN FLANGE WIDTH: 3.54 in.

COMPATIBLE WITH MAX FLANGE WIDTH: 13.39 in.

MATERIAL: Aluminum Alloy & Brass

SYSTEM STRENGTH: Greater than 23 kN (5000 lbs.)

CONFORM TO THE NORM: ANSI Z359.1-2007

WEIGHT: 4.13 lbs. ± 0.02 lbs.

PN: A00001

TECHNICAL SPECIFICATIONS

Single Point Steel Anchor

Single Point Steel Anchor. Galvanized Steel. Min breaking strength 5000 lbs. Conforms to ANSI Z359.1-2007.

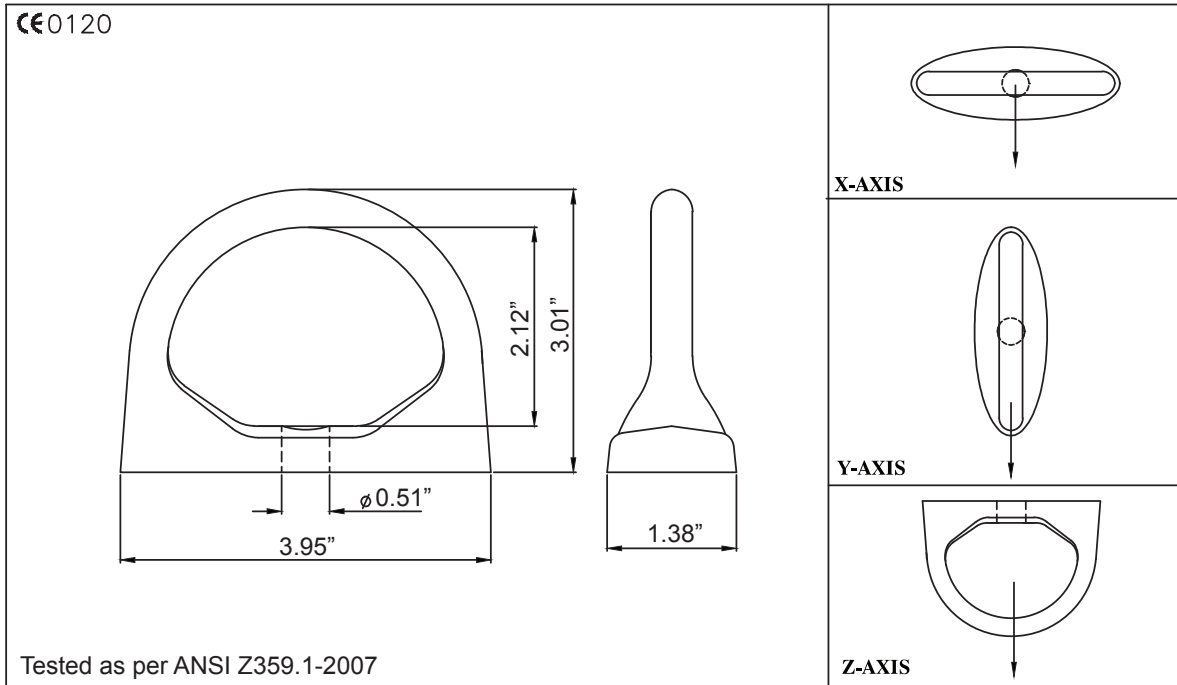

- DESIGN:**
- Single point anchor is designed to be fixed on walls, ceilings, roof tops or steel structures.
 - It can be used to sustain the load impact in all three axes (X, Y, & Z).
 - Alloy Steel

FINISH: Silver/golden yellow galvanized

MINIMUM BREAKING STRENGTH: X Axis: 23 kN (min) | Y Axis: 23 kN (min) | Z Axis: 23 kN (min)

CONFORM TO NORM: ANSI Z359.1-2007

WEIGHT: 0.84 lbs. \pm 0.02 lbs.

TECHNICAL SPECIFICATIONS

Rescue Trauma Strap

Trauma strap step up relief pack.

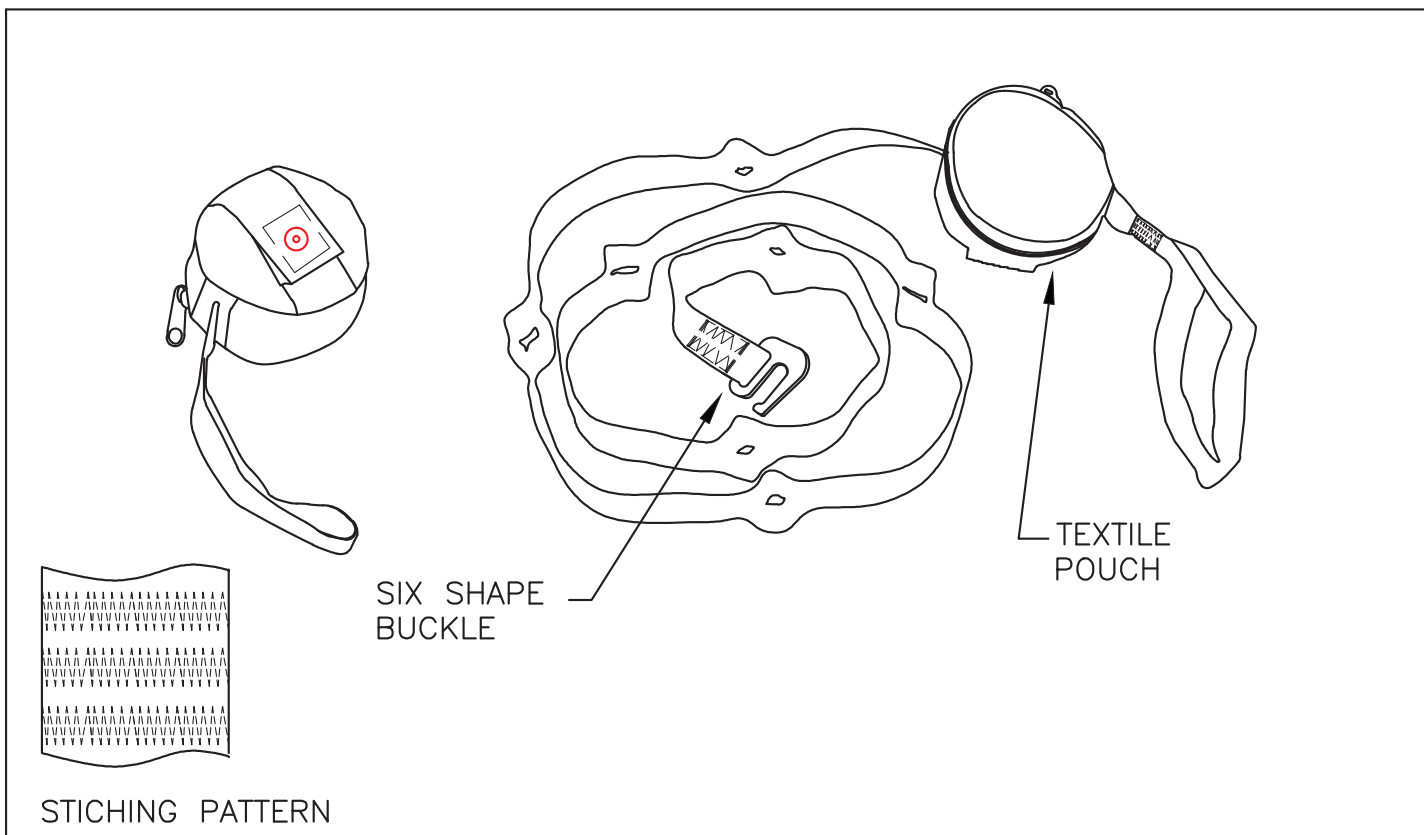

- 0.79 in. polyester webbing
- DESIGN:**
 - Formed pouch for holding the straps
 - Textile loops are given on the straps for adjustment at different heights

WEBBING: Material: Polyester
 Width: 0.79 in. ± 0.04 in.
 Breaking strength: 200 Kgf

STITCHING THREAD: Material: High tenacity polyester

METAL COMPONENTS: Material: Steel
 Plating: Zinc plating
 Finish: Deburred & Polished

WEIGHT: 0.24 lbs. ± 0.02 lbs.

PN: T2201



• Fall Protection • Competent Training • Netting • PPE

Phone: (504) 733-1808
Fax: (504) 733-2996
PalmerSafetyUS.com

TECHNICAL SPECIFICATIONS

Tool Lanyard Key Chain

Tool Lanyard with Key Chain Carabiner. 22 lbs. tool rated.

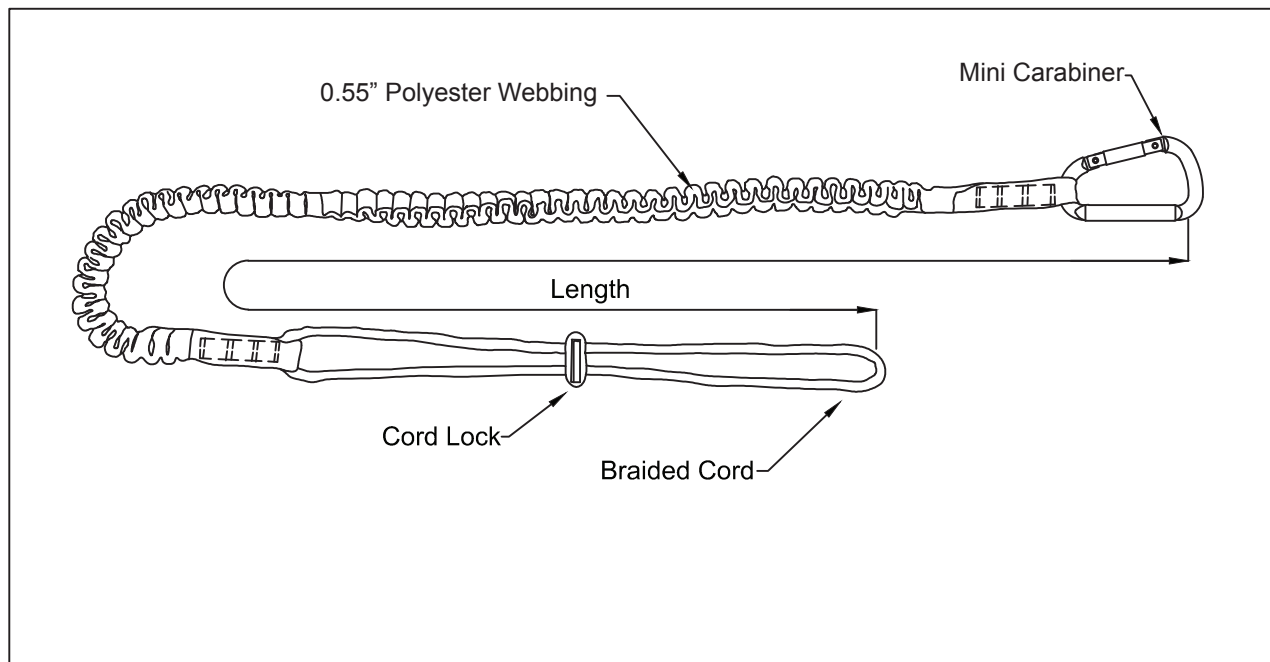

- DESIGN:**
- Convenient stretch lanyard for tool holding
 - Provided with a light-weight carabiner for attachment to the user's belt
 - Elasticated webbing used for contraction property

MATERIAL: Webbing: 0.55 in. polyester
Carabiner: High strength aluminum

STRENGTH: Strength of tool lanyard is 22 lbs.

WEIGHT: 0.10 lbs. ± 0.004 lbs.

LENGTH: Relaxed Length: 2.79 ft.
Expanded Length: 4.43 ft.

TECHNICAL SPECIFICATIONS

Tool Lanyard Key Chain Twin

Tool Lanyard with Key Chain Carabiner. Twin tool. 22 lbs. tool rated.

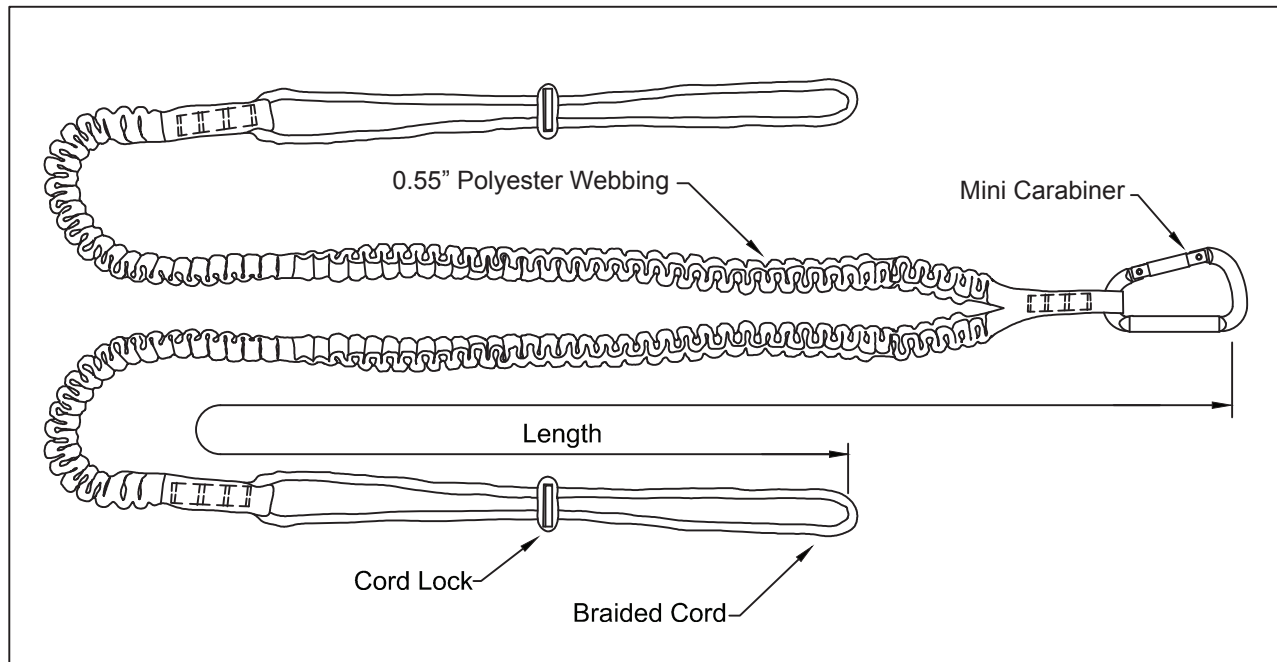

- DESIGN:**
- Convenient “Y” Leg stretch lanyard for tool holding
 - Provided with a light-weight carabiner for attachment to the user’s belt
 - Elasticated webbing used for contraction property

MATERIAL: Webbing: 0.55 in. polyester
 Carabiner: High strength aluminum

STRENGTH: Strength of tool lanyard is 22 lbs.

WEIGHT: 0.17 lbs. ± 0.02 lbs.

LENGTH: Relaxed Length: 2.79 ft.
 Expanded Length: 4.43 ft.

TECHNICAL SPECIFICATIONS

Harness 3pt., Grommet Leg, & Back/Side D rings. Yellow Color.

Yellow full body harness with 3 point adjustment, dorsal D-ring, hip D-rings, tongue buckle leg straps. Universal size. Meets or Exceeds ANSI Z359.11-2014. A10.32-2012.

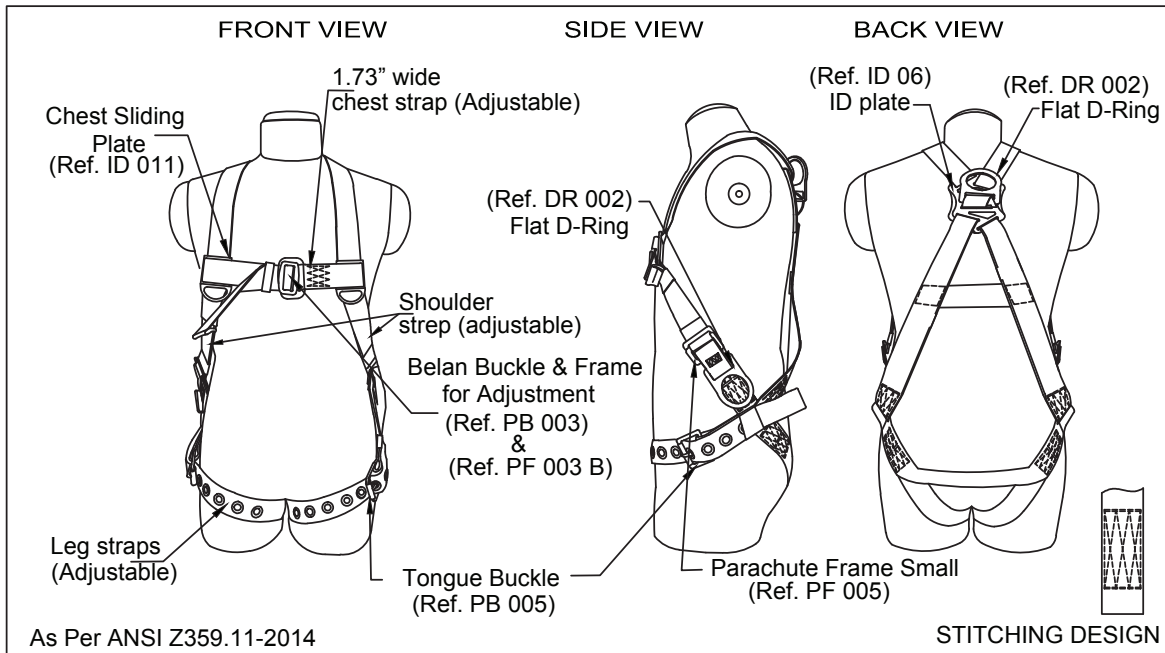

- DESIGN:**
- One dorsal attachment D-ring for fall arrest.
 - Adjustable Shoulder straps.
 - Adjustable grommeted leg straps.
 - Two side D-rings for work positioning

WEBBING: Material: Polyester
 Width: 1.73 in. ± 0.04 in.
 Breaking Strength: 5000 lbs.

STITCHING THREAD: Material: High-tenacity polyester

METAL COMPONENTS: Material: Alloy steel
 Plating: Silver or golden yellow galvanized

VITAL TEST COMPLIANCE: Static Strength: 3600 lbs. for 1 Minute
 Dynamic performance: Free fall from 6 feet height done to a test dummy weighing 220.46 lbs. at dorsal attachment element. Harness should not release the dummy for 5 minutes (Retention time).

WEIGHT OF HARNESS: 3.53 lbs. ± 0.02 lbs.

TECHNICAL SPECIFICATIONS

Harness 3pt, Pass-Thru Leg Straps, Back D-ring. Yellow Color.

Yellow full body harness with 3 point adjustment, dorsal D-ring, adjustable mating buckle leg straps. Universal size. Meets or Exceeds ANSI Z359.11-2014. A10.32-2012

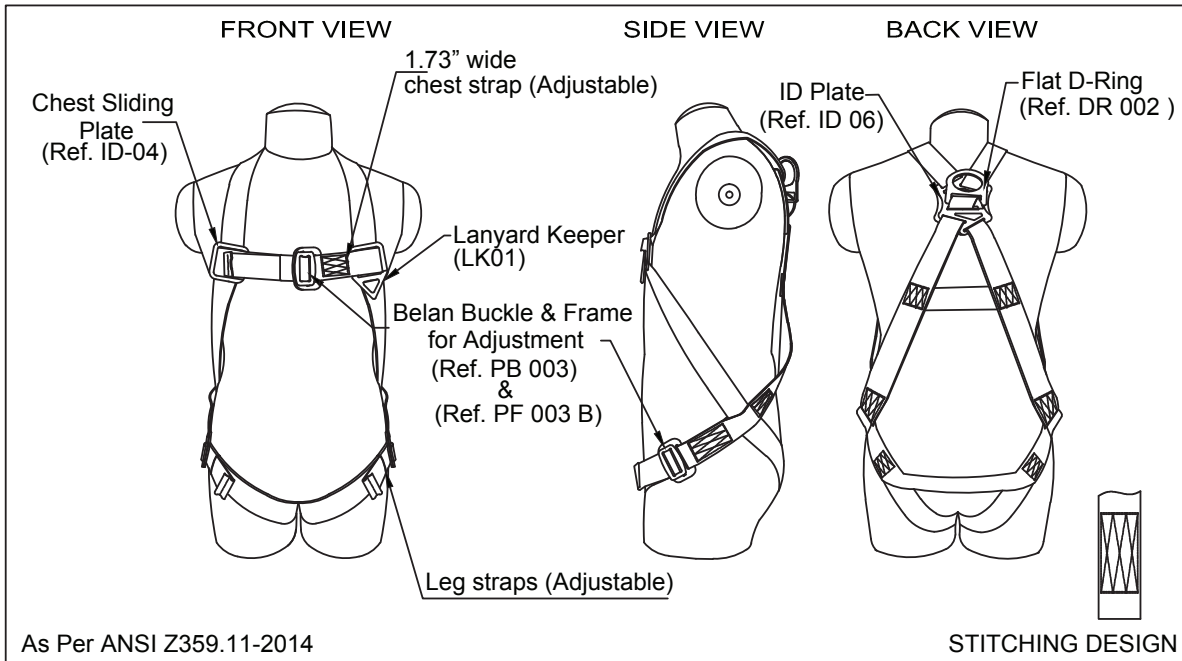

- DESIGN:**
- One dorsal attachment D-ring for fall arrest.
 - Adjustable leg straps.

WEBBING: Material: Polyester
 Width: 1.73 in. ± 0.04 in.
 Breaking Strength: 5000 lbs.

STITCHING THREAD: Material: High-tenacity polyester

METAL COMPONENT: Material: Alloy Steel
 Finish: Silver or Golden Yellow Galvanized

VITAL TEST COMPLIANCE: Static Strength: 3600 lbs. for 1 Minute
 Dynamic performance: Free fall from 6 feet height done to a test dummy weighing 220.46 lbs. at dorsal attachment element. Harness should not release the dummy for 5 minutes (Retention time).

WEIGHT OF HARNESS: 2.23 lbs. ± 0.02 lbs.

TECHNICAL SPECIFICATIONS

Harness 3pt, Grommet Leg, Back D-ring. Yellow Color.

Yellow full body harness with 3 point adjustment, dorsal D-ring, tongue buckle leg straps. Universal size. Meets or Exceeds ANSI Z359.11-2014. A10.32-2012

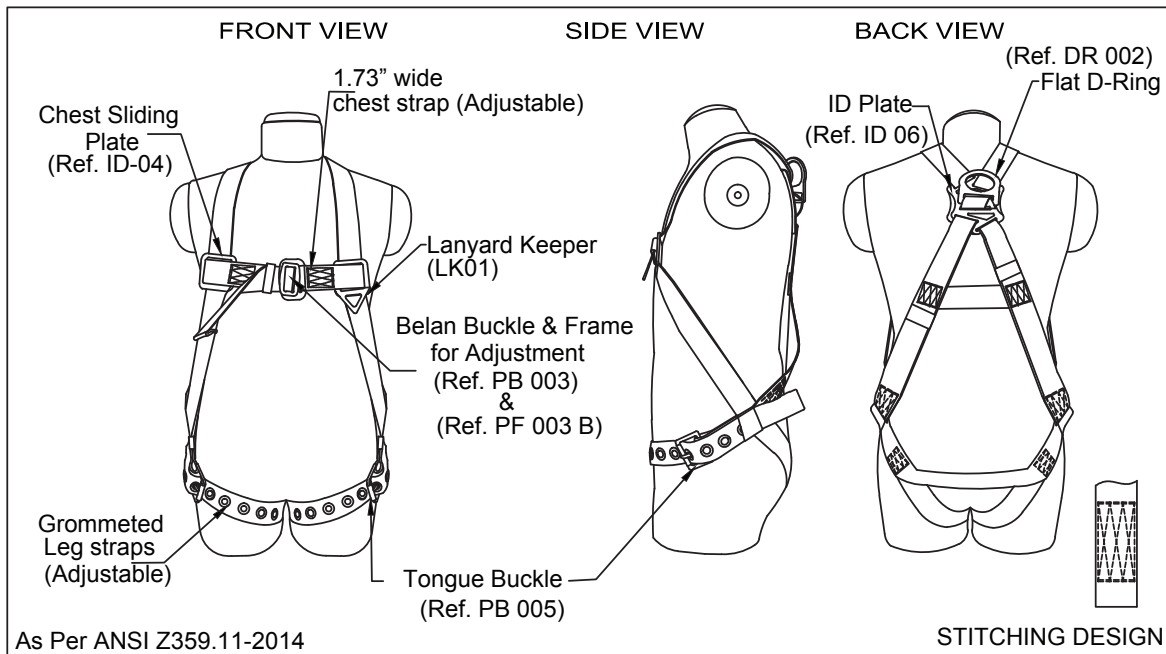

- DESIGN:**
- One dorsal attachment D-ring for fall arrest.
 - Adjustable grommeted leg straps.

WEBBING: Material: Polyester
 Width: 1.73 in. ± 0.04 in.
 Breaking Strength: 5000 lbs.

STITCHING THREAD: Material: High-tenacity polyester

METAL COMPONENT: Material: Alloy Steel
 Finish: Silver or Golden Yellow Galvanized

VITAL TEST COMPLIANCE: Static Strength: 3600 lbs. for 1 Minute
 Dynamic performance: Free fall from 6 feet height done to a test dummy weighing 220.46 lbs. at dorsal attachment element. Harness should not release the dummy for 5 minutes (Retention time).

WEIGHT OF HARNESS: 2.81 lbs. ± 0.02 lbs.

TECHNICAL SPECIFICATIONS

Harness 5pt. Back Padded, QCB Chest, Grommet Leg, Back/Side D rings, & Positioning Belt.

Full body harness with 5 point adjustment, dorsal D-ring, hip D-rings, heavy duty back support/positioning pad with removable tool belt, Black tongue buckle leg straps double stitched. Quick connect chest. Sewn in back pad. Meets or Exceeds ANSI Z359.11-2014. A10.32-2012.

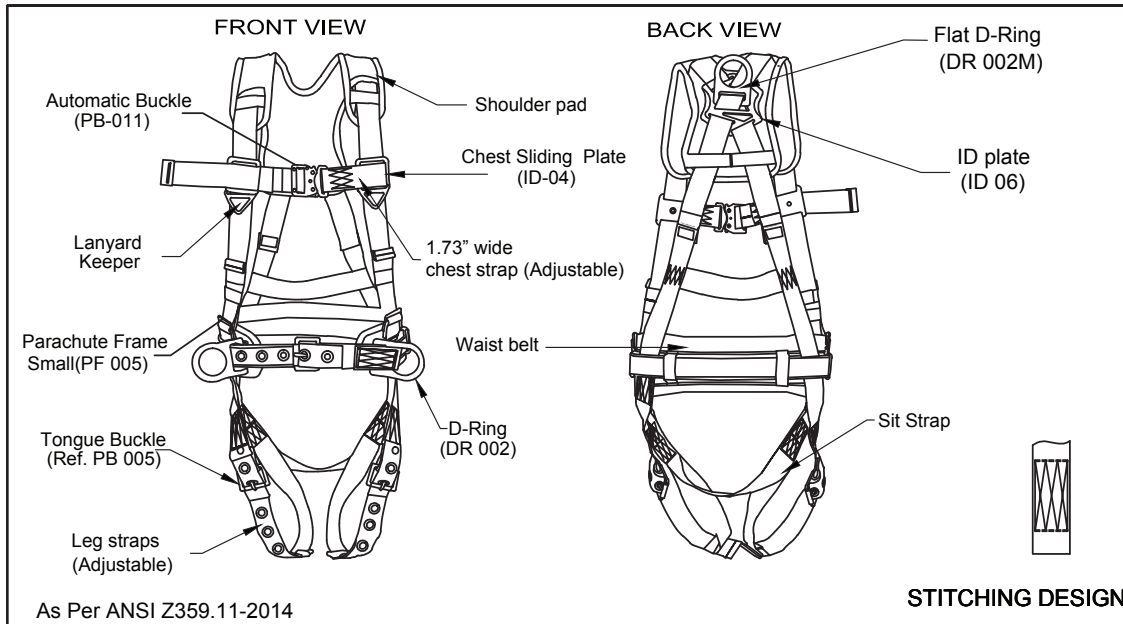

- DESIGN:**
- One dorsal attachment D-ring for fall arrest.
 - Adjustable Shoulder straps.
 - Adjustable leg straps.
 - Equipped with work positioning belt

WEBBING: Material: Polyester
 Width: 1.73 in. ± 0.04 in.
 Breaking Strength: 5000 lbs.

STITCHING THREAD: Material: High-tenacity polyester

METAL COMPONENT: Material: Alloy Steel
 Finish: Silver or Golden Yellow Galvanized

VITAL TEST COMPLIANCE: Static Strength: 3600 lbs. for 1 Minute
 Dynamic performance: Free fall from 6 feet height done to a test dummy weighing 220.46 lbs. at dorsal attachment element. Harness should not release the dummy for 5 minutes (Retention time).

WEIGHT OF HARNESS: 5.28 lbs. ± 0.02 lbs.

Part #	Color	Size
H222101121SM	Red	Small
H222101121MD		Medium
H222101121LG		Large
H222101121XLG		X-Large
H222101123SM	Blue	Small
H222101123MD		Medium
H222101123LG		Large
H222101123XLG		X-Large
H222101125SM	Yellow	Small
H222101125MD		Medium
H222101125LG		Large
H222101125XLG		X-Large
H222101126SM	Green	Small
H222101126MD		Medium
H222101126LG		Large
H222101126XLG		X-Large

TECHNICAL SPECIFICATIONS

Harness 5pt, Pass-Thru Leg Straps, Back D-ring. Black Color.

Black top, black bottom. Full body harness with 5 point adjustment, dorsal D-ring, pass through leg straps. Universal size. Meets or Exceeds ANSI Z359.11-2014. A10.32-2012

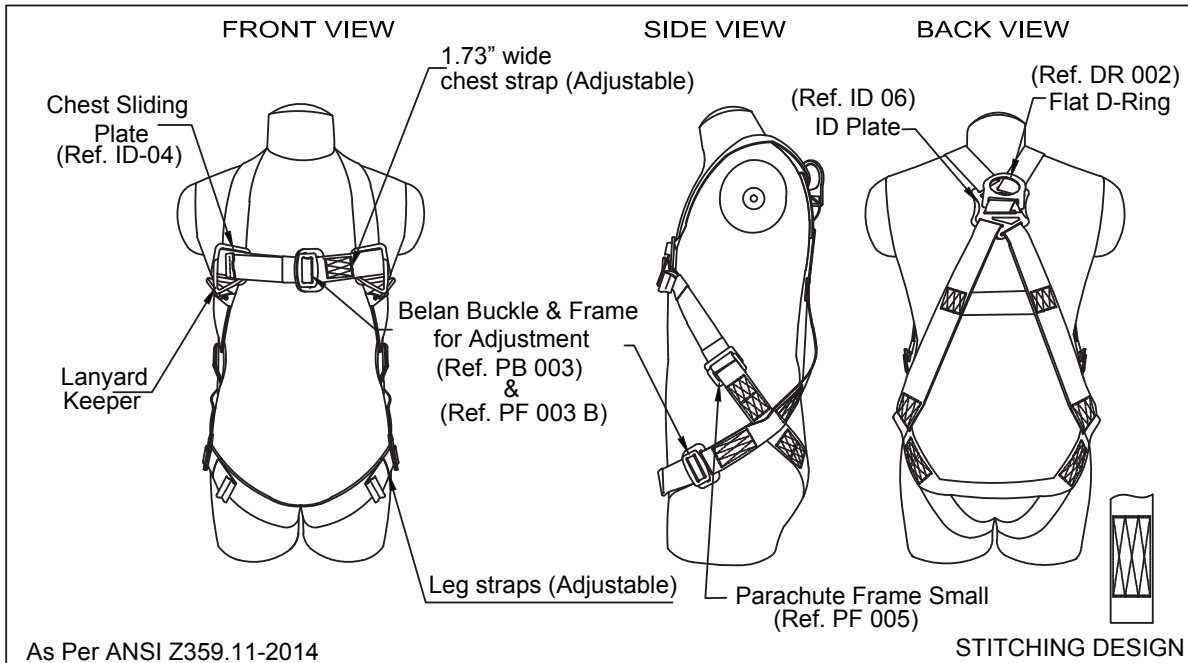

- DESIGN:**
- One dorsal attachment D-ring for fall arrest.
 - Adjustable Shoulder straps.
 - Adjustable leg straps.

WEBBING: Material: Polyester
 Width: 1.73 in. ± 0.04 in.
 Breaking Strength: 5000 lbs.

STITCHING THREAD: Material: High-tenacity polyester

METAL COMPONENT: Material: Alloy Steel
 Finish: Silver or Golden Yellow Galvanized

VITAL TEST COMPLIANCE: Static Strength: 3600 lbs. for 1 Minute
 Dynamic performance: Free fall from 6 feet height done to a test dummy weighing 220.46 lbs. at dorsal attachment element. Harness should not release the dummy for 5 minutes (Retention time).

WEIGHT OF HARNESS: 2.88 lbs. ± 0.02 lbs.

TECHNICAL SPECIFICATIONS

Harness 5pt, Grommet Leg, Back D-ring. Assorted Color Options.

Assorted color option top, black bottom. Full body harness with 5 point adjustment, dorsal D-ring, grommet leg straps, and fall indicators. Universal size. Meets or Exceeds ANSI Z359.11-2014. A10.32-2012.

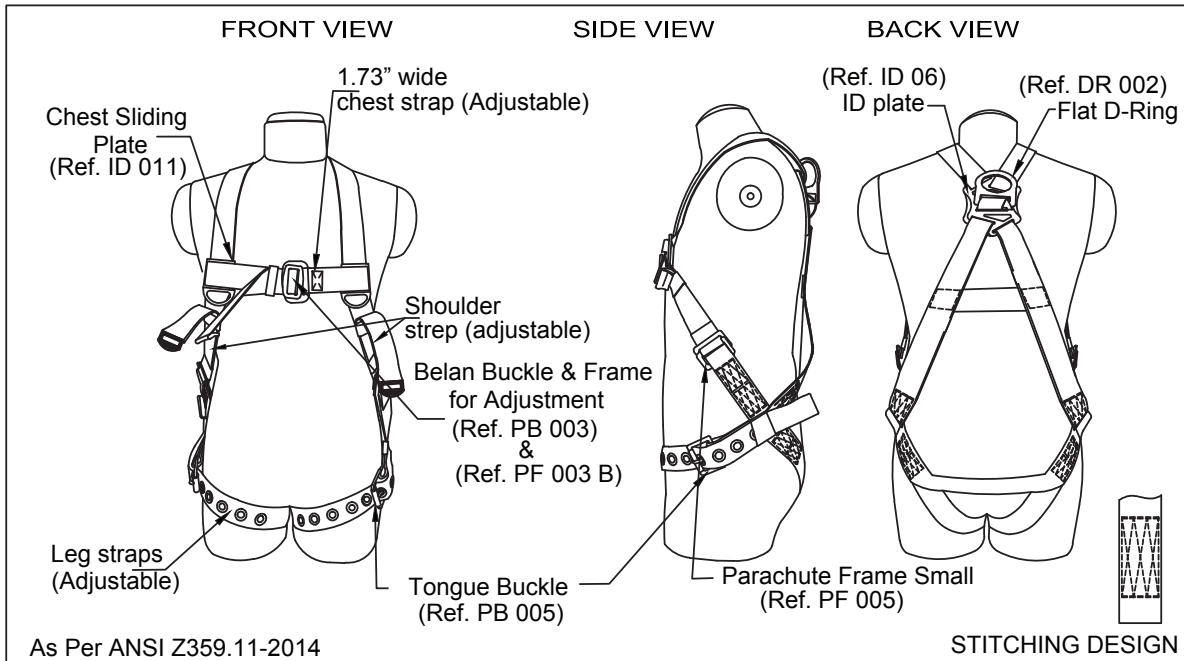

- DESIGN:**
- One dorsal attachment D-ring for fall arrest.
 - Adjustable shoulder straps.
 - Adjustable grommeted leg straps.

WEBBING: Material: Polyester | Width: 1.73 in. ± 0.04 in. | Breaking Strength: 5000 lbs.

STITCHING THREAD: Material: High-tenacity polyester | Color: Yellow/Black

METAL COMPONENT: Material: Alloy steel | Finish: Silver or yellow golden galvanized

VITAL TEST COMPLIANCE: Static Strength: 3600 lbs. for 1 Minute
 Dynamic performance: Free fall from 6 ft. height done to a test dummy weighing 220.46 lbs. at dorsal attachment element. Harness should not release the dummy for 5 minutes (Retention time).

WEIGHT OF HARNESS: 3.31 lbs. ± 0.02 lbs.

Part #	Color
H21210003	Blue
H21210006	Green

TECHNICAL SPECIFICATIONS

Harness 5pt. Back Padded, Grommet Leg, & Back/Side D rings.

Assorted color options for top, black heavy duty bottom with 5 point adjustment. Pass-thru chest, grommet legs, hip D-rings, sewn in back pads. Universal size. Meets or Exceeds ANSI Z359.11-2014. A10.32-2012.

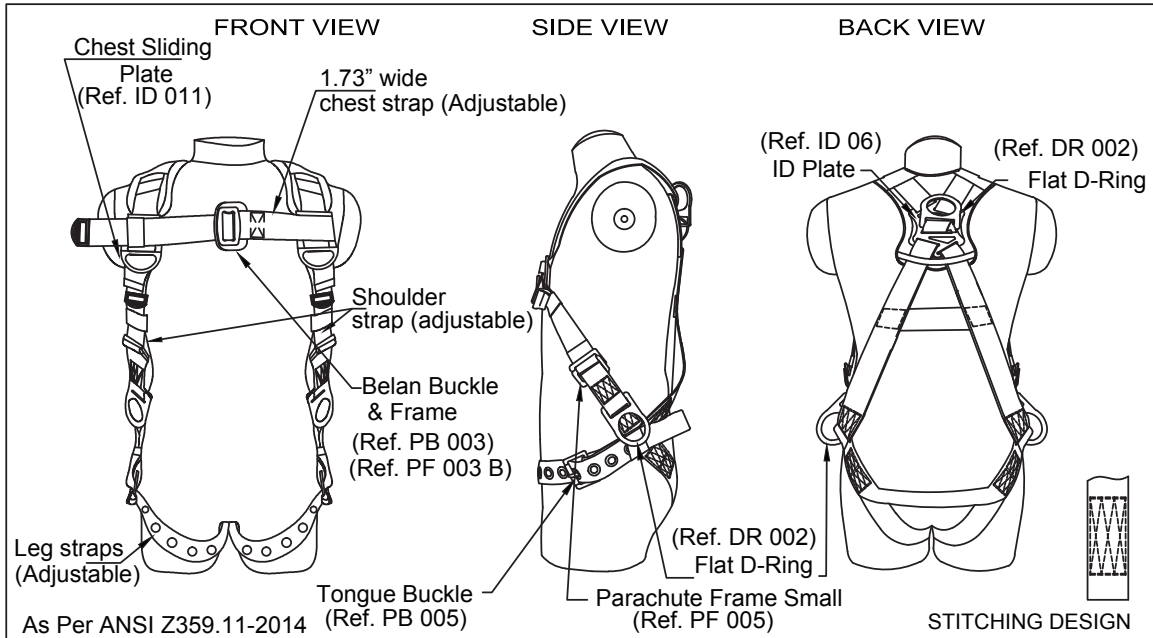

- DESIGN:**
- One dorsal attachment D-ring for fall arrest.
 - Adjustable Shoulder straps.
 - Adjustable grommeted leg straps.
 - Two side D-rings for work positioning

WEBBING: Material: Polyester
 Width: 1.73 in. ± 0.04 in.
 Breaking Strength: 5000 lbs.

STITCHING THREAD: Material: High-tenacity polyester

METAL COMPONENT: Material: High Strength Steel
 Plating: Zinc plated
 Finish: Shot blasted

VITAL TEST COMPLIANCE: Static Strength: 3600 lbs. for 1 Minute
 Dynamic performance: Free fall from 6 feet height done to a test dummy weighing 220.46 lbs. at dorsal attachment element. Harness should not release the dummy for 5 minutes (Retention time).

WEIGHT OF HARNESS: 3.97 lbs. ± 0.02 lbs.

Part #	Color
H21210111	Red
H21210115	Yellow
H21210116	Green

TECHNICAL SPECIFICATIONS

Harness 5pt., QCB, Padded Back & Leg, & Back D-ring. Black Color.

Black top, black padding, 5 point adjustment, QCB, padded back sewn in, padded legs sewn in, and back d-ring. Universal size. Meets or Exceeds ANSI Z359.11-2014. A10.32-2012

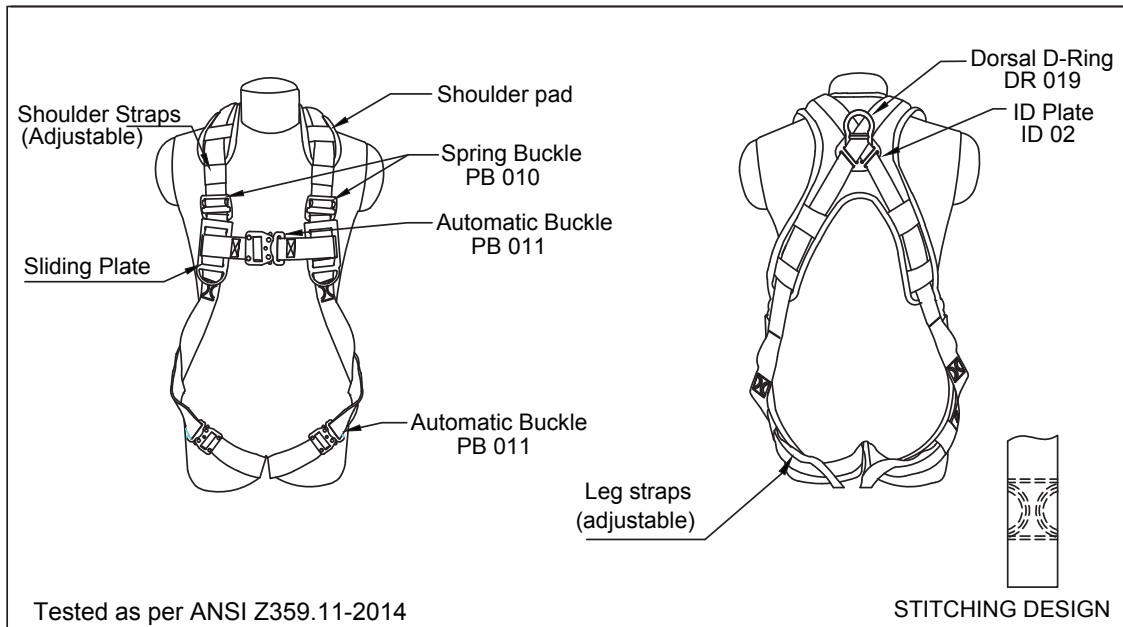

- DESIGN:**
- One dorsal attachment D-ring for fall arrest.
 - Adjustable shoulder straps for easy adjustment and snug fitting.
 - Adjustable leg straps for snug fitting.
 - Two lanyard keepers have been incorporated to store unused leg of the lanyard.

WEBBING: Material: Polyester
 Width: 1.73 in. ± 0.04 in.
 Breaking Strength: 5000 lbs.

STITCHING THREAD: Material: High-tenacity polyester

METAL COMPONENT: Material: Alloy Steel
 Finish: Silver or Golden Yellow Galvanized, Black Electrophoretic

D-RING: Material: Aluminum Alloy
 Finish: Natural Silver Polished or Powder Coated

VITAL TEST COMPLIANCE: Static Strength: 3600 lbs. for 1 Minute
 Dynamic performance: Free fall from 6 feet height done to a test dummy weighing 220.46 lbs. at dorsal attachment element. Harness should not release the dummy for 5 minutes (Retention time).

WEIGHT OF HARNESS: 3.79 lbs. ± 0.02 lbs.

TECHNICAL SPECIFICATIONS

Harness 5pt., QCB, Padded Back & Leg, Back D-Ring, Side D-Rings with Positioning Belt, Black Color

Black top, black padding, 5 point adjustment, QCB, padded back sewn in, padded legs sewn in, positioning belt black. and 3 D-Rings. Universal size. Meets or Exceeds ANSI Z359.11-2014. A10.32-2012.

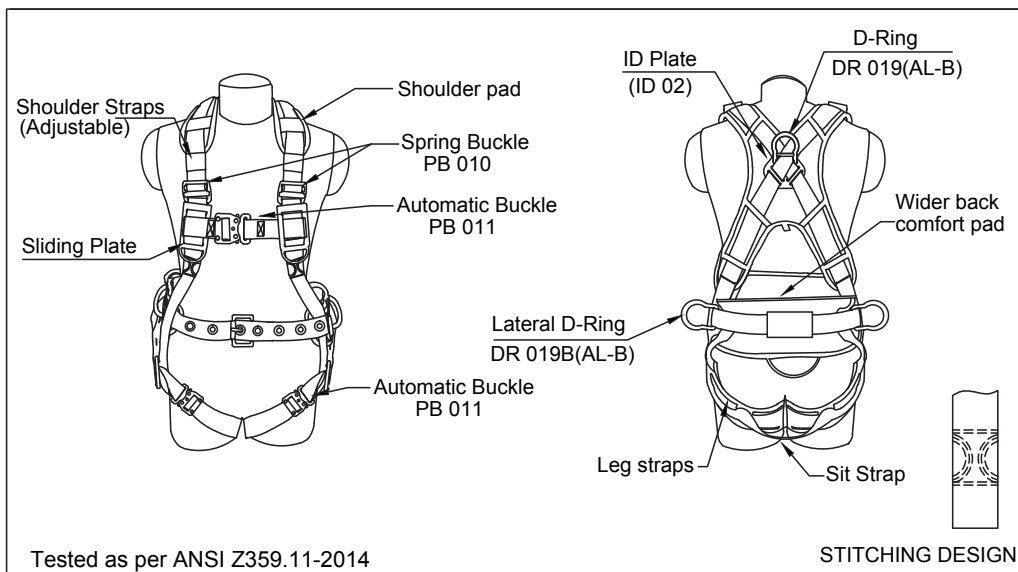

DESIGN:

- One dorsal attachment D-ring for fall arrest.
- Adjustable shoulder straps for easy adjustment and snug fitting.
- Adjustable leg straps for snug fitting.
- Two lanyard keepers have been incorporated to store unused leg of the lanyard.
- Equipped with work positioning belt.
- Equipped with two side D-rings for work positioning.

WEBBING: Material: Polyester | Width: 1.73 in. ± 0.04 in. | Breaking Strength: 5000 lbs.

STITCHING THREAD: Material: High-tenacity polyester

METAL COMPONENT: Material: Alloy Steel
 Finish: Silver or Golden Yellow Galvanized

D-RING: Material: Aluminum Alloy | Finish: Natural Silver Polished or Powder Coated

VITAL TEST COMPLIANCE: Static Strength: 3600 lbs. for 1 Minute at attachment element.
 Dynamic performance: Free fall from 6 feet height done to a test dummy weighing 220.46 lbs. at dorsal attachment element. Harness should not release the dummy for 5 minutes (Retention time).

WEIGHT OF HARNESS: 5.89 lbs. ± 0.02 lbs.

TECHNICAL SPECIFICATIONS

Harness 5pt., QCB, Padded Back & Leg, Side D-Rings, Positioning Belt, Dual Front D Rings.

Black top , black padding, 5 point adjustment, QCB, padded back sewn in, padded legs sewn in, 3 D-Rings, and front dual D-Rings. Universal size. Meets or Exceeds ANSI Z359.11-2014. A10.32-2012

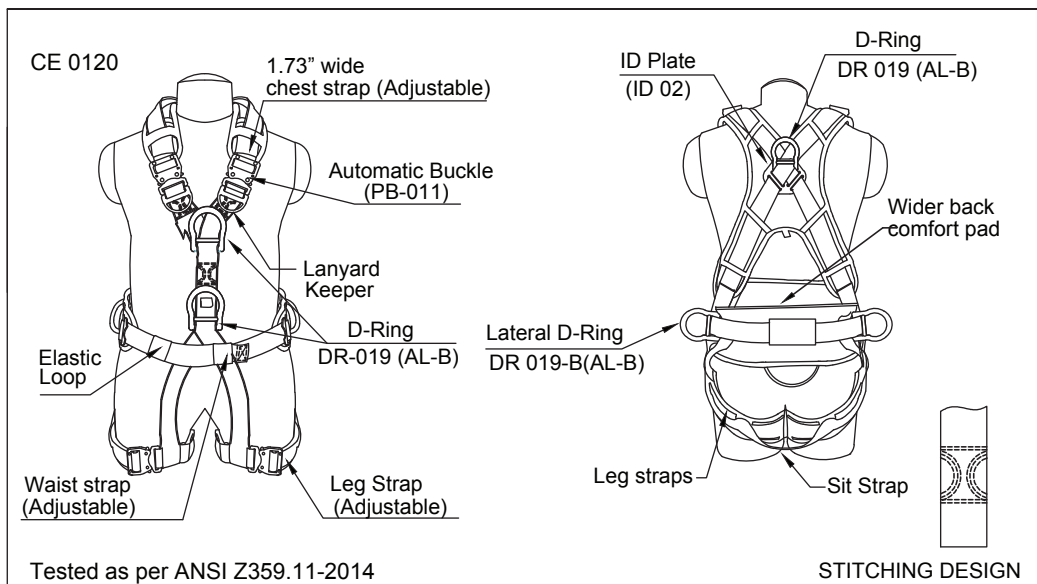

- One dorsal attachment D-ring for fall arrest & one front D-ring for climbing purpose.
- Adjustable shoulder straps for easy adjustment and snug fitting.
- Adjustable leg straps for snug fitting.
- DESIGN:**
 - Two lanyard keepers have been incorporated to store unused leg of the lanyard.
 - Equipped with work positioning belt.
 - Equipped with two side D-rings for work positioning.
 - Equipped with ventral D-ring for rope access purpose.

WEBBING: Material: Polyester | Width: 1.73 in. ± 0.04 in. | Breaking Strength: 5000 lbs.

STITCHING THREAD: Material: High-tenacity polyester

METAL COMPONENT: Material: Alloy Steel
 Finish: Silver or Golden Yellow Galvanized

D-RING: Material: Aluminum Alloy | Finish: Natural Silver Polished or Powder Coated

VITAL TEST COMPLIANCE: Static Strength: 3600 lbs. for 1 Minute at attachment element.
 Dynamic performance: Free fall from 6 feet height done to a test dummy weighing 220.46 lbs. at dorsal attachment element. Harness should not release the dummy for 5 minutes (Retention time).

WEIGHT OF HARNESS: 5.82 lbs. ± 0.02 lbs.

PN: C111

TECHNICAL SPECIFICATIONS

Hook Carabiner .67"

Micro double connection with steel twist lock, ½" gate opening, gate strength of 3600 lbs., and Min breaking strength of 5000 lbs. Meets ANSI Z359.12-2009.

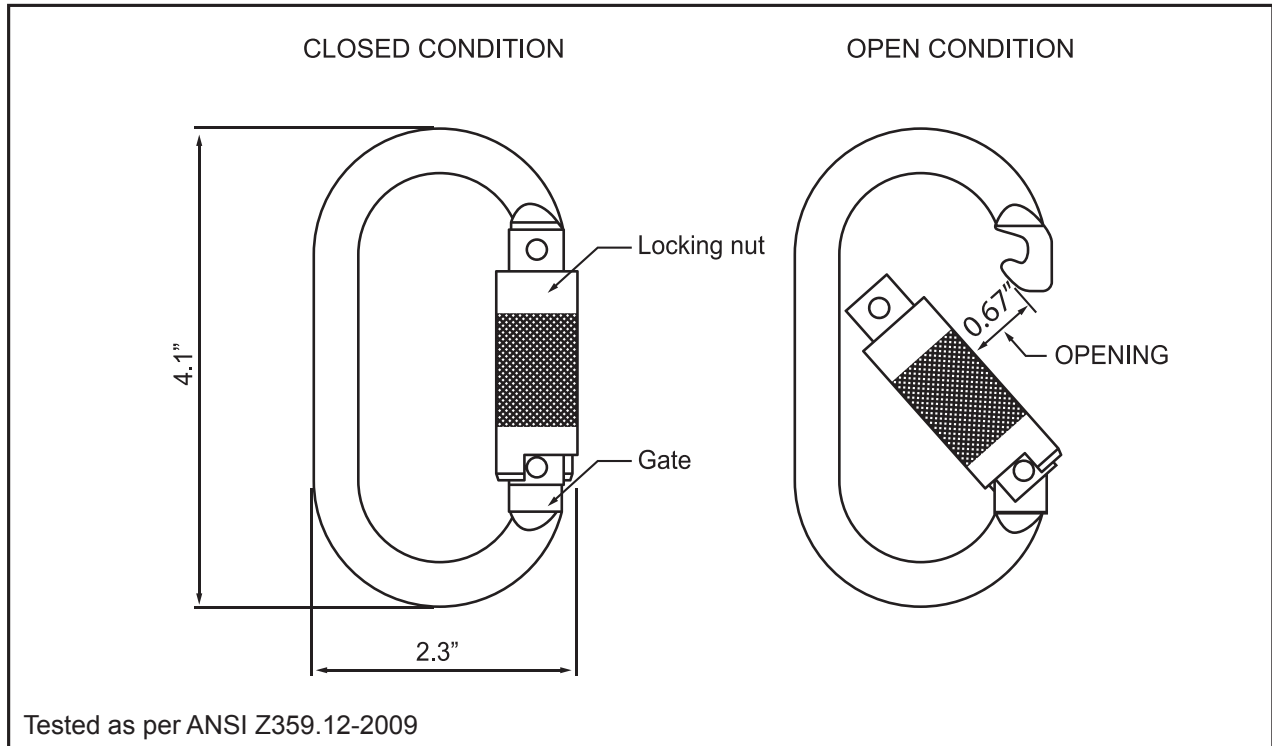

- DESIGN:**
- Gate opening 0.67".
 - Oval shaped carabiner made of round steel bar.
 - Quarter turn locking carabiner.
 - Locking by auto nut rotation.

MATERIAL: Alloy Steel

FINISH: Galvanized with golden yellow/silver passivation

MINIMUM BREAKING STRENGTH: 5000 lbs.

GATE FACE STRENGTH: 3600 lbs.

GATE SIDE STRENGTH: 3600 lbs.

WEIGHT: 0.35 lbs. ± 0.02 lbs.

TECHNICAL SPECIFICATIONS

Hook Carabiner .84"

Steel twist lock, ½" gate opening, gate strength of 3600 lbs., and Min breaking strength of 5000 lbs. Meets ANSI Z359.12-2009.

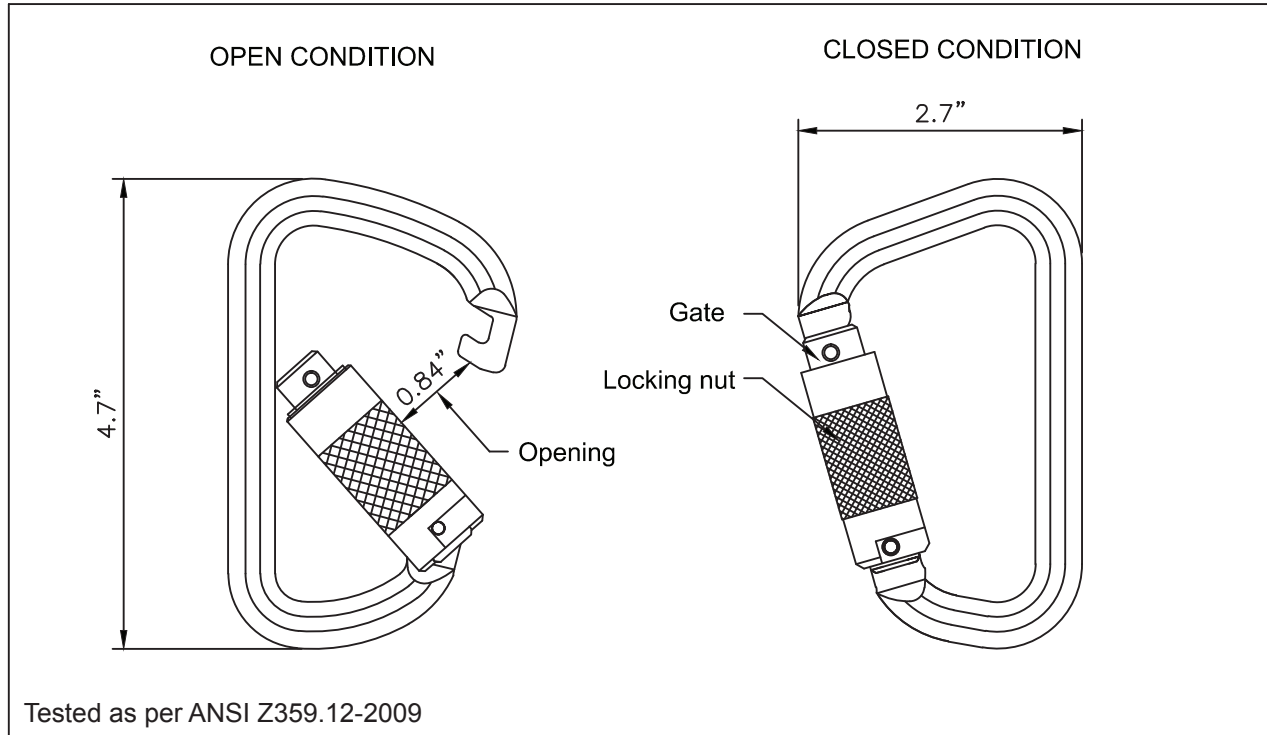

- DESIGN:**
- Gate opening 0.84\".
 - Oval shaped carabiner made of 0.43\" diameter round bar.
 - Self closing and automatic locking type carabiner.
 - Locking by quarter turn nut.

MATERIAL: Alloy Steel

FINISH: Galvanized with golden yellow/silver passivation

MINIMUM BREAKING STRENGTH: 9000 lbs.

GATE FACE STRENGTH: 3600 lbs.

GATE SIDE STRENGTH: 3600 lbs.

WEIGHT: 0.584 lbs. ± 0.02 lbs.

TECHNICAL SPECIFICATIONS

Hook Carabiner 1.97"

Yellow chromate finish, forged steel twist lock gate, 2 ½" gate opening. Gate Strength 3600 lbs. Min breaking strength 5000 lbs. Meets ANSI Z359.12-2009.

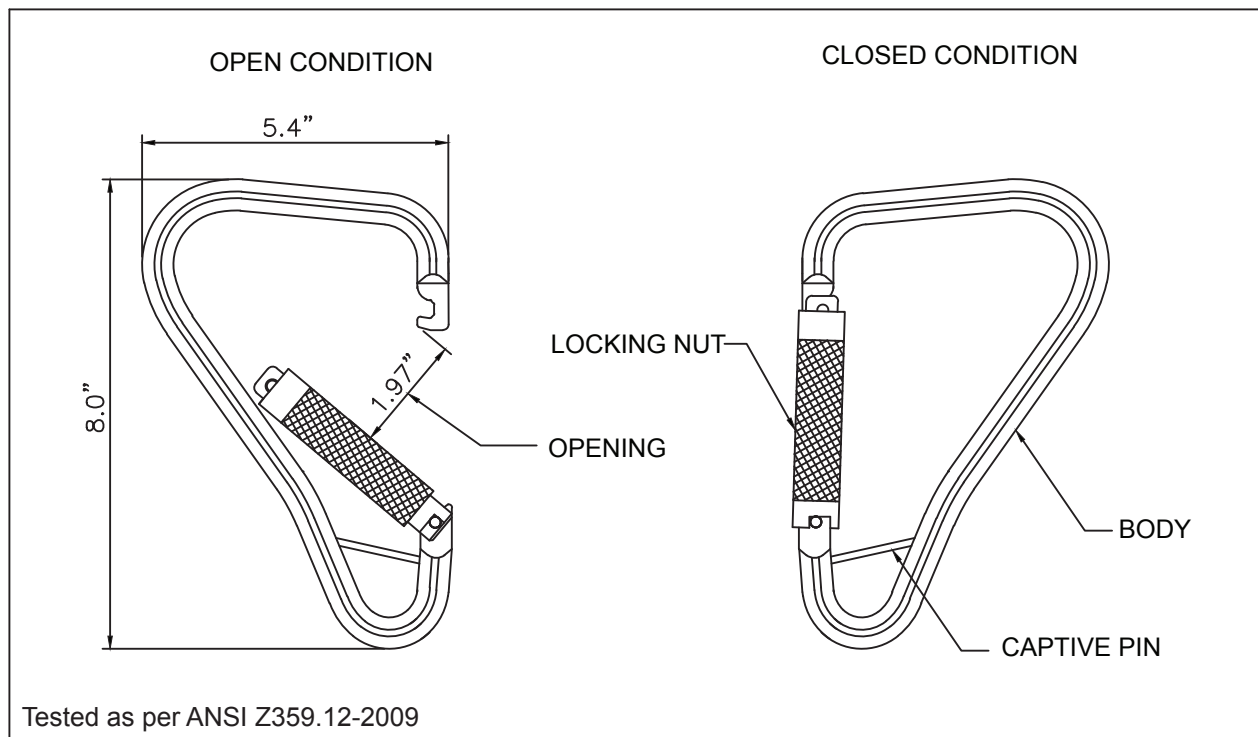

- DESIGN:**
- Gate opening 1.97".
 - Steel tower hook made of 0.55" diameter round bar.
 - Self closing and automatic locking type hook.
 - Locking by quarter turn nut.

MATERIAL: Alloy Steel

FINISH: Galvanized with golden yellow/silver passivation

MINIMUM BREAKING STRENGTH: 5000 lbs.

GATE FACE STRENGTH: 3600 lbs.

GATE SIDE STRENGTH: 3600 lbs.

WEIGHT: 1.65 lbs. ± 0.02 lbs.

TECHNICAL SPECIFICATIONS

Hook Twin SRL Connector

Dual Leg SRL Converter with a C111 carabiner with SRL Plastic Connector. Gate Strength 3600 lbs. Min breaking strength 5000 lbs. Meets ANSI Z359.12-2009.

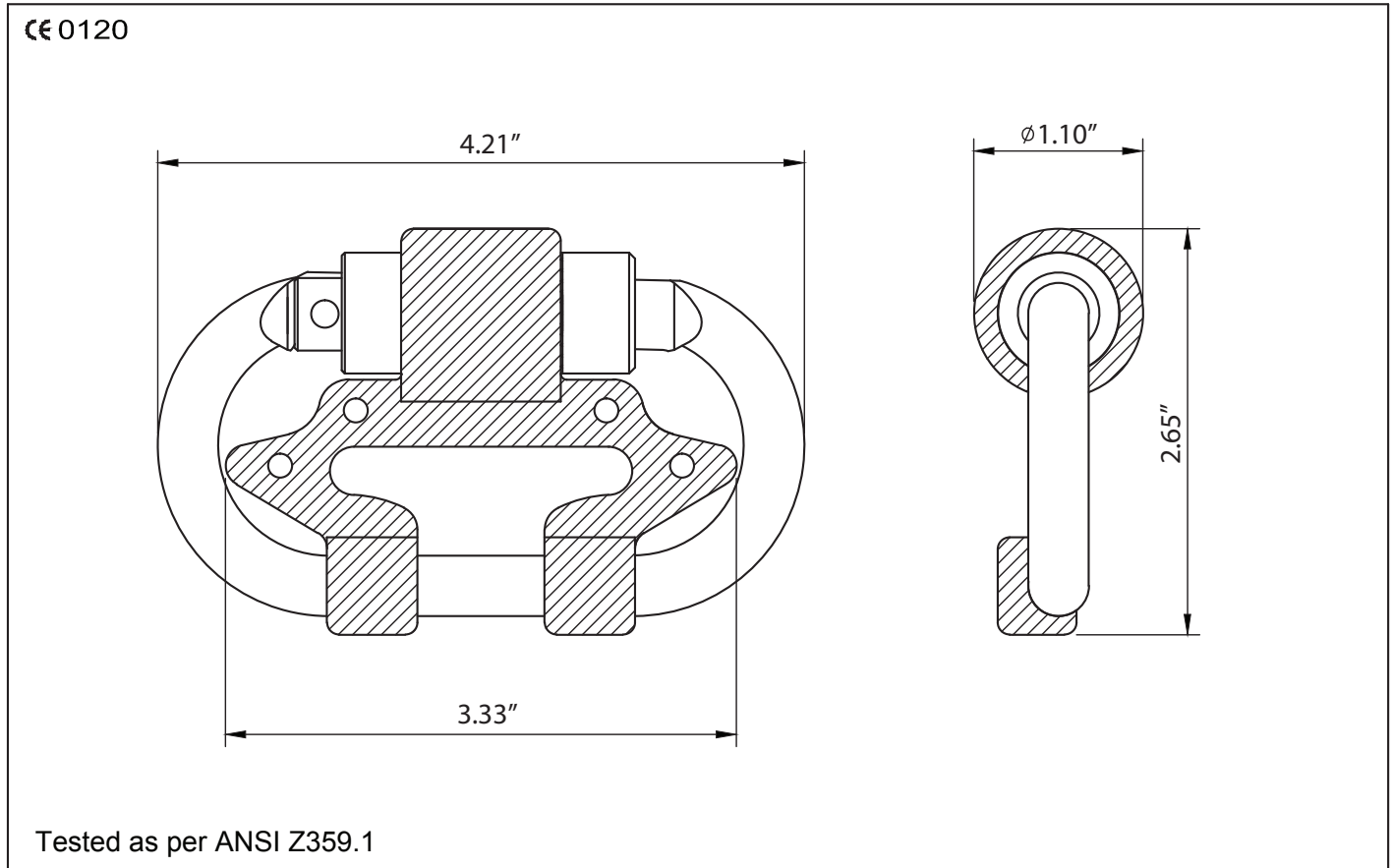

DESIGN: Ultimate solution to attach 2 SRL's directly with user's harness with no additional connector required. Also reduces the length of swing during the fall thereby preventing impact of SRL's on the back of user's head.

MATERIAL: C111: Alloy Steel
 Separator: High density polyethylene

FINISH: C111: Zinc plated with yellow/silver passivation

MINIMUM BREAKING STRENGTH: 23 kN (5170 lbs.)

WEIGHT: 0.385 lbs. ± 0.02 lbs. (175.0 gm ± 10.0 gm)

PN: SRL170

TECHNICAL SPECIFICATIONS

Hook Twin SRL Steel Connector

Dual Leg SRL Converter with a PN 170 alloy steel connector. Gate Strength 3600 lbs. Min breaking strength 5000 lbs. Meets ANSI Z359.12-2009.

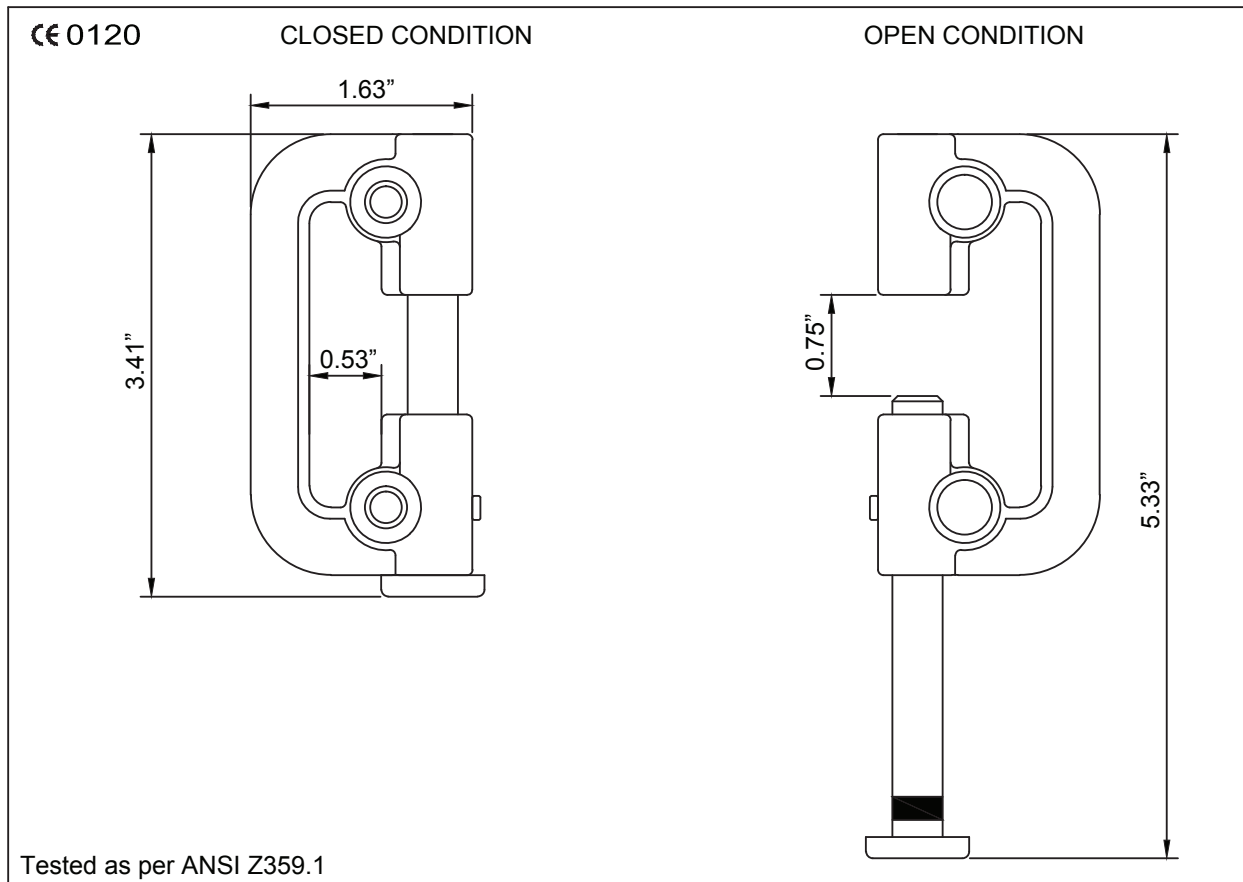

DESIGN: Ultimate solution to attach 2 SRL's directly with user's harness with no additional connector required. Also reduces the length of swing during the fall thereby preventing impact of SRL's on the back of user's head.

MATERIAL: High Strength Alloy Steel

FINISH: Zinc plated in yellow passivation

MINIMUM BREAKING STRENGTH: 23 kN (5170 lbs.)

MINOR STRENGTH: 15 kN (3372 lbs.)

WEIGHT: 0.374 lbs. \pm 0.02 lbs. (170 gm \pm 10.0 gm)

PN: LE18134

TECHNICAL SPECIFICATIONS

Lanyard Extender 18 in.

18" - 1 3/4" web single leg lanyard extender, locking snap hook on one end and large D-ring on opposite end.

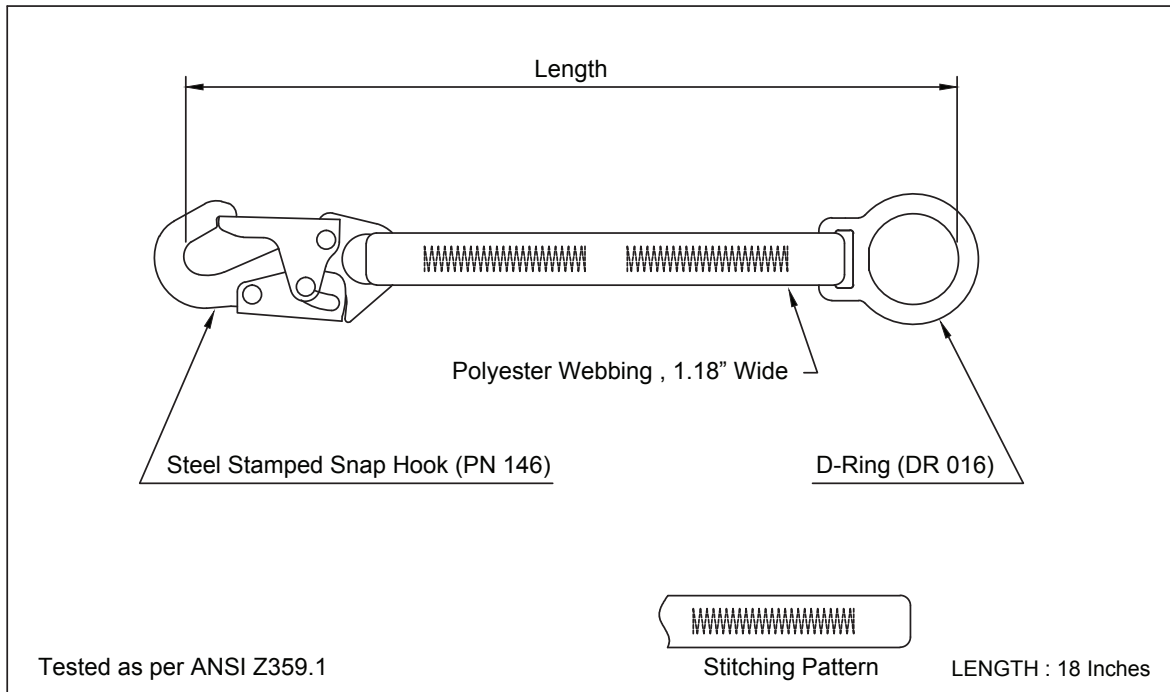

DESIGN: 1.18 in. wide polyester webbing having steel stamped snap hook (PN 146) at one end & D-ring (DR 016) at other end.

WEBBING: Material: Polyester
Width: 1.18 in. ± 0.04 in.
Breaking Strength: 6000 lbs.

STITCHING THREAD: Material: High-tenacity polyester

METAL COMPONENT: Material: Alloy Steel
Plating: Zinc plated
Finish: Shot blasted
Breaking Strength: 5000 lbs.

VITAL TEST COMPLIANCE: Static Strength: 5000 lbs. for 1 minute

WEIGHT: 1.21 lbs. ± 0.02 lbs.

TECHNICAL SPECIFICATIONS

Positioning Device Rebar

Rebar chain positioning device, one 2¼" hook swivel on top and two ¾" snap hooks on opposite ends. NO SHOCK ABSORBER. Adjustable hook. Conforms to ANSI Z359.3-2007.

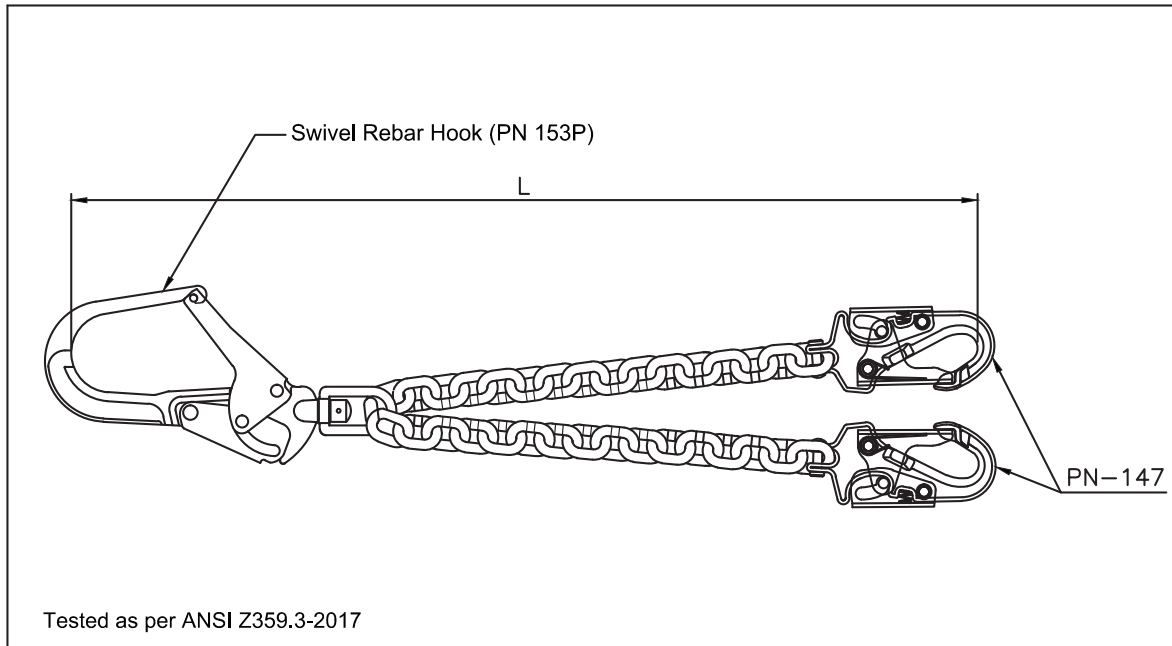

- DESIGN:**
- Double, Y shaped lanyard.
 - This positioning device incorporates a high tensile strength chain and has swivel rebar hook (PN 153P).
 - The two ends of the chain have the special forged clevis snap hooks (PN 147) used for positioning.
 - Available Length: (L) 59", 71" & 79"

CHAIN: 0.31" diameter link of chain
 Grade of Chain: Grade 80
 Tensile Strength: Min. 5000 lbs.

METAL COMPONENT: Material: Alloy Steel
 Plating: Zinc plated
 Finish: Deburred & polished

VITAL TEST COMPLIANCE: Static Strength: 5000 lbs. for 1 minute
 Dynamic Strength: When tested with 282 lbs. with a free fall to generate 3600 lbs. force on the receiving structure mass held clear off the ground for a period of 1 minute.

WEIGHT: 59 inch: 4.08 lbs. ± 0.2 lbs.
 71 inch: 4.34 lbs. ± 0.2 lbs.
 79 inch: 4.61 lbs. ± 0.2 lbs.

TECHNICAL SPECIFICATIONS

Lanyard 6 ft. Shock pack, small hooks. Single Leg.

6 ft. Single leg Shock-Sorb™ lanyard, 3/4" hook, yellow webbing, blue color shock pack. Meets ANSI Z359.13-2013.

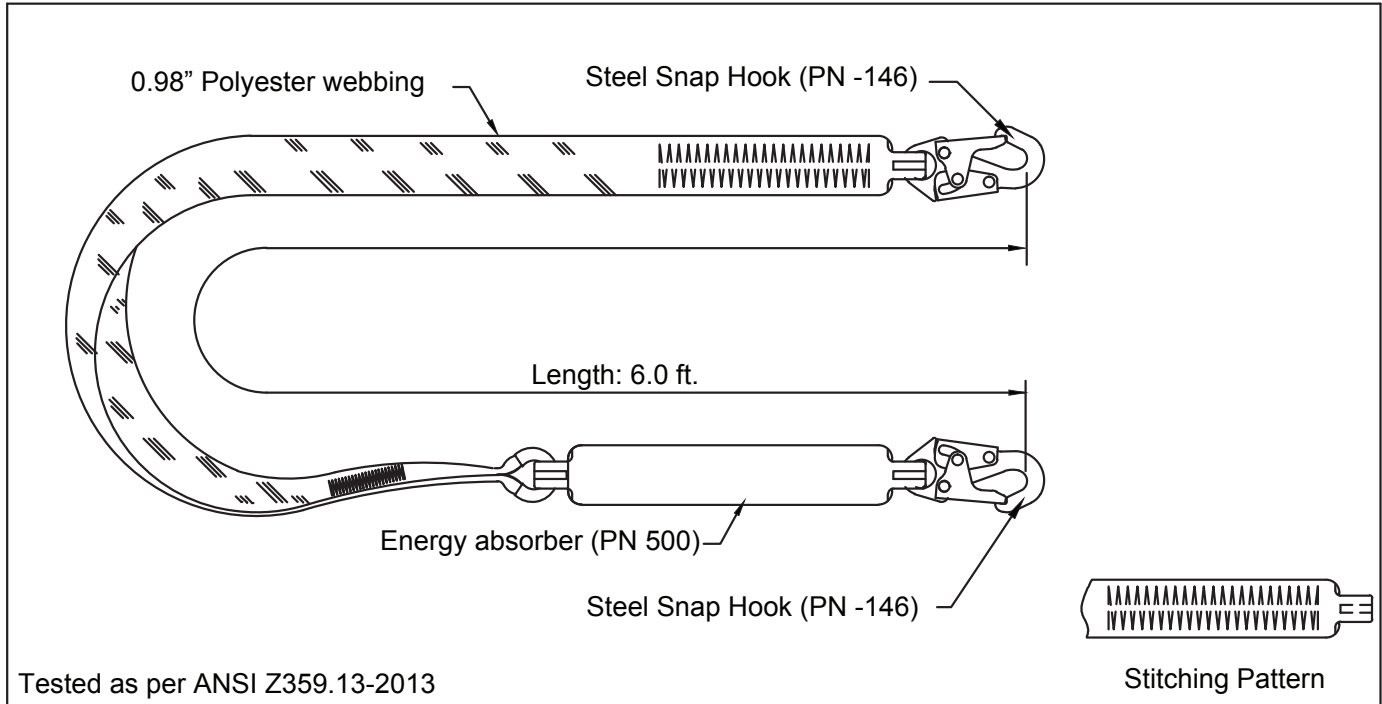

- DESIGN:**
- Single leg lanyard incorporated with energy absorber (PN 500).
 - Both ends of the lanyard equipped with steel snap hook (PN-146).

WEBBING: Material: Polyester
 Width: 0.98 in. ± 0.04 in.
 Breaking Strength: 6000 lbs.

STITCHING THREAD: Material: High-tenacity polyester

METAL COMPONENT: Material: Alloy Steel
 Finish: Silver or Golden Yellow Galvanized
 Breaking Strength: 5000 lbs.

VITAL TEST COMPLIANCE: Static Strength: 5000 lbs. for 1 minute
 Dynamic Strength: Maximum breaking force does not exceed 8 kN in the line when tested on a free fall from 6 ft. height attached to a test mass of 282 lbs.

WEIGHT: 2.72 lbs. ± 0.02 lbs.

TECHNICAL SPECIFICATIONS

Lanyard 6 ft. Internal Shock, small hooks. Single Leg.

6 ft. single leg, non-stretch, internal shock absorbing lanyard, 3/4" hooks, red webbing. Meets ANSI Z359.13-2013.

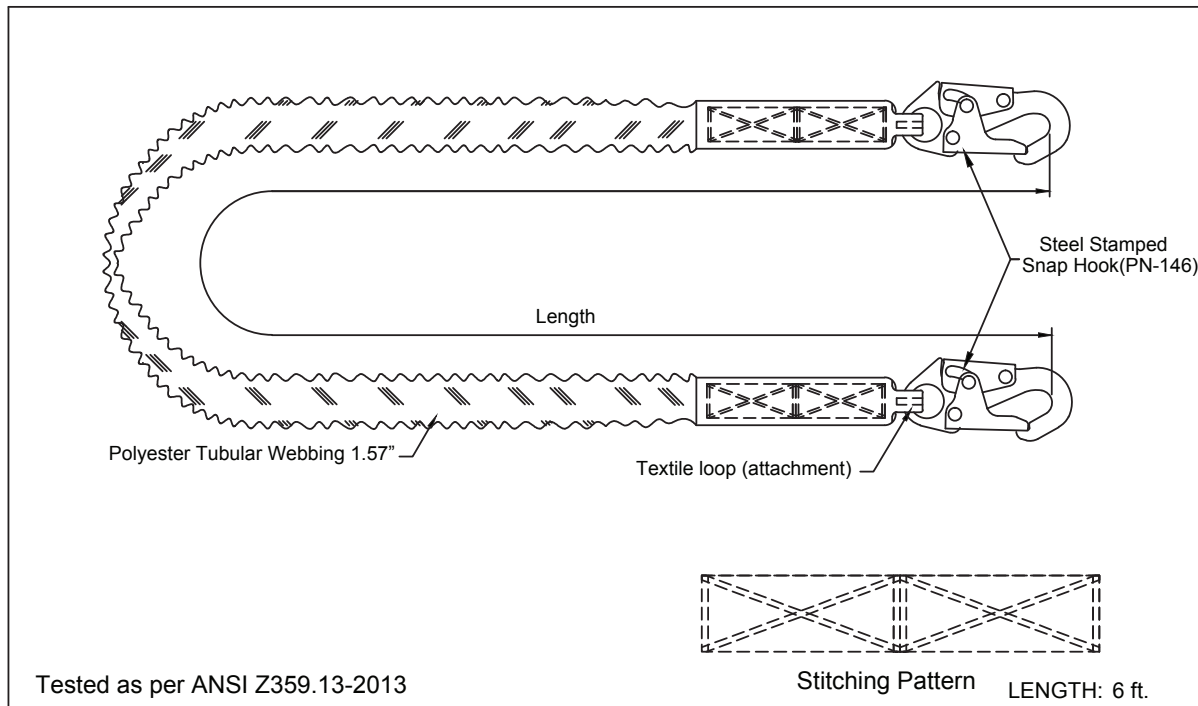

DESIGN: • 1.57 in. wide polyester tubular webbing incorporated with energy absorbing (6 ft.) polyester webbing. Both ends have a textile loop with steel stamped snap hook (PN 146).

WEBBING: Material: Polyester
 Width: 1.57 in. ± 0.04 in.
 Breaking Strength: 5000 lbs.

STITCHING THREAD: Material: High-tenacity polyester

METAL COMPONENTS: Material: Alloy steel
 Plating: Zinc plated
 Finish: Shot blasted
 Breaking Strength: 5000 lbs.

VITAL TEST COMPLIANCE: Static Strength: 5000 lbs. for 1 minute
 Dynamic Strength: Maximum breaking force does not exceed 1800 lbs. in the line when tested on a free fall from 6 ft. height attached to a test mass of 282 lbs.

WEIGHT: 2.54 lbs. ± 0.02 lbs.

TECHNICAL SPECIFICATIONS

Lanyard 6 ft. Shock pack, rebar hook. Single Leg.

6 ft. Single leg Shock-Sorb™ lanyard, 2¼" hook, yellow webbing, blue color shock pack. Meets ANSI Z359.13-2013.

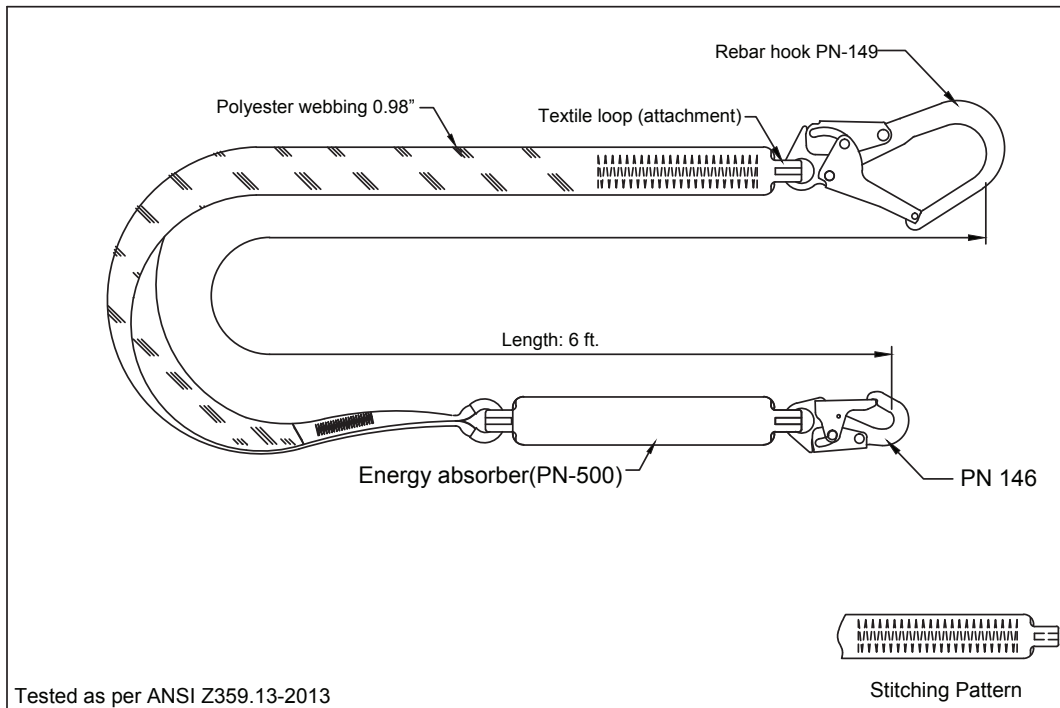

- DESIGN:**
- Single leg lanyard incorporated with energy absorber (PN 500).
 - One end of the lanyard equipped with steel snap hook (PN-146) and the other end of the lanyard equipped with Rebar hook (PN-149).

WEBBING: Material: Polyester
 Width: 0.98 in. ± 0.04 in.
 Breaking Strength: 6000 lbs. (Min)

STITCHING THREAD: Material: High-tenacity polyester

METAL COMPONENT: Material: Alloy Steel
 Finish: Silver or Golden Yellow Galvanized
 Breaking Strength: 5000 lbs.

VITAL TEST COMPLIANCE: Static Strength: 5000 lbs. for 1 minute
 Dynamic Strength: Maximum breaking force does not exceed 8 kN in the line when tested on a free fall from 6 ft. height attached to a test mass of 282 lbs.

WEIGHT: 3.44 lbs. ± 0.02 lbs.

TECHNICAL SPECIFICATIONS

Lanyard 6 ft. Internal Shock, Rebar hook. Single leg.

6ft. single leg, non-stretch, internal shock absorber lanyard, 2¼" rebar hook. Red webbing. Meets ANSI Z359.13-2013.

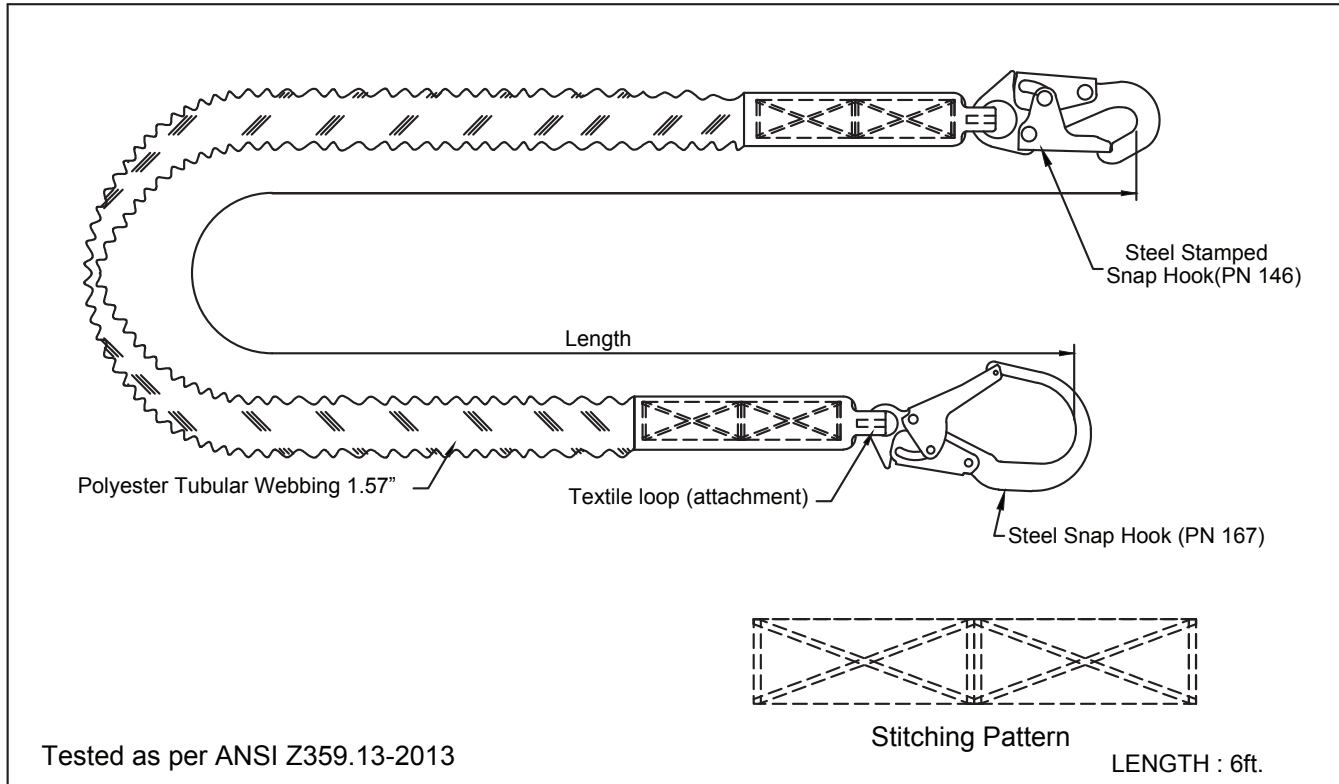

- DESIGN:**
- 1.57 in. wide polyester tubular elasticated webbing incorporated with energy absorbing (6 ft.) POY webbing.
 - One end of the lanyard equipped with steel stamped snap hook (PN-146) and the other end of the lanyard equipped with a steel snap hook (PN-167).

WEBBING: Material: Polyester | Width: 1.57 in. ± 0.04 in. | Breaking Strength: 5000 lbs.

STITCHING THREAD: Material: High-tenacity polyester

METAL COMPONENTS: Material: Alloy steel
 Plating: Zinc plated
 Finish: Shot blasted
 Breaking Strength: 5000 lbs.

VITAL TEST COMPLIANCE: Static Strength: 5000 lbs. for 1 minute
 Dynamic Strength: Maximum breaking force does not exceed 1800 lbs. in the line when tested on a free fall from 6 ft. height attached to a test mass of 282 lbs.

WEIGHT: 3.37 lbs. ± 0.02 lbs.

TECHNICAL SPECIFICATIONS

Lanyard 6 ft. Shock pack, small hooks. Double Leg.

6 ft. Double leg Shock-Sorb™ lanyard, 3/4" hook, yellow webbing , blue color shock pack. Meets ANSI Z359.13-2013.

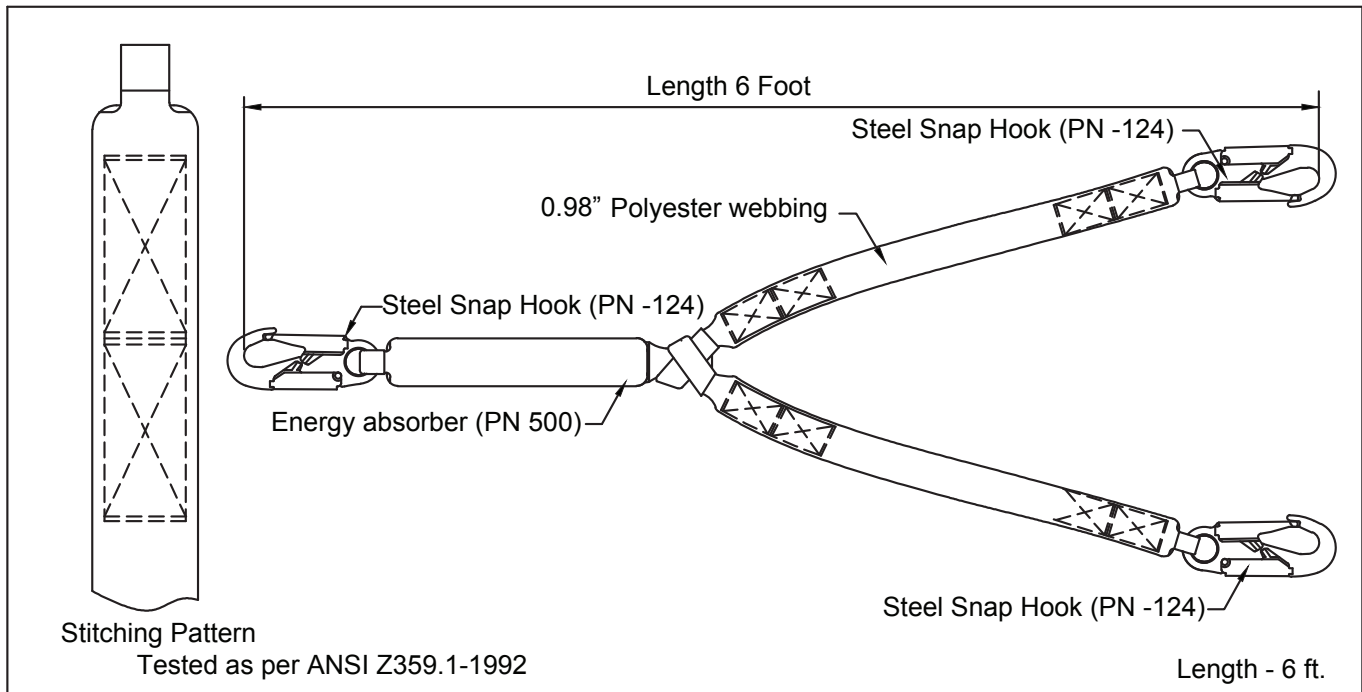

- DESIGN:**
- Double, Y shaped lanyard incorporated with energy absorber.
 - All ends of the lanyard equipped with steel snap hook (PN-124).

WEBBING: Material: Polyester
 Width: 0.98 in. ± 0.04 in.
 Breaking Strength: 30 kN (Min)

STITCHING THREAD: Material: High-tenacity polyamide
 Color: Black

METAL COMPONENT: Material: Medium Carbon Steel (Hardness 35 to 42 HRC)
 Plating: Zinc Plated | Finish: Shot blasted
 Tensile Strength (PN-124): MIN 22.2 kN | Gate Face Testing (PN-124): MIN 1.0 kN
 Side Load Testing (PN-124): MIN 1.6 kN

VITAL TEST COMPLIANCE: Static Strength: 22.2 kN for 2 minutes
 Dynamic Strength: Maximum breaking force does not exceed 8 kN and lanyard elongation does not exceed 42 inches from a 6 foot free fall.

WEIGHT: 2.77 lbs. ± 0.02 lbs.

TECHNICAL SPECIFICATIONS

Lanyard 6 ft. Shock pack, rebar hooks. Double Leg.

6 ft. Double leg Shock-Sorb™ lanyard, 2¼" hook, yellow webbing, blue color shock pack. Meets ANSI Z359.13-2013.

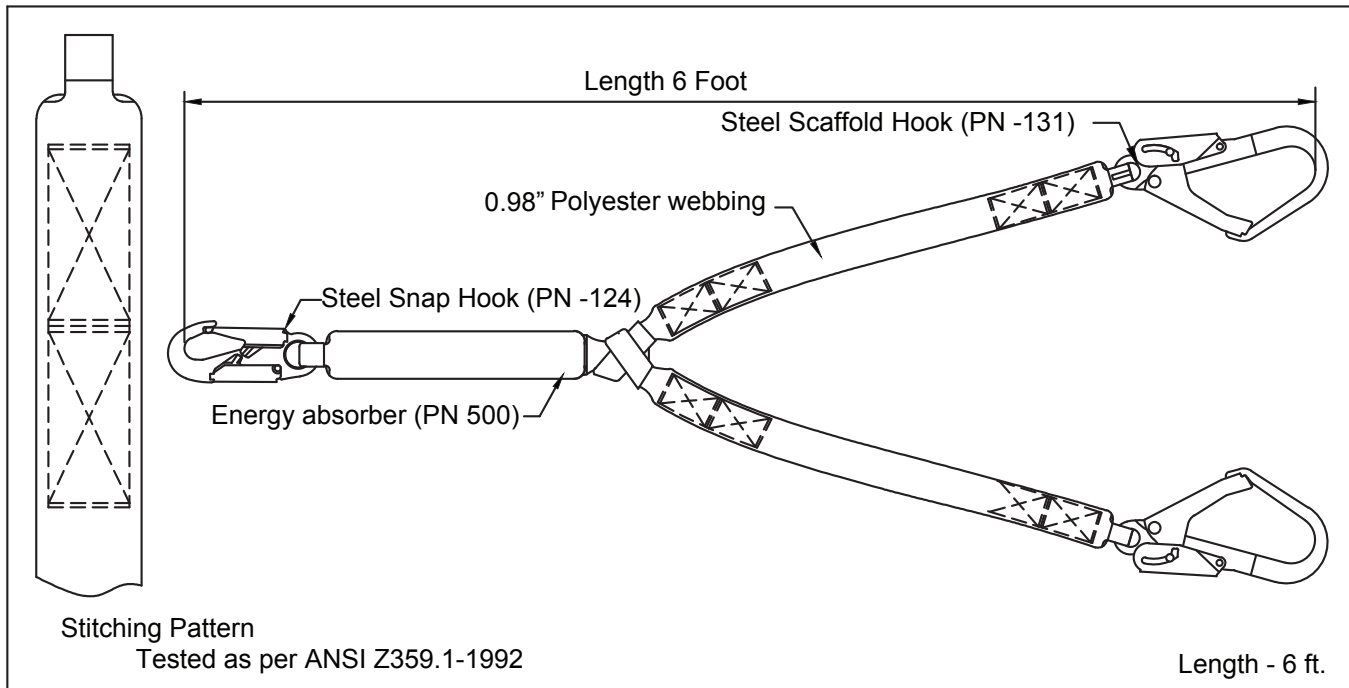

- DESIGN:**
- Double, Y shaped lanyard incorporated with energy absorber.
 - One end of the energy absorber equipped with steel snap hook (PN-124) while the other sides of the lanyard are equipped with Steel scaffold hooks (PN-131).

WEBBING: Material: Polyester | Width: 0.98 in. ± 0.04 in. | Breaking Strength: 30 kN (Min)

STITCHING THREAD: Material: High-tenacity polyamide | Color: Black

METAL COMPONENT: Material: Medium Carbon Steel (Hardness 35 to 42 HRC)
 Plating: Zinc Plated | Finish: Shot blasted
 Tensile Strength (PN-124): MIN 22.2 kN | Tensile Strength (PN-131): MIN 22.2 kN
 Gate Face Testing (PN-124): MIN 1.0 kN | Gate Face Testing (PN-131): MIN 1.0 kN
 Side Load Testing (PN-124): MIN 1.6 kN | Side Load Testing (PN-131): MIN 1.6 kN

VITAL TEST COMPLIANCE: Static Strength: 22.2 kN for 2 minutes
 Dynamic Strength: Maximum breaking force does not exceed 8 kN and lanyard elongation does not exceed 42 inches from a 6 foot free fall.

WEIGHT: 3.85 lbs. ± 0.02 lbs.

TECHNICAL SPECIFICATIONS

Lanyard 6 ft. Internal Shock, Rebar Hooks. Double Leg.

6 ft. double leg, non-stretch, internal shock absorber lanyard, 3/4" rebar hooks. Red webbing. Meets ANSI Z359.13-2013

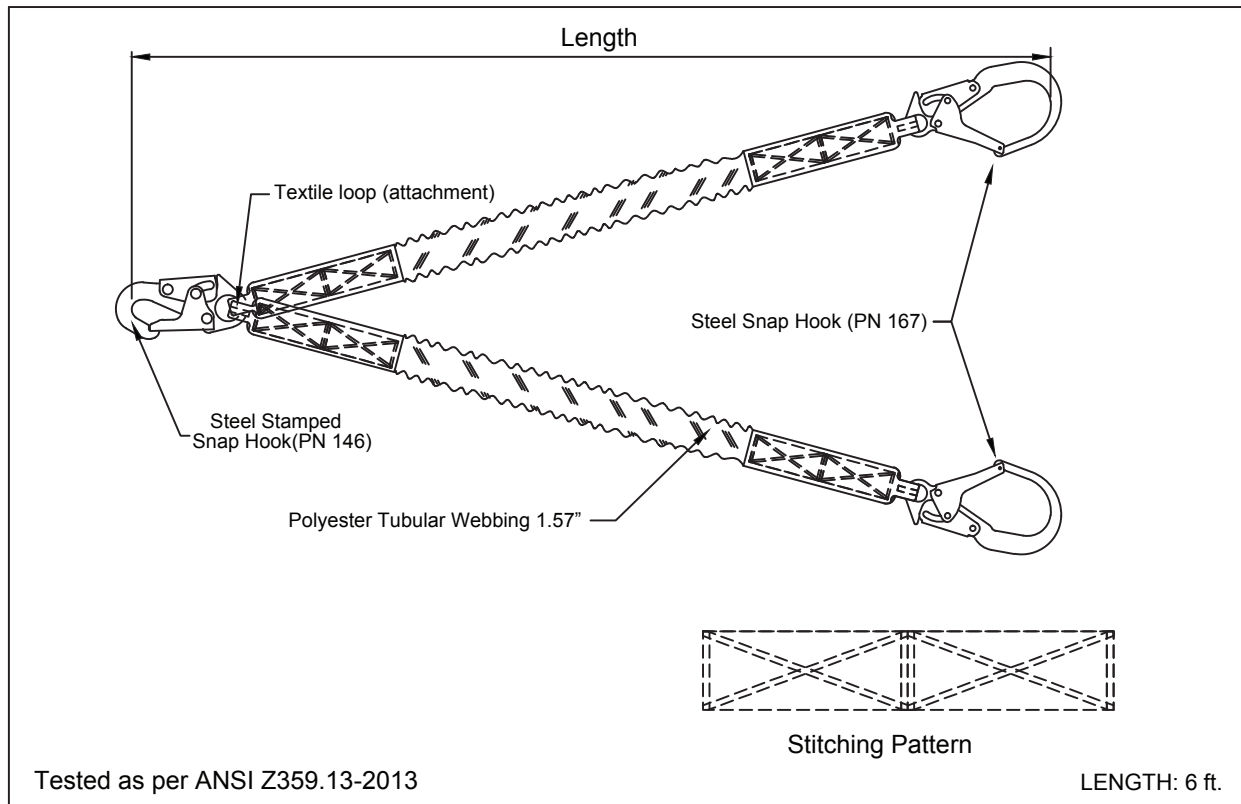

DESIGN: Y shaped 1.57 in. wide polyester tubular webbing incorporated with energy absorbing (6 ft.) polyester webbing with one end having a steel stamped snap hook (PN-146) and the other two ends having steel snap hooks (PN-167).

WEBBING: Material: Polyester | Width: 1.57 in. ± 0.04 in. | Breaking Strength: 6000 lbs. (Min)

STITCHING THREAD: Material: High-tenacity polyester

METAL COMPONENTS: Material: Alloy steel | Plating: Zinc plated | Finish: Shot blasted | Breaking Strength: 5000 lbs.

VITAL TEST COMPLIANCE: Static Strength: 5000 lbs. for 1 minute
 Dynamic Strength: Maximum breaking force does not exceed 1800 lbs. in the line when tested on a free fall from a 6 foot height attached to a test mass of 282 lbs.

WEIGHT: 5.84 lbs. ± 0.02 lbs.

PN: C0850

TECHNICAL SPECIFICATIONS

Rope Grab 3/8" diameter.

5/8" Large Bail Yellow Chromate Finish Rope Grab. Min breaking strength 3372 lbs. Meets ANSI Z359.1-2007.

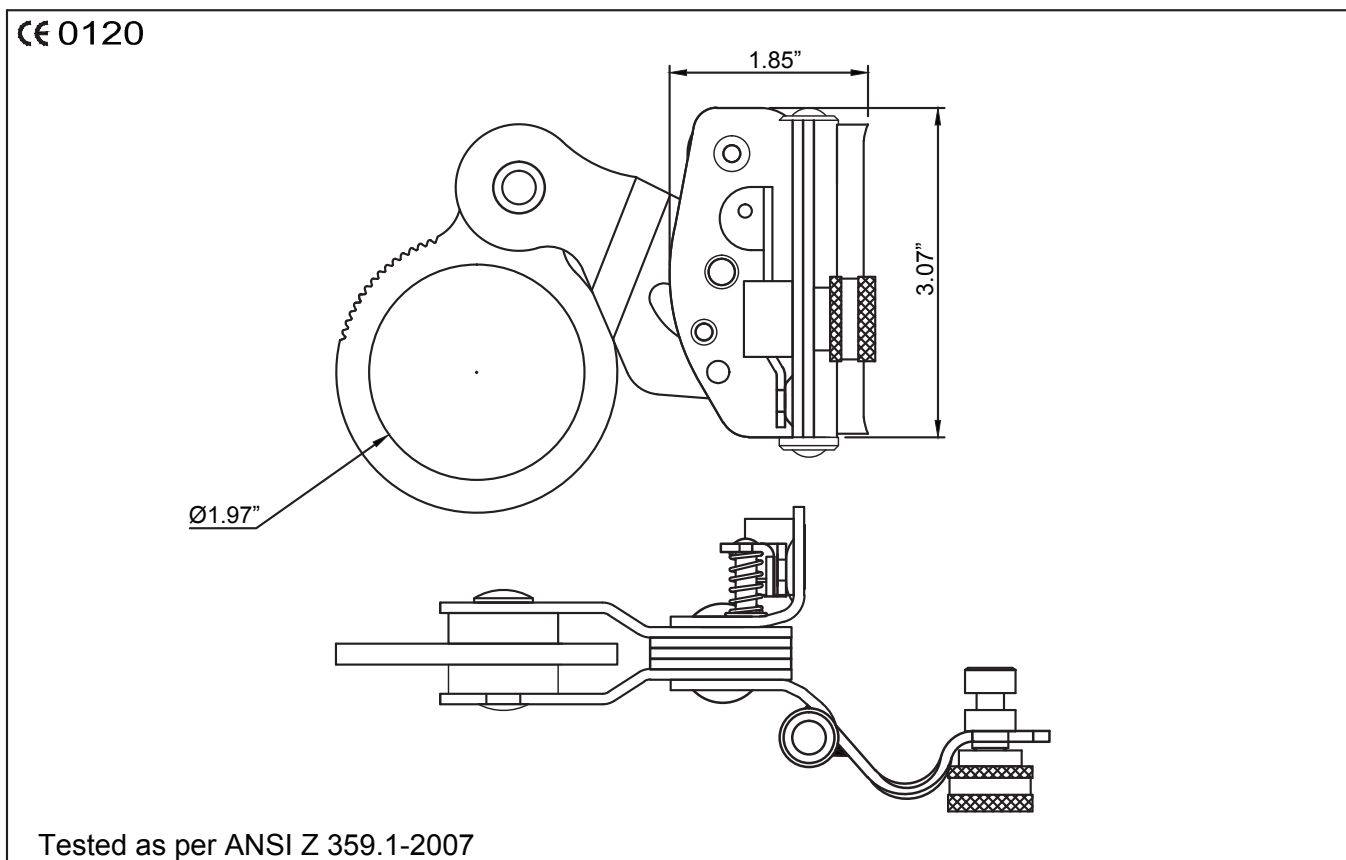

- Moving Rope Grab RG 08(50) on flexible anchorage line.
 - Moves along with the user climbing up or down and locks him in the case of a fall.
- DESIGN:**
- Capable of using on 0.47 in. diameter Kernmantle Rope.
 - Capable of using on 0.55 in. diameter & 0.63 in. diameter twisted rope.
 - Galvanized sheet openable rope grab with a unique anti-panic feature and a connecting eye of 1.97 in. diameter.

MATERIAL: Made of high strength alloy steel

FINISH: Golden yellow galvanized for better finish & corrosion protection

MINIMUM BREAKING STRENGTH: 15 kN

WEIGHT: 1.21 lbs. ± 0.02 lbs.

TECHNICAL SPECIFICATIONS

Vertical Rope Lifeline - Various Lengths

50 ft., 100 ft., or 150 ft. Lifeline 5/8" polyester rope, locking snap hook on one end. Meets ANSI Z359.1-2007.

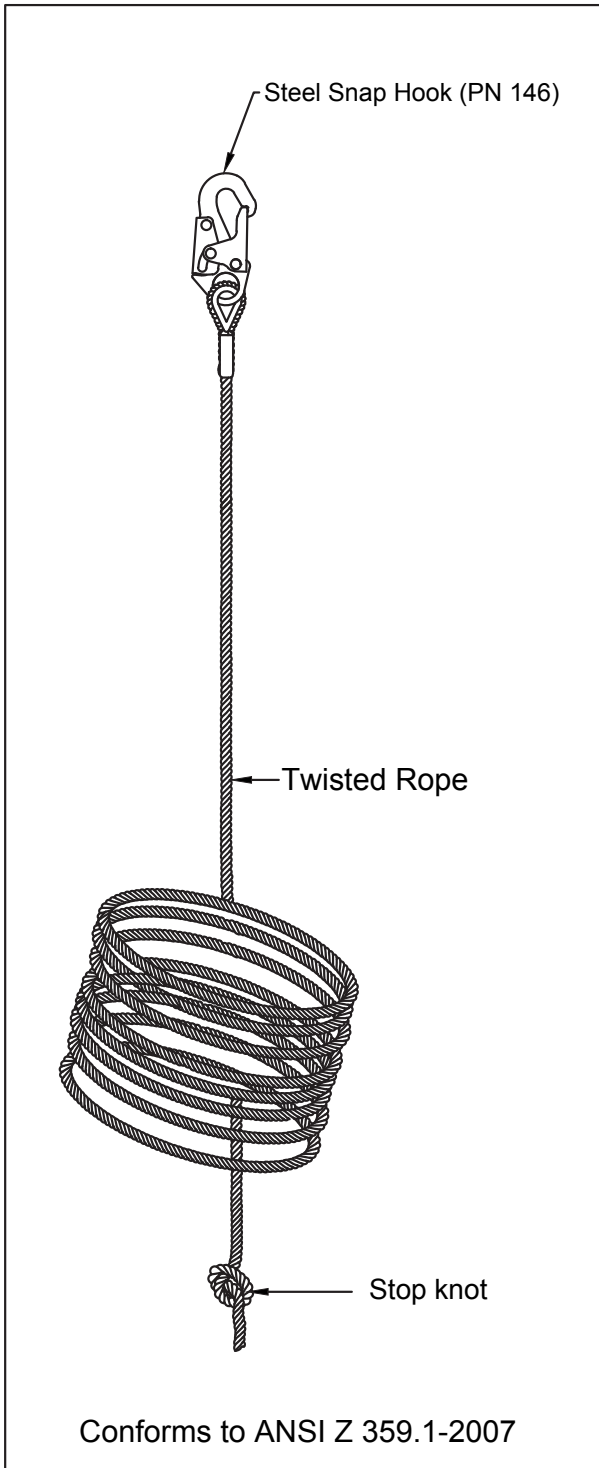

- DESIGN:**
- This lifeline is made up of high strength polysteel twisted rope.
 - The diameter of the rope is 5/8".
 - It is provided with snap hook (PN 146) spliced at one end and the other end has a stop knot.

- STEEL** • Made of Alloy Steel
SNAP • Silver or golden yellow galvanized
HOOK: • Breaking strength: 5000 lbs.

LENGTHS: 50', 100', or 150'

Part #	Length
V503201	50'
V1003201	100'
V1503201	150'

PN: S00140

TECHNICAL SPECIFICATIONS

Hook Rebar Scaffold

Rebar scaffold hook. Alloy Steel. Min breaking strength 5000 lbs. Conforms to ANSI Z359.12-2009.

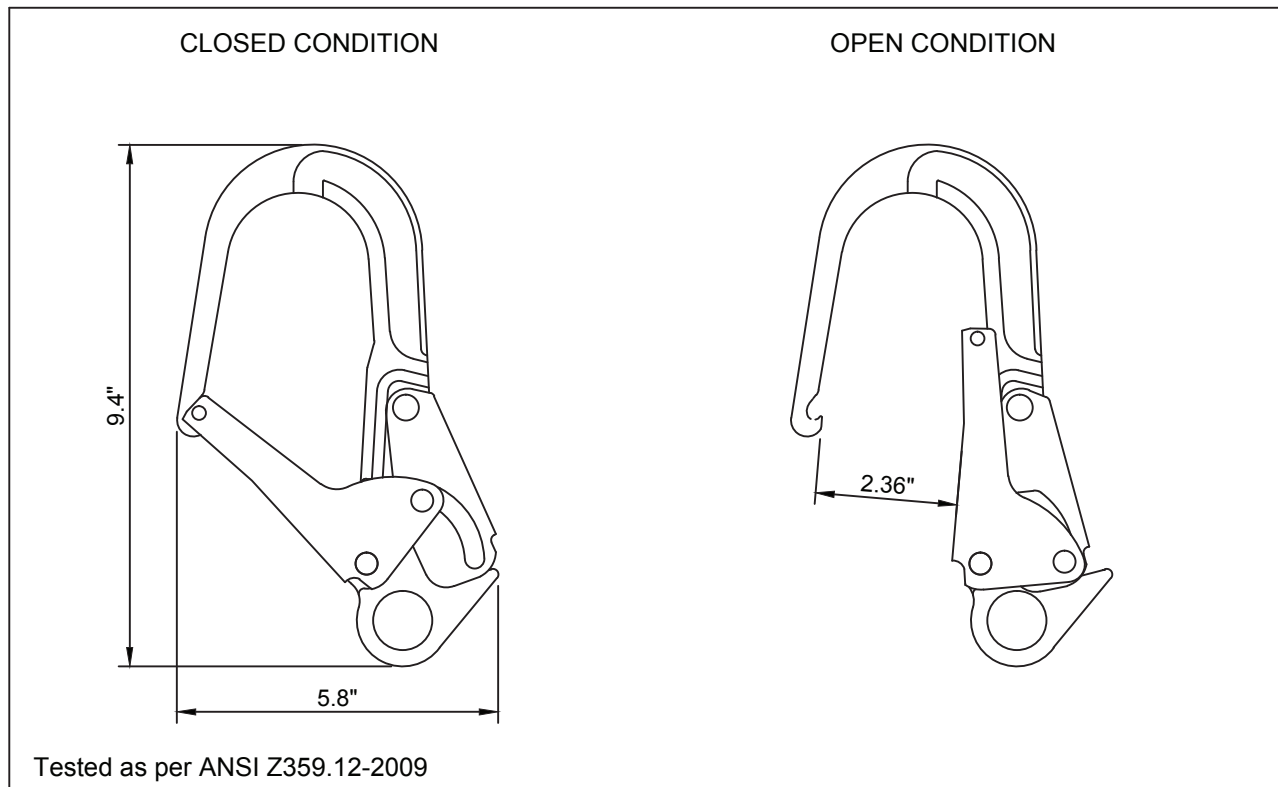

- Gate opening 2.36".
- DESIGN:**
- Auto closing and auto locking type steel scaffold hook.
 - Locking by spring operated attachments.

PROCESS: Forged

MATERIAL: Alloy Steel

FINISH: Galvanized with golden yellow/silver passivation

MINIMUM BREAKING STRENGTH: 5000 lbs.

GATE FACE STRENGTH: 3600 lbs.

GATE SIDE STRENGTH: 3600 lbs.

WEIGHT: 1.8 lbs. ± 0.02 lbs.

PN: CS817

TECHNICAL SPECIFICATIONS

Confined Space Winch

Confined Space Winch, galvanized cable, $\frac{3}{4}$ " hook. Max load 310 lbs. Personal or material. Meets ANSI Z359.1-1992, ANSI Z117.1-1995.

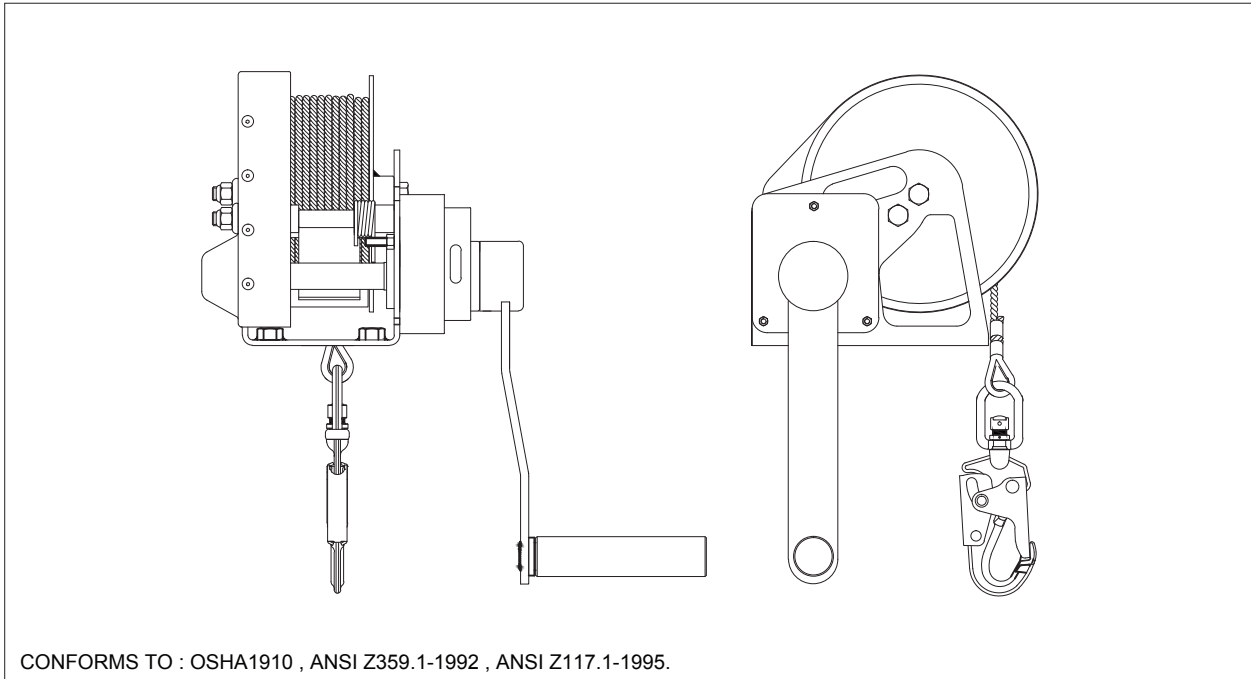

- Material or man lifting rescue winch.
 - Mounting plate having four bolts for mounting to Davit Arm DA 01, DA 02, DA 03, DA 04, SA 17 & PN 800/PN 800A with use of specialized brackets.
- DESIGN:**
- Galvanized steel wire rope of $\frac{3}{16}$ " & length of 60' maximum.
 - Equipped with Swivel Steel Snap Hook (PN 144 as per ANSI Z359.12-2009 gate strength 3600 lbs.) as connector.
 - Handle rotating mechanism for lifting or lowering.

BODY: Material: Galvanized steel

RATED LOAD CAPACITY: 300 lbs.

VITAL TEST COMPLIANCE: Static Strength: Tested at 3100 lbs.

WEIGHT: 20.61 lbs. \pm 0.02 lbs.

TECHNICAL SPECIFICATIONS

Confined Space Tripod

Confined Space Tripod - 7 ft. Max load 1100 lbs. Adjustable height 4.3 ft. - 7 ft. Meets ANSI Z359.1-2007, ANSI Z359.4-2013.

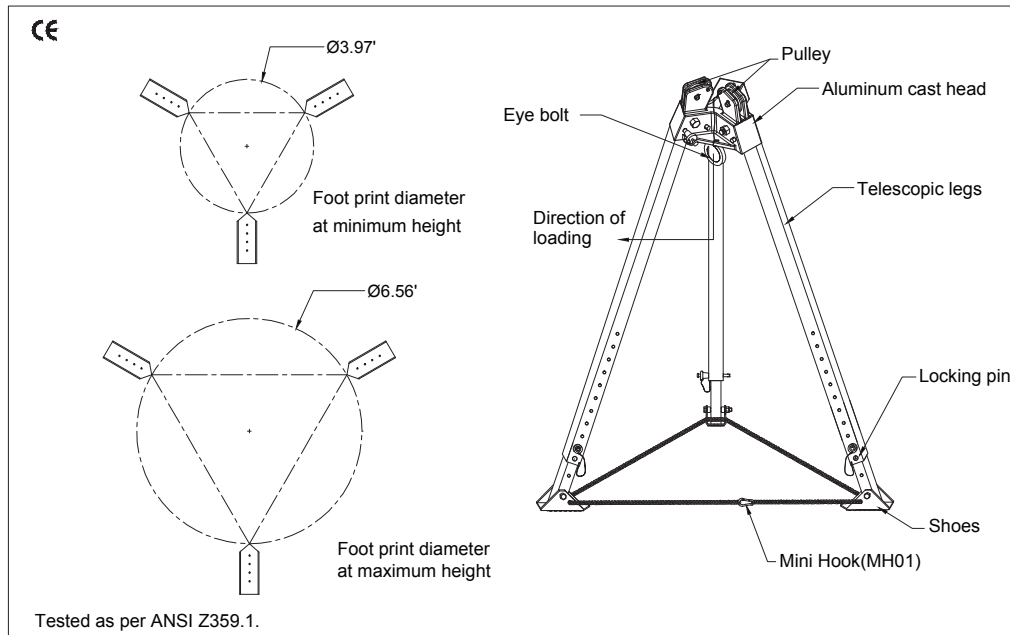

- Adjustable height from 4'4" (1.32 m) to 7' (2.13 m) from ground level.
- At minimum height, distance between legs (foot point): 3'2" (0.96 m) & foot print diameter of 3.97' (1.21 m).
- At maximum height, distance between legs (foot point): 5'8" (1.72 m) & foot print diameter of 6.56' (6.56 ft.).

- DESIGN:**
- Adjustment achieved by sliding telescopic legs (inner & outer).
 - Locking pins attached by SS cables.
 - Securely connected two eye bolts to be used for connection to personal protective equipment.
 - Two pulley system provided to pass the wire rope of winch mounted on one leg and retrieval block on the other leg simultaneously.

LOAD CAPACITY: 310 lbs. (As per ANSI Z359.1)

TRIPOD LEGS: Material: Prime quality aluminum alloy | Finish: Anodized

HEAD: Material: Prime quality aluminum alloy | Finish: Powder coated

LOCKING PINS: Material: Prime quality aluminum alloy eye bolt & stainless steel locking pin
 Finish: Deburred & polished

VITAL TEST COMPLIANCE: Static Strength: 25 kN (5000 lbs.) for 1 minute

WEIGHT: 41.9 lbs. (19.01 kg)

TECHNICAL SPECIFICATIONS

SRL 6' Light Weight Web with Small Hook

6' retractable web, light weight plastic housing, external shock-pack, 3/4" hook, 1/2" carabiner included. Min breaking strength 3000 lbs. Meets ANSI Z359.14-2014 Class A.

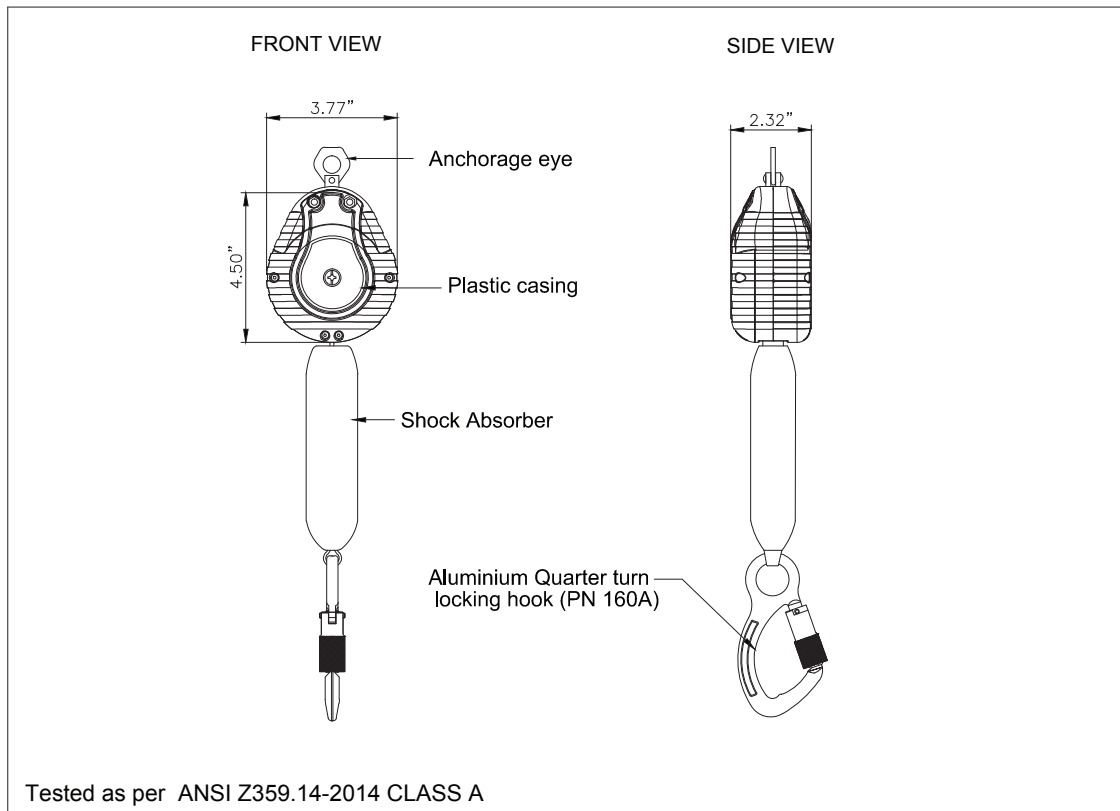

- PHYSICAL PARAMETERS:**
- Lightest available SRL in its range/class.
 - Robust & durable plastic casting.
 - Technora Webbing with Energy absorber.
 - Aluminum quarter turn locking hook at attachment end (PN 160A as per ANSI Z359.12-2009 gate strength 3600 lbs.)

LENGTH: 6 ft. (Maximum)

WEBBING: Material: Technora webbing 13/16"
 Minimum Breaking Strength: 4500 lbs.

VITAL TEST COMPLIANCE:

Static Strength: 3000 lbs. for 1 minute.
 Dynamic Strength: 300 lbs. mass subjected to a 4' free fall. SRL lock and remain lock until released.
 Dynamic Performance: 282 lbs. mass subjected to a zero free fall with extension of 36" webbing. Breaking force less than 1800 lbs. and arrest distance less than 24".

WEIGHT: 1.84 lbs. ± 0.02 lbs.

TECHNICAL SPECIFICATIONS

SRL 6' Light Weight Web with Aluminum Rebar Hook

6' retractable web, light weight plastic housing, external shock-pack, 2¼" aluminum hook, ½" carabiner included. Min breaking strength 3000 lbs. Meets ANSI Z359.14-2014 Class A.

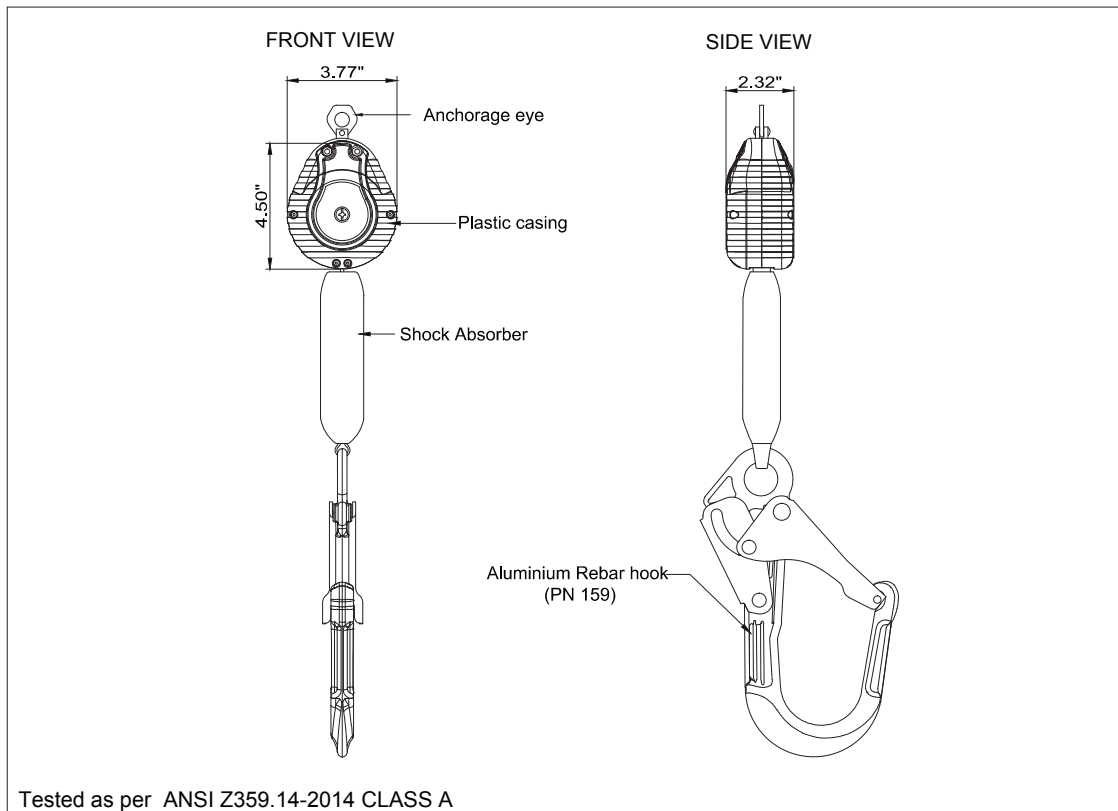

- PHYSICAL PARAMETERS:**
- Lightest available SRL in its range/class.
 - Robust & durable plastic casting.
 - Technora Webbing with Energy absorber.
 - Aluminum rebar hook at attachment end (PN 159 as per ANSI Z359.12-2009 gate strength 3600 lbs.)

LENGTH: 6 ft. (Maximum)

WEBBING: Material: Technora webbing 13/16"
 Minimum Breaking Strength: 4500 lbs.

VITAL TEST COMPLIANCE:

Static Strength: 3000 lbs. for 1 minute.
 Dynamic Strength: 300 lbs. mass subjected to a 4' free fall. SRL lock and remain lock until released.
 Dynamic Performance: 282 lbs. mass subjected to a zero free fall with extension of 36" webbing. Breaking force less than 1800 lbs. and arrest distance less than 24".

WEIGHT: 2.68 lbs. ± 0.02 lbs.

TECHNICAL SPECIFICATIONS

SRL 6' Light Weight Web with Rebar Hook

6' retractable web, light weight plastic housing, external shock-pack, 2¼" hook, ½" carabiner included. Min breaking strength 3000 lbs. Meets ANSI Z359.14-2014 Class A.

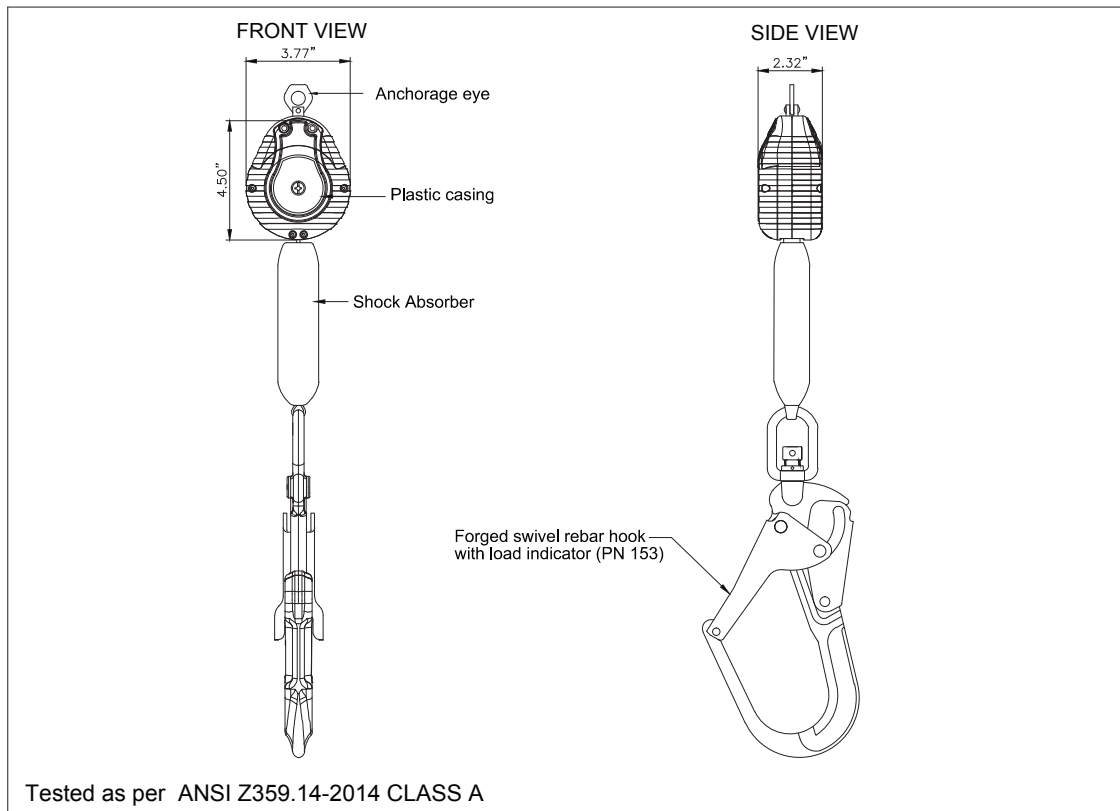

- PHYSICAL PARAMETERS:**
- Lightest available SRL in its range/class.
 - Robust & durable plastic casting.
 - Technora Webbing with Energy absorber.
 - Swivel steel rebar hook at attachment end (PN 153 as per ANSI Z359.12-2009 gate strength 3600 lbs.)

LENGTH: 6 ft. (Maximum)

WEBBING: Material: Technora webbing 13/16"
 Minimum Breaking Strength: 4500 lbs.

VITAL TEST COMPLIANCE:

Static Strength: 3000 lbs. for 1 minute.
 Dynamic Strength: 300 lbs. mass subjected to a 4' free fall. SRL lock and remain lock until released.
 Dynamic Performance: 282 lbs. mass subjected to a zero free fall with extension of 36" webbing. Breaking force less than 1800 lbs. and arrest distance less than 24".

WEIGHT: 3.37 lbs. ± 0.02 lbs.

TECHNICAL SPECIFICATIONS

SRL 11' Web with Small Hook

11' retractable web, swivel top plastic housing, 3/4" load indicator hook, 1/2" carabiner included. Blue housing. Min breaking strength 4500 lbs. Meets ANSI Z359.14-2012 Class B.

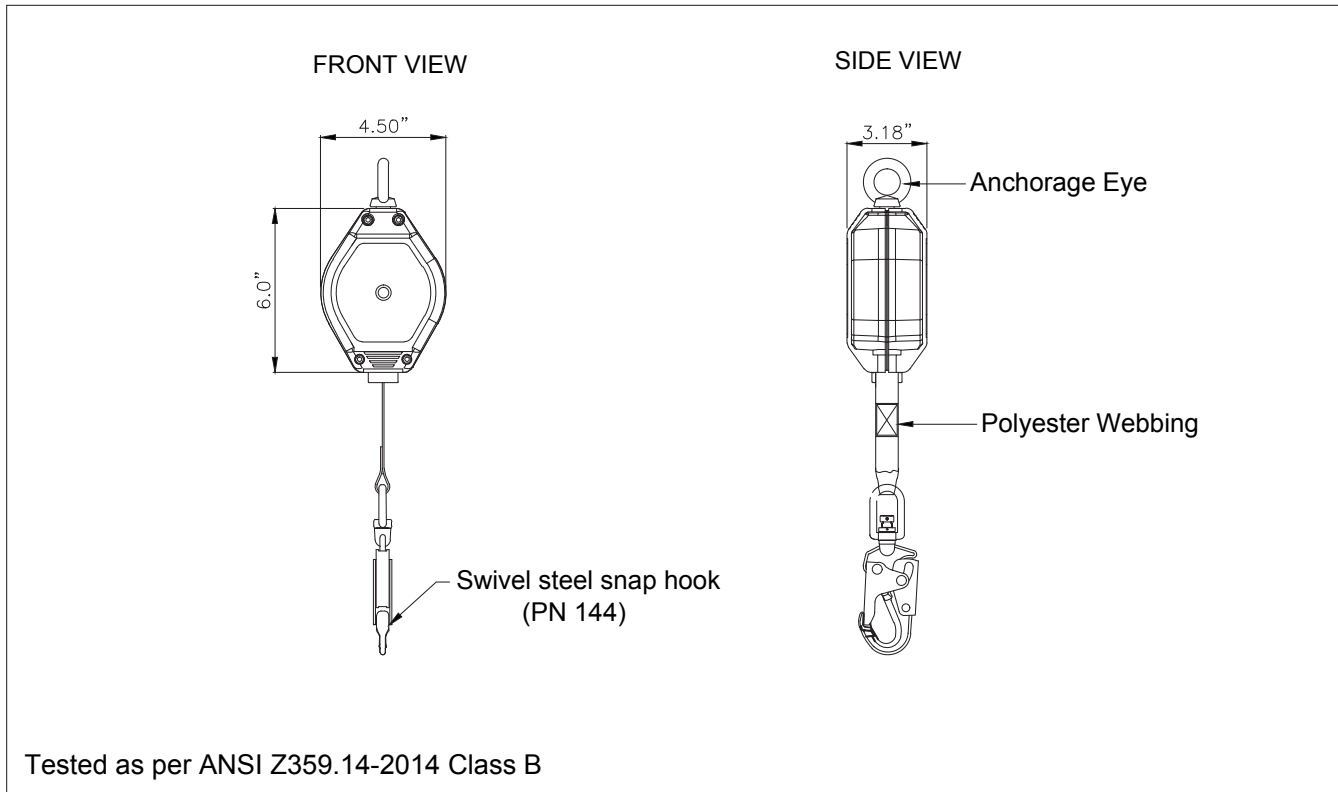

- PHYSICAL PARAMETERS:**
- Robust & durable plastic casing.
 - Has swivel anchorage eye at anchorage end.
 - Swivel steel snap hook with load indicator at attachment end (PN 144).
 - Polyester Webbing

LENGTH: 11 ft.

WEBBING: Material: Polyester
 Width: 1"
 Minimum Breaking Strength: 4500 lbs.

VITAL TEST COMPLIANCE: Static Strength: 3000 lbs. for 1 minute.
 Dynamic Strength: 300 lbs. mass subjected to a 4' free fall. SRL lock and remain lock until released.
 Dynamic Performance: 282 lbs. mass subjected to a zero free fall with extension of 36" lifeline. Braking force less than 1800 lbs. Average braking force less than 900 lbs. and arrest distance less than 54".

WEIGHT: 3.52 lbs. ± 0.11 lbs.

TECHNICAL SPECIFICATIONS

SRL 11' Web with Rebar Hook

11' retractable web, swivel top plastic housing, built-in shock-pack, 2¼" load indicator hook, ½" carabiner included. Blue housing. Min breaking strength 4500 lbs. Meets ANSI Z359.14-2012 Class B.

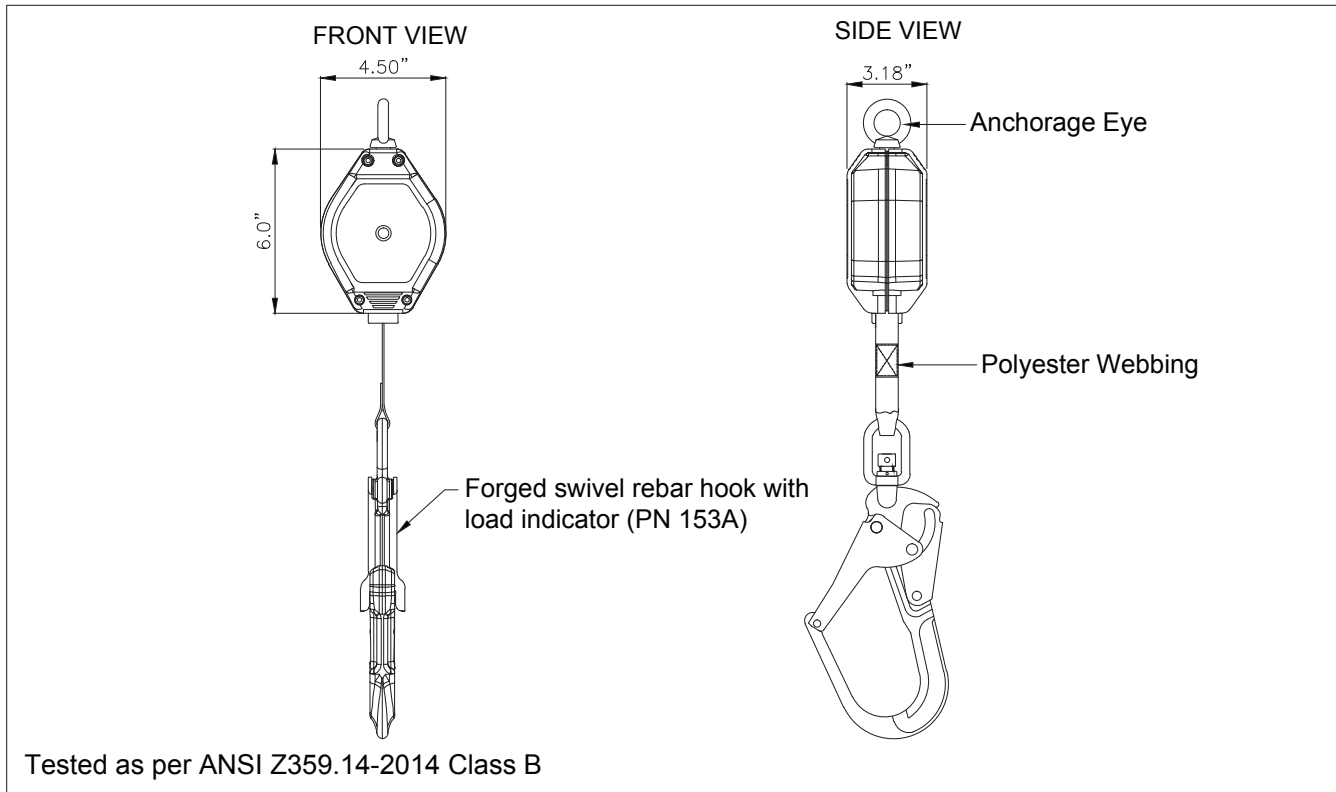

- PHYSICAL PARAMETERS:**
- Robust & durable plastic casing.
 - Has swivel anchorage eye at anchorage end.
 - Forged swivel rebar hook with load indicator at attachment end (PN 153A).
 - Polyester Webbing

LENGTH: 11 ft.

WEBBING: Material: Polyester
 Width: 1"
 Minimum Breaking Strength: 4500 lbs.

VITAL TEST COMPLIANCE: Static Strength: 3000 lbs. for 1 minute.
 Dynamic Strength: 300 lbs. mass subjected to a 4' free fall. SRL lock and remain lock until released.
 Dynamic Performance: 282 lbs. mass subjected to a zero free fall with extension of 36" lifeline. Braking force less than 1800 lbs. Average braking force less than 900 lbs. and arrest distance less than 54".

WEIGHT: 4.35 lbs. ± 0.11 lbs.

TECHNICAL SPECIFICATIONS

SRL Web with Small Hook. Various Sizes.

15' or 20' retractable web, swivel top plastic housing, built in shock absorber, 3/4" load indicator hook, 1/2" carabiner included. Blue housing. Min breaking strength 4500lbs. Meets ANSI Z359.14-2012 Class B.

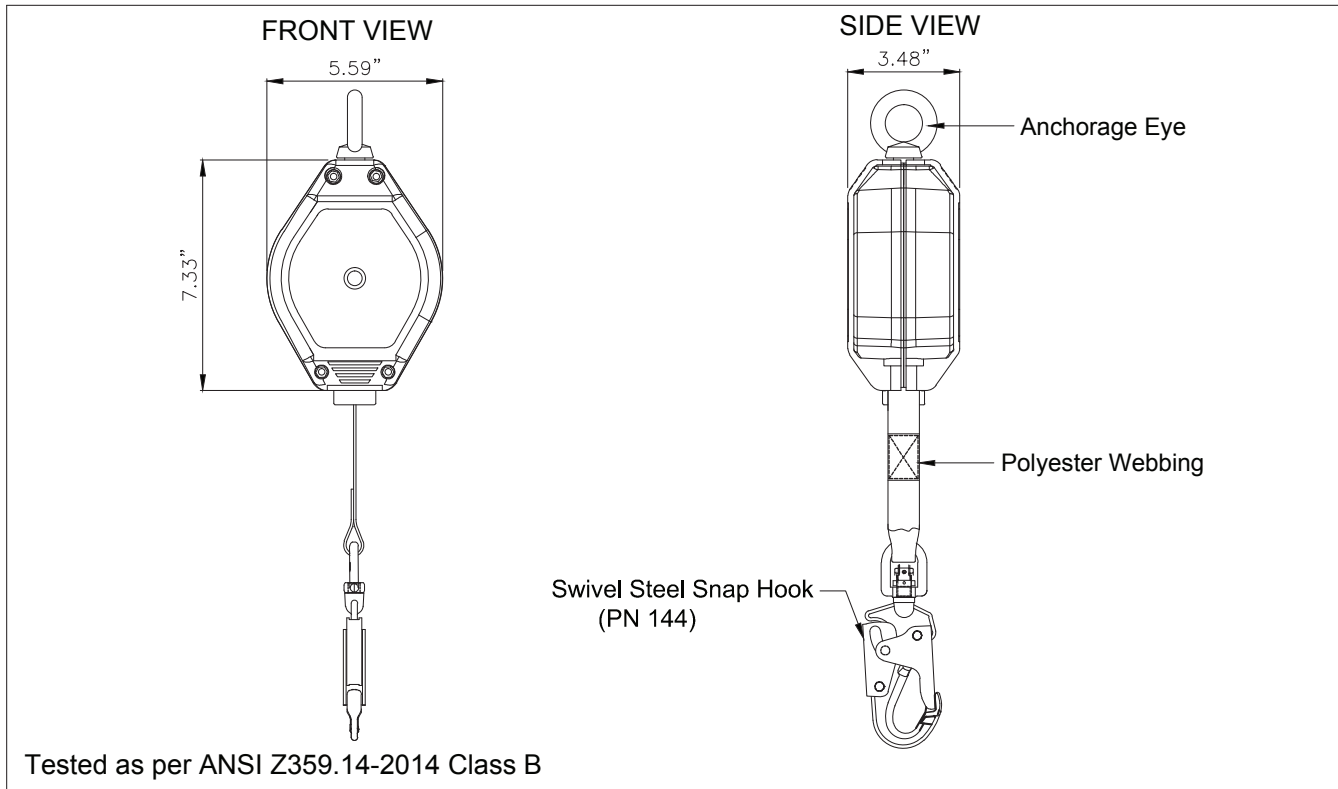

- PHYSICAL PARAMETERS:**
- Robust & durable plastic casing.
 - Has swivel anchorage eye at anchorage end.
 - Swivel steel snap hook with load indicator at attachment end (PN 144 as per ANSI Z359.12-2009; gate strength 3600 lbs.).
 - Polyester Webbing

LENGTH: SRL521311: 15' | SRL621311: 20'

WEBBING: Material: Polyester
 Width: 1"
 Minimum Breaking Strength: 4500 lbs.

Part #	Length
SRL521311	15'
SRL621311	20'

VITAL TEST COMPLIANCE:

Static Strength: 3000 lbs. for 1 minute.
 Dynamic Strength: 300 lbs. mass subjected to a 4' free fall. SRL lock and remain lock until released.
 Dynamic Performance: 282 lbs. mass subjected to a zero free fall with extension of 36" lifeline. Braking force less than 1800 lbs. Average braking force less than 900 lbs. and arrest distance less than 54".

WEIGHT: SRL521311: 5.12 lbs. ± 0.02 lbs. | SRL621311: 5.42 lbs. ± 0.02 lbs.

TECHNICAL SPECIFICATIONS

SRL 10' Galvanized Cable with Small Hook.

10' retractable galvanized cable, swivel top plastic housing, 3/4" load indicator hook, 1/2" carabiner and 10' tagline included. Blue housing. Min breaking strength 3000 lbs. Meets ANSI Z359.14-2014 Class B.

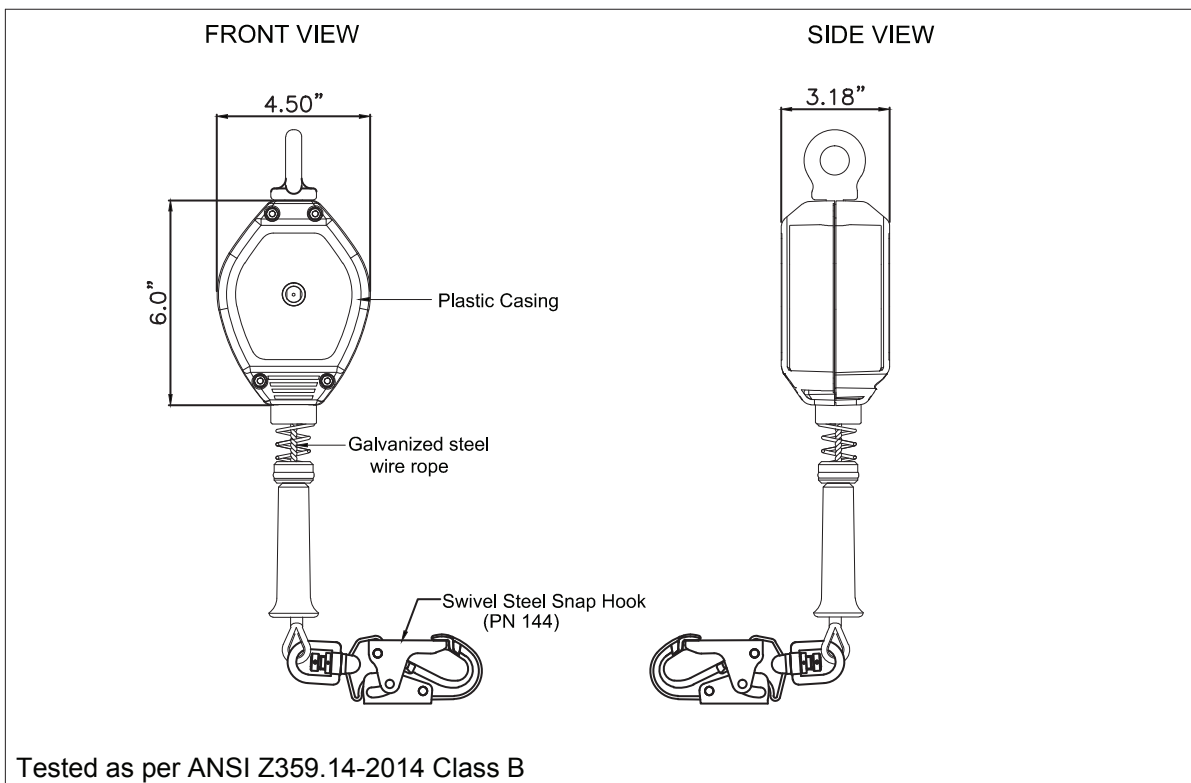

- PHYSICAL PARAMETERS:**
- Robust & durable plastic casing.
 - Has swivel eye at anchorage end.
 - Swivel steel snap hook with load indicator at attachment end (PN 144 as per ANSI Z359.12-2009; gate strength 3600 lbs.).
 - Galvanized steel wire rope (option of having S.S. wire rope available).

LENGTH: 10'

CABLE: Material: Galvanized steel wire rope diameter of 3/16"
 Minimum Breaking Strength: 3300 lbs.

VITAL TEST COMPLIANCE:

Static Strength: 3000 lbs. for 1 minute.
 Dynamic Strength: 300 lbs. mass subjected to a 4' free fall. SRL lock and remain lock until released.
 Dynamic Performance: 282 lbs. mass subjected to a zero free fall with extension of 36" lifeline. Braking force less than 1800 lbs. Average braking force less than 900 lbs. and arrest distance less than 54".

WEIGHT: 5.25 lbs. ± 0.11 lbs.

TECHNICAL SPECIFICATIONS

SRL Galvanized Cable with Small Hook. Various Sizes.

15' or 20' retractable galvanized cable, swivel top plastic housing, 3/4" load indicator hook, 1/2" carabiner and 15' or 20' tagline included. Blue housing. Min breaking strength 3000 lbs. Meets ANSI Z359.14-2014 Class B.

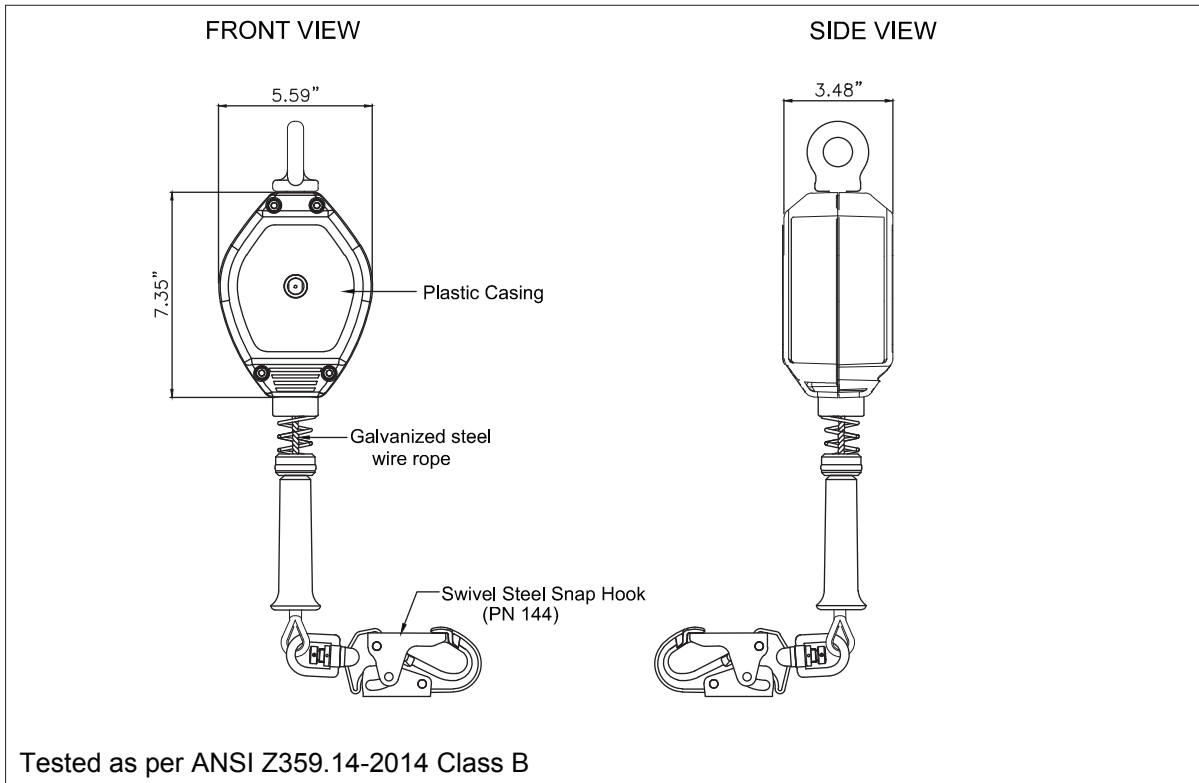

- PHYSICAL PARAMETERS:**
- Robust & durable plastic casing.
 - Has swivel eye at anchorage end.
 - Swivel steel snap hook with load indicator at attachment end (PN 144 as per ANSI Z359.12-2009; gate strength 3600 lbs.).
 - Galvanized steel wire rope (option of having S.S. wire rope available).

LENGTH: SRL511311: 15' | SRL611311: 20'

CABLE: Material: Galvanized steel wire rope diameter of 3/16"
 Minimum Breaking Strength: 3300 lbs.

Part #	Length
SRL511311	15'
SRL611311	20'

VITAL TEST COMPLIANCE:

Static Strength: 3000 lbs. for 1 minute.
 Dynamic Strength: 300 lbs. mass subjected to a 4' free fall. SRL lock and remain lock until released.
 Dynamic Performance: 282 lbs. mass subjected to a zero free fall with extension of 36" lifeline. Braking force less than 1800 lbs. Average braking force less than 900 lbs. and arrest distance less than 54".

WEIGHT: SRL511311: 8.24 lbs. ± 0.11 lbs. | SRL611311: 8.54 lbs. ± 0.11 lbs.

TECHNICAL SPECIFICATIONS

SRL 30' Galvanized Cable with Small Hook.

30' retractable galvanized cable, swivel top composite housing, 3/4" load indicator hook, 1/2" carabiner and 30' tagline included. Blue housing. Min breaking strength 3000 lbs. Meets ANSI Z359.14-2014 Class B.

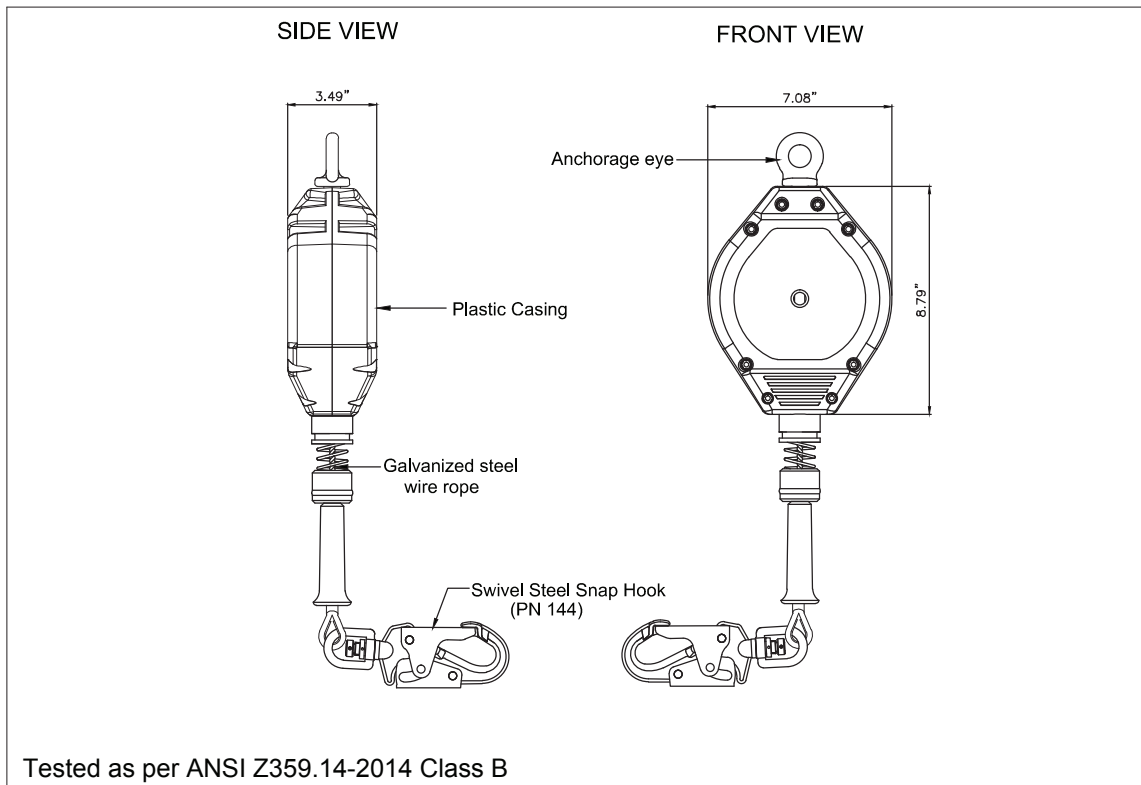

- PHYSICAL PARAMETERS:**
- Robust & durable plastic casing.
 - Has swivel anchorage eye at anchorage end.
 - Swivel steel snap hook with load indicator at attachment end (PN 144 as per ANSI Z359.12-2009; gate strength 3600 lbs.).
 - Galvanized steel wire rope (option of having S.S. wire rope available).

LENGTH: 30'

CABLE: Material: Galvanized steel wire rope diameter of 3/16"
 Minimum Breaking Strength: 3300 lbs.

VITAL TEST COMPLIANCE:

Static Strength: 3000 lbs. for 1 minute.
 Dynamic Strength: 300 lbs. mass subjected to a 4' free fall. SRL lock and remain lock until released.
 Dynamic Performance: 282 lbs. mass subjected to a zero free fall with extension of 36" lifeline. Braking force less than 1800 lbs. Average braking force less than 900 lbs. and arrest distance less than 54".

WEIGHT: 10.80 lbs. ± 0.11 lbs.

TECHNICAL SPECIFICATIONS

SRL 50' Galvanized Cable with Small Hook.

50' retractable galvanized cable, swivel top composite housing, 3/4" load indicator hook, 1/2" carabiner and 50' tagline included. Blue housing. Min breaking strength 3000 lbs. Meets ANSI Z359.14-2014 Class B.

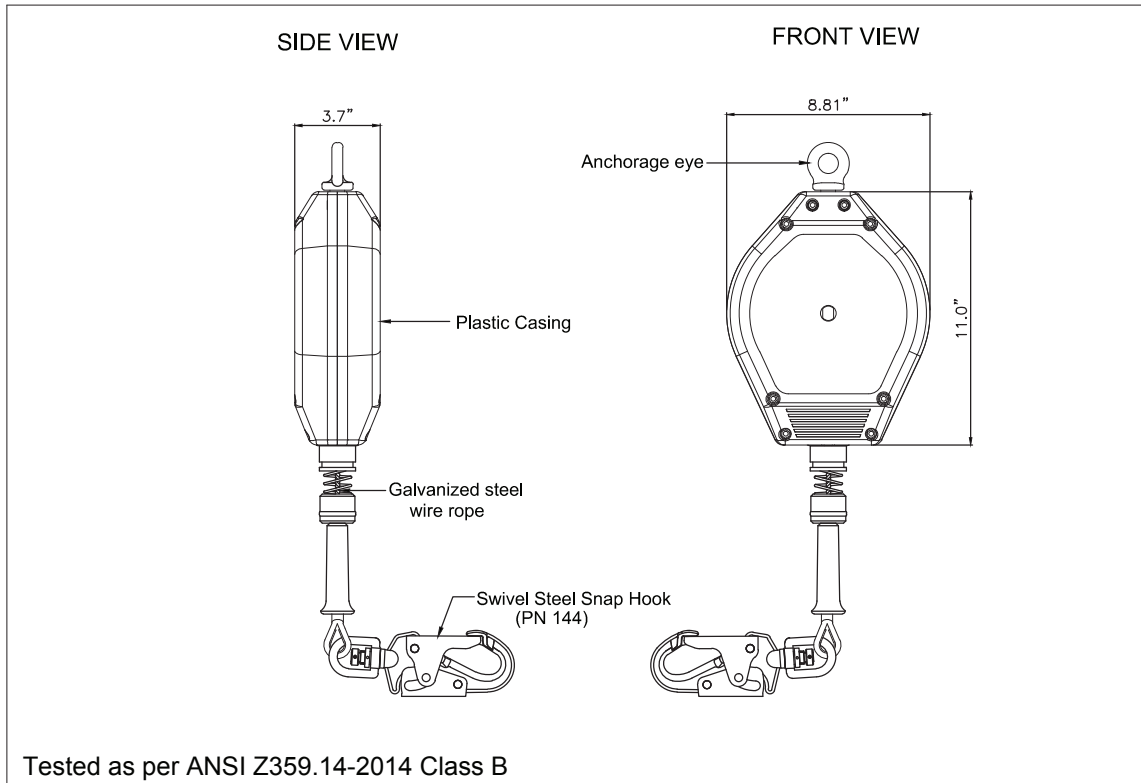

- PHYSICAL PARAMETERS:**
- Robust & durable plastic casing.
 - Has swivel eye at anchorage end.
 - Swivel steel snap hook with load indicator at attachment end (PN 144 as per ANSI Z359.12-2009; gate strength 3600 lbs.).
 - Galvanized steel wire rope (option of having S.S. wire rope available).

LENGTH: 50'

CABLE: Material: Galvanized steel wire rope diameter of 3/16"
 Minimum Breaking Strength: 3300 lbs.

VITAL TEST COMPLIANCE:

Static Strength: 3000 lbs. for 1 minute.
 Dynamic Strength: 300 lbs. mass subjected to a 4' free fall. SRL lock and remain lock until released.
 Dynamic Performance: 282 lbs. mass subjected to a zero free fall with extension of 36" lifeline. Braking force less than 1800 lbs. Average braking force less than 900 lbs. and arrest distance less than 54".

WEIGHT: 15.30 lbs. ± 0.11 lbs.

TECHNICAL SPECIFICATIONS

SRL LE 18' Galvanized Cable with Small Hook.

18' leading edge retractable galvanized cable, swivel top composite housing, ¾" load indicator hook, ½" carabiner. Black housing. Min breaking strength 3000 lbs. Meets ANSI Z359.14-2014 and ANSI Z359.14-2014 SRL-LE.

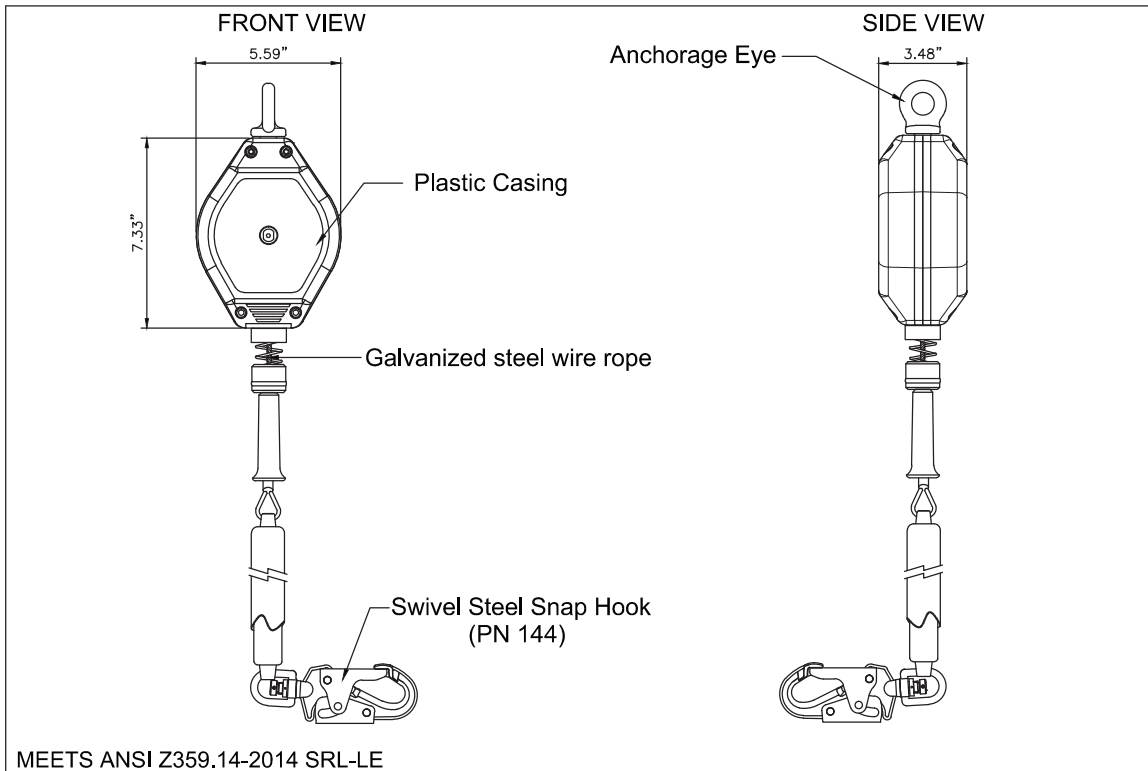

- PHYSICAL PARAMETERS:**
- Robust & durable plastic casing.
 - Has swivel eye at anchorage end.
 - Swivel steel snap hook with load indicator at attachment end (PN 144 as per ANSI Z359.12-2009; gate strength 3600 lbs.).
 - Galvanized steel wire rope (option of having S.S. wire rope available).
 - Designed to be used where user needs to work near a potential leading edge.

LENGTH: 18'

CABLE: Material: Galvanized steel wire rope diameter of 7/32"
 Minimum Breaking Strength: 3800 lbs.

VITAL TEST COMPLIANCE: Static Strength: 3000 lbs. for 1 minute.
 Dynamic Strength: 300 lbs. mass subjected in a leading edge having a radius of max 0.005" to a 5' free fall. SRL lock and remain lock until released.
 Dynamic Performance: 282 lbs. mass subjected to a 5' free fall on leading edge having max radius of 0.005". Braking force less than 1800 lbs. Average braking force less than 1575 lbs.

NORM: Meets ANSI Z359.14-2014 SRL-LE

WEIGHT: 9.07 lbs. ± 0.11 lbs.

TECHNICAL SPECIFICATIONS

SRL LE 25' Galvanized Cable with Small Hook.

25' leading edge retractable galvanized cable, swivel top composite housing, 3/4" load indicator hook, 1/2" carabiner. Black housing. Min breaking strength 3000 lbs. Meets ANSI Z359.14-2014 and ANSI Z359.14-2014 SRL-LE.

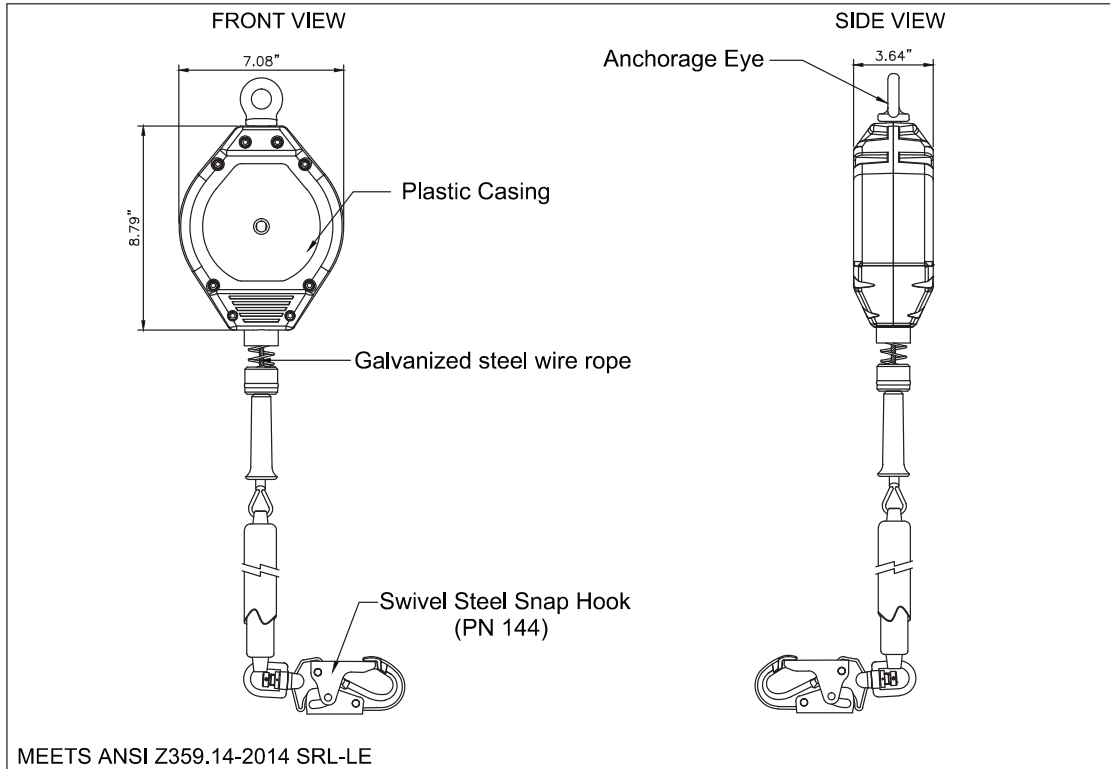

- PHYSICAL PARAMETERS:**
- Robust & durable plastic casing.
 - Has swivel eye at anchorage end.
 - Swivel steel snap hook with load indicator at attachment end (PN 144 as per ANSI Z359.12-2009; gate strength 3600 lbs.).
 - Galvanized steel wire rope (option of having S.S. wire rope available).
 - Designed to be used where user needs to work near a potential leading edge.

LENGTH: 25'

CABLE: Material: Galvanized steel wire rope diameter of 7/32"
 Minimum Breaking Strength: 3800 lbs.

VITAL TEST COMPLIANCE: Static Strength: 3000 lbs. for 1 minute.
 Dynamic Strength: 300 lbs. mass subjected in a leading edge having a radius of max 0.005" to a 5' free fall. SRL lock and remain lock until released.
 Dynamic Performance: 282 lbs. mass subjected to a 5' free fall on leading edge having max radius of 0.005". Braking force less than 1800 lbs. Average braking force less than 1575 lbs.

NORM: Meets ANSI Z359.14-2014 SRL-LE

WEIGHT: 10.481 lbs. ± 0.121 lbs.

TECHNICAL SPECIFICATIONS

SRL LE 50' Galvanized Cable with Small Hook.

50' leading edge retractable galvanized cable, swivel top composite housing, $\frac{3}{4}$ " load indicator hook, $\frac{1}{2}$ " carabiner. Black housing. Min breaking strength 3000 lbs. Meets ANSI Z359.14-2014 and ANSI Z359.14-2014 SRL-LE.

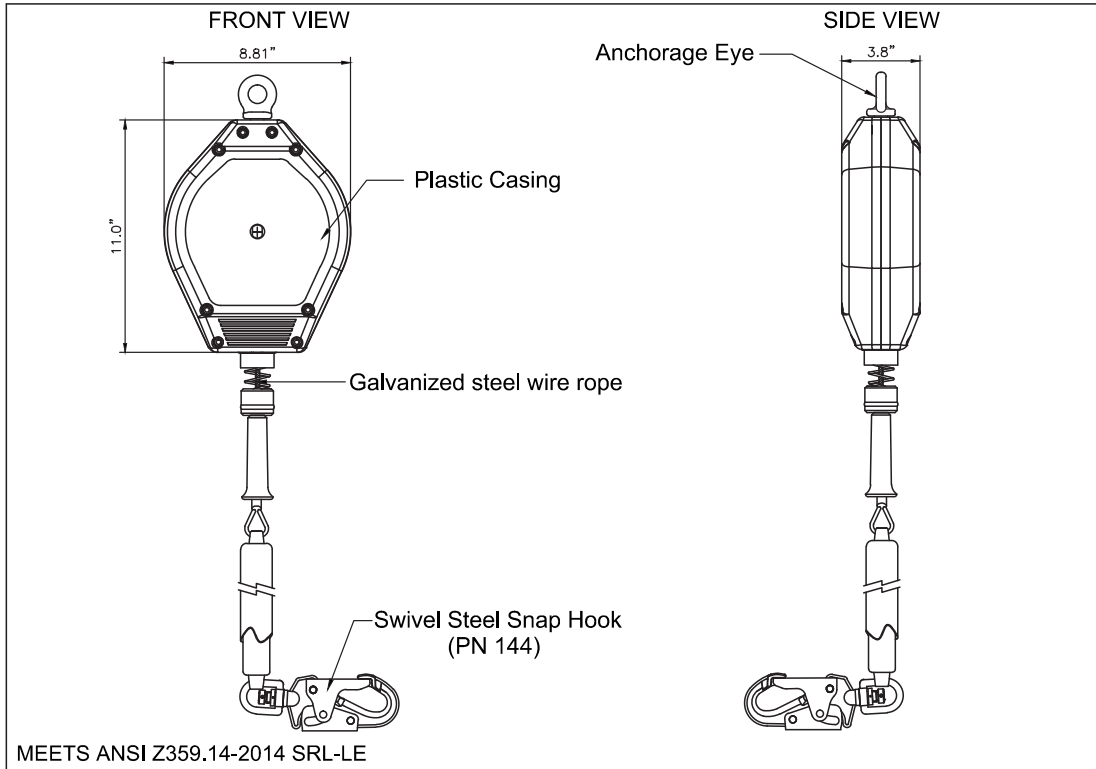

- PHYSICAL PARAMETERS:**
- Robust & durable plastic casing.
 - Has swivel eye at anchorage end.
 - Swivel steel snap hook with load indicator at attachment end (PN 144 as per ANSI Z359.12-2009; gate strength 3600 lbs.).
 - Galvanized steel wire rope (option of having S.S. wire rope available).
 - Designed to be used where user needs to work near a potential leading edge.

LENGTH: 50'

CABLE: Material: Galvanized steel wire rope diameter of $\frac{7}{32}$ "
 Minimum Breaking Strength: 3800 lbs.

VITAL TEST COMPLIANCE: Static Strength: 3000 lbs. for 1 minute.
 Dynamic Strength: 300 lbs. mass subjected in a leading edge having a radius of max 0.005" to a 5' free fall. SRL lock and remain lock until released.
 Dynamic Performance: 282 lbs. mass subjected to a 5' free fall on leading edge having max radius of 0.005". Braking force less than 1800 lbs. Average braking force less than 1575 lbs.

NORM: Meets ANSI Z359.14-2014 SRL-LE

WEIGHT: 19.53 lbs. \pm 0.22 lbs.

TECHNICAL SPECIFICATIONS

SRLD 60 ft. Galvanized Cable, Small hook

Self-Retractable Lifeline Retrieval System with rescue for tripod. Galvanized cable, 3/4" load indicator hook, 1/2" carabiner. Blue housing. Min breaking strength 3000lbs. Meets ANSI Z359.14-2014 Class B, ANSI Z359.14-2014 SRL-R.

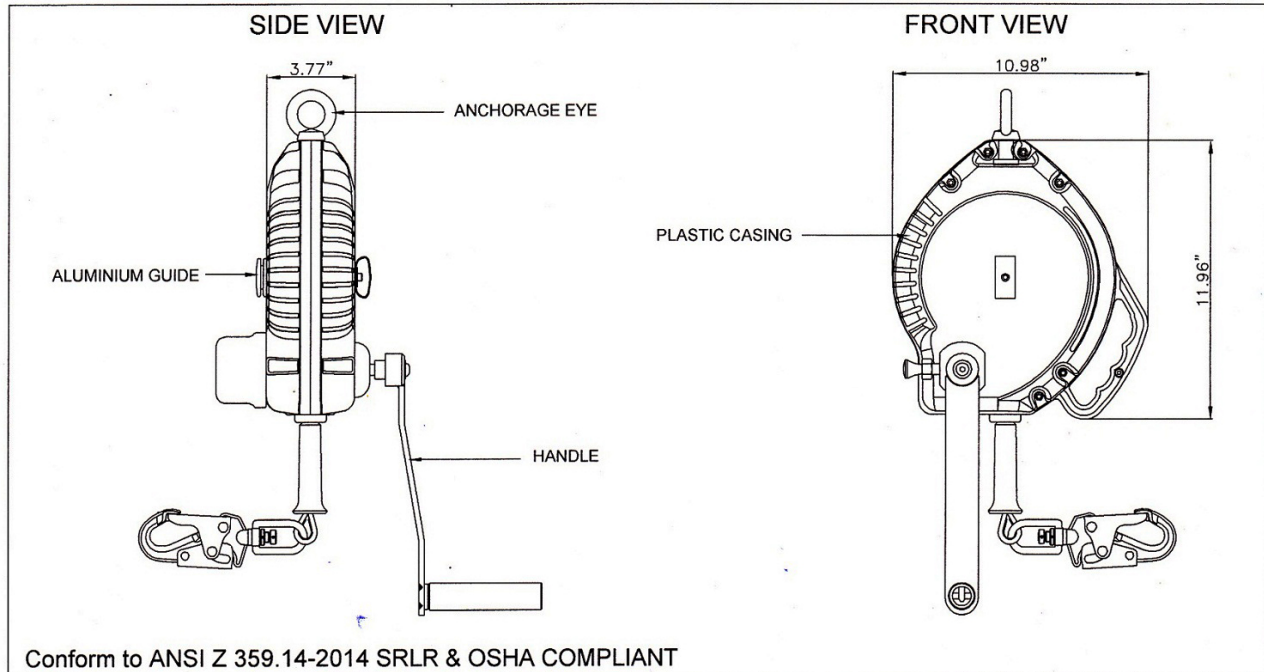

- DESIGN:**
- Retrieval fall arrester block in polymer casing coupled with hoisting winch to enable easy retrieval of victim.
 - The locking pin on the side of the casing at the base of the handle allows this dual system to work in independent fall arrest & winch modes.
 - Can be easily mounted on the leg of Palmer Safety System with specialized brackets: SA 17(20) for Mega Pods, PN 800A(R)(10) for Tripods, PN 900(07) for K Pods, and DA 04(12) for Davit Arm

- PHYSICAL PARAMETERS:**
- Robust & durable plastic casting.
 - Has swivel anchorage eye at anchorage end.
 - Swivel steel snap hook with load indicator (PN 144) at attachment end.
 - Galvanized steel wire rope (option of having S.S. wire rope available)

LENGTH: 60 ft.

CABLE: Galvanized steel wire rope 3/16" diameter

MINIMUM BREAKING STRENGTH: 3400 lbs.

NORM: Meets ANSI Z359.14-2014 SRLR & OSHA Compliant

WEIGHT: 20.3 lbs. ± 0.02 lbs.

PN: B0004

TECHNICAL SPECIFICATIONS

Empty Kit Bag

Woven bag made up of Polyester having dimension 15.75" x 11.81" with black cord.

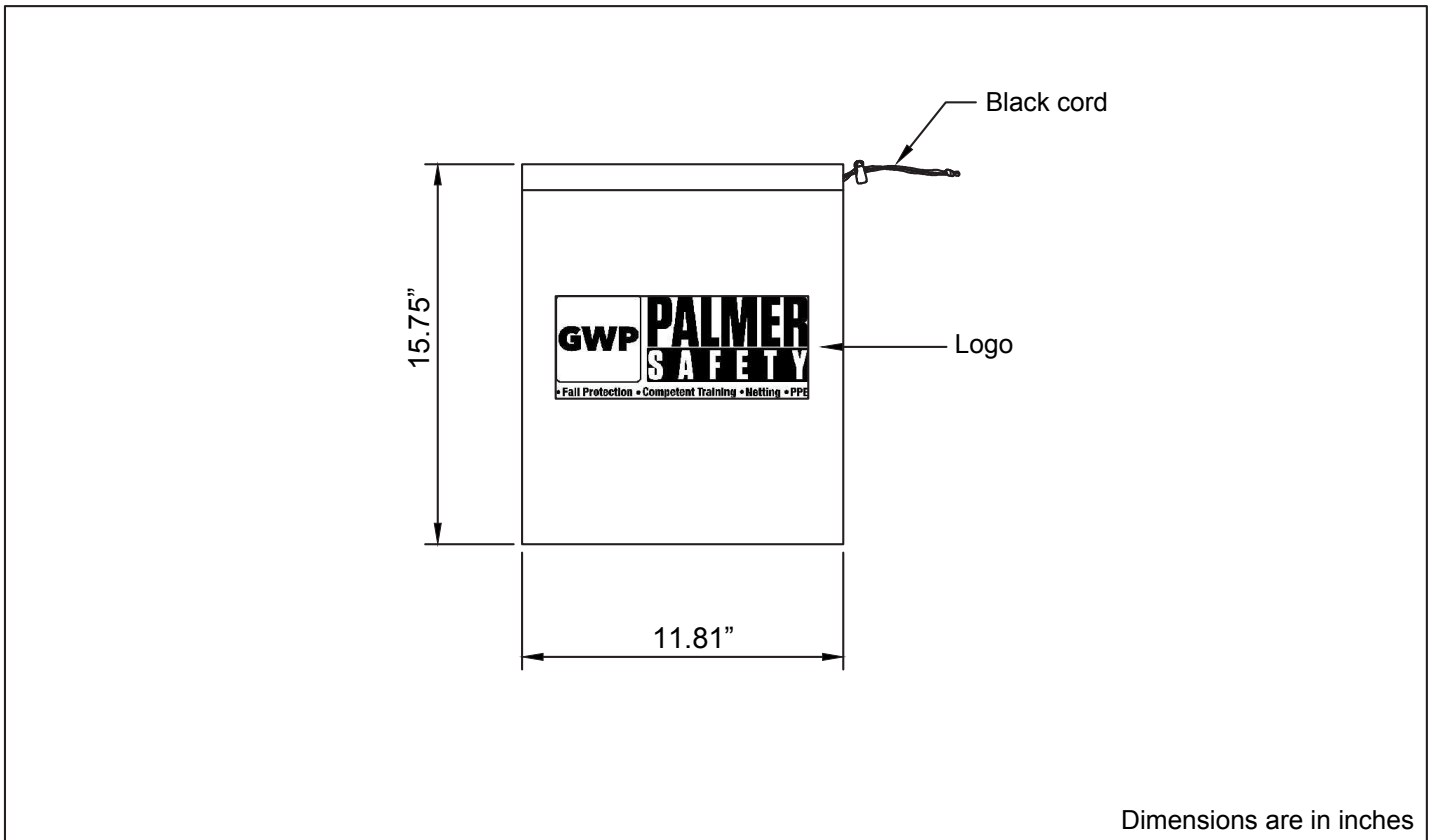

DESIGN: Woven bag made up of Polyester having dimension 15.75" x 11.81" with black cord.

COLOR: Blue

MATERIAL: Polyester

WEIGHT: 0.05 lbs. ± 0.004 lbs.

WEIGHT CAPACITY: 11 lbs.