

Samsung SmartThings Getting Started

INS-C006

Smart Shades Now Compatible with SmartThings

NOTE: Only on the condition that all the blinds has been set up with upper and lower limits and can be controlled by remote, the following operations with the smart speakers can be moved on !!!

BEFORE YOU GET STARTED

1. Make sure your Samsung SmartThings account is set up and working.
2. Download the latest version of the Samsung SmartThings app.
3. Set up your Samsung SmartThings hub (2nd or 3rd generation hub – 1st generation hubs are not compatible).

NAMING YOUR WINDOW TREATMENTS

To get the most convenient control of your window treatments with Samsung SmartThings, consider how you plan to interact with them. If you plan to operate each window treatment individually, imagine what the most logical names might be while labeling the window treatments. For example, a name like *Bedroom* may be easier to remember than Shade 4. Please try to avoid using the word “Blind” or “Shade” in the name as it may conflict with some of the below commands. Instead, try to use specific words like *Roller*, *Roman*, *Sheer* and *Blackout* when naming your shades within the app. Consider names like *Kitchen Solar* instead of *Kitchen Shade*.

CONTROLLING YOUR WINDOW TREATMENTS

Samsung SmartThings allows you to control individual window treatments and groups of window treatments through two different methods. Individual shades can be controlled by adjusting the slider to the desired percentage of openness. Groups of shades are best controlled through scenes.

1. PERCENTAGE CONTROL

An individual window treatment or group of window treatments can be set to a percentage of openness. The percentage will be based on what the programmed limits are within the motor. For example, a shade that is completely raised to its upper limit is at 100% while a shade that is completely lowered to its lower limit is at 0%.

2. SCENE CONTROL

If you plan to use scenes in Samsung SmartThings, consider what the most meaningful and easy-to-remember scene names might be when programming them. For instance, a scene named Good Morning is easy to remember and accurately describes the experience one might look for in that scene.

3. VOICE CONTROL

Smart shades that work with Alexa and Google Home. Control your smart shades via voice commands to open/close the shades.

Kickstart your journey with SmartThings Edge

SmartThings Edge Device Drivers integrate Hub Connected Devices into the SmartThings Platform. These Edge drivers allow all Hub Connected device integrations to run locally on the Hub, offering numerous benefits such as speed, reliability, and enhanced functionality. Our partner Bud uploaded instructions, learn more here.

- [Get Started with SmartThings Edge](#)
- [Edge Driver Installation Instructions for SmartWings Zigbee Roller Shades in SmartThings](#)

Initial Set Up and App Control

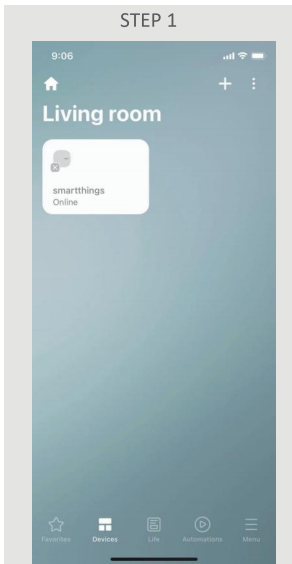

On the SmartThings Device screen, select the (+) icon in the top right corner.

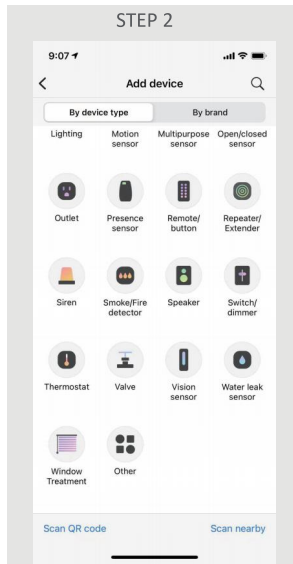

Select By device type, then select Window treatment.

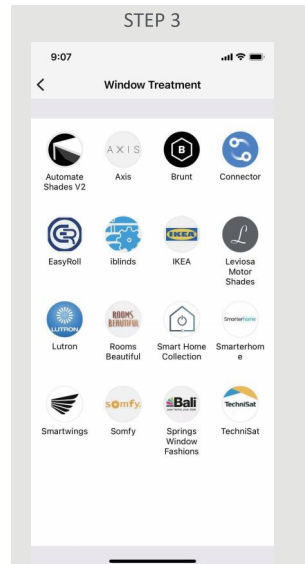

Select Smartwings

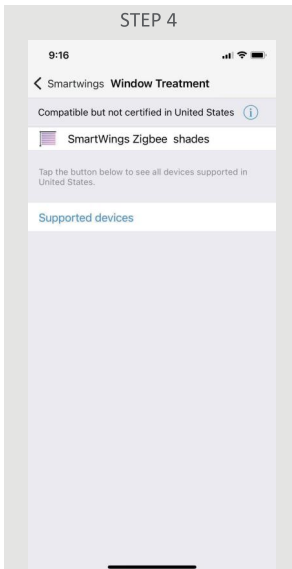

Select the "SmartWings Zigbee shades".

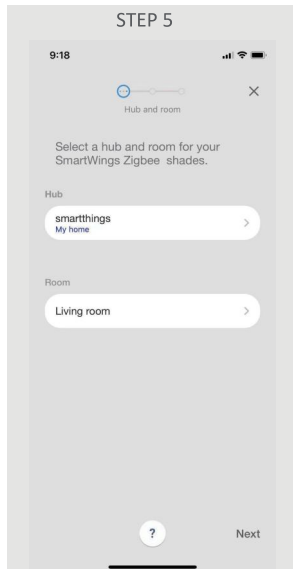

Choose the shade location.

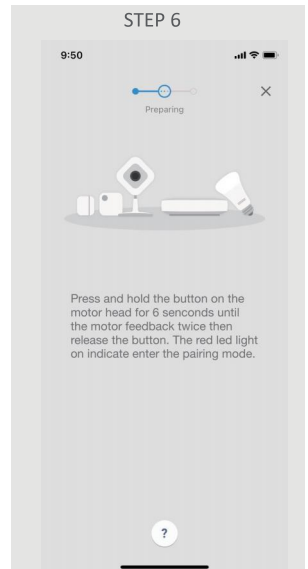

Pairing with the motor.

Initial Set Up and App Control

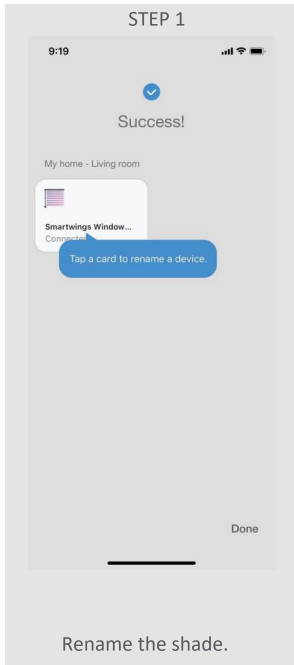

Rename the shade.

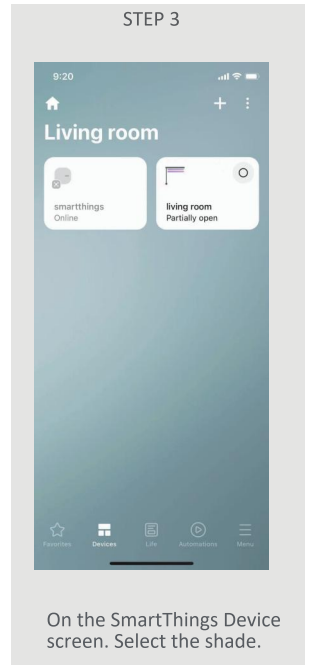
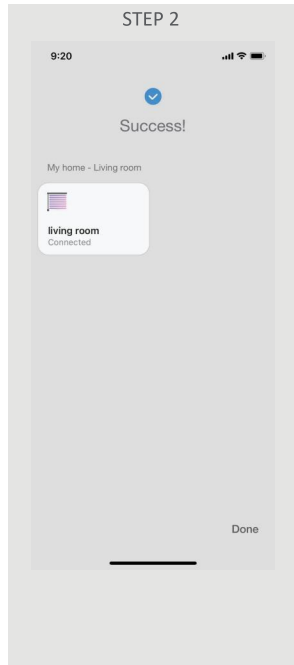

On the SmartThings Device screen, Select the shade.

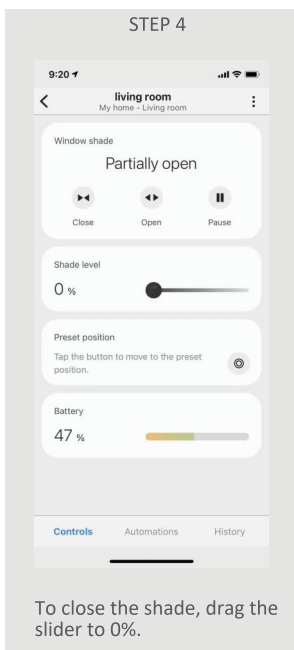

To close the shade, drag the slider to 0%.

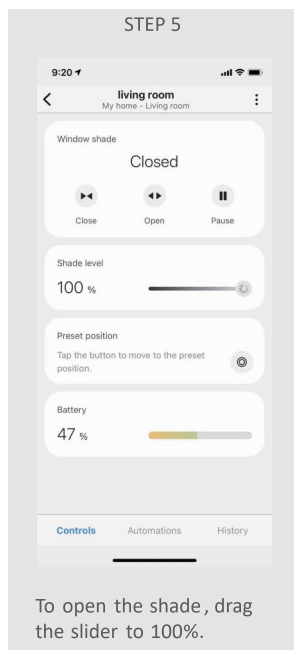

To open the shade, drag the slider to 100%.

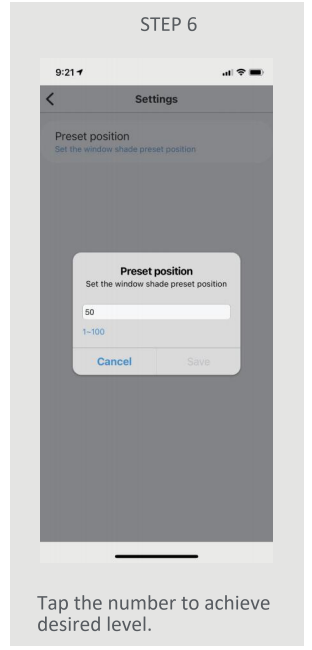

Tap the number to achieve desired level.

How to Create a Scene in the SmartThings App

STEP 1

Click the Automation icon, Select "Add scene"

STEP 2

Select the Control devices

STEP 3

Select the shade

STEP 4

Program the shade level or select the shade open/close

STEP 5

If you select the "Good morning" Scene, you can open a shade or group of shades, as have been programmed.

STEP 6

In the "Automation" Screen, you can control Scenes

How to Add Automation in the SmartThings App

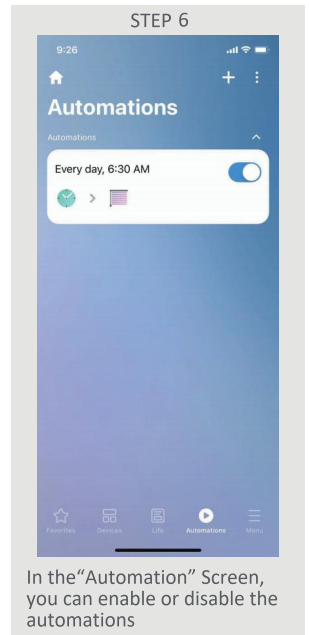
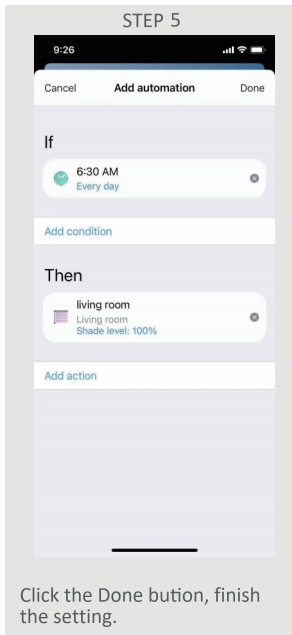
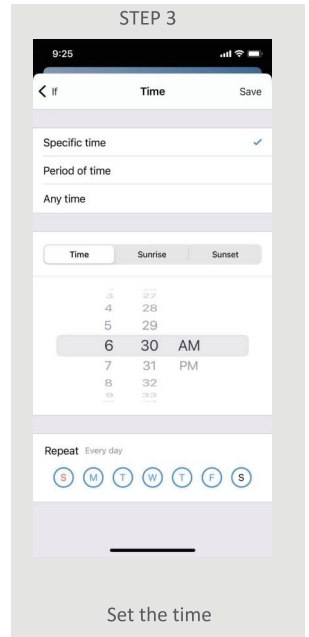
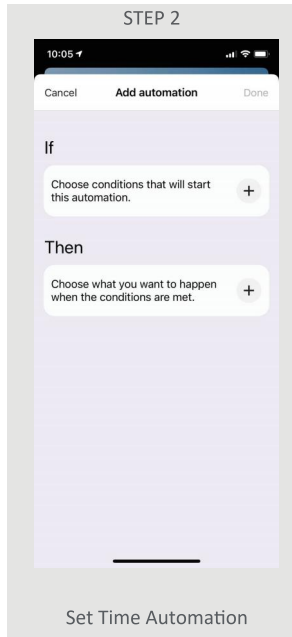
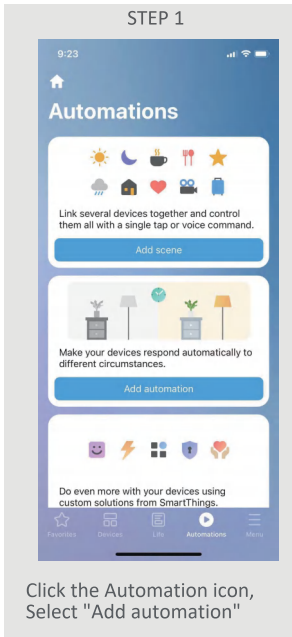

Voice Control

