

WR04-08CH

Emitter specification

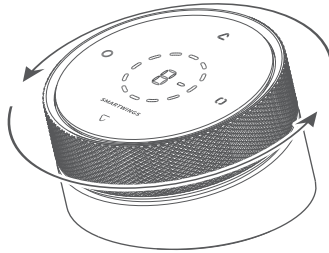

F Button Function Description

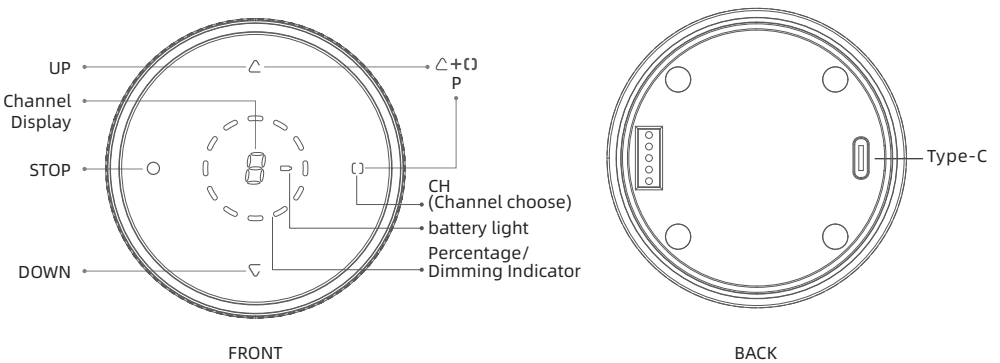

T Technical support

Technical specification	Function instruction
<ul style="list-style-type: none">Input voltage: 3.7VTransmitting frequency: 433.925MHzTransmitting power: 10 MilliwattOperating temperature: -5°C~50°CTransmission distance: outside: 200 meters, inside (between two walls): 35 meters	<p>One number of screen means one control channel. Press "channel choose" button [] to change the channel. On the analogy of this, loose finger when the screen shows the suitable channel that you select effective channel. If screen number show "o" that means all channels if effective (group control state).</p> <p>Notice: Emitter couldn't be exposed to moisture and struck, so as not to affect life. When you use emitter, if found emission distance obviously short or less sensitive, please change another same new battery. Please have batteries for recycling.</p> <p>Caution: Risk of explosion if battery is replaced by an incorrect type. Dispose of used batteries according to the instructions.</p>

B Wall mounted magnetic suction bracket

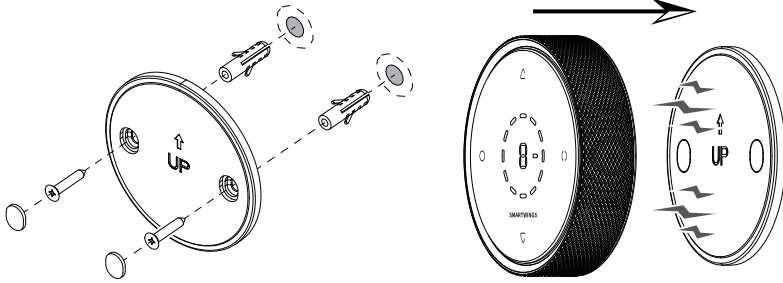

Place the magnetic bracket horizontally on the wall, mark the wall through the two small holes in the middle, fix the magnetic bracket at the marked position with screws, and then attach the rubber pad.

P Pairing remote to Motor

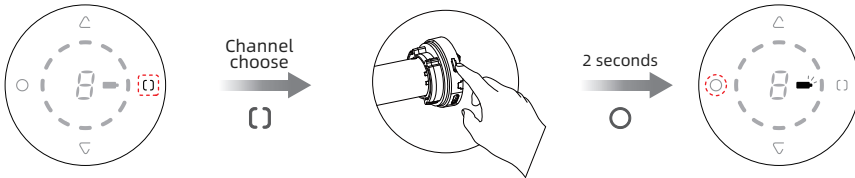

Press the "CH" button, select the channel to be paired in 1-8 (0 channel controls all channels at the same time, cannot be paired individually).

Press & HOLD Programming button on motor head, the motor jog once.

Within 10 sec of activating pairing mode, **Press & Hold STOP** (2 sec), motor jog twice, pairing is successful!

S Switch between "Percentage Mode" and "Tilt Mode"



- The factory default is percentage mode.
- Dimming cannot be performed when the shade has not reached the maximum downstroke point.

Enter Tilt Mode:

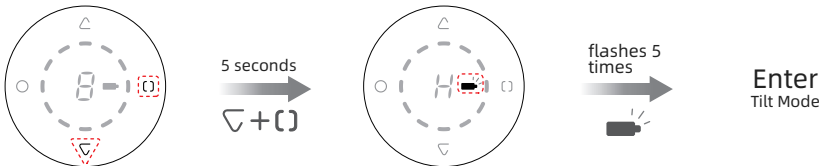

Press and hold the "channel choose" key and the down key.

Until the power indicator **flashes 5 times**

Enter Percentage Mode:

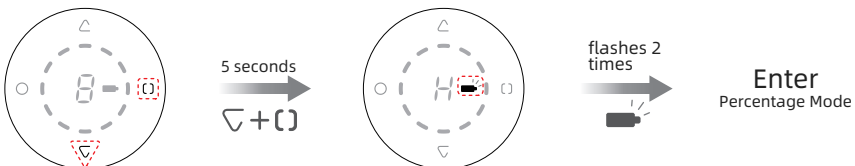

Press and hold the "channel choose" key and the down key.

Until the power indicator **flashes 2 times**

P Motor operating instructions in "Percentage mode"

- When the emitter is in Percentage Mode, the percentage of window opening/closing can be controlled by rotating the control ring.

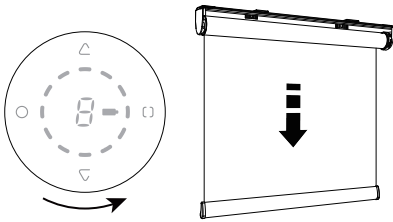

Open the shade by turning the Control Ring clockwise; when the lights are all on, the shade is fully open.

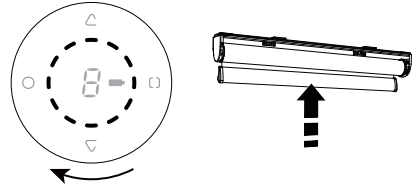

Close the shade by turning the Control Ring counterclockwise; when the lights are all off, the shade is fully closed.

The position of the shade corresponding to the "percentage indicator"

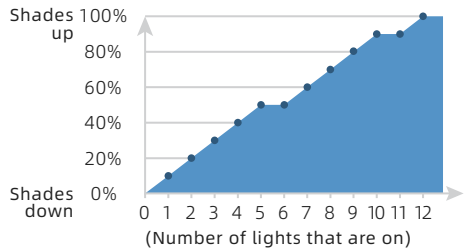

T Motor operating instructions in "Tilt Mode"

- When the emitter enters Tilt Mode, the light transmission of the blinds / wood blinds / ShangriLa shades can be controlled by rotating the control ring.

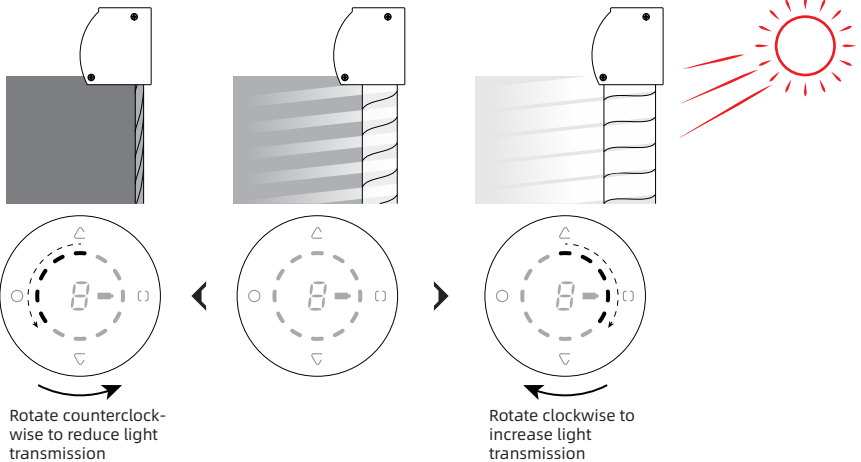

Rotate counterclockwise to reduce light transmission

Rotate clockwise to increase light transmission

- Gently turn the control ring so that as the indicator lights up gradually in a clockwise direction, the shade increases the amount of light that can pass through;
- When the indicator lights up gradually along the counterclockwise direction, shade decreases the light that can pass through.

A Additional Features

Match the tilt mode used by the lower version of the motor.



Note.

- The factory default is percentage mode.
- Dimming cannot be performed when the shade has not reached the maximum downstroke point.

Enter Tilt Mode (compatibility):

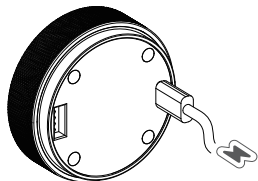

- When operating this step, the transmitter must be connected to power.
Plug the powered-on Type-C charging cable into the type-c charging port on the back of the transmitter.

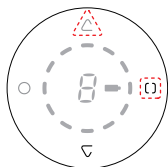

5 seconds

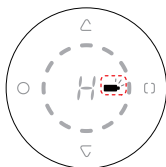

flashes 5 times



Enter
Tilt Mode

Press and hold the "channel choose" key and the "UP" key.

Until the power indicator **flashes 5 times**.

Enter Percentage Mode (compatibility):

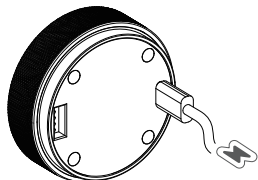

- When operating this step, the transmitter must be connected to power.
Plug the powered-on Type-C charging cable into the type-c charging port on the back of the transmitter.

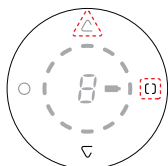

5 seconds

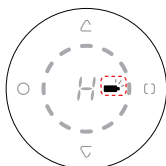

flashes 2 times



Enter
Percentage Mode

Press and hold the "channel choose" key and the "UP" key.

Until the power indicator **flashes 2 times**.