

LaserPecker
LaserPecker 2 Versatile Electric Roller
User Manual



Product Name: LaserPecker
 Model: Versatile Electric Roller
 Version number: 2022-1.1Ar

LaserPecker

01 /Accessories List

Versatile electric roller Mounting bracket

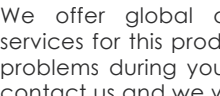
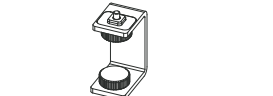

Secondary sliders of versatile electric roller



USB-C cable



Silicone bands



After-sales service

- We offer global online technical support services for this product. If you encounter any problems during your use, please feel free to contact us and we will respond to you as soon as possible.
- Facebook: LaserPecker 2 VIP Group
- Email: LaserPecker 2 VIP Group
- Tel: +86 0755-28913864

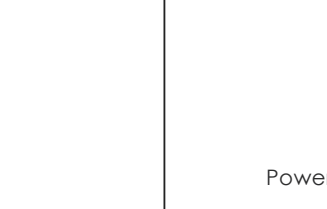

Scan QR code to watch instruction video

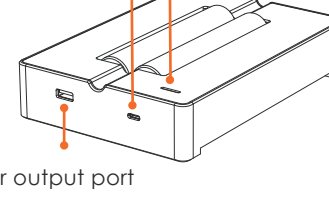

LaserPecker 2 VIP Group

LaserPecker

02 /Indicator and Interface Instructions

- Port and indicator
- Connection diagram

Connection indicator

Power input port

Power output port

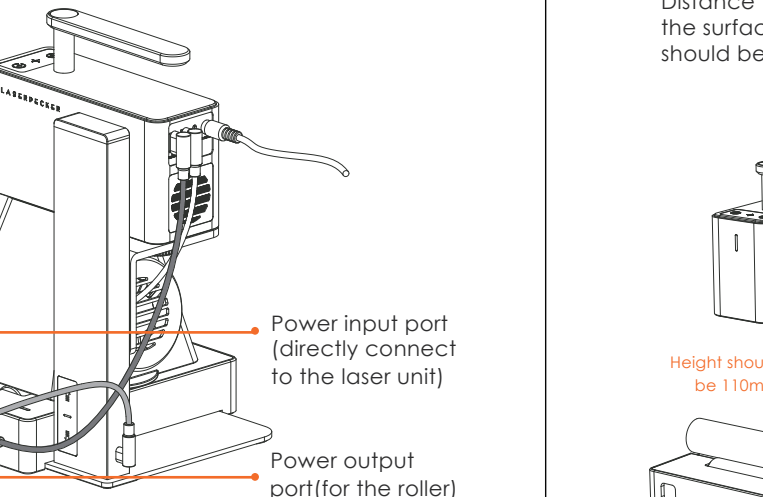

LaserPecker

03 /Ranging Method

- Ruler ranging
- Ranging by ranging rod
- Ranging by protective cover

Distance from laser outlet to the surface of engraved object should be 110mm.

The bottom edge of rod contacts the surface of engraved object.

Adjust the height so that the bottom edge of protective cover touches the surface of the object.

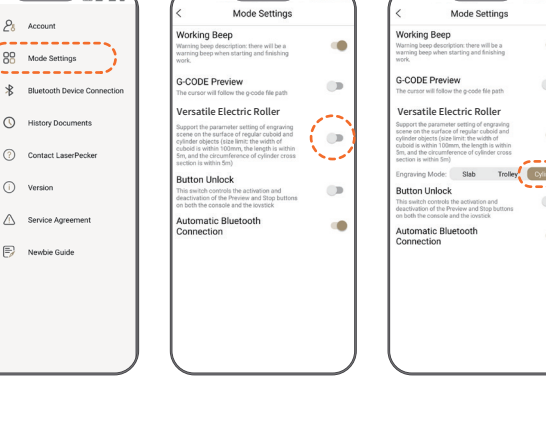
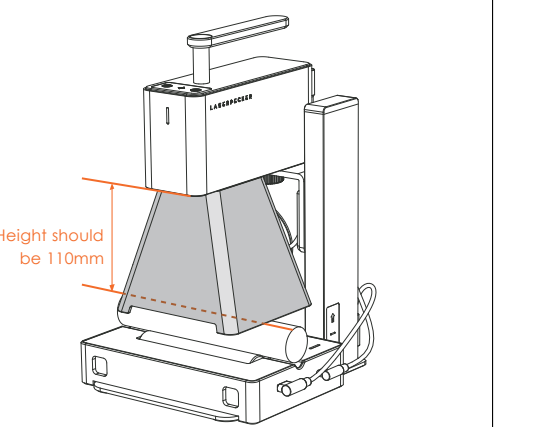
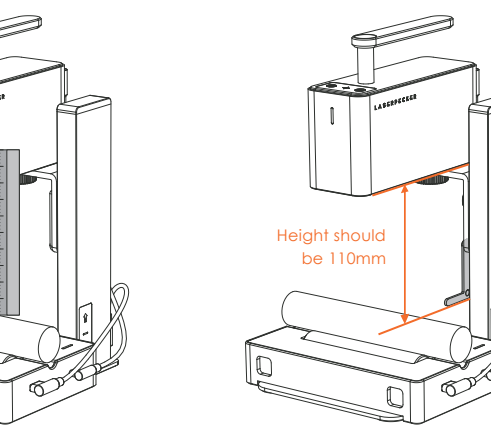

LaserPecker

04 /Engraving Mode- Cylinder Mode

This mode is used to engrave on cylindrical objects. Select [cylinder] in APP, set the correct distance 110mm, preview engraving position, set proper power/depth and engraving size, then ready to engrave.

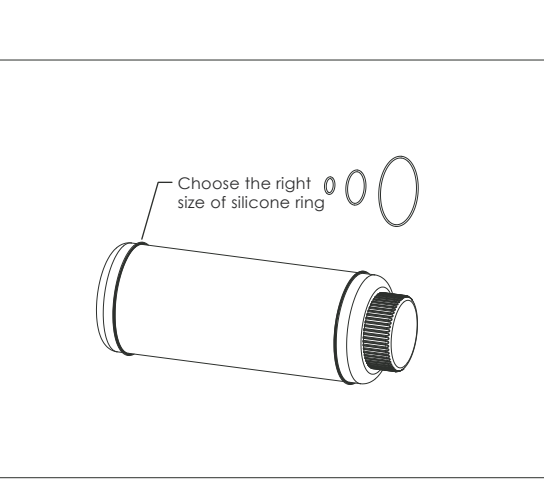
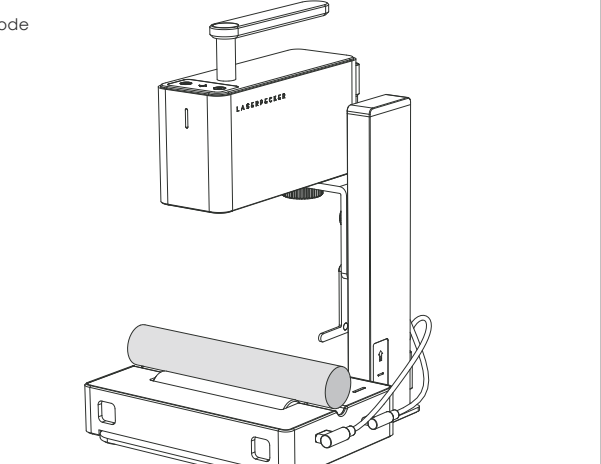

LaserPecker

Engraving Frictionless Objects

In [cylinder] mode, if the cylindrical object is frictionless, please wrap silicone bands on it.

- 1 Wrap two silicone bands on both ends of the object.
- 2 They'll prevent the object from skidding from the roller.

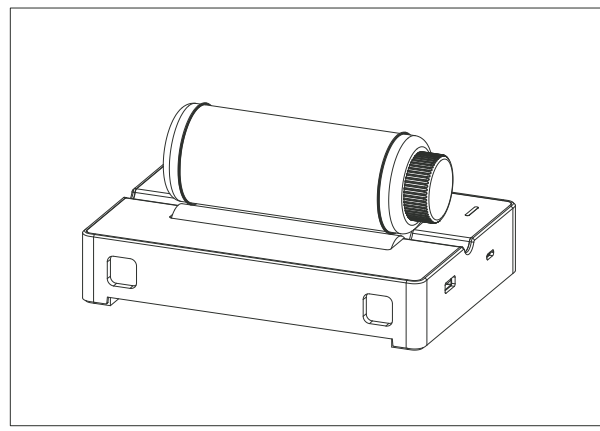

LaserPecker

05 /Engraving Mode - Slab Mode

This mode is used to engrave on long and flat objects. Select [slab] in APP, set the correct distance 110mm, preview engraving position, set proper power/depth and engraving size, then ready to engrave.

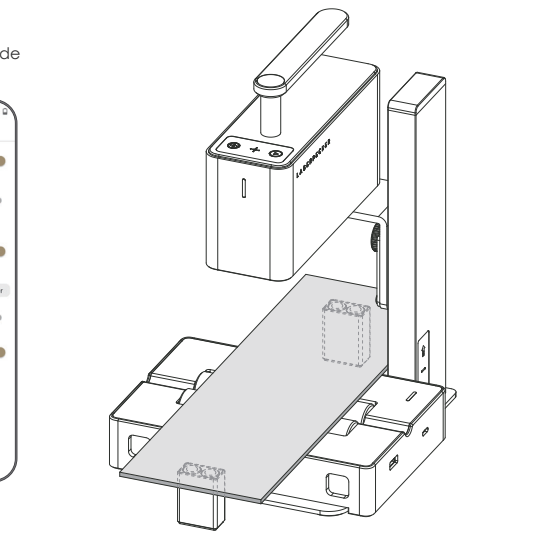
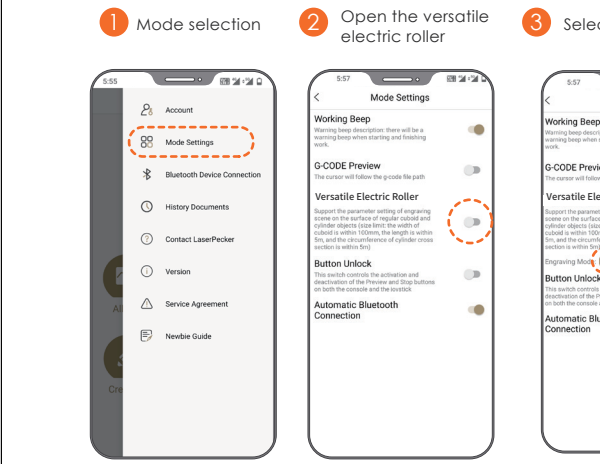

LaserPecker

06 /Engraving Mode - Trolley Mode

This mode is used to engrave on heavy, long and flat objects. Select [trolley] in APP, set the correct distance 110mm, preview engraving position, set proper power/depth and engraving size, then ready to engrave.

