

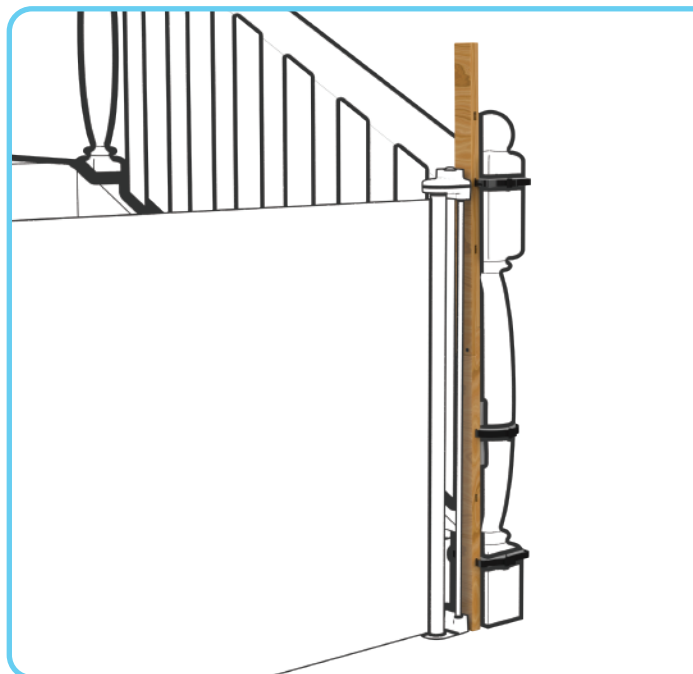

Banister Adapter Kit Instruction Manual



PART LIST:



TOOLS REQUIRED:



Assembly

1. Align 2x Timber Banister Adapter pieces
2. Fix together using 4x 20mm Screws (3/4")

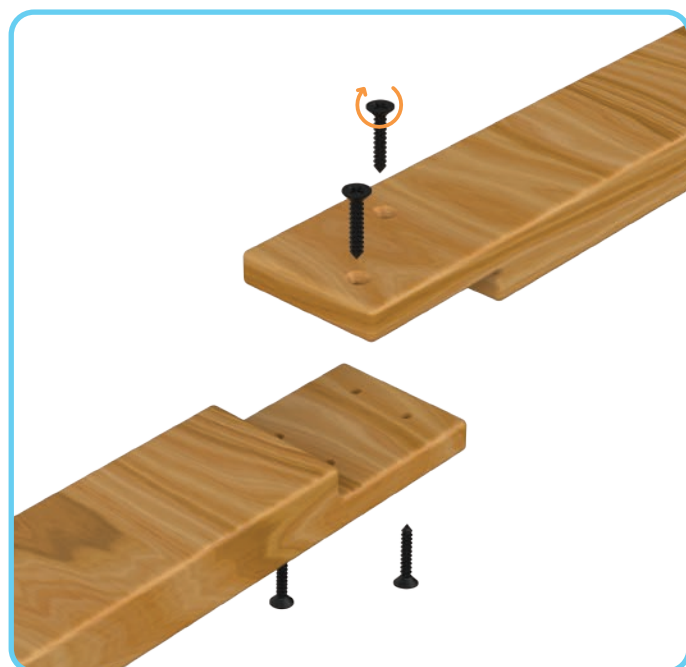

Placement / Trim to Fit

A. Measure the opening and confirm that the gate will fit the opening width.

B. Check the height of your gate against the full height of the Banister Adapter. Then measure the height of your banister, if the Banister Adapter is taller than the gate and the banister it can be shortened by cutting the excess timber.

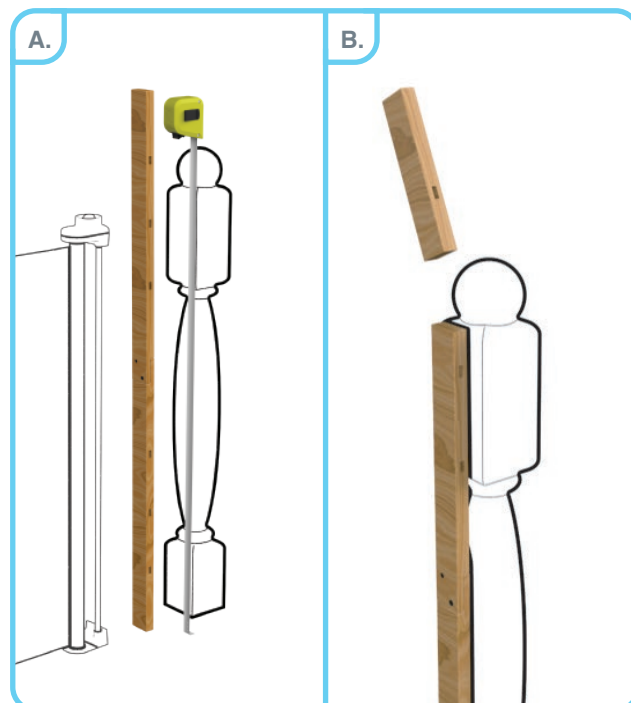

AFTER SALES SUPPORT



Scan the QR code for
Live Chat Support or visit:
permachildsafety.com/contact-us

Banister Adapter Installation

The Banister Adapter Kit must be installed in a structurally sound opening and only be fixed to a solid and secure surface. If unsure, check with a qualified builder that the installation you intend is suitable and safe within the chosen location.

1.

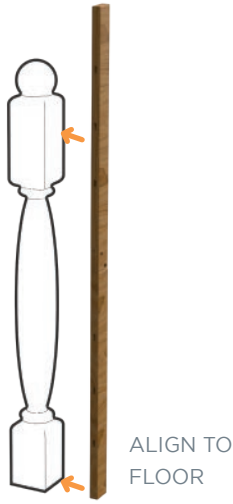

ALIGN TO FLOOR

Place adapter vertically against banister

2.

A. Insert zip tie in the bottom hole and loop around banister.

B. To protect banister add double sided foam tape then tighten.

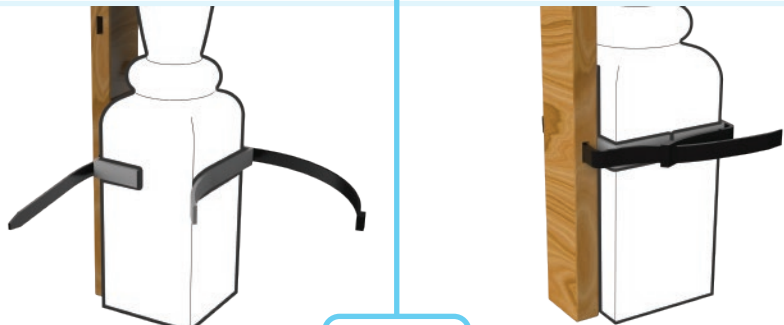

BOTTOM

3.

A. Insert zip tie in the top hole and loop around banister.

B. To protect banister add double sided foam tape then tighten.

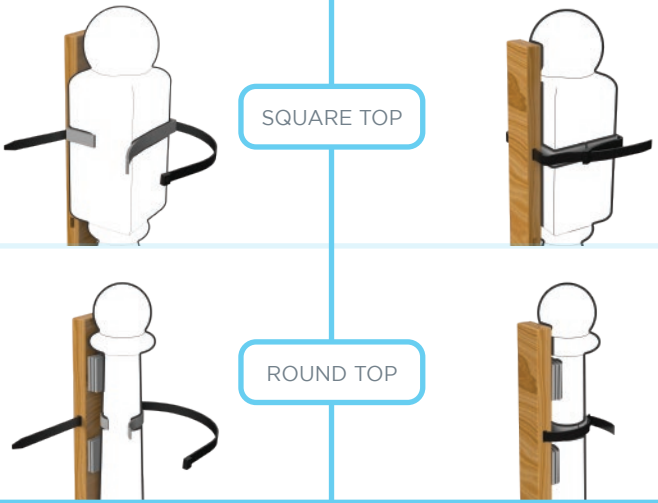

SQUARE TOP

ROUND TOP

Round top banisters will require extra foam packing to ensure the adapter is vertical with the lowest mount.

4.



Add the middle zip ties into the middle holes using the same process.

5.

Trim the zip ties with a knife, be careful not to leave sharp edges.



6.

Follow instruction provided with gate to mount into the Timber Adapter Kit. Use a screwdriver and the 20mm (3/4") screws provided.

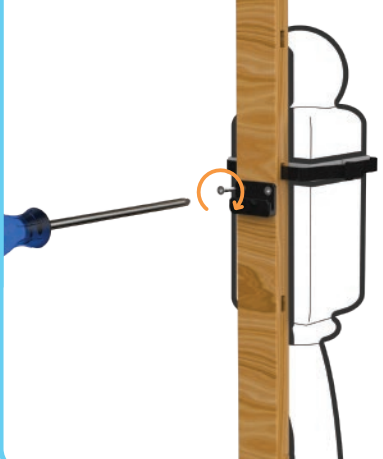

FOR OTHER INSTALLATION OPTIONS

Scan the QR code or visit the product page on permachildsafety.com