

PART LIST:



2x TV Anchors



2x 6mm Bolts



2x 8mm Bolts



6x 34mm Screws



Locate the VESA mounting holes on the back of your flat screen TV. Determine the correct size bolts to use (details can be found in TV user manual). Place the bolt through the metal end with single hole and tighten the bolts into the VESA holes. Extend straps to help position for mounting.

This anchor must only be fixed to a solid and secure surface. To install you will need a screwdriver, pencil and drill.

Note: Hardwall/masonry and plasterboard fixings are not included, consult local hardware store for correct fixings.

Timber Fixing:

Drill 2mm pilot holes and use the timber screws provided screwing directly into the timber.



Plaster Board Walls:

Locate timber stud and follow timber fixing instructions. Plaster board walls without studs require expandable wall plugs (not supplied).



Hard Wall Fixing:

(Concrete or Brick)
 Hard wall surfaces require expandable wall plugs (not supplied).

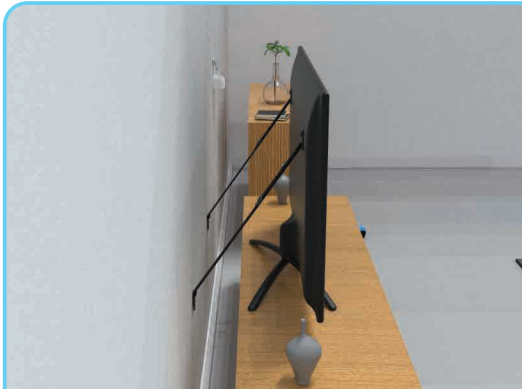
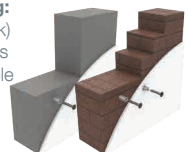

Wall Mounting: Each lower bracket must be a minimum 15cm below the VESA holes. Each bracket should be attached to separate wall studs and face down. Mark the position of each bracket and drill pilot holes. Secure the brackets to studs with 40mm screws. Ensure straps are not twisted and tighten until taught.



Furniture Mounting: Each lower bracket must be fix to a strong suitable surface facing down. Mark the position of each bracket and drill pilot holes. Secure the brackets with 40mm screws. Ensure straps are not twisted and tighten until taught.

CAUTION: Never leave child unattended. This product is not a substitute for adult supervision. Ensure that the product is securely installed into solid furniture or timber studs in the wall. Regularly check all screws are firmly secured.