

**YOUR GUIDE TO**

**SimplyGoodCoffee™**

# HELLO

**Meet the SimplyGoodCoffee Brewer,  
designed to brew great tasting coffee,  
simple and easy.**

- 1 | Read all the instructions before brewing, especially the SAFETY section**
- 2 | Remove all packaging labels and stickers. Keep plastics and small pieces away from children**
- 3 | Follow the steps on the next pages, simply good coffee is a just a few minutes away**



**For questions and support contact us by email at [brew@simplygoodcoffee.com](mailto:brew@simplygoodcoffee.com) or call 1-877-355-5684**

# 1 WASH

Clean the Brewer

- 1 | Fill the Water Reservoir with clear, cold water to the “MAX” level mark
- 2 | Turn the Brewer On and allow all the water to run through a complete brew cycle
- 3 | Let the Brewer cool down for 5 minutes, then repeat steps 1 & 2

Your Brewer is now ready to make coffee!

## 2 PARTS

1. Water reservoir lid
2. Water reservoir
3. Filter basket bracket
4. Main body
5. Power switch (On/Off)
6. Indicator light (Orange)
7. Bloom switch (Up position is On)
8. Base
9. Bottom cover
10. Warming plate
11. Glass carafe
12. Carafe lid with mixing tube lid
13. Drip toggle
14. Filter basket
15. Filter basket lid
16. Showerhead

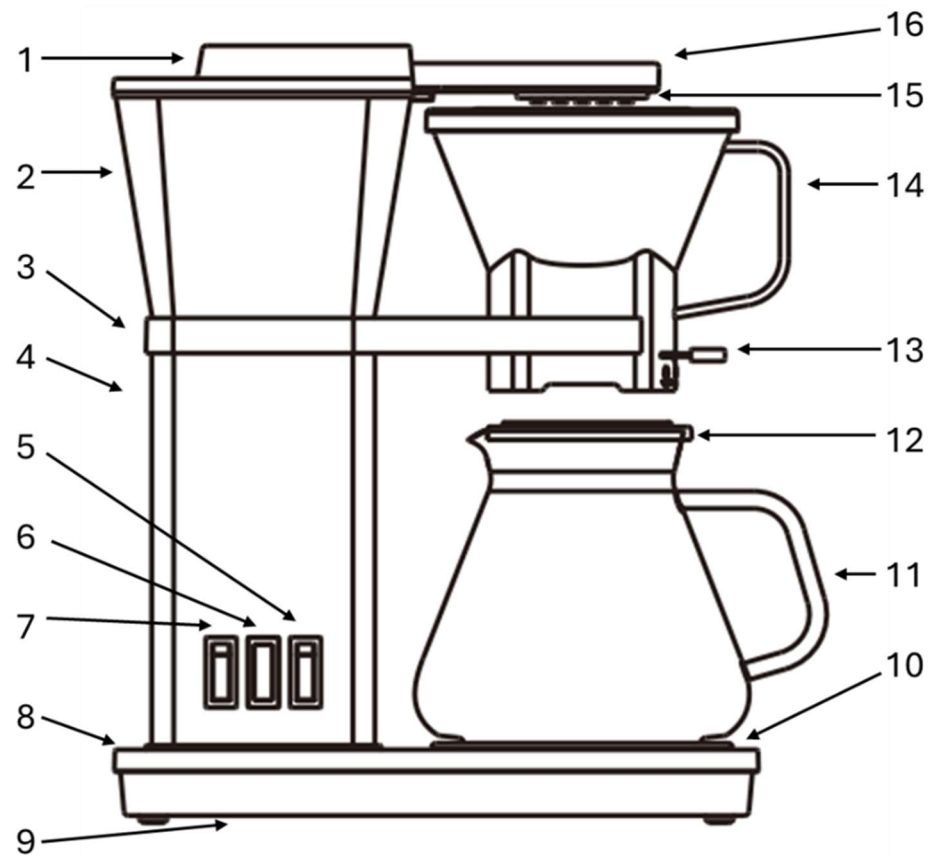

TECHNICAL DATA | Rated voltage: 120V 60Hz | Rated power input: 1560W

Plastic parts contacting liquid are BPA, BPS and Phthalates free.

# 3 BREW

## Step 1

Lift the Water reservoir lid and use the Carafe (or other pitcher) to pour the desired amount of cold water into the Water reservoir according to the amount of coffee you are going to brew. The water level must meet the MIN line and not exceed the MAX line indicated on the Water reservoir. This will brew between 2-8 cups of coffee.

## Step 2

Insert a #4 V-shaped paper coffee filter into the brew basket (fold the filter at the crimped edges for proper fit (see Fold The Filter diagram on Page 5). Scoop ground coffee into the filter. We recommend 1 rounded tablespoon (6-9 grams) of ground coffee per cup, and you can adjust the amount according to your taste. Place the Lid on the Filter basket and make sure the Drip toggle (at the bottom of the brew basket beneath the handle) is in the Open position “O” to avoid overflow during brewing. See figure A.

## Step 3

Place the lid on the Water reservoir. Slide the Filter basket (containing the filter and ground coffee) into the Filter basket bracket – you will feel the magnetic catch when it is in place. Place the Glass carafe with Mixing tube lid on the Warming plate. The Brewer should be plugged into a 120V GFI/GFCI (ground fault circuit interrupter) protected electrical outlet.

## Step 4

Press the Power switch ON – in the up position. The Power switch will toggle back to the down position immediately for safety, but it is On – the orange Indicator light will be illuminated, and the Brewer has started heating the water to make coffee. The Brewer will take a minute or so to start brewing, and you will have 8 cups in 6 minutes or so. It will take less time to make fewer cups. The Brewer will shut off automatically. In case you need to shut off the Brewer manually, press the Power switch again and the orange Indicator light will shut off, indicating the Brewer is OFF.

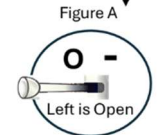
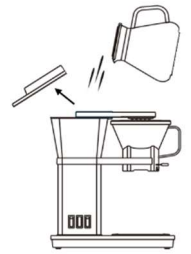

## 4 DO'S

### FOLD THE FILTER

Use #4 paper coffee filters. For best fit and operation, fold the filter along the bottom and side crimped edges so the filter sits properly in the Filter basket. These #4 filters are widely available at most grocery stores.

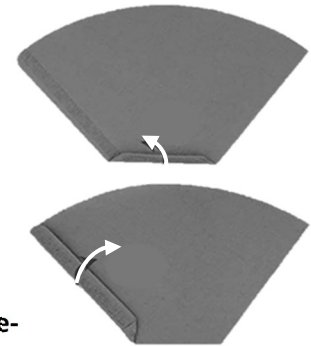

### BLOOM

We recommend using the Bloom feature especially when you are using freshly roasted coffee. Freshly roasted coffee has natural carbon dioxide in the bean that should be released during the brewing process. Our Bloom (pre-infusion) automatically pauses the brew after the grounds have been wet enough to let the carbon dioxide escape.

To use the Bloom, simply press the Bloom switch to the ON position (Up), and then press the Power switch On (Up), as you would normally start brewing. The brewing process now includes the Bloom automatically – after the brewing begins, you will notice a pause in the water flow from the showerhead, and then after the coffee is given time to Bloom, the brewing automatically resumes to completion. There is no need to touch the Bloom switch while brewing, it is automatic.

When the Bloom switch is On (Up) the Brewer will include the Bloom as part of the brewing process for every pot of coffee. Simply press the Bloom switch Off (Down) to brew without it. You will likely find the Bloom makes a fuller, rounder (less bitter) cup of coffee.

### WARM

This Brewer is quick, so brewing the amount of coffee you want to drink fresh is easy. And fresh coffee is always the best. This Brewer has a Warming plate designed to keep a carafe of coffee warm for 40 minutes. The Warming plate is not too hot and will not stay on too long, to avoid cooking the coffee while keeping it warm. Also, the Warming plate shuts off automatically after 40 minutes for safety. You can turn off the Warming plate (and the Brewer) by pressing the Power switch (Up) and the orange light will go off.

### COMPOST

Remove the Filter basket and discard used ground coffee and filter in-between each use. Coffee grounds and paper filters make for great compost. Your garden will thank you!

## 5 DON'TS

### **SAFETY – PAY CLOSE ATTENTION!**

Make sure that the voltage in your home corresponds with the voltage indicated on the bottom of the Brewer. Never operate the Brewer if it only works intermittently or stops working altogether.

Do not touch hot surfaces - use the handles or knobs. Do not operate the Brewer if its cord, plug, or various parts have been damaged, or if unattended children are nearby.

Do not move the Brewer while in use and keep Brewer away from walls and furniture while in use. Place the Brewer on a flat level surface. Do not place Brewer on or near a hot electric or gas burner, or in a heated oven.

Ensure the showerhead is installed correctly prior to use. Do not adjust or remove the showerhead while brewing.

Only use the carafe designed for this Brewer. Do not set a hot carafe on a wet or cold surface. Carafe must never be used on a range top. Never remove the carafe, lid or filter basket during brewing cycle. Do not use the carafe if it sustains an impact or has a loose or damaged handle. Check for cracks, damage, or signs of leakage before using.

Do not let the cord hang over the edge of a table or counter or immerse cord, plugs or the Brewer in water or other liquids. Do not use outdoors or in damp areas.

Never operate the Brewer without putting water in the tank. Only fresh, filtered, cold water should be used in the tank. Do not use hot water.

The Brewer can be switched off manually at any time by using the ON/OFF switch. To disconnect the Brewer, first turn the POWER switch OFF, then remove plug from the wall outlet. Do not unplug from outlet with wet hands.

Before cleaning, unplug from outlet and allow to cool before putting on or taking off parts.

Do not remove the bottom cover from the Brewer. There are no user-serviceable parts to this Brewer. You should not attempt to repair it. The use of accessory attachments may result in fire, electric shock or personal injury.

Do not use this Brewer for anything other than its intended use.

## **6 EXTENSION CORDS**

**A short power-supply cord is provided on purpose to reduce the risk of accidents such as tangling and tripping. Longer detachable power-supply cords or extension cords may be used if care is exercised. Make sure the electrical rating of the extension cord is the electrical rating of the Brewer. Avoid any chance of tripping, snagging, or tugging by making sure the cord and extension cord does not hang over the countertop or table, is not intertwined with other cords or appliances and is free from other potential hazards. Be especially careful when children are present.**

### **ADDITIONAL DISCLAIMERS**

**This Brewer is for household use only.**

**When using the Brewer, basic safety precautions should always be followed to avoid fires, electric shocks, burns, or other injuries and damage.**

**Read all operating and safety instructions carefully. Keep them for future reference.**

**Do not attempt to repair the Brewer yourself. Contact customer service for information on examination, repair, and adjustments.**

**Do not return the Brewer to any store, contact customer service by email at [brew@simplygoodcoffee.com](mailto:brew@simplygoodcoffee.com) or call 1-877-355-5684.**

**See the SimplyGoodCoffee Warranty for more information.**



# 7 CLEANING & MAINTENANCE

Clean after each use and your Brewer will make great coffee for many years.

Unplug the Brewer, let it cool down completely before cleaning. Remove the showerhead and wash by hand or on top rack of a dishwasher.

Only use soft, damp cloth to clean the outside of the machine. Do not clean the coffee Brewer, carafe or warming plate with abrasive cleansers, steel wool pads, or other abrasive materials.

Never submerge the Brewer in water. Do not place the Brewer in the dishwasher.

## DESCALE

We recommend that you descale your Brewer once every two months or every one hundred brews. We recommend using Urnex or other good quality, biodegradable and phosphate-free coffee Brewer descaling solution. Follow instructions on descaling product package. Clean the Brewer by filling the water tank with fresh, filtered, cold water to the MAX line and run through the brew process. We do not recommend vinegar, baking soda or other household items to descale.

## WATER TEMPERATURE

This Brewer is designed to consistently deliver 195°F – 205°F water temperature per SCA (Specialty Coffee Association) guidelines for brewing to Specialty Coffee Standards. An independent Brewer Testing and Analysis Report is available at [SimplyGoodCoffee.com](http://SimplyGoodCoffee.com) under Customer Support. Some customers try to measure the water temperature from the Brewer (which we do not recommend) by placing a thermometer in the Carafe or under the shower head. This method will not provide accurate temperature readings and is not how SCA temperature testing is done. The shower head pulses water drops that mix with air, and the coffee has already cooled at the bottom of the carafe, so both locations are poor choices to measure water temperature. According to SCA guidelines measuring water temperature should be done in the Filter basket just below the top of the slurry of coffee and water, approximately one minute or more into the brew, with the Bloom feature off.

# 8 TROUBLE SHOOTING

PROBLEM	CAUSE	SOLUTION
Coffee overflows the filter basket	<ul style="list-style-type: none"> <li>A) Drip toggle at the bottom of the filter basket is closed and needs to be open (O position to the left)</li> <li>B) Ground coffee is too fine, clogging the filter basket</li> <li>C) Filter is not properly placed in the filter basket</li> </ul>	<ul style="list-style-type: none"> <li>A) Move the toggle to the O position (Open, left)</li> <li>B) Wash the filter basket and ensure nothing is blocking/clogging the hole at the bottom, and use a coarser grind</li> <li>C) Make sure filter is folded along the crimped edges and sits properly in the filter basket</li> </ul>
Does not brew	<ul style="list-style-type: none"> <li>A) Power cord is not plugged in properly</li> <li>B) Not enough water in the water reservoir</li> <li>C) Appliance failure</li> </ul>	<ul style="list-style-type: none"> <li>A) Unplug and plug back in the power cord, ensuring it is properly plugged in. Make sure GFCI is set</li> <li>B) Fill the reservoir with the right amount of water</li> <li>C) Stop using the appliance and contact customer service at <a href="mailto:brew@simplygoodcoffee.com">brew@simplygoodcoffee.com</a> or call 877-355-5684</li> </ul>
Brews too slowly	<ul style="list-style-type: none"> <li>A) Filter basket is clogged</li> <li>B) Ground coffee is too fine or compact</li> <li>C) Water minerals are clogging the brewer</li> </ul>	<ul style="list-style-type: none"> <li>A) Wash the filter basket and ensure nothing is blocking/clogging the hole at the bottom,</li> <li>B) Use a coarser grind, do not compact the coffee in the filter</li> <li>C) Time to descale the brewer</li> </ul>
Brews too quickly, coffee is light	A)Ground coffee is too coarse	A) Use a finer grind

**SATISFACTION GUARANTEE:** 30-day Satisfaction Guarantee: If you are not happy, for any reason, return the brewer to us within 30 days of your purchase. It is very important to us that you love your new brewer! For details, visit: <https://simplygoodcoffee.com/pages/satisfaction-guarantee>

**WARRANTY:** 2-YEAR NO FUSS WARRANTY For details, visit <https://simplygoodcoffee.com/pages/warranty>. YOU MUST REGISTER YOUR NEW BREWER IN ORDER FOR THE WARRANTY TO BE IN EFFECT.

**CUSTOMER SERVICE:** If you have any questions please contact us at [brew@simplygoodcoffee.com](mailto:brew@simplygoodcoffee.com) or call us toll free at [877-355-5684](tel:877-355-5684).

### **California Proposition 65 Notice:**

Note: This warning does not necessarily mean that our products will cause harm. Our products comply with all applicable health and safety standards. However, we provide this warning as a precaution based on the requirements of Proposition 65.

WARNING: This product contains chemicals known to the State of California to cause cancer and birth defects or other reproductive harm. This notice is provided in compliance with California Proposition 65 (Safe Drinking Water and Toxic Enforcement Act of 1986), which requires businesses to provide warnings to California consumers about significant exposures to chemicals that cause cancer, birth defects, or other reproductive harm:

Product: Simply Good Coffee brewers. all models  
Manufacturer: Simply Good Coffee, Inc.

The use of this product involves handling or consumption of materials and substances that may expose consumers to chemicals known to the State of California to cause cancer and birth defects or other reproductive harm. Chemicals of concern may include substances found in plastic and metal components of this coffee maker.

To reduce exposure, it is advisable to operate this product in a well-ventilated area, follow all instructions provided by the manufacturer, and ensure proper maintenance and cleaning procedures are followed.

For more information about California Proposition 65, please visit the California Proposition 65 Website.

For inquiries regarding this notice or the product, please contact: [Brew@simplygoodcoffee.com](mailto:Brew@simplygoodcoffee.com).