

## TRUSS MONITOR BRACKET KIT

### Have a Question?

Please contact [support@tradeshowplus.com](mailto:support@tradeshowplus.com)  
Visit: [www.tradeshowplus.com](http://www.tradeshowplus.com)



### OR-SM-MB

SIZES: 17" - 37"

#### ASSEMBLED UNIT:

9"W X 16"H X 1.4"D  
230MM (W) X 410MM (H) X 35MM (D)

#### SHIPPING DIMENSIONS:

14"L X 6"H X 4"D  
356MM (L) X 152MM (H) X 102MM (D)

#### APPROXIMATE SHIPPING WEIGHT:

6 LB / 2.7 KG

#### VESA:

75 X 75 - 200 X 200MM



### OR-M-MB

SIZES: 32" - 55"

#### ASSEMBLED UNIT:

16"W X 16"H X 1.4"D  
410MM (W) X 410MM (H) X 35MM (D)

#### SHIPPING DIMENSIONS:

24"L X 4"H X 4"D  
610MM (L) X 102MM (H) X 102MM (D)

#### APPROXIMATE SHIPPING WEIGHT:

7 LB / 3.2 KG

#### VESA:

100 X 100 - 400 X 400MM



### OR-LG-MB

SIZES: 40" - 65"

#### ASSEMBLED UNIT:

24"W X 16"H X 1.4"D  
610MM (W) X 410MM (H) X 35MM (D)

#### SHIPPING DIMENSIONS:

28"L X 6"H X 6"D  
711MM (L) X 152MM (H) X 152MM (D)

#### APPROXIMATE SHIPPING WEIGHT:

8 LB. / 3.6 KG

#### VESA:

100 X 100 - 600 X 400MM

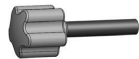

(2) OR-IS-KNOB-2



(1) OR-TVA-PLT



(2) OR-TVA-PBKT



(2) SPACER

## TRUSS CONNECTION

### Have a Question?

Please contact [support@tradeshowplus.com](mailto:support@tradeshowplus.com)

Visit: [www.tradeshowplus.com](http://www.tradeshowplus.com)

### Vertical Connection

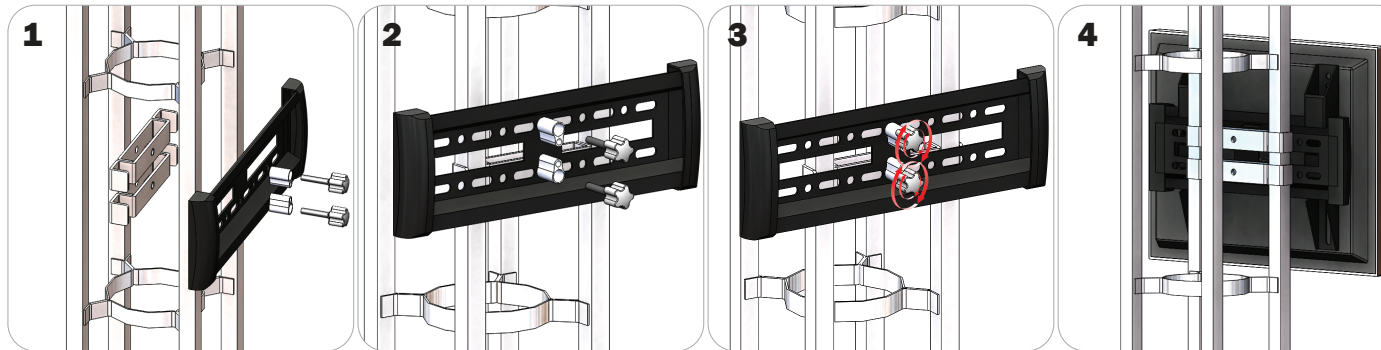

Locate all components needed to assemble the monitor mount with the Vertical Orbital Truss method. You will need (1) monitor bracket, (2) OR-TVA-PBKT-1 brackets, (2) OR-KNOB-2, and (2) spacers. Determine your desired monitor location.

**Step 1:** Place the OR-TVA-PBKT-1 brackets so that they wrap around the posts of the truss.

**Step 2:** Align your monitor bracket so that the center holes align with the bracket holes behind them.

**Step 3:** One at a time place a spacer over the hole and thread your OR-KNOB-2 thumbscrews.

**Step 4:** Reference the included manufacturer monitor mount instructions for fastening your monitor to the bracket.

### Horizontal Connection

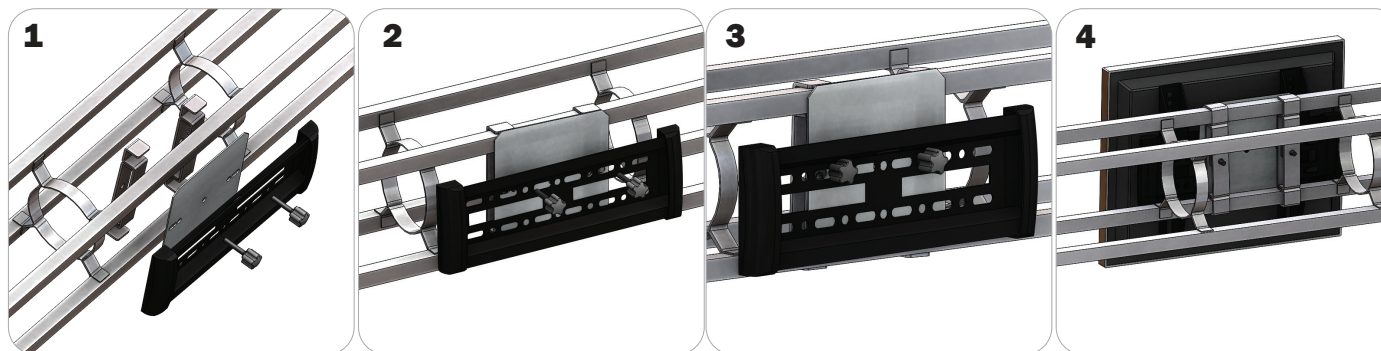

Locate all components needed to assemble the monitor mount with the Horizontal Orbital Truss method.

You will need (1) monitor bracket, (2) OR-TVA-PBKT-1 brackets, (2) OR-KNOB-2, and (1) OR-TVA-PLT. Determine your desired monitor location.

**Step 1:** Place the OR-TVA-PBKT-1 brackets so that they wrap around the posts of the truss. Add your OR-TVA-PLT and align the holes to the OR-TVA-PBKT-1.

**Step 2:** Align your monitor bracket so that the left and right holes align with the plate holes behind them.

**Step 3:** One at a time thread your OR-KNOB-2 thumbscrews through the holes.

**Step 4:** Reference the included manufacturer monitor mount instructions for fastening your monitor to the bracket.