

# INDOOR BANNER STANDS

ONE CHOICE - KAI



Front View



Angle View



Back View

## PRODUCT DESCRIPTION

One Choice Kai Display is a modern leaning tube display, with a simple pullover graphic. Unique and contemporary, One Choice Kai Display's tube design is free standing and made with durable steel. Custom edge-to-edge dye-sub graphics are printed on stretch fabric to give that nice taut finish.

## FEATURES

### DISPLAY DIMENSIONS

- 24" W x 67 1/8" H x 19" D

### GRAPHIC DIMENSIONS

- 25" W x 65 3/4" H

### GRAPHIC MATERIAL

- Stretch Fabric

### GRAPHIC FINISHING

- Sewn on left, right, and top and hemmed at the bottom.

### DISPLAY CONSTRUCTION

- 1" dia. Steel Tube Construction

## WEIGHTS & DIMENSIONS (WITH STAND & GRAPHICS)

### SHIPPING WEIGHTS

- (Qty 1): 11 lbs
- (Qty 50): 550 lbs

### PACKAGE DIMENSIONS

- (Single box): 42 1/2" L x 24" W x 11 1/2" H
- (Freight): 48" L x 40" W x 44" H skid

## TURNAROUND TIME

### GRAPHIC PACKAGE

- 4 business days after proof approval\*

### AVAILABILITY

- WEST COAST FULFILLMENT CENTER

\*After proof approval, for up to 10 sets.



Scan QR Code To View More Resources.



# INDOOR BANNER STANDS

ONE CHOICE - KAI



## PARTS LIST

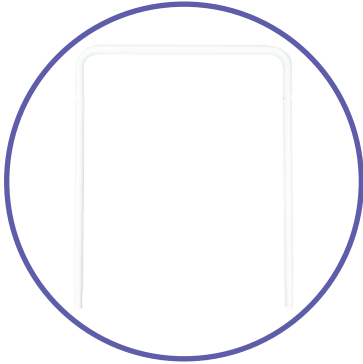

**QTY 1:**  
**Top Tube**

• 23 5/8" W x 29" H  
(27" + 2" Swage off)

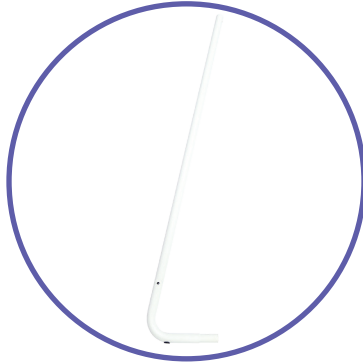

**QTY 2:**  
**Leg Tubes**

• 6 1/2" W x 41" H  
(4 1/2" + 2" Swage off)

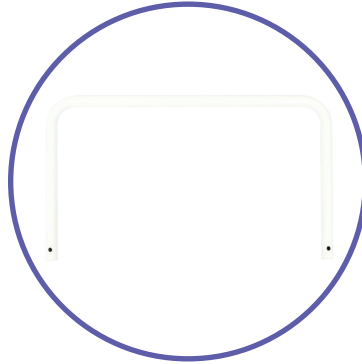

**QTY 1:**  
**Bottom Tube**

• 23 1/2" L x 14" W

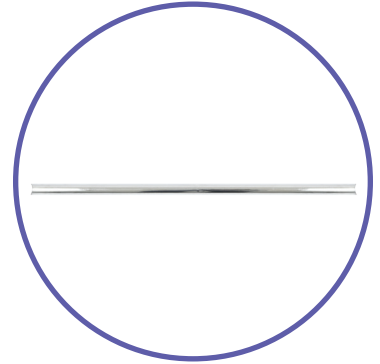

**QTY 1:**  
**Bottom Support Tube**

• 22" W



**QTY 4:**  
**Screws**

• 1/2" L x 3/16" W



**QTY 2:**  
**Large Screws**

• 1 3/4" L x 3/16" W

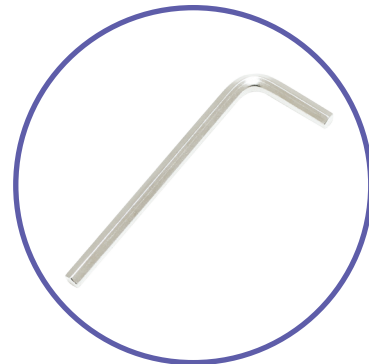

**QTY 1:**  
**4mm Allen Key**

• 2" L

# INDOOR BANNER STANDS

ONE CHOICE - KAI

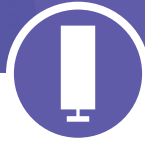

## INSTRUCTIONS

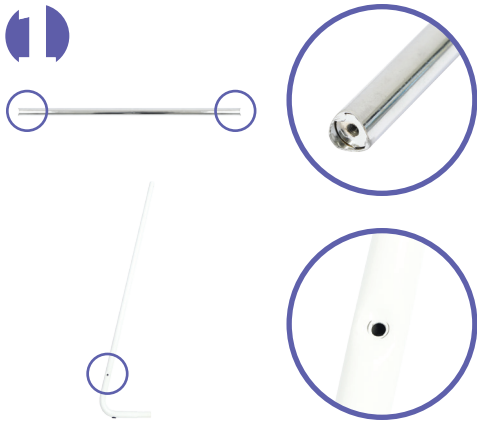

- At each end of the Bottom Support Tube, locate the screw holes. Then locate the holes on each side of the Leg Tubes.

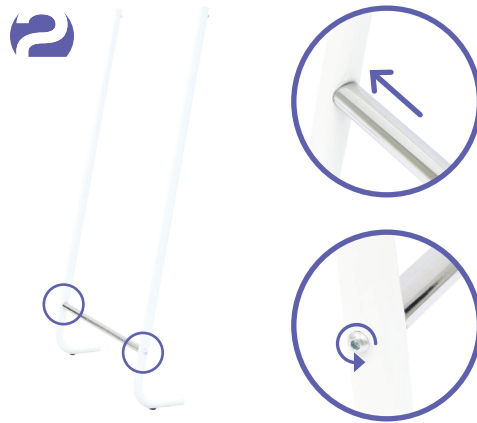

- Align the Bottom Support Tube screw holes with holes of the lower leg tubes on each side. Insert the large screws and tighten to secure with allen key.

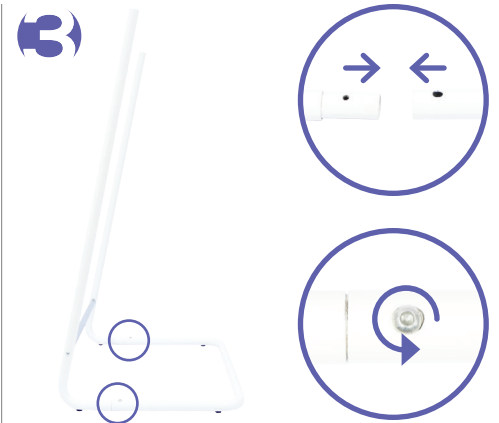

- Connect the Bottom Tube and the bottom Leg Tubes to align holes together. Insert the screws and tighten to secure with allen key.

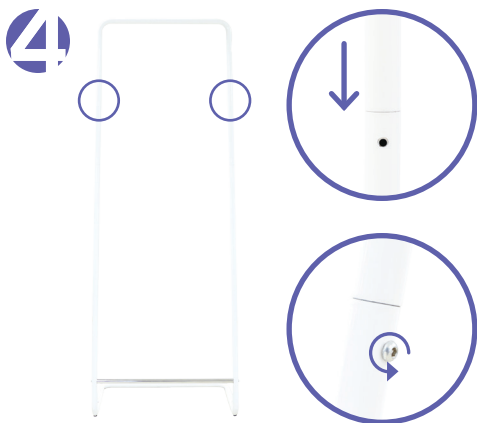

- Insert the Top Tube on top of the Leg Tubes to align holes. Insert the screws and tighten to secure with allen key.

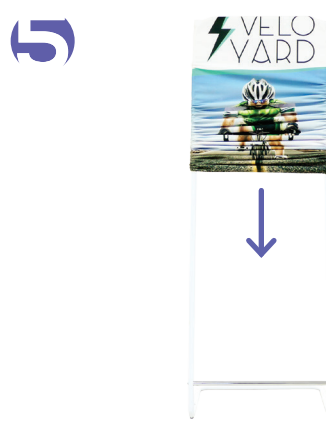

- Swiftly drape with the pillowcase graphic onto the frame. Pull down graphic to cover whole frame.

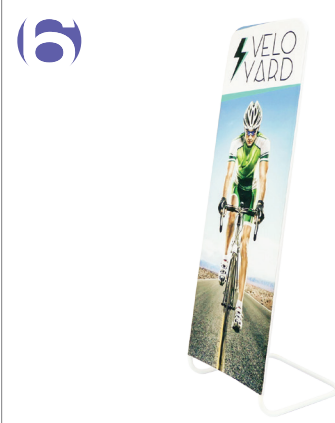

- Complete stand.

# INDOOR BANNER STANDS

ONE CHOICE - KAI



## CARE SHEET - DYE-SUB FABRIC

### HANDLING TIPS

1. If your exhibit fabric has a zipper, please keep zipper closed for storage.
2. Wrinkles can be removed with cool iron or fabric steamer.
3. Fabric should NOT be stored when damp or wet. Store in cool, dry area.
4. For storing graphics please remove from plastic packaging that was provided and keep fabric in cool/dry place.

### WASHING

1. Your fabric graphic can be machine washed. Remove any hardware attached to the fabric prior to cleaning. Use MILD soap and cool water. Air dry fabric, dry on frame if frame is available.
2. Fabric must be COMPLETELY dry prior to storing.
3. DO NOT DRY CLEAN

### STAIN TREATMENT

1. Treat stain from backside of fabric.
2. Remove as much debris as possible with a soft bristle brush (do NOT rub too hard).
3. Use a clean, lint-free white cloth. Lightly pat the stain from the outside moving in (to keep stain from spreading).
4. If a cleaning solution is used, rinse the area well with water to ensure NO solution is left on fabric.
5. Most stains can be treated with household fabric stain removers. It is ALWAYS important to test how the solution will react to the fabric. This can be tested by dabbing solution to a small corner of the fabric. Most household cleaners will provide treatment instructions depending on the type of stain.



- Wrinkles can be removed from fabric with a cool iron or steamer.



- Fabric can be machine washed - use cold water, delicate cycle.



- Do NOT bleach fabric



- Do NOT tumble dry. Fabric must be air dried on the frame to prevent shrinking.