

LINEAR PRO 10X20 KIT 26

Linear Pro Modular Backwall Kit 26 provides a modern, slick and stylish appearance. The extrusion based inline exhibit features Velcro applied fabric center graphics, UV printed headers and wings, as well as two pillowcase fabric canopies. Four tables provide additional space for products or messaging and are available in four color options. Four 50 watt spotlights provide illumination to messaging. Kit includes four OCH shipping cases.

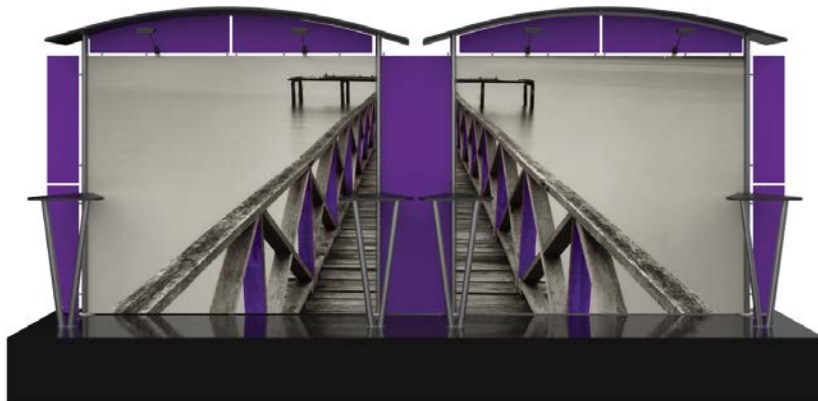

We are continually improving and modifying our product range and reserve the right to vary the specifications without prior notice. All dimensions and weights quoted are approximate and we accept no responsibility for variance. E&OE. See Graphic Templates for graphic bleed specifications.

12/16/2020

FEATURES & BENEFITS

- Custom appearance. Easy to assemble
- Velcro fastener-applied fabric center graphic
- PVC graphic wings and headers
- Pillowcase C-shaped fabric canopy
- Installation tool included
- Aluminum construction: vertical extrusions 75 mm x 50 mm
- Tabletops available in four color options
- Kit includes four OCH cases, four v-leg tables, and four LED spotlights
- Lifetime hardware warranty against manufacturer defects

DIMENSIONS

Assembled unit:
240"w x 99.1"h x 30.6"d

4 OCH Cases:
52"w x 29"h x 12"d

GRAPHICS

Main Panel:
Dye sublimated fabric graphic

Headers & Wings:
printed PVC

Canopy:
Solid silver, black, white fabric or custom printed dye sublimated fabric graphic

Refer to related graphic template for more information.

Visit:
<https://tradeshowplus.com>

SHIPPING

Hardware ships in 4 boxes:
52"w x 29"h x 12"d each

Shipping Weight:
275 lbs

ADDITIONAL INFO

Countertop: can support max of 25 lbs each

Counter colors:



silver



black



mahogany



natural

Have a Question?

Please contact support@tradeshowplus.com



KIT INCLUDES

Have a Question?

Please contact support@tradeshowplus.com

Parts Included		
Part Label	Qty	Part Description
LN-FS-UPRIGHT	x4	LN-FS-UPRIGHT - LINEAR UPRIGHT WITH FOOT
PH-1168-L-L	x8	1168MM (46") LENGTH OF PH EXTRUSION WITH CAM LOCK BOTH SIDES
PH-1067-L1	x4	1067MM (42") PH LOCK HOLE ONE SIDE
PH-567-L-L	x2	567MM PH WITH LOCK ONE END & CAP
LN-ADJ-FT	x2	LINEAR ADJUSTING FOOT
IB2	x2	INLINE BRACKET
PM30-1067	x4	1067MM (42") PM30 OPEN ENDS
LN605-EN	x2	PH END CAP
WME-1000	x12	1000MM (39.375") WIRE MANAGEMENT EXTRUSION W/ hook and loop fastener
LN-10X10-FG	x2	LINEAR 10X10 FABRIC CENTER GRAPHIC
LN-26-HW-A-G	x1	LINEAR KIT 26 HEADER/WING GRAPHIC A
LN-26-HW-B-G	x1	LINEAR KIT 26 HEADER/WING GRAPHIC B
LN-26-HW-C-G	x1	LINEAR KIT 26 HEADER/WING GRAPHIC C
LN-26-HW-D-G	x1	LINEAR KIT 26 HEADER/WING GRAPHIC D
LN-26-HW-E-G	x1	LINEAR KIT 26 HEADER/WING GRAPHIC E
LN-26-HW-F-G	x1	LINEAR KIT 26 HEADER/WING GRAPHIC F
LN-26-HW-E-G	x1	LINEAR KIT 26 HEADER/WING GRAPHIC G
LN-26-HW-F-G	x1	LINEAR KIT 26 HEADER/WING GRAPHIC H
LN-CAN-K-C	x2	LINEAR CANOPY KIT, C-SHAPE
LN-TBL-V-LEG-STD	x2	LINEAR V-LEG STANDARD TABLE TOP *FINISH MAY VARY
LN-TBL-V-LEG-TRI	x2	LINEAR V-LEG TRIANGLE TABLE TOP *FINISH MAY VARY
PANEL CLAMP	x20	PANEL CLAMP
PHFC2-150-L	x4	150MM PHFC2 W/ONE LOCK
LUM-LED-ORL-7	x4	LUMINA LED LIGHT
HEX KEY SET	x2	ALLEN KEY MULTI-TOOL (HEX KEY TOOL)

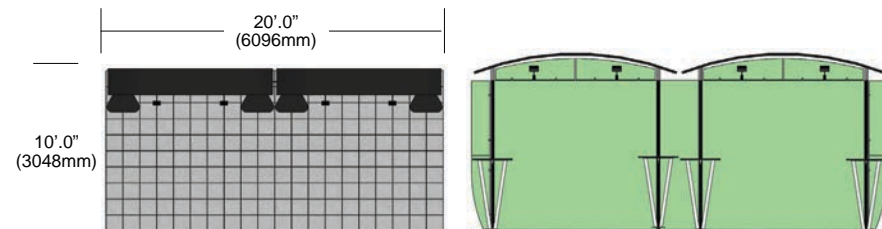
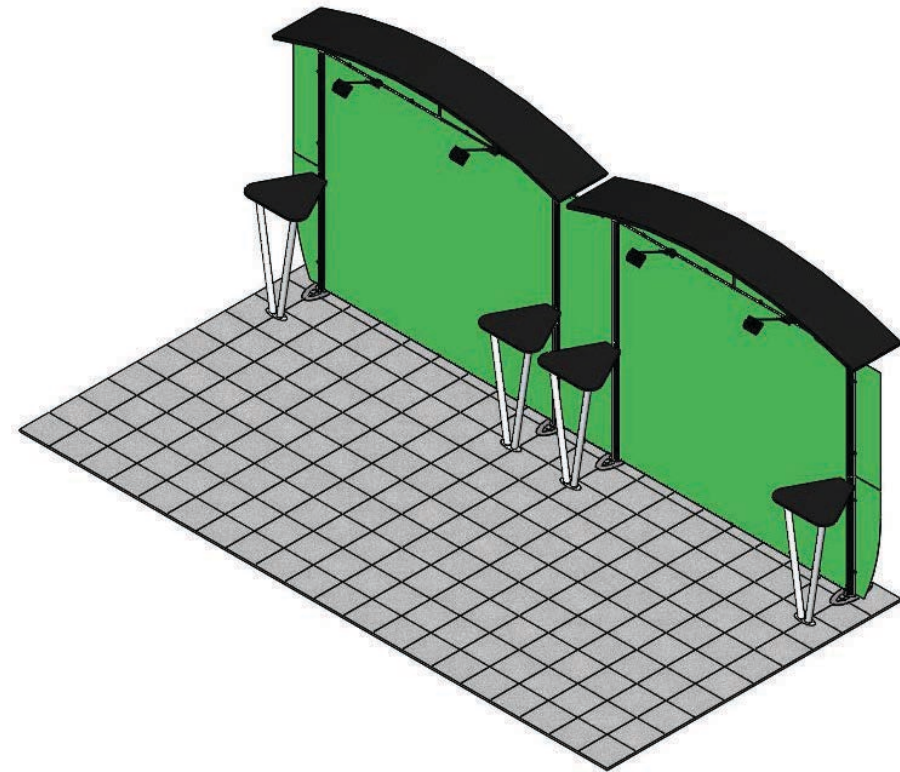

ASSEMBLY

Have a Question?

Please contact support@tradeshowplus.com

Step 1. Assemble the bottom of the frame

Using the 5MM HEX KEY, attach each PH-1168-L-L and both sides of the PH-567-L-L to the LN-FS-UPRIGHT's with the hook and loop fastener facing front. Attach the opposite ends of the PH-1168-L-Ls to the PH-1067-L1 uprights using the 5MM HEX KEY. Once all are attached, use the 5MM HEX KEY to depress the IB2 lower button and insert into the top of the PH-1067-L1s, DO NOT LOCK.

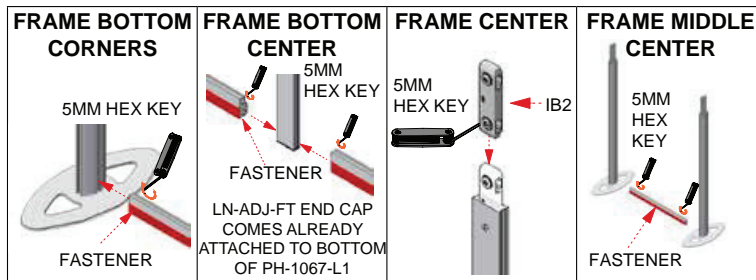
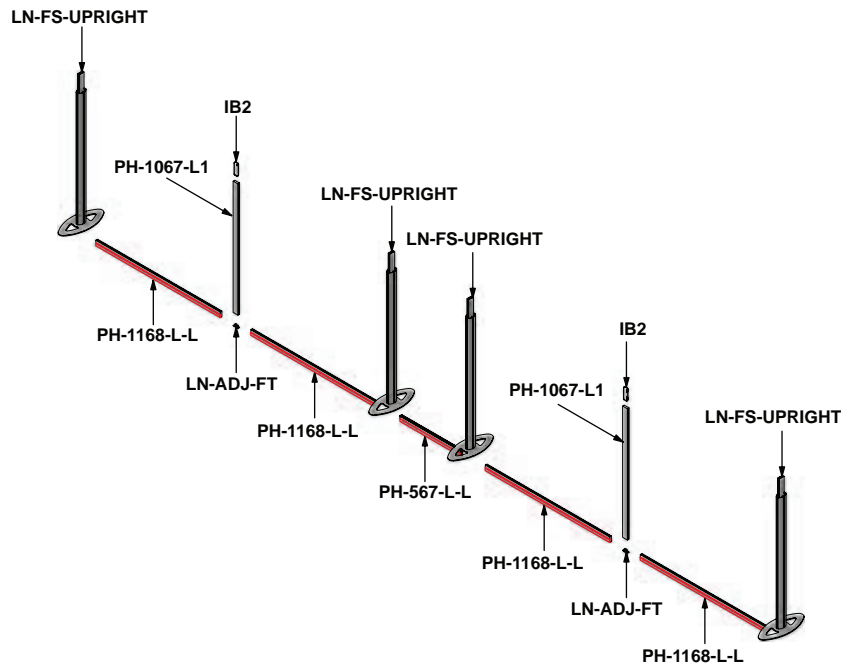

Step 2. Assemble the top of the frame

Make sure the hook and loop fastener is facing towards the front and slide the left and right PM3O-1067s onto the LN-FS-UPRIGHT on the left and right ends of the frame. Push in the lock button to slide and attach the two PH-1067-L1s to the IB2s below, then lock both buttons. Attach PH-1168-L-Ls and the PH-567-L-L to the PM3O-1067s and PH-1067-L1s using the 5MM HEX KEY.

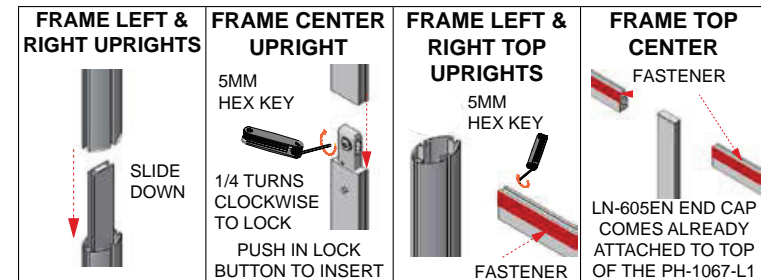
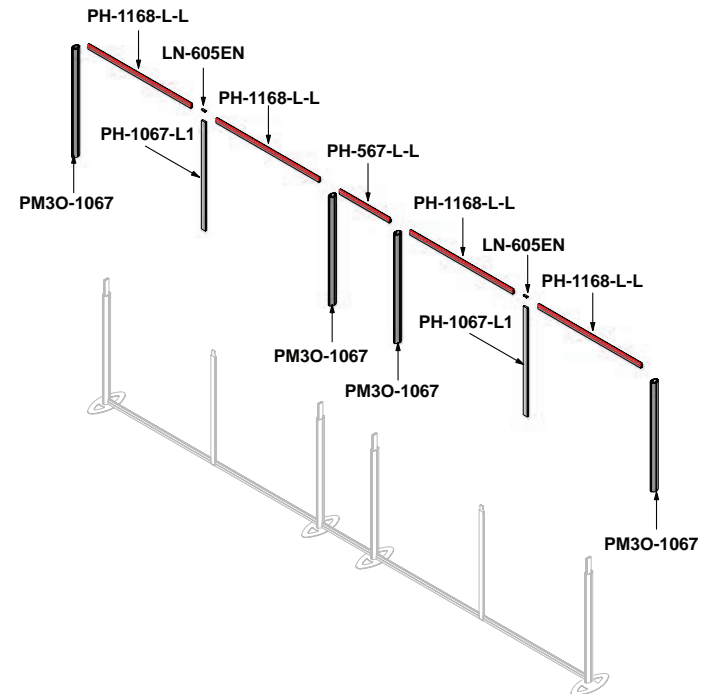

ASSEMBLY

Have a Question?

Please contact support@tradeshowplus.com

Step 3. Attach graphic support & adhere PANEL CLAMP for graphic headers/wings

Snap attach the WME-1000 (graphic support) onto the frame inside the left and right uprights of the left, center, and right frame sections. Make sure the hook and loop fastener is facing towards the front. Insert the 20 PANEL CLAMP into the outside perimeter channels and turn clockwise to lock, other locking screws should be loose. Evenly space out the standoffs for each header or wing.

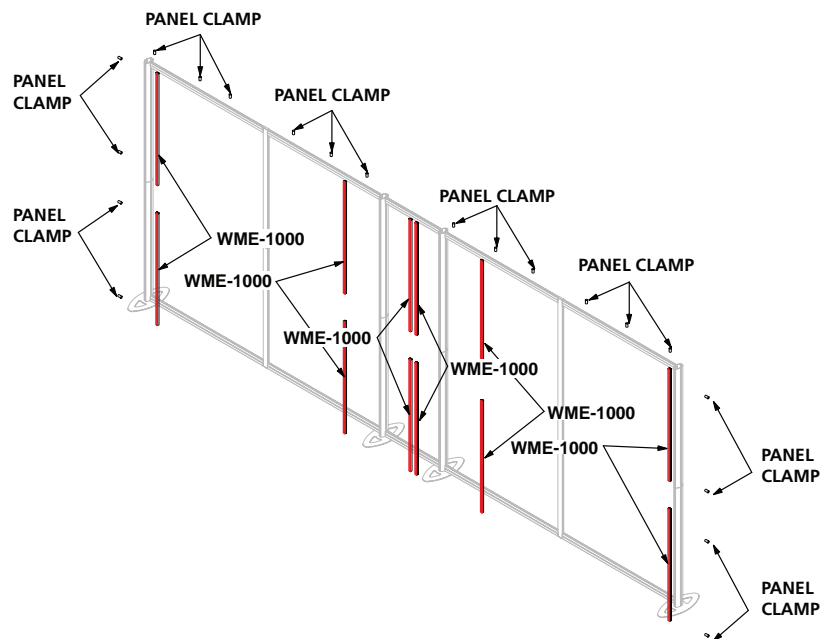

PVC EXTRUSION PVC EXTRUSION

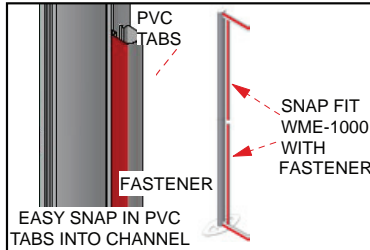

PANEL CLAMP ATTACHMENT

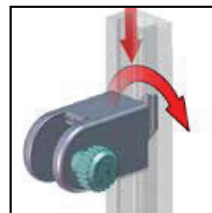

Step 4. Attach graphic headers/wings, right and left graphic, and center graphic
Screw the PANEL CLAMP clockwise into channel until it is tight. Loosen the THUMBSCREW, place rigid sintra panel graphic and tighten in place. hook and loop fastener attach the LN-10X10-FG (left & right large fabric graphics) and the LN-C-FG (center fabric graphic) to the frame starting at the top left corner. Continue to hook and loop fastener attach the graphics to the frame ending in the bottom right corner.

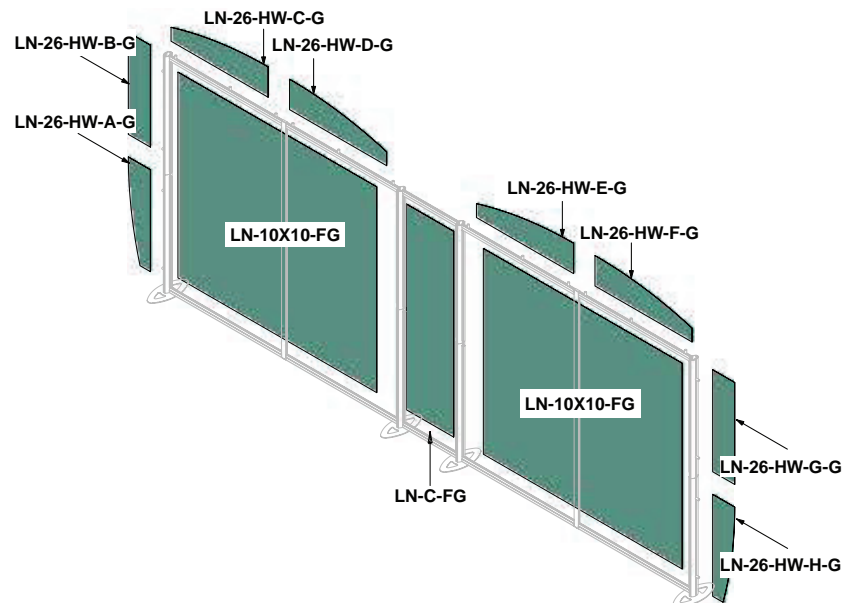

HEADER/WING ATTACHMENT

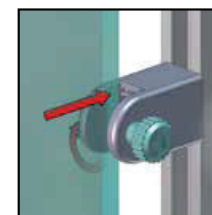

FABRIC PANEL TOP LEFT

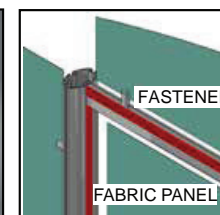

ASSEMBLY

Have a Question?

Please contact support@tradeshowplus.com

Step 5. Attach c-shaped canopies

Assemble each frame in order using the number key to attach the tubes and hubs. Pull over the pillowcase and insert the screws through frame parts 1, 7, and the pillowcase slots. Loosely fasten canopy post mounts to screws, DO NOT ZIPPER. Last, slide the post mounts onto the frame and tighten using the 8MM HEX KEY, then zipper the pillowcase. Repeat for the second canopy.

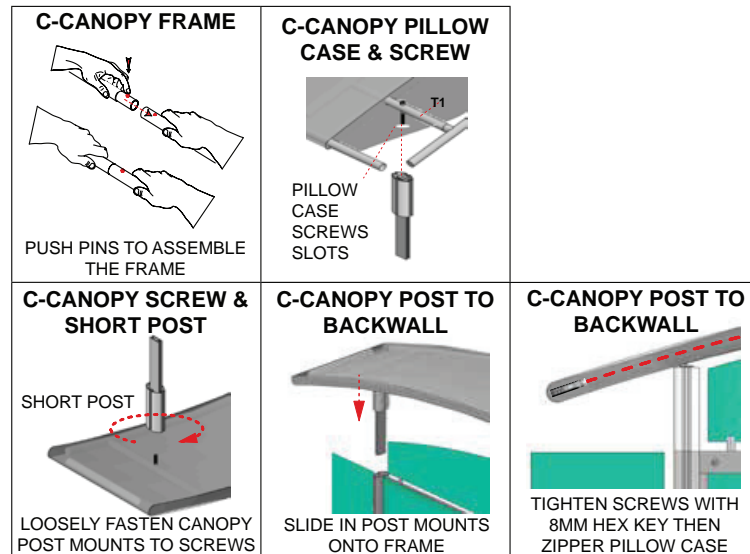
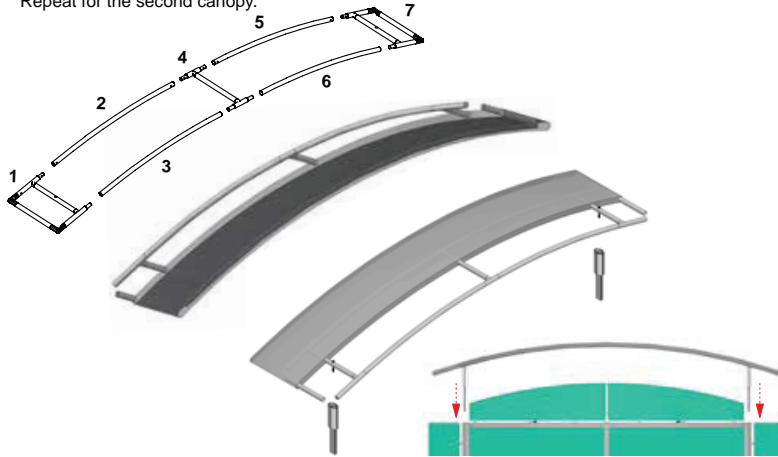

Step 6. Assemble lights & tables & attach to backwall

Slide the light fixture LUM-LED-ORL-7 onto the light clip. Lift and rest light clip onto top of horizontal channel and run the wires in between and behind the panels. Slide the PHFC2-150-L into the underside of the table. Fasten the table legs to the underside of the table top using the THUMB SCREWS. Once finished turn table over and attach it to the backwall frame (LN-FS-UPRIGHT) using the 5MM HEX KEY on the PHFC2-150-L. Repeat for all of the other table.

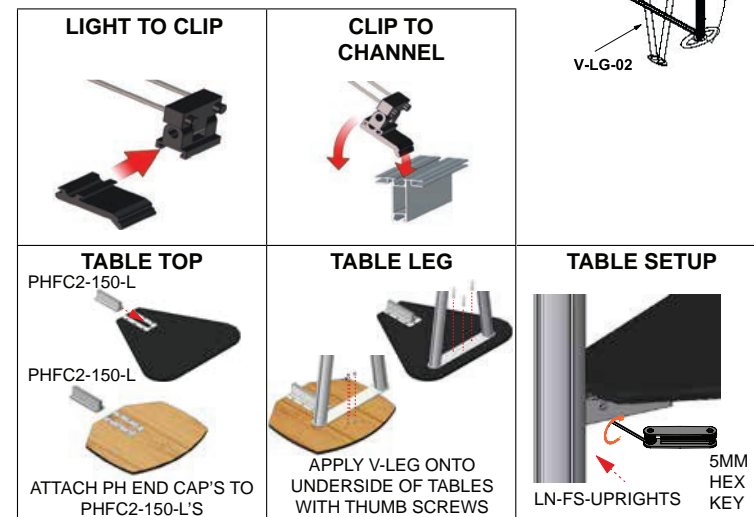
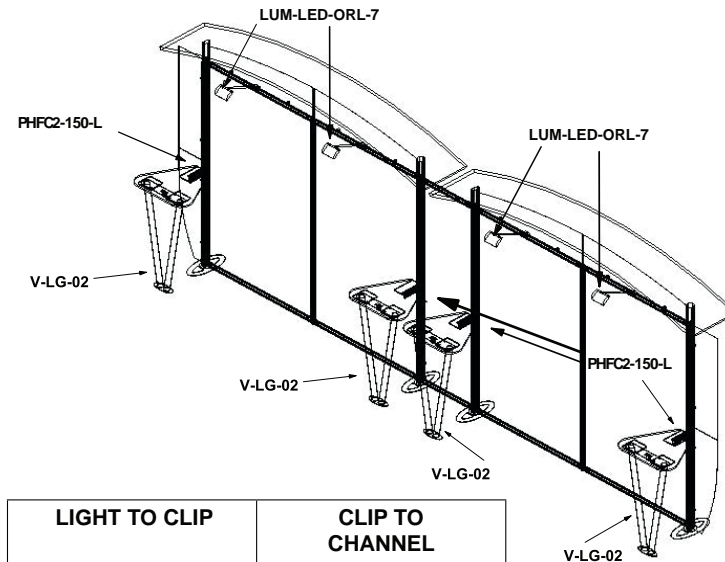

LINEAR DISPLAY LINE

Have a Question?

Please contact support@tradeshowplus.com



Linear Pro Kit 22

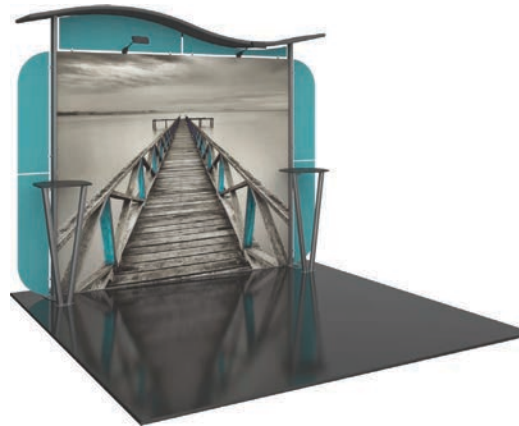

Linear Pro Kit 25



Linear Pro Kit 26



Linear Pro Kit 27