

# Formulate Essential 8ft Straight Display

The Formulate® Essential 8ft Straight Fabric Display provides an affordable, economy option for your portable display needs. The durable frame goes together easily because it features bungee-corded aluminum tubes. The frame matches perfectly with zip up pillowcase graphics, which are custom made to reflect your branding and messaging. Shipping and transportation is made easy with an included canvas carry bag.



## features and benefits:

- Economy aluminum tube frame features bungee cords and rounded corners
- Easy to store and ship
- Quick to set up
- Kit includes: one frame, pillowcase zipper fabric graphic and canvas carry bag
- One year limited hardware warranty against manufacturer defects

## dimensions:

Hardware	Graphic
<p>Assembled unit: 99.75" w x 92.5" h x 13.75" d 2533.65mm(w) x 2349.5mm(h) x 349.5mm(d)</p> <p>Approximate weight (includes graphic): 20.55 lbs / 9.3 kgs</p>	<p>Total visual area: 97" w x 90.5" h 2299mm(w) x 2464mm(h)</p> <p>Please be sure to include a 2" bleed around the perimeter.</p> <p>Refer to related graphic template for more information.</p>
<p>Shipping</p> <p>Shipping dimensions: 37.2" l x 10.4" w x 8.5" h 945mm(l) x 265mm(w) x 215mm(h)</p> <p>Approximate shipping weight: 22.05 lbs / 10 kgs</p>	<p>Visit: <a href="http://www.tradeshowplus.com">www.tradeshowplus.com</a></p>

## additional information:

Graphic material:  
dye-sublimation zipper pillowcase fabric

We are continually improving and modifying our product range and reserve the right to vary the specifications without prior notice. All dimensions and weights quoted are approximate and we accept no responsibility for variance. E&OE. See Graphic Templates for graphic bleed specifications.



## STEP 1: ASSEMBLE FRAME

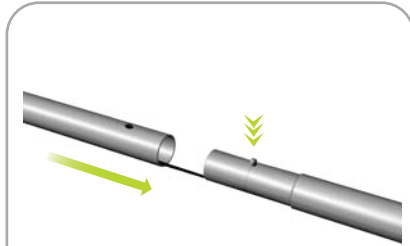

Connect bungee tubes by lining up holes with snap buttons

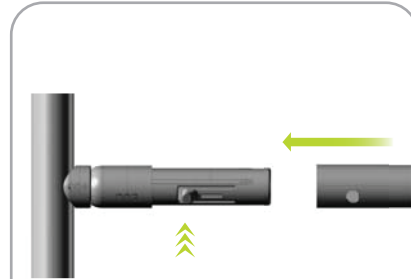

Connect bungee tubes by lining up holes with snap buttons

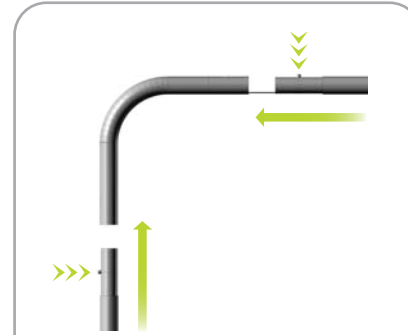

Connect corners of frame by lining up holes with snap buttons



Place the center stability pole in the holes at the top and bottom

## STEP 2: ATTACH FEET

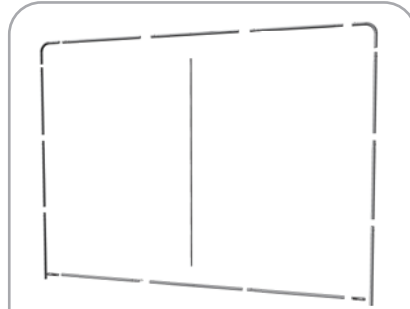

Frame assembly is complete once all sides are connected



Connect frame to feet by lining up holes with snap button on feet

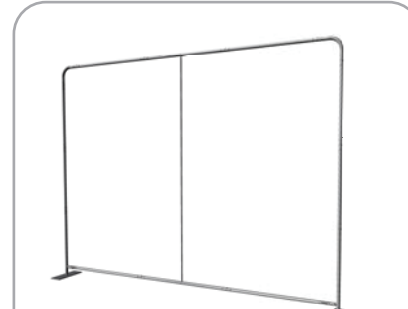

Complete the entire frame assembly

## STEP 3: ATTACH GRAPHIC

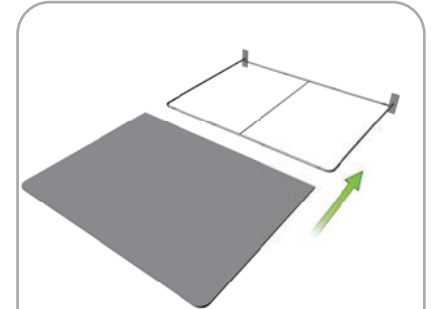

Slide graphic over top of frame

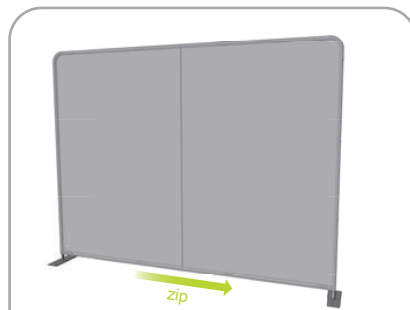

Zip graphic closed along bottom of frame