

Select the model :

1. Make sure the backlight is OFF. Press the 2 and 8 keys at the same time.
2. Hold the buttons for about 10 seconds until the backlight flashes twice.
3. Enter the model number 1-4 to be selected to select the desired function, as shown in the table below.
4. If other error values are entered, the LED flashes 3 times.

1	GDR21-purple
2	GDR26-red
3	GDR31-green
4	GDR36-yellow

Setting a PIN:

5. Locate the learn button on the back of the opener hanging in your garage.
6. Press and release the learn button (the next step must be completed within 30 seconds of releasing the learn button)

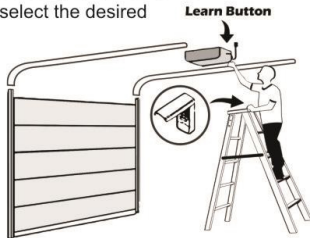

7. Enter a unique 4 digit PIN on the keypad then press and hold ENTER on the keypad
8. Hold the ENTER button until the lights flash on the opener or you hear two "clicks".
9. The PIN is now set. Test operation.

Operation:

1. Open – Enter 4 digit PIN then press ENTER on the keypad
2. Close – Press the ENTER button twice (Do not enter PIN to close)

⚠ WARNING

In order to prevent possible **SERIOUS INJURY or DEATH** from a moving gate or garage door:

- keep remote controls out of the reach of children.
- Only use the remote control when the gate/garage door can be seen clearly, is properly adjusted, and there are no obstructions to door travel.
- Keep the gate/garage door in sight until it is completely closed. Do not allow anyone to cross paths with the gate/garage door while moving or operating the remote control.