

**EMMO**

GREEN YOUR LIFE

# USER'S MANUAL



**EMMO**  
**Monta**

# CAUTIONS

**This manual contains important safety, performance and service information. Read and understand it along with the information provided during the on-delivery instructions before using the product, and keep it for reference.**

EMMO

© 2019 Emmo Inc. All rights reserved. No texts, details, or illustrations from this Manual may be reproduced or distributed, or become the subject of unauthorized use for commercial purposes. Should you discover any errors, we would be grateful if you would bring them to our attention.

# MENU

<b>About EMMO</b>	<b>4</b>
<b>Rules and Regulations of Riding an E-Bike</b>	<b>5</b>
<b>Parts Overview</b>	<b>6</b>
<b>Speedometer and control buttons</b>	<b>8</b>
<i>turn on/off</i>	<b>10</b>
<i>pedal assist level</i>	<b>12</b>
<i>general settings</i>	<b>15</b>
<b>Gear Shifter</b>	<b>18</b>
<b>Thumb Throttle</b>	<b>19</b>
<b>Safety Instructions</b>	<b>20</b>
<b>How to ride</b>	<b>21</b>
<b>How to charge</b>	<b>22</b>
<b>How to remove the battery</b>	<b>24</b>
<b>How to adjust the brakes</b>	<b>26</b>
<b>Maintenance</b>	<b>27</b>
<b>Error Code</b>	<b>28</b>
<b>E-Bike Registration Form</b>	<b>29</b>

# ABOUT EMMO

*Established in 2009, Emmo Inc. is a proud Canadian venture that is focused on creating a more sustainable future by providing high quality electric bicycles. We offer a wide variety of E-bikes that are suitable for leading a greener, and more stylish, way of living. Emmo E-bikes are priced competitively with other green solutions. At Emmo, you will get the best e-bikes and also receive the best service.*



GREEN YOUR LIFE

# RULES and REGULATIONS

## of riding an e-bike

According to Canada's Motor Vehicle Safety Regulations ( *MVSR* ). A qualified e-bike (defined as Power Assist Bicycle) must meet the following requirements:

- ***The e-bike must have operable pedals***
- ***Upper wattage limit for the motor is 500W.***
- ***Maximum speed of an e-bike is 32km/h.***

Other requirements include a permanently affixed compliance label from the manufacturer stating that the vehicle is a power-assisted bicycle under statutory requirements in force at the time of manufacture. Currently, there is no license, no insurance, and no vehicle registration required to operate a qualified e-bike according to federal legislation. E-Bike riders share the same rights and responsibilities as other road users.

However, provinces and local municipalities have the power to restrict the use of e-bikes. Most provinces require the rider to wear a helmet. Some provinces have special requirements with regard to the age limit to operate an e-bike, the type of helmet required, even the number of wheels and wheel size. In Ontario, typically, e-bikes are generally treated the same as regular bicycles. According to the Ministry of Transportation of Ontario (MTO), the age limit to operate an e-bike is 16 years old and above; the maximum weight of the bike is 120 kilograms (265 pounds); the bike must have a brake distance of less than 9 meters; Any modifications made to the bike's motor to create speeds greater than 32km/h are prohibited.

As the rules and regulations are subject to changes in different provinces and municipalities. Please check your municipal bylaw and see where you stand.

# 1. PARTS OVERVIEW

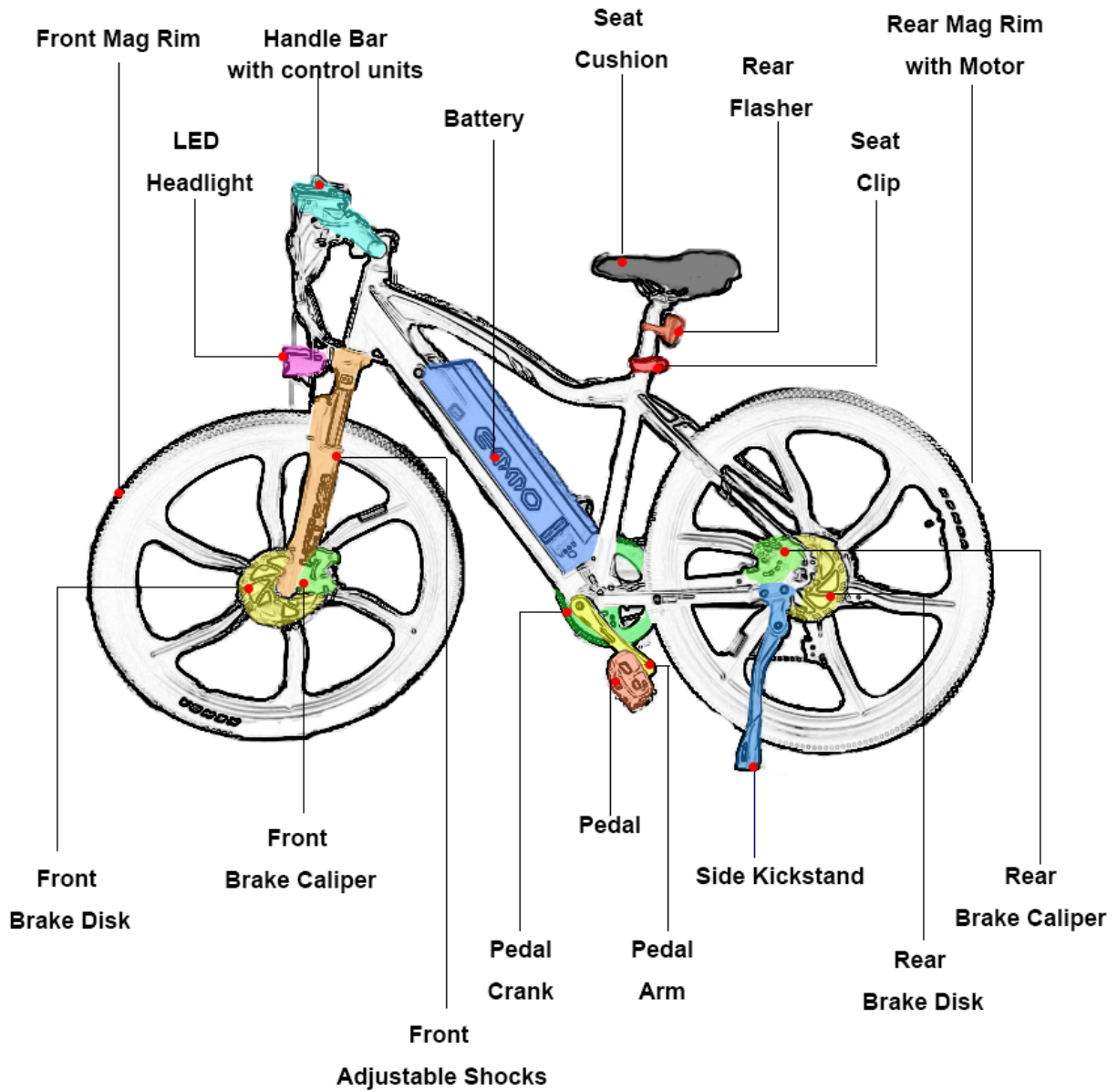

# 1. PARTS OVERVIEW

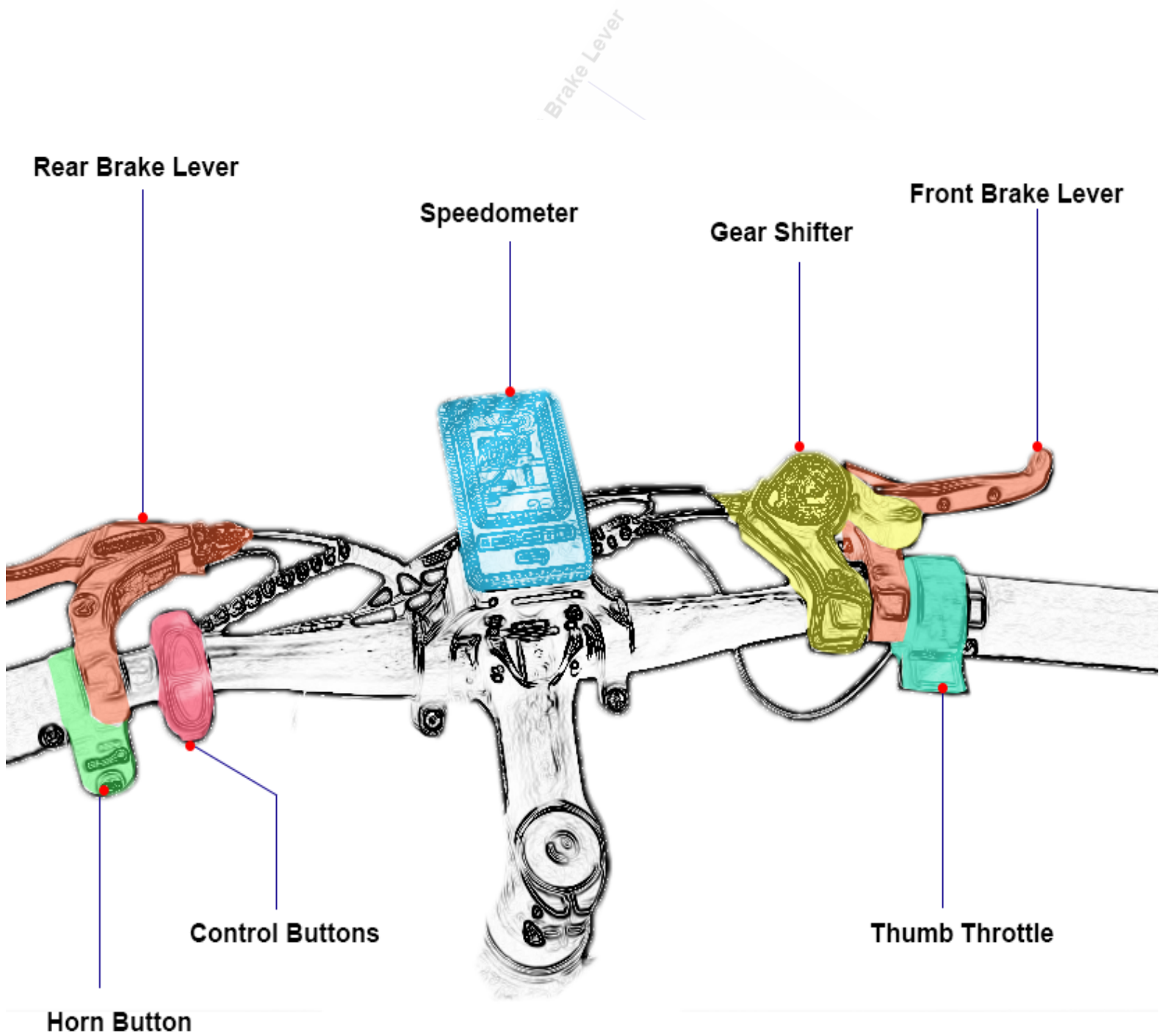

# 2. SPEEDOMETER & CONTROL

## General Description

### Function Summary

In addition to changing some settings of the bike, the following information can be displayed by the speedometer.

- **Battery Strength Indicator**
- **Motor Power Indicator**
- **Speeds (Current Speed, Maximum Speed and Average Speed)**
- **Odometer (Total Travel Distance)**
- **Trip Distance/Time**
- **Pedal-Assist Level**
- **Back Light & Headlight On/Off**
- **Error Code**



Display Interface



# 2. SPEEDOMETER & CONTROL

## Definition of Buttons

There are 3 buttons on the bike. They are defined as below.

- M** is defined as "MODE"
- +** is defined as "UP".
- is defined as "DOWN".

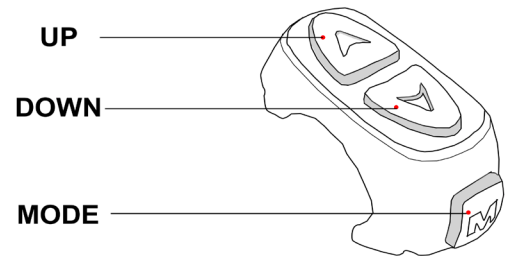

## Cautions:



Avoid any collision.



Changing the manufacturer setting may affect or completely void the warranty provided by the manufacturer. Please consult your Emmo Dealer for more details.



Please have your bike repaired once you find a problem.

# 2. SPEEDOMETER & CONTROL

## On/Off

To start, hold the **MODE** button, you will be able to turn on the speedometer and the power supply of the whole bike. When on, hold the **MODE** button, you can turn off the bike and the speedometer.



The speedometer will shut off automatically if the bike is not used for **10** minutes.

## Information displayed

Once started, current speed is displayed by default setting. To change the speed type, please hold the **MODE** and **DOWN** simultaneously. You will be able to switch to maximum speed and average speed.

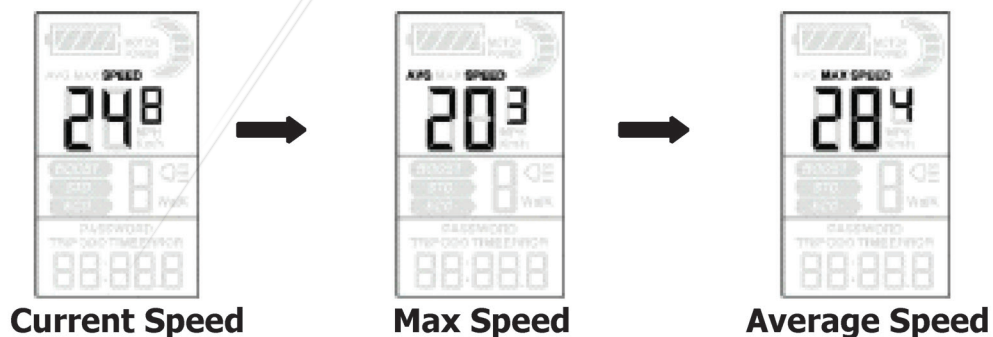

# 2. SPEEDOMETER & CONTROL

Once started, trip distance is displayed by default setting. To change the information displayed, please press the **MODE** button. You will be able to switch the information to odometer and trip time.

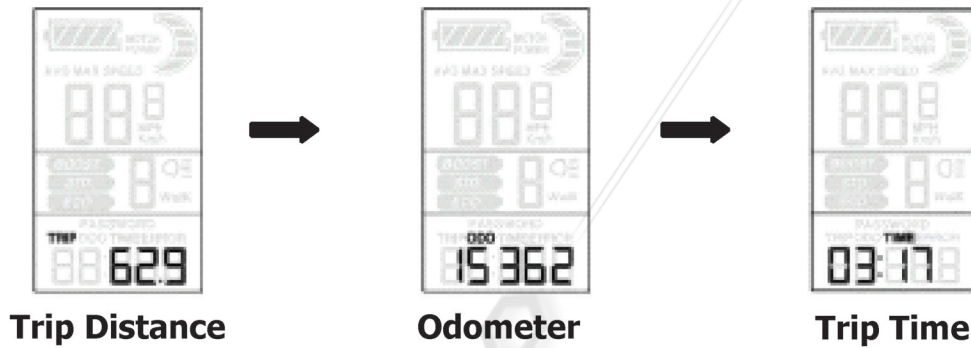

## Walking Mode

Hold the **DOWN** button for about 2 seconds. You will turn on the walking mode. The bike will proceed at about 6km/h.



# 2. SPEEDOMETER & CONTROL

## Screen Back Light and Headlight

Hold the **UP** button for about 2 seconds, you will be able to turn on the back light of the screen and the headlight. To turn them off, hold the **UP** button again.

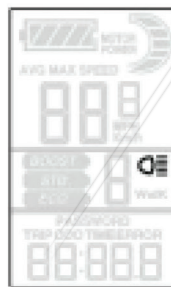

**Headlight indicator**

## Pedal Assist Level

Press the **UP** button or **DOWN** button, you can switch the pedal assist level between 0 to 5.



**Pedal Assist Level**

# 2. SPEEDOMETER & CONTROL

## Battery Strength Indicator

The 5 bars represent the battery strength. It is suggested that you charge the battery when it is lower than 20%-30%. If the battery level is extremely low, the battery frame will flash. You must charge the battery immediately to prevent possible damage to the battery.

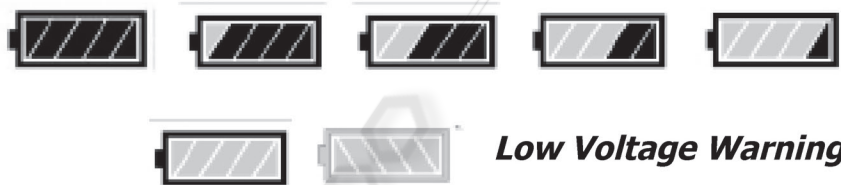

**Battery Indicator**

## Motor Output Power

Motor power is showed as below:



# 2. SPEEDOMETER & CONTROL

## Error Code

The Error Code will appear automatically when a problem is detected. Please refer to Table 1 in the appendix for more details on Error Codes.



**Error Code**



**Please have the bike repaired as soon as possible.**

# 2. SPEEDOMETER & CONTROL

## General Settings

Hold the **MODE** button to turn on the bike. While on, hold the **UP** and **DOWN** buttons simultaneously for about 2 seconds to enter the general setting menu.

- **Reset Trip Distance and Trip Time**

TC stands for Trip Distance Clearance. Press the **UP/DOWN** to choose yes (clear it) or no (keep it).

Hold the **MODE** button to exist and return to the main page. Or Press the **MODE** button to confirm the selection and you will be able to go to the next setting.



**Trip distance and trip time will be cleared at the same time.**



**Reset Trip Information**

# 2. SPEEDOMETER & CONTROL

- **Back Light Brightness**

BL means backlight. There are 3 levels of brightness for you to choose. Level 1 is the lowest brightness, while Level 3 is the highest. The default brightness is Level 1. By pressing **UP/DOWN**, you can change the back light brightness. Press the **MODE** button to confirm the selection and go to the next setting.



**Back Light Brightness**

- **Wheel Size**

Press **UP** or **DOWN** to choose the wheel diameter for a more accurate calculation of speed and travel distance. You will be able to select from 16 inches, 18 inches, 20 inches, 22 inches, 22 inches, 24 inches, 26 inches, 700C, and 28 inches. 26 inches would be set by default.

Press the **MODE** button to confirm the selection and go to the next setting.



## 2. SPEEDOMETER & CONTROL



Wheel Size Setting

- **Maximum Speed Setting**

When the running speed exceeds the set maximum speed, the controller will cut off the motor power. You can use **UP** or **DOWN** to adjust the top speed between 12 km/h to 40 km/h. Default speed limit is 32 km/h.

press the **MODE** button to confirm the selection and go to the next setting.



**For off-road use only, changing the maximum speed may affect or completely void the manufacturer warranty of the bike. Please consult you Emmo Dealer for more details.**

- **Unit**

You can use **UP** or **DOWN** to change the unit between km/h and MPH.

press the **MODE** button to confirm the selection and go to the next setting.

# 3.GEAR SHIFTER

Pushing the upper lever to raise the gear lever (smaller numbers).

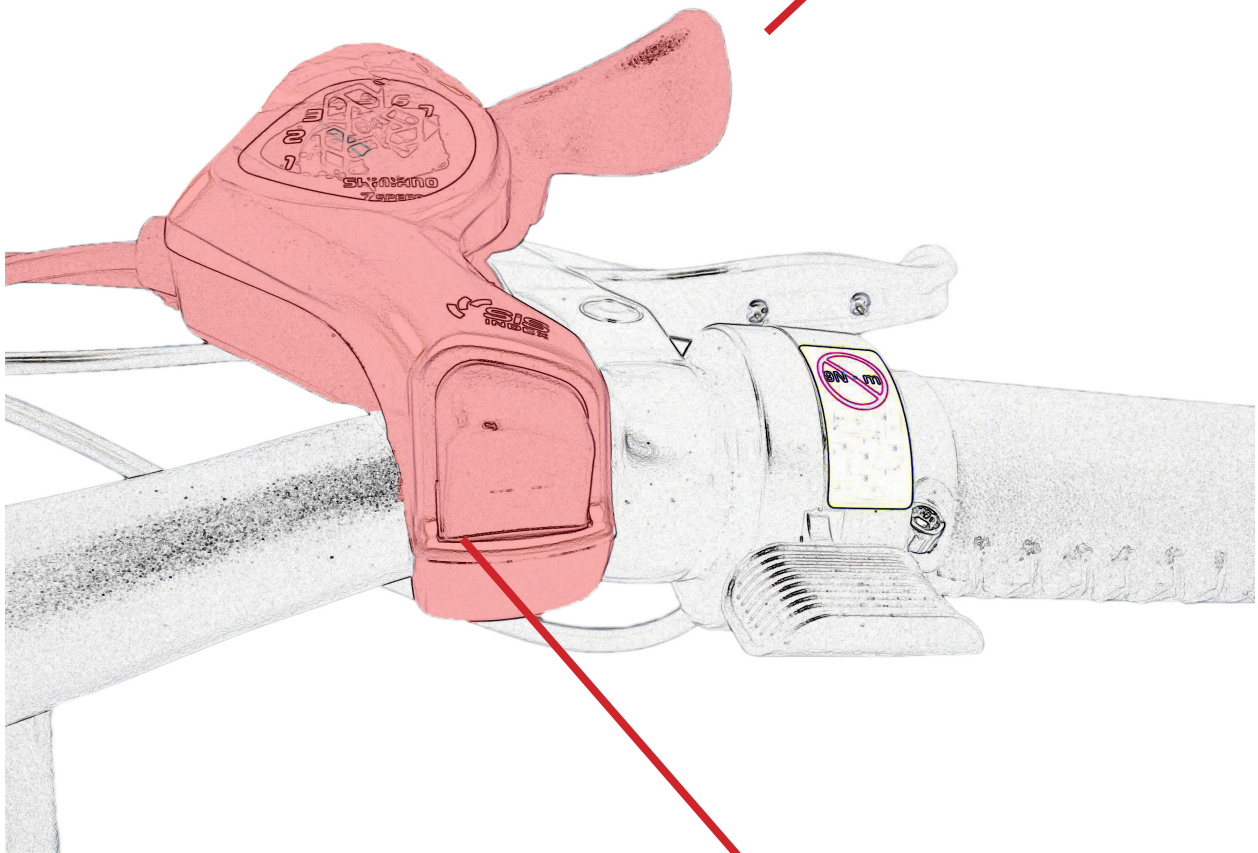

Pushing the button to lower the gear lever (bigger numbers).

# 4. THUMB THROTTLE

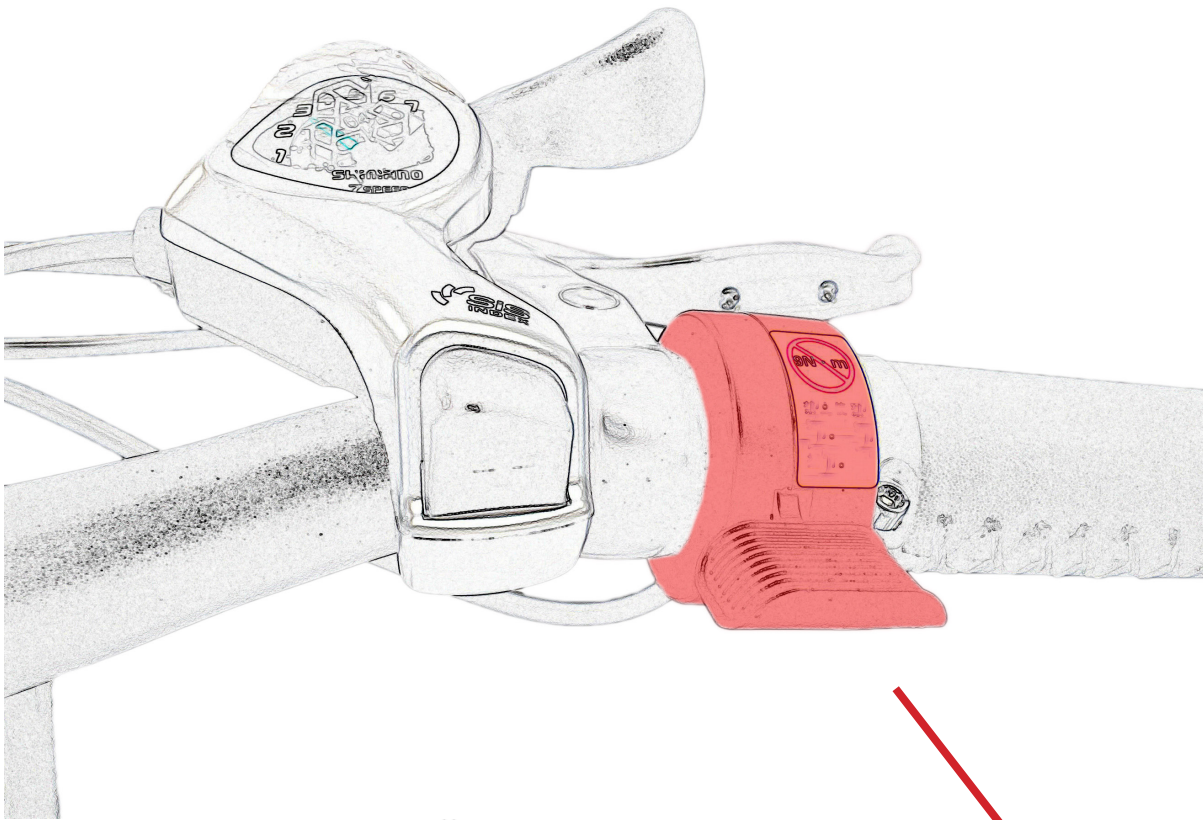

Gently pushing the throttle lever downwards to accelerate.

# 5. SAFETY INSTRUCTIONS

To ensure the safety of you and others,

- Do not ride after you take medications which may affect your riding ability, drink alcohol, or when you are unwell.
- Please make sure you are familiar with your local bylaw regarding e-bikes.
- Check the road conditions and weather conditions, so as to actively avoid danger.
- Wear necessary protective equipment, such as an helmet, if required by local bylaw.
- Perform a basic inspection of the bike before the ride:

**1. Battery strength:** make sure that you have enough charge for the trip.

**2. Tire pressure:** on the casing side of the tire you will find the minimum and maximum pressure that applies to the tire. Insufficient tire pressure will affect the performance of your bike.

**3. Brakes:** check and make sure both brakes are in good working condition.

**4. Lights/signals:** make sure that headlight, signal lights, tail light and brake light are working well. Make sure you have a working rear reflector/tail light if you need to ride the bike at night.

# 6. HOW TO RIDE THE BIKE

- Sit on the bike. Put on the helmet or any protective equipment required.

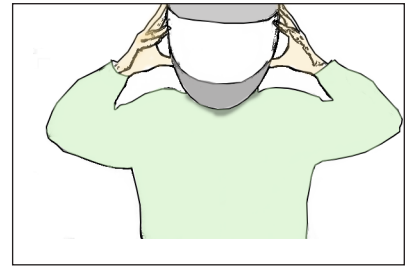

- With your feet still on the floor, turn the bike on (refer to page 10).

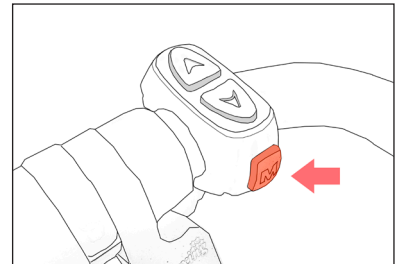

- Before you start off, kick the side kick-stand up.

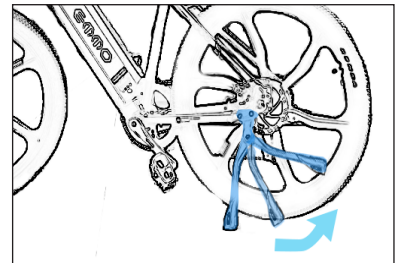

- When you are ready, start pedalling or turn the throttle. (NB: You don't have to pedal to start the bike.)



# 7. HOW TO CHARGE



**The charger is separated into two different parts:**

*1. A cable with one end that goes into a 110V power outlet, and the other end that goes into the charger box itself.*

*2. The charger box with a cable that plugs into the bike.*

**Step 1.** Take the cable from the charger box and plug it into the charging port on the battery.

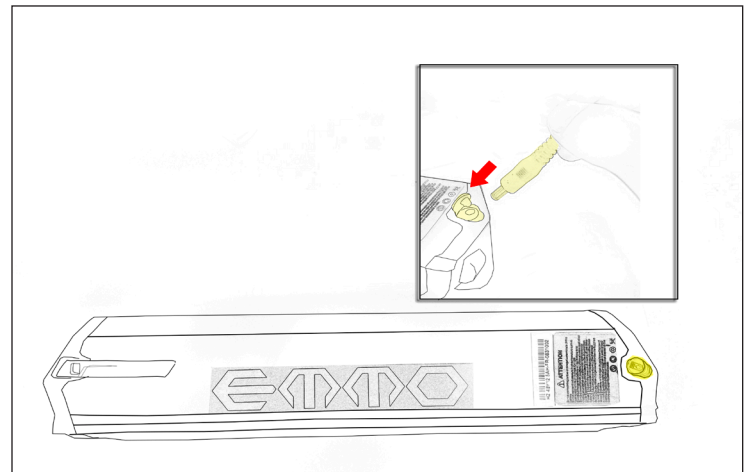

**Step 2.** Plug the the charger into a regular 110V outlet.

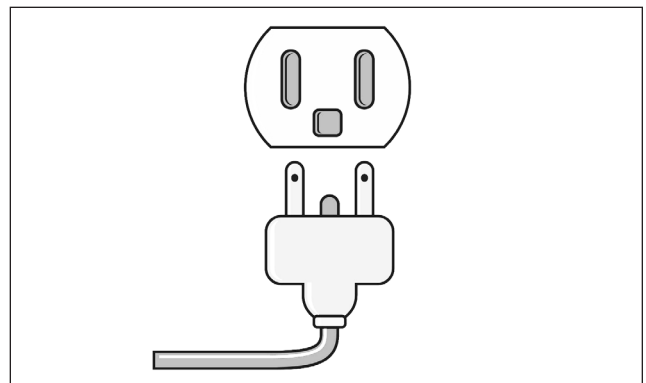

# 7. HOW TO CHARGE

**Step 3.** Make sure the indicator on the charger turns red (red indicator means it is charging, green indicator means the battery is fully charged.)

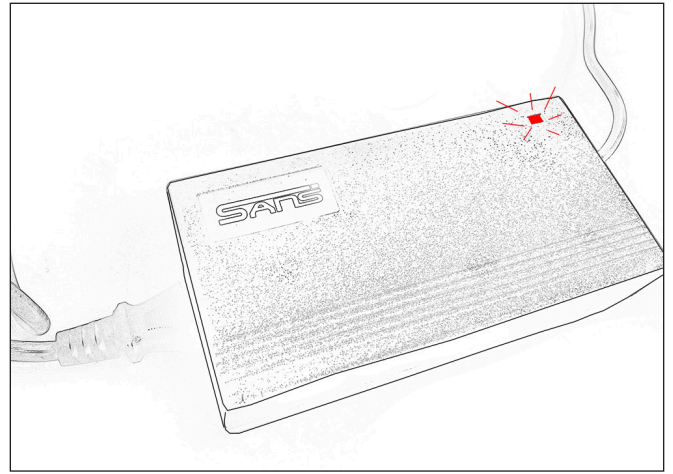

**Step 4.** Once the battery is fully charged, unplug the charger from the power outlet first and then unplug the charger from the battery.

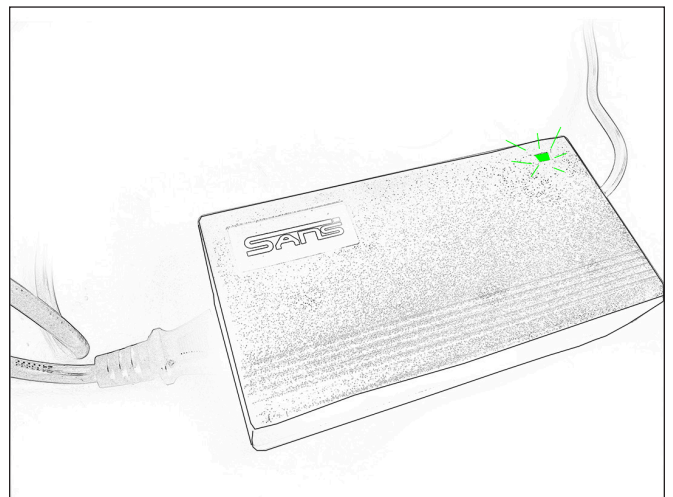

*Warning: Do not charge the battery for more than 8 hours. If you have any concern, please contact your local dealer for assistance.*

# 8. HOW TO REMOVE THE BATTERY

- Plug in the key. Unlock the battery lock.

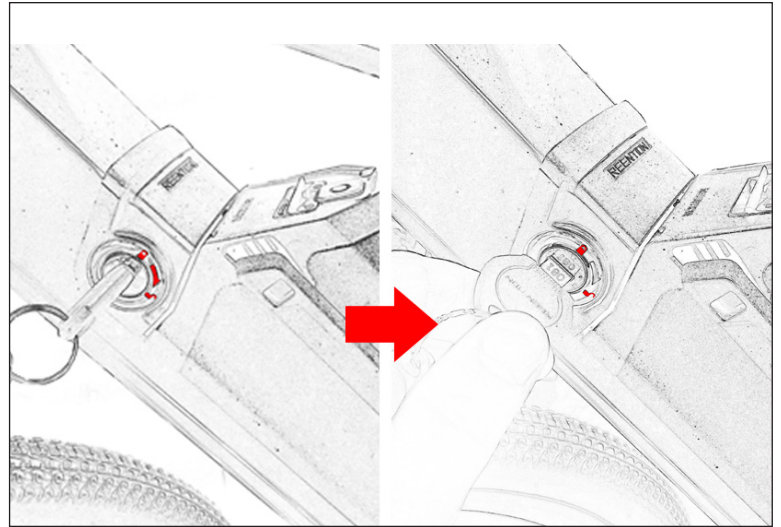

- Keep the battery lock in unlocked position. Pull the lever out and remove the battery from the bike.

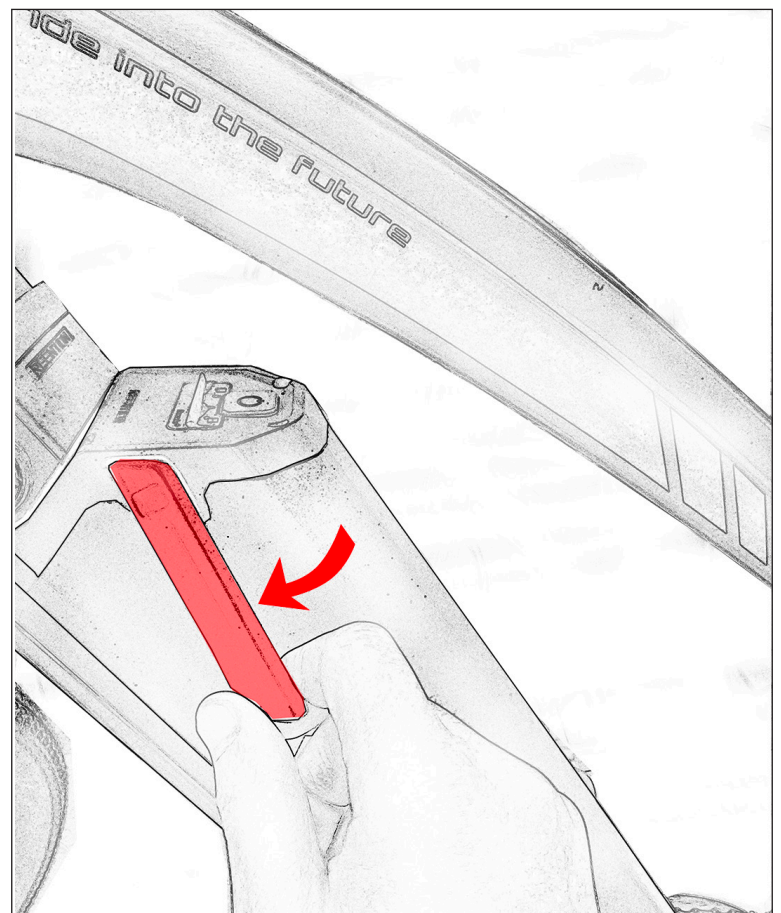



# 8. HOW TO REMOVE THE BATTERY

- Remove the battery carefully.

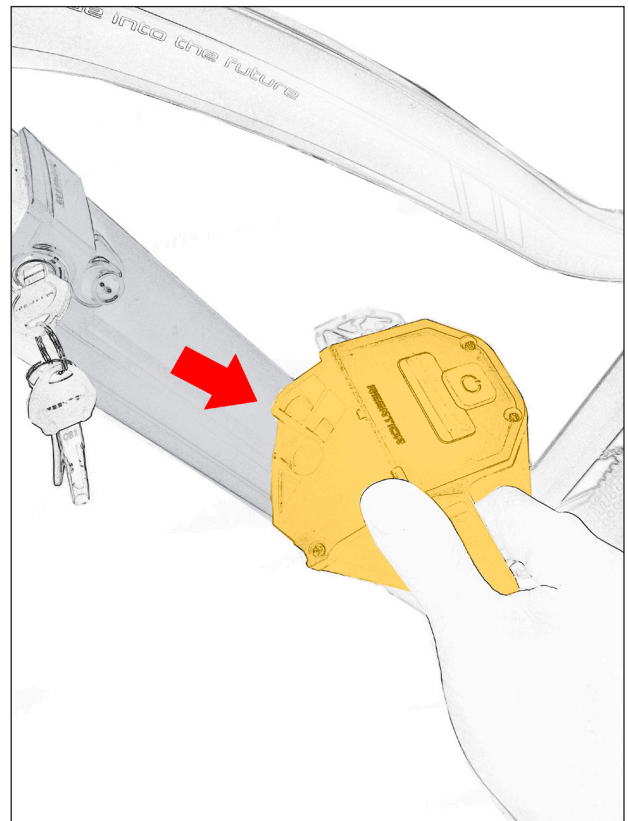

## **TIP:**

If you want to put the battery back to the bike, make sure the bottom tooth on the battery goes into the notch on the frame.

Pull the lever, keep the battery lock in unlocked position, and gently put the battery onto the frame and lock the battery.

Make sure the battery is locked in place.

# 9. HOW TO ADJUST THE BRAKE

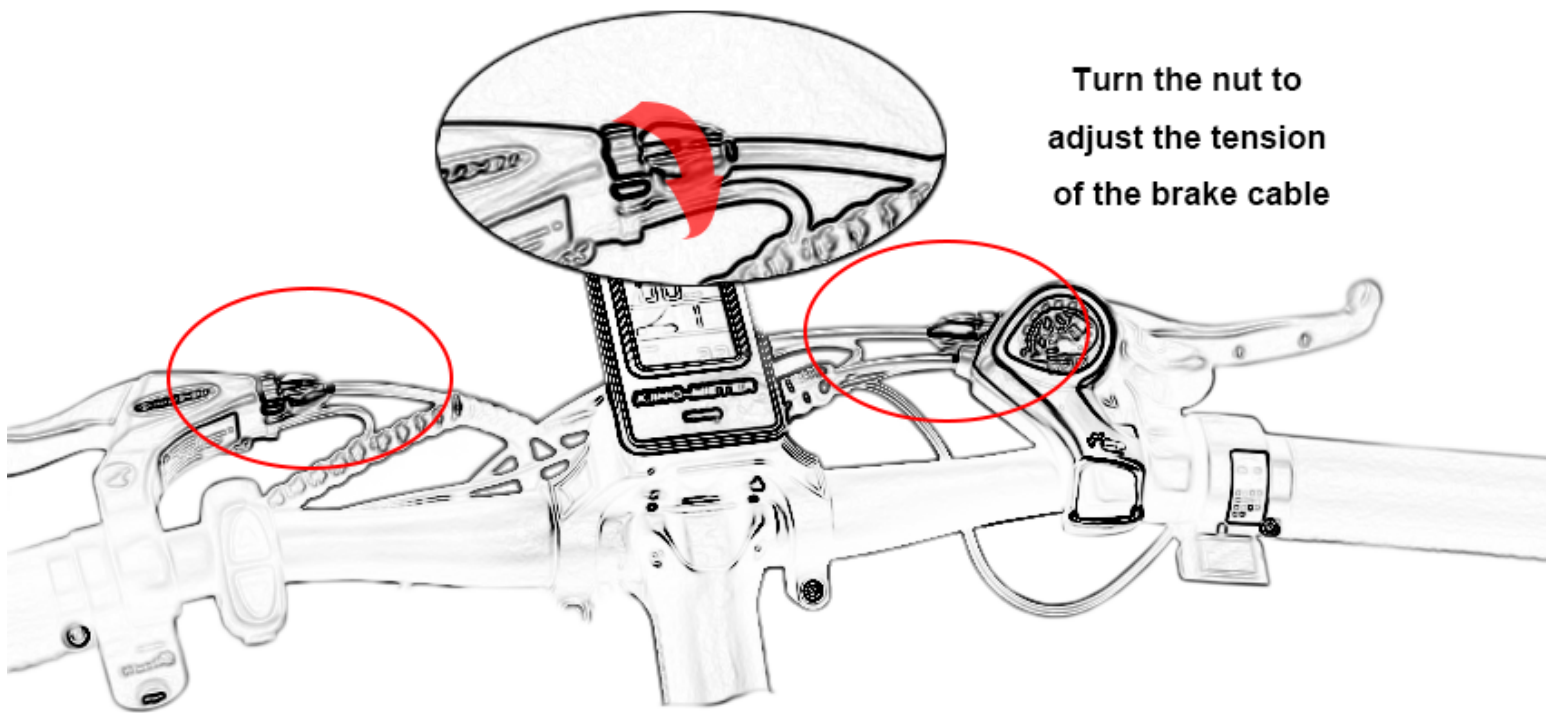

Turn the nut to  
adjust the tension  
of the brake cable

**TIP:**

Turning the nuts will slightly adjust the tension the brake cable. For further adjustments of the brake, you will need proper tools and adjust the brake cable on the caliper side. It is recommended to visit your local EMMO shop.

# 10. MAINTENANCE

*Regular maintenance is required to keep the bike in its best working conditions.*

## CLEAN

Please use clean water and neutral detergent to clean the bike. Use soft cloths or sponges to clean the surfaces. Please do not use metal brushes, sandpaper or any other abrasive material to avoid scratches or physical damage. Dry the bike with soft cloths. Please clean and grease the chain and sprockets.

### *Warning:*

- *Please turn off the circuit breaker and remove the battery (if applicable) before cleaning the bike.*
- *Please do not power wash the e-bike.*

## STORAGE

In case of storage of more than one month, such as winter storage, **Please charge the battery regularly (at least once a month) and turn off the circuit breaker.** The bike, including the battery and charger, is suggested to be stored in clean, dry ventilated place. Please do not leave the battery outside under freezing temperature. Please avoid any corrosive material or heat source.

## REGULAR INSPECTION

For **every 3000km** you travel or every **6 months**, a full inspection/tune-up is recommended based on the condition of the bike.

**Table 1      Error Code Explanation**

<b>Error Code</b>	<b>Explanation</b>
21	Current Abnormality
22	Throttle Failure
23	Motor Disorder
24	Motor Hall Signal Disorder
25	Brake Failure
30	Communication Failure

# E-Bike Registration

## E-Bike Registration

Once you have purchased an Emmo E-bike, you can register your vehicle with us to validate your warranty.

In order to register your e-bikes, please follow the steps listed below:

1. Fill out the following form:

Invoice Number: \_\_\_\_\_

Store Location: \_\_\_\_\_

Customer Name: \_\_\_\_\_

Address: \_\_\_\_\_

Phone Number: \_\_\_\_\_

E-mail: \_\_\_\_\_

### Survey:

How did you find out about Emmo Inc.? (Please select the options that apply)

Returning Customer     Family/Friend     Passing by Store     Kijiji  
 TERA     Google     Yelp     Other \_\_\_\_\_

2. Send the information listed above to our e-mail: [info@emmo.ca](mailto:info@emmo.ca)

3. Wait for a confirmation e-mail from Emmo Inc.