

FORESSO®

FLOORING DESIGN GUIDE

INTRODUCTION

Foresso is a material composed of offcut timber, wood dust, mineral powders, and 0% VOC bio-based resin cast onto a birch plywood substrate. It is a durable and versatile material made of wood that can be used in a wide variety of projects.

MATERIAL VARIATION

Foresso contains natural materials and as such no two pieces will be the same.

- Wood chips will vary in colour, tone, size, grain patterns, and will include knots and other character. This will vary within a sheet and between sheets, samples are indicative only and do not guarantee a timber colour.
- Chip densities will vary within each sheet and between sheets. There will be areas with lesser and greater chip density.
- The sheet surface can contain small pores, indentations, or other small oddities as a result of our hand casting process. These are not considered defects and do not affect the performance of the surface.

We cannot be held responsible for damage caused by poor workmanship, improper storage conditions, nor damage on site.

STORAGE

Temperature - min 19°C
Relative Humidity - 35% - 65%

NB - If stored in cold conditions Foresso sheets can warp, this can happen when items are in transit. In the event of bowing or cupping store lying down flat in a suitable environment as detailed above.

Please allow at least 1 hour for panels to relax, the top surface should not feel cold to the touch.

INSTALLATION

Installing Foresso flooring is the same as any other engineered timber product.

Ensure that you are using products suitable for engineered wood products and that the environment is as detailed above.

For more information refer to our installation guide or get in touch with us on contact@foresso.co.uk or call us on +44 203 302 7387.

STANDARD FLOORING SIZES

2400 x 200mm



1200 x 200mm



1200 x 780mm

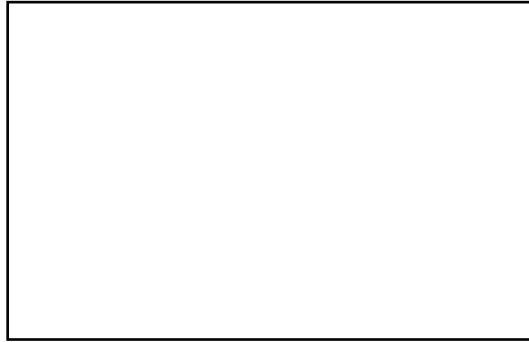

580 x 580mm

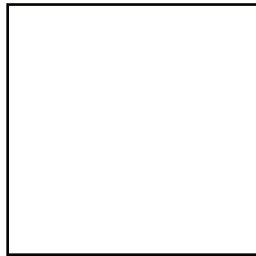

PROFILE

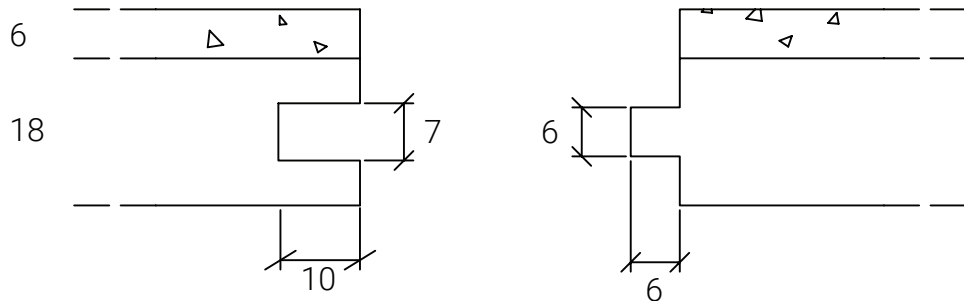

TOLERANCES

Thickness : 23.5mm +/- 0.5mm

Length and Width : +/- 1mm

FINISH

Our standard finish is a hardwax oil that brings out the natural beauty of the timber. This gives good water, stain, and abrasion resistance and is suitable for low - medium traffic flooring.

Foresso floors should be treated like other wood flooring, and we recommend re-oiling once per year. Please see our maintenance guide for more detailed information.

Foresso can also be lacquered to suit high traffic commercial environments, including off the street areas, bars, restaurants, etc.

The London Collection

Inspired by London. Made in Britain.



Bianco Mono

London Plane in a white binder

London Plane's fibrous grain can vary between pale yellows, browns, and reddish pink depending on the part of the tree used.



Ivory Duo

British Walnut & Cedar in an ivory binder

Rich Walnut browns paired with Cedar's orange-brown colouring with dark rings through the grain.



Charcoal Mono

British Walnut in a black binder

Varying between rich dark brown and a pale mid brown, British Walnut's grain can also include dark lines and figuring.

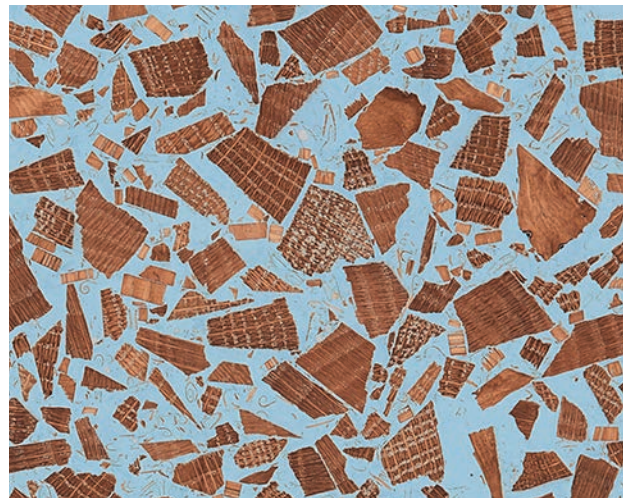

Azure Mono

British Oak in a blue binder

A consistent mid brown timber with light brown rays spreading across the grain.

CUSTOM FORESSO

Custom binder colours can be made to a RAL reference, please allow a minimum of 3 weeks lead time for control samples.

All custom Foresso must be signed off before production.

GUIDE TO JOINS

Foresso flooring has a tongue and groove join with a small chamfer on the edges. This is the same as engineered wood flooring products and ensures that there is a pleasant fit between tiles or planks.



For more design inspiration take a look at our [Commercial](#) and [Residential](#) project pages.