

CCT & WATTAGE SELECTABLE LED WALLPACK LR40530, LR40540

NOTE

Add a bead of exterior grade silicone sealant around the perimeter of the wall pack on the wall to inhibit any moisture from attachment bolts.

JUNCTION BOX MOUNTING

1. UNSCREW THE SCREWS ON THE RIGHT SIDE USING A SUITABLE SCREWDRIVER. SEPARATE THE MALE AND FEMALE CONNECTORS, THEN REMOVE THE REFLECTOR FROM THE BACK PLATE.

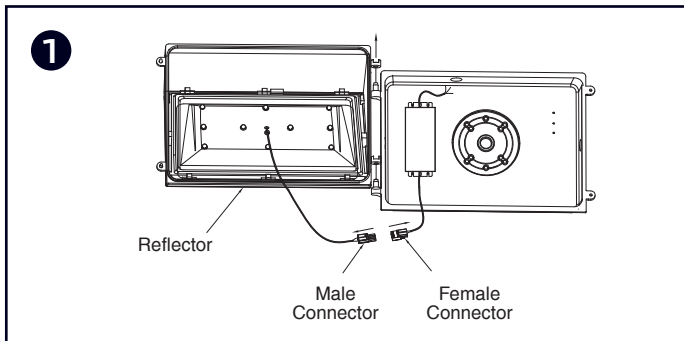

2. CREATE FOUR 5.0 MM HOLES BY KNOCKING-OUT THE FOUR POINTS INDICATED IN A/B/C/D. UNSCREW BOLT (1) FROM THE BOTTOM CENTER. (NOTE: THE OTHER THREE BOLTS (2)/(3)/(4) CAN BE UNSCREWED DEPENDING ON YOUR REQUIREMENTS DURING THE WIRING PROCESS.

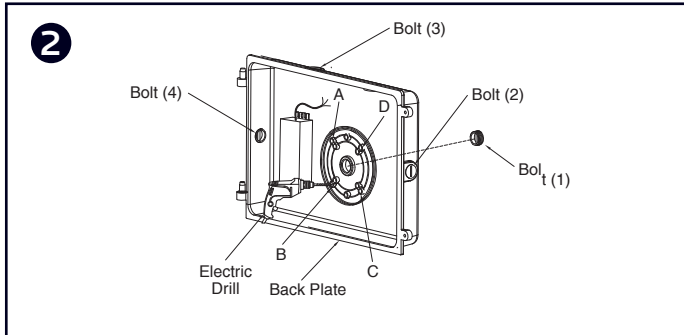

3. RUN THE MAIN POWER WIRE FROM THE WATER-PROOF J-BOX THROUGH THE HOLE (H), THEN LOCK THE BACK PLATE TO THE WATER-PROOF J-BOX USING FOUR #8-32 SCREWS.

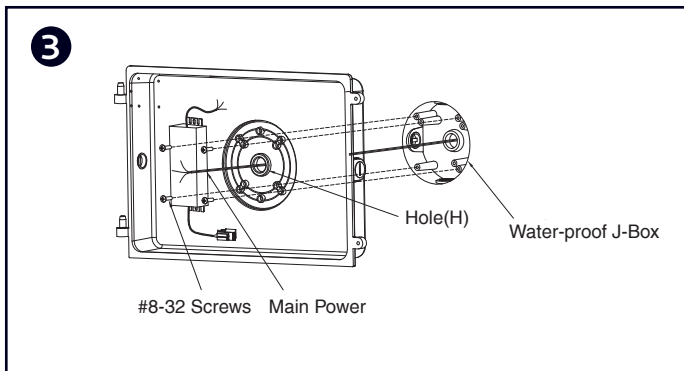

4. USE THE HINGE TO LOCK THE REFLECTOR TO THE BACK PLATE FIRMLY, THEN CONNECT THE MAIN POWER. BLACK WIRING TO L, WHITE TO N, GREEN TO G (SEE DIAGRAM ABOVE) NEXT, CONNECT THE MALE AND FEMALE CONNECTORS TOGETHER. FINALLY, USE A SUITABLE SCREWDRIVER TO CONNECT THE REFLECTOR TO THE BACK PLATE.

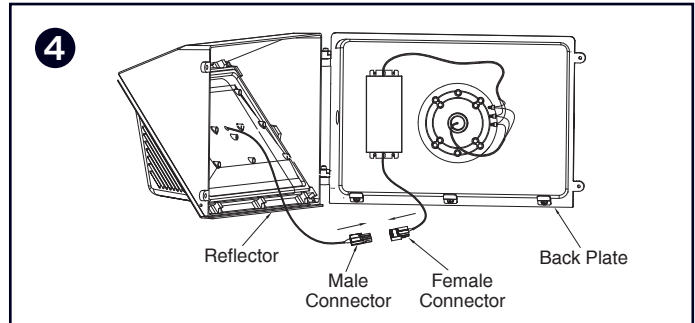

CONDUIT MOUNTING:

1. UNSCREW THE SCREWS ON THE RIGHT SIDE USING A SUITABLE SCREWDRIVER. SEPARATE THE MALE AND FEMALE CONNECTORS, THEN REMOVE THE REFLECTOR FROM THE BACK PLATE.

2. UNSCREW THE RIGHT-SIDE BOLT (5), DRILL THREE 6.5 MM HOLES IN E/F/G USING A SUITABLE DRILL. NEXT, FASTEN THE BACK PLATE TO THE WALL WITH THE THREE SCREW COMPONENTS. (MAKE SURE TO WATERPROOF THREE OPEN HOLES E/F/G)

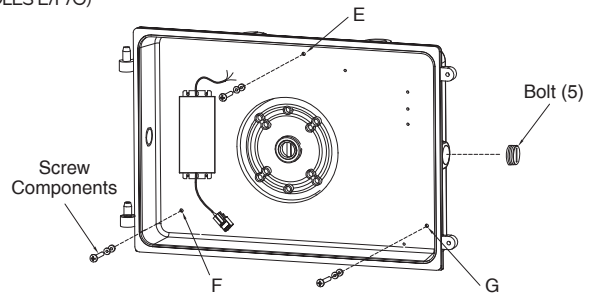

3. RUN THE MAIN POWER THROUGH THE RIGHT HOLE AND THEN FINISH THE WIRING (BLACK WIRE - L, WHITE WIRE - N, GREEN WIRE - G) SEE WIRING DIAGRAM ON PAGE 2.

4. USE THE HINGE TO LOCK THE REFLECTOR TO THE BACK PLATE FIRMLY. NEXT, CONNECT THE MALE AND FEMALE CONNECTORS TOGETHER. FINALLY, USE A SUITABLE SCREWDRIVER TO CONNECT THE REFLECTOR TO THE BACK PLATE.

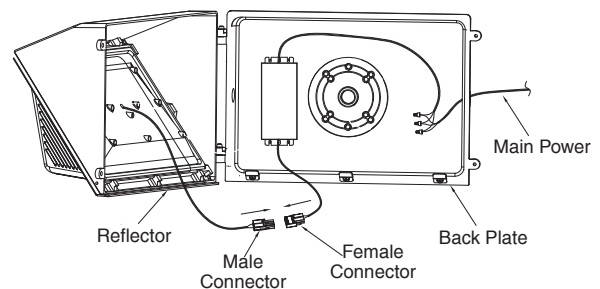

NOTE: 1 to 4 demonstrate different internal wiring diagrams; if the wall pack has an internal emergency driver, please use the second installation instructions - for installation.

GENERAL WIRING DIAGRAM

CAUTION: TURN OFF ELECTRICAL POWER AT FUSE OR CIRCUIT BREAKER BOX BEFORE WIRING FIXTURE TO THE POWER SUPPLY.

CONNECTING PANELS TO AC SOURCE SUPPLY. ALL UNITS MUST BE INDIVIDUALLY CONNECTED TO THE AC SUPPLY.

- BLACK = LINE
- WHITE = NEUTRAL
- GREEN = GROUND

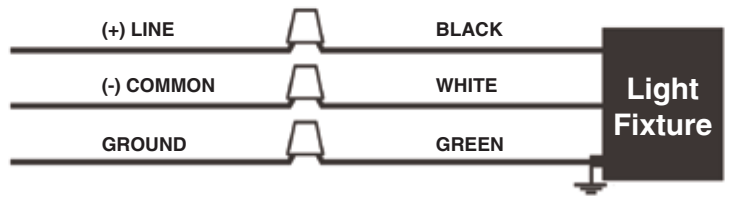

1. 277/480Vac DIAGRAM

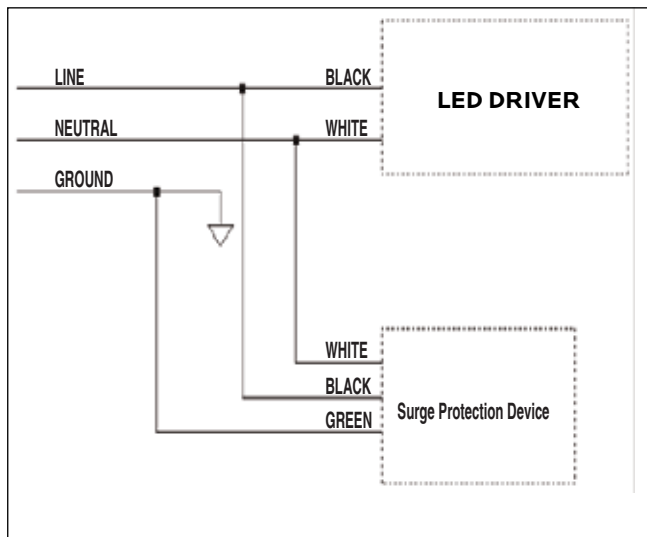

2. EMERGENCY BATTERY BACKUP WIRING DIAGRAM

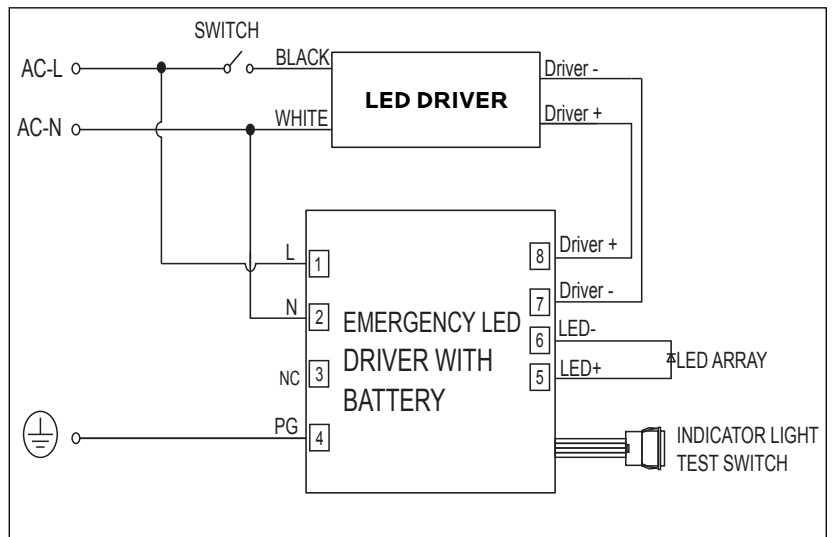

3. PHOTOCELL DIAGRAM

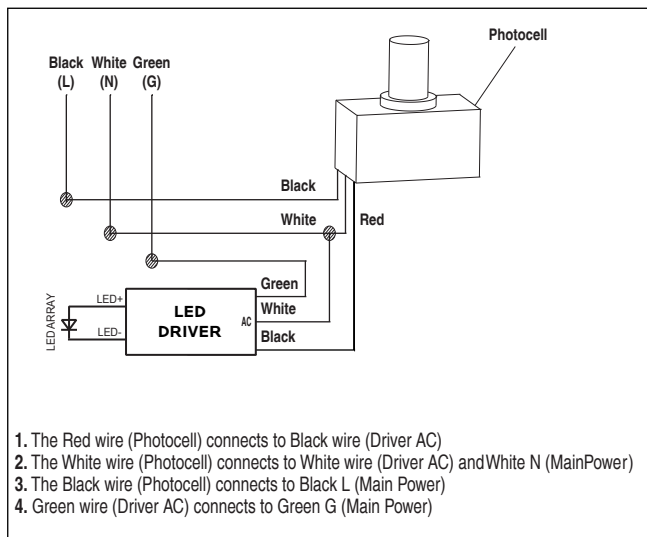

4. MICROWAVE SENSOR WIRING DIAGRAM

