

LR25190 MICROWAVE SENSOR

1. Dual setting by DIP switch and remote control.
2. Suitable for Tri-Proof light.
3. Tri-Level control by 1-10V output.
4. Loop in and loop out for easy installation.
5. Sensitive and reliable
6. 8-15m High altitude installation.
7. 5 year limited warranty.

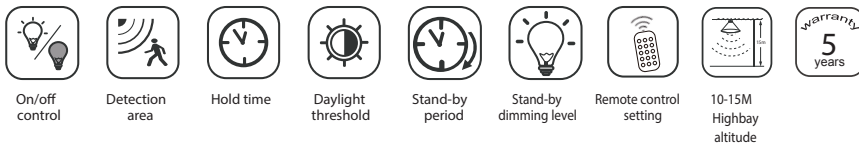

DETECTION COVERAGE

This figure indicates the maximum distance at the highest mounting height with 100% sensitivity.
Typical installation height 8-15m

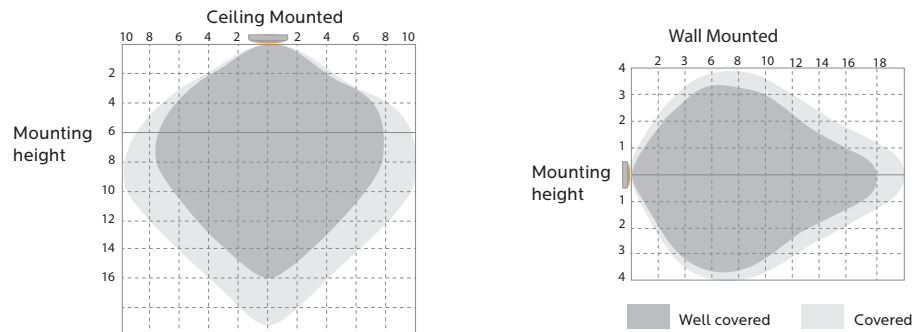

TECHNICAL DATA

Operating voltage	120-277VAC,50Hz/60Hz
Switching capacity	Max,3.0A@120Vac,50/60Hz; Max,2.0A@277Vac,50/60Hz
Stand-by power	≤1W
Control method	On/off / 1-10V Dimming Remote Control
Microwave frequency	5.8GHz±75MHz
Microwave power	<0.3mW
Detection area	50%/100%
Hold time	5s/30s/1min/10min
Daylight threshold	2Lux/10Lux/50Lux/Disable
Stand-by period	0s/30s/20min/+∞
Stand-by dimming level	10%/20%/30%/50%
Mounting height	8-15m /26.25-49.2ft
Detection range	Max.ø14m/45.93ft
Motion detection	0.5~1.5m/s
Operating temperature	-30°C~+70°C
IP rating	IP20
Warranty	5 years

MECHANICAL STRUCTURE

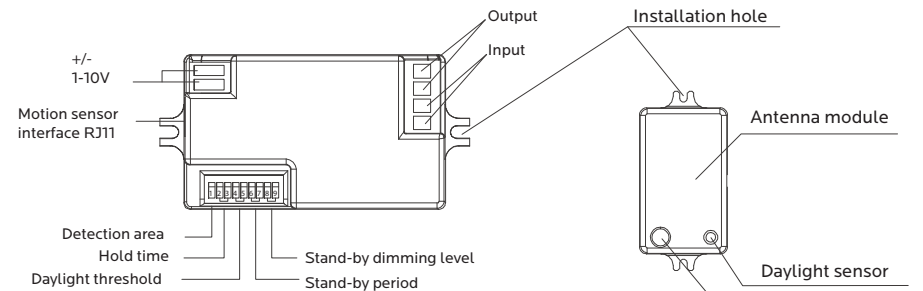

DIMENSIONS (UNIT: MM)

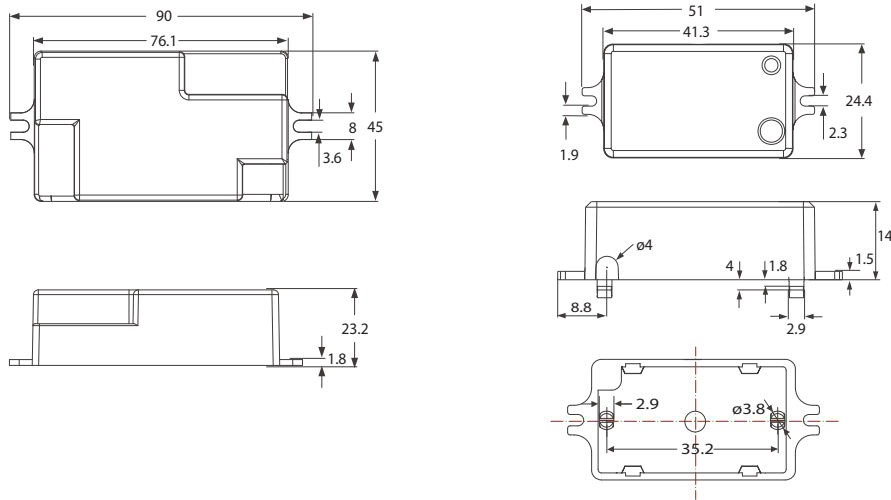

Note: Motion sensor setting and dimming setting please refer to remote control HD03R.
 HD02VRH Wire diameter 4mm, Standard Version Cable Length 48.5 cm (can be customized).

WIRING DIAGRAM

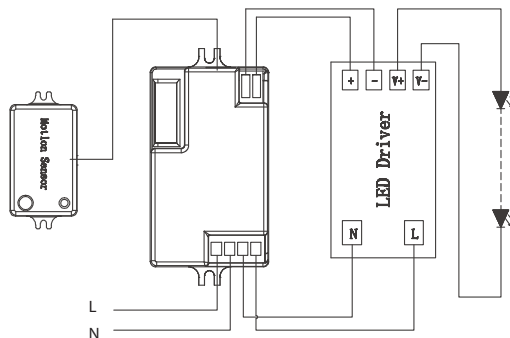

SETTINGS

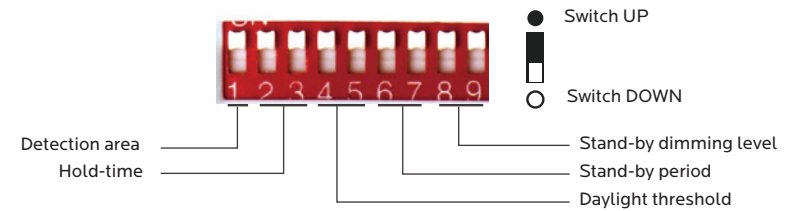

DETECTION AREA

●	100%
○	50%

In this area, movement will be detected and able to trigger the sensor. 100% detection area is also known as the strong sensitivity.

HOLD-TIME

●	●	5s
○	●	30s
●	○	1min
○	○	10min

The period of light keeping 100% brightness after moving objects leave the detection area.

DAYLIGHT TRESHOLD

●	●	Disable
○	●	50lux
●	○	10lux
○	○	2lux

Definition of the ambient brightness; only when the ambient brightness is lower than the preset specific lux amount, the sensor will work; when it's preset as "disable", the sensor works everytime it detects motion regardless the ambient brightness.

STAND-BY PERIOD

●	●	0s
○	●	30s
●	○	20min
○	○	+ ∞

The period of light keeping low output before it's completely switched off. When it's preset as "←", the light always keep at low output if no movement in the detection area and doesn't turn off.

STAND-BY DIMMING LEVEL

●	●	10%
○	●	20%
●	○	30%
○	○	50%

The definition of low output in the standby period.

APPLICATION

1. AUTOMATICALLY ON/OFF FUNCTION:

Light on when detect movement and off after people leave at night. Applications: Corridor, Staircase.

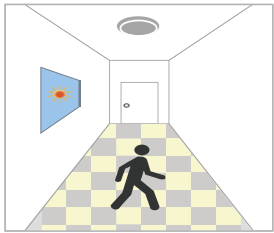

With sufficient daylight, even when motion detected, light remains OFF.

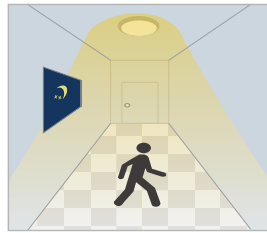

With insufficient daylight, when motion detected, light ON.

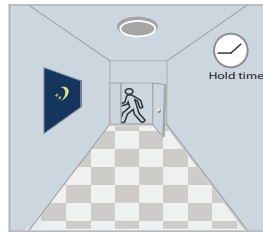

After the last detection and the present hold time elapsed, light OFF.

2. NO DAYLIGHT FUNCTION

The daylight threshold is set to "Disable".

Light on when detect movement, After people leave, Light off after stand-by period.

Applications: Dim places such as Basement Parking, Underpass.



When motion is detected, the sensor will switch on the light to 100% brightness.

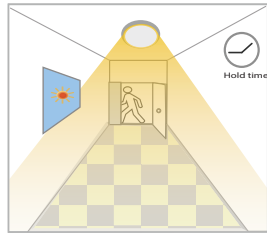

After people leave the detection area, light remains 100% brightness within hold time.

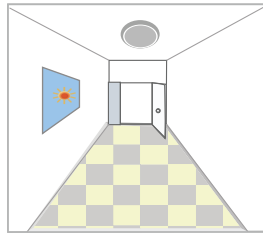

After the last detection and the present hold time elapsed, light OFF.

3. FUNCTION DEMO - DIMMABLE CONTROL/CORRIDOR FUNCTION

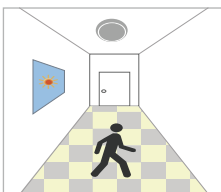

With sufficient daylight, even when motion detected, light remains OFF.



With insufficient daylight, when motion detected, light ON.

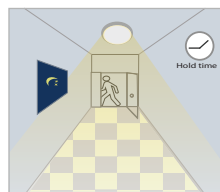

After last detection, the light will be dimmed down to the stand-by dimming level (10%,20%,30% or 50%)

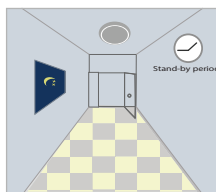

After the stand-by period, light OFF.

INSTALL METHOD

4 WAYS OF INSTALLATION

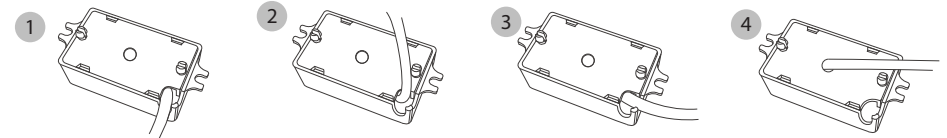

CABLE ON CENTER

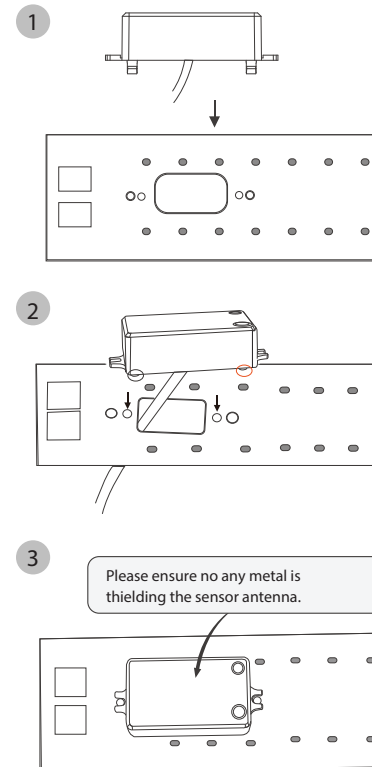

CABLE ON TIP SIDE

