

# SHP-DP609

## User Manual

### Samsung SDS Digital Door Lock

#### WiFi Function (p.13, 19)

App based user service using the WiFi function

#### Silent Mode (p.4)

When entering or exiting, the sounds from the keypad and doorlock will be muted.

#### Double Authorization Function (p.17)

Both a password and a fingerprint are required to unlock your door lock, to strengthen its security.

#### Welcome Function (p.15, 16)

When a user approaches the door lock, the authorization standby mode will automatically activate.

#### Security Assurance Function (p.21)

When someone is inside the house, authorization for entry from the outside will be prohibited.

#### Away Security Function (p.22)

When a user is out of the house, if the inside of the door lock is used, an alarm is triggered.

#### High Temperature Alarm (p.23)

If the inside of a house has a very high temperature, the door lock will be automatically unlocked.

#### Voice Guide (p.19)

Guides each action by voice.

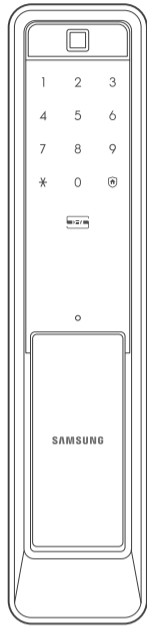

smarhome.samsungsds.com

## Safety Precautions



This section contains important information to ensure the user's safety and prevent potential damage to property. Please, read this section carefully and use the product accordingly.

- The installation and repair should be done by the professional installer or service person.
  - Do not install the product in the place where the gap between the door and the frame is 5 mm or more.
  - Long-term exposure to direct sunlight may cause a crack on its touch pad. Avoid exposure to direct sunlight.
  - Do not use the excessive force or sharp objects to push the lock buttons, as this can damage the product.
  - Do not operate the product with wet hands, and keep liquids such as water or drinks away from the product, or the product may malfunction or be damaged.
  - Do not use water, benzene or alcohol when cleaning the product, but use a soft dry cloth.
  - Make sure that the door is completely closed when going outside.
  - Make sure that no unauthorized person has the access to the password.
- Change it regularly.
- Be sure to correctly match the battery polarities (+/-) when installing the batteries. Wrong direction of battery polarities may cause the battery liquid leakage or the burst of them.
  - When the battery replacement alarm melody is generated, use all new batteries instead of the existing batteries.
  - According to the wireless communication environment, its battery may consume much.
  - Interference in wireless communication may occur when this product is used, or radio interference may occur from other devices.
  - As this radio system may have radio interference during the operation, it cannot provide a service for human lives.
  - Too much dew condensation may affect the performance of this product.
  - Keep 20 cm or longer away from this product when using it.

※ The information of this user manual is subject to change without any notices to improve the performance of this product.

※ Customer's improper installation may result in an additional service costs. We highly recommend professional installation.

## Product Components

The product components may vary depending on the installation environment.

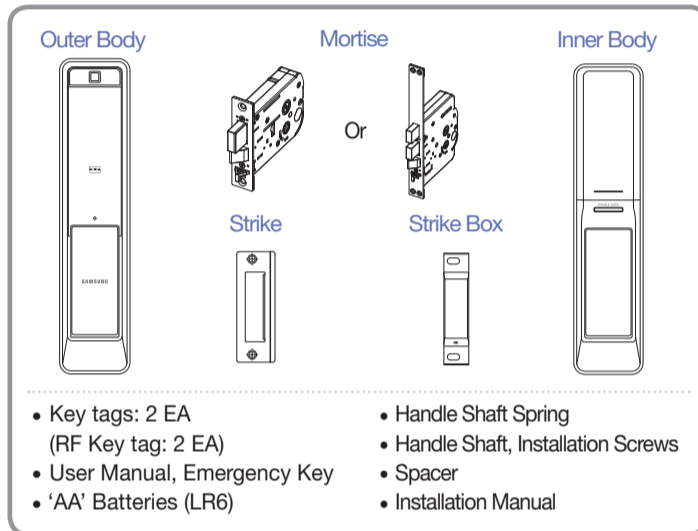

## Outer Body Parts

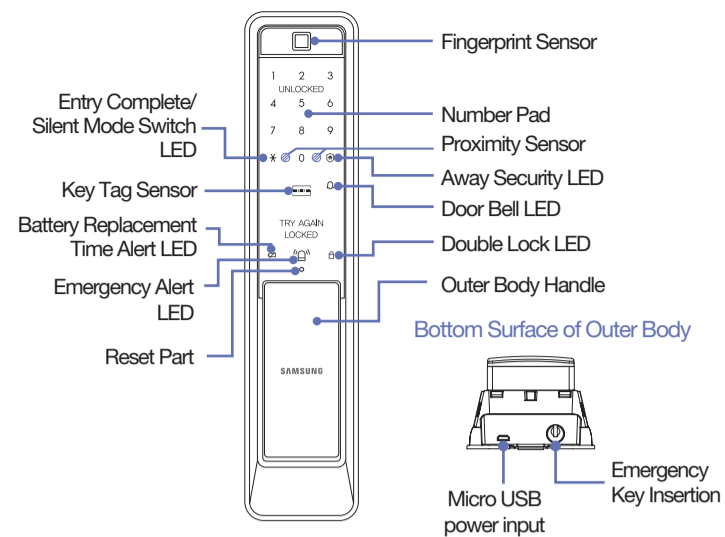

## Inner Body Parts

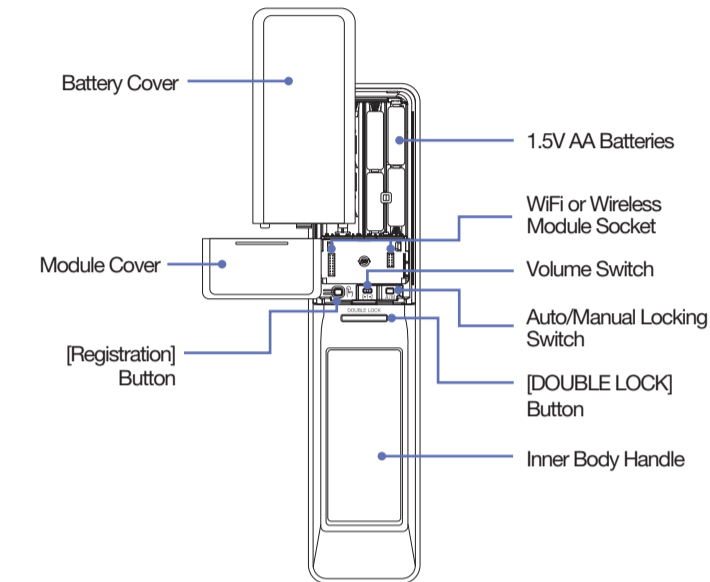

## Mortise

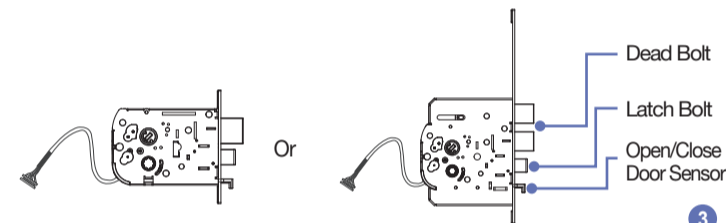

## Opening the Door from Outside (Master/User Password)

When purchased, the product is set to Multi-leveled Security Code Entry Mode initially. Please, refer to 'Multi-leveled Security Code Entry Mode setting' for Common Mode setting.

### ※ Silent Mode

Before entering the master/user password, press the [\*] button and enter the master/user password, then both the sound of the key entering and the door opening will be muted. It is a useful function if you do not want to disturb neighbors when you go in and out at night.

### 1. Multi-leveled Security Code Entry Mode

Accessing the door lock or touching the number pad (in the Welcome Function mode) will light up the number pad.

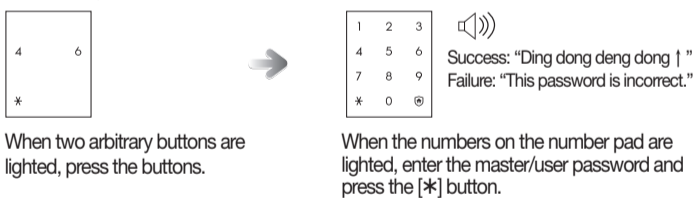

When two arbitrary buttons are lighted, press the buttons.

When the numbers on the number pad are lighted, enter the master/user password and press the [\*] button.

### 2. Common Mode

Accessing the door lock or touching the number pad (in the Welcome Function mode) will light up the number pad.

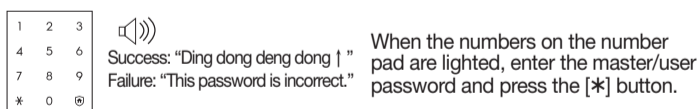

When the numbers on the number pad are lighted, enter the master/user password and press the [\*] button.

- Note
- Master/User password must be entered after the light is on. If not, touch the number pad and re-enter the password.
  - To cancel the password entry, press the [⊕] button and re-enter the password.
  - If the password is wrong 5 times, the "You entered the wrong information five times." alarm will sound. In about 10 seconds, the "The input block mode will be activated for three minutes." alarm will sound, and the system will shut-down for about 3 minutes. If the correct password is entered before the 3-minute entry block mode alarm is generated, the entry block mode will not be activated.

## Opening the Door from Outside (Fingerprint)

A locked door can be opened from outside by using a fingerprint. Place the registered fingerprint on the fingerprint sensor.

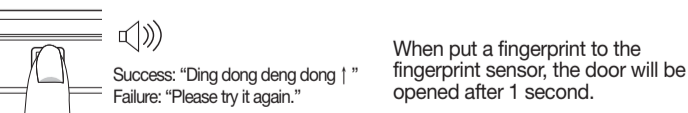

When put a fingerprint to the fingerprint sensor, the door will be opened after 1 second.

## Opening the Door from Outside (Key tag, Mobile key)

A locked door can be opened from outside by using a key tag or mobile key. Place the registered key tag or mobile key on the key tag sensor.

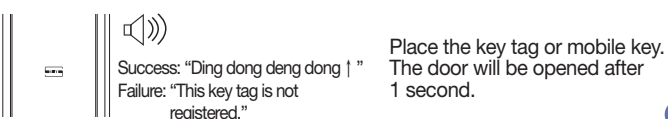

Place the key tag or mobile key. The door will be opened after 1 second.

## Opening the Door from the Inside

### Opening the Door by Pulling the Inside Handle (Pull-Push)

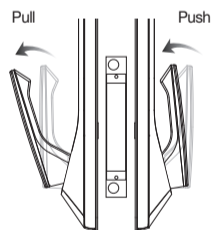

Warning: Please be careful not to trap your hand during use.

## Locking the Door from the Inside

**Automatic Locking Setting** The door is automatically locked 1 second after the door is closed.

**Manual Locking Setting** The door is locked when the [DOUBLE LOCK] button from the inside is pressed.

Note: If you want to check the door status in the house, shortly touch the Double Lock button. If the door is locked, the red LED blinks. If not, the green LED blinks.

## Menu

### Registration Mode

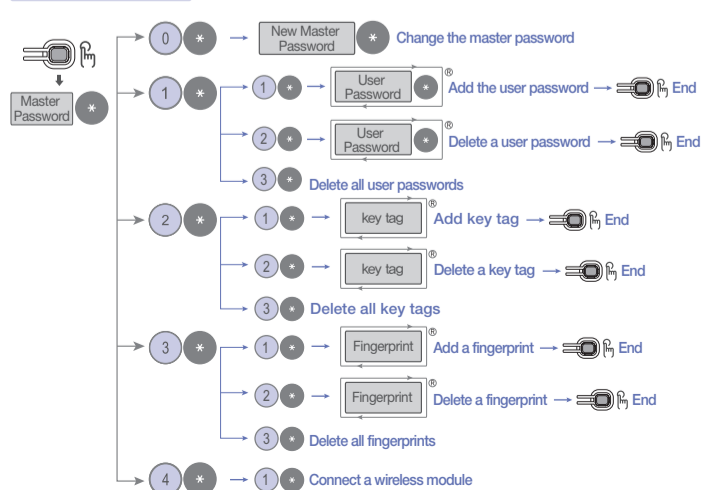

### Setting Mode

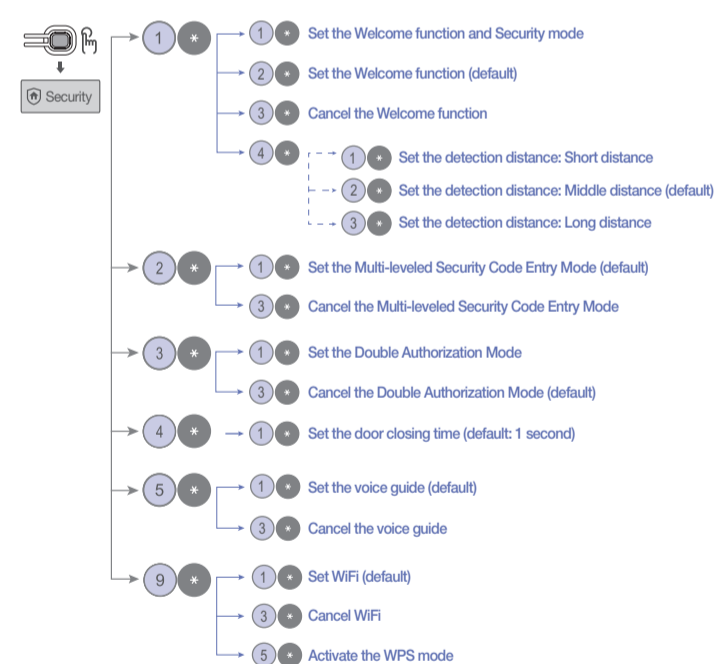

### Initialization Mode



### WiFi Registration Mode

Register a WiFi

While the door is closed,

### Number pad Guide

The number pad of the door lock shows diverse settings.

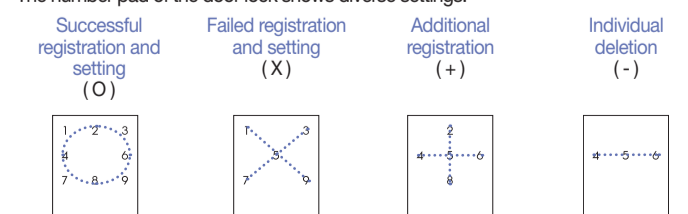

※ All registration and setting are activated only when the door is opened.  
(WiFi connection is activated only when the door is closed.)

## Registration Mode

A user can change a master password, or register and delete a user password or a Key tag or fingerprint or delete all user passwords or a Key tag or fingerprints.

In addition, a wireless connection can be registered as an option.  
In the Registration mode, select a function.  
(For the details of each function, refer to page 7-14.)

※ In the Registration mode, be careful that the door is not locked even though it is closed during the registration time (60 seconds). To cancel the Registration mode, press the Register button of the inner body.

### 1. [Register] Button

"Ding dong" →  
"Press the password and the asterisk sign to manage an authentication tool. Press the Security button for the environment setting. Press the Register button to end this process."

Open the battery cover of the inner body and press the [Register] button shortly.

### 2. Existing Master Password

"Ding dong deng" →  
"Press "0" and the asterisk sign to change a password. Press "1" and the asterisk sign to manage a user password. Press "2" and the asterisk sign to manage a key tag. Press "3" and the asterisk sign to manage a fingerprint. Press "4" and the asterisk sign to set up a wireless connection."

Press the existing master password and the [\*] button.

## Change the master password

A user can register a master password (4 to 12 digits), and only one master password can be registered. The default master password is "1234."

### 1. Enter Registration Mode

### 2. Select Master Password Change

"Password Change mode"

"Press a new password and the asterisk sign."

Press the [0] button.  
- To hear the announcement again, press a number button before pressing the [\*] button.

### 3. Press New Master Password

"Ding dong deng" →  
Success: "It was changed."  
Failure: "Wrong information was entered."

Press a new master password and the [\*] button.

### 4. Check Changed Password

"Ding dong deng" →  
Success: "It is registered. If you need to register it more, press a new user password and the asterisk sign."  
Failure: "Wrong information was entered." or "It already exists."

Press the [Register] button, the new password, and the [1] button, consecutively, and check if the Registration mode is accessed.

**Warning**

- To prevent an intrusion, it is recommended to make a password with 6 or more digits. (Each digit number ranges from 0 to 9.)
- Manage your master password with care so that unauthorized people will not have access to it. Regularly changing your password can reduce the risk of it being leaked.
- A registered master password cannot be deleted. Register a new master password.
- To make sure the password has been properly registered, check the new password and close the door.
- If checking the new password fails, initialize the key information (see page 14) to initialize the password, and change the password again.

## Adding/Deleting User Password/ Deleting All User Passwords

A user can register a user password (4 to 12 digits).  
Up to 100 user passwords can be registered.  
A user password registered can be deleted, or all user passwords can be deleted.

### 1. Enter Registration Mode

### 2. Select User Password Management

"User Password Management mode"

"Press "1" and the asterisk sign for additional registrations. Press "2" and the asterisk sign for individual deletions. Press "3" and the asterisk sign for all deletions."

Press the [1] button.  
- To hear the announcement again, press a number button before pressing the [\*] button.

### [Add a user password]

### 3. Select Additional Registration

"Additional Registration mode"

"Press a user password and the asterisk sign."

Press the [1] button.  
- To hear the announcement again, press a number button before pressing the [\*] button.

### 4. Press New User Password

"Ding dong deng" →  
Success: "It is registered. If you need to register it more, press a new user password and the asterisk sign."  
Failure: "Wrong information was entered." or "It already exists."

Press a new user password and the [\*] button.

### 5. Exit Registration Mode

If you want to end this process, press the [Register] button of the inner body shortly.

### [Delete a user password]

### 3. Select Individual Deletion

"Individual Deletion mode"

"Press the user password and the asterisk sign."

Press the [2] button.  
- To hear the announcement again, press a number button before pressing the [\*] button.

### 4. Press User Password to Delete

"Ding dong deng" →  
Success: "It is deleted. If you need to delete more, press the user password and the asterisk sign."  
Failure: "This password is not registered."

Press the user password registered and the [\*] button.

### 5. Exit Registration Mode

If you want to end this process, press the [Register] button of the inner body shortly.

### [Delete all user passwords]

### 3. Select All Deletion

"All deletion mode"

"Ding dong deng" →  
"All deleted."

Press the [3] button.  
- To hear the announcement again, press a number button before pressing the [\*] button.

**Note**

- Continuously, a user password can be registered or deleted. When a user enters a user password within 60 seconds after a new user password is registered or deleted, the registration or deletion continues to be performed.
- To make sure the password has been properly registered or deleted, check the password and close the door.

## Adding/Deleting a Key tag / Deleting All Key tags

Up to 100 key tags can be registered. A registered key tag can be deleted, or all key tags can be deleted (ISO 14443 Type A supportable).

### 1. Enter Registration Mode

### 2. Select Key tag Management

"Key tag Management mode"

"Press "1" and the asterisk sign for additional registrations. Press "2" and the asterisk sign for individual deletions. Press "3" and the asterisk sign for all deletions."

Press the [2] button.

Press the [\*] button.

### [Add a key tag]

### 3. Select Additional Registration

"Additional Registration mode"

"Connect the key tag to be registered additionally."

Press the [1] button.

"Ding dong deng" →  
Success: "It is registered. If you need to register more, connect a key tag to be registered additionally."  
Failure: "This key tag already exists."

Connect a key tag to be added to the key tag sensor.

### 5. Exit Registration Mode

If you want to end this process, press the [Register] button shortly.

### [Delete a key tag]

### 3. Select Individual Deletion

"Individual Deletion mode"

"Connect the key tag to be deleted."

Press the [2] button.

### 4. Connect the Key tag to be Deleted

"Ding dong deng" →  
Success: "It is deleted. If you need to delete more, contact the key tag to the key tag recognition part."  
Failure: "This key tag is not registered yet."

Connect the key tag to delete to the key tag recognition part.

### 5. Exit Registration Mode

If you want to end this process, press the [Register] button shortly.

### [Delete All Key tags]

### 3. Select All Deletion

"All Deletion mode"

"Ding dong deng" →  
"All deleted."

Press the [3] button.

**Note**

- A key tag can be registered or deleted continuously. When a user connects a key tag within 60 seconds after a new key tag has been registered or deleted, registration or deletion can continue.
- To make sure the password has been properly registered or deleted, check the password and close the door.

**Warning**

- Only the key tags provided by Samsung SDS can be used.
- Samsung SDS will not be responsible for any problems occurring from the use of authentication methods, other than the key tags it has provided.

## Adding/Deleting Fingerprint/ Deleting All Fingerprints

Max 100 fingerprints can be registered.  
A fingerprint registered can be deleted, or all fingerprints can be deleted.

### 1. Enter Registration Mode

### 2. Select Fingerprint Management

"Fingerprint Management mode"

"Press "1" and the asterisk sign for additional registrations. Press "2" and the asterisk sign for individual deletions. Press "3" and the asterisk sign for all deletions."

Press the [3] button.  
- To hear the announcement again, press a number button before pressing the [\*] button.

### [Add a fingerprint]

### 3. Select Additional Registration

"Additional Registration mode"

"Input a new fingerprint three times to the fingerprint recognition part."

Press the [1] button.  
- To hear the announcement again, press a number button before pressing the [\*] button.

### 4. Put a fingerprint to Add

"beep" →  
"beep" →  
"beep" →  
"beep" →  
"Ding dong deng" →  
Success: "It is registered. If you need to register it more, input your fingerprint three times to the fingerprint recognition part."  
Failure: "Please try it again."

Put a fingerprint to add to the fingerprint sensor.  
(In registering your fingerprint, change its position gradually until it is recognized.)  
When "beep" sound is generated and the recognition count is displayed on the number pad, remove the finger from the sensor and contact it again. (Total three times)

### 5. Exit Registration Mode

If you want to end this process, press the [Register] button of the inner body shortly.

**Note**

- In registering your fingerprint, it is recommended to register your thumb or index finger.
- If the quality of the fingerprint image is bad, fingerprint registration may be refused.

### [Delete a fingerprint]

### 3. Select Individual Deletion

"Individual Deletion mode"

"Input the fingerprint to the fingerprint recognition part."

Press the [2] button.  
- To hear the announcement again, press a number button before pressing the [\*] button.

### 4. Put the fingerprint to Delete

"Ding dong deng" →  
Success: "It is deleted. If you need to delete more, input the fingerprint to the fingerprint recognition part."  
Failure: "Please try it again."

Put the fingerprint to delete to the fingerprint sensor.

### 5. Exit Registration Mode

If you want to end this process, press the [Register] button of the inner body shortly.

### [Delete all fingerprints]

### 3. Select All Deletion

"All deletion mode"

"Ding dong deng" →  
"All deleted."

Press the [3] button.  
- To hear the announcement again, press a number button before pressing the [\*] button.

**Note**

- Continuously, a fingerprint can be registered or deleted. When a user contacts a fingerprint within 60 seconds after a new fingerprint is registered or deleted, the registration or deletion continues to be performed.
- To make sure the password has been properly registered or deleted, check the password and close the door.

## Managing Wireless Module (OPTION)

You can purchase a Wi-Fi or wireless module sold by Samsung and mount it into the Wi-Fi or wireless module socket.

However, even though you purchase a proper Samsung Wi-Fi or wireless module, it may not be used in a model that does not support the module. Thus, please, contact the store before purchasing a Wi-Fi or wireless module to inquire the module type of your model.

### 1. Mount WiFi or Wireless Module

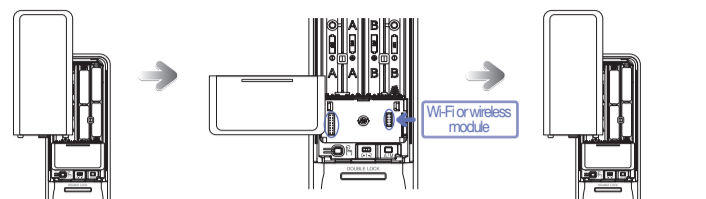

Open the battery cover and remove the batteries.

Open the module cover and mount a WiFi or wireless module into the WiFi or wireless module socket.

Insert the batteries and close the battery cover.

### 2. Enter Registration Mode

Select the Registration mode. (Refer to the Registration mode on page 7.)

### 3. Select Wireless Connection Setting

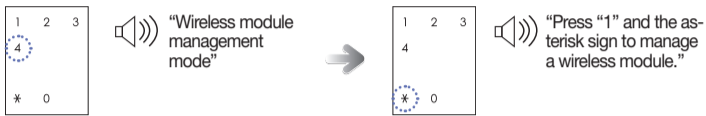

Press the [4] button.  
- To hear the announcement again, press a number button before pressing the [\*] button.

Press the [\*] button.

#### [Wireless module connection/disconnection]

### 4. Enter Connection/Disconnection Mode from Controller

The Connection/Disconnection mode is activated from the controller. (Refer to the user manual of the controller.)

### 5. Select Wireless Module Management

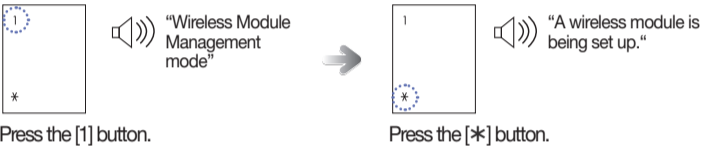

Press the [1] button.  
- To hear the announcement again, press a number button before pressing the [\*] button.

Press the [\*] button.

### 6. Wireless Module Connection

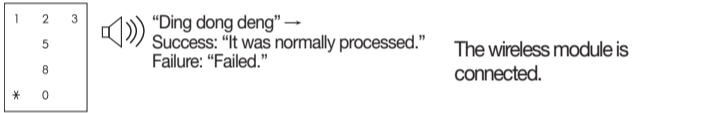

"Ding dong deng" — Success: "It was normally processed." Failure: "Failed." The wireless module is connected.

• A wireless module not sold by Samsung cannot be arbitrarily connected and used.  
• For the wireless module, it may be impossible to purchase depending on the situation by country.  
• When a wireless module is linked, up to 20 user passwords can be registered. (Only for Zigbee / Z-wave module).

13

## Register a WiFi (OPTION)

When connecting a WiFi, a user can use App based various user services through WiFi.

WiFi connection is activated only when the door is closed. (WiFi band: 2.4 GHz)

### App Installation and Use

Install the 'Samsung Smart Doorlock' app from Google Play/App Store. (Chinese users can install the Android app from Baidu, Tencent, or Qihoo360.) After becoming a member, a WiFi can be connected.

- For the information on the registration and the use method, refer to the guide provided from the app.

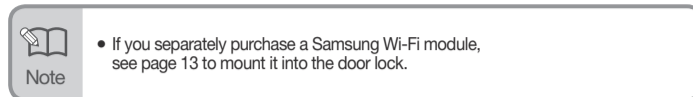

## Initialization

All registered data are deleted.

### 1. Press and Hold [Register] Button

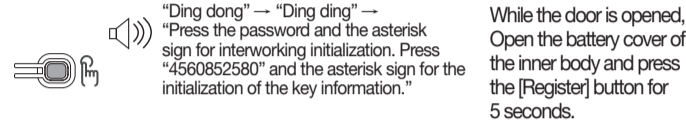

"Ding dong" — "Ding ding" — "Press the password and the asterisk sign for interworking initialization. Press "4560852580" and the asterisk sign for the initialization of the key information."

While the door is opened, Open the battery cover of the inner body and press the [Register] button for 5 seconds.

#### [Initialize the linked information]

- WiFi linkage: Initialize the mobile key and WiFi registration information.
- The master/user passwords and the fingerprint information are maintained.

### 2. Enter Master Password

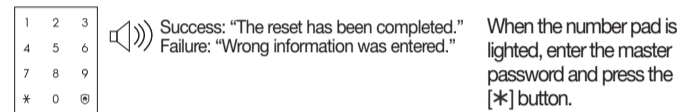

Success: "The reset has been completed." Failure: "Wrong information was entered."

When the number pad is lighted, enter the master password and press the [\*] button.

#### [Initialize the key information]

The master/user passwords key tags, and fingerprint information can be initialized.

- WiFi linkage: The mobile key is initialized and the WiFi registration information is maintained.
- Link of a wireless module: The linked information is maintained.

### 2. Enter Initialization Number of Key Information.

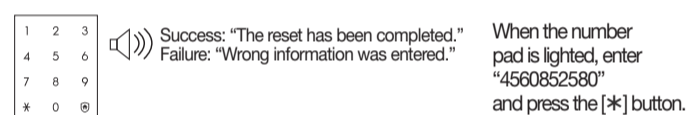

Success: "The reset has been completed." Failure: "Wrong information was entered."

When the number pad is lighted, enter "4560852580" and press the [\*] button.

## Setting Mode

You can set various functions of the door lock.

In the Setting mode, select a function.

(For the details of each function, refer to page 15-20.)

※ In the Setting mode, be careful that the door is not locked even though it is closed during the setting time (60 seconds). To cancel the Setting mode, press the Register button section of the inner body.

### 1. [Register] Button

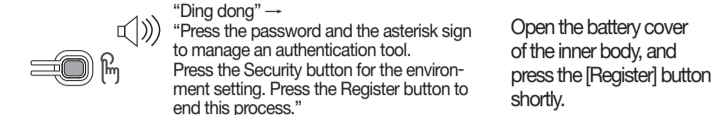

"Ding dong" — "Press the password and the asterisk sign to manage an authentication tool. Press the Security button for the environment setting. Press the Register button to end this process."

Open the battery cover of the inner body, and press the [Register] button shortly.

### 1. [Security] Button



"Setting mode." Press "1" and the asterisk sign for the Welcome function. Press "2" and the asterisk sign for the Randomizer. Press "3" and the asterisk sign for the Dual authentication. Press "4" and the asterisk sign for the Door close time. Press "5" and the asterisk sign for the Voice guidance. Press "9" and the asterisk sign for Wi-Fi."

Press the [Security] button.

## Welcome Function

When a user approaches a door lock, the door lock gets automatically in the authentication standby status even though the user does not touch the number pad or the fingerprint authentication part.

By default, the Welcome function is set, and the Security mode is deactivated. In addition, the detection distance is set to Middle distance.

### 1. Enter Setting Mode

Select the Setting mode. (Refer to the Setting mode.)

### 2. Select Welcome Function Setting Mode

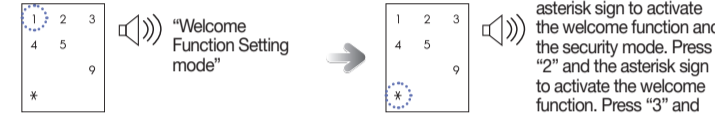

"Welcome Function Setting mode"

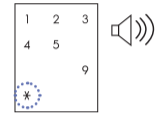

"Press "1" and the asterisk sign to activate the welcome function and the security mode. Press "2" and the asterisk sign to activate the welcome function. Press "3" and the asterisk sign to deactivate the welcome function. Press "4" and the asterisk sign to set the identification range."

Press the [1] button.  
- To hear the announcement again, press a number button before pressing the [\*] button.

Press the [\*] button.

#### [Set the welcome function and the security mode]

- Welcome function setting: When a user approaches to the door lock, the authorization standby mode will automatically activate.
- Security mode setting: When someone is in front of the door lock for a minute or longer, an alarm sound is generated.

### 3. Set the welcome function and the security mode

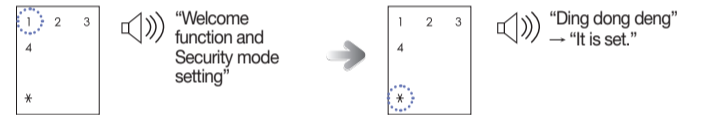

"Welcome function and Security mode setting"

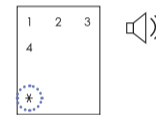

"Ding dong deng" — "It is set."

Press the [1] button.  
- To hear the announcement again, press a number button before pressing the [\*] button.

Press the [\*] button.

14

#### [Set the welcome function and deactivate the security mode]

### 3. Select Welcome Function Setting and Security Mode Cancellation

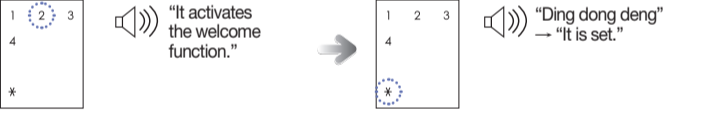

"It activates the welcome function." "Ding dong deng" — "It is set."

Press the [2] button.  
- To hear the announcement again, press a number button before pressing the [\*] button.

Press the [\*] button.

#### [Deactivate the Welcome function]

- Welcome function deactivation Even though a user approaches a door lock, the door lock does not get automatically in the authentication standby status. Touch the number pad or contact your fingerprint the fingerprint authentication part to use the door lock.

### 3. Select Welcome Function Cancellation

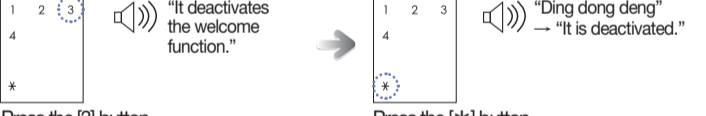

"It deactivates the welcome function." "Ding dong deng" — "It is deactivated."

Press the [3] button.  
- To hear the announcement again, press a number button before pressing the [\*] button.

Press the [\*] button.

#### [Set the detection distance]

A user can set the distance that can detect a user who approaches the door. (Short distance: About 40 cm, middle distance: About 60 cm, long distance: About 80 cm)

### 3. Select Detection Distance Setting

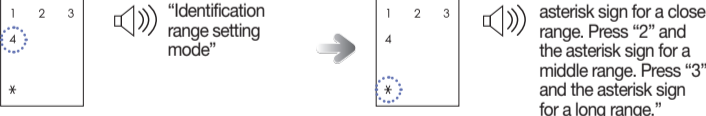

"Identification range setting mode" "Press "1" and the asterisk sign for a close range. Press "2" and the asterisk sign for a middle range. Press "3" and the asterisk sign for a long range."

Press the [4] button.  
- To hear the announcement again, press a number button before pressing the [\*] button.

Press the [\*] button.

### 4. Set Detection Distance

- Select the short distance setting

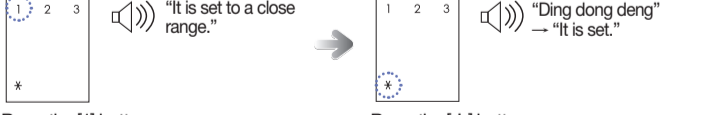

"It is set to a close range." "Ding dong deng" — "It is set."

Press the [1] button.  
- To hear the announcement again, press a number button before pressing the [\*] button.

Press the [\*] button.

- Select the middle distance setting



"It is set to a middle range." "Ding dong deng" — "It is set."

Press the [2] button.  
- To hear the announcement again, press a number button before pressing the [\*] button.

Press the [\*] button.

- Select the long distance setting



"It is set to a long range." "Ding dong deng" — "It is set."

Press the [3] button.  
- To hear the announcement again, press a number button before pressing the [\*] button.

Press the [\*] button.

16

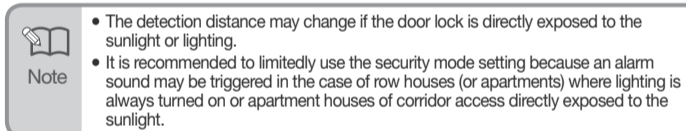

## Multi-Leveled Security Code Entry Mode

By pressing a password in order after two arbitrary numbers are inputted, a user can prevent password leak.

By default, the multi-leveled security code entry mode is set.

### 1. Enter Setting Mode

Select the Setting mode. (Refer to the Setting mode on page 15.)

### 2. Select Multi-Leveled Security Code Entry Mode Setting.

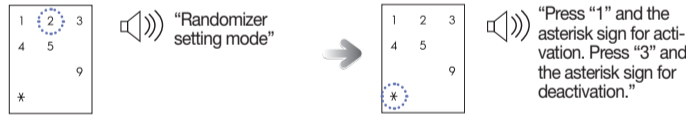

"Randomizer setting mode" "Press "1" and the asterisk sign for activation. Press "3" and the asterisk sign for deactivation."

Press the [2] button.  
- To hear the announcement again, press a number button before pressing the [\*] button.

Press the [\*] button.

### 3. Select Activation/Deactivation

- Select the setting

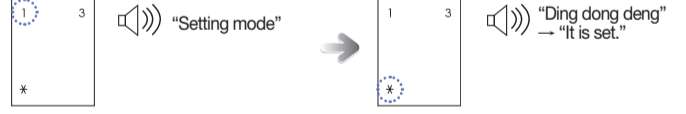

"Setting mode" "Ding dong deng" — "It is set."

Press the [1] button.  
- To hear the announcement again, press a number button before pressing the [\*] button.

Press the [\*] button.

- Select the deactivation (common mode)

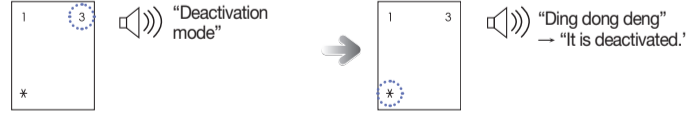

"Deactivation mode" "Ding dong deng" — "It is deactivated."

Press the [3] button.  
- To hear the announcement again, press a number button before pressing the [\*] button.

Press the [\*] button.

## Double Authorization Mode

Double authorization mode requires both password and fingerprint to open the door, enhancing more security.

To set the double authorization mode, one or more fingerprints need to be registered. When purchased, the door lock is not set to double authorization mode initially.

### 1. Enter Setting Mode

Select the Setting mode. (Refer to the Setting mode on page 15.)

### 2. Select Double Authorization Mode.

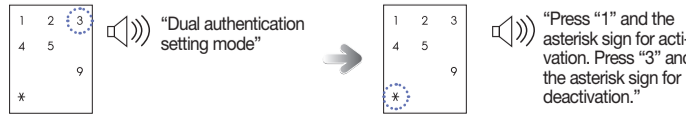

"Dual authentication setting mode" "Press "1" and the asterisk sign for activation. Press "3" and the asterisk sign for deactivation."

Press the [3] button.  
- To hear the announcement again, press a number button before pressing the [\*] button.

Press the [\*] button.

17

### 3. Select Activation/Deactivation

- Select the setting

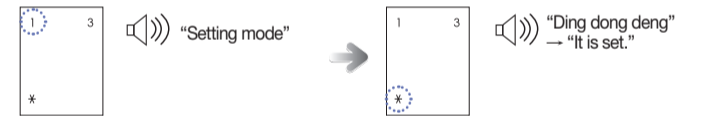

"Setting mode" "Ding dong deng" — "It is set."

Press the [1] button.  
- To hear the announcement again, press a number button before pressing the [\*] button.

Press the [\*] button.

- Select the deactivation (common mode)

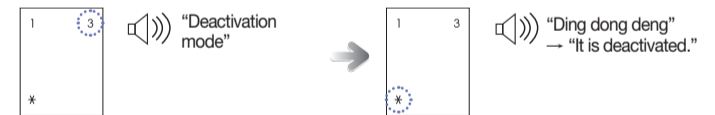

"Deactivation mode" "Ding dong deng" — "It is deactivated."

Press the [3] button.  
- To hear the announcement again, press a number button before pressing the [\*] button.

Press the [\*] button.

## Door Lock Closing Time Setup Function

This function sets the delay time of the door lock locking after open/close door sensor detects the door.

In an environment that the door closes slowly and the deadbolt jams before the door is fully closed, the situation can be fixed by adjusting the door lock closing time.

By default, the door lock closing time is set to 1 second.

### 1. Enter Setting Mode

Select the Setting mode. (Refer to the Setting mode on page 15.)

### 2. Select Door Lock Time Setting Mode



"Door closing time-setting mode" "Press "1" for one second and "2" for two seconds. Press a number from one to nine and the asterisk sign."

Press the [4] button.  
- To hear the announcement again, press a number button before pressing the [\*] button.

Press the [\*] button.

### 3. Set Time

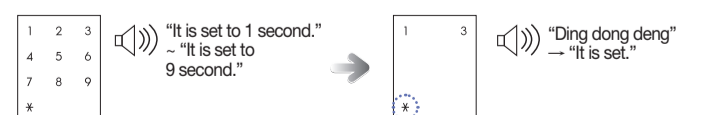

"It is set to 1 second." ~ "It is set to 9 second." "Ding dong deng" — "It is set."

Press [1] ~ [9] button.  
- To hear the announcement again, press a number button before pressing the [\*] button.

Press the [\*] button.

18

## Voice Guide Setting

Door lock functions are guided by voice. By default, the voice guide is set.

### 1. Enter Setting Mode

Select the Setting mode. (Refer to the Setting mode on page 15.)

### 2. Select Voice Guide Setting

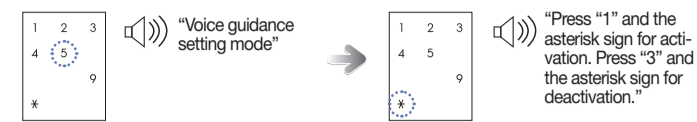

Press the [5] button.  
- To hear the announcement again, press a number button before pressing the [\*] button.

Press the [\*] button.

### 3. Select Activation/Deactivation

- Select the setting

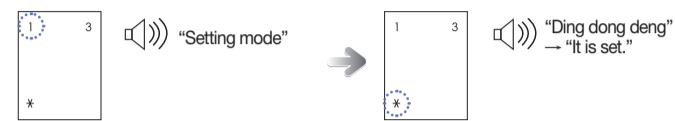

Press the [1] button.  
- To hear the announcement again, press a number button before pressing the [\*] button.

Press the [\*] button.

- Select the deactivation  
Even though this voice guide is deactivated, if an abnormal/emergency situation occurs, an alarm sound is generated. The voice guide for the low voltage notification, security assurance mode, and away security mode are not deactivated.

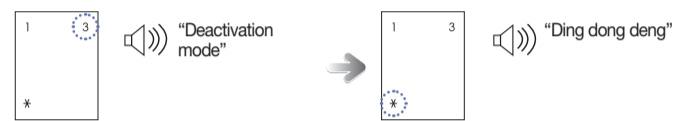

Press the [3] button.  
- To hear the announcement again, press a number button before pressing the [\*] button.

Press the [\*] button.

## WiFi Use

By default, the WiFi Use is set.

### 1. Enter Setting Mode

Select the Setting mode. (Refer to the Setting mode on page 15.)

### 2. Select WiFi Use Setting Mode



Press the [9] button.  
- To hear the announcement again, press a number button before pressing the [\*] button.

Press the [\*] button.

## [Activation/Deactivation Wi-Fi Use]

### 3. Select Activation/Deactivation

- Select the setting

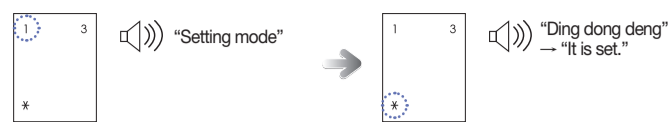

Press the [1] button.  
- To hear the announcement again, press a number button before pressing the [\*] button.

Press the [\*] button.

- Select the deactivation

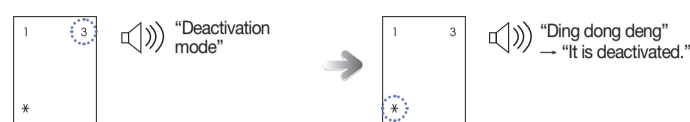

Press the [3] button.  
- To hear the announcement again, press a number button before pressing the [\*] button.

Press the [\*] button.

Note

- When WiFi Use is deactivated, a user cannot use various other services provided by the App.
- If you do not use the app, it is recommended to deactivate the use of WiFi.

## [WPS mode]

When an AP is changed while a WiFi is used after its registration, this WPS mode allows convenient setting from the connection to the security setting without complex process. This mode can be used only when an AP supporting the WPS. For the information on how to use the WPS of an AP refer to the AP user manual.

### 3. Select WPS of Changed AP

Select the WPS of a changed AP.

### 4. Select WPS

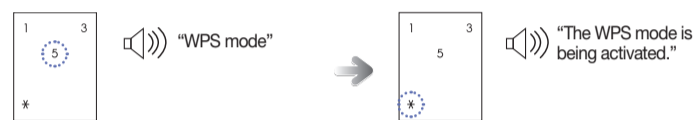

Press the [5] button.  
- To hear the announcement again, press a number button before pressing the [\*] button.

Press the [\*] button.

### 5. Connect to AP

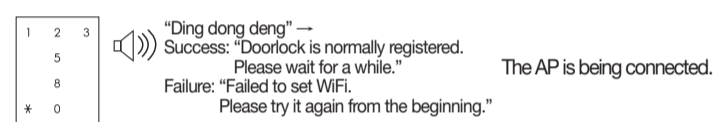

The AP is being connected.

Note

- WPS: WiFi Protected Setup
- If an AP does not support the WPS, take the WiFi registration procedure again to use the changed AP.
- For the information on the WiFi registration, refer to the page 14.

## Automatic/Manual Locking Setting

The Automatic Locking mode allows for automatic locking of the door when it is closed.



Open the battery cover of the inner body. Set the [Automatic/Manual Locking] toggle switch of the inner body to A/M position.

### Automatic

The door is automatically locked 1 second after the door is closed. If the battery low voltage voice message and an alarm sound are heard, replace the batteries. If the voltage of the door lock continues to be low, the door may not be locked.

### Manual

The door does not automatically lock, and the [DOUBLE LOCK] button must be pressed from the inside or touch [number pad] to close the door.

Note

- Regardless of the automatic/manual locking setting, the door will automatically lock 7 seconds after the door lock is unlocked if the door is not opened.

## Volume Setting

The sound that is generated when the number buttons are pressed, when the door is locked, or when the locked door is unlocked, can be set according to the user's preference.

When purchased, all sounds are set to be generated initially. (1 level)

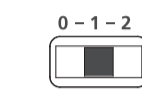

Open the battery cover of the inner body. Set the [Sound Control] switch to [0]-[2].

- [0]: The sounds of door opening/closing and key touching are not deactivated (except an alarm sound).  
- [1]-[2]: All sounds are activated, and the sounds get bigger as the step becomes higher.

## Door Bell Function

Approaching the door lock or touching the number pad (in the Welcome Function mode) when the door is closed will light up the number pad. Pressing the door bell LED in the number pad LED generates a bell sound to let a user in the house know there is a guest.

## Security Assurance Mode Activation/Deactivation

At-home security mode is to prevent opening of the door from outside while someone is inside.

### Security Assurance Mode Activation

Press the [DOUBLE LOCK] button on the indoor side for 3 seconds to prevent the door from opening with the smart detection while the door is locked.

### Security Assurance Mode Deactivation

Pull the inner body handle to open the door, and it will deactivate.



## Security Assurance Mode Operation

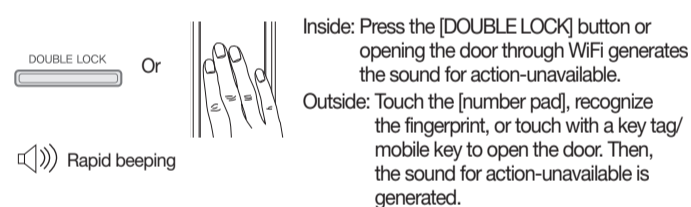

Inside: Press the [DOUBLE LOCK] button or opening the door through WiFi generates the sound for action-unavailable.  
Outside: Touch the [number pad], recognize the fingerprint, or touch with a key tag/mobile key to open the door. Then, the sound for action-unavailable is generated.

Warning

- When the security assurance function is activated, the door cannot be unlocked from the outside, so please be careful. Be especially careful not to allow children to set this mode accidentally from the inside.

## Away Mode and Anti unlock Activation/Deactivation

### Away Mode

To prevent intrusion when a user goes out, this function triggers an alarm sound when someone tries to open the door from the inside. In Away mode, if someone tries to open the door from the inside, "beep-beep" sound is triggered for 5 minutes.

### Anti unlock

When this function is activated, the internal handle will become tightened to prevent bypass attempts through door edge tools will be minimized.

### Away Mode Activation



Once the door is locked, the [ ] button of the number pad is lighted. Press the [ ] button within 3 seconds to activate the Away mode.

### Anti unlock Activation

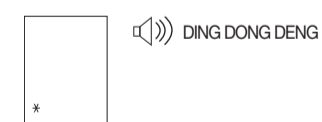

Press [\*] and hold. After 3 seconds, the alarm will be come active.

### Away Mode Deactivation

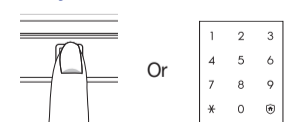

Enter the master/user password, touch a registered key tag/mobile key, recognize a fingerprint, or use WiFi, and open the door to deactivate the Away mode.

### Anti unlock Deactivation



Press the [DOUBLE LOCK] button to release the internal handle from Anti-Bypass function. When this function is active, it may be harder to pull the internal handle for elderly or children to open the door from inside.

Warning

- Anti unlock function should only be set up when there is no one inside.

## Intrusion Detection Function

This function triggers an alarm sound when an attempt is made to forcefully open the door from the inside or the outside. (It is a basic function, and cannot be activate/deactivated by the user.) If the door is forcefully opened while locked, the open/close door sensor detects it and triggers an alarm sound for 5 minutes.

## Prank Prevention Function

This function triggers an alarm sound and deactivates lock operation when the door lock is improperly handled from the outside. If a fingerprint/key tag/mobile key that are not registered or a wrong password are used five times, an alarm sound is generated and the door lock is deactivated for 3 minutes.

## Alarm Sound Deactivation

Open the battery cover on the inner body and press the [Register] button, or open the battery cover and separate the batteries. Authenticate a registered fingerprint/key tag/mobile key or pressing the master/user password and press the [\*] button.

## High Temperature Alarm Function

If the room temperature abnormally increases, the temperature sensor detects it and an alarm is triggered. (It is a basic function, and cannot be activate/deactivated by the user.) This high temperature alarm function is activated at about 70 °C±10 °C. Depending on the installation environment, the temperature may be different.

When a high temperature occurs, the temperature sensor detects it. The LED of the [DOUBLE LOCK] button on the inner body flashes while an alarm sound is generated for 15 seconds. After the alarm sound stops, the door is automatically opened. (If the room temperature decreases to below a certain temperature, the door lock is normally operated.)

## Battery Replacement

### Melody for low battery notification is triggered

When the door is opened by pressing a master/user password, recognizing a fingerprint or touching with key tag/mobile key, if the voice message, "Replace the batteries." is heard, the batteries should be replaced. (If the battery replacement alarm melody sounds, the battery replacement [ ] LED is lighted on the number pad.)

### Battery Replacement

When the battery replacement alarm voice is heard, immediately replace all batteries with new ones.  
- The unit will stop operating suddenly if the batteries are not replaced.

Warning

- Depending on battery manufacturer, date of manufacture, and the user environment, the duration of use may vary. (In the case of average use, given as 10 times a day, 8 AA alkaline 1.5V batteries can last for 10 months).
- Liquid leaks from batteries can damage the product. Check the batteries regularly (about every 6 months).
- Before the batteries are replaced after the battery replacement melody sounds, a menu function such as activating the registration/setting mode cannot be used.

## Emergency Power Use

If batteries are not replaced on time, they will be completely discharged and the lock will not operate.

### How to open the door Using Emergency Power

By connecting the Micro USB 5-pin cable of a smartphone portable charger, an extra power can be used for the door lock.

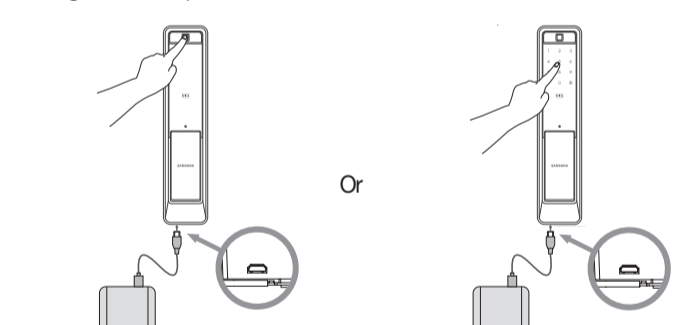

To open the door, connect a Micro USB 5-Pin cable from a smartphone portable charger to the Micro USB power input on the bottom of the outer body, and then authenticate the fingerprint or enter the password.

## Emergency Key Use

An emergency key is used when the door lock does not work because the battery replacement time comes or a circuit is wrong. There is the emergency key hole on the emergency key insertion part on the bottom of the outer body. Insert the emergency key and turn the key to release the lock.

Warning

- If you lose an emergency key, it is recommended to replace the entire key cylinder body. (Replacing the entire key cylinder body is paid by a user.)

## Product Specifications

Item	Specifications	
Voltage	Four AA Alkaline 1.5 V batteries (LR6) (DC 6 V)	
Emergency Power Source	Smartphone portable charger with Micro-USB 5-pin connector (sold separately)	
Operation Method	Authentication method (password, key tag, fingerprint, NFC, WiFi)	
Weight	3.430 kg (including both inner and outer bodies)	
Product Dimensions (including the handle)	Outer Body	88mm (W) x 392.1mm (H) x 63.8mm (D)
	Inner Body	86.2mm (W) x 391mm (H) x 68.5mm (D)