

SAMSUNG

SAMSUNG SDS



SHP-DH537

USER MANUAL

Samsung SDS Digital Door Lock

Convenient Opening

A user can conveniently open the door using key tag or password.

Silent Mode

When going in or out, the sound of the key entering and door opening will be suspended.

Security Assurance Function

When someone is inside the house, authorization for entry from the outside will be prohibited.

Away Security Function

When a user is outside the house, if the inside of the door lock is used, an alarm is generated.

High Temperature Alarm

If the inside of a house has a very high temperature, the door lock will be automatically unlocked.

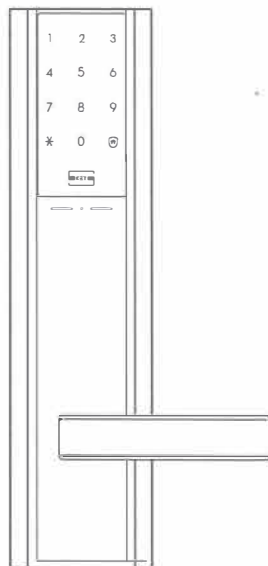

Call to our Sales Team: 65898484 (Office) | 87666971 (Michelle) | 94666676 (Jess) | 86455549 (Niko) | 88137317 (Jerome) | 91154094 (Leon)

smarthome.samsungsds.com

Safety Cautions



Warning

This section contains important information to ensure the user's safety and prevent potential damage to property. Please, read this section carefully and use the product accordingly.

- The user shall not install or repair the product without authorization.
- Do not install the product in the place where the gap between the door and the frame is 5 mm or more.
- Long-term exposure to direct sunlight may cause a crack on its touchpad. Avoid exposure to direct sunlight.
- Do not use excessive force or sharp objects to push the lock buttons, as this can damage the product.
- Do not operate the product with wet hands, and keep liquids such as water or drinks away from the product, or the product may malfunction or be damaged.
- Do not use water, benzene, or alcohol when cleaning the product, but use a soft dry cloth.
- Make sure that the door is completely closed when going outside.
- Make sure that no unauthorized person has access to the password. Change it regularly.
- Be sure to correctly match the ends (+/-) when installing the batteries. Wrong insertion direction or ends of batteries may cause batteries to burst or liquid leakage.
- When the battery replacement alarm melody is heard, replace all existing batteries with new ones.
- Depending on the wireless communication environment, battery consumption may increase.
- Interference in wireless communication may occur when this product is used, or radio interference may occur from other devices.
- As this radio system may have radio interference during the operation, it cannot provide a service for human lives.
- Excessive dew condensation may adversely affect the performance of this product.

※ Customer's improper installation may result in additional service costs. We highly recommend professional installation.

※ The information of this user manual may vary without any notices to improve the performance of this product.

Product Components

The product components may vary depending on the installation environment.

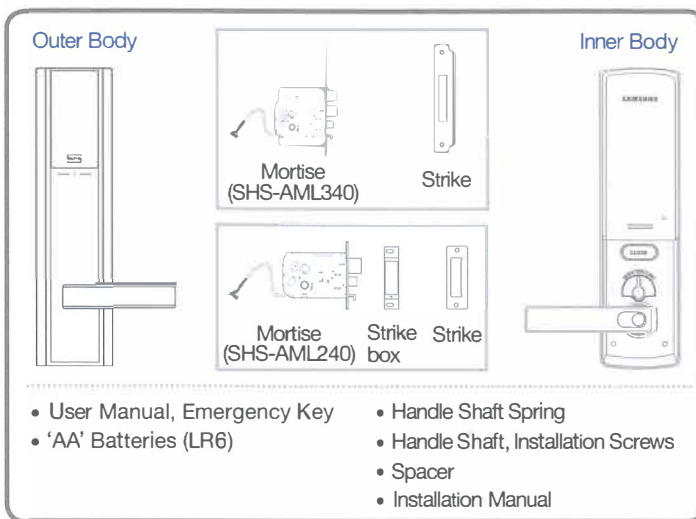

Outer Body Parts

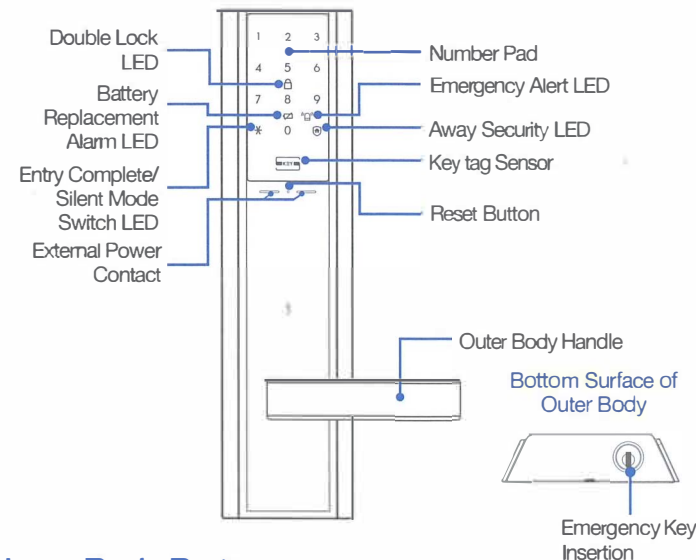

Inner Body Parts

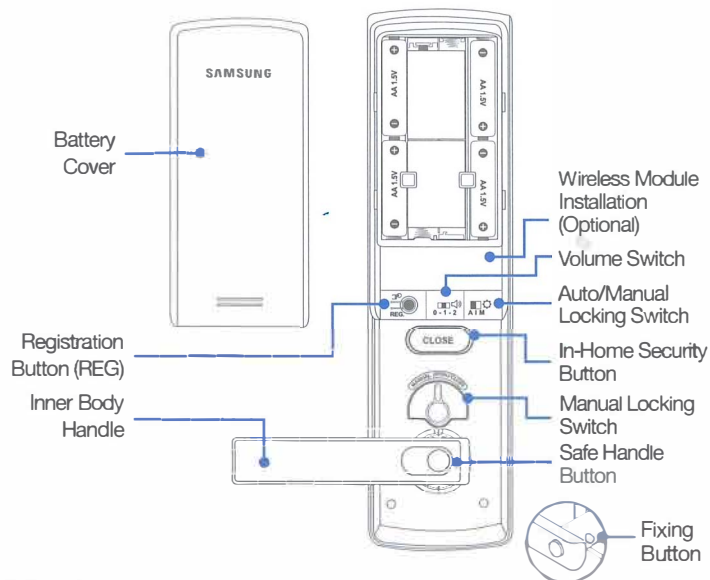

Mortise

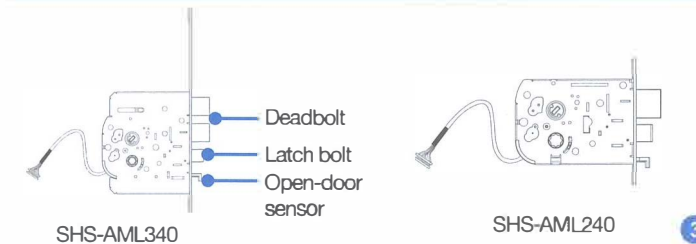

Opening the Door from Outside (Password)

When purchased, the product is set to Multi-level Security Code Entry Mode initially. Please, refer to "Multi-level Security Code Entry Mode setting" for Common Mode setting.

※ Silent Mode

Before entering a password, press the [*] button and enter the password, then both the sound of the key entering and the door opening will be suspended. It is a useful function if you do not want to disturb neighbors when you go in and out at night.

1. Multi-level Security Code Entry Mode

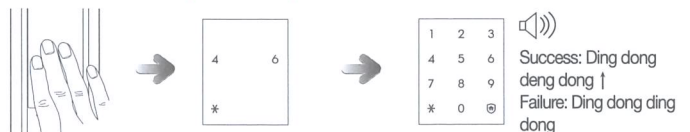

Touching the [number pad] will light up the number pad.

When two arbitrary buttons are lighted, touch the buttons in order.

When the numbers on the number pad are lighted, enter the password and touch the [*] button.

2. General Mode



Touching the [number pad] will light up the number pad.

Enter the password and touch the [*] button.



Note

- A password must be entered after the light is on. If not, touch the [number pad] and re-enter the password.
- To cancel the password entry, press the [Ⓜ] button and re-enter the password.
- If the password is entered wrong 5 times in a row, a warning sound, "Bbri-bbri-bbri," will be generated 20 times, and the system will shut down for about 3 minutes. When malfunction happens, a "beep" will sound every 10 seconds, and the entry block mode will be turned off automatically after 3 minutes with the sound of "beep beep beep beep beep beep."

Opening the Door from the Inside

Fix the Safe Handle Button

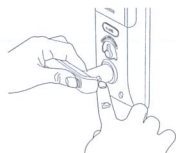

While pressing the safe handle button, press the Fixing button.

Open the Door While the Fixing Button is Pressed



Pull down the handle to open the door.

Use the Manual Locking Switch



Turn the Manual Locking Switch left or right on the inner body to lock or unlock the door.



Note

- To prevent an intrusion, it is recommended to close the door while the Fixing button is not pressed.
- When frequently going in and going out, press the Fixing button to conveniently open the door.

Unfix the Safe Handle Button

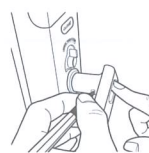

While pressing the safe handle button, push the Fixing button (using a ballpoint pen, etc.) to protrude it again.

Open the Door While the Fixing Button is Not Pressed



Press the safe handle button, and pull down the handle to open the door.

Opening the Door from the Outside (Key tag)

A locked door can be opened from the outside by using a key tag. Place the registered key tag on the key tag detector.

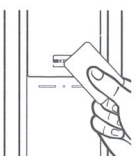

Success: Ding dong deng dong ↑
Failure: Ding dong ding dong

Place the key tag. The door will be opened after about 1 second.

Locking the Door from the Inside

Automatic Locking Setting

The door is automatically locked 1 second after the door is closed.

Manual Locking Setting



Touch the [In-Home Security] button to close the door.



Note

- If you want to check the door status in the house, briefly touch the In-Home Security button. If the door is locked, the red LED blinks. If not, the green LED blinks.

Menu

※ All registration and setting are activated only when the door is opened.

Registration Mode

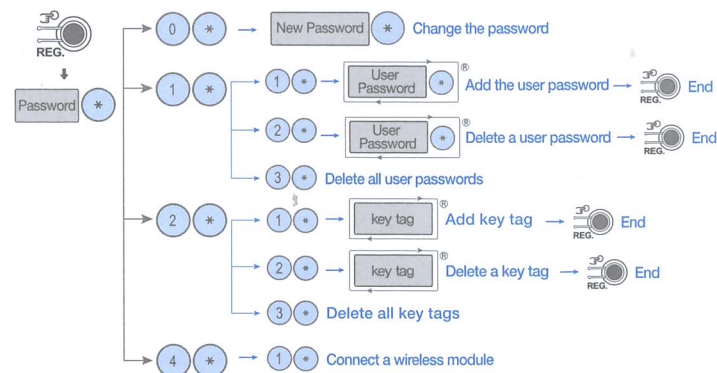

Setting Mode

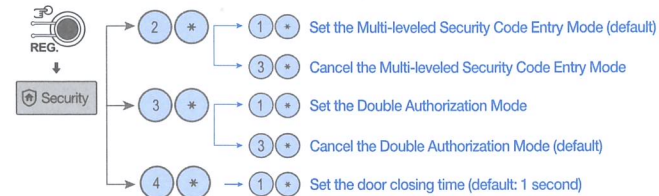

Initialization Mode

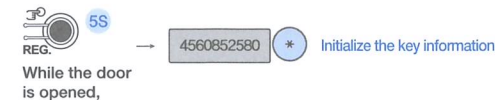

Number Pad Guide

The number pad of the door lock shows diverse settings.

Successful registration and setting (O)

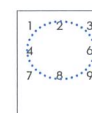

Failed registration and setting (X)

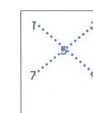

Additional registration (+)

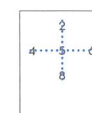

Individual deletion (-)

