

Please Read Before Application

1. Our Static Cling film is applied onto the inside of windows.
2. Do not use on windows with visible flaws, cracks or nicks. Do not use on non-tempered Low-e glass.
3. Either side of the film can be applied to the window. The film will be applied as is. There is no backing to be removed.
4. Mix the "tint-on" solution into the included spray bottle before starting. (Included in the tool kit)



How to Mix Solution: Pour the packet labeled "tint-on" solution into the bottle. Fill bottle with water. Mix well.

*Note: If you did not purchase a tool kit with provided solution, soapy water (dish soap) can be used as application solution.

Installation Tool Kit: Tool kit is not included and must be purchased separately.

Removing & Storing: Keep the white paper liner if you would like to store and reuse the film in the future. For removing, peel film off from a corner of the window. Pull gently. For storing, place the removed film on the liner. Roll it up and store at room temperature. When reusing, unroll and use soapy water to clean the film before applying again.

Please Note: The film partially absorbs heat, making the film hot to the touch. To test the amount of heat that is being blocked, place your hand in front of the window (not touching the window) with the film applied and also feel the window without the film to feel the difference.

Test the UV blocking: A specific UV machine needs to be used to measure the amount of UV that is being blocked.

Step 1. Clean & Cut



A. Clean window thoroughly. Spray mixed solution and use scraper to remove dirt if needed.

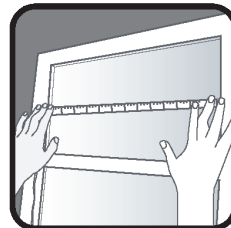

B. Measure the width and height of windows. Cut the film accordingly. You can leave 1 inch on length and width to ensure you cover the entire window. The excess can be trimmed after installation.

Step 2. Apply & Squeegee

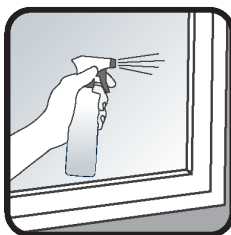

A. Make sure the glass is clean. Spray the film and window with solution and place the film onto the window. Slide the film and make sure it covers all edges of the window.

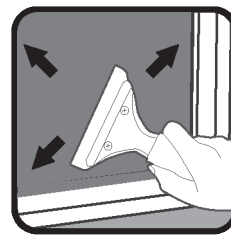

B. Spray the film with solution. Start to squeegee from the center of the window to all edges. Be sure to apply firm pressure to ensure all solution is removed.

Tip: If there's dirt under the film, you can slightly peel off the film to clean the surface and repeat the above steps.

Step 3. Trim & Squeegee

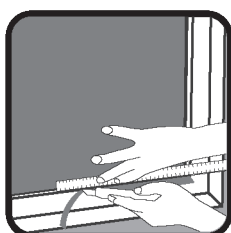

A. To trim the excess film, firmly press down on the edge of the window using cutting stick and trim excess film with trimming knife. Repeat step 2B to finish installation and ensure all solution is removed from under the film.

Caution

- Please keep cutting knife out of reach of children.
- In case application solution comes in contact with eyes, flush thoroughly with water. If irritation persists, seek medical attention.
- Do not use or move windows for 48 hours after application.
- Do not use suction cup on window for 48 hours.

Thank you for your purchase. Please contact us if you have any questions or concerns.

Instik | www.instikshop.com | Tel: (972)-247-1176

Monday - Friday: 9:00 AM - 5:00 PM (Central Time Zone) Sat & Sun: Closed