



### STANDARD FEATURES

- Single or double side sealed burner(s) configurations
- Double side burners: 20,000 Btu/hour brass front burner and 10,000 Btu/hour brass rear burner
- Single side burner: 20,000 Btu/hour brass sealed burner
- 5/16" thick DiamondCut™ grate

Lasered Stainless Steel Grate - 5/16" thick



Bright LED Lighting



Sealed Burner Bowl



Stainless Cover



- Sealed burner bowl with drain tube for easy cleaning
- Electronic ignition system with re-ignition capability
- LED lighting on front control panel
- Heavy gauge welded body construction
- Stainless steel drip tray for ease of cleaning
- Stainless steel top cover
- Double side burner is mountable to Tower Carts
- 120V, 60Hz, 1 amp



Model shown AGB121-LP

Model shown AGB122-LP

### OPTIONS & ACCESSORIES

- Natural Gas (NG) or Liquid Propane (LP)
- Twelve (12) Hestan signature color finishes
- High altitude kit
- Carbon Fiber Vinyl Cover



Shown attached to Tower Cart

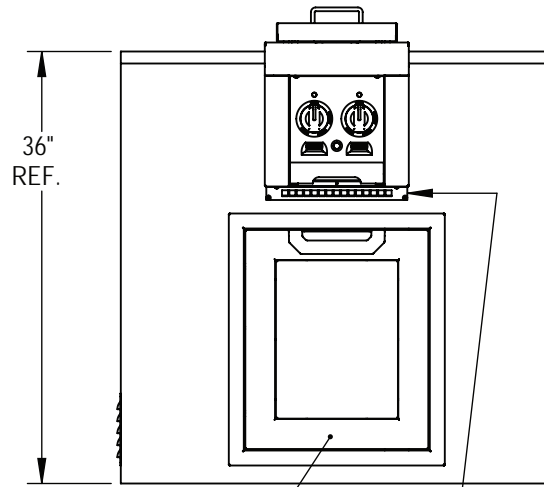

36" REF.

HESTAN ACCESS DOOR (SOLD SEPARATELY)

INSTALL THIS TRIM AFTER SIDE BURNER INSTALLATION

3-1/2" X 5-1/2" OPENING FOR GAS SUPPLY & ELECTRICAL

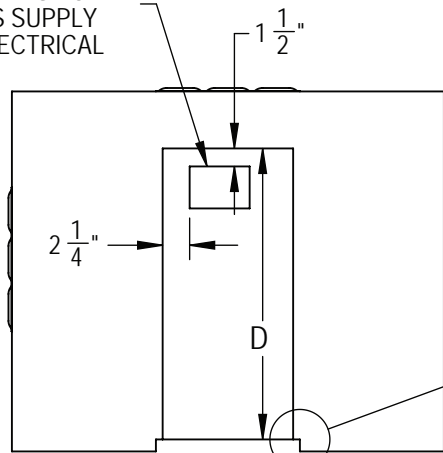

TOP VIEW

9/16" NOTCH

1" MAX. COUNTERTOP OVERHANG

LAYOUT FOR NON-COMBUSTIBLE ENCLOSURE (ISLAND)

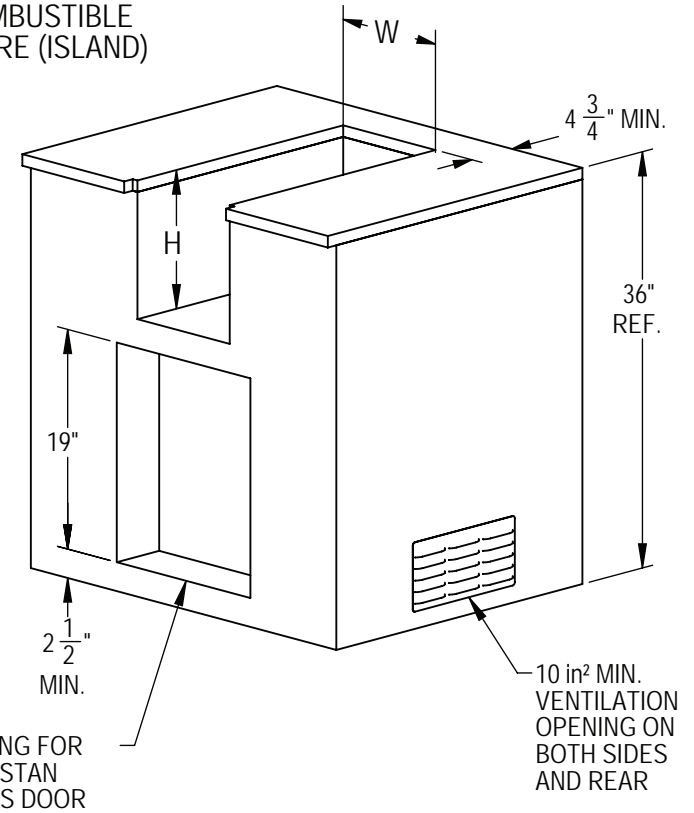

OPENING FOR HESTAN ACCESS DOOR

10 in<sup>2</sup> MIN. VENTILATION OPENING ON BOTH SIDES AND REAR

**ELECTRICAL REQUIREMENTS** : 120V, 60Hz, 6 amps

**GAS REQUIREMENTS** : 1/2" NPT gas connection. Minimum gas supply is 7" water column for natural gas and 11" for propane. Operating pressure at the manifold is 4" water column for natural gas and 10" for propane. All units require a regulated gas supply.



All Models	Description	Cutout Dimensions			Total Btu's	Approx SHP WT
		W(in.)	D(in.)	H(in.)		
AGB121-NG / -LP	Single Side Burner, Built-in, 12"	11	13 <sup>7</sup> / <sub>8</sub>	12	20000	000
AGB122-NG / -LP	Double Side Burner, Built-In or Cart-Attached 12"	11	24 <sup>1</sup> / <sub>4</sub>	12	30000	000