

# **SECTION 3**

## **ELECTRICAL**

ELECTRICAL (OLYMPIC)

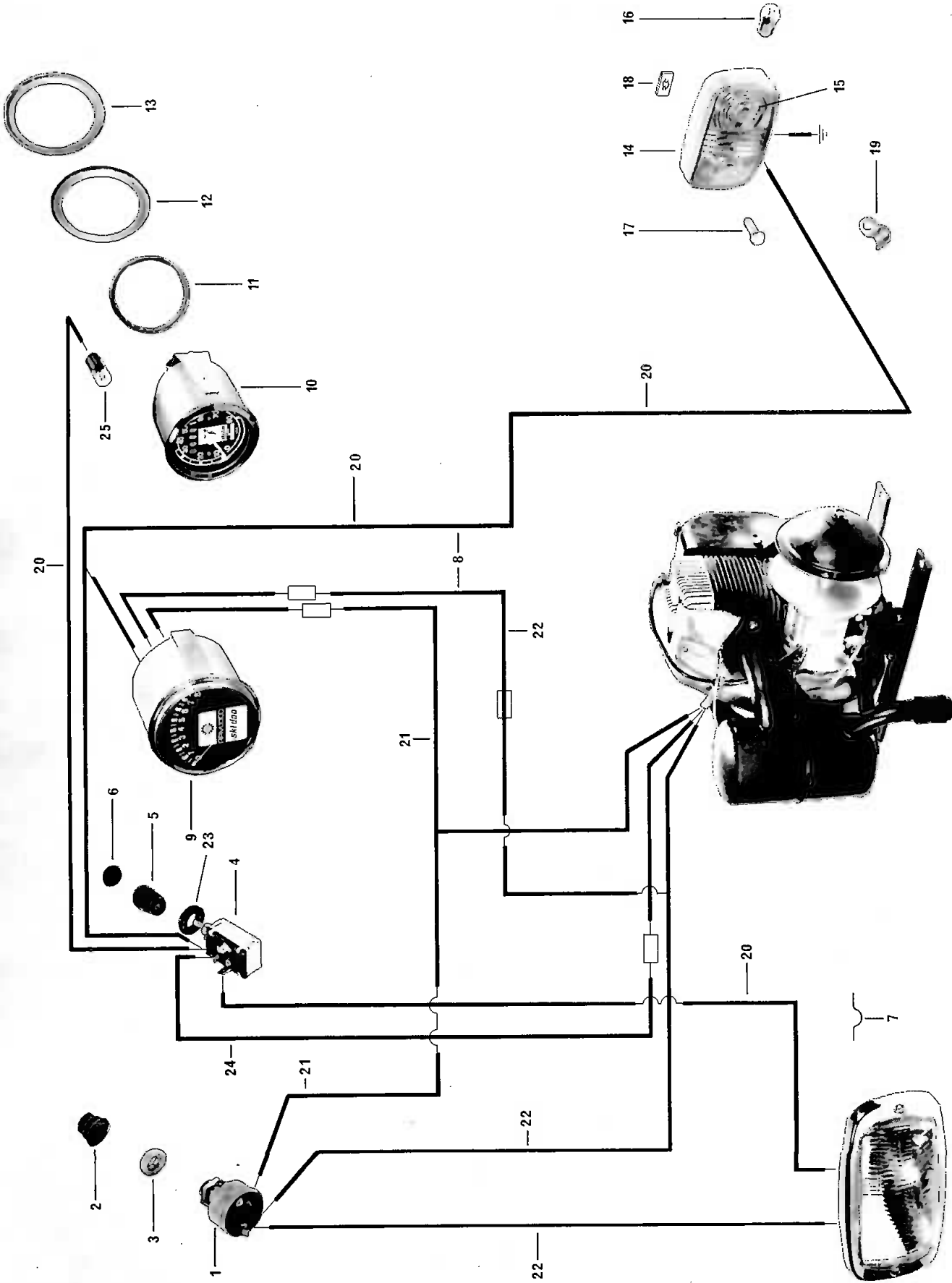

ELECTRICAL (OLYMPIC)

ITEM NO.	PART NO.	DESCRIPTION	QUANTITY						
			12/3	335	399	TNT 292	TNT 340	TNT 292S	TNT 340S
1	410 1006	Ignition Switch .....	1	1	1	1	1	1	1
2	670 1503	Ignition Switch Boot .....	1	1	1	1	1	1	1
3	410 1008	Face Nut .....	1	1	1	1	1	1	1
4	410 1004	Headlight Switch .....	1	1	1	1	1	1	1
5	414 0251	Headlight Switch Knob .....	1	1	1	1	1	1	1
6	414 0345	Knob Decal .....	1	1	1	1	1	1	1
7	5150102	Wire Clamp .....	1	1	1	1	1	1	1
8	515 0175	Harness Ass'y .....	1	1					
8	515 0206	Harness Ass'y .....			1				
8	515 0203	Harness Ass'y .....				1	1	1	1
9	414 0341	Tachometer .....				1	1	1	1
10	414 0193	Speedometer .....				1	1	1	1
11	414 0194	Shock Absorber .....				1	1	1	1
12	414 0499	Speedo Outer Ring .....				1	1	1	1
13	414 0500	Speedo Inner Ring .....				1	1	1	1
14	410 6007	Tail Lamp Ass'y .....	1	1	1	1	1	1	1
15	410 9019	Tail Lamp Lens .....	1	1	1	1	1	1	1
16	410 5006	Tail Lamp Bulb .....	2	2	2	2	2	2	2
17	321 6046	Screw .....	2	2	2				
17	321 6043	Screw .....				2	2	2	2
18	389 8010	Nut .....	2	2	2	2	2	2	2
19	517 0096	Clip .....	1	1	1				
20	409 6020	Wire Brown 16 Ga. Mult 12'' .....	AR	AR	AR	AR	AR	AR	AR
21	409 6021	Wire Black 16 Ga. Mult 12'' .....	AR	AR	AR	AR	AR	AR	AR
22	409 6022	Wire Yellow 16 Ga. Mult 12'' .....	AR	AR	AR	AR	AR	AR	AR
23	410 1010	Headlight Switch Face Nut .....	1	1	1	1	1	1	1
24	409 6028	Wire Red W/Stripped White 16 Ga. Mult 12'' .....	AR	AR		AR	AR	AR	AR
24	409 6079	Red/WStripped Violet 16 Ga. Mult 12'' .....			1				
25	410 5010	Speedo Bulb .....				1	1	1	1
-	410 9040	Spirap Tubing Mult. 12'' .....	AR	AR	AR	AR	AR	AR	AR
-	409 9001	Housing 3/16 Ø Mult 12'' .....	AR	AR	AR	AR	AR	AR	AR
-	099 0004	Vinyl Tape .....	AR	AR	AR	AR	AR	AR	AR



ELECTRICAL (NORDIC)

ITEM NO.	PART NO.	DESCRIPTION	QUANTITY				
			399	TNT 399	TNT 640	TNT 399S	TNT 640S
1	410 1006	Ignition Switch .....	1	1	1	1	1
2	670 1503	Ignition Switch Boot .....	1	1	1	1	1
3	410 1008	Face Nut .....	1	1	1	1	1
4	414 0501	Ignition Sticker .....		1	1	1	1
5	410 1004	Headlight Switch .....	1	1	1	1	1
6	414 0251	Headlight Switch Knob .....	1	1	1	1	1
7	414 0345	Headlight Switch Knob Decal .....	1	1	1	1	1
8	414 0502	Light Sticker .....		1	1	1	1
9	515 0178	Harness Ass'y .....	1				
9	515 0200	Harness Ass'y .....		1	1	1	1
10	414 0341	Tachometer .....		1	1	1	1
11	414 0193	Speedometer .....		1	1	1	1
12	414 0194	Shock Absorber .....		1	1	1	1
13	414 0499	Speedo Outer Ring .....		1	1	1	1
14	414 0500	Speedo Inner Ring .....		1	1	1	1
15	410 6007	Tail Lamp Ass'y .....	1	1	1	1	1
16	410 9019	Tail Lamp Lens .....	1	1	1	1	1
17	410 5006	Tail Lamp Bulb .....	2	2	2	2	2
18	321 6046	Screw .....	2				
18	321 6043	Screw .....		2	2	2	2
19	389 8010	Nut .....	2	2	2	2	2
20	517 0096	Clip .....	1				
21	409 6029	Wire Red W/Stripped Violet 16 Ga. Mult. 12'' .....	AR	AR	AR	AR	AR
22	409 6020	Wire Brown 16 Ga. Mult. 12'' .....	AR	AR	AR	AR	AR
23	409 6021	Wire Black 16 Ga. Mult. 12'' .....	AR	AR	AR	AR	AR
24	409 6022	Wire Yellow 16 Ga. Mult. 12'' .....	AR	AR	AR	AR	AR
25	410 1010	Headlight Switch Face Nut .....	1	1	1	1	1
26	410 5010	Speedometer Bulb .....		1	1	1	1
-	099 0004	Vinyl Tape .....	AR	AR	AR	AR	AR
-	409 9001	Housing 3/16 Ø Mult. 12 .....	AR	AR	AR	AR	AR
-	410 9040	Spirap Tubing Mult. 12'' .....	AR	AR	AR	AR	AR

ELECTRICAL (OLYMPIC NORDIC)

SFF-9 June

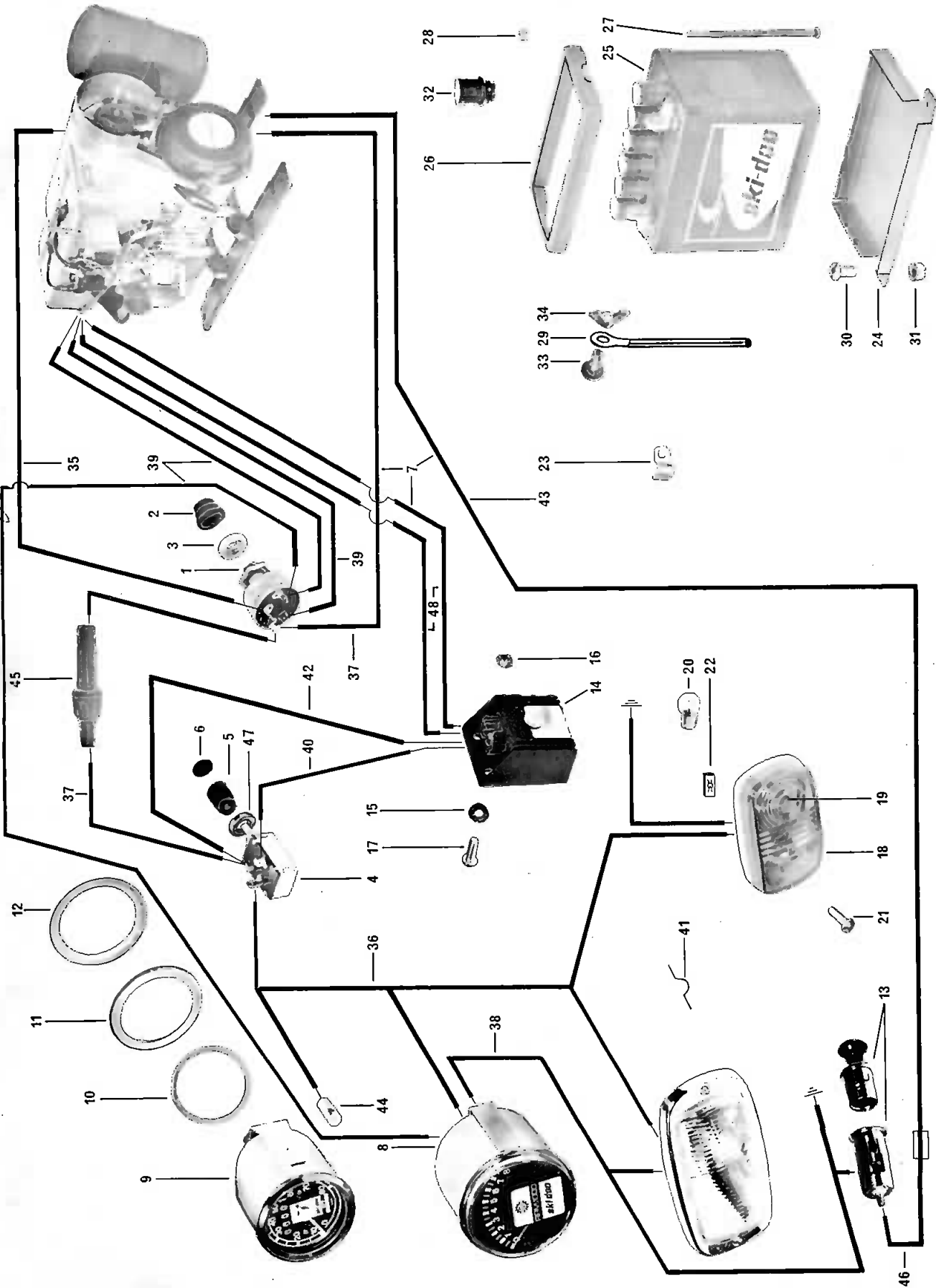

## ELECTRICAL (OLYMPIC NORDIC)

ITEM NO.	PART NO.	DESCRIPTION	QUANTITY		
			O 335E	N 399E	N 640E
1	410 1009	Ignition Switch .....	1	1	1
2	670 1503	Ignition Switch Boot .....	1	1	1
3	410 1008	Face Nut .....	1	1	1
4	410 1004	Headlight Switch .....	1	1	1
5	414 0251	Headlight Switch Knob .....	1	1	1
6	414 0345	Knob Decal .....	1	1	1
7	515 0183	Harness Ass'y .....	1		
7	515 0182	Harness Ass'y .....		1	
7	515 0195	Harness Ass'y .....			1
8	414 0341	Tachometer .....			1
9	414 0193	Speedometer .....			1
10	414 0194	Shock Absorber .....			1
11	414 0499	Speedo Outer Ring .....			1
12	414 0500	Speedo Inner Ring .....			1
13	414 0317	Lighter .....		1	1
14	410 9032	Rectifier W/Fuse .....	1	1	1
15	399 9015	Washer .....	2		
15	399 9018	Washer .....		2	2
16	386 9003	Nut .....	2		
16	387 3013	Nut .....		2	2
17	320 9061	Screw .....		2	2
18	410 6007	Tail Lamp Ass'y .....	1	1	1
19	410 9019	Tail Lamp Lens .....	1	1	1
20	410 5006	Tail Lamp Bulb .....	2	2	2
21	321 6046	Screw .....	2	2	2
22	389 8010	Nut .....	2	2	2
23	517 0096	Clip .....	1	1	1
24	515 0135	Battery Seat .....	1	1	1
25	410 3002	Battery .....	1	1	1
26	515 0156	Battery Cover .....	1	1	1
27	300 4026	Screw .....	2	2	2
28	387 0019	Nut .....	2	2	2
29	409 6006	Ground Wire .....	1	1	1
29	409 6007	Current Wire .....	1		
29	409 6023	Current Wire .....		1	1
30	321 7100	Screw .....	2	2	2
31	387 0019	Nut .....	2	2	2
32	410 3004	Battery Cap .....	6	6	6
33	360 5020	Bolt (N) .....	1	1	1
33	360 5050	Bolt (P) .....	1	1	1
34	386 4019	Wing Nut (N) .....	1	1	1
34	386 4022	Wing Nut (P) .....	1	1	1
35	109 5022	Wire Green 14 Ga. Mult. 12'' .....	AR	AR	AR
36	409 6020	Wire Brown 16 Ga. Mult. 12'' .....	AR	AR	AR
37	409 6025	Wire Red 14 Ga. Mult. 12'' .....	AR	AR	AR
38	409 6022	Wire Yellow 16 Ga. Mult. 12'' .....	AR	AR	AR
39	409 6021	Wire Black 16 Ga. Mult. 12'' .....	AR	AR	AR
40	409 6028	Wire Red W/Stripped White 16 Ga. Mult 12. ....	AR	AR	AR
41	515 0102	Wire Clamp .....	1		
42	409 6029	Wire Red W/Stripped Violet 16 Ga. Mult. 12'' .....		AR	AR
43	409 6024	Wire Violet 16 Ga. Mult 12'' .....		AR	AR
44	410 5010	Speedometer Bulb .....		1	1
45	410 9038	Fuse Holder .....	1	1	1
46	414 0436	Wire (Lighter) .....		1	
46	414 0479	Wire (Lighter) .....			1
47	410 1010	Headlight Switch Face Nut .....	1	1	1
-	409 9001	Housing 3/16'' Ø Mult. 12'' .....	AR	AR	AR
-	099 0004	Vinyl Tape .....	AR	AR	AR
-	570 1504	Pad Protector .....	1		
-	410 9040	Spirap Tubing Mult. 12'' .....	AR	AR	AR
48	409 6019	Wire Yellow W/Stripped Red 16 Ga. Mult. 12'' .....	AR	AR	AR

# HEADLAMP (OLYMPIC)

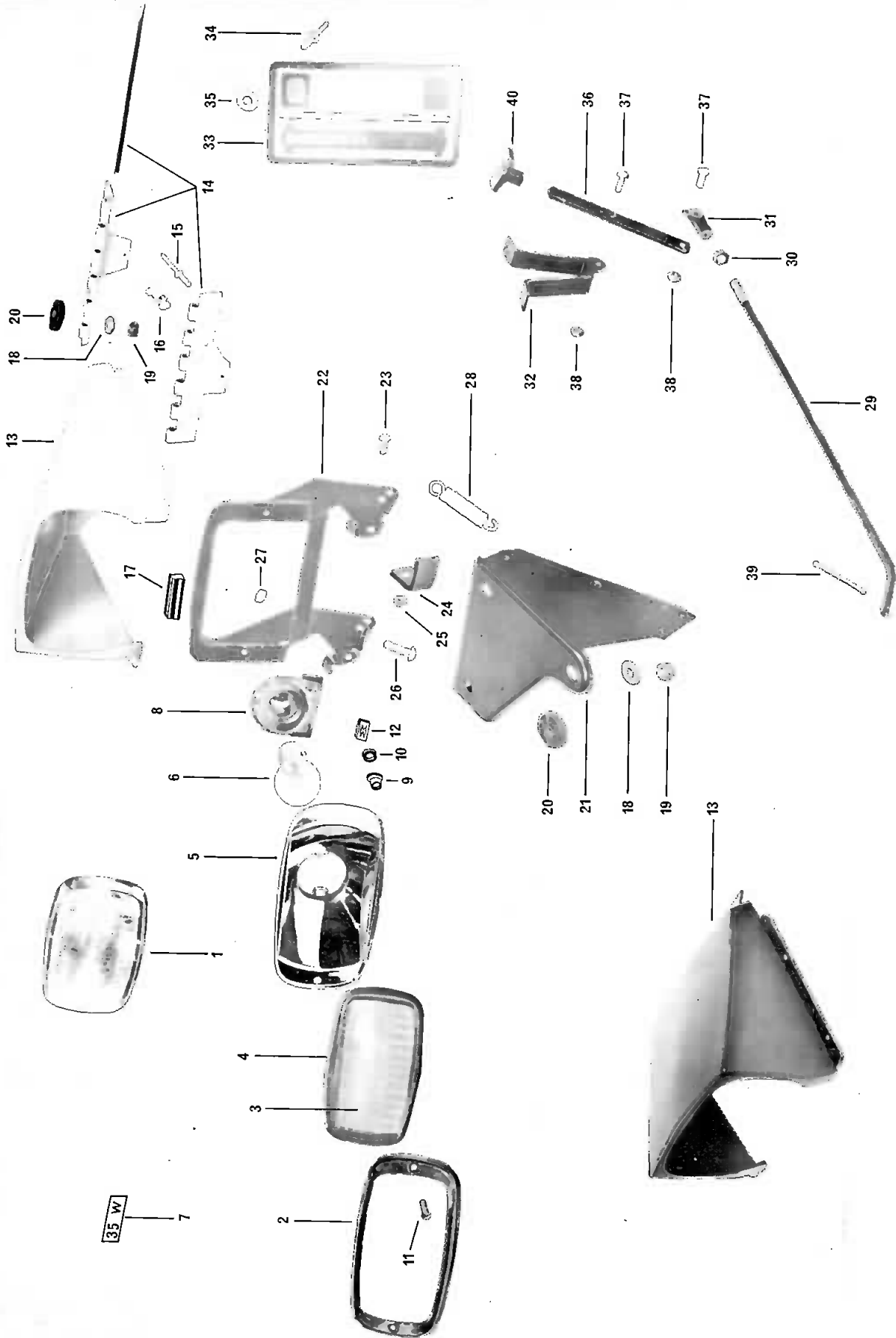



## HEADLAMP (OLYMPIC)

ITEM NO.	PART NO.	DESCRIPTION	QUANTITY							
			12/3	335	335E	399	TNT 292	TNT 340	TNT 292S	TNT 340S
1	410 6010	Projector Ass'y .....	1	1	1	1	1	1	1	1
2	410 6012	Chromed Ring .....	1	1	1	1	1	1	1	1
3	410 6014	Glass .....	1	1	1	1	1	1	1	1
4	410 6013	Rubber Ring .....	1	1	1	1	1	1	1	1
5	C.S.A.	Reflector .....	1	1	1	1	1	1	1	1
6	<del>410 5009</del>	Bulb 60W 35W <i>use 410 5017</i> .....	1	1	1		1	1	1	1
6	410 5011	Bulb 60W .....				1				
7	414 0280	Label 35W .....	1	1	1		1	1	1	1
7	414 0476	Label 60W .....				1				
8	410 6015	Socket .....	1	1	1	1	1	1	1	1
9	C.S.A.	Blank .....	2	2	2	2	2	2	2	2
10	C.S.A.	Washer .....	2	2	2	2	2	2	2	2
11	410 6011	Screw .....	2	2	2	2	2	2	2	2
12	389 8010	Nut .....	2	2	2	2	2	2	2	2
13	571 1733	Head Lamp Housing .....		1	1	1				
13	571 1760	Head Lamp Housing .....						1		1
14	582 1016	Hinge .....		1	1	1		1		1
15	390 4013	Rivet .....		4	4	4		4		4
16	414 0229	Housing Spring .....		1	1	1		1		1
17	107 7002	Spacer Strip (Mult. 12") .....	AR	AR	AR			AR		AR
18	399 9008	Washer .....		5	5	5		5		5
19	387 5019	Nut .....		5	5	5		5		5
20	570 1711	Insulator Rubber .....		10	10	10		10		10
21	515 0174	Head Lamp Support Bracket .....		1	1	1		1		1
22	515 0142	Head Lamp Ring .....		1	1	1		1		1
23	320 1062	Screw .....		1	1	1		1		1
23	320 1061	Screw .....		1	1	1		1		1
24	515 0157	Stop Bracket .....		1	1	1		1		1
25	387 3013	Nut .....		2	2	2		2		2
26	321 7103	Adjustment Screw .....		1	1	1		1		1
27	380 9019	Nut .....		1	1	1		1		1
28	414 0246	Head Lamp Spring .....		1	1	1		1		1
29	515 0188	Control Rod .....		1	1	1		1		1
30	380 9019	Nut .....		1	1	1		1		1
31	515 0189	Adjuster Tube .....		1	1	1		1		1
32	515 0190	Control Bracket .....		1	1	1		1		1
33	414 0326	Guide Plate .....		1	1	1		1		1
34	390 4003	Pop Rivet .....		4	4	4		4		4
35	399 9001	Flat Washer .....		4	4	4		4		4
36	515 0191	Control Lever .....		1	1	1		1		1
37	320 1063	Screw .....		2	2	2		2		2
38	387 3013	Nut .....		2	2	2		2		2
39	371 0011	Cotter Pin .....		2	2	2		2		2
40	414 0054	Control Knob .....		1	1	1		1		1

Symbol "C.S.A.": Part numbers coded "C.S.A." are for components superseded by complete. Individual parts are no longer available.

Symbole "C.S.A.": Les numéros de pièces avec le code "C.S.A." sont pour les pièces utilisées pour fabriquer une assemblée qui n'est plus disponible. Ces pièces sont remplacées par l'assemblée complète

# HEADLAMP (NORDIC)

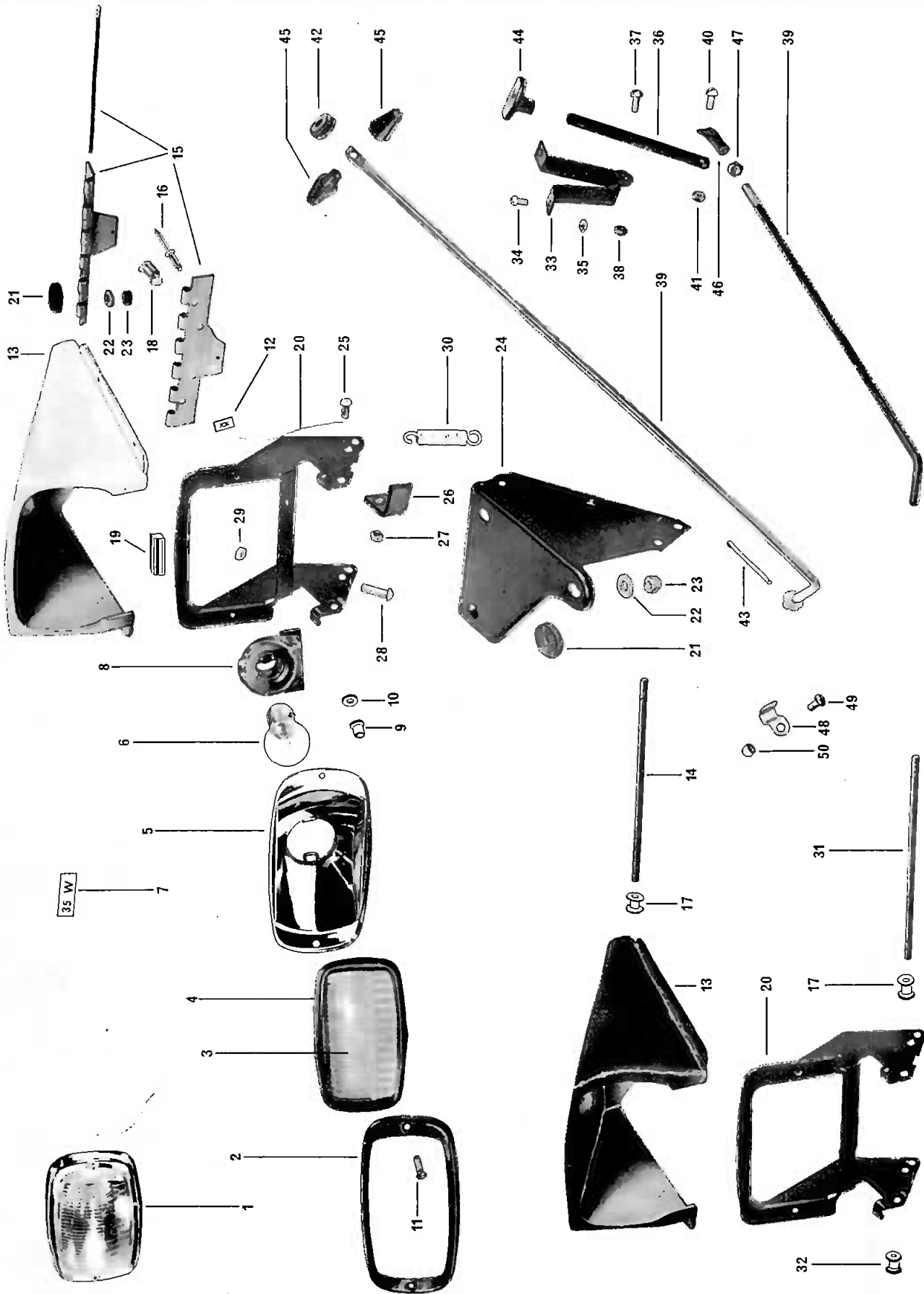

## HEADLAMP (NORDIC)

ITEM NO.	PART NO.	DESCRIPTION	QUANTITY						
			399	399E	640E	TNT 399	TNT 640	TNT 399S	TNT 640S
1	410 6010	Projector Ass'y .....	1	1	1	1	1	1	1
2	410 6012	Chromed Ring .....	1	1	1	1	1	1	1
3	410 6014	Glass .....	1	1	1	1	1	1	1
4	410 6013	Rubber Ring .....	1	1	1	1	1	1	1
5	C.S.A.	Reflector .....	1	1	1	1	1	1	1
6	410 5009	Bulb 35W .....	1	1	1		1	1	1
6	410 5011	Bulb 60W .....				1			
7	414 0280	Label 35W .....	1	1	1		1	1	1
7	414 0476	Label 60W .....				1			
8	410 6015	Socket .....	1	1	1	1	1	1	1
9	C.S.A.	Blank .....	2	2	2	2	2	2	2
10	C.S.A.	Washer .....	2	2	2	2	2	2	2
11	410 6011	Screw .....	2	2	2	2	2	2	2
12	389 8010	Nut .....	2	2	2	2	2	2	2
13	572 1703	Head Lamp Housing .....	1	1					
13	571 1733	Head Lamp Housing .....			1				
13	571 1760	Head Lamp Housing .....				1	1	1	1
14	517 0212	Hinge Pin .....	1	1					
15	582 1016	Hinge Ass'y .....			1	1	1	1	1
16	390 4013	Rivet .....			4	4	4	4	4
17	570 1750	Grommet W/Groove .....	3	3					
18	414 0229	Housing Spring .....	1	1	1	1	1	1	1
19	107 7002	Spacer Strip (Mult 12'') .....	AR	AR	AR	AR	AR	AR	AR
20	515 0214	Head Lamp Ring .....	1	1					
20	515 0142	Head Lamp Ring .....			1	1	1	1	1
21	570 1711	Insulator Rubber .....			5	5	5	5	5
22	399 9008	Washer .....			5	5	5	5	5
23	387 5019	Nut .....			5	5	5	5	5
24	515 0174	Head Lamp Support .....			1	1	1	1	1
25	320 1062	Screw .....			1	1	1	1	1
25	320 1061	Screw .....			1	1	1	1	1
26	515 0157	Stop Bracket .....			1	1	1	1	1
27	387 3013	Nut .....			2	2	2	2	2
28	321 7103	Adjustment Screw .....			1	1	1	1	1
29	380 9019	Nut .....			1	1	1	1	1
30	414 0497	Head Lamp Spring .....	1	1					
30	414 0246	Head Lamp Spring .....			1	1	1	1	1
31	517 0188	Hinge Pin .....	1	1					
32	414 0512	Grommet .....	1	1					
33	515 0190	Control Bracket .....	1	1	1				
34	323 3061	Screw .....	2	2	2				
35	387 3013	Nut .....	2	2	2				
36	515 0191	Control Lever .....	1	1	1				
37	320 1063	Screw .....	1	1	1				
38	387 3013	Nut .....	1	1	1				
39	515 0173	Control Rod .....	1	1	1				
39	517 0168	Control Rod .....				1	1	1	1
40	320 1063	Screw .....	1	1	1				
41	387 3013	Nut .....	1	1	1				
42	414 0363	Grommet .....				1	1	1	1
43	371 0011	Cotter Pin .....	2	2	2	1	1	1	1
44	414 0054	Control Knob .....	1	1	1				
45	414 0295	Control Knob (Male) .....				1	1	1	1
45	414 0294	Control Knob (Female) .....				1	1	1	1
46	515 0149	Adjuster Tube .....	1	1	1				
47	380 9019	Nut .....	1	1	1				
48	517 0096	Clip .....			1	1	1	1	1
49	320 1061	Screw .....			1	1	1	1	1
50	386 7002	Nut .....			1	1	1	1	1

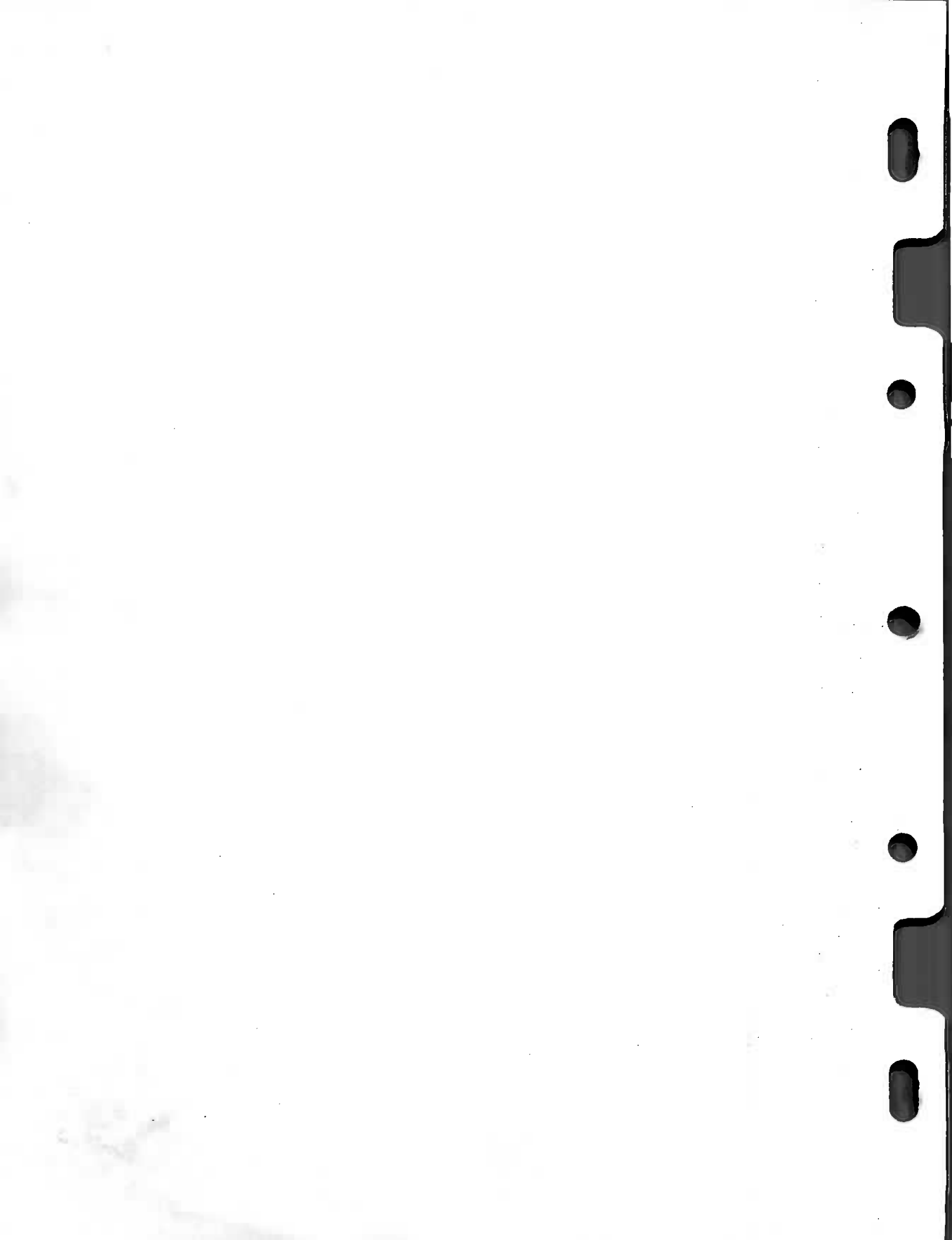

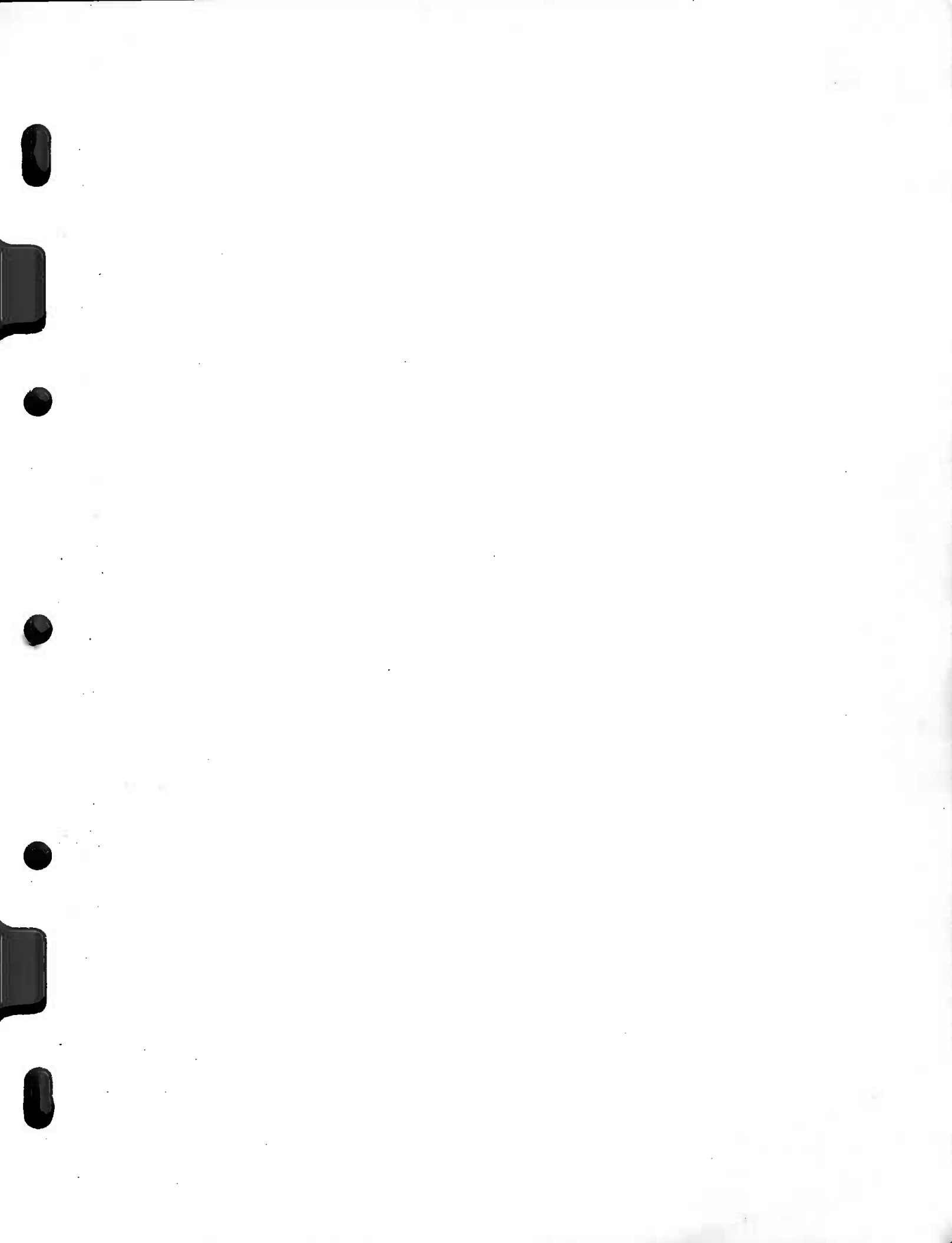

# ELECTRICAL (ALPINE)

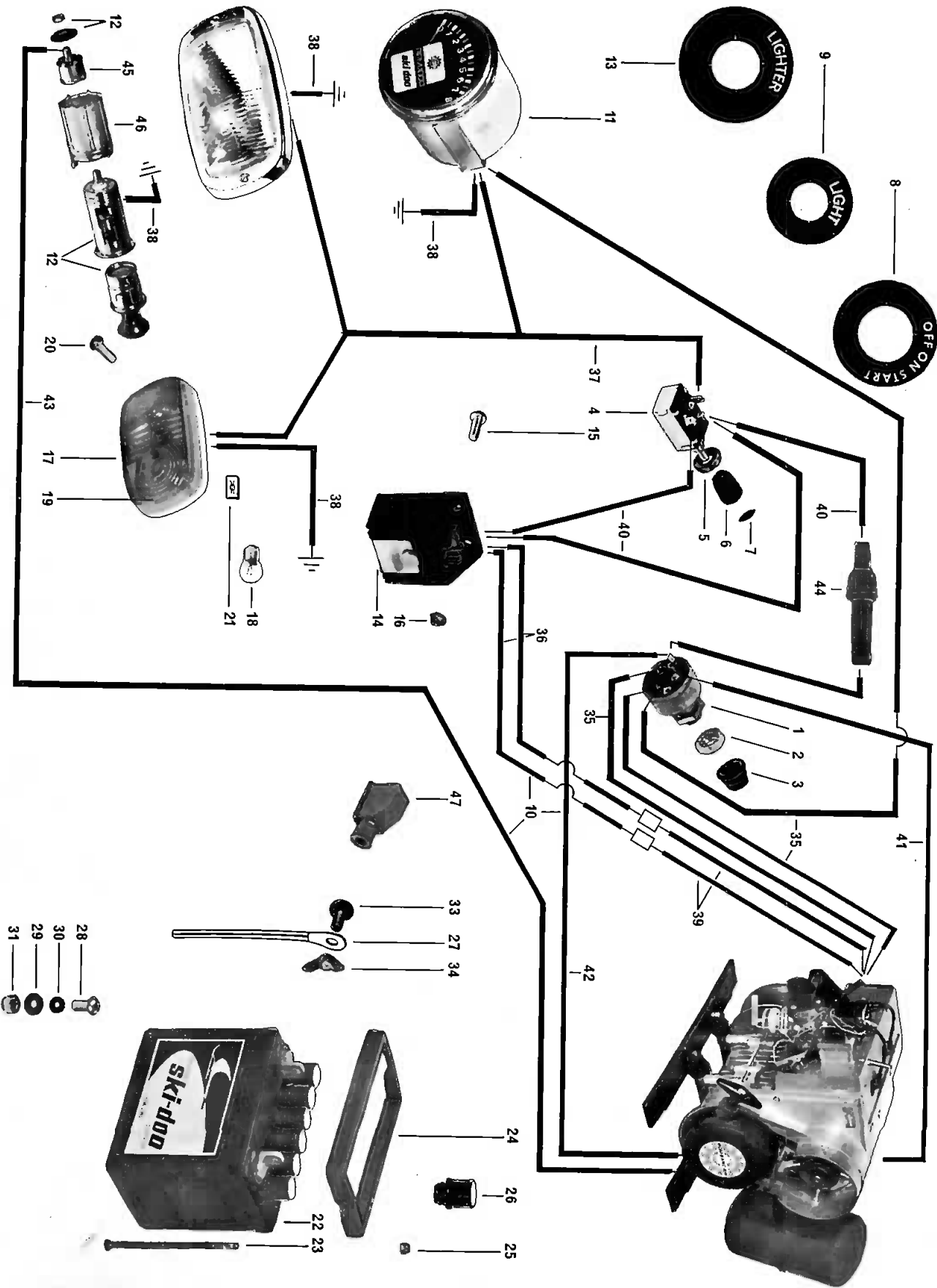

# ELECTRICAL (ALPINE)



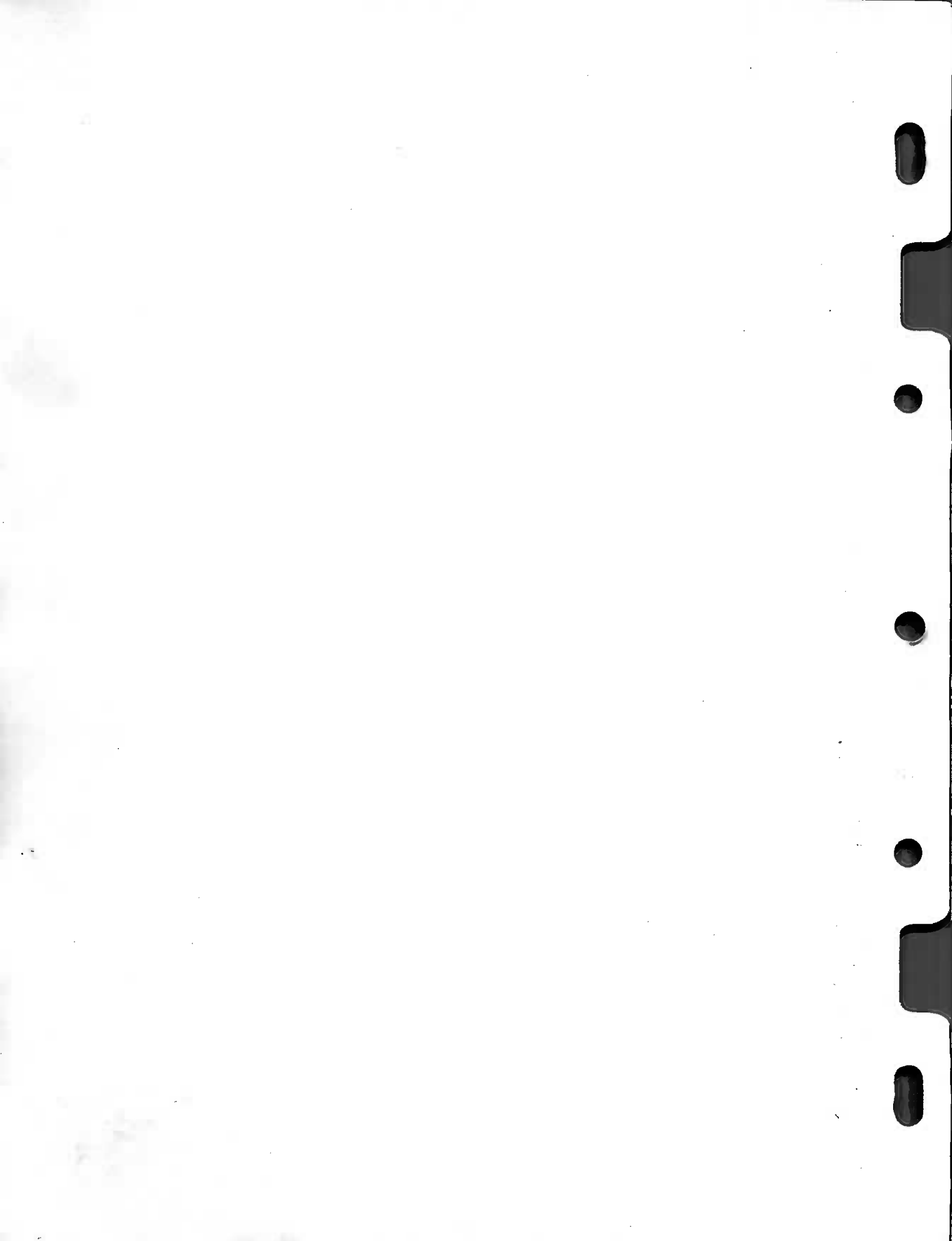







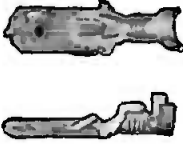

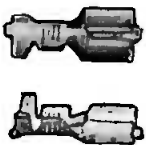



ITEM NO.	PART NO.	DESCRIPTION	QUANTITY		
			399	399E	640E
1	410 1006	Ignition Switch .....	1		
1	410 1009	Ignition Switch .....		1	1
2	410 1008	Face Nut .....	1	1	1
3	670 1503	Ignition Switch Boot .....	1	1	1
4	410 1004	Head Light Switch .....	1	1	1
5	410 1010	Face Nut .....	1	1	1
6	414 0251	Head Light Switch Knob .....	1	1	1
7	414 0345	Knob Decal .....	1	1	1
8	414 0501	Ignition Sticker .....	1		
8	414 0481	Ignition Sticker .....		1	
9	414 0502	Light Sticker .....	1	1	
10	515 0184	Harness Ass'y .....	1		
10	515 0185	Harness Ass'y .....		1	
10	515 0211	Harness Ass'y .....			1
11	414 0498	Tachometer .....			1
12	414 0321	Lighter .....		1	1
13	414 0495	Lighter Sticker .....		1	
14	410 9032	Rectifier .....		1	1
15	320 0061	Mach. Screw .....		2	2
16	387 3013	Nut .....		2	2
17	410 6016	Tail Lamp Ass'y .....	1	1	1
18	410 5006	Bulb .....	2	2	2
19	410 9019	Lens .....	1	1	1
20	321 6043	Screw .....	2	2	2
21	389 8010	Speed Nut .....	2	2	2
22	410 3002	Battery .....		1	1
23	515 0096	Rod .....		2	2
24	515 0156	Battery Cover .....		1	1
25	387 0019	Nut .....		2	2
26	410 3004	Battery Cap .....	6	6	6
27	409 6030	Ground Wire .....		1	1
27	409 6026	Current Wire .....		1	1
28	323 2102	Screw .....		1	1
29	399 9015	Flat Washer .....		1	1
30	399 8007	Lock Washer .....		1	1
31	387 2019	Nut .....		1	1
33	360 5020	Bolt (n) .....		1	1
33	360 5050	Bolt (p) .....		1	1
34	386 4019	Wing Nut (n) .....		1	1
34	386 4022	Wing Nut (p) .....		1	1
35	409 6021	Wire Black 16 GA (Mult 12'') .....	AR	AR	AR
36	409 6028	Wire Red/White 16 ga. (Mult 12'') .....	AR	AR	AR
37	409 6020	Wire Brown 16 ga. (Mult 12'') .....	AR	AR	AR
38	409 6022	Wire Yellow 16 ga. (Mult 12'') .....	AR	AR	AR
39	409 6029	Wire Red/Violet 16 ga. (Mult 12'') .....	AR	AR	AR
40	409 6018	Wire Red 16 ga. (Mult 12'') .....		AR	AR
41	109 5022	Wire Green 14 ga. (Mult 12'') .....		AR	AR
42	409 6025	Wire Red 14 ga. (Mult 12'') .....		AR	AR
43	414 0352	Lighter Wire .....		1	1
44	410 9038	Fuse Holder .....		1	1
44	410 9040	Spirap Tubing .....	AR	AR	AR
45	414 0318	Breaker .....		1	1
46	414 0319	Socket Retainer .....		1	1
47	570 1505	Protection Cap .....		1	1

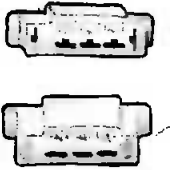





# TERMINAL

 <p>1</p>	 <p>2</p>	 <p>3</p>			
 <p>4</p>	 <p>5</p>	 <p>6</p>			
 <p>7</p>	 <p>8</p>				
 <p>9</p>	 <p>10</p>				
 <p>11</p>	 <p>12</p>	 <p>13</p>			
 <p>14</p>	 <p>15</p>	 <p>16</p>			

**TERMINAL**

ITEM NO.	PART NO.	DESCRIPTION	QUANTITY
1	409 2010	Tab .....	Kit of 5
2	409 2022	Receptacle .....	Kit of 5
3	409 2014	Receptacle .....	Kit of 5
4	409 2013	Tab Housing .....	Kit of 5
5	409 2012	Receptacle Housing .....	Kit of 5
6	409 2023	Receptacle Housing (2 Circ) .....	Kit of 5
7	409 2019	Tab Housing (6 Circ) .....	1
8	409 2018	Receptacle Housing (6 Circ) .....	1
9	409 2021	Tab Housing (8 Circ) .....	1
10	409 2020	Receptacle Housing (8 Circ) .....	1
11	409 0018	Open Barrel .....	Kit of 5
12	409 0019	Open Barrel .....	Kit of 5
13	409 0020	Open Barrel .....	Kit of 5
14	410 9033	Ignition Switch Block .....	1
15	410 9034	Rectifier Block .....	1
16	410 9035	Headlight Switch Block .....	1

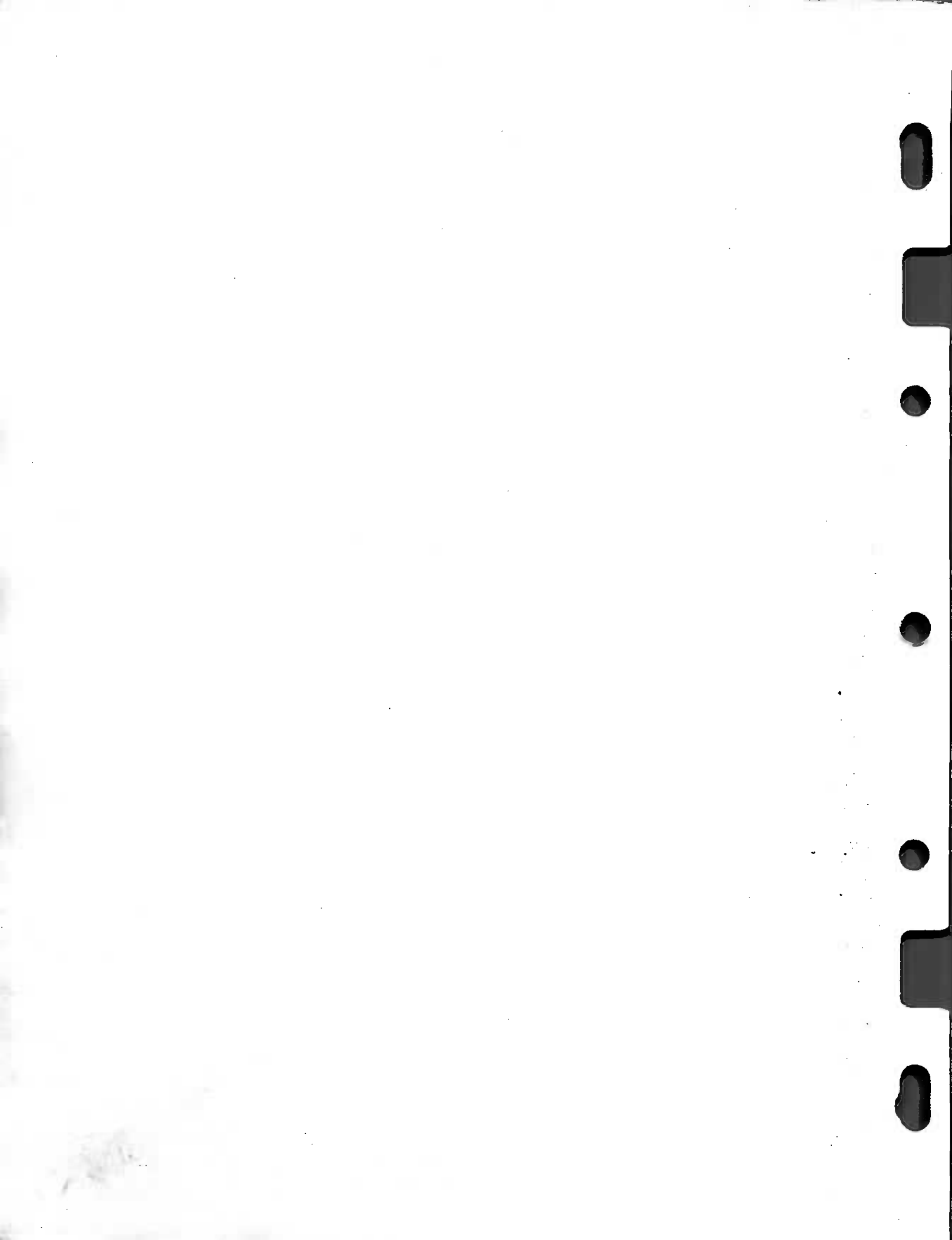

**TNT 775s**

**1970**

REFER TO TNT 640s

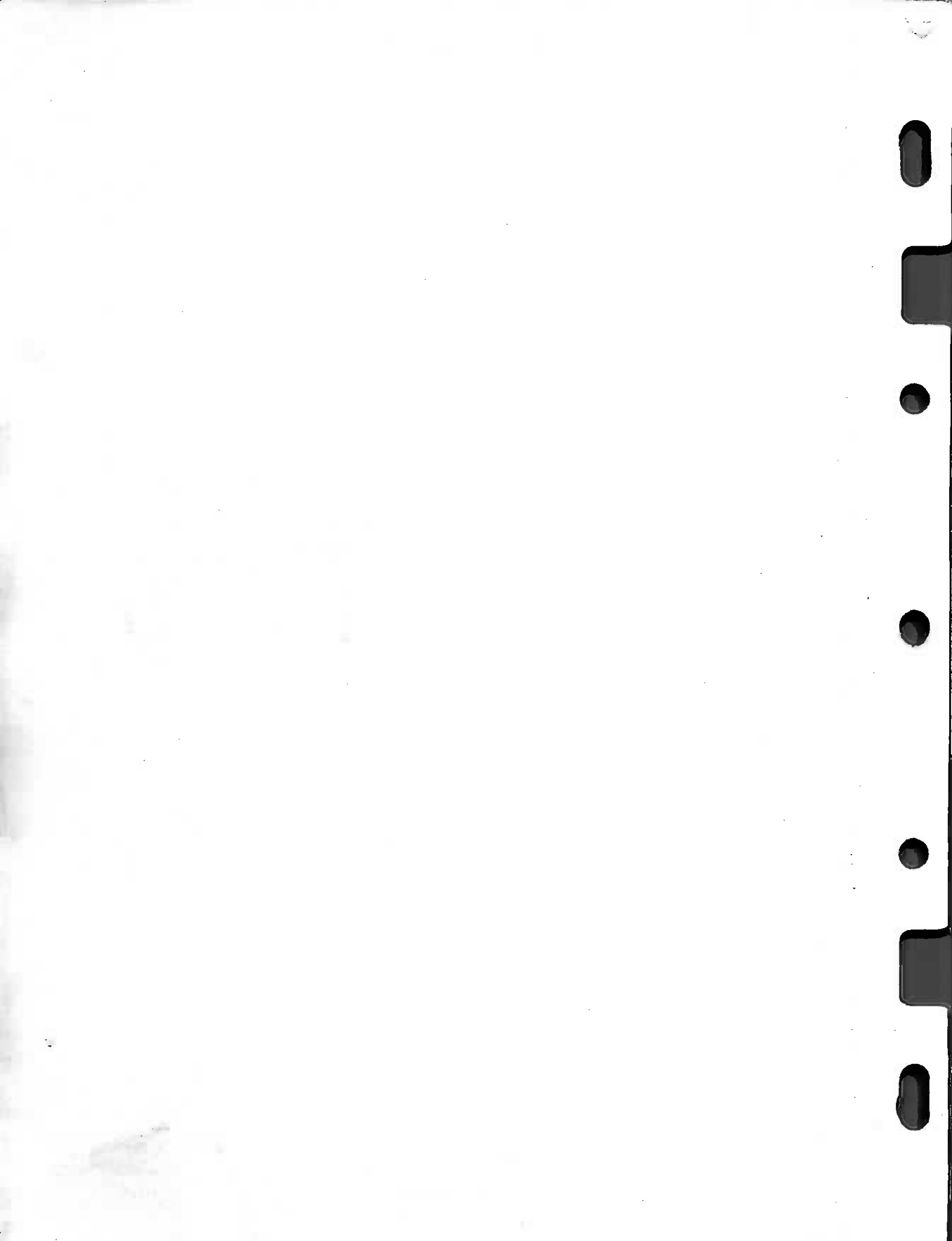

BLIZZARD ELECTRICAL

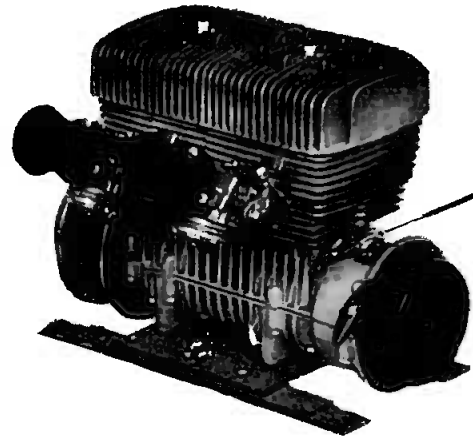
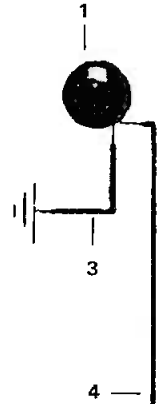
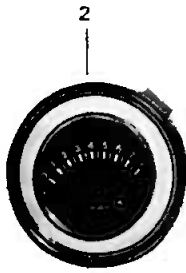

ITEM NO.	PART NO.	DESCRIPTION	QUANTITY				
			292	340	436	636	776
1	402 4222	Shorting Button . . . . .	1	1	1	1	1
	402 4221	Shorting Button Clamp . . . . .	1	1	1	1	1
2	414 0550	Tachometer . . . . .	1	1	1	1	1
3	409 6022	Wire Yellow 16 Ga. Mult. 12" . . .	AR	AR	AR	AR	AR
4	409 6021	Wire Black 16 Ga. Mult 12" . . . . .	AR	AR	AR	AR	AR

