



emulait™

NIPPLE 2-PACK

USER INSTRUCTION MANUAL



What's Included



Nipple x 2

Before First Use

Clean hands and surfaces thoroughly before handling. Sterilize the Emulait Nipples in boiling water for about five minutes. Let them cool and dry before use.

How to Assemble

Flow Control

Emulait Nipples must be used with a flow control valve inserted to prevent collapse. Choose desired flow rate and insert into the Emulait Nipple before use.

You may notice that the nipple compresses during feeding. This is due to suction from the baby's latch and does not affect the flow of milk.

1 Insert flow control valve

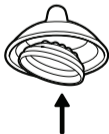

Insert flow control valve into the Emulait Nipple and push it into place

2 Fill the bottle and attach nipple on to bottle base with flow control valve inserted

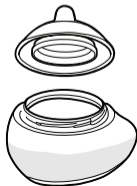

How to Disassemble for Cleaning

1 Detach nipple and base



2 Remove flow control valve

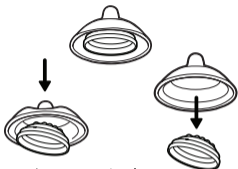

Lightly press down on nipple to remove flow control valve

3 Invert nipple



To ensure a thorough cleaning, use the Emulait bottle brush to clean between fibres

Cleaning and Sterilizing

Fully remove the Emulait Nipple from your Emulait Bottle. Wash nipple in hot water and soap. Rinse and dry thoroughly.

The Emulait Nipples are dishwasher safe (top rack only), and safe for use in an electric sterilizer, microwave sterilizer or boiling water. Use sterilizing solutions or sterilizers strictly according to the manufacturer's instructions. Steam can cause severe skin burns, use caution when boiling on the stove or using any sterilizing equipment. Avoid unnecessary handling of sterilized items and equipment.

For Your Child's Safety and Health

⚠ WARNING!

Inspect carefully before every use.
Always check the Emulait Nipples for any tears or signs of damage.
Dispose of the Emulait Nipples at the first signs of damage or weakness.
When not in use, keep the Emulait Nipples out of the reach of children.
Always use this product with adult supervision.
The Emulait Nipples should only be used for bottle feeding and should not be given to children to play with or teethe.

Yours Truly