



emulait™

**FLOW CONTROL VALVE
3-PACK**

USER INSTRUCTION MANUAL



What's Included



Slow Flow Control Valve x 1



Medium Flow Control Valve x 1



Fast Flow Control Valve x 1

Before First Use

Clean hands and surfaces thoroughly before handling. Sterilize the flow control valves in boiling water for about five minutes. Let them cool and dry before use.

How to Insert Flow Control Valves

Flow Control

Emulait Nipples must be used with a flow control valve inserted to prevent collapse. Choose desired flow rate and insert into the Emulait Nipple before use.

You may notice that the nipple compresses during feeding. This is due to suction from the baby's latch and does not affect the flow of milk.

1 Insert flow control valve

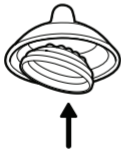

Insert flow control valve into the Emulait Nipple and push it into place

2 Fill the bottle and attach nipple on to bottle base with flow control valve inserted

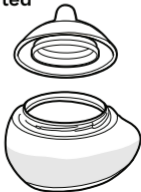

How to Remove Flow Control Valves

1 Detach nipple and base



2 Remove flow control valve

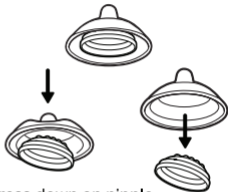

Lightly press down on nipple
to remove flow control valve

3 Invert nipple



To ensure a thorough cleaning, use
the Emulait bottle brush to clean
between fibres

Cleaning and Sterilizing

Fully disassemble all parts. Wash all parts in hot water and soap. Rinse and dry thoroughly, ensuring all cavities are clean.

All parts are dishwasher safe (top rack only), and safe for use in an electric sterilizer, microwave sterilizer or boiling water. Use sterilizing solutions or sterilizers strictly according to the manufacturer's instructions. Steam can cause severe skin burns, use caution when boiling on the stove or using any sterilizing equipment. Avoid unnecessary handling of sterilized items and equipment. We recommend using the Emulait Dishwasher Basket to clean and store your flow control valves when not in use.

For Your Child's Safety and Health

⚠ WARNING!

Inspect carefully before every use.

Always check flow control valves for any cracks or signs of damage.

Dispose of flow control valves at the first signs of damage or weakness.

When not in use, keep flow control valves out of the reach of children.

Always use this product with adult supervision.

The flow control valves are not toys and should not be given to children to play with or suck on.

Yours Truly