

OVEN TOASTER GRILLER  
SA 5033/ SA 5023

**GLEN**  
Live Better !



DIGITAL

11 PRE SET MENUS

T O A S T

B A G E L

P I Z Z A

B A K E

R O A S T

B R O I L

C O O K I E S

R O T I S S

D E H Y D

F E R M E N T

W A R M

**GLEN**

Glen Appliances Pvt. Ltd., I-34, DLF Ind. Area, Phase-I, Faridabad, India.  
Helpline : 92666 55555  
E-mail : [info@glenindia.com](mailto:info@glenindia.com) Website : [www.glenindia.com](http://www.glenindia.com)

USER'S GUIDE

## Identifying your Glen Oven Toaster Grill

### SA 5033 Digital / SA 5023 Digital

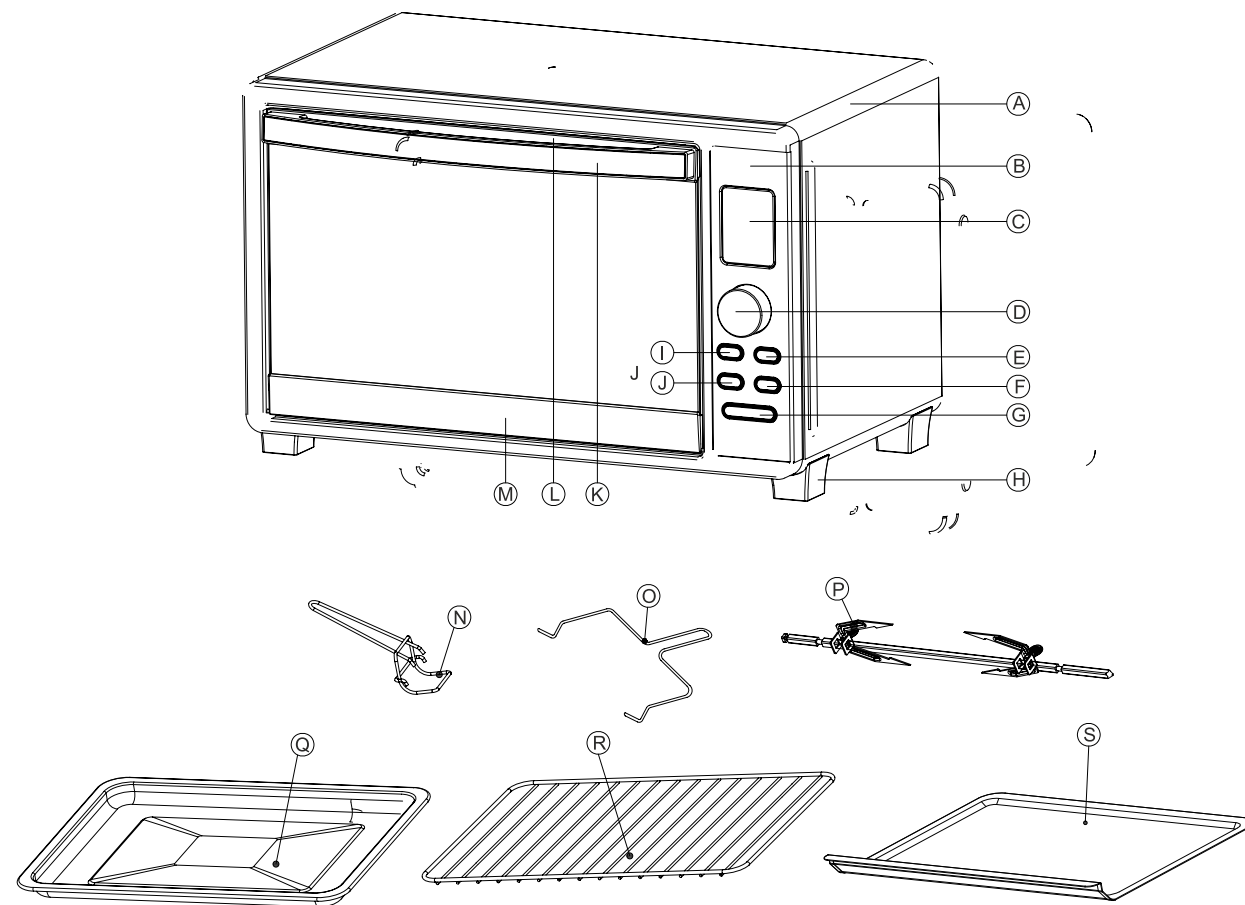

- |                              |                       |
|------------------------------|-----------------------|
| A: Housing                   | B: Front panel        |
| C: Digital display           | D: Knob for Selection |
| E: Light / Convection button | F: Temperature button |
| G: Start/Cancel              | H: Foot / Leg         |
| I: Model selection button    | J: Timer button       |
| K: Door handle               | L: Upper door frame   |
| M: Lower door frame          | N: Tray handle        |
| O: Rotisserie handle         | P: Rotisserie set     |
| Q: Bake tray                 | R: Wire rack          |
| S: Crumb tray                |                       |

\*Images are just for representation. Actual products may vary.

## Digital Display and Buttons Instruction

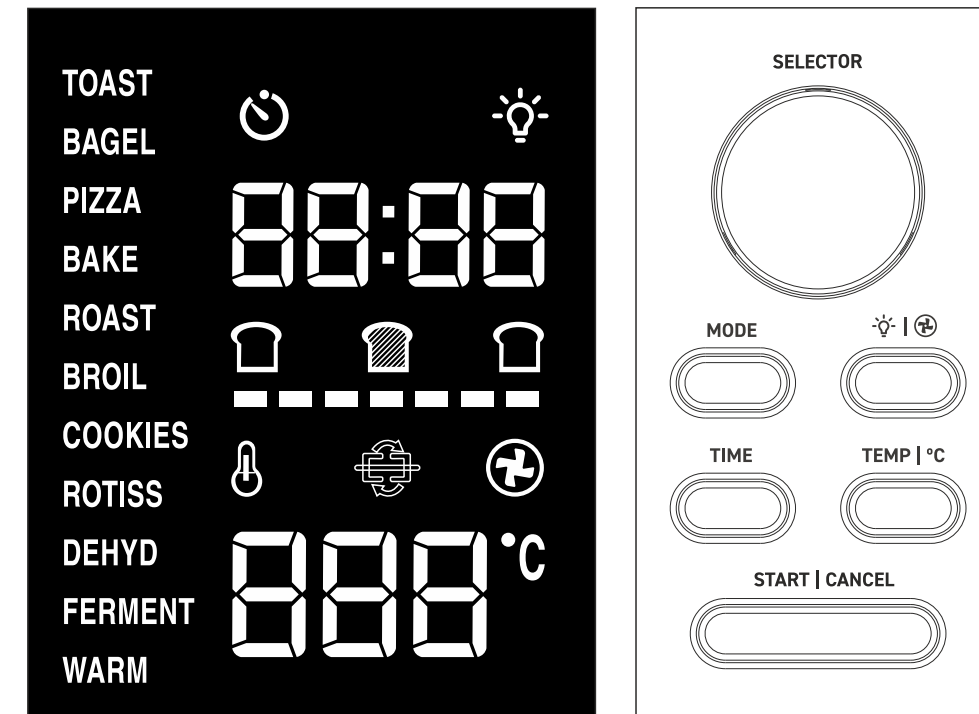

a) Display

b) Knob & Buttons

Connect your OTG power plug to socket, display is lighted as pic a), function “Toast” is flickering and Bread color level the middle mark is lighted. Button “START/CANCEL” is lighted in blue or white color.

And oven will be closed of work if have no/any operation after “Toast” flickering for 10 minutes.

**Selector Knob:** Turn knob in clockwise or anti-clockwise to choose the function such as TOAST, BAGEL, PIZZA, BAKE, ROAST, BROIL, COOKIES, ROTISS, DEHYD, FERMENT, WARM, or turn knob to adjust Time or Temperature, or turn knob to choose color level of bread.

**Mode:** Function button, press “MODE”, the “► Toast” is flickering, then turn the “SELECTOR” knob to select function, different function with a acquiescent time and temperature, you can press START button to work, or adjust the time or temperature to what you ask.

If you choose “Toast” or “Bagel”, press “Mode” button to choose it. And if you want to choose other function please press “Mode” button first, then turn knob to choose it.

**Temp:** Temperature button, press “TEMP” button, the default temperature is flickering, then turn the “SELECTOR” knob to adjust temperature from 65 to 230°C or 30-45°C by per 5°C unit. Different functions with a different temperature range (See Functions details sheet as below).



Once you stop to turn knob for 2 seconds, the current temperature is chosen after flickering for 2 time.

Once you find the temperature, press “TEMP” again, the temperature is chosen.

**Time:** Timer function, press “TIME” button, the default time is flickering, then turn the “SELECTOR” knob to adjust the time from 1 - 120 mins. But function “Dehydrate”, “Warm” and “Ferment” are 12 hours. (See Functions details sheet as below).  
Adjust time from 1-60 mins by per 1 min unit, from 61-120 mins by per 2 mins unit, from 121-720 mins by per 10 mins unit.

Once you stop to turn knob for 2 seconds, the current time is chosen after flickering for 2 time. Once you find the time, press “TIME” again, the time is chosen.

LAMP /CONV: Lamp & Convection function. Press button, “Convection” start to work, the convection mark

 |  **LAMP /CONV:** Lamp & Convection function. Press button, “Convection” start to work, the convection mark  is lighted on display. And press button again, “Convection” stop to work. Press button for 2 seconds then the lamp is turn on until oven is closed of work. But if you press button for 2 seconds again, the lamp is turn off even oven is under working.

**START/CANCEL:** Switch button. After you choose function / Time /Temperature, then press this button to start work. And you can press button again to stop oven working. Once oven is closed of work under preset time, there have end of signal “beep” warning for 4 times.

**Note:**

- Time and Temperature are adjustable whenever oven is working or closed of working.
- Lamp and Convection are adjustable whenever oven is working or closed of working.

**Setting Up Your Oven Toaster Griller**

Read all instructions included in this user's guide.  
Check all the accessories in the carton and remove all racks and pans & wash in hot water or dishwasher

After re-assembling your oven, we recommend to run it maximum temperature for approximately 15 minutes to eliminate any packing oil that may remain.

**Installation & Use of Your Digital OTG**

Place your oven on a stable work surface. Allow a free flow of air around your appliance. The oven must have a minimum of 10cm of space on either side, including the back, and 30 cm top clearance. Unwind the power cord and plug it into the wall outlet. Before using your oven for the first time, we suggest that you run the oven while empty at a temperature of 230°C for about 15 minutes in order to get rid of the “new smell.”

**Using Your Oven**

- Set the temperature according to the dish that you are going to cook.
- Set the corresponding temperature button by turning it clockwise to select the appropriate temperature (from 65°C to 230°C) for the dish you are going to cook.

**Toast Function**

Please note that the “**Toast**” setting uses all of the heating elements. The large capacity oven allows you to toast 4 to 6 slices of bread, 6 muffins, frozen waffles or pancakes. When only toasting 1 or 2 items, place the food in the centre of the middle rack.

Step 1. Open the door, place the bread (4 or 6 slices) into the oven and close the door.

Step 2. Press the “Mode” button; turn the “Selection” knob to choose Toaster function. the browning shade indicator (1-3) will appear on display. Choose the color level as you ask.

Step 3: Temperature 230°C is not adjustable. Time is acquiescent according to bread color level

As below picture ( See Functions details sheet as below ).

Step 4: Press button “START/CANCEL “ to work.



## Bagel Function

The same as Toast Function



The same operation to other functions, choose function, adjust temperature and time, start work

### Pizza function

### Bake function

### Roast function



### Broil function

### Cookies function

### Rotisserie function

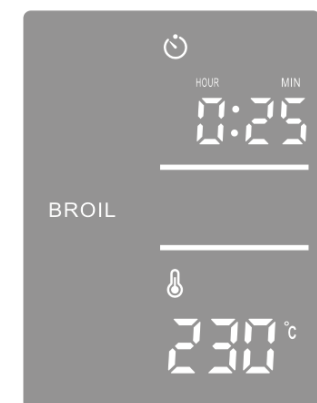

### Dehydrate function

### Fermentation function

### Warm function

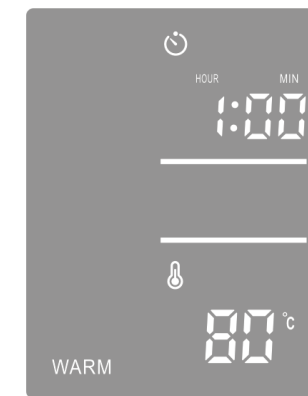

## Functions Operation Details Sheet

Seq	Function	Power (W)	Upper heating	Lower heating	Default Timer (M)	Default temperature (°C)	Adjustable Time (Hour-Min)	Adjustable temperature (°C)	Convection	Rotisserie
1	Toast	1500	Yes	Yes	0 : 03	230	0:03-0:05	No	No	No
					0 : 06		0:05-0:09			
					0 : 10		0:09-0:15			
2	Bagel	1500/750	Yes	Yes	0 : 03	230	0:03-0:05	No	No	No
					0 : 06		0:05-0:09			
					0 : 10		0:09-0:15			
3	Pizza	1500	Yes	Yes	0 : 18	230	0:01-2:00	65-230	No	No
4	Bake	1500	Yes	Yes	0 : 30	165	0:01-2:00	65-230	Yes	No
5	Roast	1500	Yes	Yes	1:00	175	0:01-2:00	65-230	Yes	No
6	Broil	750	Yes	No	0:25	230	0:01-2:00	65-230	No	No
7	Cookies	1500	Yes	Yes	0:11	175	0:01-2:00	65-230	Yes	No
8	Rotisserie	1500	Yes	Yes	0:45	230	0:01-2:00	65-230	Yes	Yes
9	Dehydrate	750	No	Yes	8:00	75	0:01-12:00	40-80	Yes	No
10	Fermentation	750	No	Yes	1:00	35	0:01-12:00	30-45	No	No
11	Warm	750	No	Yes	1:00	80	0:01-12:00	60-110	No	No

Temperature may vary + - 10degree due to voltage variation and ambient temperature.



## Note: Special functions to this Digital Oven

1) Display will go to sleep mode if oven is not in use more than 10 minutes. to operate again just push any button.

2) Memory function: This oven with intelligent memory function. For example, your last cooking Pizza was finished, and now your cooking Toast is finished too, you want to start next cooking Bagel, the display will show Pizza information (temperature, time) automatically.

## How to Use The Rotisserie

### Inserting the Rotisserie

For the rotisserie function, the roasting spit is provided.

The roasting spit can hold up to 3 kilograms, but for chicken, this model only can bake about 1kgs

since the limited space.

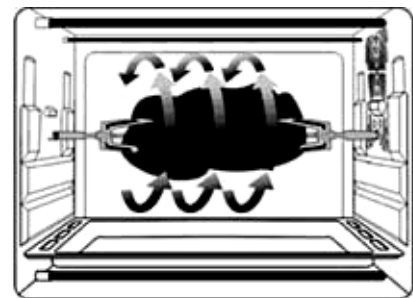

### Installing the Rotisserie spit:

Insert the rotisserie spit into the holes provided for this purpose, holes "A" and "B" as shown in the diagram below. Then place the crumb tray below to collect the juices or oils.



### CAUTION:

Always use the rotisserie handle when removing the rotisserie spit so that don't burn yourself.

Be careful not to burn yourself when removing cooking juices or other liquids from the oven.

## Oven maintenance

Always unplug the appliance and allow it to cool completely before cleaning or moving it.

Clean the tray, the grill, and the tray handle after each use.

Clean the interior of the oven and all of the removable parts with a mild, non-abrasive cleanser after each use. Rinse and dry carefully.

Clean the glass exterior of the oven door with glass cleaner or mild detergent and a damp cloth. Do not use abrasive cleansers or pads that could scratch the surface coating of the appliance.

Rinse and dry thoroughly with a clean, dry cloth. Let the oven dry completely before closing the door.

To facilitate cleaning: auto clean the walls after a greasy meal by heating the oven to the maximum setting while empty, with the door closed for a period of 10 minutes.

If you need to store the oven, unplug it, allow it to cool, and clean it before placing it in the box. Store it in a cool, dry place. Never store the unit when it is still hot.

Never wrap the power cord around the appliance. Do not put any stress on the power cord at the place where it is attached to the unit. It could become damaged and break.

## Important Safeguards

When using electric appliances, basic safety precautions should always be followed, including the following:

Do not touch hot surfaces. Always use handles or knobs.

Close supervision is necessary when any appliance is used by or near children.

To protect against electric shock, do not immerse cord, plug or any parts of the oven in water or any other liquids.

Do not let cord hang over edge of table or counter, or touch hot surfaces.

Do not operate appliance with damaged cord or plug or after the appliance malfunctions or has been damaged in any manner. Return appliance to its authorized agent for repair, as special purpose tools are required.

The use of accessory attachments not recommended by the appliance manufacturer may cause hazard or injury.

Do not place on or near a hot gas or electric burner.

When operating the oven, keep at least four inches of free space on all sides of the oven to allow for adequate air circulation.

To disconnect, turn the time control to UFF, then remove the plug. Always hold the plug, and never pull the cord.

Extreme caution must be used when moving a drip pan containing hot oil or ether hot liquids.

Use extreme caution when removing the tray, racks or disposing of hot grease or other hot liquids.

Do not clean the inside of the oven with metal scouring pads, pieces can break off the pad and touch electrical parts, creating a risk of electric shock.

Oversized foods or metal utensils must not be inserted in a toaster oven as they may create a fire or risk of electric risk.

A fire may occur if the oven is covered or touching flammable material, including the curtains, draperies, walls, and the like, when in operation. Do not store any item on top of the appliance when in operation.

Extreme cautions should be exercised when using cooking or baking containers constructed of anything other than metal or ovenproof gloves.

Be sure that nothing touches the top or bottom elements of the oven.

Do not place any of the following materials in the oven: cardboard, plastic, paper, or anything similar.

Do not store any materials other than manufacturer's recommended accessories in this oven when not in use.

Always wear protective, insulated oven gloves when inserting or removing items from the hot oven.

This appliance is OFF when the Timer Control button is in the "OFF" position.

Do not use outdoors.

Do not use appliance for other than intended use.

## SPECIFICATIONS

Model No.	SA-5033DIGI	SA-5023DIGI
Voltage (V)	220-240V	220-240V
Frequency (Hz)	50	50
Capacity (L)	33	23
Power (W)	1500W	1500W
Product dimensions in mm (LxWxH)	522x360x322	467x350x290

## WARRANTY

This GLEN Oven Toaster Griller is fully warranted against any defect arising out of defective materials or faulty workmanship for a period of two year from the date of purchase. Should any defect develop in this product, the customer should bring the product to the nearest authorised service centre, where the company undertakes to get the product repaired free of charge.

This warranty is not valid if:

- The use and care instructions have not been followed.
- Defects are caused by accident, misuse, abuse or commercial use.
- The repair work is carried out by persons not authorised by the company.
- Any modification or alteration of any nature is made in the product.
- Normal wear & tear of the product is not covered under warranty
- The Bill/Cash memo and copy of warranty card is not presented.

Under no circumstances, whether based on limited warranty or otherwise shall the company be liable for incidental, special or consequential damages. Use of product indicates acceptance by you of the aforesaid terms and conditions.

PRODUCT NAME: **OVEN TOASTER GL 5033 DIGI / GL 5023 DIGI**

DATE OF PURCHASE: \_\_\_\_\_

SERIAL NO.: \_\_\_\_\_

Packing List: Basic Unit, Bake Tray, Wire Rack, Rotisserie Skewer, Tray Handle, Skewer Handle, Crumbs Tray User's Guide

DEALER'S STAMP & SIGNATURE