

**The Life Time Warranty is offered on the following conditions:**

- The photocopy of this email along with copy of bill of purchase needs to be presented for making the claim.
- The chimney should be used as per the directions given in the user's guide. Defects caused by improper or reckless use are not covered.
- Any damages due to the use of abrasive chemicals, or usage in extremely adverse atmosphere, i.e. abnormally corrosive / alkaline / acidic, is not covered under warranty.
- The warranty will not cover Chimneys used for commercial purposes.
- The chimney should have been serviced and cleaned at regular intervals at-least once in two months by a Glen Authorized Service Centre failure to comply with this will render this warranty void. The cost of any such service will be borne by the customer.
- No installation / modification / alteration / service of any nature is made in the chimney by unauthorized persons. The Installation Charges are to be borne by the customer.
- Only the parts covered under LTW will be replaced free. The labour charges for the replacement of under warranty parts will be borne by the customer. The visit charges (within municipal area only) of Rs. 250/- (subject to change from time to time) will be charged extra.
- This chimney has been designed to last a long time and depending on the up-keep & maintenance by the customer the Chimney may last a long time but for the purpose of Life Time Warranty the Life of the Chimney will be taken as 7 years from the date of Purchase of the Chimney.
- The warranty is not valid for any damages arising due to erratic power supply.
- The warranty is not valid in case chimney is used on Inverter or Generator.
- The warranty doesn't include the regular servicing of the product.
- Parts covered under warranty are motor, switch and controls only. **Electronic controls/Touch sensor controls carry only one year warranty and are not covered under life time warranty.**
- Glass or Glass products, LED Lamps,Bulbs, Rubber & Plastic parts are not covered under warranty.
- The company will not accept any liability for any loss or damages of whatsoever nature on account of fire, storm, theft, malicious damage, pressure cooker bursting or any other unforeseen acts or incidents.
- Any damage done by rats or rodents etc. will not be covered by the warranty.
- Glen Appliances Pvt. Ltd. accepts no liability for any consequential loss and / or damages caused to the user or any third party due to any failure / malfunction of the product. The company's liability is limited to the repair or replacement of the defective part.
- In case of installation beyond the municipal limits of the areas of operation of authorized service centres, or in areas where there are no service centres, the expenses incurred in transporting the parts / machine including loading / unloading will be borne by the user and paid in advance.
- The warranty will be valid only at the original place of purchase and in case of transfer the Chimney should have been un-installed and then re-installed only by the authorized technician. No claims would be entertained in cases of ownership changes.
- The decision of Glen Appliances Pvt. Ltd. in respect of all claims in this regard would be final and binding. All disputes subject to Faridabad jurisdiction.

**PACKING LIST**  
Main Unit, Universal Spigot, Plastic Wall Plugs, Screws, User's Guide

**TECHNICAL SPECIFICATIONS**

The specifications of this Chimney will be based on the model selected by you identified with various features as given in the below mentioned table:

Air Flow	750 M³	1000 M³	1250 M³
Motor Wattage	145W	155W	180W
Housing	FRP Flame Retardant Plastic		PDCA Pressure Die-casted Aluminium
Lamps	Incandescent		LED
Wattage (each)	40W		1.5W
Speed Controls	SL (3 Speed Sliding)	PB (3 Speed Push Button)	TC/TS/EL (3 Speed With Timer)
Filters	BF Stainless Steel Baffle Filter		CF Aluminium Cassette Filter

Based on the features as mentioned in the model you have selected the specifications will be different. Please note as improvements are a continuous process specifications are subject to change.

**GUARANTEE**

Glen Appliances Pvt. Ltd. guarantees to get the product or any part thereof repaired free of charge for a period of one year from the date of purchase, should any defect develop due to faulty or defective workmanship or material. However, the glass, plastic breakable parts, lamps, push buttons, filter locks, and items subject to normal wear and tear due to operation are not covered under guarantee.

**Terms to Guarantee**

- The Bill/Cash Memo should be presented.
- No repair work should be carried out by any unauthorised person.
- Product should be used as per the directions given in the user's guide.
- Any defects caused by improper or reckless use are not covered under guarantee.
- The Serial No. has not been tampered with.
- No modification/alteration of any nature is made in the Product.
- Under warranty service / repair will be provided on FOC in the municipality limit of the service centre.
- Outside the municipality limit of the service centre, minimum visiting charges of Rs.500/- will be applicable or customer may bring it to service centre at his own for free service / repair under warranty .

**The company accepts no responsibility for any consequential losses arising out of misuse or negligence on the part of the user.**

**PRODUCT** \_\_\_\_\_ **SERIAL NO :** \_\_\_\_\_

**BILL NO. & DATE :** \_\_\_\_\_ **NAME OF OWNER :** \_\_\_\_\_

**ADDRESS :** \_\_\_\_\_

Manufactured by  
**Glen Appliances Pvt. Ltd.**  
EPIP, Phase-II, Thana Baddi, Tehsil Nalagarh, Distt. Solan (H.P.)

**Customer Care & H.O.**  
I-34, DLF Indl. Area, Phase 1, Faridabad (Haryana), INDIA.  
Phone : 0129-2254191 Fax : 0129-2274344  
E-mail : cr@glenindia.com Website : www.glenindia.com

**Helpline : 9548-130-131**

DEALER'S STAMP & SIGNATURE



**CHIMNEY HOOD**  
**USER'S GUIDE**

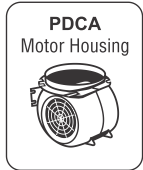

Features may vary with individual models. See product brochure for more details.

## INSTALLATION

- The chimney must be mounted over the center of the cooking area. The minimum distance between the cooktop and the bottom of the chimney must be 750 mm.

- Join the two parts of the spigot (some models may have a single piece) attach it to the hood using the four screws. In a few models the spigot may already be mounted.

### Fastening the chimney to the wall

- Mark the position of the holes on the wall. Before drilling make sure that no wiring and tube will be damaged. Drill two fastening holes, drive in the wall plugs and screw in the screw until their heads are about 6 mm from wall.

- Place the chimney to the wall in order to check that it seats properly. Then mark the position of the two holes. Take it off from the wall now, drill the holes and fit the plugs. Place the hood once again to the wall, and introduce the screw from the inside of the appliance.

- The product can be used in re circulation or the exhaust mode. It is however recommended that wherever possible it should be used in exhaust mode for best results.

### Exhaust mode

- The chimney must be connected by the spigot (supplied as part of the hood) to a duct to vent all the exhausted air outside the kitchen. Over horizontal areas, if any, the duct must be slanted about 10° downwards.
- The diameter of the Duct pipe should be a minimum of 6" (15cm) for all chimneys with suction of 1000m<sup>3</sup>/h anything smaller than this will result in vibrations at higher speeds.
- The maximum recommended length of ducting is 10 feet with a maximum of two bends. The suction power of the chimney considerably decreases in case the length of the duct and number of bends increases further.

### Universal Spigot

- Your chimney now comes with a universal spigot for fixing the exhaust pipe. It has 3 steps, one each suitable for 4", 5' & 6" dia. pipe. Based on your requirement you may cut the unwanted portion with hacksaw blade as marked in the picture.
- The cutting is required for 5" & 6" dia. Pipe for smooth flow of the air.

### Re-circulation mode (Available in select model)

- This mode is used when no exhaust duct to the outdoors is available. The air is purified by an active carbon filter and recycled into the room.
- The carbon filter is an optional attachment and must be procured in this case.
- Remove the metal filters. Insert the carbon filters and rotate it to lock at the side of the hood. For effective functioning the carbon filters need to be replaced after 3-4 months.

### Installing the duct covers

- Fix the bracket with 2 plugs and screw at the required height for the duct cover. Screw the short duct with 2 screws on the bracket. Insert the 2 nuts in the holes on the lower part of the long duct. Put the long pipe over the short one by pulling apart the laterals of the duct. Insert the nuts supplied, and working from the inside of the chimney, using the two screws fix the long duct. In few models the long duct can be fixed by using two screws which must be inserted into the holes at the bottom of the duct.

### Electric connection

- Make sure that the supply voltage rating correspond with the specifications provided In the User's Guide.

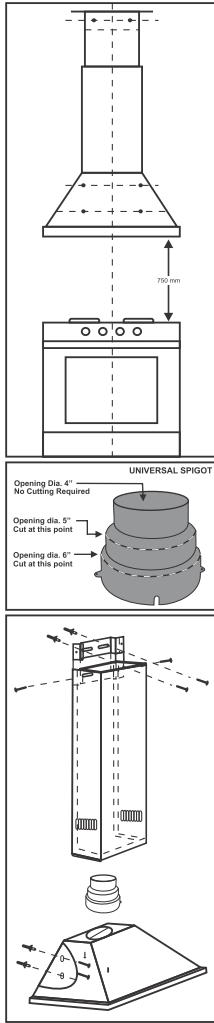

## USAGE

Switch on the chimney 5 minutes before you start cooking. The Soft Touch Electronic push button/slider control have three speed settings. Kindly choose the speed as per your requirement.

### Slider Control

- It has three speed setting and can be selected as per the requirement by sliding the speed knob. For hob light, slide the other knob.

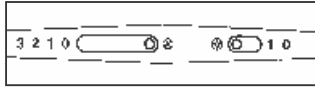

### Push Button Control

- It has four buttons and a light indicator. By pressing the first button you can switch on the hob light. By pressing the second button, chimney will start at speed 1 and indicator will start glowing. Speed second and third can be selected by just pressing the respective buttons.

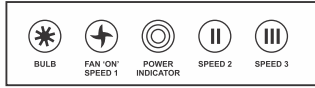

- To switch off just press the second button which has fan mark on it. The chimney will be switched off.

### Soft Touch Electronic Control

- It has four soft touch rectangle buttons and a digital display. By just pressing the button with light indicator hob light will be switched on. To start the chimney press the button having (+) mark and to increase the speed press once more. The level of speed will be displayed in the digital display. To reduce the speed or to switch off press the button which (-) mark .

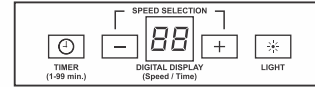

- It also has an auto off timer and to set this you have to press the button with the clock on it and the display will show the time it can be set between 1-99 minutes by pressing again and again. Once you leave the same, the Chimney will switch off automatically at the end of the timer.

### Touch Sensor Control

- To switch on the power, touch (⏻) . Fan speed can be selected by touching ① ② ③ . You can also start by touching the desired speed directly.

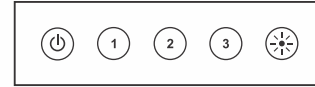

- Auto Shut Off / Timer : To switch off the chimney touch (⏻) and the light will start blinking, speed will get reduce to 1 and chimney will switch off automatically after 3 minutes. In case you want instant stop, touch (⏻) once more. By touching (⏻) you can switch on/off the hob light.

### Touch Control

- The chimney is provided with a touch control panel. Switch on the power with On/Off switch select the fan speed by touching the fan button, once for speed 1, again for speed 2, again for speed 3 and again for speed zero.



- **Auto** : The chimney has an auto sensor feature, where by it senses heat or gas (LPG) leaks under the hood and automatically gets on, for selecting the auto function, switch on the power and touch the auto function button once.

- **Timer** : The chimney can be set to be off after a set time using the timer function. Every touch to the timer switch will increase the set time by one minute upto 99 minutes.

- **LED lamps** : The chimney is provided with energy efficient LED lamps. They consume only a fraction of electricity as compared to any other lighting and last about ten times longer. LEDs contain no mercury and are environmentally safe. They also remain cool to the touch. The touch control switch is electronic and may malfunction or stop working due to sudden surge of voltage. It should not be used on inverter or generator power.

## MAINTENANCE

- When performing maintenance operations, disconnect the plug from the socket.
- The efficiency of the chimney depends on the condition of the filters.
- The filters should be washed as often as possible but at least once in 10 to 15 days in normal operating conditions.
- The baffle & aluminium filters can be removed easily by unlocking.
- Dip the filter for 10-15 minutes into a boiling hot soap solution and then wash in running water. Dry and reinstall the filter.
- The chimney surface should be cleaned with a damp cloth. No abrasive chemicals should be used.

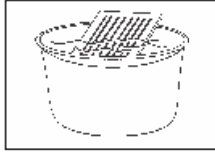

## DO'S & DON'T'S

- No flame based cooking should be done below the chimney.
- While frying do not leave the cooking oil unattended as it may flare up and cause fire.
- Clean all the oily residues on surface frequently to avoid fire.
- The minimum distance between the cooktop and the bottom of the chimney must be 750 mm.
- Make sure that the supply voltage ratings correspond with the specifications provided in the User's Guide.
- Before using the chimney for the first time please ensure that all plastic films on baffle filter and stainless body are removed.
- Wash the filters as often as possible at least once in 10-15 days in normal operating conditions.
- When performing maintenance operations, disconnect the plug from the socket.
- No repair work should be carried out by any unauthorised person.
- In case the chimney is installed in the under construction Kitchens, it is advisable to install the Chimney, test it and then again remove the same and pack in the box. As if the Chimney is left unattended the paints, chemicals, dust & moisture etc if not cleaned timely may result in rust formation which will not be covered in the warranty.
- Chimney should be used as per the directions given in the User's Guide.
- Do not allow children to operate the chimney.

## LIFETIME WARRANTY (On select models only)

To avail the lifetime warranty you need to register online within 90 days of your purchase.

To register online you need to do the following:

Log on to glen website [www.glenindia.com](http://www.glenindia.com)

Click on lifetime warranty, it will open a window there you need to feed the Lifetime Warranty unique ID, model number and serial number of the chimney hood.

For LTW unique ID and serial number you need to open the chimneyhood. You will find two labels one for LTW unique ID and other for serial number. **(Never ever remove the labels otherwise the warranty becomes void).**

If all your information is correct and matches with our record another window will open wherein you will need to fill the personal details like name & address etc.

Once you complete the information and press submit a confirmation number will be given for future reference. Also one confirmation mail with all the details will be sent to your email id. You are requested to take a printout of the same and keep it safe. In case of any repair in future you will need to show this mail to the service engineer to avail the lifetime warranty.

**Note** : The offer lapses if not registered with in 90 days of date of purchase.