

Primo
149 Shaw Ave Irvington NJ 07111
www.Primobaby.com

(5) Highchair Conversion to Toddler Chair

Unscrew bottom half of legs and attach footpads to bottom of chair.

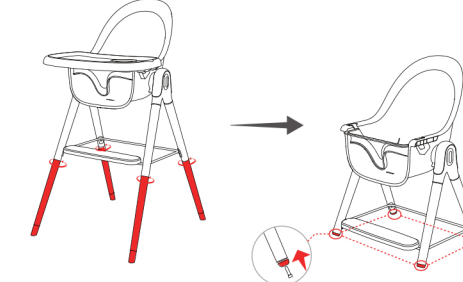

(5) Rock Chair Conversion

Remove footpads from toddler chair and install rocking legs using 4 M6*20 screws. Rocking chair has 3 adjustable backrest recline positions. Note: Footrest can be removed if desired while in use as rocking chair or toddler chair.

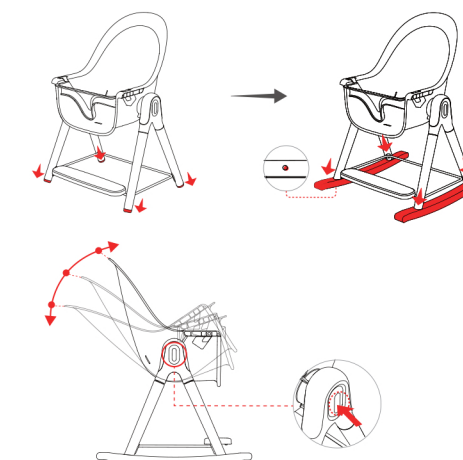

(4) Harness Adjustment

- To fasten safety harness, insert two side straps into center buckle as shown in Pic 4-2.
- To unfasten safety harness, press center button as shown in Pic 4-3.

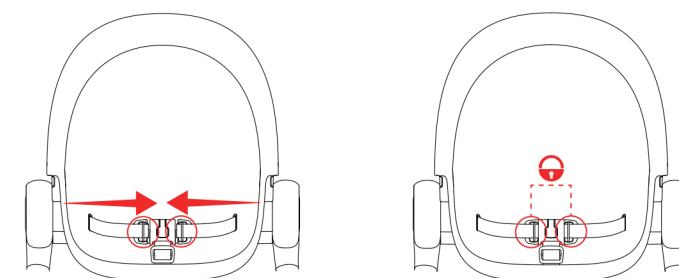

Pic4-2

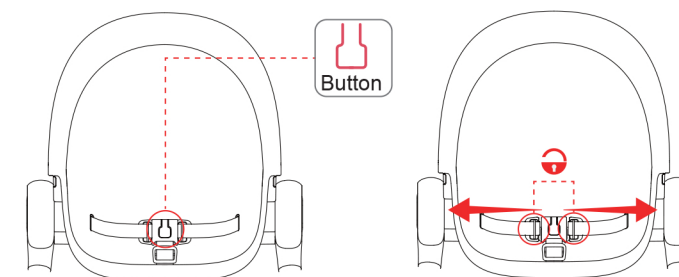

Pic4-3

Warning: Baby *must* use the safety harness while sitting in High Chair.

(2) Tray Adjustment & Installation

- Find both tray buttons on bottom of tray and pull outward at the same time. Insert tray into seat frame until you hear a click.



- Tray has 2 positions, pull button to adjust positions. You will hear a click when the tray has locked into place.

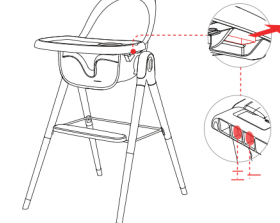

(3) Seat Recline Adjustment

- Press both side buttons simultaneously to adjust chair recline angle. The Vista has 3 possible levels of recline.

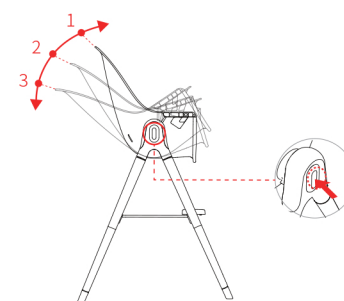

(5) Insert T-bar into the seat frame.

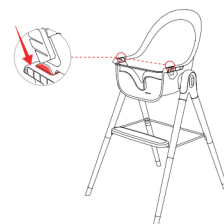

- Check to make sure that all of the parts are stable and attached securely. You may need to rotate foot pads so that they sit flat on the ground as shown below.

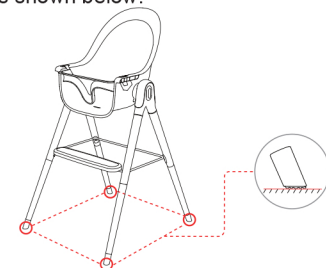

(7) Basic assembly complete!

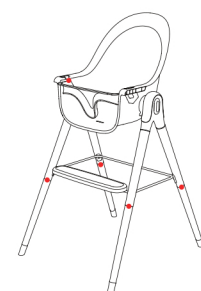

2. Installation

(1) Highchair Assembly

1. Part List

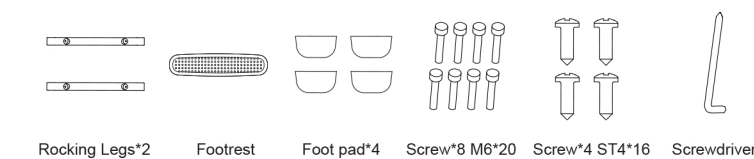
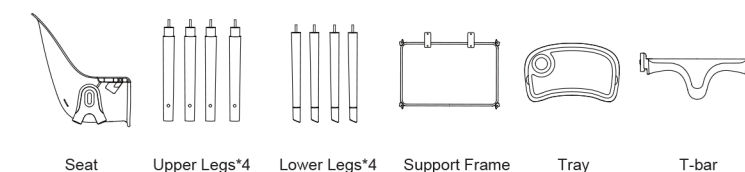

Pic4-1

- Screw upper legs (marked A/B/C/D) into lower legs (marked A/B/C/D). Ensure that upper and lower legs are matched into corresponding leg.



- Screw completed legs into seat frame.

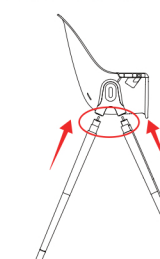

- Screw support frame tightly into legs with M6*20 screws. You may need to slightly turn the legs counterclockwise to align holes in the legs with support frame.

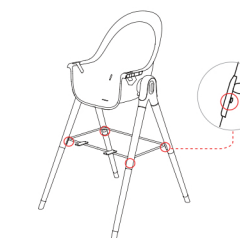

- Attach the footrest to the support frame using the ST4*16 screws.

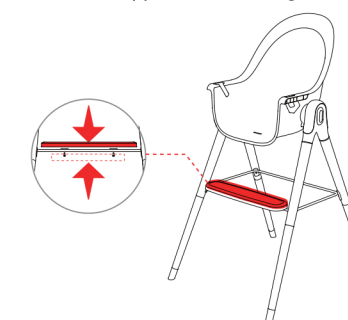

WARNING

FALL HAZARD: Children have suffered severe head injuries including skull fractures when falling from high chairs. Falls can happen suddenly if child is not restrained properly.
1) Always use restraints, and adjust to fit snugly.
2) Tray is not designed to hold child in chair.
3) Stay near and watch child during use.

RISQUE DE CHUTE: Des enfants ont subi de graves blessures à la tête, y compris des fractures du crâne en tombant d'une chaise haute. Les chutes peuvent survenir soudainement si l'enfant n'est pas correctement retenu.
1) Utilisez toujours des dispositifs de retenue et ajustez-les pour qu'ils s'adaptent parfaitement.
2) Le plateau n'est pas conçu pour tenir un enfant dans une chaise.
3) Restez à proximité et surveillez l'enfant pendant l'utilisation.

PELIGRO DE CAÍDAS: Los niños han sufrido lesiones graves en la cabeza, incluidas fracturas de cráneo, al caer de sillas altas. Las caídas pueden ocurrir repentinamente si el niño no se sujeta correctamente.
1) Utilice siempre sistemas de sujeción y ajústelos para que queden bien.
2) La bandeja no está diseñada para sostener a un niño en una silla.
3) Permanezca cerca y observe al niño durante el uso.

"VISTA" Serial #: Ages: 6-36 Months Max: 30 Lbs/13 Kg
PRIMO 149 Shaw Ave Irvington, NJ 07111 Tel: 973-926-5900
www.primobaby.com

Maintenance

1. Cleaning Instructions:

- Seat & Feeding Tray: Wipe with damp cloth and soap.
- Legs: Wipe down with damp cloth and dry immediately.
- Feeding Tray Top: Top-rack dishwasher safe or clean with soap and water.

- Exposure to high heat or direct sunlight for extended periods can cause damage to plastic products.

1. Part List

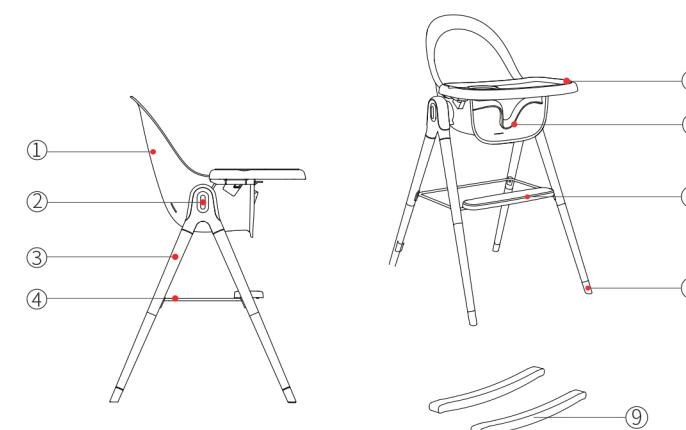

- Seat
- Reclining Adjust Button
- Wooden leg
- Support Frame
- Tray
- Footrest
- Foot Pad
- T-bar
- Rocking legs