

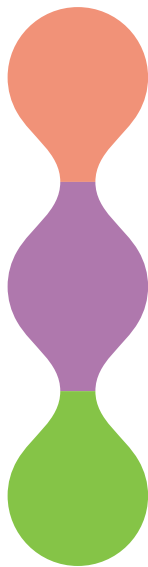

Model No:
GK-5001M

User Guide

Multi-device
maca keys mini



Version 1.10
(English | Indonesian)

1 Package Contents

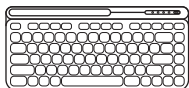

x 1



x 1



x 1



x 1

2 Overview

Front View

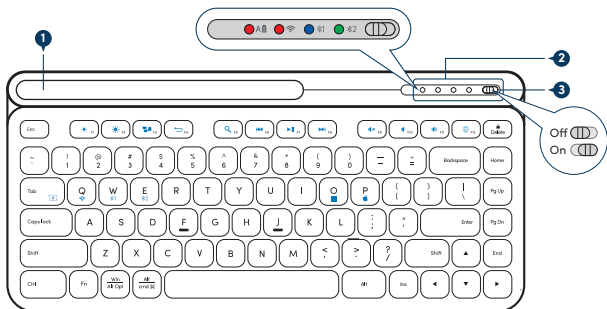

Rear View

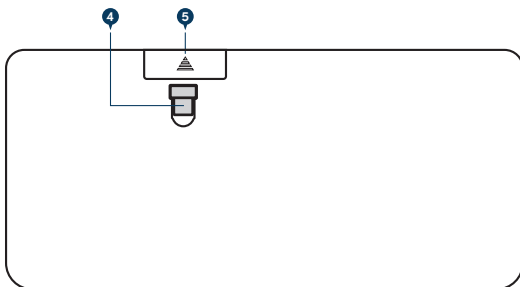

2 Overview

Interface

1. Holder for mobile device
2. LED Indicators
3. On/off button
4. Nano USB receiver
5. Battery compartment

Mobile Device Holder

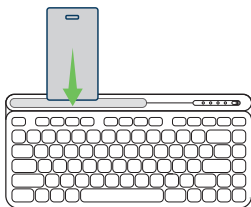

3 Features

- Compact keyboard
- Holder for mobile device
- Switch between multiple devices easily
- Dual-mode: Wireless 2.4GHz + Bluetooth 5.0
- 82 keys compact structure
- Operating range up to 10 meters
- Keys lifespan 5 million times
- Auto sleep mode after 30mins of inactivity
- Anti-bacterial

4 Connection mode

Dual-mode connection

GK-5001M connects with up to three devices using Wireless 2.4GHz or Bluetooth and lets you switch effortlessly between them simultaneously.

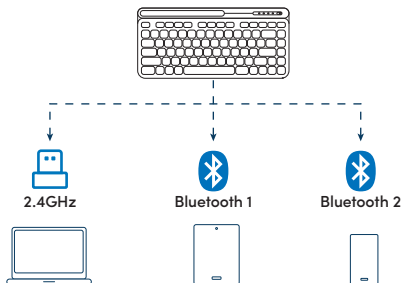

Wireless 2.4GHz mode

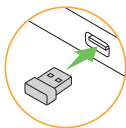

1. Insert nano USB receiver

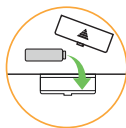

2. Insert the battery into battery compartment

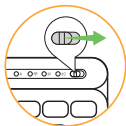

3. Switch ON the keyboard



4. Keyboard is ready to use

*If no response, please eject the receiver and insert to another USB port of the computer or replace a new battery

4 Connection mode

Bluetooth mode

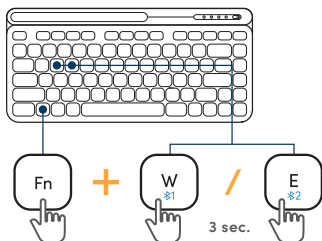

Press and hold FN + W (Bluetooth symbol) / E (Bluetooth symbol) keys for 3 seconds, the indicator light flashes when entering pairing mode (Blue/Green light). From your device's screen, select "GK5001M_BT3" or "GK5001M_BT5" and click "Pair".

Notes:

- Recommended: Connect to "GK5001M_BT5" (Bluetooth 5.0 BLE) for better connection stability.
- Successful Bluetooth 5.0 connection is dependent on the hardware compatibility of the device(s) you connect to.

Toggle between devices

Simply press the combination keys and connect to respective device.

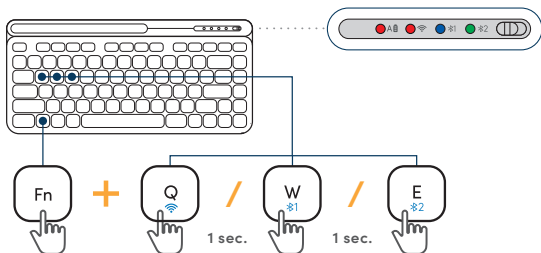

- Fn + Q Connect to Wireless 2.4GHz channel (LED blinks in Red)
- Fn + W Connect to Bluetooth 1 channel (LED blinks in Blue)
- Fn + E Connect to Bluetooth 2 channel (LED blinks in Green)

4 Connection mode

Toggle between Operating System (OS)

Select a specific OS layout by holding the combination keys for 3 seconds.

Windows OS / Android OS

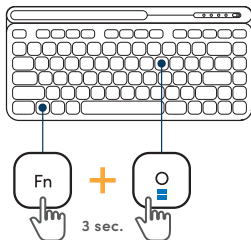

macOS / iPadOS / iOS

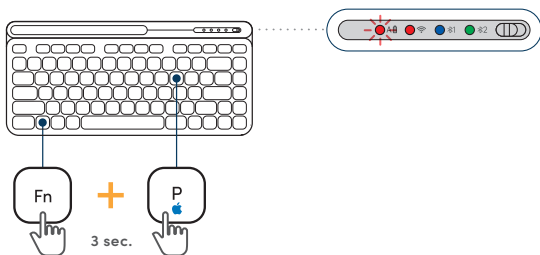







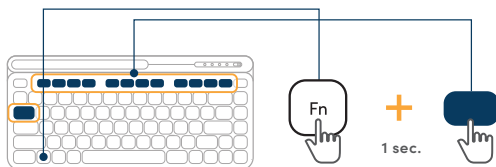





*LED blinks in Red after switching to macOS / iPadOS / iOS layout successfully

5 Shortcuts and function keys

The tables below shows multimedia shortcuts available for Windows, macOS, Android, iPadOS and iOS.



Keys	 F1	 F2	 F3	 F4	 F5	 F6	 F7
Functions	Decrease display brightness	Increase display brightness	Task switcher	Return	Search	Previous track	Play/Pause

Keys	 F8	 F9	 F10	 F11	 F12	 Tab
Functions	Next track	Mute	Decrease volume	Increase volume	Switch input language	Screenshot

*Task Switcher (Fn+F3): Not available on iPhone iOS

**Switch Input Language (Fn+F12): Recommended to use Shift + Space for Android (except Huawei) default keyboard.

1 Isi Kemasan

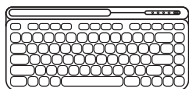

x 1



x 1



x 1



x 1

2 Keterangan Gambar

Tampak hadapan

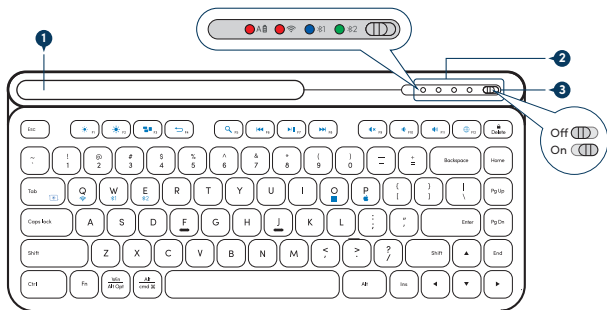

Tampak belakang

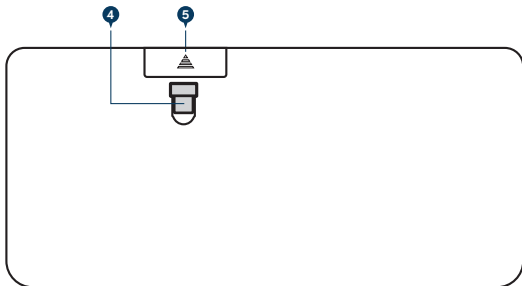

2 Keterangan Gambar

Antarmuka

1. Pemegang untuk perangkat seluler
2. Indikator LED
3. Butang on/off
4. Penerima USB nano
5. Kompartemen baterai

Pemegang Perangkat Seluler

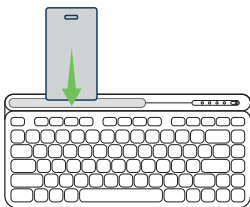

3 Fitur

- Papan ketik yang ringkas
- Alur untuk perangkat seluler
- Beralih di antara beberapa perangkat dengan mudah
- Mode ganda - Nirkabel 2.4GHz + BT3.0 / BT5.0
- 82 kunci struktur kompak
- Jangkauan operasi hingga 10 meter
- Umur kunci 5 juta kali
- Mode tidur otomatis setelah 30 menit tidak aktif
- Anti-bakteri

4 Mode koneksi

Koneksi mode ganda

GK-5001M terhubung dengan hingga tiga perangkat menggunakan Wireless 2.4GHz or Bluetooth dan memungkinkan Anda beralih dengan mudah di antara keduanya secara bersamaan.

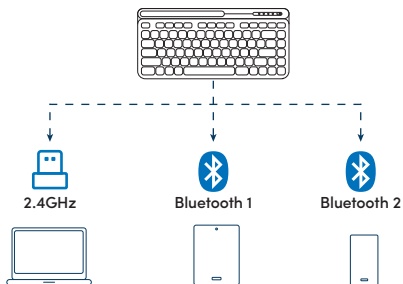

Mode nirkabel 2.4GHz

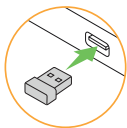

1. Masukkan penerima USB nano

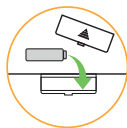

2. Masukkan baterai ke dalam kompartemen baterai

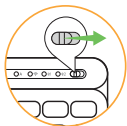

3. Nyalakan keyboard



4. Papan ketik siap digunakan

*Jika tidak ada tanggapan, harap keluarkan receiver dan masukkan ke port USB lain di komputer atau ganti baterai baru

4 Mode koneksi

Mode Bluetooth

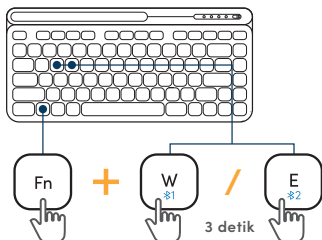

Tekan dan tahan tombol FN + W (*1) / E (*2) selama 3 detik, lampu indikator berkedip saat memasuki mode berpasangan (lampu **Biru/Hijau**). Dari perangkat Anda layar, pilih "GK5001M_BT3" atau "GK5001M_BT5" dan klik "Pair".

Nota:

- Direkomendasikan: Hubungkan ke "GK5001M_BT5" (Bluetooth 5.0 BLE) untuk stabilitas koneksi yang lebih baik.
- Koneksi Bluetooth 5.0 yang berhasil bergantung pada kompatibilitas perangkat keras perangkat yang Anda gunakan terhubung ke.

Beralih antar perangkat

Cukup tekan tombol kombinasi dan sambungkan ke perangkat masing-masing.

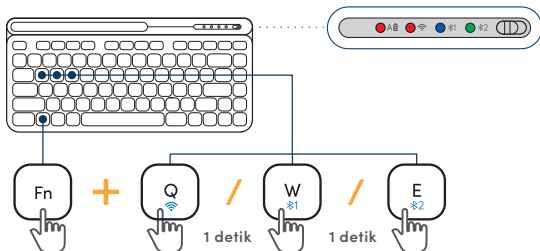

Fn + Q Hubungkan ke saluran Nirkabel 2.4GHz (LED berkedip dalam warna **Merah**)

Fn + W Hubungkan ke saluran Bluetooth 1 (LED berkedip dengan warna **Biru**)

Fn + E Hubungkan ke saluran Bluetooth 2 (LED berkedip dalam warna **Hijau**)

4 Mode koneksi

Beralih antara Sistem Operasi (OS)

Pilih tata letak OS tertentu dengan menahan tombol kombinasi selama 3 detik.

Windows OS / Android OS

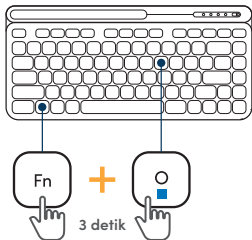

macOS / iPadOS / iOS

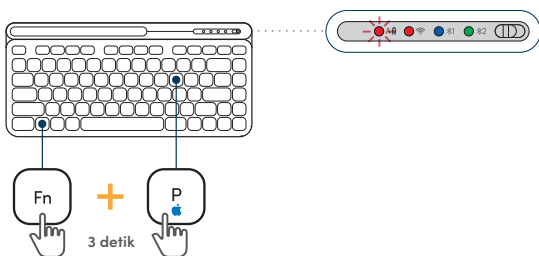

*LED berkedip Merah setelah berhasil beralih ke tata letak macOS / iPadOS / iOS

5 Pintasan dan tombol fungsi

Tabel di bawah ini menunjukkan pintasan multimedia yang tersedia untuk Windows, macOS, Android, iPadOS, dan iOS.

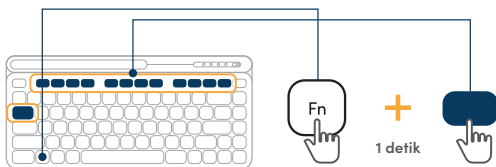

Kunci							
Fungsi	Mengurangi menampilkan kecerahan	Meningkatkan menampilkan kecerahan	Tugas pengalih	Kembali	Mencari	Lacak sebelumnya	Putar/Jeda

Kunci						Tab
Fungsi	Lacak berikutnya	Memisukan	Mengurangi volume	Meningkatkan volume	Beralih masukan bahasa	Tangkapan layar

*Pengalih Tugas (Fn+F3): Tidak tersedia di iPhone iOS

**Beralih Bahasa Input (Fn+F12): Disarankan untuk menggunakan Shift + Spasi untuk Android (kecuali Huawei) papan ketik bawaan.

Worldwide Customer Care Centers

INDONESIA Office

PT PROLINK INTIDATA NUSANTARA

Walk-In : Jl. Cideng Barat No. 79, Jakarta Pusat 10150, Indonesia.

Telephone : +62 21 3483 1777

Sale Enquiries : sales.id@prolink2u.com

Technical Support: support.id@prolink2u.com

MALAYSIA Office

FIDA SYSTEMS (M) SDN BHD

Walk-In : 29 Jalan USJ 1/31, 47600 Subang Jaya, Selangor Darul Ehsan, Malaysia.

Telephone : +60 3 8024 9151

Sale Enquiries : sales.my@prolink2u.com

Technical Support: support.my@prolink2u.com

SINGAPORE Office

FIDA INTERNATIONAL (S) PTE LTD

Walk-In : Block 16 Kallang Place #06-02, Kallang Basin Industrial Estate, Singapore 339156.

Telephone : +65 6357 0668

Sale Enquiries : sales@prolink2u.com

Technical Support: support@prolink2u.com

Technical Support Hotline

INDONESIA : +62 21 3483 1717

MALAYSIA : +60 3 8023 9151

SINGAPORE : +65 6357 0666

Note: Closed on Saturdays, Sundays and local/regional Public Holidays.

Register online for your Product Warranty at www.prolink2u.com

Prolink is a registered trademark of Fida International (S) Pte Ltd. Other brands and product names are trademarks or registered trademarks of their respective holders. Product images are purely for illustrative purposes and may differ from the actual product. Specifications are subjected to changes without prior notice. Copyright © 2022 Fida International (S) Pte Ltd.

Kami mengucapkan terima kasih atas kepercayaan Anda memilih produk kami dan selaku distributor di Indonesia, kami memberikan garansi produk selama 1 (satu) tahun.

1. Garansi Hanya Berlaku Jika:

- a. Diisi dengan jelas, lengkap dan benar.
- b. Jika telah dikirimkan dan diterima oleh PT. Prolink Intidata Nusantara.
- c. Memperlihatkan kartu garansi asli dan nota pembelian pada saat klaim service.

2. Garansi Tidak Berlaku Apabila:

- a. Kerusakan yang disebabkan oleh, kelalaian pemakai, bencana alam, kebakaran, tegangan listrik yang terlalu tinggi / rendah, terkena cairan.
- b. Kerusakan yang diakibatkan karena transportasi / pengiriman, pemasangan / pengoperasian yang tidak sesuai dengan buku petunjuk, penyambungan dengan alat lain.
- c. Barang yang diservice tidak sesuai dengan kartu garansi.
- d. Serial number rusak / robek / tidak ada.

3. Ruang Lingkup Garansi:

- a. Garansi hanya mencakup bagian-bagian / komponen perangkat keras dari konfigurasi standar yang terdapat pada spesifikasi produk sesuai dengan faktur.
- b. Standart garansi, Barang yang akan di service di kirimkan ke service center kami oleh user.

Daftarkan secara online untuk jaminan produk Anda di www.prolink2u.com

*Biaya pengiriman ditanggung pembeli



prolink

Tempelkan perangkat
disini.
Hanya untuk pengeposan
di Indonesia

**Kepada Yth.
Customer Service
PT. PROLINK INTIDATA NUSANTARA
Jl. Cideng Barat No. 79
Jakarta Pusat 10150 - Indonesia**



KARTU GARANSI
(for Indonesia region only)

No:

KARTU GARANSI / WARRANTY CARD

(for Indonesia region only)

Barang : Data Comm Networking
 Product : UPS Display* Accessories

S/N:

Nama :
 Name :

Model:

Alamat :
 Address :

Tgl. Pembelian :
 Purchase Date :

Dealer :
 Toko :

Kota: Kode Pos:

Kota :
 City :

Tel / Fax:

Email:

Pelanggan

PT. Prolink Intidata Nusantara

Cap Toko

Kartu Garansi harus diisi lengkap, kirimkan paling lambat 14 Hari setelah Tgl. Pembelian / Please Fill-in Your Warranty Card Completely and Send max. 14 day after Purchase

Alamat Pengiriman : PT. PROLINK INTIDATA NUSANTARA
 Address : Jl. Cideng Barat No. 79 Jakarta Pusat 10150 - Indonesia

Telp. : (62-21) 34831777
 Fax : (62-21) 34830788
 Email : service@prolink.com.co.id



No:

KARTU GARANSI / WARRANTY CARD

(for Indonesia region only)

Barang : Data Comm Networking
 Product : UPS Display* Accessories

S/N:

Nama :
 Name :

Model:

Alamat :
 Address :

Tgl. Pembelian :
 Purchase Date :

Dealer :
 Toko :

Kota: Kode Pos:

Kota :
 City :

Tel / Fax:

Email:

Pelanggan

PT. Prolink Intidata Nusantara

Cap Toko

Kartu Garansi harus diisi lengkap, kirimkan paling lambat 14 Hari setelah Tgl. Pembelian / Please Fill-in Your Warranty Card Completely and Send max. 14 day after Purchase

Alamat Pengiriman : PT. PROLINK INTIDATA NUSANTARA
 Address : Jl. Cideng Barat No. 79 Jakarta Pusat 10150 - Indonesia

Telp. : (62-21) 34831777
 Fax : (62-21) 34830788
 Email : service@prolink.com.co.id