

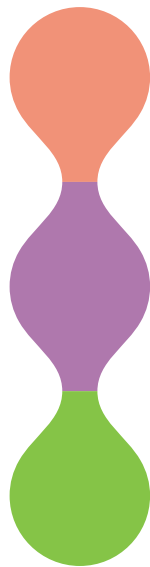

Model No:  
GK-6002M/  
GK-6002MS

# User Guide

Mechanical gaming  
keyboard



Version 2.10  
(English | Indonesian)

## 1 Package Contents

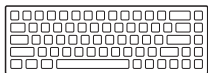

x 1



x 1



x 1

Accessory kit x 1



\*Applicable for GK-6002MS hot-swap version only

## 2 Overview

Side View

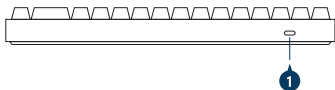

Bottom View

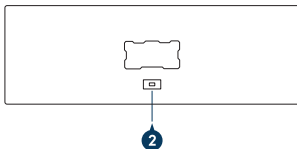

Interface

1. USB-C port

Button

2. LED on/off switch

## 2 Overview

### Front View

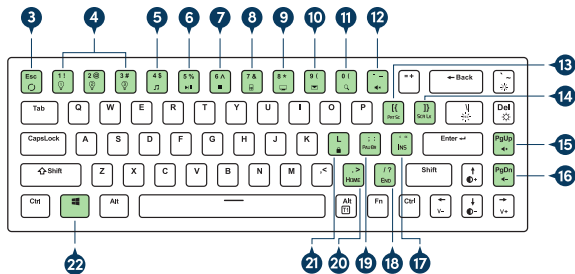

### Fn shortcuts

3. Fn + (ESC) Restore factory default (press and hold for 3 – 5 seconds)
4. Fn + (1 – 3) Lighting profile 1 – 3
5. Fn + (4) Media player
6. Fn + (5) Play/ Pause
7. Fn + (6) Stop
8. Fn + (7) Calculator
9. Fn + (8) My Computer
10. Fn + (9) Mail
11. Fn + (0) Search
12. Fn + (-\_) Mute
13. Fn + ([) Print Screen
14. Fn + (]) Scroll Lock
15. Fn + (Pg Up) Increase Volume
16. Fn + (Pg Dn) Decrease Volume
17. Fn + (“ ”) Insert
18. Fn + (/ ?) End
19. Fn + (; :) Pause Break
20. Fn + (. >) Home
21. Fn + (L) Lock/ unlock the keyboard (press and hold for 3 – 5 seconds). L Key will light up in White to indicate that keyboard is locked
22. Fn + (Win) Win lock

### 3 Features

- Plug & play
- 68 keys space-saving design
- RGB backlighting
- 12 preset lighting effects
- 3 customizable lighting profiles
- Outemu switches
- Detachable 1.75m USB-A to C braided cable
- Full N-key rollover (68 anti-ghosting keys)
- Durable double-injection keycaps
- 50 million keystrokes
- Windows lock function

### 4 Hardware Installation

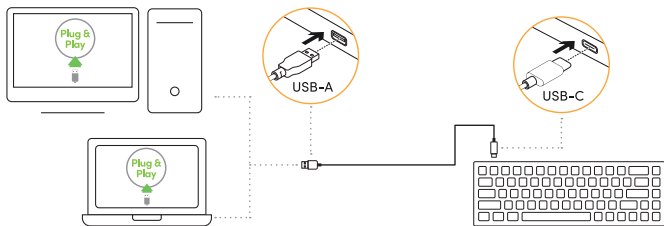

#### How to change the mechanical switch

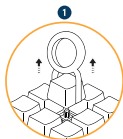

Use the keycap puller to detach the keycaps

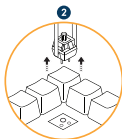

Place the switch puller on the tiny tabs of each switch. Squeeze the switch puller to press the tabs in, allowing you to pull the switch up to remove it from the keyboard

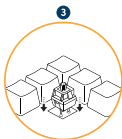

Ensure the two copper pins of the switch are straightened before inserting into each slot. Align switch with the respective slots and push in gently



Check if each switch is properly secured before reattaching the keycap

## 5 LED Illumination (Keyboard)

### On/Off LED



Switch on/ off RGB lighting

### Toggle between 12 preset lighting effects



Basic Glow, Snake, Touch to Glow, RGB Spectrum, Linear, Rainbow Wave, Strobe, Waterfall, Ripple, Inwards Wave, Mystical and Static

### Toggle between 7 LED colours



Turquoise, Red, Green, Blue, Pink, Yellow and White (applicable for single-colour lighting modes only)

### Adjust LED brightness



Increase/ decrease lighting intensity

### Adjust backlight speed













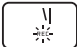

Increase/ decrease dynamic lighting movement

## 5 LED Illumination (Keyboard)

### Customize lighting profiles

Design up to 3 sets of static lighting profiles.

-  +  Start creating by clicking on **Fn + \**. **Numeric 1, 2 and 3** will start flashing
-  /  /  Select any of the flashing Numeric keys to customize desired lighting pattern. Change a key's colour by tapping repetitively to cycle through the colour spectrum
-  +  Save your configuration and exit. Repeat above step to customize other two keys
-   +  /  Launch your customized lighting profiles 1, 2, or 3
-  +  Press and hold 3 – 5 seconds to restore factory default

## 6 Anti-Ghosting Keys

**N-key rollover (NKRO)** enables each keypress to be correctly detected, regardless of the number of keys being pressed simultaneously.

This prevents "**ghosting**", where certain keystrokes may not be registered when two or more keys are pressed together.

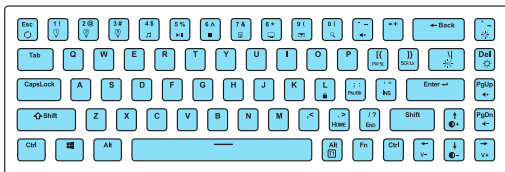

## 7 Key Mapping

### Transcoding-1



#### To activate

Press and hold for 3 – 5 seconds. **Alt** key will light up in White



F1



F5



F9



F2



F6



F10



F3



F7



F11



F4



F8



F12



#### To deactivate

Press and hold for 3 – 5 seconds. LED of **Alt** key will return to the current lighting effect

## 1 Isi Kemasan



Aksesori kit x 1



\*Berlaku untuk versi hot-swap GK-6002MS saja

## 2 Keterangan Gambar

Tampak Sisi

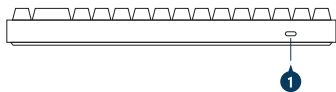

Tampak Bawah

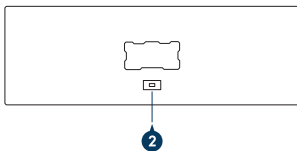

**Antaramuka**

1. Port USB-C

**Tombol**

2. LED on/off switch



## 2 Keterangan Gambar

### Tampak Hadapan

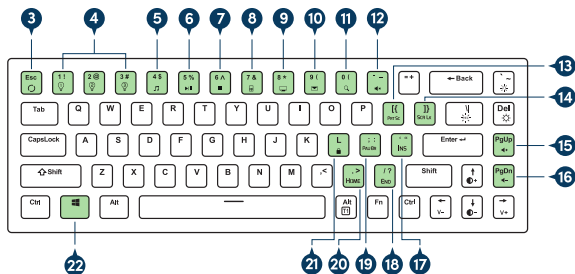

### Pintasan Fn

3. Fn + (ESC) Kembalikan default pabrik (tekan dan tahan selama 3 – 5 detik)
4. Fn + (1 – 3) Lighting profile 1 – 3
5. Fn + (4) Media player
6. Fn + (5) Play/ Pause
7. Fn + (6) Berhenti
8. Fn + (7) Kalkulator
9. Fn + (8) My Computer
10. Fn + (9) Mail
11. Fn + (0) Search
12. Fn + (-\_) Mute
13. Fn + ([) Print Screen
14. Fn + ([ ]) Scroll Lock
15. Fn + (Pg Up) Increase Volume
16. Fn + (Pg Dn) Decrease Volume
17. Fn + (" ") Insert
18. Fn + (/ ?) End
19. Fn + (; :) Pause Break
20. Fn + (. >) Home
21. Fn + (L) Mengunci/membuka kunci keyboard (tekan dan tahan selama 3 – 5 detik). Tombol L akan menyala Putih untuk menunjukkan bahwa keyboard terkunci
22. Fn + (Win) Win lock

### 3 Fitur

- Plug & play
- 68 kunci desain hemat-ruang
- lampu latar RGB
- 12 efek pencahayaan preset
- 3 profil pencahayaan yang dapat disesuaikan
- Sakelar Outemu
- Kabel jalinan USB-A ke C 1.75m yang dapat dilepas
- Rollover N-key penuh (68 tombol anti-ghosting)
- Keycaps injeksi ganda yang tahan lama
- 50 juta penekanan tombol
- Fungsi kunci Windows

### 4 Instalasi Perangkat

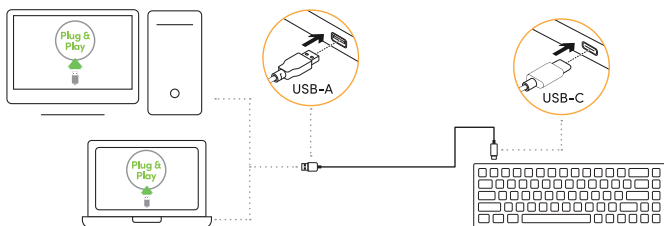

### Cara mengganti sakelar mekanis

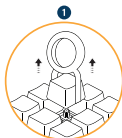

Gunakan penarik keycap untuk melepaskan keycaps

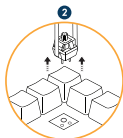

Tempatkan penarik sakelar pada tab kecil setiap sakelar. Peras penarik sakelar untuk menekan tab, memungkinkan Anda menarik sakelar ke atas untuk melepaskannya dari keyboard

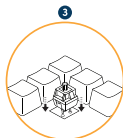

Pastikan kedua pin tembaga sakelar diluruskan sebelum memasukkan ke setiap slot. Sejajarkan sakelar dengan slot masing-masing dan tekan dengan lembut



Periksa apakah setiap sakelar diamankan dengan benar sebelum memasang kembali keycap

## 5 Penerangan LED (Keyboard)

### LED Hidup/Mati



Menghidupkan/mematikan pencahayaan RGB

### Beralih di antara 12 efek pencahayaan prasetel



Cahaya Dasar, Ular, Sentuh untuk Cahaya, Spektrum RGB, Linier, Gelombang Pelangi, Strobo, Air Terjun, Riak, Ke dalam Gelombang, Mistik dan Statis

### Beralih antara 7 warna LED



Pirus, Merah, Hijau, Biru, Merah Muda, Kuning dan Putih (berlaku untuk satu warna mode pencahayaan saja)

### Sesuaikan kecerahan LED



Menambah/mengurangi intensitas pencahayaan

### Sesuaikan kecepatan lampu latar















Menambah/mengurangi dinamis gerakan pencahayaan

## 5 Penerangan LED (Keyboard)

### Sesuaikan profil pencahayaan

Rancang hingga 3 set profil pencahayaan statis.

-  +  Mulai membuat dengan mengklik **Fn + \.** **Numerik 1, 2 dan 3** akan mulai berkedip
-  /  /  Pilih salah satu tombol Numerik yang berkedip untuk menyesuaikan pola pencahayaan yang diinginkan. Ubah warna kunci dengan mengetuk berulang kali untuk menelusuri spektrum warna
-  +  Simpan konfigurasi Anda dan keluar. Ulangi langkah di atas untuk menyesuaikan dua tombol lainnya
-  +  /  /  Luncurkan profil pencahayaan khusus Anda 1, 2, atau 3
-  +  Tekan dan tahan 3 – 5 detik untuk mengembalikan ke pabrik default

## 6 Kunci Anti-Ghosting

Rollover N-key (NKRO) memungkinkan setiap penekanan tombol dideteksi dengan benar, terlepas dari jumlah tombol yang ditekan secara bersamaan. Ini mencegah "ghosting", di mana penekanan tombol tertentu mungkin tidak terdaftar saat dua atau lebih tombol ditekan bersamaan.

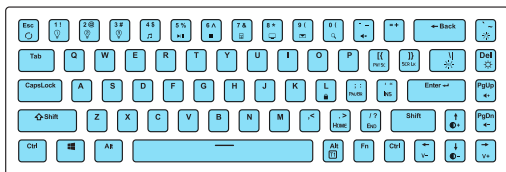

## 7 Pemetaan Kunci

### Transkode-1



#### Mengaktifkan

Tekan dan tahan selama 3 – 5 detik. LED tombol Alt menyala Putih



F1



F5



F9



F2



F6



F10



F3



F7



F11



F4



F8



F12



#### Untuk menonaktifkan

Tekan dan tahan selama 3 – 5 detik. LED tombol Alt akan kembali ke efek pencahayaan sebelumnya

# Worldwide Customer Care Centers

## **INDONESIA Office**

PT PROLiNK INTI|DATA NUSANTARA

Walk-In : Jl. Cideng Barat No. 79, Jakarta Pusat 10150, Indonesia.

Telephone : +62 21 3483 1777

Sale Enquiries : sales.id@prolink2u.com

Technical Support: support.id@prolink2u.com

## **MALAYSIA Office**

FIDA SYSTEMS (M) SDN BHD

Walk-In : 29 Jalan USJ 1/31, 47600 Subang Jaya, Selangor Darul Ehsan, Malaysia.

Telephone : +60 3 8024 9151

Sale Enquiries : sales.my@prolink2u.com

Technical Support: support.my@prolink2u.com

## **SINGAPORE Office**

FIDA INTERNATIONAL (S) PTE LTD

Walk-In : Block 16 Kallang Place #06-02, Kallang Basin Industrial Estate, Singapore 339156.

Telephone : +65 6357 0668

Sale Enquiries : sales@prolink2u.com

Technical Support: support@prolink2u.com

## **Technical Support Hotline**

INDONESIA : +62 21 3483 1717

MALAYSIA : +60 3 8023 9151

SINGAPORE : +65 6357 0666

**Note: Closed on Saturdays, Sundays and local/regional Public Holidays.**

**Register online for your Product Warranty at [www.prolink2u.com](http://www.prolink2u.com)**

Prolink is a registered trademark of Fida International (S) Pte Ltd. Other brands and product names are trademarks or registered trademarks of their respective holders. Product images are purely for illustrative purposes and may differ from the actual product. Specifications are subjected to changes without prior notice. Copyright © 2021 Fida International (S) Pte Ltd.