



# Professional II+ Series (1P/1P)-Tower

PRO900-ES/EL SERIES | 1~10kVA, p.f 0.9



CCTV & Security Systems



Local Area Network (LAN)



Work-Stations



Servers



ATM

Prolink **Professional II+ Series (1P/1P)** is a **single-phase UPS** system using microprocessor controlled true online double conversion technology and it can be used to provide protection for critical loads especially on IT applications. High input power factor correction in the system improves efficiency and reduces overall losses.

Users can easily monitor and access to their UPS status from a comprehensive LCD display. Both Tower and Rack Types of UPS systems have USB and RS-232 communication ports as standard, with a built-in intelligent slot for additional adapters, protocol converters and relay contact cards. SNMP option is also available for power management via SNMP manager and web browser.

In addition, Emergency Power Off (EPO) function is also available to protect the personnel and the equipment in case of fire outbreak or other types of emergency.



## Key Features

- True double-conversion
- Microprocessor control optimizes reliability
- Input power factor correction
- Output power factor 0.9
- Wide input voltage (110 V – 300 V)
- Converter mode available
- ECO mode for energy saving (Only available for 1-3KVA model)
- Generator compatible
- Smart SNMP works well with either USB or RS-232 together
- Emergency Power Off function [EPO]  
(Optional for 1~3kVA, Built-in for 6/10kVA)

## Rear Panel

### 1-3KVA

1. AC input
2. Input circuit breaker
3. USB communication port
4. RS-232 communication port

5. Intelligent slot
6. External battery connection (only available for L model)

7. Output receptacles
8. Output terminal
9. Cooling fan



PRO901-ES

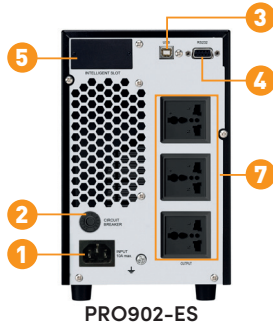

PRO902-ES

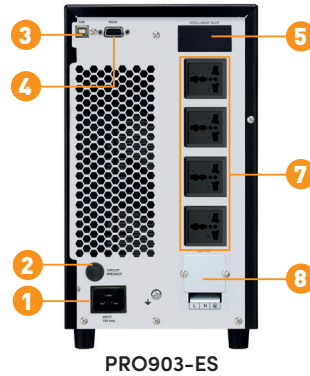

PRO903-ES

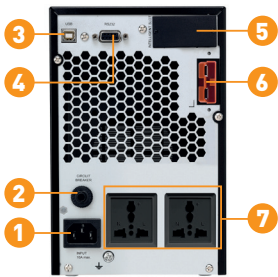

PRO901-EL

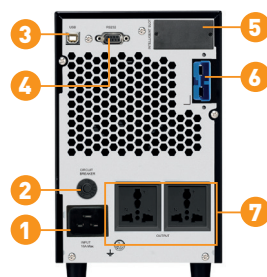

PRO902-EL

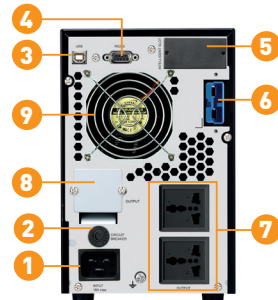

PRO903-EL

Note : IEC/NEMA/Schuko outlets options are also available.

### 6-10KVA

1. External battery connector (Only available for L model)
2. RS-232 communication port
3. Intelligent slot
4. USB Communication port
5. Emergency power off function connector (EPO connector)
6. Cooling fan
7. Input circuit breaker
8. Input/Output terminal
9. Maintenance bypass switch (Optional)



PRO906-ES / PRO910-ES

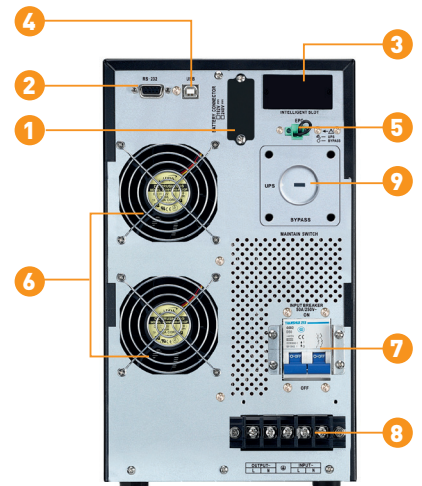

PRO906-EL / PRO910-EL



## Specifications

MODEL	PRO901-ES/EL	PRO902-ES/EL	PRO903-ES/EL	
PHASE	Single phase with ground			
CAPACITY*	1000 VA / 900 W	2000 VA / 1800 W	3000 VA / 2700 W	
<b>INPUT</b>				
Nominal Voltage	200/208/220/230/240VAC			
Input Voltage Range	110-300 VAC (Based on load at 50%) 160-280VAC (Based on load at 100%)			
Frequency Range	40~70 Hz			
Power Factor	≥ 0.99 @ Nominall Voltage (100% load)			
<b>OUTPUT</b>				
Output Voltage	200/208/220/230/240VAC			
Voltage Regulation	± 1 %			
Frequency Range (Synchronized Range)	47~ 53 Hz or 57 ~ 63 Hz			
Frequency Range (Batt. Mode)	50 Hz ± 0.05 Hz or 60Hz ± 0.05 Hz			
Current Crest Ratio	3:1			
Harmonic Distortion	≤ 3 % THD (Linear Load) ≤ 6 % THD (Non-linear Load)			
Transfer Time	AC Mode to Battery Mode	Zero		
	Inverter to Bypass	4 ms (Typical)		
Waveform (Batt. Mode)	Pure Sinewave			
Overload	100%~110%: 3min; 110%~130%: 30sec; >130% : 10sec			
<b>EFFICIENCY</b>				
AC Mode	88%	88%	90%	
Battery Mode	83%	87%	88%	
<b>BATTERY</b>				
Standard Model	Battery Type	12 V / 9 Ah	12 V / 9 Ah	12 V / 9 Ah
	Numbers	2	4	6
	Typical Recharge Time	4 hours recover to 90% capacity		
	Charging Current (max.)	1A		
	Charging Voltage	27.4VDC ± 1%	54.7 VDC ±1%	82.1 VDC ±1%
Long-run Model **	Battery Type	Depending on the capacity of external batteries		
	Numbers	3	6	6
	Charging Current (max.)	1A/2A/4A/6A (Adjustable)		
	Charging Voltage	41.0 VDC ± 1%	82.1 VDC ±1%	82.1 VDC ±1%
<b>INDICATORS</b>				
LCD	Load level, Battery level, AC mode, Battery mode, Bypass mode, and Fault indicators			
<b>ALARM</b>				
Battery Mode	Sounding every 4 seconds			
Low Battery	Sounding every second			
Overload	Sounding twice every second			
Fault	Continuously sounding			
<b>PHYSICAL</b>				
Standard Model	Dimension, DxWxH (mm)	282 x 145 x 220	397 x 145 x 220	421 x 190 x 318
	Net Weight (kgs)	9.8	17	27.6
Long-run Model **	Dimension, DxWxH (mm)	282 x 145 x 220	397 x 145 x 220	
	Net Weight (kgs)	4.1	6.8	7.4
<b>ENVIRONMENT</b>				
Humidity	20-90 % RH @ 0- 40°C (Non-condensing)			
Noise Level	Less than 50dB @ 1 Meter			
<b>SURGE PROTECTION AND FILTERING</b>				
Surge Energy Rating (Joules)	625J			
<b>MANAGEMENT</b>				
Smart RS-232 / USB	Supports Windows® 2000/2003/XP/Vista/2008, Windows® 7/8/10, Linux and MAC			
Optional SNMP	Power management from SNMP manager and web browser			
<b>COMPLIANCE STANDARDS</b>				
Safety	IEC/EN 62040-1			
EMC	IEC/EN 62040-2			
Performance	IEC/EN 62040-3			

\*1-3KVA: Derate to 80% of capacity in Frequency converter mode and to 80% when the output voltage is adjusted to 200/208VAC.

\*\*Long-run model is only available for 200/208/220/230/240VAC systems.

Product specifications are subject to change without further notice.

100/110/115/120/127VAC input and output is available as an option for 1~3KVA



## Specifications

MODEL	PRO906-ES/EL	PRO910-ES/EL	
PHASE	Single phase with ground		
CAPACITY *	6000VA / 5400W	10000 VA / 9000 W	
<b>INPUT</b>			
Nominal Voltage	208/220/230/240VAC		
Input Voltage Range	110-300 VAC (Based on load at 50%) 176-300 VAC (Based on load at 100%)		
Frequency Range	40~70 Hz		
Power Factor	≥ 0.99 @ Nominal Voltage (100% load)		
<b>OUTPUT</b>			
Output Voltage	208/220/230/240VAC		
Voltage Regulation	± 1 %		
Frequency Range (Synchronized Range)	46~54 Hz or 56~64 Hz		
Frequency Range (Batt. Mode)	50 Hz or 60Hz ± 0.1 Hz		
Current Crest Ratio	3:1		
Harmonic Distortion	≤ 3 % THD (Linear Load) ≤ 5 % THD (Non-linear Load)		
Transfer Time	AC Mode to Battery Mode Inverter to Bypass	Zero Zero	
Waveform (Batt. Mode)	Pure Sinewave		
Overload	100%~110%: 3min; 110%~130%: 30sec; >130% : 10sec		
<b>EFFICIENCY</b>			
AC Mode	92%	93%	
Battery Mode	90%	91%	
<b>BATTERY</b>			
Standard Model	Battery Type	12 V / 9 Ah	
	Numbers	16	
	Typical Recharge Time	9 hours recover to 90% capacity	
	Charging Current (max.)	1 A / 2 A	
Long-run Model **	Charging Voltage	218.4 VDC ±1%	
	Battery Type	Depending on the capacity of external batteries	
	Numbers	16 ~ 20 (Adjustable)	
	Charging Current (max.)	1A/2A/4A/6A (Adjustable, 6A is only available for 16pcs batteries)	
	Charging Voltage	273 VDC ±1% (Based on 20pcs batteries)	
<b>INDICATORS</b>			
LCD	Load level, Battery level, AC mode, Battery mode, Bypass mode, and Fault indicators		
<b>ALARM</b>			
Battery Mode	Sounding every 4 seconds		
Low Battery	Sounding every second		
Overload	Sounding twice every second		
Fault	Continuously sounding		
<b>PHYSICAL</b>			
Standard Model	Dimension, DxWxH (mm)	369 x 190 x 688	442 x 190 x 688
	Net Weight (kgs)	61	66
Long-run Model **	Dimension, DxWxH (mm)	369 x 190 x 318	442 x 190 x 318
	Net Weight (kgs)	12	16
<b>ENVIRONMENT</b>			
Humidity	0-95% RH @ 0-40°C (non-condensing)	0-95% RH @ 0-40°C (non-condensing)	
Noise Level	Less than 55dB @ 1 Meter	Less than 58dB @ 1 Meter	
<b>SURGE PROTECTION AND FILTERING</b>			
Surge Energy Rating (Joules)	1080J		
<b>MANAGEMENT</b>			
Smart RS-232 / USB	Supports Windows® 2000/2003/XP/Vista/2008, Windows® 7/8/10, Linux and MAC		
Optional SNMP	Power management from SNMP manager and web browser		
<b>COMPLIANCE STANDARDS</b>			
Safety	IEC/EN 62040-1		
EMC	IEC/EN 62040-2		
Performance	IEC/EN 62040-3		

6-10KVA: Derate to 60% of capacity in Frequency converter mode and to 90% when the output voltage is adjusted to 208VAC.  
 Product specifications are subject to change without further notice.  
 20 blocks battery option is available for 6/10kVA Standard models

Ver1.0\_5.07.2022

Authorised Distributor/ Reseller:

Compatible with:



System Requirements:  
 Windows XP/Vista/7/8/10, Mac, Linux