

PEV5400G-DM | 30KW~60KW



IP54 Rated



User Friendly



Touch Screen



Commercial



Wide DC Output Voltage Range



Fast charging



High Efficiency



EU Type 2
CCS2
(IEC 62196-3)

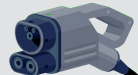

Japan
CHAdeMO
(Optional)

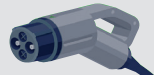

- Floor mounting type
- IP54 and IK10 rated metal enclosure; IP55 rated connector
- Supports multiple charging standards (GB, CCS2 and CHAdeMO)
- Constant output power at wide DC voltage range 300V to 1000V, faster charging efficiency
- UL approved DC power module (to sustain the dusty and salty air tests to improve environmental adaptability)
- Dedicated LED status indicator light for each charging mode
- Multilingual support for 7" coloured touch screen LCD
- Maximum efficiency up to 93%

- THDi < 5% at full load
- Built-in RFID card reader
- Supports OCPP 1.6 JSON network and 3G/4G
- Adapting OCPP network security protocol to implement the OTA feature
- Cloud network protocol verified by OCTT
- Vehicle end protocol DIN 70121, ISO15118 verified by TUV
- Linux 5.10 OS and CPU conformed with cybersecurity standards
- Singapore TR25:2022 charging standard compliance
- SGS certified and CE certification with ILAC-MRA endorsement
- Passed rigorous environmental and thermal shock tests from -35°C to 55°C to ensure the system reliability

OVERVIEW

Operating light

Charging status

Charging controller

7-inch colour touch screen Built-in RFID card reader Equipped with Wifi, 4G OCPP

Low noise

Standby low energy consumption (patent)



Charger nozzle

GB, CCS1, CCS2, CHAdeMO

EPO

Charging module

DC300-1000V

Charging module

DC300-1000V

Product Selection Guide

Model	Power module #	DC charger nozzle #	AC charger nozzle #	Dimension
PEV5430G-DM	1	up to 2	N/A	235.5 x 660 x 1250
PEV5460G-DM	2	up to 2	N/A	

Specifications

MODEL		PEV5430G-DM	PEV5460G-DM
Charging Type		DC fast charging	
Outlet Options		CCS2 (Default), CHAdEMO (Optional), GB/T (Optional)	
AC Input Power @ 400V 50Hz		48 A, 33 kVA	93 A, 64 kVA
Input Voltage Range		380/400/415 VAC	
Input Frequency		50 Hz or 60 Hz	
DC Output Power Rating		30 kW	60 kW
DC Output Voltage		200-1000 Vdc (Constant power from 300-1000Vdc)	
Number of EV Served		1	Up to 2
Cable Length		5.0 m, Optional: 6.0 m / 7.0 m	
Maximum Current	CCS Cables	100A	200 A
	CHAdEMO Cables	100A	125 A
	GBT Cables	100A	200 A
Electro-Magnetic Compatibility		Class A (optional Class B) according to EN 61000-6-3:2007	
Distribution Systems		TN-S, TN-C, TN-C-S, TT (required external RCD)	
Connector Type		3P + N + PE	
Protection		Overcurrent, overvoltage, undervoltage, integrated surge protection, ground fault including DC leakage protection, door opening protection	
Overvoltage Category		Type II	
Power Factor (Full Load)		≥ 0.98	≥ 0.99
THDi		≤ 5%	
Efficiency		≥ 93% (peak)	
Standby Power		< 35 W	
Short Circuit Current		10 kA	
Pre-charge Current		< 1 A	
Inrush Current		< 55 A	< 100 A
Leakage Current		0.8 mA	
Energy Metering		Standard: Meter for DC outlet, Optional: AC inlet	
Cellular Communication		GSM / 4G/ LTE (Optional)	
USER INTERFACE			
Connectivity		Internet access via 4G/3G/Ethernet (RJ45)	
User Authentication		RFID, QR code	
User Interface		7" LCD high-contrast touchscreen	
Communication Protocols		Proprietary and OCPP 1.6j	
RFID Reader		ISO/IEC 14443 A/B Mifare RFID reader	
Emergency Button		Yes	
CONFIGURATION			
Software Upgrade		Over-The-Air (OTA)	
Language System		English, Chinese, French, Spanish	
GENERAL CHARACTERISTICS			
Protection Rating		IP54 and IK10 (enclosure) / IK8 (touchscreen) / IP55 (connector)	
Housing Material		SGCC, SUS430 (Optional)	
Operating Altitude		Up to 2000 m	
Operating Temperature		-35 °C to 55 °C	
Storage Temperature		-40 °C to 70 °C	
Humidity		20-95 % Rh non-condensing	
Mounting		Free-standing cabinet	
Dimensions (D x W x H) mm		235.5 × 660 × 1250	
Net Weight (kgs)		80	105
COMPLIANCE STANDARDS			
Codes & Standards		TR25:2022 (Charger: IEC 61851-1, IEC 61851-21-2; IEC 61851-23, IEC 61851-24, Connector: IEC 62196-1, IEC 62196-3) IEC 61000, GBT18487, GBT20234, NB/T 33008.1, NB/T 33001	
Communication to the EV		DIN 70121, ISO/IEC 15118, CHAdEMO 1.2, GBT27930, GBT 34657, GBT 34658	

Product specifications are subject to change without further notice