

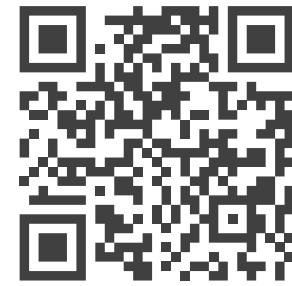

USER MANUAL

Model : Yesper Fast II



yes-per.com

FR DE RU 日本語

Für die deutsche Beschreibung, können Sie von der Handbuchseite unserer Website herunterladen: yes-per.com/user-guide

Пожалуйста, перейдите на страницу руководства на нашем официальном сайте, чтобы загрузить русскоязычную версию руководства: yes-per.com/user-guide

Pour la version française du manuel d'utilisation, veuillez le télécharger à partir de la page du manuel d'utilisation de notre Site Officiel : yes-per.com/user-guide

日本語取扱説明書については、公式サイト取扱説明書ページからダウンロードしてください: yes-per.com/user-guide

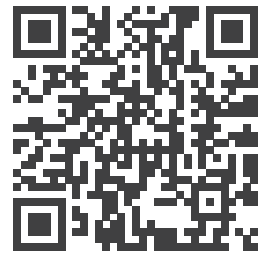

FR DE RU 日本語

USER MANUAL

Thank you for choosing the Yesper Fast II! Always follow basic safety precautions when using electrical appliances. Read all instructions carefully. Please keep this instruction manual for easy reference.

A. PRODUCT LAYOUT:

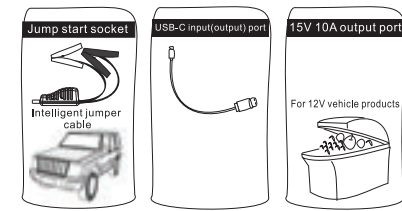
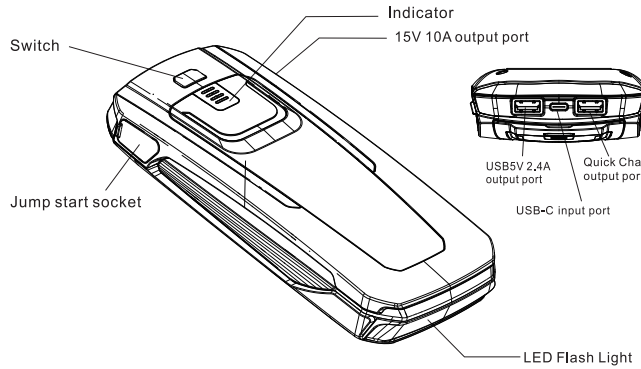

B. OPERATION GUIDANCE

Indicator

Press the switch to check the storage level of FAST II.

Indicator	Unit	1 solid	2 solid	3 solid	4 solid
Storage level	0%	25%	50%	75%	100%

The indicator will flash one by one during the period of charging. Different number of solid indicators show different storage level of Yesper Fast II. All indicators light off when the charging is paused or completed.

FAST II Charging Instruction :

1. Plug a home adaptor into the universal socket.
2. Connect USB-C input port of Yesper Fast II to the other

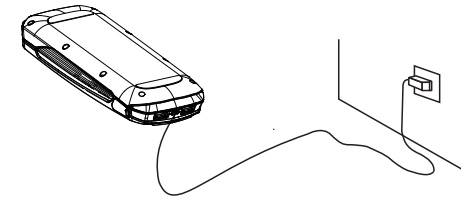

Jump Start 12V Vehicle Instruction:

1. Connect the blue plug fully seated into the host, and make sure the Cable Indicator is off.
2. Connect Red Clamp to the positive (+) battery terminal, Black Clamp to the negative (-) battery terminal.
3. Operate following the instruction of the Cable Indicator:

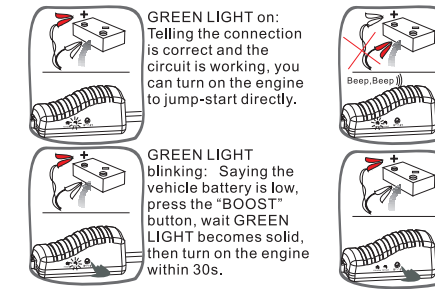
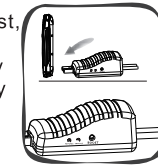

4. Start the vehicle.
5. When the vehicle is started, remove the jumper cable from the vehicle battery. Leave the vehicle's engine running.

Charging Cell Phone or Tablet Instruction:

1. Plug the switch cable to Quick Charge output port.
2. Select appropriate connector and connect it to your mobile phones or tablet.
3. Press the switch button to charge.
4. If doesn't work, please try another USB Output port.

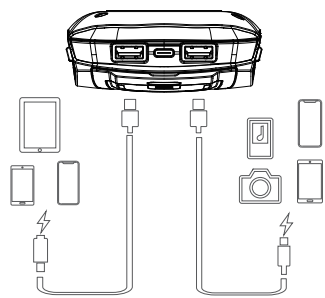

- For Power Supply to Vehicle Products or Electronics
1. Plug the optional switch cable to 15V 10A output port.
 2. Connect the optional switch cable and vehicle product or electronics.
 3. Press the switch button to power supply.

LED Flash Light
Press the switch 3 seconds to start the LED flash light. There are 4 modes of LED light appear in order (normal, strobe, SOS, off) if you press slightly.

C. PARTS LIST:

#	Parts Name	Quantity	#	Parts Name	Quantity
1	Host	1	4	Intelligent jumper cable	1
2	USB to USB-C cable	1	5	User Manual	1
3	Cigarette lighter socket adapter	1			

D. TECHNICAL SPECIFICATIONS:

Model: Fast II
Size: 223*93*38mm
Weight: 630g
Battery Capacity: 18000mAh(66.6Wh)
Output: Quick Charge(5V/2.4A, 9V/2A, 12V/1.5A); 15V/10A
Input: USB-C(5V/3A)
Full charging time: 4 hours
Peak current: 2160A
Operating temperature: -20°C ~ 60°C

E. FAQ:

Q. How to turn off this appliance?
A. This appliance will power off automatically when no load or charging is complete

Q. How long time to full charge the Yesper Fast II?
A. 4 hours through the USB-C for Fast II.

Q. How many times can this appliance charge for my cell phone?
A. Depend on the battery capacity of your cell phone. Please go to our official website yes-per.com to view the most detailed information.

Q. What's the lifetime of Fast II?
A. Usually 3-5 years in normal condition.

Q. How long does the battery last still can jump start the car after fully charged?
A. 6-12 months, however, we suggest to recharge it every 3 months.

F. TOXIC AND HARMFUL SUBSTANCES:

Composition and amount of toxic and harmful substances in Fast II.					
Pb	Hg	Cd	Cr(VI)	PBB	PBDE
○	○	○	○	○	○

○: Indicate all homogeneous materials' hazardous substances content are below the MCV limit specified in the Standard 2002/95/EC(RoHS).

G. TROUBLE SHOOTING:

TROUBLE	REASON	REMEDIES
It has charged for a long time, but the fourth battery indicator is still blinking.	Battery power recognition problem.	Disconnect the charging cable and plug it in again, try to continue charging for hours.
No response when pressing the power switch.	Low voltage protection is started.	Try to charge the unit with wall charger to activate it.
This unit can not be charged, the first battery indicator blinks all the time.	The unit is over discharged or defective	Please contact us: cs@yes-per.com
This unit is over heated or swelled.	The unit is over discharged or defective.	Please contact us: cs@yes-per.com

If there is any other problem with this unit, please contact us directly at cs@yes-per.com, we will do our best to solve the problem within 24 hours.

H. WARNING:

1. Read the instruction manual carefully before using this unit.
2. Jump for 12V vehicles. It would be hazard if for other jumping.
3. DO NOT use this unit if any cable clamp or cord is damaged.
4. DO NOT use in place of a vehicle battery.
5. Never remain the unit on car battery after cranking the car success.
6. Make sure to check all the battery connections are CLEAN before Jump Starting! Make sure the battery clamps are well connected! If the battery terminals on the vehicle are dirty or corroded, the power of the unit will be lessened.
7. Do NOT Jump Start more than 3 times in a row. It could damage the unit by overheating. When starting up multiple times, each start-up interval is two minutes.
8. Remove the product from the vehicle battery within 30 seconds of Jump Starting. If not, it could lead to damage.
9. Do NOT connect the two clamps together.
10. Do NOT use by young or infirm persons without supervision.
11. Do NOT use as a toy.
12. Do NOT allow the product to become wet.
13. Do NOT immerse the product in water.
14. Do NOT operate the product in explosive atmospheres, such as in the presence of flammable liquids, gases or dust.
15. Do NOT modify or disassemble Yesper Fast II. Only a repair technician may repair this unit.
16. Do NOT expose product to extreme heat or fire.
17. Make sure someone should be within range of your voice or close enough to come to your aid when working with batteries.
18. Remove personal metal items like rings, bracelets, necklaces, etc. When using the products.
19. Do NOT drop unit. If unit receives a sharp blow or is otherwise damaged in any way have it checked by a qualified battery technician.
20. Do NOT store in locations where the temperature may exceed 60°C
21. Charge only at ambient temperature between 0°C and 45°C.
22. Charge only using the charger provided with this unit or the same standard with the host input port.

23. Do NOT use the unit to jump start a vehicle while charging the internal battery.
24. If this unit is leaking liquid dispose of at proper recycle facility immediately.
25. Under extreme conditions, battery leakage can occur. If a liquid is noticed coming from product do not handle with bare hands. In case of skin contact wash with soap and water immediately. If liquid comes in contact with eyes rinse eyes with cold running water for at least 10 minutes and get medical attention immediately.
26. Product contains lithium based battery, at end of product life dispose of product according to local regulation.
27. After jump start the car, don't charge this unit immediately.
28. Don't use the jumper cable to charge other equipment.

I. WARRANTY INFORMATION:

1. We offer a limited warranty for this product against any defects in material and workmanship for a period of 6 months from the date of purchase by the end user/consumer. The conditions of the warranty are as follows:
2. The warranty is only valid upon presentation of the original receipt (from dealer/retailer) by the original purchaser with the product to be repaired or replaced.
3. The warranty is void if the serial number, date of purchase and label has been removed.
4. The warranty does not cover damage or product failure resulting from normal wear and tear, physical abuse, improper installation, misuse, modification or repairs by unauthorized third parties.
5. We do not assume responsibility for any loss or damage incurred during shipment or as a result of a force majeure.
6. We are not liable for any incidental or consequential damages arising from the use or misuse of this product.
7. All warranty claims are limited to repair or replacement of the defective product and at the sole discretion of us.
8. If we repair or replace the product, the product will be covered for the remaining time of the original warranty period. Repair or replacement may involve the use of reconditioned units which are equivalent in function. Replaced part or product becomes the property of us.
9. Consumable components such as batteries are not covered by the warranty.

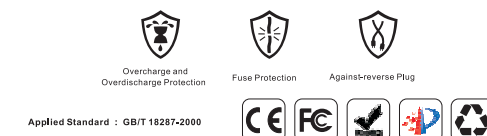

J. WARRANTY INFORMATION:

•12+6 Months Online After- Sales Service

Within 12 months, we will provide timely and effective online after- sales service after your purchase. If you register on our official store: yes-per.com and become our member customer, you will get extra 6 months service, total 18 months.



Scan to be our member for extending more 6 months warranty

•30 Days Money Back Guarantee

Within the first 30 days after your purchase, you can apply return for it through YOUR SELLER when you have any issue.

•30 Days to 12 Months (18 Months for Member Customers)

We will replace the defective unit due to manufacturing issues with a new one within 12 months; if you are our member customer, within 18 months.



Do Not Submerge In Water

Do Not Disassemble

Do Not Drop

Avoid Extreme Temperatures

Do Not Place Near or Into Fire



Overcharge/discharge Protection



Fuse Protection



Against-reverse Plug

Customer Service

12+6 Months Limited Warranty Service

Lifetime Technical Service

Feel Free to Contact Us
cs@yes-per.com

For FAQ and More Information
yes-per.com



Thank You for Choosing



Made in China

128g铜版 双面单黑印刷 风琴折

93*130mm