

STEP
2

SUCTION CUP KIT ASSEMBLY

Single, 3-Balloon & Expansion Kit



Please inflate all balloons within 30 days of purchase to comply with Warranty Guidelines.

WHAT YOU'LL NEED

1-BALLOON KIT

See Step ①

Inflated Balloon,
Cup & Stem Assembly
(1 Total)



1



3-BALLOON KIT

See Step ①

Inflated Balloon,
Cup & Stem Assembly
(X3 Total)



OR

2 1 3



IMPORTANT Complete step ① on separate card before beginning the hardware assembly steps below.

*Single Suction Cup Kit pictured

2.1

With the lever in the upward, unlocked position, place the suction cup on clean glass or smooth, non-porous surface. Push suction cup inward towards glass and press lever down to lock the suction cup into place.

TIPS: Make sure balloons won't hit structure above if applicable. Spray water on surface for increased initial suction.

A.

Push suction cup inward towards glass/smooth, non-porous surface

B.

Press lever down to lock into place

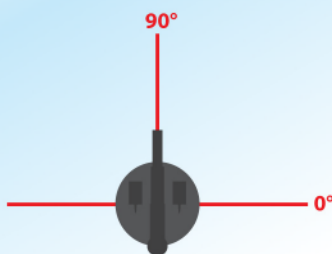
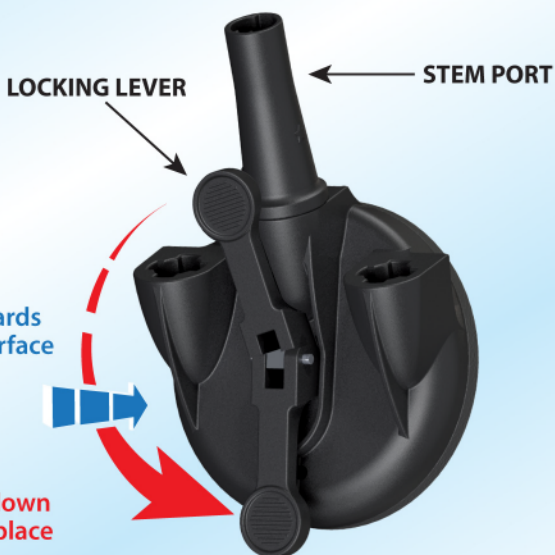

NOTE: For best results, set the suction cup at 90° so the ports point straight up. This will prevent balloons from leaning left or right.

2.2

With the suction cup properly secured to the window and ports pointed straight up, insert the push-button stem into the port the with button facing toward the hole in the port which is located on the side facing the surface.

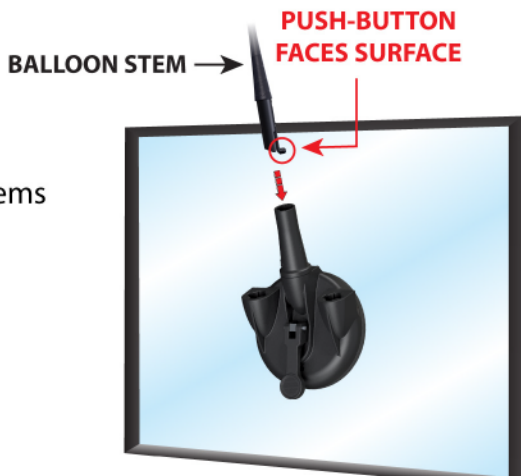

NOTE: Add remaining stems for 3-Balloon Kit.

SUCTION CUP EXPANSION KIT

See Step ① for Balloon Inflation, Cup & Stem Assembly



To add the two stem port inserts to the suction cup, place each insert into its space with the hole for the push-button facing the same direction as the existing port. Push in by hand and securely lock it in by hitting it with a rubber mallet until it is fully seated in the suction cup.

EXPANSION KIT
STEM PORTS



PLACE IN SUCTION CUP WITH
PUSH-BUTTON HOLE FACING
THE SAME DIRECTION AS
EXISTING STEM PORT