

STEPS
1 & 2

MegaBalloon Pole Assembly

Push-Button Kit



Please inflate all balloons within 30 days of purchase to comply with Warranty Guidelines.

WHAT YOU'LL NEED

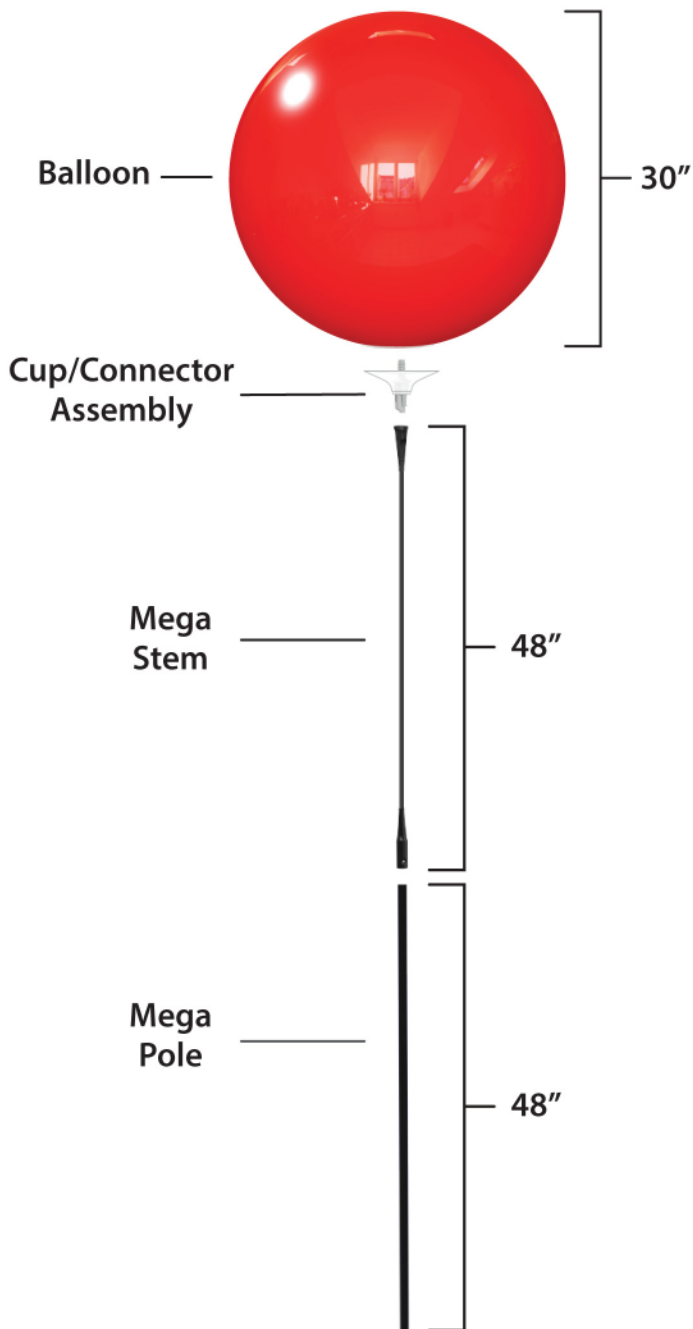

1.1

- A** Snap the Mega Stem onto the Cup/Connector Assembly.
- B** Screw the Stem & Assembly into the deflated 30" Balloon until completely seated in the base of the Upper Cup.

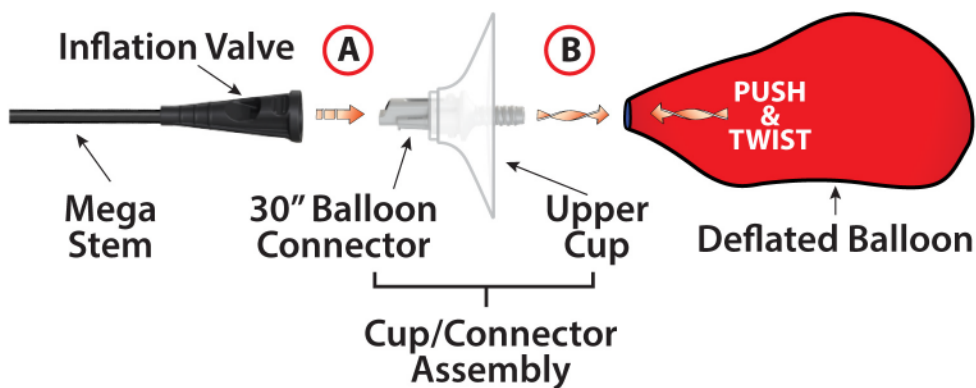

1.2

Inflate the balloon using a needle style inflation tip to a maximum of 30" to avoid bursting the balloon.

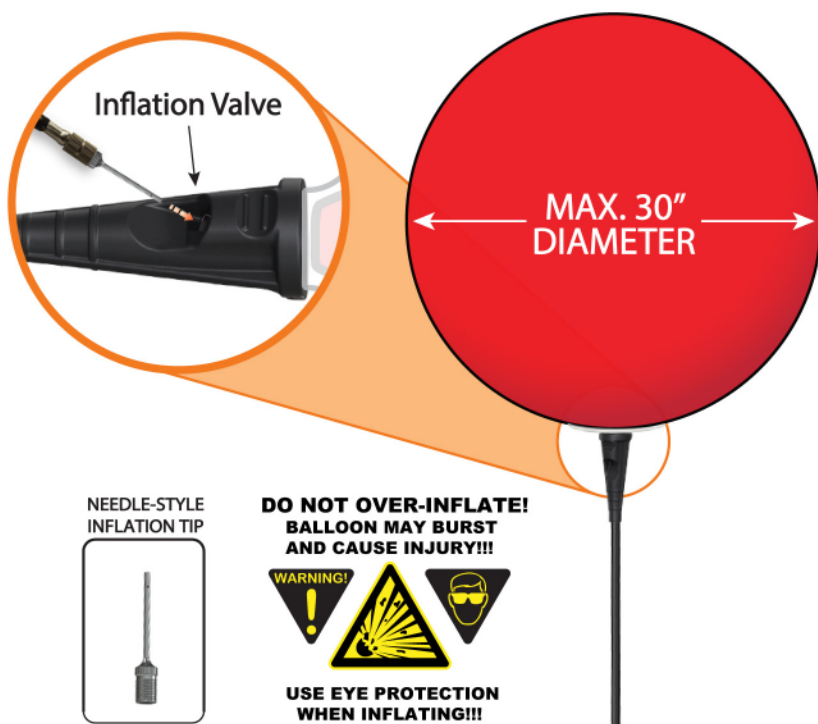

2.1

Slide the end of the pole with the snap button directly into the receiving end of the stem, locking the snap-button into place.



2.2

Assemble your chosen mounting option shown below using Step 3 to complete your MegaBalloon Pole Kit.

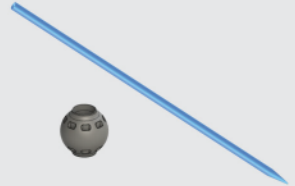
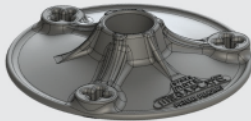

**STAKEMATE
MEGAPLATE**



or



**BAND CLAMP or SCREW
POLE BRACKETS**



WEIGHTED BASE