

User Guide

DEPOSITORY SAFE with Digital Lock

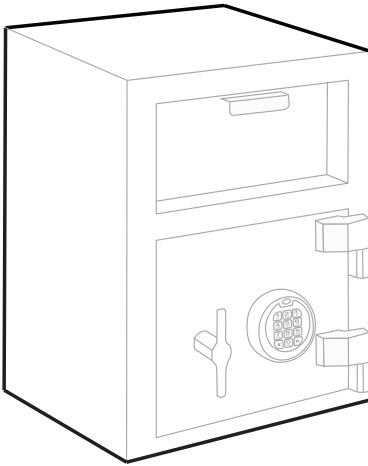

Model 5912

Package Includes:

- 1 – Depository Safe
- 1 – Operation Manual
- 2 – Override Access Keys
- 1 – Floor Mat
- 1 – Mounting Kit w/ Bolts



Safe with Digital Lock

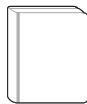

Operation
Manual

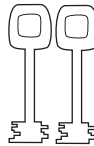

Override
Access Keys

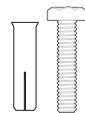

Mounting
Kit w/ Bolts

Please carefully check the above list to confirm all items have been received. If any items are missing, please contact Consumer Assistance. (See page 9 for contact information.)

Read this manual carefully and never store it inside the safe!

INDEX

WELCOME / DO NOT RETURN SAFE TO STORE / PRODUCT REGISTRATION.....	PAGE 2
INSTALL BATTERY / UNLOCK & OPEN YOUR NEW SAFE	PAGE 3
PRIMARY & SECONDARY USER CODES	PAGE 4
OVERRIDE ACCESS KEY / USING THE DROP DOOR.....	PAGE 6
ANCHORING YOUR SAFE.....	PAGE 7
SECURE LOCKOUT PERIOD / LOST OR FORGOTTEN USER CODES / CARE AND MAINTENANCE / NOTES.....	PAGE 8
CONSUMER ASSISTANCE.....	PAGE 9
ORDERING ADDITIONAL OVERRIDE ACCESS KEYS / SAFE IDENTIFICATION RECORD / DIGITAL USER CODE RECORD	PAGE 10
LIMITED WARRANTY	BACK COVER

For Your Protection

- Do not remove the Serial Number tag from the safe.
- Never Store Override Access Keys inside safe.
- Record all Safe Identification Numbers on Safe Identification Record (page 10).
- Save this manual and NEVER keep it inside the safe.

WELCOME

Your Honeywell Steel Depository Safe will provide years of safe and secure protection for your currency and check deposits, important documents and other personal items. All Honeywell safes are designed and built using the highest manufacturing standards to ensure maximum user satisfaction under a variety of conditions. With proper care, your Honeywell safe will provide peace of mind for many years to come.

Thank you and enjoy!

DO NOT RETURN SAFE TO STORE

If you are missing parts or have difficulty operating your safe, please contact our Consumer Assistance Department by telephone. Stores will not accept returned products without prior authorization. You must first contact our Consumer Assistance Department (See page 9 for contact information).

PRODUCT REGISTRATION

Please go to the following webpage to register your product:
www.hymaninc.com/product-registration/

INSTALL BATTERY

The battery must be installed before using your safe. The battery compartment is located at the bottom of the digital keypad.

1. Open the battery cover under the keypad housing. (Figure 1)
2. Pull out the battery connection wire and attach the 9 volt battery (not included). (Figure 2)
3. Insert the connected 9 volt battery into the housing and close the battery cover. (Figure 3)



Figure 1

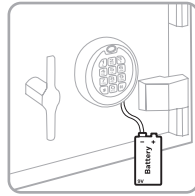

Figure 2

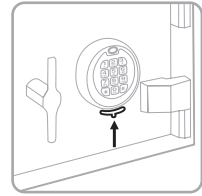

Figure 3

Note: If the red LED is on, it is an indicator that the batteries are weak and must be changed immediately. The user codes will not be erased if the battery is weak or removed. To replace the battery please follow STEPS 1 - 3.

If your battery is completely dead and you cannot open the safe by using the digital keypad, use the override access key to open safe. The use of non-alkaline or rechargeable batteries is NOT RECOMMENDED.

UNLOCK & OPEN YOUR NEW SAFE

1. To open the safe, turn handle counterclockwise (to the left) until it stops. The handle should be in the vertical position. Always do this before entering the code. (Figure 1)
2. Enter the preset factory code "168" followed by the # key.
3. If the code is entered correctly, the keypad will beep twice, a green LED will light up, and you will hear a click, indicating that the door is now unlocked. Turn handle clockwise (to the right) to open. (Figure 2 & 3)

Note: You will have approximately 5 seconds to open the safe before it re-locks, at which point you will need to reenter the code to open the safe. If the code is entered incorrectly, the safe will begin beeping and the yellow LED light will flash continuously. Repeat Step 2.

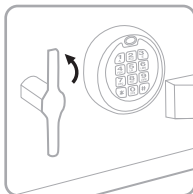

Figure 1

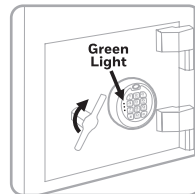

Figure 2

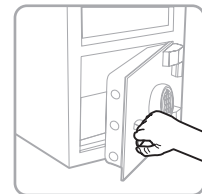

Figure 3

PRIMARY & SECONDARY USER CODES

Your new safe is equipped with a digital lock that can be operated with up to two different user codes.

· Primary Code: This code is for the primary operators of the safe.

· Secondary Code: This code can be provided to someone with limited or one-time access to the safe.

Codes can contain 1-8 digits, however, we recommend a minimum of 3 digits. An 8-digit code will provide maximum security for your safe.

The Primary User Code must be programmed first. Once that code is tested and operating successfully program the Secondary User Code.

PRIMARY USER CODE: PROGRAMMING & TESTING

Follow the steps on page 3 under UNLOCK & OPEN YOUR NEW SAFE.

1. With the safe unlocked and door open, locate and press the red RESET button on the inside edge of the safe door. (Figure 1) You will hear two beeps and a Yellow LED light will turn on. (Figure 2)
2. Enter a new 1-8 digit Primary User Code of your choice, followed by the * key. (Figure 3) Your Primary User Code is now set. Close the safe door and test the code to make sure it is working properly before programming the Secondary User Code.
3. Make sure handle is turned all the way to the left. It should be in the vertical position. (Figure 4)
4. Enter your Primary User Code followed by the # key.

· If the code is entered correctly, the keypad will beep twice, the green LED light will turn on and you will hear a click, indicating that the safe is now unlocked. Turn the handle clockwise (to the right) to open. (Figure 5 & 6)

Note: You will have approximately 5 seconds to open the safe before it re-locks, at which point you will need to reenter the code to open the safe.

· If the code is entered incorrectly, the safe will begin beeping and the yellow LED light will flash continuously. Repeat Step 4.

If you continue to have trouble opening the safe, use the override keys to unlock the safe and reset the Primary User Code beginning with Step 1.

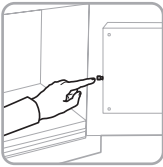

Figure 1

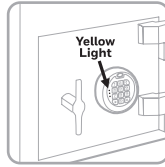

Figure 2



Figure 3

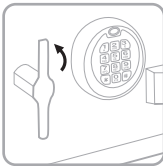

Figure 4

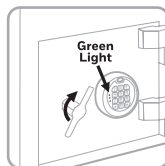

Figure 5

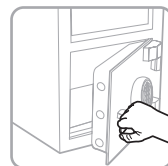

Figure 6

SECONDARY USER CODE: PROGRAMMING & TESTING

1. With the safe in the closed and locked position, turn the handle all the way to the left. It should be in the vertical position. Enter the preset factory code for the Secondary User "12345678" followed by the # key. (Figure 1) Turn the handle clockwise (to the right) to unlock and and open the safe.
2. With the safe door open, press the "0" key twice.
3. Locate and press the red RESET button on the inside edge of the safe door. (Figure 2) You will hear two beeps and a Yellow LED light will turn on. (Figure 3)
4. Enter a new 1-8 digit Secondary User Code of your choice, followed by the * key. Your Secondary User Code is now set. Close the safe door and test the code to make sure it is working properly.
5. Make sure the handle is turned all the way to the left. It should be in the vertical position. (Figure 4)
6. Enter your Secondary User Code followed by the # key.
 - If the code is entered correctly, the keypad will beep twice, the green LED light will turn on and you will hear a click, indicating that the safe is now unlocked. Turn the handle clockwise (to the right) to open. (Figure 5 & 6)

Note: You will have approximately 5 seconds to open the safe before it re-locks, at which point you will need to reenter the code to open the safe.

· If the code is entered incorrectly, the safe will begin beeping and the yellow LED light will flash continuously. Repeat Step 6.

If you continue to have trouble opening the safe, use the override keys to unlock the safe and reset the Secondary User Code beginning with Step 2.

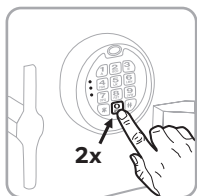

Figure 1

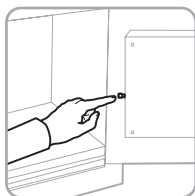

Figure 2

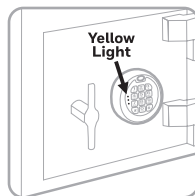

Figure 3

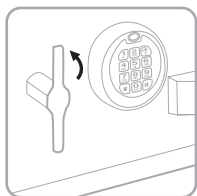

Figure 4

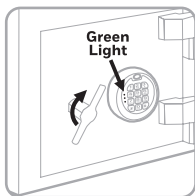

Figure 5

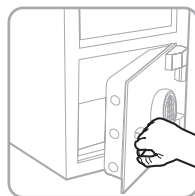

Figure 6

VERRIDE ACCESS KEY

Your safe includes 2 override access keys which allow immediate access to your safe, in the event you forget your user codes or the battery needs to be replaced.

1. Remove the sticker from the front of the keypad to access the faceplate mounting screw. Remove the screw using a Phillips head screwdriver. (Figure 1)
2. Pull the keypad away from the housing and insert the override access key as shown. (Figure 2) Turn counterclockwise. (to the left)
3. Turn handle clockwise (to the right) and pull safe door open. (Figure 3)
4. Turn override access key clockwise to the right and remove. Replace the keypad over the housing bottom first then push forward into place, secure with screw and replace sticker. (Figure 4)

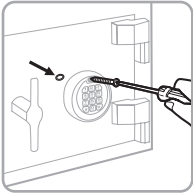

Figure 1

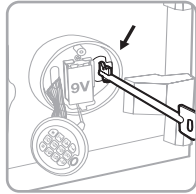

Figure 2

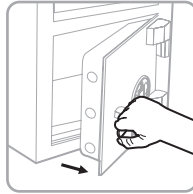

Figure 3

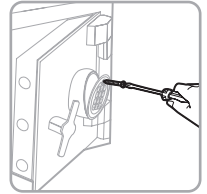

Figure 4

5. Store the override access key in a safe place away from the safe.

USING THE DROP DOOR

Depository safes are designed with drop doors for quick deposits of cash, checks, documents and other valuables without having to unlock the safe. To use the drop door follow the steps below.

1. Locate and pull down on the door handle. (Figure 1 and Figure 2)
2. Once open, drop the item you would like to deposit onto the drawer. (Figure 3)
3. Lift the door upward to the closed position and the contents will drop down to the lower section of the safe. (Figure 4)

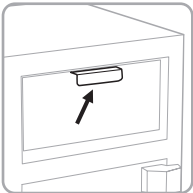

Figure 1

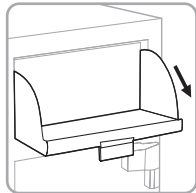

Figure 2

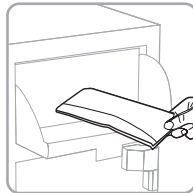

Figure 3

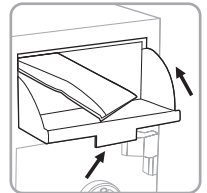

Figure 4

Note: If using the depository safe for items other than cash / checks, it is recommended that fragile or heavy items not be deposited as they may be damaged or cause damage. These items should be placed in safe through the lower safe door.

ANCHORING YOUR SAFE

For additional security, you have the option of bolting your safe to the floor. Pre-drilled anchoring holes and the included hardware kit allow you to secure your safe to concrete or wood surfaces. For metal surfaces, additional hardware will be needed. Contact your local home center for assistance.

To secure your safe:

1. Find a suitable and convenient location for your safe.
2. Empty the safe and remove the floor mat.
3. Locate the pre-drilled holes on the inside floor of the safe.
4. With the safe in your desired location, use a pencil or other tool to mark the floor through the pre-drilled holes. Move the safe aside.

Note: Only 2 of the 4 pre-drilled holes are needed for mounting purposes. Choose two that are positioned diagonally from each other. (Figure 1)

5. Drilling

For concrete surfaces:

Using a 1/2 in (12mm) drill bit, drill a hole at each of the 2 marks you made previously, approximately 3 inches in depth. Remove any excess dust. (Figure 2)

Place the 2 anchors into the drilled holes and tap gently with a hammer until the anchors are flush with the floor. (Figure 3)

For wood surfaces:

Using an 11/32 in (10mm) drill bit, drill 2 pilot holes at each of the 2 marks you made previously. Remove any excess dust. (Figure 2)

The anchors are **not** needed for wood floors.

6. Place the safe back over the holes and secure in place using the 2 lag screws provided; tighten with a 1/2 inch socket wrench. (Figure 4)
7. Once completed, replace the floor mat and close the safe door. Rotate handle counterclockwise (to the left) to secure the lock.

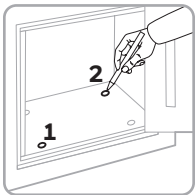

Figure 1

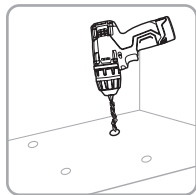

Figure 2

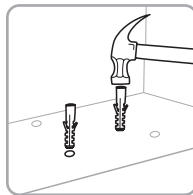

Figure 3
Only for Concrete
Mounting

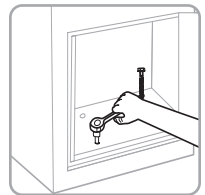

Figure 4

Note: Bolting/unbolting of the unit is at the consumer's expense and discretion. LH Licensed Products is not responsible for any costs incurred if the unit is damaged.

If you have any questions about mounting the safe, please check with your local home center/hardware retailer or independent contractor.

SECURE LOCKOUT PERIOD

If the wrong user code is entered into the keypad 3 times in a row, the keypad will automatically go into lockout mode and you will not be able to open the safe using the digital keypad for 15 minutes. During the lockout period you can access the safe using the override access keys.

LOST OR FORGOTTEN USER CODES

LOSS OF BOTH PRIMARY AND SECONDARY USER CODES

It is recommended that you record your new user codes in the “Digital User Code Record” section on page 10 and keep this manual in a secure location away from the safe. However, if you lose or forget either the primary or secondary user codes, you may open the safe using the override access keys. Follow the instructions on pages 4 & 5 to reset the codes.

CARE AND MAINTENANCE

When properly maintained, your safe will continue to operate for many years. In order to ensure optimal performance of your safe, please follow these simple precautions:

CLEAN HANDS - Never attempt to operate the digital keypad if your hands have excessive dirt, debris or liquids on them.

CLEAN SAFE – To clean the surface of your safe, it is recommended that you use a mild cleaner (e.g., window cleaner) to avoid scratching or discoloring the surface. Always wipe dry and NEVER use abrasive cleansers on the safe or digital keypad.

For future reference, store this Operation and Installation Guide in a secure area away from the safe.

NOTES

CONSUMER ASSISTANCE

WEBSITE:

www.honeywellsafes.com

www.taruna-jaya.com

ADDRESS:

Consumer Assistance Dept.

LH Licensed Products, Inc.

860 East Sandhill Avenue Carson, CA 90746 USA

E-MAIL:

support@taruna-jaya.com

TELEPHONE:

US/Canada 1-877-354-5457 (Toll Free)

Indonesia 62-21-6410845, 64701938

Mexico 01-800-288-2872 After English voice recording stops you must then enter 800-860-1677 to complete your call. (Toll Free)

Australia 0011-800-5325-7000 (Toll Free)

Germany/New Zealand 00-800-5325-7000 (Toll Free)

Other Countries XX*-310-323-5722 (Toll Charges Apply)

XX*- Dial U.S. Country Code first

CALL CENTER HOURS:

US/Canada 7am – 5pm (PST**) Mon – Fri (Subject to change)

CALL BACK HOURS:

Other Countries 7am – 8pm (PST**) Mon – Fri (Subject to change)

PST**- Local time in Los Angeles, CA, USA

INTERNATIONAL CALL BACK HOURS:

If you need to speak with a consumer assistant and cannot contact us during the Call Center hours above, please send an email or leave a telephone message, including your Name, Telephone Number and the best time for us to contact you during the Call Back hours above, and we will make every effort to contact you and help answer any of your questions or concerns.

* Insert correct Country Code

** Local Time based on Los Angles California USA

ORDERING ADDITIONAL OVERRIDE ACCESS KEYS

The following information is required to order keys:

1. PROOF OF OWNERSHIP (1 of 2 Options Below)

A) SALES RECEIPT & IDENTIFICATION – INTERNATIONAL ORDERS ONLY!

- Copy of sales receipt showing Store, Date & Product Description.
- Copy of your picture I.D. (Drivers license, passport, regular I.D.).

B) PRODUCT OWNERSHIP VERIFICATION FORM

If sales receipt is not available, contact us by email or telephone to request a "Product Ownership Verification Form".

2. ORDER INFORMATION

CONTACT

- Name & Shipping Address
- E-mail address (If Available)
- Telephone Number
- Best Time to Contact You

PRODUCT

- Safe Model #
- Safe Serial #
- Lock Key #
- Quantity of Keys Ordered

3. PLACING AN ORDER

- To begin the order process, contact us by telephone, email, or mail

4. METHOD OF PAYMENT

- Visa, MasterCard, Check or Money Order

NOTE: For pricing please contact Consumer Assistance. Contact information is located on the back cover of this manual. Payment method and pricing subject to change.

SAFE IDENTIFICATION RECORD

Model Number 5912

Serial Number: _____

Override Access Key Number: _____

DIGITAL USER CODE RECORD

Primary User: _____

Secondary User: _____

LIMITED WARRANTY

LH Licensed Products, Inc., ("LHLP, Inc.") warrants that for a period of five (5) years from the date of purchase, this product will be free from structural or mechanical defects resulting from materials or workmanship. LHLP, Inc., at its sole option and as the purchaser's sole remedy under this warranty, will repair or replace this product or any component of the product found to be defective during the warranty period. Replacement or repair will be made with a new or re-manufactured product or component. If the product is no longer available, replacement may be made with a similar product of equal or greater value.

THIS IS YOUR EXCLUSIVE WARRANTY.

Our goods come with guarantees that cannot be excluded under Indonesian Consumer Law. You are entitled to a replacement or refund for a major failure and for compensation for any other reasonably foreseeable loss or damage. You are also entitled to have the goods repaired or replaced if the goods fail to be of acceptable quality and the failure does not amount to a major failure. This warranty is only valid for the original retail purchaser from the date of initial retail purchase and is not transferable. You must keep the original sales receipt. Proof of purchase is required to obtain warranty service.

LHLP, Inc. dealers, service centers, or retail stores selling this product do not have the right to alter, modify or in any way change the terms and conditions of this warranty. This warranty does not apply to the finish on the product. This warranty does not cover normal wear and tear of parts or damage resulting from any of the following: negligent use or misuse of the product, use contrary to the operating instructions, disassembly, repair or alteration by anyone other than LHLP, Inc. or an authorized service center, improper installation, or exposure to extremes of heat or humidity. Further, the warranty does not cover Acts of God, such as fire, flood, earthquakes, hurricanes and tornadoes.

LHLP, Inc. shall not be liable for any incidental or consequential damages caused by the breach of any express or implied warranty or otherwise relating to the sale of this product. LHLP, Inc. is also not responsible for: costs associated with removing or installing the product; damage or loss of the contents of the product; nor for the unauthorized removal of the contents; or damages incurred during shipment.

THE ABOVE WARRANTY IS IN LIEU OF ALL OTHER WARRANTIES, EXPRESS OR IMPLIED, INCLUDING ANY WARRANTIES OF MERCHANTABILITY OR FITNESS FOR A PARTICULAR PURPOSE, AND LHLP, INC. DISCLAIMS ANY AND ALL OTHER COVENANTS AND WARRANTIES.

Except to the extent prohibited by applicable law, any implied warranty of merchantability or fitness for a particular purpose is limited in duration to the duration of the above warranty period. Some states, provinces or jurisdictions do not allow the exclusion or limitation of incidental or consequential damages or limitations on how long an implied warranty lasts, so the above limitations or exclusion may not apply to you. This warranty gives you specific legal rights, and you may also have other rights that vary from state to state, or province to province, or jurisdiction to jurisdiction.



LHLP

Manufactured by:
LH Licensed Products, Inc.
860 East Sandhill Avenue
Carson, CA 90746

The Honeywell Trademark is used under license from Honeywell International Inc. Honeywell International Inc. makes no representations or warranties with respect to this product.