

## User Guide

# DEPOSITORY SAFE with Combination Lock

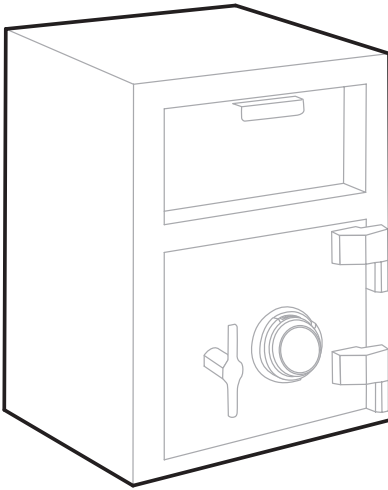

---

Model 5911

---

## Package Includes:

- 1 – Depository Safe
- 1 – Operation Manual
- 1 – Floor Mat
- 1 – Mounting Kit w/ Bolts

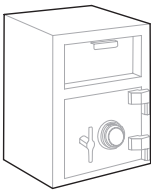

Safe with Combination Lock

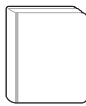

Operation  
Manual

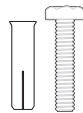

Mounting  
Kit w/ Bolts

Please carefully check the above list to confirm all items have been received. If any items are missing, please contact Consumer Assistance. (See page 6 for contact information.)

**Read this manual carefully and never store it inside the safe!**

# INDEX

WELCOME / PRODUCT REGISTRATION .....	PAGE 1
UNLOCKING AND LOCKING THE SAFE .....	PAGE 2
USING THE DROP DOOR.....	PAGE 3
ANCHORING YOUR SAFE.....	PAGE 4
CARE AND MAINTENANCE / NOTES.....	PAGE 5
CONSUMER ASSISTANCE.....	PAGE 6
RECOVERING LOST COMBINATION / SAFE IDENTIFICATION RECORD .....	PAGE 7
LIMITED WARRANTY .....	BACK COVER

## For Your Protection

- Do not remove the Serial Number tag from the safe.
- Record all Safe Identification Numbers on Safe Identification Record (page 7).
- Save this manual and NEVER keep it inside the safe.

## WELCOME

Your Honeywell Steel Depository Safe will provide years of safe and secure protection for your currency and check deposits, important documents and other personal items. All Honeywell safes are designed and built using the highest manufacturing standards to ensure maximum user satisfaction under a variety of conditions. With proper care, your Honeywell safe will provide peace of mind for many years to come.

Thank you and enjoy!

## **ATTENTION: Do not return safe to stores.**

If you are missing parts or have difficulty operating your safe, please contact our Consumer Assistance Department by telephone. Stores will not accept returned products without prior authorization. You must first contact our Consumer Assistance Department. (See page 6 for contact information.)

## PRODUCT REGISTRATION

Please go to the following webpage to register your product:  
[www.hymaninc.com/product-registration/](http://www.hymaninc.com/product-registration/)

# UNLOCKING AND LOCKING THE SAFE

Your safe comes with a preset 3-digit combination. It is printed in the manual below. Keep this manual in a safe location and never store it inside the safe.

## TO UNLOCK AND OPEN THE SAFE

1. Turn combination dial until 00 is positioned at the center index mark. (Figure 1)
2. Turn the dial to the right, passing 00 three times, and stop on the first number of your 3-digit combination. (Figure 2)
3. Turn the dial to the left, passing the first number one time, and stop on the second number of your 3-digit combination. (Figure 3)
4. Turn the dial to the right and stop at the third number of your 3-digit combination. (Figure 4)
5. Rotate the handle to the right and pull the door open. (Figure 5)

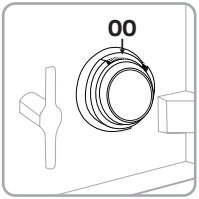

Figure 1

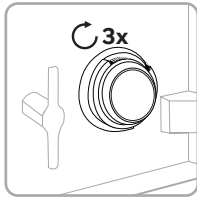

Figure 2

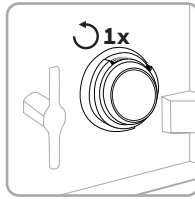

Figure 3

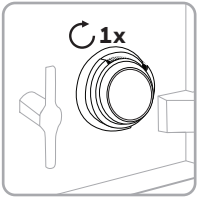

Figure 4

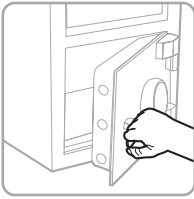

Figure 5

Combination

\_\_\_\_\_

## TO CLOSE AND LOCK THE SAFE

1. Close the door and rotate the handle to the left to secure it in the closed position. (Figure 1)
2. Turn the dial to the right at least four times to lock and secure your safe. (Figure 2)

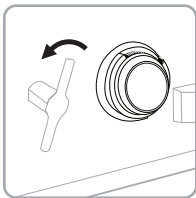

Figure 1

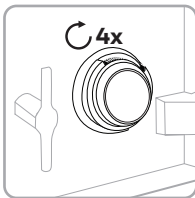

Figure 2

# USING THE DROP DOOR

Depository safes are designed with drop doors for quick deposits of cash, checks, documents and other valuables without having to unlock the safe. To use the drop door, follow the steps below.

1. Locate and pull down on the drop door handle. (Figures 1&2)
2. Once open, place the item you would like to deposit inside. (Figure 3)
3. Lift the drop door upward to the closed position and the contents will drop down to the lower section of the safe. (Figure 4)

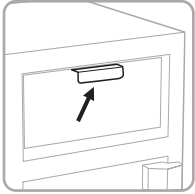

Figure 1

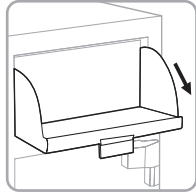

Figure 2

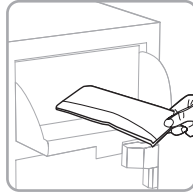

Figure 3

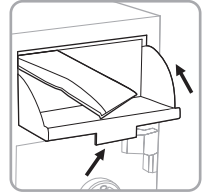

Figure 4

**Note:** If using the depository safe for items other than cash / checks, it is recommended that fragile or heavy items not be deposited as illustrated above to prevent damage. These items should be placed in the safe using the lower safe door.

# ANCHORING YOUR SAFE

For additional security, you have the option of bolting your safe to the floor. Pre-drilled anchoring holes and the included hardware kit allow you to secure your safe to concrete or wood surfaces. For metal surfaces, additional hardware will be needed. Contact your local home center for assistance.

## To secure your safe:

1. Find a suitable and convenient location for your safe.
2. Empty the safe and remove the floor mat.
3. Locate the pre-drilled holes on the inside floor of the safe.
4. With the safe in your desired location, use a pencil or other tool to mark the floor through the pre-drilled holes. Move the safe aside.

**Note:** Only 2 of the 4 pre-drilled holes are needed for mounting purposes. Choose two that are positioned diagonally from each other. (Figure 1)

## 5. Drilling

For concrete surfaces:

Using a 1/2 in (12mm) drill bit, drill a hole at each of the 2 marks you made previously, approximately 3 inches in depth. Remove any excess dust. (Figure 2)

Place the 2 anchors into the drilled holes and tap gently with a hammer until the anchors are flush with the floor. (Figure 3)

For wood surfaces:

Using an 11/32 in (10mm) drill bit, drill 2 pilot holes at each of the 2 marks you made previously. Remove any excess dust. (Figure 2)

The anchors are **not** needed for wood floors.

6. Place the safe back over the holes and secure in place using the 2 lag screws provided; tighten with a 1/2 inch socket wrench. (Figure 4)
7. Once completed, replace the floor mat and close the safe door. Rotate handle counterclockwise (to the left), then turn dial at least 4 times to secure the lock.

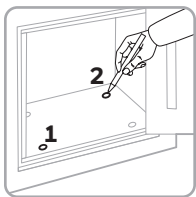

Figure 1

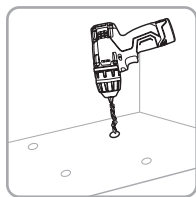

Figure 2

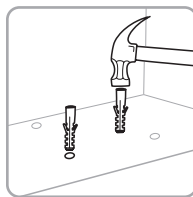

Figure 3  
Only for Concrete  
Mounting

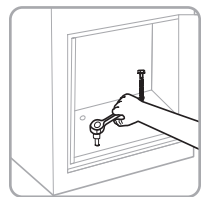

Figure 4

**Note:** Bolting/unbolting of the unit is at the consumer's expense and discretion. LH Licensed Products is not responsible for any costs incurred if the unit is damaged.

If you have any questions about mounting the safe, please check with your local home center/hardware retailer or independent contractor.

## CARE AND MAINTENANCE

When properly maintained, your safe will continue to operate for many years. In order to ensure optimal performance of your safe, please follow these simple precautions:

**CLEAN HANDS** - Never attempt to operate the digital keypad if your hands have excessive dirt, debris or liquids on them.

**CLEAN SAFE** - To clean the surface of your safe, it is recommended that you use a mild cleaner (e.g., window cleaner) to avoid scratching or discoloring the surface. Always wipe dry and NEVER use abrasive cleansers on the safe or digital keypad.

For future reference, store this operation manual in a secure area away from the safe.

## NOTES

# CONSUMER ASSISTANCE

**WEBSITE:**

www.honeywellsafes.com

www.taruna-jaya.com

**ADDRESS:**

Consumer Assistance Dept.

LH Licensed Products, Inc.

860 East Sandhill Avenue Carson, CA 90746 USA

**E-MAIL:**

support@taruna-jaya.com

**TELEPHONE:**

US/Canada 1-877-354-5457 (Toll Free)

Indonesia 62-21-6410845, 64701938

Mexico 01-800-288-2872 After English voice recording stops you must then enter 800-860-1677 to complete your call. (Toll Free)

Australia 0011-800-5325-7000 (Toll Free)

Germany/New Zealand 00-800-5325-7000 (Toll Free)

Other Countries XX\*-310-323-5722 (Toll Charges Apply)

XX\*- Dial U.S. Country Code first

**CALL CENTER HOURS:**

US/Canada 7am – 5pm (PST\*\*) Mon – Fri (Subject to change)

**CALL BACK HOURS:**

Other Countries 7am – 8pm (PST\*\*) Mon – Fri (Subject to change)

PST\*\*- Local time in Los Angeles, CA, USA

**INTERNATIONAL CALL BACK HOURS:**

If you need to speak with a consumer assistant and cannot contact us during the Call Center hours above, please send an email or leave a telephone message, including your Name, Telephone Number and the best time for us to contact you during the Call Back hours above, and we will make every effort to contact you and help answer any of your questions or concerns.

\* Insert correct Country Code

\*\* Local Time based on Los Angles California USA



# RECOVERING LOST COMBINATION

The following information is required to obtain the safes combination:

## 1. PROOF OF OWNERSHIP (1 of 2 Options Below)

### A) SALES RECEIPT & IDENTIFICATION – INTERNATIONAL ORDERS ONLY!

- Copy of sales receipt showing Store, Date & Product Description.
- Copy of your picture I.D. (Drivers license, passport, regular I.D.).

### B) PRODUCT OWNERSHIP VERIFICATION FORM

If sales receipt is not available, contact us by email or telephone to request a "Product Ownership Verification Form".

## 2. ORDER INFORMATION CONTACT

- Name & Shipping Address
- E-mail address (If Available)
- Telephone Number
- Best Time to Contact You

### PRODUCT

- Safe Model #
- Safe Serial #

## 3. PLACING AN ORDER

- To begin the order process, contact us by telephone, email, or mail

## 4. METHOD OF PAYMENT

- Visa, MasterCard, Check or Money Order

NOTE: For pricing please contact Consumer Assistance. Contact information is located on the back cover of this manual. Payment method and pricing subject to change.

# SAFE IDENTIFICATION RECORD

Model Number 5911

Serial Number: \_\_\_\_\_

# LIMITED WARRANTY

LH Licensed Products, Inc., (“LHLP, Inc.”) warrants that for a period of five (5) years from the date of purchase, this product will be free from structural or mechanical defects resulting from materials or workmanship. LHLP, Inc., at its sole option and as the purchaser’s sole remedy under this warranty, will repair or replace this product or any component of the product found to be defective during the warranty period. Replacement or repair will be made with a new or re-manufactured product or component. If the product is no longer available, replacement may be made with a similar product of equal or greater value.

## THIS IS YOUR EXCLUSIVE WARRANTY.

Our goods come with guarantees that cannot be excluded under Indonesian Consumer Law. You are entitled to a replacement or refund for a major failure and for compensation for any other reasonably foreseeable loss or damage. You are also entitled to have the goods repaired or replaced if the goods fail to be of acceptable quality and the failure does not amount to a major failure. This warranty is only valid for the original retail purchaser from the date of initial retail purchase and is not transferable. You must keep the original sales receipt. Proof of purchase is required to obtain warranty service.

LHLP, Inc. dealers, service centers, or retail stores selling this product do not have the right to alter, modify or in any way change the terms and conditions of this warranty. This warranty does not apply to the finish on the product. This warranty does not cover normal wear and tear of parts or damage resulting from any of the following: negligent use or misuse of the product, use contrary to the operating instructions, disassembly, repair or alteration by anyone other than LHLP, Inc. or an authorized service center, improper installation, or exposure to extremes of heat or humidity. Further, the warranty does not cover Acts of God, such as fire, flood, earthquakes, hurricanes and tornadoes.

LHLP, Inc. shall not be liable for any incidental or consequential damages caused by the breach of any express or implied warranty or otherwise relating to the sale of this product. LHLP, Inc. is also not responsible for: costs associated with removing or installing the product; damage or loss of the contents of the product; nor for the unauthorized removal of the contents; or damages incurred during shipment.

THE ABOVE WARRANTY IS IN LIEU OF ALL OTHER WARRANTIES, EXPRESS OR IMPLIED, INCLUDING ANY WARRANTIES OF MERCHANTABILITY OR FITNESS FOR A PARTICULAR PURPOSE, AND LHLP, INC. DISCLAIMS ANY AND ALL OTHER COVENANTS AND WARRANTIES.

Except to the extent prohibited by applicable law, any implied warranty of merchantability or fitness for a particular purpose is limited in duration to the duration of the above warranty period. Some states, provinces or jurisdictions do not allow the exclusion or limitation of incidental or consequential damages or limitations on how long an implied warranty lasts, so the above limitations or exclusion may not apply to you. This warranty gives you specific legal rights, and you may also have other rights that vary from state to state, or province to province, or jurisdiction to jurisdiction.



**LHLP**

Manufactured by:  
LH Licensed Products, Inc.  
860 East Sandhill Avenue  
Carson, CA 90746

The Honeywell Trademark is used under license from Honeywell International Inc. Honeywell International Inc. makes no representations or warranties with respect to this product.