



## INSTALLATION GUIDE



HONDA CIVIC 2.0L (2016-2021)  
HIGH VOLUME INTAKE

# PRL INSTALLATION OVERVIEW

**PRODUCT:** PRL-HC10-20-INT-HVI PRL MOTORSPORTS HIGH VOLUME INTAKE

**FITMENT:** 2016-2021 Honda Civic 2.0L

**INSTALLATION TIME:** Approximately 45 minutes - 1 hour

**NOTE:** THIS ITEM DOES NOT REQUIRE AN ECU RE-CALIBRATION.

Please check that all components that are listed in the parts list have been supplied to you, and are correct. If you require any assistance or are missing components please email: [support@prlmotorsports.com](mailto:support@prlmotorsports.com). Please verify with a customer service representative before installation or returning the product.

## **PRODUCT DISCLAIMER:**

United States 48 State Compliant:

California/New York Residents please see Prop 65.

This is a Race Only product that is to be used solely for competition, it cannot be used on vehicles that are operated on public streets, roads or highways. Its use is limited to closed-course and open-course racing that is formally sanctioned by a recognized racing organization. Any other use including recreational use could be in violation of local, state and federal laws.

PRL Motorsports is not responsible for any vehicle damage or personal injury that may occur due to an installation error, product misuse, or removal of PRL Motorsports products.

PRL Motorsports highly suggests that a trained professional conduct the installation on all products. PRL Motorsports is not responsible for damaged products due to incorrect installation.

## **REQUIRED TOOLS:**

Ratchet

Allen Wrench - 3mm

Allen Wrench - 5mm

Extension (3" & 12" Length)

5.5mm Socket

10mm Socket

Phillips Head Screw Driver

Flat Head Screw Driver

Needlenose Pliers

Magnetic Pickup Tool (Recommended)

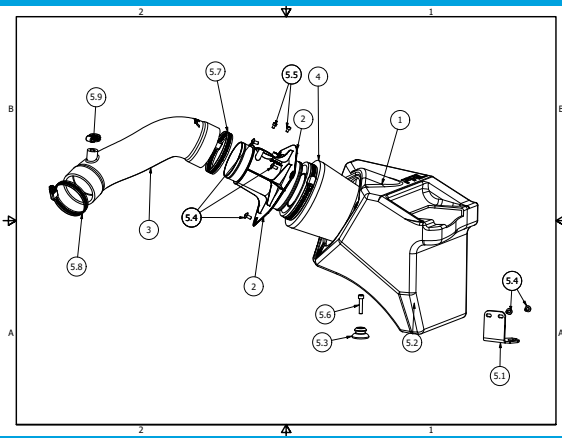

## COMPONENT LIST

#	PART #	QTY	DESCRIPTION
1	RAW-HC10-20-INT-HVI-ROTOBOX	1	2016-2021 Civic 2.0L High Volume Airbox
2	HC10-20-INT-MAF	1	2016+ Civic 2.0L High Volume MAF Housing
3	SIL-HC10-20-INT-HVI	1	2016-2021 Civic 2.0L High Volume Silicone Intake Hose
4	PRL-AF-4258	1	PRL 4" Inlet Air Filter Assembly
5	RAW-HC10-20-INT-HVI-HW	1	2016-2021 Civic 2.0L HVI Hardware Kit
5.1	RAW-HC10-20-INT-HVI-BKT	1	2016-2021 Civic 2.0L High Volume Bracket
5.2	RAW-POST-MOUNT	1	Airbox Mounting Post
5.3	PRL-RABG	1	PRL Rubber Grommet
5.4	BOLT-FLBHCS-M5x0.8x10	5	M5 x 0.8 x 10mm Flanged Button Head Cap Screw - Stainless
5.4	BOLT-SHCS-M4x0.7x6	2	M4 x 0.7 x 6mm Socket Head Cap Screw - Stainless
5.6	BOLT-SHCS-M6x1x30	1	M6 x 1 x 30mm Socket Head Cap Screw - Stainless
5.7	IFE-70-90-12	1	IFE 70-90-12 Hose Clamp
5.8	IFE-60-80-12	1	IFE 60-80-12 Hose Clamp
5.9	IFE-12-22-9	1	IFE 12-22-9 Hose Clamp

## Before Beginning Your Installation:

1. Turn off the ignition. Loosen battery terminal and disconnect the negative battery terminal cable. Allow the vehicle to sit for a minimum of 5 minutes to drain any remaining charge from the charging system.

**NOTE: Disconnection of the negative battery cable erases pre-programmed electronic memory. We recommend saving any memory settings before disconnecting the negative terminal. Some radios will require an anti-theft code to be entered after the negative battery cable is reconnected.**



## Preparing Your High Volume Intake

2. Before beginning any OEM component removal, please reference the parts list and ensure all components are enclosed. If something is missing, please contact PRL Customer Support.

3. The factory air box will need to be removed to install the High Volume Intake. This design utilizes the part of the factory ducting that is affixed to the top of the core support. This factory piece will attach to the PRL High Volume Intake.



4. You will need to unclip the MAF sensor harness from the factory airbox. Simply push the clip down and pull it free of the sensor itself.



5. Unclip the MAF sensor harness from the factory airbox lid using a set of needlenose pliers. Squeeze the tab to free it from the lid's mounting point.

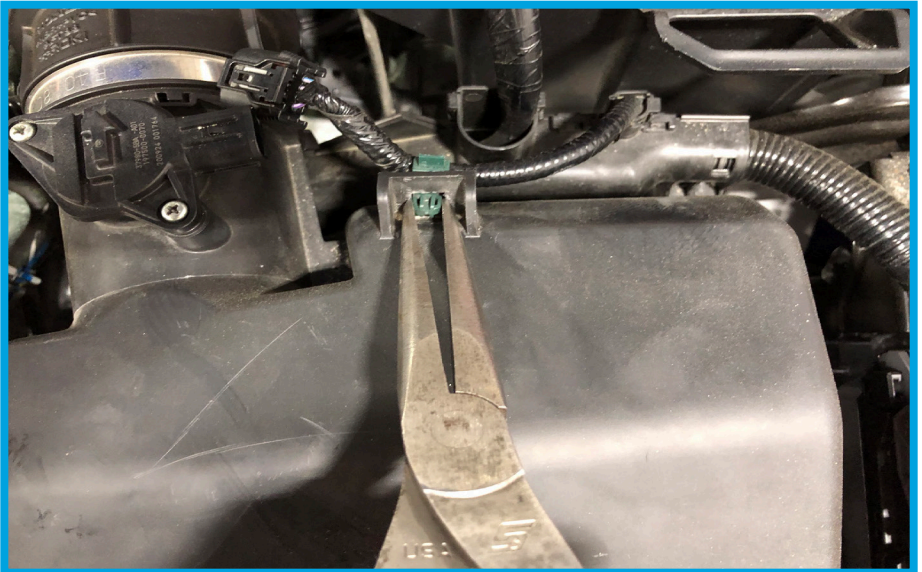

6. Remove the (11) factory push clips that hold the plastic core support cover.



7. Remove the two push clips that attach the air box duct to the core support. Using a 12" extension with a 5.5mm socket loosen the first factory hose clamp holding the factory hose to the factory airbox.





8. Using a 12" extension with a 5.5mm socket, loosen the second factory hose clamp holding the factory hose to the throttle body.



9. Using needlenose pliers, remove the tension clip that holds the factory EVAP lines to the factory hose. This clamp will not be re-used. Free the EVAP lines from the factory hose, and loosen and remove the factory hose off the engine and factory airbox.



10. Release the (4) tabs that attach the air box lid, remove the lid and set aside.

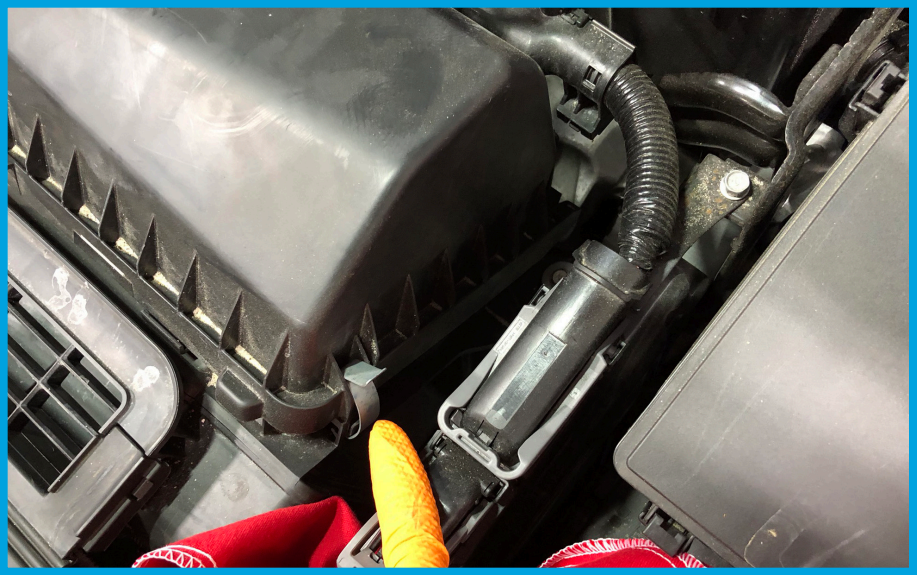

11. Using a 12" extension, remove the factory 10mm bolt located on the right side and near the front of the factory airbox. This bolt will be re-used for the PRL HVI Airbox.





12. Using the 12" extension, remove the factory 10mm bolt located on the right side and near the rear of the factory airbox. This bolt will be NOT re-used for the PRL HVI Airbox.

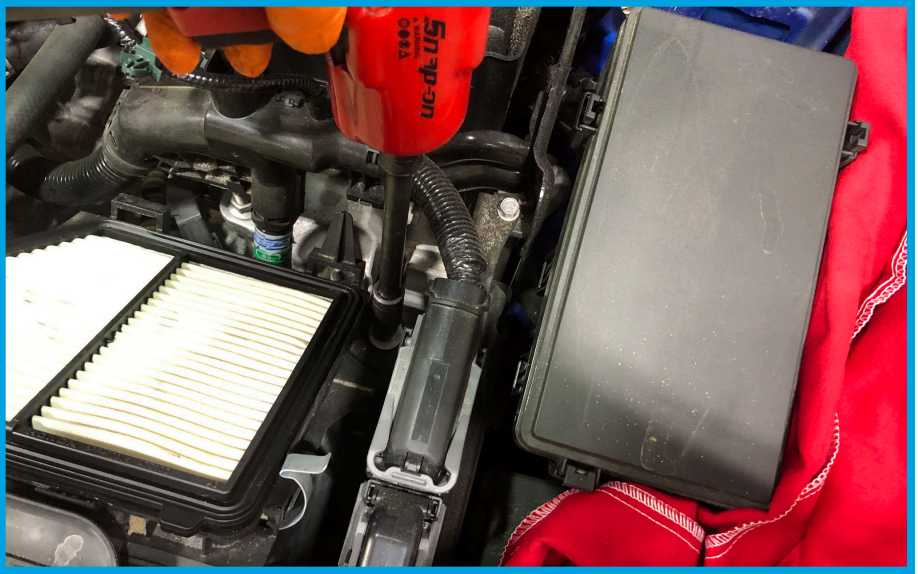

13. With the bolts removed, wiggle the airbox side-to-side, while pulling upwards. This will free it from the engine bay mounting post. Be sure to remove the rubber grommet if it did not come out with the air box assembly.



14. Affix the PRL Air Filter to the High Volume MAF housing. Using a flathead screwdriver, tighten the provided clamp and secure the filter onto the housing.



15. Take (1) of the provided PRL Mounting Posts and secure it using (1) of the M6 socket head screws. This is tightened using a 5mm Allen wrench.

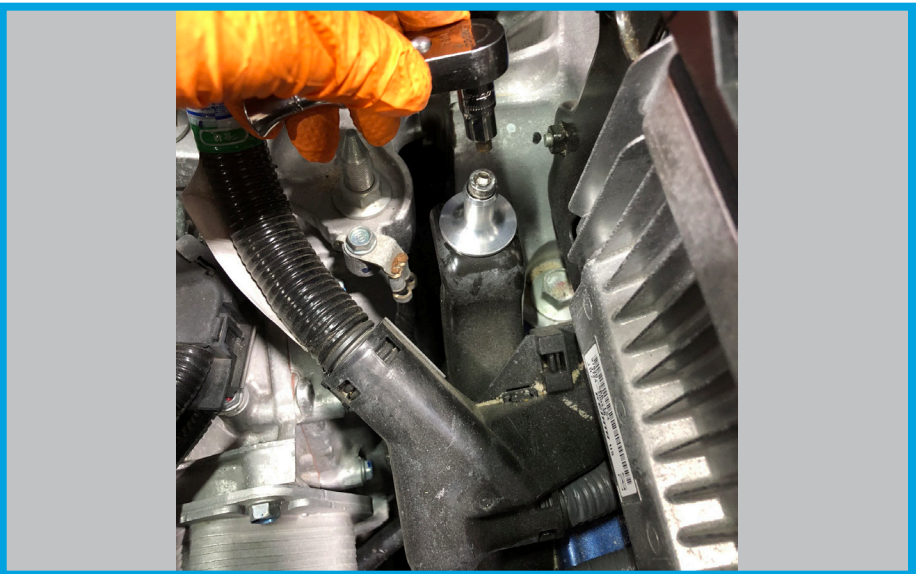

16. Using (1) of the provided PRL Rubber Grommets, place it firmly into the hole in the bottom of the PRL High Volume Airbox.



17. Place the PRL High Volume MAF Housing with the filter attached into the airbox. It's easier to mount this with the airbox still out of the engine bay.





18. Using (3) of the provided flanged button head screws, affix the MAF Housing to the PRL High Volume Airbox. This is tightened using a 3mm Allen wrench.



19. Using (2) of the provided flanged button head screws, affix the PRL Mounting bracket to the side of the PRL High Volume Airbox. Keep loose for desired fitment adjustment. Tighten once fitment is as desired.





20. Install the factory rubber bushing into the supplied PRL air box bracket, then push the metal pin through the center with the flange side facing down.



21. Slide the provided hose clamps onto the silicone and place the silicone in the engine bay, affix the throttle body side first. Do not tighten the clamps yet.



22. Insert the Evap line into the silicone hose.



23. Affix the other end of the silicone hose onto the PRL High Volume Airbox. You will have to use an even, firm amount of pressure to do this.



24. Seat the PRL High Volume Airbox onto the (1) mounting post. You will need to press down firmly once it is lined up.

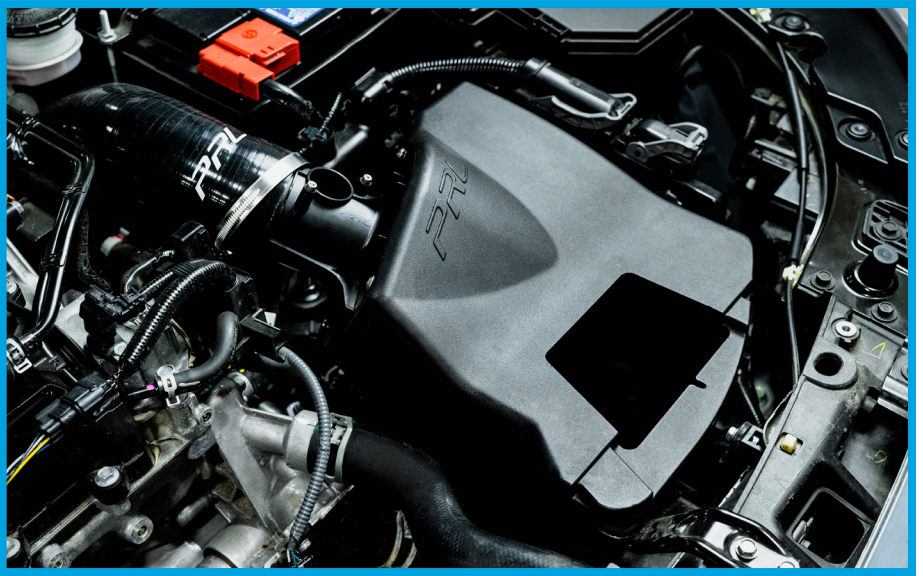

25. Using the (1) factory 10mm bolt, thread it through the grommet and fasten the front of PRL High Volume Airbox down in the engine bay.

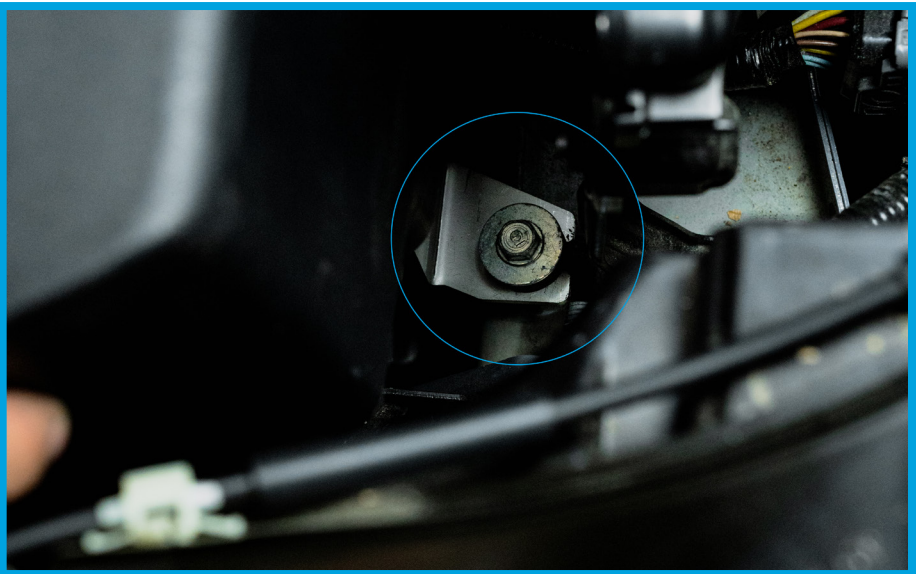



26. Using a flathead screwdriver, tighten the (2) larger hose clamps. These should be tightened firmly, ensure a proper seal and check for gaps.



27. If you have not already, push the EVAP lines into the top bung of the PRL silicone. Using a flathead screwdriver, tighten this smaller hose clamp.



38. Using a Phillips head screwdriver, carefully remove the MAF sensor from the factory airbox. These screws will not be used in the PRL High Volume Intake Airbox.

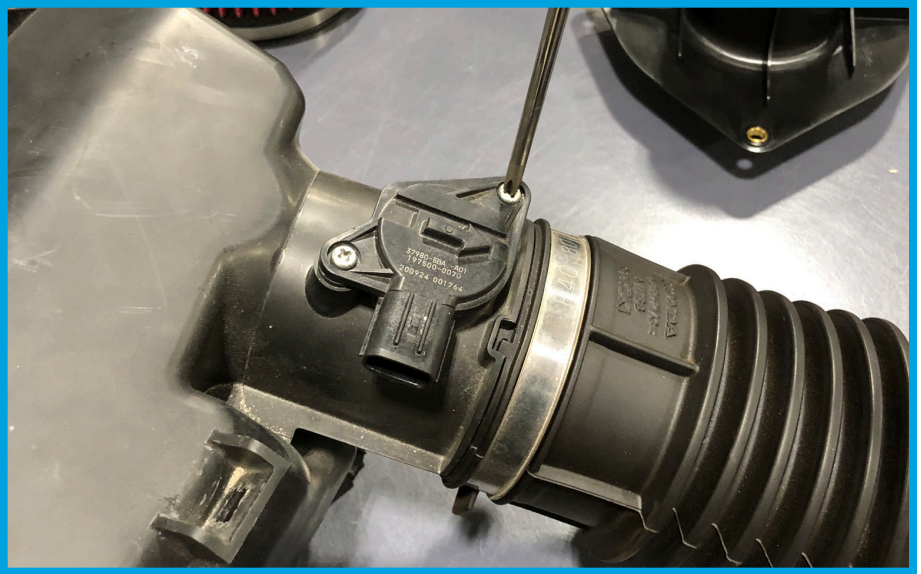

29. Place the MAF sensor into the PRL High Volume MAF housing. Using the (2) M4 socket head screws affix the MAF sensor in place. This is sec Be sure to not over-torque these screws. This is tightened using a 3mm Allen wrench.

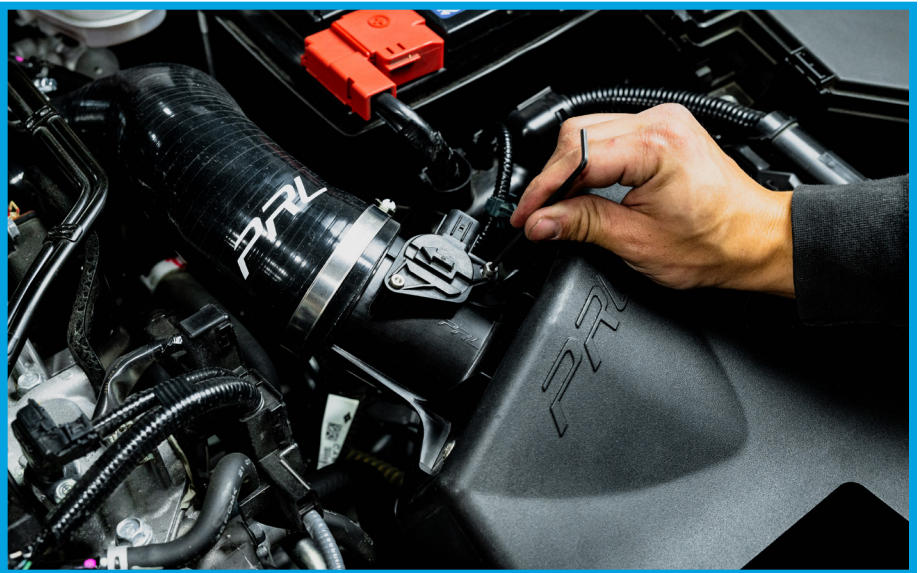

30. Clip the MAF sensor harness into the MAF sensor itself. There should be a slight click when it is secured into place.

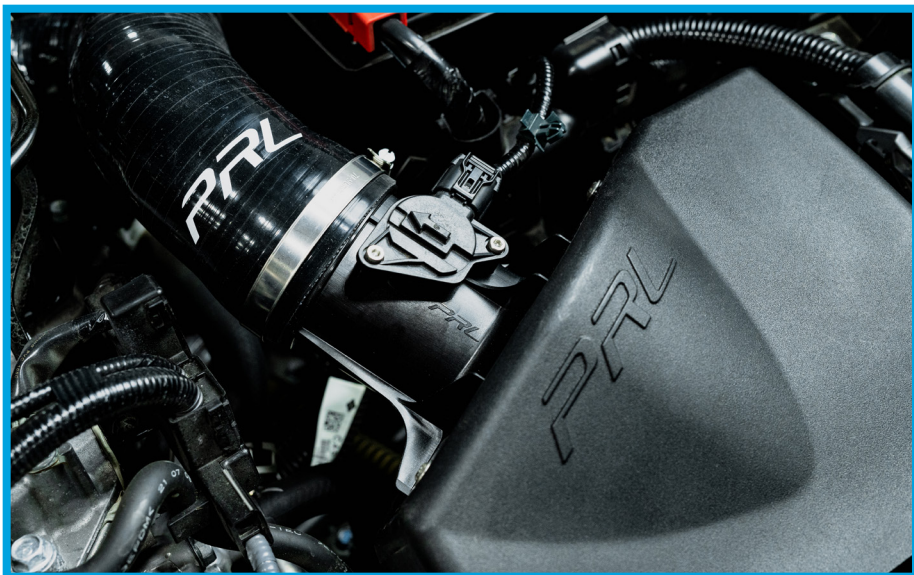



31. Secure the (11) factory push-clips back to the plastic core support cover.



32. Once the duct is re-attached, check all connections to ensure everything is tightened and secured in the correct position. Clean a flat visible surface under the hood and affix the enclosed CARB EO Sticker for SMOG purposes. (CALIFORNIA VEHICLES ONLY)

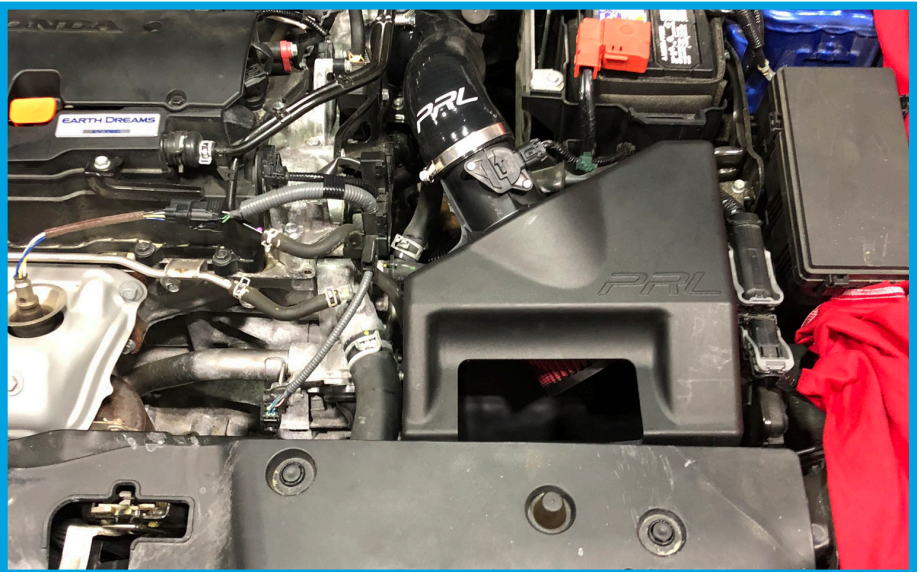

## Road Testing Your PRL High Volume Intake

1. Start the vehicle with the transmission in neutral and the emergency brake engaged. Assess to make sure of any possible issue(s) and then make any subsequent adjustments as they are needed.
2. Test drive the vehicle to ensure everything is in working order.
3. If after the road testing, everything is good to go, enjoy your PRL High Volume Intake! Thank you for being a part of the #PRLARMY.

**If you have any questions/concerns please reach out to us at:**  
[support@PRLMotorsports.com](mailto:support@PRLMotorsports.com)

Please provide a full description of your issue, ideally with any pertinent images or video clips that can help our team address the issue.

Please note: All support tickets are addressed during business hours and in order of received.

As stated at the beginning of this guide, the PRL High Volume Intake has been specifically designed to be 100% compatible with the factory ECU calibration. No tuning is required to benefit from the advertised gains and performance.

## Required Maintenance

PRL Motorsports thoroughly recommends visually inspecting the air filter screen inside the HVI at every oil change. It is required to clean the air filter element whenever the screen is no longer visible or at a 30,000 mile interval. When used in a higher dust/arid climate or varied terrain environments, the air filter will require cleaning more often. To clean and re-oil, our #2801 Filter Cleaning & Recharge kits can be purchased direct on our website, or via an authorized PRL Motorsports dealer.

## Filter Recharging Guide:

- 1. Pre-Cleaning:** Tap the filter or use canned air/compressor to remove any excess debris from the filter. Be careful to not damage the filter.
- 2. Apply Cleaner:** Spray the filter with the special cleaning solution provided in the kit and allow the solution to soak in for at least 15 minutes.
- 3. Rinsing:** Rinse the filter with warm water, clean side to dirty side to flush the dirt and debris outwards from the filter.
- 4. Drying:** Allow the filter to dry naturally. Try to avoid heat to prohibit any shrinkage that could occur in the cotton present in the filter.
- 5. Oil Application:** Re-oil the filter using the filter oil that is supplied in the kit. It is recommended to use a single spray per 2" of filter media. Do not over oil.





1400 RANDALL COURT - UNIT 104  
EXPORT, PENNSYLVANIA 15632  
[www.PRLMotorsports.com](http://www.PRLMotorsports.com)

Follow Us!  
PRLMotorsports





*PRL*

