

U8i

Bluetooth Headphones

User Manual



Thank you for purchasing our products, please read the user manual carefully before use.

English Version

Package Contents.....	1
At a Glance.....	2
Wearing the headphones.....	3
Using the Headphones.....	4
FAQs.....	8
Specifications.....	10
SAFETY AND WARRANTY.....	11

Package Contents

- ① Bluetooth headphones × 1
- ② Eartips × 4 pairs (L / M / S / XS; M-size eartips pre-installed)
- ③ Charging cable × 1
- ④ Wire button (removable) × 1
- ⑤ Carry bag × 1
- ⑥ User manual × 1

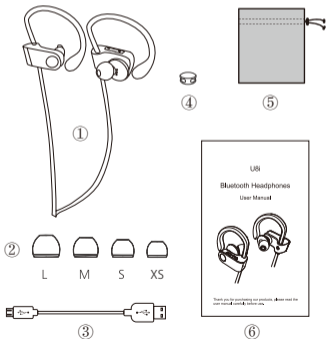

At a Glance

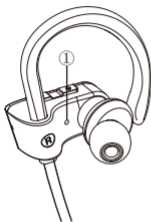

① Microphone

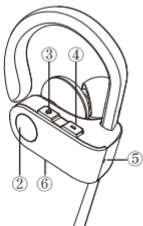

② MFB button
(multi-function button)

③ Volume +

④ Volume -

⑤ LED indicator

⑥ Charging port

LED Indicator Guide

System State	Indicator Activity
Power on	The indicator stays blue for 1 second
Power off	The indicator stays red for 3 seconds
Pairing	The indicator flashes red and blue alternately
Connected	The indicator flashes blue once every 10 seconds
Charging	The indicator stays red
Fully charged	The indicator stays blue
Low battery	The indicator flashes red 3 times every 5 minutes (with a voice prompt)

Wearing the headphones

- 1) Identify the right and left earpieces.
- 2) Insert the earbuds into your ears.
- 3) Adjust the ear hooks until you feel comfortable with it. To determine the best fit, you may need to try all sizes of eartips.

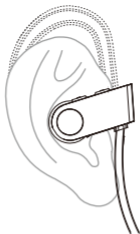

Using the Headphones

Charge the headphones

- 1) Open the hinged door on the bottom of the right earphone.
- 2) Plug the small end of the charging cable into the charging port of the headphones.
- 3) Plug the other end into a USB wall charger or computer (DC 5V) that is powered on.

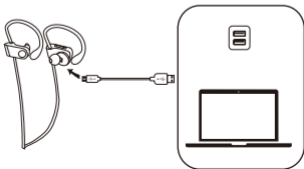

Notes:

- Fully charge the headphones before using them for the first time.
- The indicator is red during charge and turns blue when the headphones are fully charged.

Power on / off

- **Power on:** Press and hold the MFB button for 1 second.
- **Power off:** Press and hold the MFB button for 3 seconds.

Pair

- 1) Turn on the Bluetooth of your Bluetooth devices.
- 2) Turn on the headphones and the headphones enter pairing mode (indicator flashes red and blue alternately).
- 3) In the list of found Bluetooth devices in your Bluetooth device, choose "U8i" to pair.



- 4) Enter "0000" or "1234" if your Bluetooth device asks you to enter a code to pair.

Notes:

- When the headphones are on but not paired with your Bluetooth device, they will be automatically off in about 5 minutes (to enter pairing mode again, turn on the headphones).
- The headphones will directly enter pairing mode the first time you turn them on, and each time you turn on your headphones, they will automatically connect to your last successfully connected device if available within the Bluetooth range.
- To have the headphones enter the pairing mode when they had been paired with a Bluetooth device, turn off the headphones and press and hold the MFB button for 5 seconds (indicator flashes red and blue alternately).

Headphones functions

Function	What to do
Play / Pause	Press the MFB button
Volume up / down	Press the Volume + / Volume - button
Previous / Next track	Press and hold the Volume - / Volume + button for 1 second

Call functions

Function	What to do
Answer / end a call	Press the MFB button
Reject a call	Press and hold the MFB button for 1 second
Redial the last number	Press the MFB button twice
Activate Siri or other voice assistant software	Press and hold the Volume + and Volume - button simultaneously for 1 second

Reset the earbuds / clear all pairing information on the earbuds

- 1) Connect the headphones to a power source for charging.
- 2) Press and hold the MFB button for 5 seconds until you hear a "Du" sound.

FAQs

Q: I paired the headphones with my phone before, but I failed to pair them with my phone again.

A: 1) Turn on the Bluetooth of your phone and in "MY DEVICES", choose "U8i" and tap "i" → "Forget This Device".

2) Turn off the headphones.

3) Reset the headphones.

4) Fully charge the headphones.

5) Pair the headphones with your phone again following the instructions in the previous part "Pair".

Q: I paired the headphones with my phone, but there is no sound from the headphones.

A: Make sure the headphones / phone are / is not muted. Some phones ask for the setup of the wireless headphones as an audio output device before a sound is transmitted. Please refer to the instructions of your phone for details. If you use a music player or other devices, please make sure it supports A2DP stereo music profile.

Q: The connection between headphones and phone is not stable.

A: Make sure your headphones stay close to your phone (not away from your phone more than 33 feet, no obstacles between, and no radio or Wi-Fi interference nearby).

For Android phone users, if using aptX HD / aptX and connection is unstable, please go to the headphones setting of U8i in the Bluetooth settings and disable the high sound quality function.

Q: Can I use the headphones during charging?

A: No, you can't use the headphones during charging.

Q: My headphones will not switch on.

A: Please recharge the headphones and make sure they have enough battery power. If they are fully charged and still nothing happens or if you are not able to charge the unit, please contact our customer support for further information.

Specifications

Model	U8i
Bluetooth Version	V5.0
Battery	100mAh / 3.7V
Charging Time	Approximately 2 hours
Waterproof Rate	IPX7
Input	5V / 1A
Playtime (varies by volume level and content)	14 hours
Bluetooth Range	10 m / 33 ft.
Supporting Protocols	A2DP / HFP / HSP / AVRCP
Supporting Audio Code	SBC / aptX / aptX HD
CVC Noise Cancellation	CVC 8.0 noise cancellation microphone
Working Temperature	-10°C to 40°C

SAFETY AND WARRANTY

Important Safety Instructions

- Use of headphones will impair your ability to hear other sounds. Use caution while using your headphones when you are engaging in any activity that requires your full attention.
- If you have a pacemaker or other electrical medical devices, you should consult your physician before using this product.
- This package contains small parts that may be hazardous to children and should be kept out of reach from children. This product is not a toy – never allow children to play with this product. Always store the product out of reach from children. The bags themselves or the many small parts they contain may cause choking if ingested.
- Never try to dismantle the product yourself, or push objects of any kind into the products, as this may cause short circuits which could result in a fire or electric shock.
- None of the components can be replaced or repaired by users. Only authorized dealers or service centers may open the product. If any parts of your product require replacement for any reason, including normal wear and tear or

breakage, please contact us.

- Avoid exposing your product to heat and humidity to protect against damage to the product or injury to you.
- Keep all products, cords, and cables away from operating machinery.
- If the product overheats, if the product has been dropped or damaged, if the product has a damaged cord or plug, or if the product has been dropped in a liquid, discontinue use and contact us.
- Do NOT use in areas where there are explosive hazards.
- Do NOT submerge the headphones in water. Do NOT expose the headphones to moving water (e.g., from a faucet, etc.).
- Do NOT wear the headphones while showering or bathing, or when participating in water sports, e.g., swimming, waterskiing, surfing, etc.
- This product contains magnetic material. Consult your physician on whether this might affect your implantable medical device.
- Leaving the product in hot or cold places, such as in a closed car in the summer and winter conditions, will reduce the capacity and lifetime of the headphones.

- Dispose of the product according to local standards and regulations.
- **Remember:** *Always drive safely, avoid distractions and follow local laws!*

Using the headphones while operating a motor vehicle, motorcycle, watercraft or bicycle may be dangerous, and is illegal in some jurisdictions, just as use of the headphones with both ears covered while driving is not permitted in certain jurisdictions. Check your local laws. Use caution while using your headphones when you are engaging in any activity that requires your full attention. While engaging in any such activity, removing the headphones from your ear or turning off your headphones will keep you from being distracted, so as to avoid accident or injury. Do not take notes or read documents while driving.

WARRANTY

We strive to build our products with the highest attention to detail and craftsmanship. However, sometimes there are occurrences of a defect, so we are happy to offer a ONE-year hassle-free warranty to all our devices as we continue to make amazing products. Please contact us if you have any questions about our devices.