



***SG-2* OPERATING INSTRUCTIONS & USER MANUAL**



# PARTS LIST

- A Ergonomic Handle
- B Umbrella Holder
- C Scorecard Holder
- D Handle Tube
- E Umbrella Holder Storage
- F Upper Adjustable Bag Straps
- G Adjustable Handle Mechanism
- H Main Upper Frame Tube
- I Leg Bracket
- J Leg Frame
- K Leg Frame
- L Anti-Splay Wire
- M Connecting Rods
- N Right Weight Stabilizer
- N1 Left Weight Stabilizer
- O Right Wheel Locking Mechanism
- O1 Left Wheel Locking Mechanism
- P Lower Frame Lock Mechanism
- Q Lower Adjustable Bag Straps
- R Main Lower Frame Tube
- S Front Wheel Assembly
- T Main Rear Wheel
- U Umbrella Holder
- V Large Carry Bag
- W Sand Bucket Hook

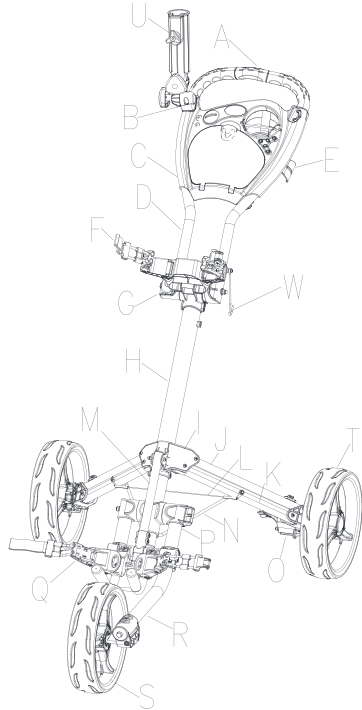

## MAINTENANCE

To clean the buggy, wipe with a soft, damp cloth. Avoid using harsh chemicals to clean. Lubricate moving parts every 6 months.

## WARNING:

For your own safety, please read and understand the following warnings and keep this user guide for future reference.

1. Always make sure the buggy is fully extended and locked before use.
2. Always make sure the buggy is folded and locked properly before lifting or transporting.
3. Do not run while using this product.
4. Do not use accessories other than those designed for use with this buggy.
5. Keep all packing materials away from children and recycle where possible or where required by law.

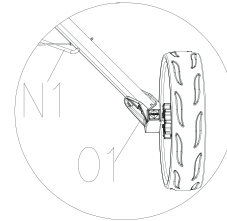
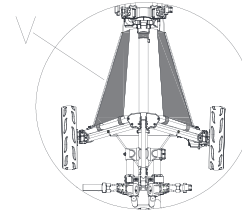

**STINGER SG-2**

## UNFOLDING THE BUGGY

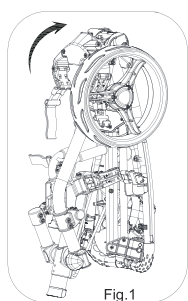
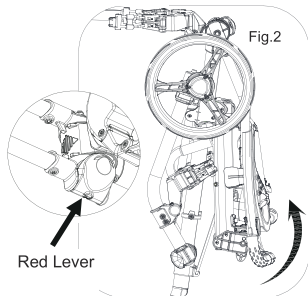

Fig.1

Lift the upper bag bracket until it clicks into position as in Fig.1.



Red Lever

Release the red lever located next to the upper bag holder, until the handle is in the desired height, then tighten the red lever as in Fig. 2.

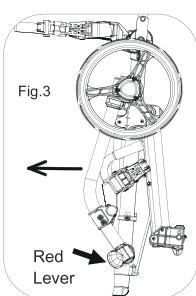

Fig.3

Red Lever

Release the red lever, push the front wheel fork downwards to fully extend the front wheel frame fork and the two leg frames, then lock the red lever as in Fig. 3 and 4.

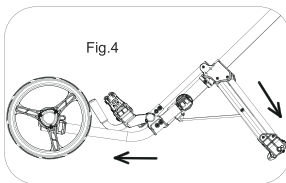

Fig.4

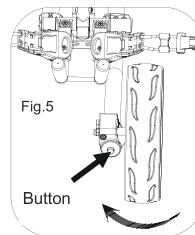
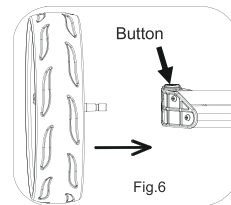

Fig.5

Button

As shown in Fig 5, press the button and rotate the front wheel 180 degrees clockwise so the front wheel is in the centre of the buggy.



Button

Fig.6

Press the button and insert both rear wheels as in Fig. 6.

## FOLDING THE BUGGY

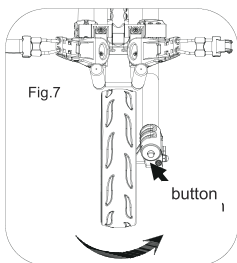

Fig.7

button 1

Press the button and rotate the front wheel counterclockwise 180 degrees to outside of the buggy as in Fig. 7.

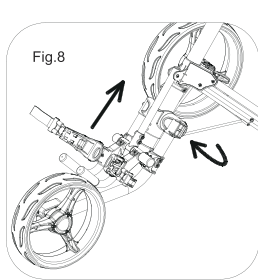

Fig.8

Release the lower lever, fold the front wheel fork until it clicks into position. Then lock the levers as in Fig. 8 & 9.

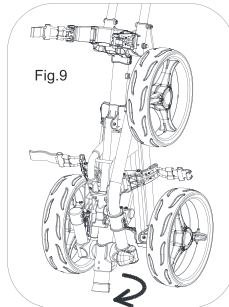

Fig.9

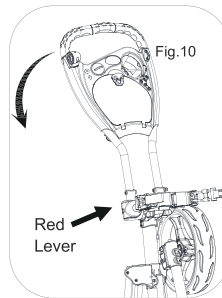

Fig.10

Red Lever

Release the red lever by the upper adjustable bag straps to fold the handle downward as in Fig.10.

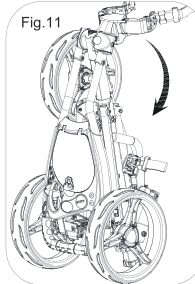

Fig.11

Fold down the top bag bracket as Fig.11.

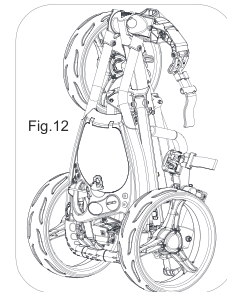

Fig.12

Step 5: The buggy is now folded as shown in Fig.12.

## UMBRELLA HOLDER USE AND STORE

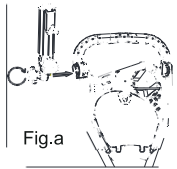

Fig.a

To attach:  
Simply attach the umbrella holder onto the buggy as in Fig. a.

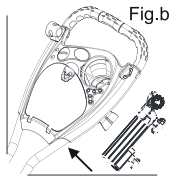

Fig.b

To store:  
Attach the umbrella holder to the storage rack on the handle as in Fig. b & c.

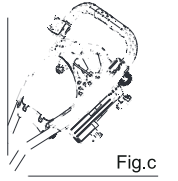

Fig.c

## FOOT OPERATED BRAKE USE

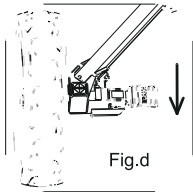

Fig.d

Push on the brake pedal to apply the rear wheel brake and lift to release.

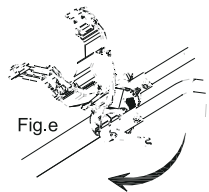

Fig.e

If the handle becomes loose during normal use, please use the supplied tool to tighten as in Fig. e

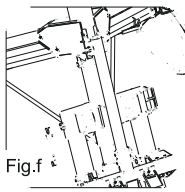
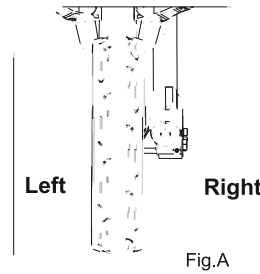

Fig.f

If the lower joint plastic cupling becomes loose during normal use, please use the supplied tool to tighten as in Fig. f

## FRONT WHEEL ADJUSTMENT MECHANISM



Left

Right

Fig.A

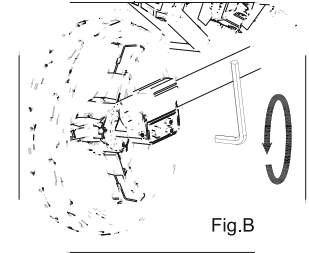

Fig.B

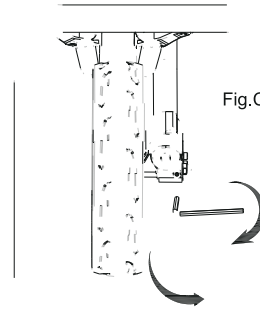

Fig.C

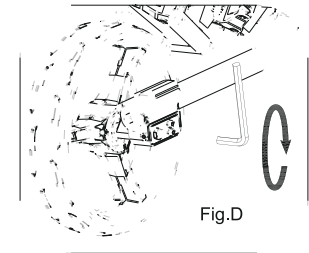

Fig.D

If the buggy veers to the right:

Step 1: Face the front wheel of the buggy and use the provided Allen Key to loose the two side screws as in Fig.B.

Step 2: Then use the Allen Key to adjust the front bolt clockwise until the front wheel is centered as in Fig.C. Then tighten the two side screws as in Fig.D.

If the buggy veers to the left:

Step1: The same as step 1 above.

Step 2: Adjust the front bolt counterclockwise until the front wheel is centered as in Fig.C. Then tighten the two side screws as in Fig.D.

# INSTALL THE STORAGE BAG

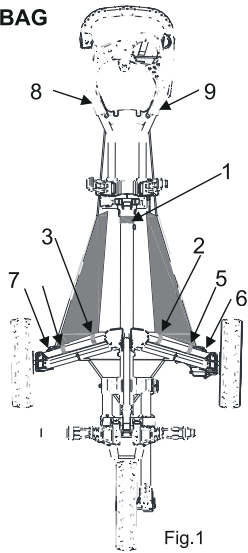

Fig.1

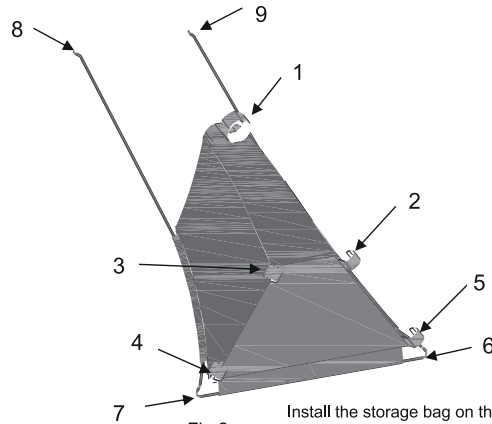

Fig.2

Install the storage bag on the buggy and assemble it in numerical order as shown in Fig.1 & 2.

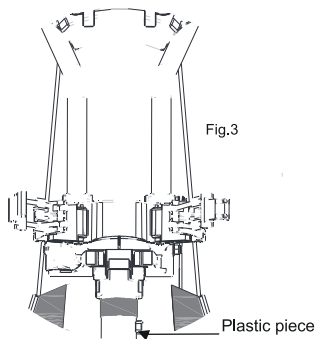

Fig.3

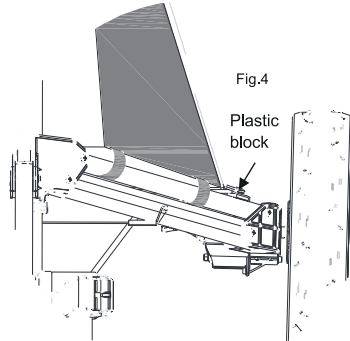

Fig.4

Step 2: Attach the velcro straps (No.2,3,4,5) on the RIGHT and LEFT leg frames as shown in Fig. 4. Then clip the elastic rope (No.6,7) into the plastic block on the R/L Leg Frame as shown in Fig. 4.

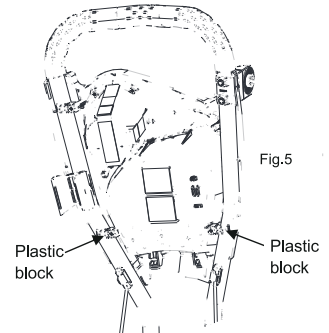

Fig.5

Step 3: Clip the elastic rope (No.8,9) into the plastic block on the back of scorecard holder as shown in Fig.5, then check the length on both are the same.

Step 1: Attach the velcro strap(No.1) on the upper frame as shown in Fig. 3. Note that it must be fixed above the plastic piece, then adjust the length of the elastic rope(No.8, 9.) so that both sides are the same length.



**EXCEEDING IMAGINATION IN QUALITY & PRICE**

[www.stingergolf.com.au](http://www.stingergolf.com.au)

[info@stingergolf.com.au](mailto:info@stingergolf.com.au)