

# VIQURE

## User Manual of Epipro



# CONTENT

<b>Chapter No.1 The User Instructions</b> .....	01
1.1 Safety .....	01
1.2 User Training .....	01
1.3 Electrical and equipment safety .....	01
<b>Chapter No.2 Device Overview</b> .....	02
2.1 Structure and performance .....	02
2.2 Treatment application .....	04
2.3 Accessories of Device .....	04
<b>Chapter No.3 Installation</b> .....	05
3.1 Procudre of Installation .....	05
<b>Chapter No.4 Software Instruction</b> .....	06
4.1 Interface display .....	06
4.2 Treatment Interface Instruction .....	07
4.3 Detail Operation Procedure .....	08
4.4 Attention after the treatment .....	08
<b>Chapter No.5 Maintance</b> .....	09
5.1 Cleaning of the device .....	09
5.2 Cleanign of the operate handle .....	09
5.3 System trouble shooting .....	10
<b>Chapter No.6 Specification</b> .....	11
<b>Chapter No.7 Recommended Treatment Parameters</b>	12

# Chapter No.1 The User Instructions

Please read the user manual carefully prior to operating the machine to ensure that the device is in working condition and to avoid unnecessary harm.

## 1.1 Safety

- When the system processor is started, it will perform a self-check continuously and periodically during operation.
- In case of an emergency, please promptly unplug the power to turn off the equipment.
- Note: Only personnel trained by the dealer have the right to maintain the internal facilities of the device. Any unauthorized disposal may cause damage and invalidate the warranty.

## 1.2 User Training

During the treatment process, the operator must wear protective glasses, and the patient must wear protective goggles. These protective glasses and goggles are specially provided by the device company. Please do not wear any protective glasses or goggles that do not meet the safety requirements.

## 1.3 Electrical and equipment safety

The device is connected to the ground through three wires, and the ground wire must be properly grounded. Only authorized personnel are permitted to repair the device, otherwise the warranty will be void. Please refrain from using flammable materials, such as acetone or alcohol. If disinfecting equipment with alcohol-containing products, please ensure that the alcohol has completely evaporated before proceeding with the equipment.

## Chapter No.2 Device Overview

Epipro is a type of semiconductor laser used for hair removal. It uses high-energy continuous semiconductor lasers to convert electricity, light, and heat energy to treat various diseases. It is a laser treatment product that integrates laser, electronic, computer, and medical technologies.

The working principle of hair removal is as follows: The microprocessor controls the laser power supply to provide an adjustable constant current for the laser module. The high-power laser diode inside the laser module converts electrical energy into light energy, which outputs a continuous laser with a wavelength of 808 nm. The laser beam then passes through the light guide. The crystal is irradiated onto the tissue to be depilated and passes through the surface layer of the skin to reach the hair follicle. The light energy is absorbed and converted into thermal energy, which destroys the hair follicle tissue, causing the hair to fall off and lose the ability to regenerate. This achieves the purpose of permanent hair removal.

### 2.1 Structure and performance

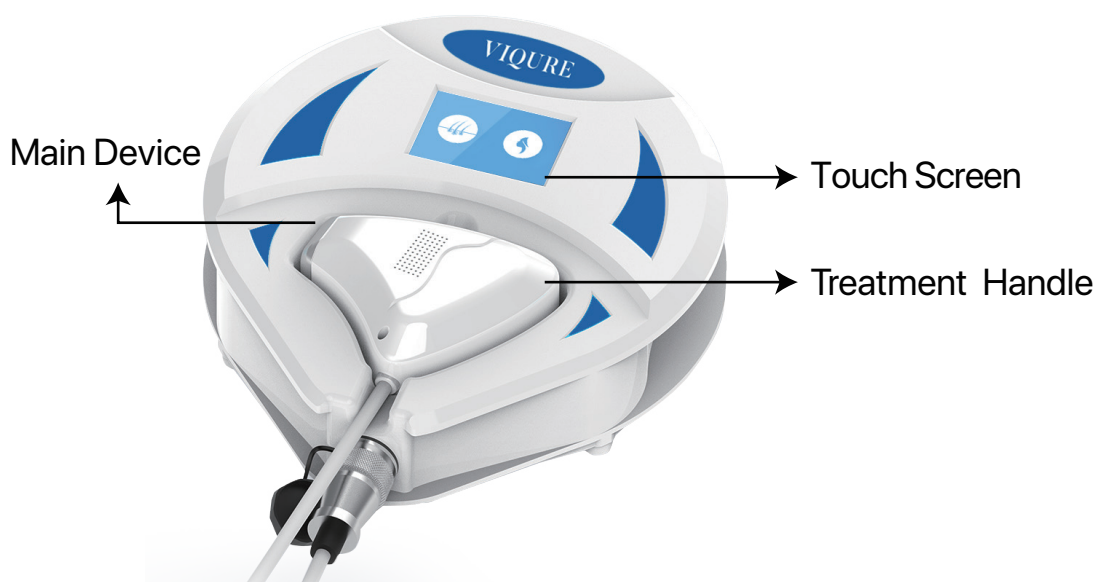

Epipro is mainly composed of a device, a control system, and a treatment handle. The control system includes an emergency button, a key switch, and a control screen. The control screen is a 3.5-inch LCD touch screen. The treatment handle is a laser handle.

## 2.1.1 Structure of the device

### 2.1.1.1 Main Device

For a device, the host is the whole of its appearance, it is also the carrier of other components of the product. EpiPro's composition as below:

**Power Module:** Supply the electric to the whole machine, it's the power source of the device working.

**Control System:** As the main cpu of the device, through the acceptance and action of the input information, the output control device to achieve the various functions required for design and user needs.

**Display module:** As an interface for human-computer interaction, various information of the system is displayed and the receive instructions from the user.

### 2.1.1.2 Control System

The operation of hand laser is mainly done through the control system. Main composition as below:

**Key switch:** Turn on/off the machine.

**Touch Screen:** As a human-computer interaction interface, display the settings of the operation and adjust the system parameters.

### 2.1.1.3 Treatment Handle

The treatment handle is the main body of operation implementation, including bellows and treatment head. The bellows are equipped with power cord and data cable. There's a control switch inside the head.



## 2.1.2 Performance parameter

2-2-1 Performance Parameter Table

Specification	Data
Function	Hair removal+skin rejuvenation
Application	Home hair removal, commercial clinic, beauty salon, nail salon, hair salon, beauty shop, other beauty industries etc.
Screen	3.5" color touch LCD screen
Frequency Response	1-6Hz(HR) / 1-5Hz(SR)
Cooling System	Semiconductor cooling+wind cooling
Wavelength	808nm
Laser Power	150W
Maximum Energy Density	20J/cm <sup>2</sup>
Electrical Power	300W
Handpiece Material	Medical plastics
Laser Output Spot Site	12mm*14mm
Handle Cooling Temperature	0°C~5°C
Machine Size	31cm*27cm*9cm
Input Voltage	AC110V, 60Hz

## 2.2 Treatment application

Epipro is designed for permanent hair removal.

## 2.3 Accessories of Device

Accessories list of Epipro as below:

Name	No.
User manual	1
Treatment handle	1
Power cable	1
Therapy glasses	1
Goggle	1

# Chapter No.3 Installation

## 3.1 Procudre of Installation

The equipment should be installed in an environment with minimal corrosive gas, dust, and particles. Corrosive gas can damage the electronic, optical components, and connecting wires of the equipment. Increased dust and particles in the air can also cause damage to filters and electrical components. Additionally, the temperature and humidity range of the installation environment must meet the performance parameters required for the equipment.

### Installation Process:

- Take out the device.
- Once the device humidity is suitable, assemble the various components of the equipment to ensure stable connections at each interface.
- After each component and power supply are completely connected, turn on the device and test its performance and various system parameters while ensuring that the device is connected without errors.



# Chapter No.4 Software Instruction

## 4.1 Interface display

### 4.1.1 Interface instruction under hair removal

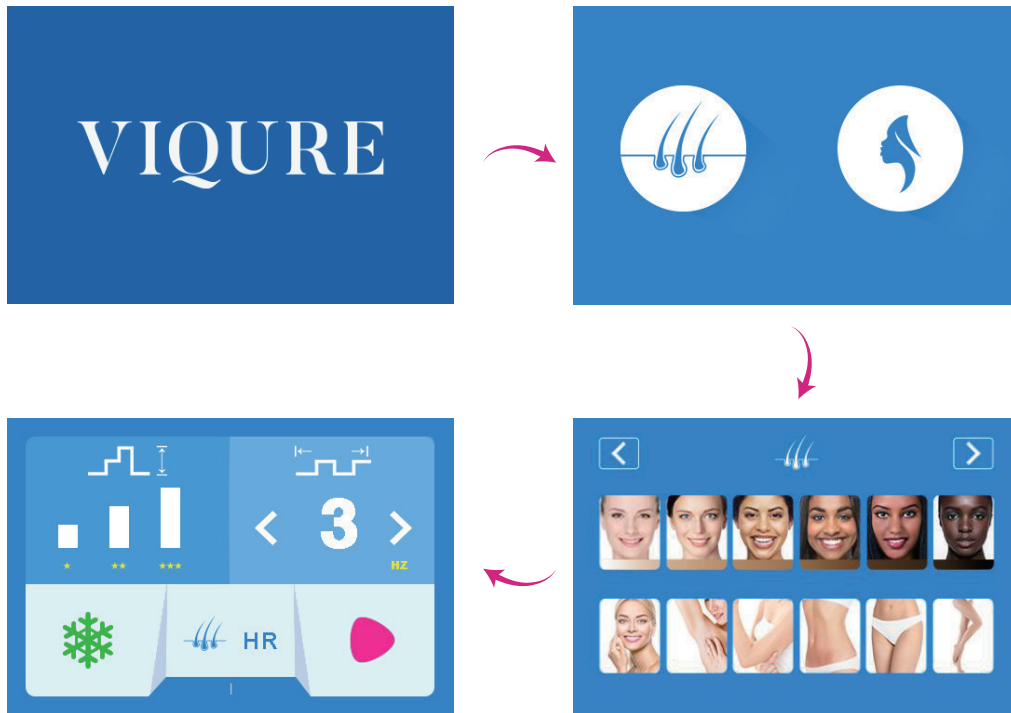

P 4-1-1

### 4.1.2 Description of hair removal working interface

#### Description of working interface

Icon	Name	Function
	Energy adjustment	It has 3 levels from 1 to 3, higher level brings higher output energy.
	Frequency adjustment	It has 6 levels from 1 to 6, higher level brings more shots in a second.
	Cooling	Turn on/off
	Ready	Turn on/off
	Function display	Hair removal mode
	Skin types selection	Select different skin types from I to VI
	Body parts selection	Select different treatment body parts



### 4.1.3 Description of skin rejuvenation interface

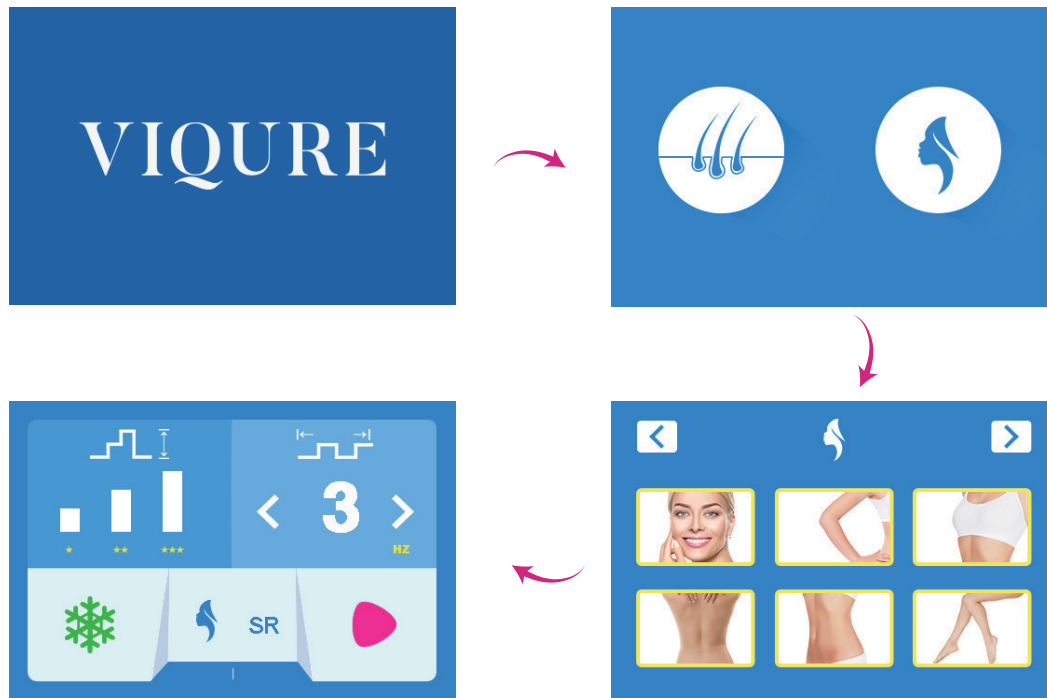



### 4.1.4 Description of skin rejuvenation working interface

4-1-2 description of working interface



Icon	Name	Function
	Energy adjustment	It has 3 levels from 1 to 3, higher level brings higher output energy.
	Frequency adjustment	It has 6 levels from 1 to 5, higher level brings more shots in a second.
	Cooling	Turn on/off
	Ready	Turn on/off
	Function display	Skin rejuvenation mode
	Body parts selection	Select different treatment body parts

## 4.2 Treatment Interface Instruction



### 4.2.1 Parameter Setting---Hair Removal

Energy level adjustment  (1-3 levels); Frequency adjustment  (1-6Hz); Cooling system  (when it's green, it's the startup state).

## 4.2.2 Parameter Setting---Skin Rejuvenation

Energy level adjustment  (1-3 levels); Frequency adjustment  (1-5Hz) ; Cooling system  (when it's green,it's the startup state).

## 4.2.3 Standby/Working status switch

Press "Standby/Ready" Switch to "Ready" if the system is "Standby". Switch to "Standby" if the system is "Ready". Standby icon is gray  , Working status is red  .

## 4.3 Detail Operation Procedure

- Before treatment, the operator communicated with the patient in detail, cleaned the treatment area with mild facial cleanser, performed simple hair shaving and shaving treatment on the target area, and finally applied 1 ~ 2mm cold gel on the treatment area.
- Start the system and enter the treatment parameter setting interface.
- According to the actual situation of the patient, set the treatment parameters, press the standby/ready button to start the treatment.
- During the treatment, the operator should observe the treatment of the patient in real time, and adjust the treatment parameters according to the actual situation if necessary.
- In the course of treatment, the treatment head should avoid staying at the same treatment site for a long time; the operator and the patient should do the protection work in real time to avoid injury.
- Turn off the power switch after treatment. Remove the cold gel from the treatment site and apply cold compress.
- Clean the treatment head with a warm towel, and then disinfect the treatment head with a cotton ball dipped in disinfectant.
- Put the clean and sterilized treatment head into the package box, remove the power plug, and the treatment process ends.

## 4.4 Attention after the treatment

During treatment, the treatment head should not stay at same treatment site for too long.

- After treatment, apply a cold compress to the area for 5-10 minutes;
- For the treatment site, do not touch hot water for 24 hours, avoid sauna steaming in 3 to 7 days;
- Avoid high humidity and heat environment;

- Forbidden to eat spicy, seafood, and pungent food; Eat less photosensitive vegetables (for example, celery, white radish, spinach, coriander, etc.)
- Pay attention to sunscreen and apply 30 times more sunscreen. If be in summer when ultraviolet ray is stronger, can fill brush a few times more, play sunshade or wear sunshade cap;
- Use of efficacious cosmetics on therapeutic sites is prohibited for nearly a month.

## Chapter No.5 Maintenance

### 5.1 Cleaning of the device

Clean the main machine with a soft wet cloth, but avoid liquid flowing into the inside of the device.

### 5.2 Cleanign of the operate handle

- Regularly clean the treatment handle lens (a small amount of pigment particles will splash onto the treatment lens during the treatment process, affecting the laser output), and wipe the treatment lens with lens paper or a cotton ball with absolute ethanol.
- Each treatment handle has a certain service life. It must be replaced after half a year (about 5 million treatments). You need to contact the dealer to purchase again.

### 5.3 System trouble shooting

#### 5-3-1 System trouble handling

Trouble Phenomenon	Solution
Screen without display	Check the electric wire
	Check the circuit-breaker, fuse wire
	Please check the power supplier switch
	Please contact the distributor or device producer
No reaction of the handle switch button	Please check whether the power supply switch behind the device is on or not .If on ,the trouble is still ,please contact the distributor or device producer
System can not be initialization	Check the power supply
	Please contact the distributor or device producer

Trouble Phenomenon	Solution
The energy output lower or no laser output	The voltage is too lower result the handle can not work normally
	Please check whether there are dirty thing on the laser reflective mirror ,if yes ,please clean it
	The handle inner is destroyed ,please replace new treatment handle
	Disassemble the treatment handle to check whether the head reflective mirror are destroyed or not
	The treatment handle is too hot ,please turn off the machine ,cool down around 30 minutes ,then use again
Treatment handle dropped out of the handle holder	Whether have a start-up heat dissipation
Cooling system temperature is too high	Please check the handle destroyed or not ,if yes , please replace new handle
The treatment handle output energy is too lower	Turn off the device for minutes ,then return on again. If the cooling system is still abnormal ,please contact distributor or device producer
	Please check whether there are dirty thing on the reflective mirror ,If yes please clean it
	If the handle is hot ,please turn off the machine 30minutes Please check the head of the reflective mirror good or not ,if there are any destroy .Please contact your distributor or device producer
The treatment handle output energy is too low	The working life of treatment head is over.please contact your distributor or device producer
The laser emitter is broken	Please contact your distributor or device producer

# Chapter No.6 Specification

This chapter details the most important technical parameters and treatment system of categories.

## 6-1 System Standard List

Specification	Data
<b>Electrical connections data</b>	
Electrical voltage	110VAC ±10%
Electrical frequency	60Hz
<b>Device type</b>	
Against electric shock protection type	Type I
Against electric shock protection level	BF
Harmful water invade type	Normal
<b>Weather condition(during the operation)</b>	
Temperature around	+15℃ to +30℃
Relative humidity	30% to 80%
Atmospheric pressure	86.0 kpa to 106.0kpa
<b>Weather condition(during the transport of device )</b>	
Temperature around	+5℃ to +55℃
Relative humidity	30% to 80%
Atmospheric pressure	86.0 kpa to 106.0kpa
<b>Device Size &amp; Weight</b>	
Length	310mm
Width	270mm
Height	90mm
Weight	2.5Kg

# Chapter No.7

## Recommended Treatment Parameters

Body Parts	Frequency	Skin Type	Recommended Energy	Recommended Treatment Times
Face	1-2 Hz	Type I	3 Level	5-8 times
		Type II	3 Level	5-8 times
		Type III	1 Level	3-5 times
		Type IV	2 Level	3-5 times
		Type V	2 Level	3-4 times
		Type VI	2 Level	3-4 times
Armpit	1-2 Hz	Type I	3 Level	5-8 times
		Type II	2 Level	5-8 times
		Type III	2 Level	3-5 times
		Type IV	2 Level	3-5 times
		Type V	1 Level	3-4 times
		Type VI	1 Level	3-4 times
Arms	2-3 Hz	Type I	3 Level	5-8 times
		Type II	3 Level	5-8 times
		Type III	3 Level	3-5 times
		Type IV	2 Level	3-5 times
		Type V	2 Level	3-4 times
		Type VI	2 Level	3-4 times
Belly	3-4 Hz	Type I	3 Level	5-8 times
		Type II	3 Level	5-8 times
		Type III	3 Level	3-5 times
		Type IV	2 Level	3-5 times
		Type V	2 Level	3-4 times
		Type VI	2 Level	3-4 times
Bikini	1-2 Hz	Type I	2 Level	5-8 times
		Type II	2 Level	5-8 times
		Type III	2 Level	3-5 times
		Type IV	2 Level	3-5 times
		Type V	1 Level	3-4 times
		Type VI	1 Level	3-4 times
Legs	4-6 Hz	Type I	3 Level	5-8 times
		Type II	3 Level	5-8 times
		Type III	3 Level	3-5 times
		Type IV	2 Level	3-5 times
		Type V	2 Level	3-4 times
		Type VI	2 Level	3-4 times

### Note:

1. The cold gel needs to be applied thinly, and the moving speed of the handle on the skin needs to be slowed down during hair removal treatment. The frequency can be set to 1Hz if necessary to change the treatment mode from continuous shooting to single shooting therapy.
2. Different people have different skin color, hair color, hair thickness, hair density and personal physique. Due to limited clinical sample data, the recommended parameters are for reference only and need to be adjusted according to the physical response of the customers.

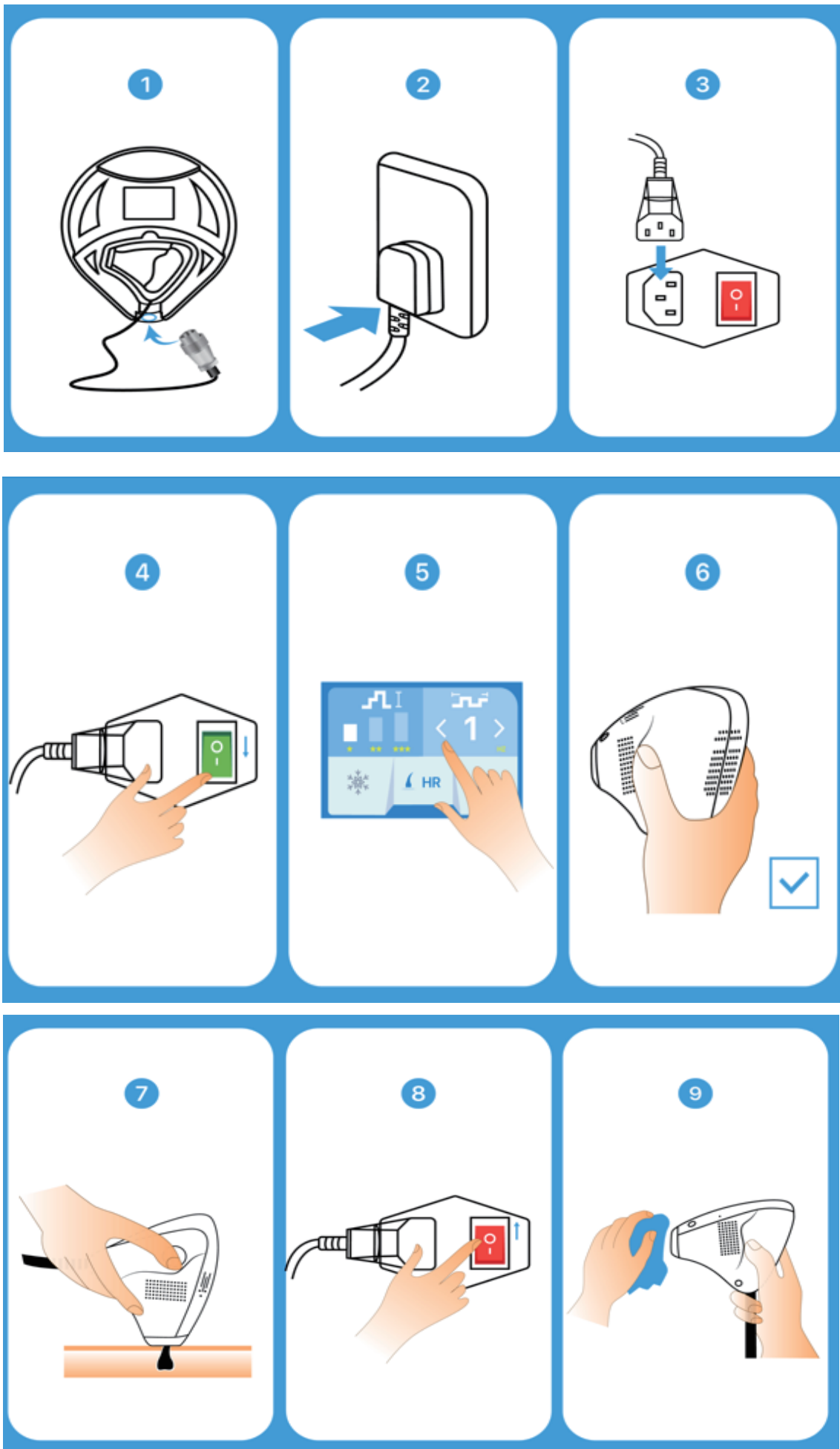

VIQUIRE

VIQURE