



Hydra.Pen®
Skin Aesthetics Force



User Manual H3 EN

Please read the manual before use



Product description	2
Parts name	3
How to operate	4
How to operate	5
Adjustment of needle length	6
Speed display and adjustment	6
Introduction for wireless mode	7
How to charge the battery	7
Needle cartridge introduction	8
Specification	8
Precaution	9
Warranty	10



The device consists of an electric microneedling pen and disposable liquid containable needle cartridges. This manual will explain how to use each component in detail.

The device is used to improve the appearance of the skin and reduce signs of aging. It is intended to stimulate the skin with micro-needles for collagen and elastin production. The microchannels created in the superficial skin by the device also help with the absorption of skin serums.

There are 3 different types of needle cartridges designed for the device. These cartridges can be used for micro-needling treatment and nano-needling treatment.

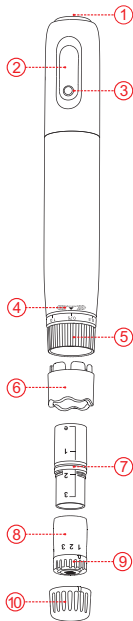

① Power Interface

② Display Screen

③ Power / Speed Button

④ Scale point

⑤ Scale adjustment ring

⑥ Retaining ring

⑦ Needle cartridge body

⑧ Upper part of needle Cartridge

⑨ Regulating ring

⑩ Protective Cover



Take out needle cartridge from the sterilized packaging.
[fig 1]

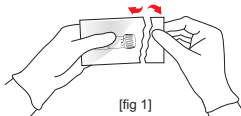

Hold the needle cartridge body same direction as [fig 2].
Put essence into the empty needle cartridge body.

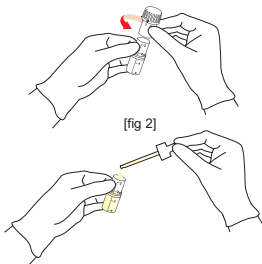

Screw the upper part of needle cartridge onto needle cartridge body well. [fig 3]

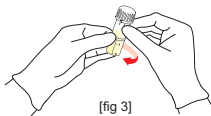



Please choose suitable discharge level according to the consistency of essence.

1. Align the locating point of protective cover with the scale point of regulating ring. [fig 4]

2. Adjust the flow out of essence by rotating the protective cover.

The number aligning with the locating point of protective cover shows the current discharge level of essence. [fig 5]

Adjust the regulating ring to level 1 if the essence is thin.

Adjust the regulating ring to level 3 if the essence is thick.



[fig 4]

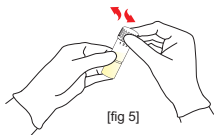

[fig 5]

3. Remove the protective cover.

Place the needle cartridge to the pen. [fig 6]

4. Place the retaining ring to the pen. [fig 7]

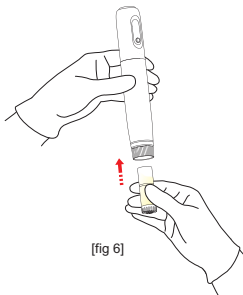

[fig 6]

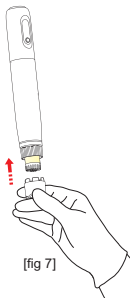

[fig 7]



Use suitable needle size according to different treatment areas and skin problems

Adjust the depth of the needle by turning the scale adjustment ring. The depth of the needle should be adjusted after starting the pen. The scale number aligning with the scale point shows the current needle depth. [fig 8]

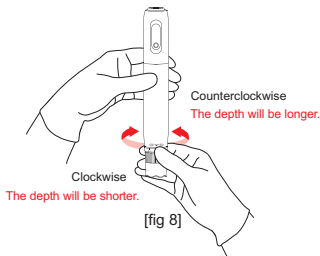

Speed display and adjustment

Speed Display



6 Speeds Adjustment

Press and hold the power button for 3 seconds to start or shut down the device. After starting the device, the speed changes once each time the power button is pressed.



This device is powered by a built-in battery. It can work wirelessly. The power cable and the adapter are used to charge the device when it is out of battery.



How to charge the battery

Connect the power cable with adapter to the power interface of device and plug the adapter into a live AC outlet to charge the device. Charging will be completed in about 2 hours.

The number of speed flashes slowly when the battery capacity is 10% left .

The pen turn off automatically after the number of speed flashes quickly for 1 minute.

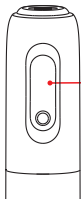

The pen shows "  " when restarting after the low battery automatic shutdown.

The pen shows spinning "  " while charging .

The pen shows "  " when charging is completed.



Nano-HS



Nano-HR



H12

The needle cartridge is disposable.

The needle cartridge is designed for Hydra.pen H3 only.

Please sterilize the needle cartridge with 75% alcohol for a few minutes before use.

Please dispose the used needle cartridge to the trash container.

In order to protect the instrument well, do not invert the pen to prevent the liquid back-flow.



Specification

Model name : Hydra.pen H3

Adapter Input : 100-240V 50-60HZ Output : 5V $\overline{\text{---}}$ 2A

Package Weight : 390 g Size : 169*123*56 mm

Packing List

Item	Quantity
Hand Piece	1 pc
Adapter	1 pc
Manual	1 pc
Power Cable	1 pc
Needle Cartridge	2 pcs



	Please be sure to read the instructions before use and follow as described.		
	Do not apply it to the person as following: 1. Who has acute disease or bloody disease over 38°C 2. Who has allergy and hemophilia 3. Who has melanosis of the face 4. Who has high internal heat 5. Who regularly visits hospital 6. Who takes medicines 7. Who is under 12 years old		
	Do not use it on the power other than AC 220V. It may cause fires or malfunction.		
	Do not use it near the place with high temperature, dust or humidity (Near the humidifier). It may cause malfunction.		
	Do not repair, disassemble or alter the controller and the body. It may cause malfunction.		
	Do not touch the device or detach the power cords with wet hands. It may cause electric shock.		
	Do not use the stripped cord or propped cord. It may cause fires(Be sure to replace it with another).		
	Do not use the propped cord which has crack or scares. It may cause scares on the skin.		
	When you don't use it for a long time, unplug it from the outlet.		
	Be sure to have an inspection for test. If any troubles are found, get it repaired.		
	No one other than the operator can touch it. It may cause accidents or malfunction.		
	Alternating current		Serial No
	Direct current		Manufacturer
	Date of manufacture		CE mark
	Attention, consult accompanying documents		Consult instruction for use



The warranty period of the device is 12 months. We offer repair service from the purchase date. If any of our product has damages or natural trouble, we provide replacements or repair service. The use of third-party cartridges can cause damage to the device. This could invalidate the warranty.

General maintenance

Make sure to inspect the device and adapter before use.

Ensure the device is turned off when not in use. Wipe its surface with a disinfecting wipe.

Pay attention to clean areas such as crevices, seams, and areas around where the needle cartridge attaches to the device.

Keep it away from direct sunlight, high temperature or humidity.

Do not leave the measurement, repair or alter of the device to non-professional staffs.

When you use the device which has not been used for a long time, Please make sure to check if it works properly with safety.



Hydra.Pen[®]
Skin Aesthetics Force