

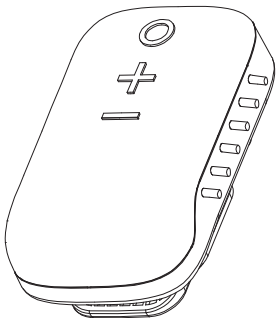

# go **SPKR**

WEARABLE BLUETOOTH CLIP SPEAKER WITH MAGNET



goSPKR Setup Guide

Scan the QR code or visit:

[MEEaudio.com/goSPKRsupport](http://MEEaudio.com/goSPKRsupport)

**QUICK START GUIDE**

# what's in the box

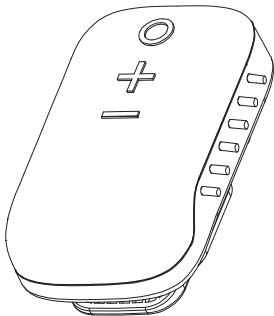

goSPKR

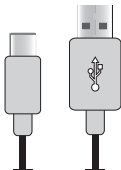

Charging Cable

## Multifunction button

**Power on/off:** Long press 3s

**Play/pause:** Press 1x

**Siri® / Google Assistant™:** Press 3x

**Answer/hang up phone call:** Press 1x

**Reject incoming call:** Long press 3s

**Enable/disable stereo mode:** Press 2x

## Volume up button

**Volume up:** Press 1x

**Next track:** Long press 3s

## Volume down button

**Volume down:** Press 1x

**Previous track:** Long press 3s

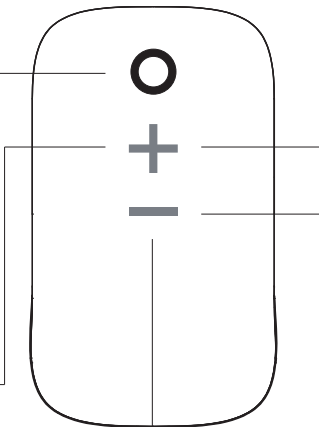

**HOLD  
BOTH  
buttons**

**5s**

— Reset

# charging ⚡

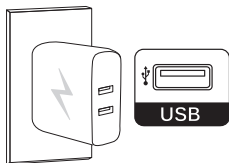

**Step 1**  
Plug charging cable into  
a powered USB port

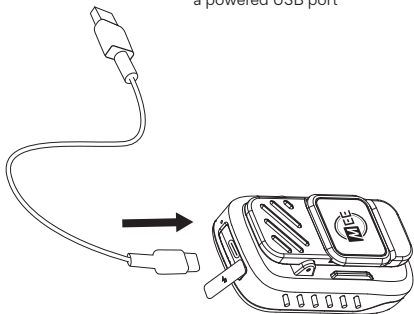

**Step 2**  
Plug charging cable into goSPKR



red light = charging



green light = charged

# Bluetooth pairing



## Step 1

Power on

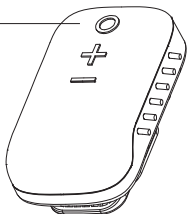

## Step 2

Select MEE audio goSPKR on device

Note: To pair a different device, remove or disconnect the goSPKR from the Bluetooth menu of the original device



# stereo mode



## Stereo mode

Link 2 goSPKRs together for stereo sound!

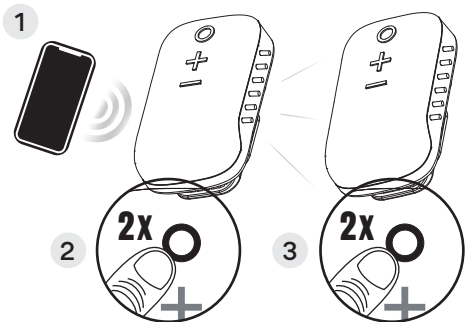

### Step 1

Connect the first goSPKR to your device

### Step 2

Double press the  button on first goSPKR

### Step 3

Power on the second goSPKR. Unpair it from any previously-paired Bluetooth device, then double press its  button

Note: Double press the  button on either goSPKR to exit stereo mode

## WARNINGS

This device is designed and manufactured to operate within its defined design limits. Misuse may result in electric shock or fire. Read and follow these instructions carefully.

- Danger of explosion or fire if batteries are damaged. Never attempt to open the battery for any reason. Do not use the device if it has been crushed, pierced, or otherwise damaged in any way that could compromise the battery. Do not leave the speaker in any location with excessive heat including naked flames or near heat sources such as radiators and stoves. Do not expose the battery to spark, flame, or salt water.
- Do not charge or use around flammable gasses, liquids, or dust as fire or explosion may occur
- There are no user replaceable/reparable parts in the device. Disassembling it will void your warranty and may cause personal injury. Changes or modifications to this unit not expressly approved by MEE audio could void the user's authority to operate the equipment.
- Only use attachments/accessories specified by the manufacturer
- Keep the device and packaging out of the reach of children

## SAFETY & CARE

- Using speakers at high volumes for extended periods of time will result in permanent hearing damage. It is advised you keep volume levels moderate to low at all times for your safety.
- The lifetime of the battery will be significantly reduced if your speaker is not charged for a long time. It is recommended to charge your speaker at least once a month.
- Battery performance will be severely decreased when stored in extreme temperatures. Do not store the speaker in locations where temperatures may reach below  $-10^{\circ}\text{C}/14^{\circ}\text{F}$  or above  $40^{\circ}\text{C}/105^{\circ}\text{F}$ , including direct sunlight.
- Do not expose this product to rain or other moisture for an extended period of time. If submersed in water, do not turn the device on until completely dried. Note: liquid submersion voids the warranty.
- Do not use chemical cleaning sprays to clean this product. Only use a water-dampened cloth.

**questions?**  
we're here to help!

Phone Support: 626-965-1008  
Monday ~ Friday 9 am to 5 pm PST

Email Support: [support@MEEaudio.com](mailto:support@MEEaudio.com)  
All emails are responded to within 2 business days

---

**for additional support**  
view our video setup guide

Scan the QR code or enter the  
URL below into your web browser:

[MEEaudio.com/goSPKRsupport](http://MEEaudio.com/goSPKRsupport)



**SPKR**

#### **WARRANTY**

This product is covered by a 1-year manufacturer warranty.  
For more information, visit [MEEaudio.com/support](http://MEEaudio.com/support).

---

MEE audio and its logo are registered trademarks of S2E, Inc. All rights reserved.

The Bluetooth® word mark and logos are registered trademarks owned by Bluetooth SIG, Inc. and any use of such marks by MEE audio is under license. Other trademarks and trade names are those of their respective owners.

Siri® is a registered trademark of Apple Inc.  
Google Assistant is a trademark of Google Inc.