



**A161P Balanced Armature
Reference In-Ear Headset**

user manual

www.meelec.com

Thank you for your purchase of the

**A161P Balanced Armature
High-Fidelity In-Ear Headset**

Please read this manual in its entirety.

If you have any questions after reading the manual

please contact

MEElectronics customer service at

customerservice@meelec.com

 **MEE**[™] brings musical enjoyment to everyone

TABLE OF CONTENTS

Package Contents	1
Warning	2
Safety Tips	
First Use: Selecting Tips	3
How to Wear: Installing Tips	4
How to Wear: Inserting Earpiece	5
How to Wear: Using Cable Guides	6
How to Wear: More Options	7
Included Adapters	8
Earphone Removal	9
Use While Exercise	
Use While Traveling	
Care and Storage	10
Cleaning	11
Warranty	12
Troubleshooting	13
Troubleshooting Continued	14

Package Contents



A161P
Balanced
Armature
Headset



6 Pairs
of Eartips



Pair of
Cable
Guides



Headset
to PC
Adapter



Shirt
Clip



TRRS
Adapter
for Select
Smartphones



Zipper
Carrying
Case



User
Manual

Warning



Please Read: Important Safety Information to Avoid Personal Injury!

Statistics show that using noise isolating earphones while walking, jogging, or running in areas with moving vehicles or trains significantly increases the potential of accident which leads to personal injury or death.

We strongly discourage using noise isolating earphones while walking, jogging, running, cycling, driving, operating machinery, or performing other activities that require hearing surrounding sounds.

Do not use headphones at high volumes for extended periods of time as doing so will result in permanent hearing damage. It is advised that you keep volume levels moderate to low at all times for your safety.

Please visit www.osha.gov for more info.

Safety Tips

It is advised to turn the volume on your music player all the way down before connecting your MEElectronics earphones. After the earphones are connected and sealed in your ears, gradually increase the volume until you reach a comfortable listening level.

Achieving a good seal will isolate you from outside noises allowing you to play your music at lower volume levels.

First Use: Selecting Tips

A proper seal between the earpiece and your ear canal is required to achieve the best sound quality with the MEElectronics A161P. Please follow the instructions in the manual to make sure you get a proper seal. It may take several minutes to get the correct fit, but it will result in better sound and noise isolation.

Select and install the correct ear tips for your ears

This may require trying multiple sizes/types of ear tips. If you have larger ears, try the larger tips first, if you have smaller ears, try the smaller tips first. Because ear canals may not be symmetric, you may need to use different-sized ear tips in each ear. When changing ear tips, make sure they are installed securely before putting the earpiece in your ear.

Bi-flange Tips (installed): The bi-flange tips utilize two soft silicone flanges and will fit most ear sizes. This is a good ear tip to start with. If it is too big, you can go to a small triple flange or small single flange tip. If it is too small, please try the triple flange tips or large single flange ear tips.



Large Triple-Flange Tips: Providing a deep insertion, the large triple flange ear tips fit many large ears and offer the best seal. They are designed to be pushed all the way into the ear; however, if you experience discomfort at any time you should not push the tip in any further.



Small Triple-Flange Tips: These tips are included if the large triple flange tips are too big for you but you need a longer ear tip due to the shape of your ears.



Small, Medium, Large Standard Silicone Tips:

These tips are included to help ensure you will get a comfortable fit with a good seal. Many people report these tips work best for their ears.

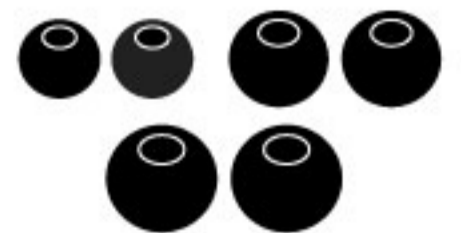

How to Wear: Installing Tips

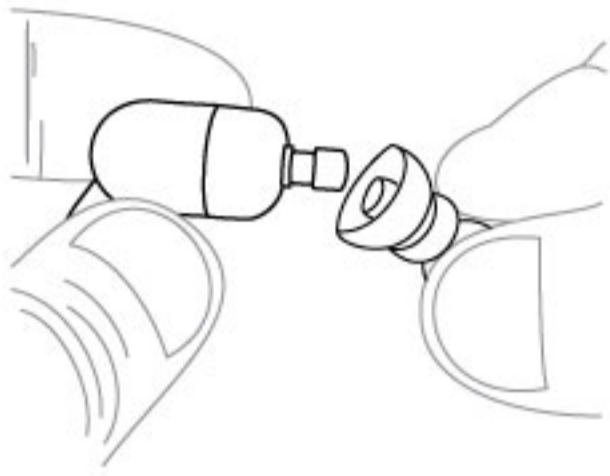

Hold the ear tip firmly in one hand and the earpiece in the other

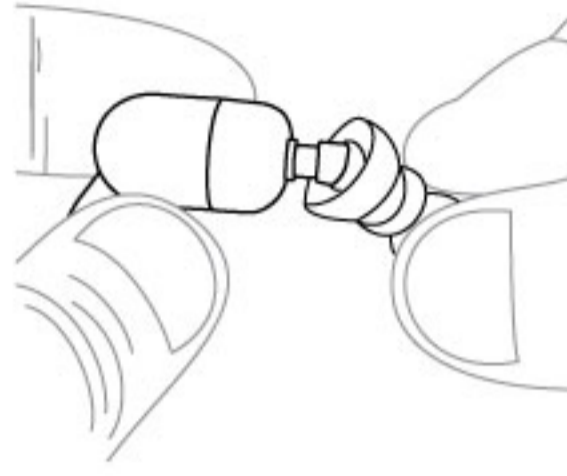

Put the tube of the ear tip on the nozzle of the ear piece as shown. Holding the ear tip at a slight angle will help with insertion.

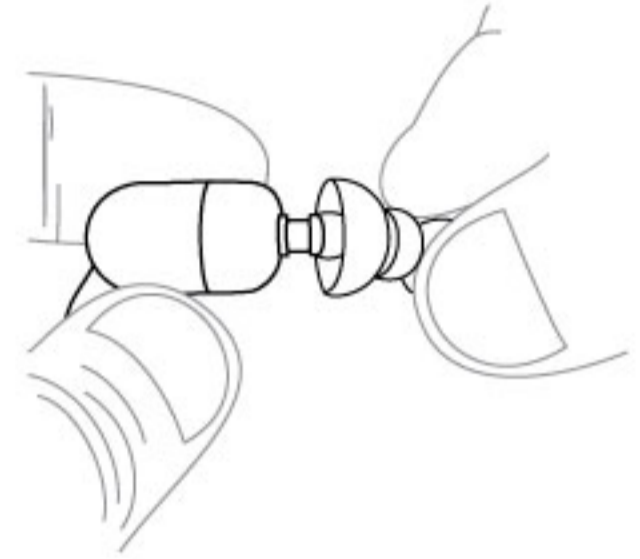

Push the ear tip all the way on the nozzle. Test to make sure the fit is secure by gently pulling on the tip; it should not come loose.

Caution: Always make sure ear tips are installed completely on the earphone nozzle to avoid an ear tip coming off in your ear. Frequent cleaning of the outer portion of the nozzle and the ear tips, including inside the stalk, will help keep them in place. Please see the 'Care and Storage' section for tips on cleaning your earphones and ear tips.

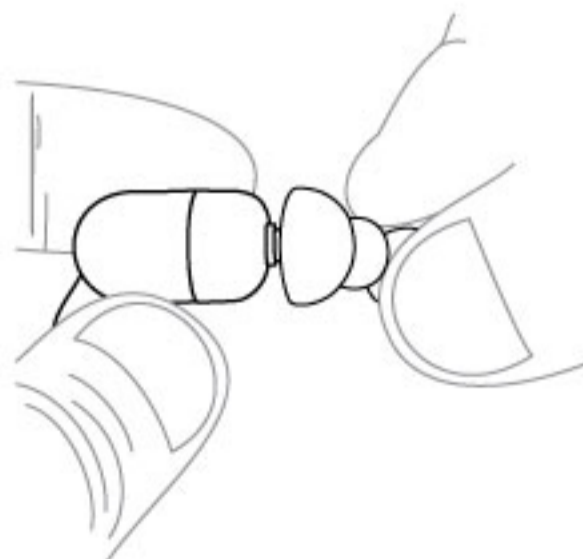

How to Wear: Inserting Earpiece

Insert the ear piece into your ear

The A161 uses a traditional straight insertion and has an angled nozzle for added comfort. It can be worn with the cable down or the cable over the ear. If you choose to wear the A161P with the cable over-the-ear please see page 6.

Each earphone is marked with a R for right and L for left. Channels are not swappable.



Move the earpiece around until the ear tip seals in your ear canal and the housing fits within your ear

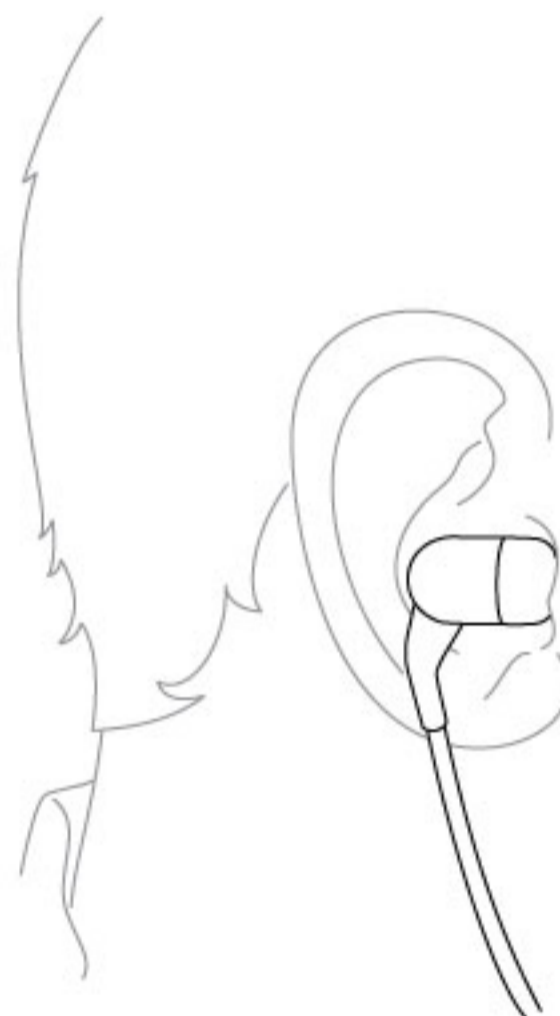

The earpiece should be flush in your ear and you should not be able to see the ear tip

Note: Pulling the upper part of your ear upwards and back while inserting your earphone may improve your ability to get a deep insertion at the proper angle. Moistening the ear tips prior to insertion may make insertion easier.

How to Wear: Using Cable Guides

Cable guides are included to keep the cable in place when the A161P is worn over-the-ear. If you are experiencing cable noise or having issues achieving a proper seal, wearing the A161P over-the-ear will help.

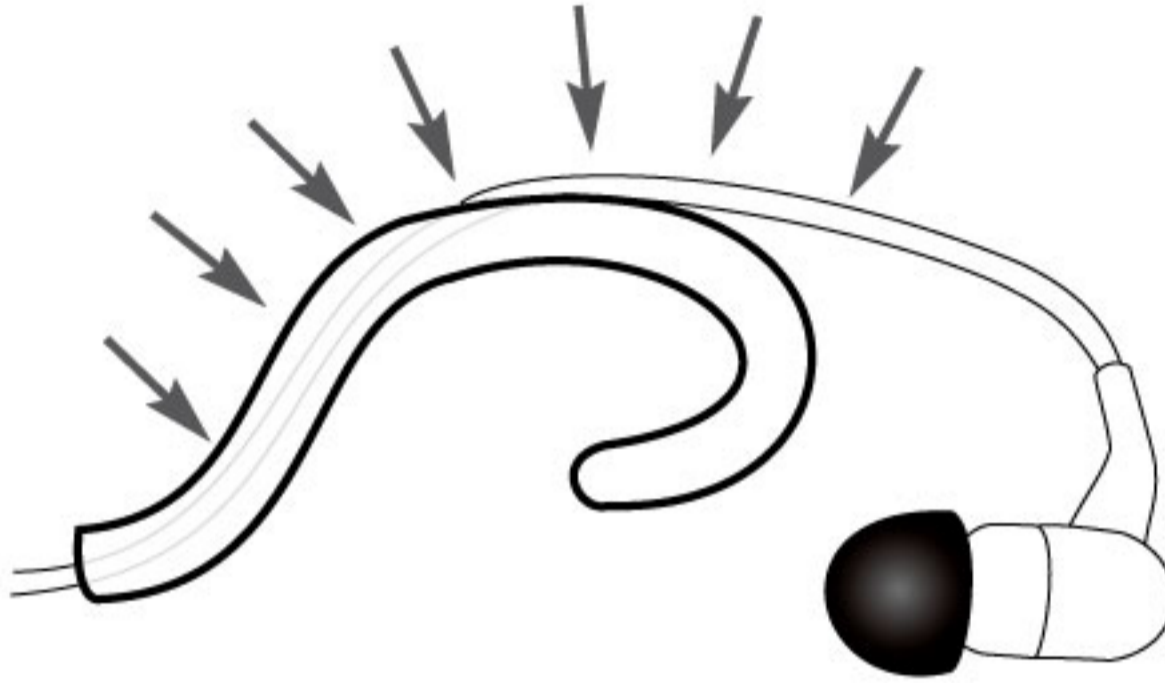

Push the cable into the slot in the cable guide



With the cable guide in place, loop the wire over and around your ear

The cable should hang down and you should have a secure fit

How to Wear: More Options

Tighten the cable cinch and use the shirt clip to control cable movement during activities.

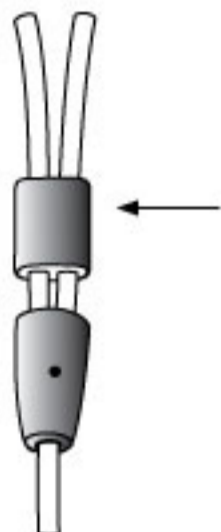

Slide the cable cinch up or down



Move the cable cinch to shorten cable after the Y split

The slider can effectively shorten the length of the cable after the Y split for use behind the back or to keep the earphones in place more securely.



Shirt clip holds cable in place



Over-the-ear with cable in front



Over-the-ear with cable in back

The cable comes with an attached shirt clip that can hold it where you want it and keep it from getting in the way during activities.

Included Adapters

TRRS Pin-Compatible Adapter for Nokia, Sony Ericsson, Samsung, and other Select Smartphones

What It Does: Reverses the microphone and ground pins, enabling your A161P to retain the mic/remote functionality with many Nokia, Sony Ericsson, and Samsung phones.

Note: Specific remote functionality varies by phone and software.



How to Use: If the audio output of your phone with the A161P is muffled, has echoes, or just sounds bad but improves when the microphone button is held down, add the adapter between the phone and A161P.

For a partial list of phones requiring an adapter, visit our website at www.meelec.com

Smartphone Headset to PC Adapter

What It Does: Separates the audio and microphone signals for use with a separate headphone jack and microphone jack found on most desktop and laptop PCs, enabling use of the A161P as a headset with your computer.



How to Use: Plug the connector of the A161P firmly into the jack of the Skype adapter. Plug the stereo connector of the adapter into the headphone port on your computer and the microphone connector into the microphone port.

Warning: Lower the volume of your computer before plugging in the earphones.

Earphone Removal

DO NOT REMOVE FROM YOUR EAR BY PULLING ON THE CABLE!

Gently wiggle the earphone before removal to break the seal. Pull the earpiece straight out of your ear and then unwrap the cable from over your ears, if necessary. Place the earphone in a safe place such as the included carrying case.

Use While Exercise

Using the included ear guides for over-the-ear use will secure the earphone in place for working out. Exposing the nozzle to sweat over the long term may degrade the sound quality and is not warrantable. Please do not use earphones when performing exercise that requires you to hear your surroundings, such as cycling or running outdoors.

Use While Traveling with Altitude Changes (Airplane/Car/Train/etc.)

During large, rapid changes in altitude you will experience pressure changes which will affect the way you hear your earphones. It is recommended that you break the seal when you feel increased pressure due to altitude changes to maintain the best sound quality.

Care and Storage

Removing the cable from your device:

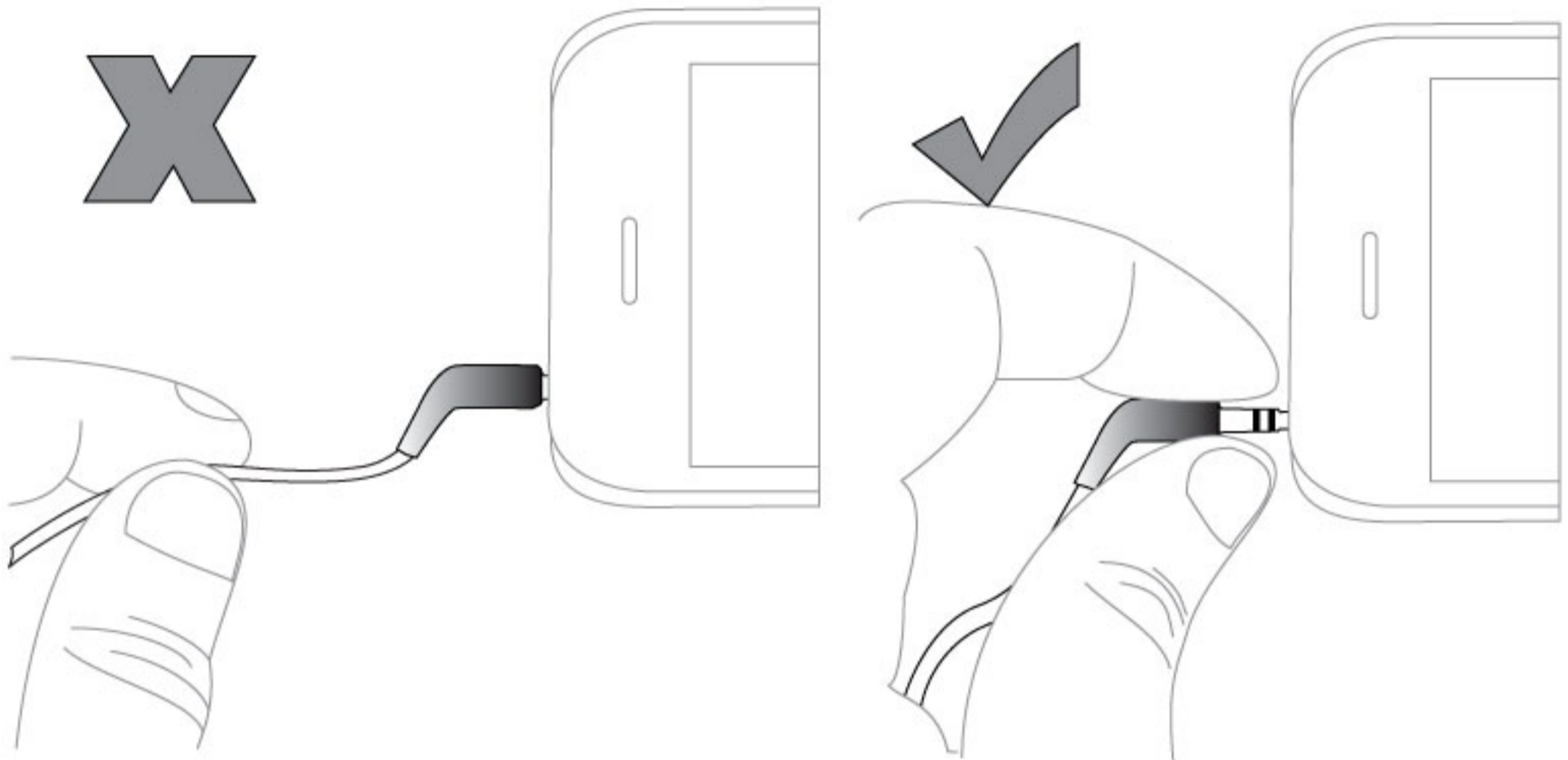

Do not pull on the cable, remove from the hard plastic of the 3.5mm plug

Use the included carrying case for storage to protect the A161P while not in use.

For best results, either wrap the cable around 3 fingers before placing in the carrying case, or just bunch the earphone cable up and put in the carrying case. The bunching method will result in less tangling after removing your earphone from the case.

Cleaning

Cleaning your MEElectronics products regularly is hygienic and will help keep the earphones looking their best. Please follow these steps when cleaning your MEElectronics earphones:

- Gently remove the ear tips from your earphone
- Take a cotton swab that is either dry or has a small amount of rubbing alcohol on it
- Swab around the nozzle of the earphone, but not the inside of the nozzle
- Swab the ear tip including the inside of the stalk
- Ear tips can also be submerged fully in rubbing alcohol or hydrogen peroxide
- Wait for the earphones and ear tips to dry completely
- Put the tips back on the earphone, making sure they are fitted securely

Warranty

The A161P is covered by a 1 year manufacturer warranty.

For issues with your product, contact customerservice@meelec.com.

For US warranty claims, contact support@meelec.com.

For international warranty claims contact your retailer.

Troubleshooting

Issue	Resolution
Lack of bass, the sound is quiet, thin, and/or tinny	<p>Fit and ear tips play a major role in how you hear your earphones. If the bass on your MEElectronics earphones is missing or seems weak, you have not achieved a good seal with your earphone. If the earphones sound quiet, you are more than likely not inserting them deep enough in your ears.</p> <p>If you are using the large triple flange tips, they can bend in your ear canal muffling the sound. Please check the 'First Use' section for instructions on achieving the best fit for you.</p> <p>Many other earphones/headphones have an extreme amount of enhanced bass and may make the accurate bass of the A161P sound lacking. Over time your perception of the bass response will change as you get used to the sound of the A161P.</p> <p>If the user manual does not resolve your issues, please contact customer service at customerservice@meelec.com for further assistance.</p>
Ear pieces won't stay in your ears	<p>Several things can cause the ear piece to come out of your ears including:</p> <ul style="list-style-type: none"> - Incorrect tip size for your ear canal. Try other sizes of ear tips. - The A161P is not inserted at the best angle for your ears. An over-the-ear wear style may achieve a better insertion angle. - The ear tips have a buildup of bodily fluids. Clean the ear tips as described in the Cleaning section.
Static	<p>Static crackling from the earphones, microphone, or both can be caused by static electricity due to electrical charge. This usually occurs during dry weather and with the use of heating or some air conditioning. If you are experiencing static crackling sounds, it is recommended that you relieve the static buildup or cease use of electronic devices. While damage from static electricity is not likely, it is possible.</p>



Troubleshooting Continued

Issue	Resolution
Sound Imbalance	<p>If the sound is louder in one ear than the other there are several possible reasons:</p> <ul style="list-style-type: none"> - The song or source is not balanced; try another song and/or source - There is pressure buildup in your ear; release it by pulling back on the earphone housing, pulling the upper part of your ear to release the pressure, or both. - Your ears require different sized ear tips; swap the channels and see if you still hear an imbalance on the same side (i.e. put the left channel in your right ear and the right channel in your left ear). - Your ear tip is not sealing properly; inspect the ear tip to make sure it is installed properly and for tears <p>If the problem persists, contact customer service at customerservice@meelec.com for further assistance.</p>
Static or Other Noise When Plug is Moved	<p>If the plug or inside of the jack is not clean you may hear static, clicking, or other noise when the plug is moved, or rarely even without any movement. Please clean the plug with a soft cloth or isopropyl alcohol. For information on cleaning the inside of the headphone jack, please consult your phone/media player manufacturer.</p>
The remote button is not working with your device	<p>Check the compatibility list at meelec.com to make sure the remote is compatible.</p>
The A161P sounds hollow unless the remote button is pressed.	<p>Your device is not pin compatible with the A161P. You may purchase a TRRS adapter at meelec.com to resolve the issue.</p>

A161P BALANCED ARMATURE REFERENCE IN-EAR HEADSET

Please read this manual in its entirety.
If you have any questions after reading the manual

please contact
MEElectronics customer service at
customerservice@meelec.com



MEElectronics and its logo are
registered trademarks of S2E, Inc.
All rights reserved.