

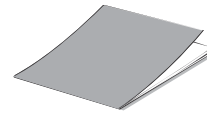

# Included

Please make sure that the following items are included.



Manual



Line-in Cable

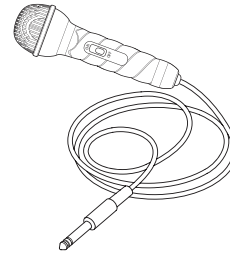

Microphone

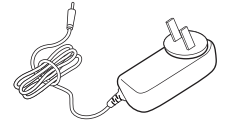

AC Adapter

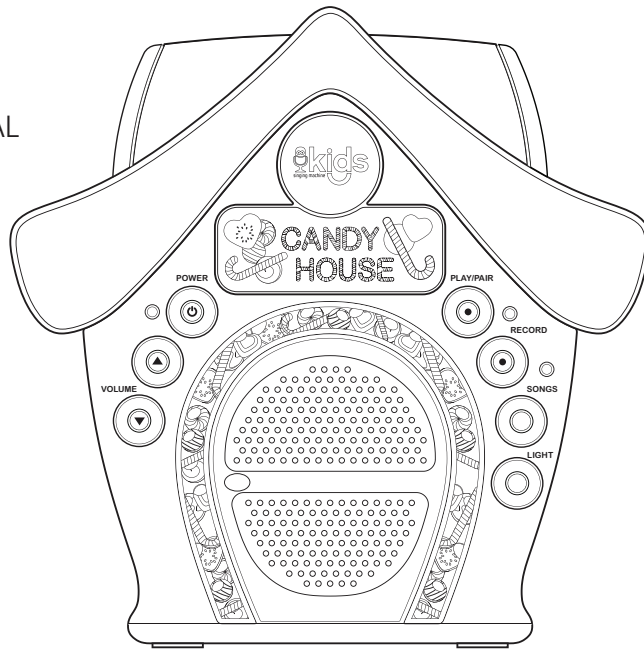

# SMK470

## INSTRUCTION MANUAL

The Singing Machine Company, Inc.  
4060 E Jurupa Street, Unit B  
Ontario, CA 91761-1413 USA

Copyright © 2017 All Rights Reserved.

PRINTED IN CHINA  
470-1701-ENG01

# www.singingsmachine.com/kids

The Singing Machine® is a registered trademark of The Singing Machine Co., Inc.

## Warnings

**CAUTION**  
RISK OF ELECTRIC SHOCK  
DO NOT OPEN

CAUTION: TO REDUCE THE RISK OF ELECTRIC SHOCK, DO NOT REMOVE COVER (OR BACK). NO USER-SERVICEABLE PARTS INSIDE. REFER SERVICING TO QUALIFIED SERVICE PERSONNEL. The Caution marking is located on the bottom panel.

**⚡ DANGEROUS VOLTAGE:** The lightning flash with arrowhead symbol within an equilateral triangle is intended to alert the user to the presence of uninsulated dangerous voltage within the product's enclosure that may be of sufficient magnitude to constitute a risk of electric shock to persons.

**⚠ ATTENTION:** The exclamation point within an equilateral triangle is intended to alert the user to the presence of important operating and maintenance (servicing) instructions in the literature accompanying this product.

**DRIPPING WARNING:** This product shall not be exposed to dripping or splashing, and no objects filled with liquids, such as vases, shall be placed on the product.

**VENTILATION WARNING:** The normal ventilation of the product shall not be impeded for intended use.

**SAFETY VERIFICATION:** This device is made and tested to meet safety standards of the FCC, requirements and compliance with safety performance of the U.S. Department of Health and Human Services and also with FDA Radiation Performance Standards 21 CFR Subchapter.

Class II equipment symbol. This symbol indicates that the unit has a double insulation system.

**WARNING: TO PREVENT FIRE OR SHOCK HAZARD, DO NOT EXPOSE THIS UNIT TO RAIN OR MOISTURE.**

**FCC WARNING:** This equipment may generate or use radio frequency energy. Changes or modifications to this equipment may cause harmful interference unless the modifications are expressly approved in the instruction manual. The user could lose the authority to operate this equipment if an unauthorized change or modification is made. This device complies with part 15 of the FCC Rules. Operation is subject to the following two conditions: (1) This device may not cause harmful interference, and (2) this device must accept any interference received, including interference that may cause undesired operation.

**NOTE:** This equipment has been tested and found to comply with the limits for a Class B digital device, pursuant to part 15 of the FCC Rules. These limits are designed to provide reasonable protection against harmful interference in a residential installation. This equipment generates, uses and can radiate radio frequency energy and, if not installed and used in accordance with the instructions, may cause harmful interference to radio communications. However, there is no guarantee that interference will not occur in a particular installation. If this equipment does cause harmful interference to radio or television reception, which can be determined by turning the equipment off and on, the user is encouraged to try to correct the interference by one or more of the following measures:

- Reorient or relocate the receiving antenna.
- Increase the separation between the equipment and receiver.
- Connect the equipment into an outlet on a circuit different from that to which the receiver is connected.
- Consult the dealer or an experienced radio/TV technician for help.
- The rating information is located at the bottom of the unit.

**INDUSTRY CANADA NOTICE:** This device complies with Industry Canada license-exempt RSS standard(s). Operation is subject to the following two conditions: 1. This device may not cause interference, and 2. This device must accept any interference, including interference that may cause undesired operation of the device.

CAN ICES-3(B)/NMB-3(B)



12. Use only with a cart, stand, tripod, bracket, or table specified by the manufacturer, or sold with the apparatus. When a cart is used, use caution when moving the cart/apparatus combination to avoid injury from tip-over.

13. Unplug this apparatus during lightning storms or when unused for long periods of time.

14. Refer all servicing to qualified service personnel. Servicing is required when the apparatus has been damaged in any way, such as power-supply cord or plug is damaged, liquid has been spilled or objects have fallen into the apparatus, the apparatus has been exposed to rain or moisture, does not operate normally, or has been dropped.

15. WARNING: To reduce the risk of fire or electric shock, do not expose this apparatus to rain or moisture. Do not place objects filled with water, such as a vase, on the apparatus.

16. The AC mains plug is used as the power disconnect device and it should remain readily accessible and operable during intended use. In order to completely disconnect the apparatus from power, the mains plug should be completely removed from the AC outlet socket.

17. CAUTION: To reduce the risk of fire or explosion, do not expose batteries to excessive heat such as sunshine, fire or other heat sources.

## Troubleshooting Guide

Should this unit exhibit a problem, check the following before seeking service:

### No Power

- Power is not on; press the **POWER** button to turn power on.
- Confirm that the batteries are installed correctly.

### No Sound – General

- Volume is set to minimum; raise volume by pressing **VOLUME ▲** button.
- If using an external audio device, raise the volume on the device.
- Check if the **LINE IN** jack is still connected by a cable.

### No sound from the microphone

- Make sure the microphone is firmly connected to the **Microphone jack**.
- Volume is set to minimum; raise volume by pressing **VOLUME ▲** button.

### Bluetooth reception failure

- Put the external BT device close to the unit.
- Pair the unit with the BT Device as the procedures stated in this manual.

## Specifications

### AUDIO

Output Power ..... 2 Watts (RMS)  
Output Impedance ..... 4 Ohms

### BLUETOOTH

Bluetooth Version ..... V4.1  
Working Distance ..... Up to 10 meters measured in open space

**LINE IN SECTION** ..... 3.5 mm Stereo line in jack  
**MICROPHONE SECTION** ..... 3.5mm Condensor Microphone

### POWER SECTION

Battery (main unit) ..... DC6V ("AA" cell 1.5V x 4pcs) (batteries not included)  
Battery (microphone) ..... DC3V ("AAA" cell 1.5V x 2pcs) (batteries not included)  
Power Adaptor ..... Input AC 100-240V ~ 50/60Hz  
..... Output DC 5V 0.6A (Positive Center)

**DIMENSIONS** ..... 9.5 X 3.7 X 9.6 inches/ 24.1 X 9.4 X 24.4cm  
**WEIGHT** ..... 3.1 lbs/1.4 kg

Specifications are subject to change without notice.

## Important Safety Information

1. Read these Instructions.
2. Keep these Instructions.
3. Heed all Warnings.
4. Follow all Instructions.
5. Do not use this apparatus near water.
6. Clean only with a dry cloth.
7. Do not block any of the ventilation openings. Install in accordance with the Manufacturer's instructions.
8. Do not install near any heat sources such as radiators, heat registers, stoves, or other apparatus (including amplifiers) that produce heat.
9. Do not defeat the safety purpose of the polarized or grounding-type plug. A polarized plug has two blades with one wider than the other. A grounding type plug has two blades and a third grounding prong. The wide blade or the third prong are provided for your safety. When the provided plug does not fit into your outlet, consult an electrician for replacement of the obsolete outlet.
10. Protect the power cord from being walked on or pinched particularly at plugs, convenience receptacles, and the point where they exit from the apparatus.
11. Only use attachments/accessories specified by the manufacturer.

# Making the Connections

## LINE IN CONNECTION

This unit is able to connect your favorite audio device (e.g. iPhone/Tablet/MP3 player, etc.). You can connect your device by using a provided cable (3.5mm audio cable). LINE IN function is automatically selected once the audio cable is plugged in.

### Warning

- To avoid excessive over amplified sound output, it is recommended that the volume control is initially adjusted to one third or less and then increase if required.

## POWER ADAPTOR OPERATION

Insert the DC plug of the power adaptor into the DC jack on the unit. Plug the other end into a standard AC outlet.

### CAUTION:

- The AC Adaptor has a polarized plug that fits into the wall outlet only one way. If the plug does not fit properly, turn it over and try again. Do not force it.

## BATTERY OPERATION

1. Switch off the Candy House unit and remove the AC power adaptor from the power socket.
2. Remove the battery compartment cover on the back of the main unit by using a Phillips-head screw driver.
3. Insert four (4) "AA" size alkaline batteries (not included) as indicated on the right diagram.
4. Replace the cover tightly before operating.

### CAUTION:

- Replace all batteries at the same time.
- Do not mix old batteries with new batteries.

## MICROPHONE CONNECTION

1. Remove the battery compartment cover on the body of the microphone by using a Phillips-head screwdriver.
2. Insert two (2) "AAA" size alkaline batteries (not included) as indicated on the right diagram.
3. Replace the cover tightly before operating.
4. Connect the microphone into the microphone jack.

### Notes:

- Do not drop or tap the microphone as damage to the microphone or speaker may occur.
- Do not twirl the microphone cord as it will cause damage to the encased wiring.

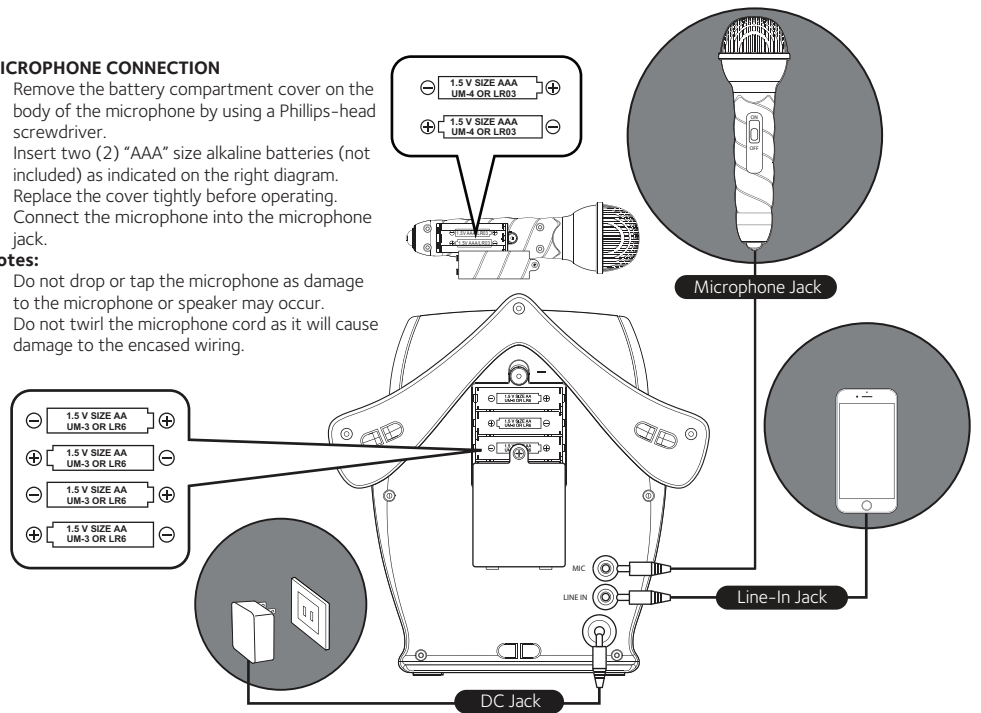

## BATTERY PRECAUTIONS

The precautions below should be followed when using batteries in this device:

1. Warning – Danger of explosion if battery is incorrectly replaced. Replace only with the same or equivalent type.
2. Use only the size and type of batteries specified.
3. Be sure to follow the correct polarity when installing the batteries as indicated in the battery compartment. A reversed battery may cause damage to the device.
4. Do not mix different types of batteries together (e.g. Alkaline, Rechargeable and Carbon-zinc) or old batteries with fresh ones.
5. If the device is not to be used for a long period of time, remove the batteries to prevent damage or injury from possible battery leakage.
6. Do not try to recharge a battery not intended to be recharged; it can overheat and rupture. (Follow battery manufacturer's directions.)
7. Remove batteries promptly if consumed.
8. Clean the battery contacts and also those of the device prior to battery installation.

## ENERGY SAVING (AUTO POWER SYSTEM-APS)

The unit will automatically enter the Standby mode after 15 minutes in the following situations:

1. No button being pressed for 15 minutes.
2. No playback from your audio device for 15 minutes. The playback of audio device had been stopped but the audio cable is still plugged into the LINE IN jack.
3. Not singing to the microphone for 15 minutes. The Power indicator will be turned off.

The unit can be resumed to turn on by pressing the Power button once. APS is for energy saving purposes.

# Operation

1. Connect the unit as described previously. Press the **POWER** button to turn the unit on; the power indicator will light on.

## USING A BLUETOOTH DEVICE

2. The Bluetooth pair indicator will blink rapidly to indicate it is in the pairing mode. You may also press and hold the **PLAY/PAIR** button to initiate the pairing mode.

Switch on the Bluetooth function of your Bluetooth compatible device within three feet of the unit. You will see "Candy House" appear on your device's search list. Select "Candy House" to start pairing. Wait for completion of the pairing and the Bluetooth indicator will light solid. Please always refer to the user manual of your bluetooth device for detailed instructions.

### Note:

If your Bluetooth device prompts you for a passcode during the pairing process, please enter "0000" to connect. If pairing fails, repeat steps. If you have paired before, a list of previously searched results will be displayed. Select "Candy House" again. On some Bluetooth devices (i.e., computers), once pairing is complete, you must select your Bluetooth device as "Use as Audio Device" or similar.

**PLAY/PAUSE:** Press the Play/Pause button on the Bluetooth device or on the unit to start.

## SING-ALONG WITH BUILT-IN SONGS

3. By pressing the **LIGHT** button to turn on the roof top light effect, press again to turn light effect off.

4. There are 3 built-in songs in this sing-along unit. Press **SONGS** button once to play the first song, press once more to play second song, press again to play the third song.

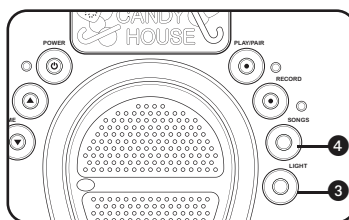
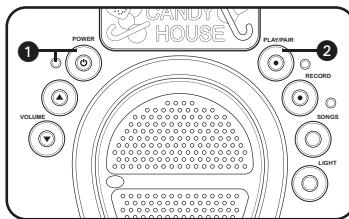

## SING-ALONG WITH LINE IN MUSIC

5. Connect the audio device to the **LINE IN** jack on the back of this unit. It will allow the audio to be played through your unit. LINE IN function is automatically selected once the audio cable is plugged in.

### Note:

- It is highly recommended to set the volume on the auxiliary unit to 1/3 or lower to avoid distortion.

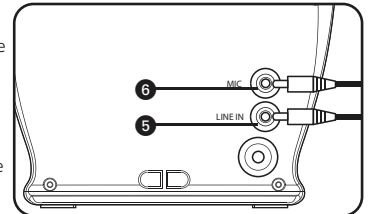

## SING-ALONG WITH MICROPHONE

6. Connect the microphone into the microphone jack at the back of the Candy House unit. Turn on the microphone by slide the ON/OFF switch to the ON position before singing, the microphone light will switch ON. You can also connect an extra microphone (not included) to another mic jack.

7. Adjust the volume to a comfortable level by pressing the button **VOLUME ▲** and **VOLUME ▼** button on the Candy House unit.

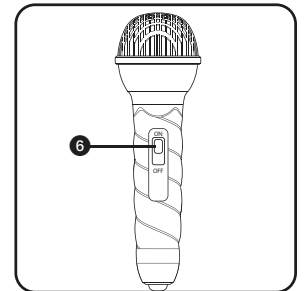

## RECORDING YOUR SINGING:

8. To record your singing as well as the music, press the **RECORD** button; recording will begin and the Record/Playback indicator will blink. When you want to finish the recording, press the **RECORD** button again. The Record/Playback indicator will stop blinking.

### Notes:

- There is up to 3 minutes and 40 seconds recording time.
- Please note that each time when the new recording is being recorded, the existing recording will be deleted.

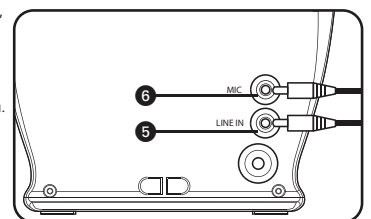

## PLAYBACK YOUR VOICE RECORDING:

9. To playback your voice recording, you can press the **PLAY/PAIR** button. The Record/Playback indicator will light on. Press the **PLAY/PAIR** button again to stop.