

# AC200MAX

## Portable Power Station

### User Manual V2.0

Please Read This Manual Before Use And Follow Its Guidance.  
Keep This Manual For Future Reference.



## AC200MAX

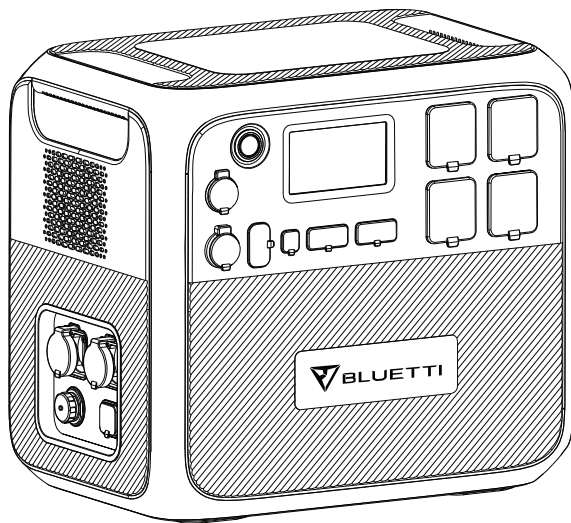

# Thank You!

Thank you for making BLUETTI a part of your family.

From the very beginning, BLUETTI has tried to stay true to a sustainable future through green energy storage solutions for both indoor and outdoor use while delivering an exceptional eco-friendly experience for our homes and our world. That's why BLUETTI makes its presence in 70+ countries and is trusted by millions of customers across the globe.



# CONTENTS

<b>1. Before You Begin</b> .....	05
<b>2. Safety Instructions</b> .....	06
2.1 General Safety.....	06
2.2 Maintenance.....	07
2.3 Handling & Storage.....	07
<b>3. What' s In The Box</b> .....	08
3.1 Standard Packaging.....	08
<b>4. Product Overview</b> .....	10
4.1 Diagram.....	10
4.2 Specifications.....	11
<b>5. Operation</b> .....	13
5.1 Powering On/Off.....	13
5.2 LCD Screen.....	14
5.3 Charging.....	16
5.4 Discharging.....	18
5.5 Capacity expansion.....	19
5.6 BLUETTI APP.....	20
<b>6. Appendix</b> .....	21
6.1 FAQs (Frequently Asked Questions).....	21
6.2 Technical Support.....	22



# 1. Before You Begin

The information contained herein is subject to change without notice.

For the latest version, please visit <https://www.bluettipower.com/pages/user-guides>

- The user manual contains instructions and notes on the operation and use of this unit.
- BLUETTI recommends that you use genuine accessories from BLUETTI whenever possible for your safety and for optimum compatibility.
- BLUETTI shall not be responsible for any damage or expense that might result from the use of parts other than genuine parts from the BLUETTI.
- For your safety and benefit, please read carefully before using and keep it handy for future reference.

## 2. Safety Instructions

### 2.1 General Safety

BLUETTI products are developed to be safe and reliable. Please read this guide for important safety information about your device. The guide is intended to help you be more comfortable and productive while using this device. Failure to follow these guidelines for proper setup, use, and care for your device may cause damage to this unit and injury to yourself or others.

#### SAVE THESE INSTRUCTIONS!

- Always operate or store the unit in accordance with specified temperature range.
- DO NOT expose the unit to fire, liquids, sweat, dirt or other contaminants, as these may cause the battery to explode or leak flammable liquid or gas.
- DO NOT place the unit on an unstable or tilted surface.
- Make sure the place where you are using the unit is well ventilated and spacious.
- DO NOT touch the unit, cord, plug or other electrical components with wet hands.
- Keep away from children and pets.
- DO NOT modify, attempt to insert foreign objects into the battery, or immerse or expose it to water or other liquids. Batteries may explode if damaged.
- Battery fluid is corrosive and may be toxic. If a battery leaks, keep the leaked fluid away from touching your skin, eyes, clothes, or other surfaces. Immediately flush the affected areas with water, and seek medical help.
- DO NOT ignore those warning indicators on components or products made by manufacturers.
- DO NOT dismantle, cut, crush, puncture, or otherwise damage the unit in any way.
- DO NOT insert foreign objects into the fan, vents, ports, or other openings.
- NEVER use a damaged battery or component. Improper use or misuse of damaged batteries or components may cause damage to your device or injury to yourself as a result of battery fluid leakage, fire, overheating, or explosion.
- Use approved battery and accessories ONLY. Improper use, or use of unapproved or incompatible batteries or components may result in a risk of fire, explosion, or other hazards, and may invalidate the unit' s official regional or regulatory approvals and your product warranty.

- Turn off the unit IMMEDIATELY in case of malfunction, and contact BLUETTI support if this manual cannot explain the malfunction adequately to you.
- Use ONLY a dry powder fire extinguisher in case of fire.
- DO NOT attempt to modify, replace the internal battery or any other components of the unit by anyone other than qualified personnel. If necessary, take it to an authorized service center as incorrect reassembly may result in a risk of fire or electric shock.

## SAVE THESE INSTRUCTIONS!

### 2.2 Maintenance

- When not using the unit for extended periods of time, power it off and remove all electrical connections.
- Charge the unit to 80% SOC every 3 months for best battery life.
- Clean the unit with a dry cloth gently and carefully.

### 2.3 Handling and Storage

- Use mechanical assistance as needed (e.g. trolleys and adjustable height workbenches).
- Keep the unit in a dry and cool place.
- DO NOT place the unit on its side or upside down.
- DO NOT stack anything on top of the unit either in storage or in use.
- Recommended storage temperature: 0°C-40°C/32°F-104°F.
- BLUETTI Power Stations are NOT permitted to be carried on board as checked or carry-on baggage.
- Dispose of the unit and related accessories in accordance with local laws, regulations and other provisions.

#### Travel Notice:

Do Not bring this product on flights. It is forbidden to carry lithium batteries and equipment with a capacity more than 160Wh on airplane due to the regulation.

# 3. What's In The Box

## 3.1 Standard Packaging

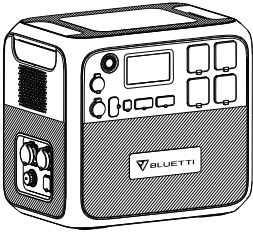

① AC200MAX Power Station

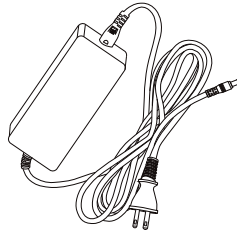

② AC Adapter



③ Solar Charging Cable



④ Car Charging Cable



⑤ Multifunctional DC Charging Cable

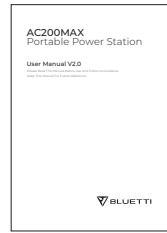

⑥ User Manual



⑦ Warranty Card



⑧ Certificate

Below accessories are not included in standard packaging and can be purchased separately at <https://www.bluettipower.com/>



⑨ 12V/30A RV Cable

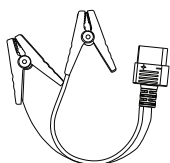

⑩ Lead-acid Battery Charging Cable



⑪ DC7909 F-XT90 Cable

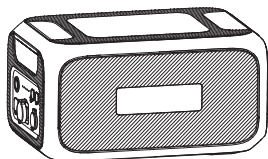

⑫ B230 Expansion Battery

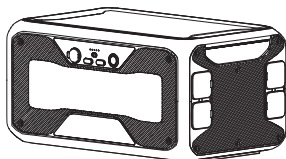

⑬ B300 Expansion Battery

\* **AC Adapter:** 70.9in/180cm (EU); 59.1in/150cm(UK).

**Solar Charging Cable:** 19.7in/50cm. MC4-XT90.

**Car Charging Cable:** 19.7in/50cm. Cigarette Lighter Port-XT90.

**Multifunctional DC Charging Cable:** 39.4in/100cm. XT90-Aviation.

**12V/30A RV Cable:** Aviation-XT60, 59.1in/150cm; XT60-SPC45, 19.7in/50cm.

**Lead-acid Battery Charging Cable:** 19.7in/50cm. XT90-Clamp.

**DC7909 F-XT90 Cable:** 5.5in/14cm.

**B230 Expansion Battery:** 2,048Wh, LiFePO<sub>4</sub> battery cells.

**B300 Expansion Battery:** 3,072Wh, LiFePO<sub>4</sub> battery cells

---

**Note:** All measurements are for reference only.

Package details are subject to change without prior notice.

## 4. Product Overview

### 4.1 Diagram

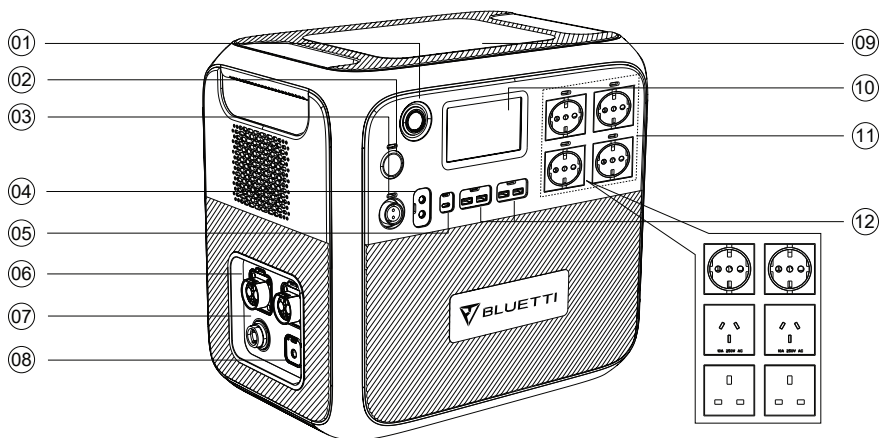

- ① Power Button
- ② Cigarette Lighter Port
- ③ 12V/30A RV Port
- ④ 12V/10A DC Port
- ⑤ USB-C 100W Port
- ⑥ Battery Extension port
- ⑦ PV/Car Input
- ⑧ Adapter Input
- ⑨ Wireless Charging Pad
- ⑩ LCD Screen
- ⑪ AC Output
- ⑫ USB-A Port

## 4.2 Specifications

AC200MAX		
General		
Battery Capacity	2048Wh/40Ah	
Cell Type	LiFePO <sub>4</sub>	
Dimensions (L*W*H)	16.5*11*15.2in/420*280*386mm	
Weight	61.9lbs/28.1kg	
Discharging Temperature	-4°F-104°F/-20°C-40°C	
Charging Temperature	32°F-104°F/0°C-40°C	
Storage Temperature	32°F-104°F/0°C-40°C	
Working Humidity	10%-90%	
AC Output		
Power	2200W	
Surge Power	4800W	
Voltage	220V-240VAC	
Frequency	50Hz-60Hz	
Overload	2200W-2750W, 2min	
	>2750W, 8 ~ 10s	
Short Circuit Protection	Yes	
Over Temperature Protection	Yes	
DC Output		
Cigarette Lighter Port *1	Voltage	12VDC
	Current	10A(Cigarette Lighter and DC5521 10A total)
	Overload	>145W, 2s
12V/30A RV Port *1	Voltage	12VDC
	Current	30A
	Overload	>400W, 2s
12V/10A DC5521 Port *2	Voltage	12VDC
	Current	10A (Cigarette Lighter and DC5521 10A total)
	Overload	>145W, 2s
USB-A *2	Voltage	5VDC
	Current	3A

USB-A QC3.0 *2	Power	18W Max.
	Voltage	5V-12VDC
	Current	3A
USB-C PD3.0 *1	Power	100W Max. (5/9/12/15/20VDC, 3A; 20VDC, 5A)
Wireless Charging *2	Power	5/7.5/10/15W
<b>Adapter Input</b>		
Power	400W Max.	
Voltage	100V-240VDC	
Current	7A Max.	
<b>PV Input</b>		
Power	900W Max.	
Voltage	10V-145VDC	
Current	15A Max.	
<b>Car Charging</b>		
Voltage	11.5V-14.5VDC/23V-29VDC	
Current	8A Max.	

**Note:** When connected with solar panels, AC200MAX turns on automatically whenever there is sunlight. AC200MAX supports pass-through charging but doesn't support UPS function. When the battery level drops to 5%, charge AC200MAX to extend the battery lifespan.



## 5. Operation

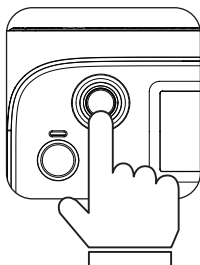

### 5.1 Powering On/Off

**Start up:** Press the power button and hold for 3 seconds to start up this unit.

**AC/DC Output:** Tap the 'AC ON/OFF' or 'DC ON/OFF' on the screen to enable and disable.

**Shut down:** Press the power button to shutdown this unit. The LCD screen will shut down after several seconds.

**Note:** Please turn on the DC power to enable wireless charging.

## 5.2 LCD Screen

### Homepage

This section displays the charge/discharge status and navigates to detailed product information.

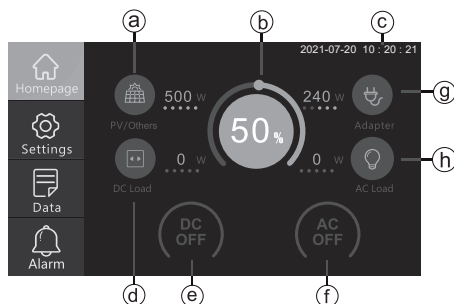

a: PV/Car Input

b: Battery Capacity

c: Date/Time

d: DC Load

e: DC ON/OFF

f: AC ON/OFF

g: Adapter Input

h: AC Load

### Settings

This section provides general setting configurations, including AC output, DC input, ECO Mode\*, language, buzzer, and system date/time.

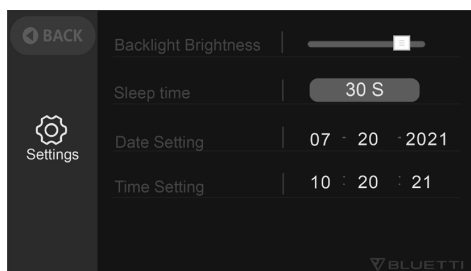
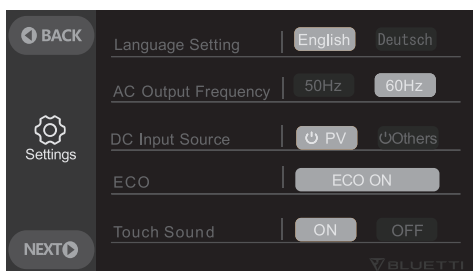

**Note:** Check all settings before first use.

Voltage and frequency for reference: EU: 230V/50Hz UK: 230V/50Hz

## Data

This section provides all basic information including product, inverter and charger, BMS maintenance, and fault history.

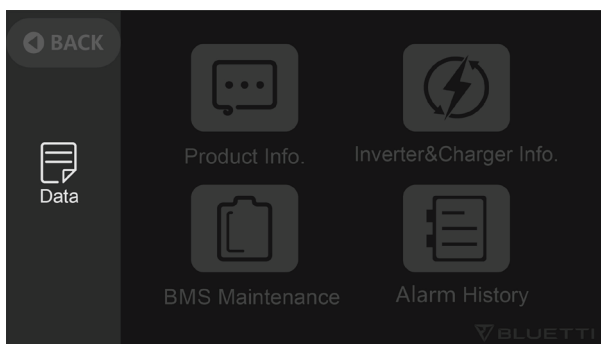

**Note:** 'Inverter&Charger Info.' indicates the output and input status of this unit;  
'BMS Maintenance' indicates the connection status of battery pack(s);  
'Alarm History' records all the error codes. When the error occurs, its indicator will turn orange.

\* When in ECO mode, the AC output will automatically turn off after 4-hour low ( $\leq 50W$ ) or no load to save power.

## 5.3 Charging

### Adapter Charging

Plug the AC200MAX into a standard wall outlet, and press the power button to start charging.

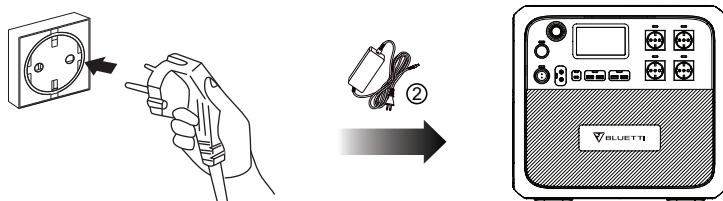

### PV Charging

Connect the solar panels (in series or parallel) to AC200MAX via the multifunctional DC charging cable and solar charging cable.

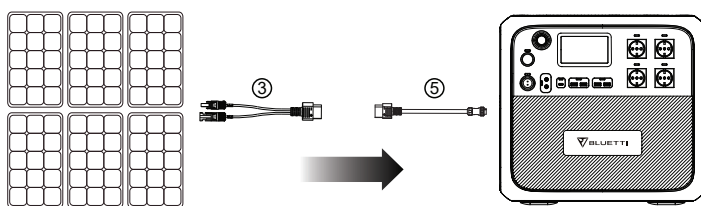

**Note:** Please make sure your solar panels comply with:

Voc\*: 10-145V    Current : 15A Max.    Power: 900W Max.

**E.g.** Connect two BLUETTI PV350 solar panels in series to the PV/Car input port.

BLUETTI PV350: Voc=46.5V    Current=9.2A Max.

Total: Voc=46.5×2=93 V    Current=9.2A Max.<15A    It is OK!

AC200MAX supports up to 900W solar input. In other words, if you' re using solar panels with a total power of 1000W to charge AC200MAX, the extra 100W will not be needed for charging but squander away directly.

\* Voc: Open circuit voltage. The maximum voltage that the solar panel can produce with no load on it.

## Car Charging

Connect AC200MAX to the vehicle plug-in cigarette lighter port via multifunctional DC charging cable and car charging cable.

**Note:** Set the 'Others' as DC input source to enable car charging.

The vehicle cigarette lighter port at least can support 8A.

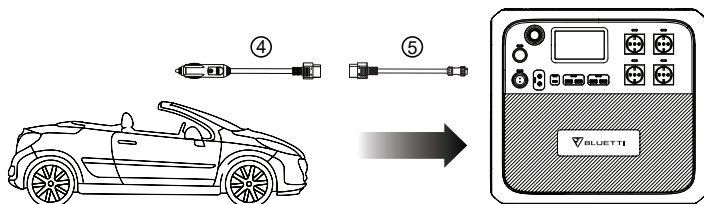

## Generator Charging

Connect AC200MAX to the generator's AC outlet via AC adapter, and press the power button to start charging.

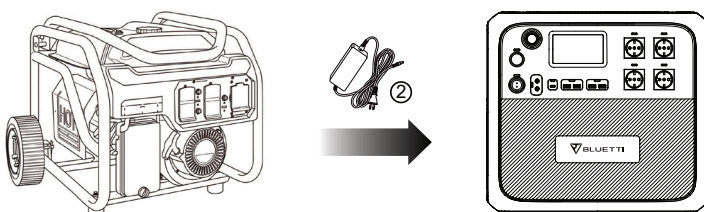

## 12V/24V Lead-acid Battery Charging

Connect AC200MAX to the battery via multifunctional DC charging cable and lead-acid battery charging cable\*. Clamp the positive connector (red) to the positive battery terminal and negative (black) to the other.

**Note:** Set the 'Others' as DC input source to enable lead-acid battery charging.

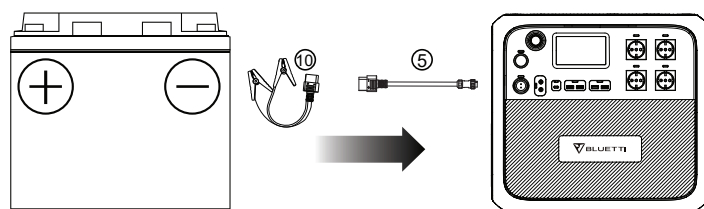

## 5.4 Discharging

Smartphone 175-200Times 10W	LED Light 75-85hrs 20W	Television 20-22hrs 75W
Power Tools 19-20hrs 80W	Refrigerator 17-19hrs 90W	Slow Cooker 8-9hrs 200W

$2000\text{Wh} \times \text{DoD} \times \eta \div (\text{load power}) = \text{charging time (estimated)}$

Note: DoD refers to the Depth of Discharge,  $\eta$  is the local inverter efficiency. DoD=90%,  $\eta=90\%$ .

DoD may vary depending on ambient-operating temperature and discharge rate.

Load power and charging time are measured in Watt and Hour.

\* The lead-acid charging cable is for recharging AC200MAX ONLY. Please contact BLUETTI customer service for details and get it directly from [http://www.amazon.de/dp/B09X33TGHK?ref=myi\\_title\\_dp](http://www.amazon.de/dp/B09X33TGHK?ref=myi_title_dp)

## 5.5 Capacity expansion

With the P090D battery expansion cable, AC200MAX supports up to 2 B230 or B300 expansion batteries for a total capacity of 6,144Wh and 8,192Wh, respectively.

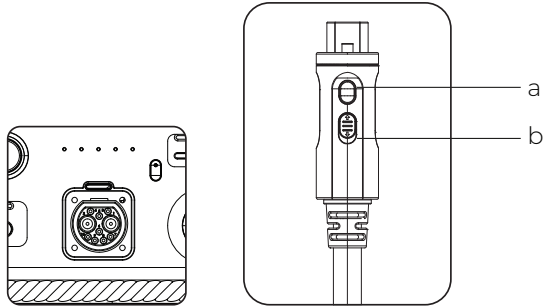

(P090D Battery Expansion Cable)

a: Enable/disable the battery expansion function.

b: Press to lock/unlock.

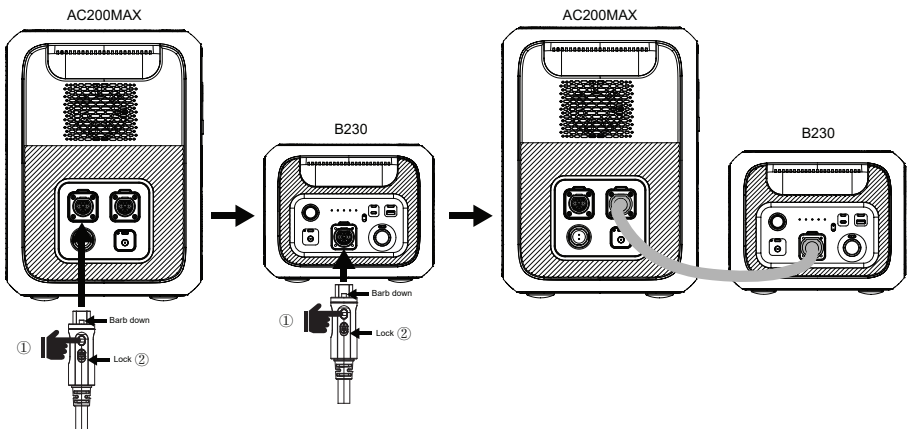

## 5.6 BLUETTI APP

Download the app from App Store or Google Play and follow the BLUETTI APP INSTRUCTIONS to better control and monitor the AC200MAX.





## 6. Appendix

### 6.1 FAQs (Frequently Asked Questions)

**Q: How do I know whether my devices will work well with this product?**

A: Please evaluate the total constant load of your appliances. If it doesn't exceed the Max. output power of AC200MAX, you can use this power station.

**Q: Can I use third-party solar panels to charge this product?**

A: Yes, you can. Please make sure your solar panels have an open circuit voltage of 10V-145V and MC4 connectors. Do not mix different types of solar panels.

**Q: What does the Depth of Discharge (DoD) refer to?**

A: DoD indicates the fraction of power that can be withdrawn from the battery. The BLUETTI AC200MAX sets the DoD to 90%, which means that 90% of the capacity is available to power your device, while the reserved is used to protect the battery from over-discharging.

**Q: Can it charge and discharge at the same time?**

A: Yes, but it has no UPS feature.

**Q: How to disable the touch screen sound?**

A: Sorry, it cannot be turned off.

**Q: Can it run my refrigerator, window air conditioner or power drill?**

A: Yes, but they typically require a startup power which is 5-7 times than the rated power, easily overloading AC200MAX.

**Q: Can two AC200MAX be paired for higher output voltage, power and capacity?**

A: No.

**Q: Can the AC200MAX be connected to the home circuit breaker box?**

A: No.

**Q: Why does the screen display 0 watt output when I plug in a small load, like a 35W LED lamp?**

A: The current is too small to be measured accurately when connected to low loads.

**Q: Why only one fan is running ?**

A: There are intelligent control program in the unit ,when total output power is between 1000W-1500W, only one fan is running , when it exceeds 1500W , both fans are running.

## **6.2 Technical Support**

Should you require any further assistance, please do not hesitate to contact BLUETTI service team.

# For more information, please visit:



@ BLUETTI Support  
@ BLUETTI Official



@ bluetti\_inc



@ bluetti.inc



@ bluetti\_us



sale-eu@bluettipower.com  
sale-uk@bluettipower.com



After-sales address in EU: Lise-Meitner-Strasse 14, 28816 Stuhr, Germany

After-sales address in UK: Unit 2 Northgate, Bolsover Busines Park, Woodhouse Line,  
Chesterfield England S44 6BD

**EU REP**

Company: POWEROAK GmbH  
Address: Lindwurmstr. 114, 80337 München Germany  
Mail: logi@bluetti.de

**UK REP**

Company: POWEROAK ENERGY UK CO.,LTD  
Address: Unit 2, NorthGate, Bolsover Business Park,  
Woodhouse Lane Chesterfield England S44 6BD  
Mail: poweroak.eu@bluetti.com