

**BEFORE YOU BEGIN:** Measure the size of the banner to be installed. Then add the height of the banner to 14.5' (or whatever the city or municipality requires as height over a street or traffic area). This will be the height of the top banner bracket shoe.

Example: 8' banner + 14.5' clearance = 22.5' (The height of the top banner bracket shoe and pole).



1. Secure the top bracket shoe to the light pole with temporary tape to hold the shoe in place, and install the bands through the slots in the sides of the shoe. Tighten bands securely and remove the tape. Any adjustable banding should be tucked back into the bracket shoe.



2. Install the rod assembly over the shoe and tighten all four hex bolts. Only tighten hex bolts finger tight plus a quarter turn. Hex bolts that are over-tightened may break and are not covered under warranty. The rod assembly should be secured in the middle of the shoe to allow for the most flexibility if adjustments are necessary.

Note: For correct installation, it is important that the cantilever on the top pole points in an upward direction with the arrows on the label of the pole pointing down.



## WINDBREAKER BRACKET SYSTEM

### WINDBREAKER BRACKET SYSTEM

The WindBreaker Bracket System has been engineered for exterior installations in all types of weather. The banner system features an aluminum housing with an adjustable fiberglass arm cantilevered to keep the banner tight. The flexible arm spills the wind pressure from the pole and banner to prolong the life of your banner program.

#### Parts Included in each set:

- 2 Banner Bracket Shoes
- 2 Banner Bracket Pole Assemblies
- 4 Adjustable Band Clamps
- 8 – 1/4" x 1" Machined Hex Bolts
- 2 pieces of solid core wire.

#### Additional materials and tools needed:

- Tape measure
- 5/16" nut driver for adjustable bands
- Tape (electrical tape works best)
- 7/16" wrench
- Nut driver or socket to tighten hex bolts

#### WARRANTY

Wind Breaker Banner Brackets are guaranteed for six (6) years against defects in material and workmanship when installed according to our installation instructions. Please note - any banner programs up over 30 days must use "Bandit-It" stainless steel banding (Model #206) and the banding must wrap around the pole twice (x2) before clamping the buckles to qualify for warranty. After three (3) years we prorate our warranty by 50% from the date of delivery. Also, as noted in your instructions, inspect your banner installation 30 days after initial installation and every 60 days thereafter making any appropriate adjustments. Please verify with your light pole manufacturer or a structural engineer to insure that the light pole is suitable for a banner bracket and a banner application.

# INSTRUCTIONS

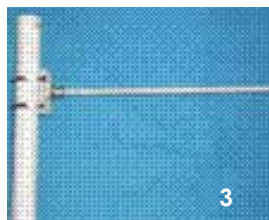

3. Slide the banner over the top rod and tie the wire through the banner grommet and through the slots in the banner bracket shoe.



4. Install the bottom bracket shoe. Pull the banner down tight and mark the light pole at the very bottom of the banner. This will be where the center of the bottom bracket shoe is installed. Secure it to the pole with tape to hold the shoe in place while installing the bands through the slots in the side of the shoe. Tighten the bands securely and remove the temporary tape. Any extra banding should again be tucked back into the bracket shoe.



5. Insert the lower rod assembly into the banner sleeve. It is important to have the cantilever of the rod pointing down and the arrows on the rod assembly pointing up (opposite of the top rod assembly). Insert the lower rod assembly over the bracket shoe and pull down on it until the inside edge of the banner is tight. Very important: it is not necessary to use force (hammers, etc.) to slide the lower rod assembly down the shoe. No special tools are required. Each bottom rod assembly can be "rocked" into position. "Rock" the rod assembly on the shoe by pushing up and down on the end of the fiberglass arm and at the same time pressing the metal sleeve (at the base of the rod) downward. Do this until the banner is tight. Do not leave the banner loose to billow in the wind. It must be tight all the way across the banner with only a mild flap along the outside edge. If the banner wrinkles from stretching, it is too tight.



6. Tighten down the four hex bolts. The rod assembly will remain in position for you while you tighten them. Excessive force (hammering, etc.) will damage the rod assembly and void the Dekra-Lite warranty. Tie the wire through the banner grommet and the side slots on the bracket shoe to complete the installation. To remove the banner, simply remove the tie wires, loosen the hex bolts and remove the pole assembly. The bracket shoes should stay in place.



## WindBreaker Maintenance:

When properly installed, WindBreaker banner brackets are almost completely maintenance free. It is recommended that you visually inspect the installation of all banners after any type of adverse weather. During normal weather conditions, it is recommended that a new installation be visually inspected approximately 30 days after initial installation to insure that banner brackets are tight, and every 60 days to 90 days thereafter. If any banding has come loose replace it and inspect all poles immediately to insure that the banding is installed properly.

# WINDBREAKER BRACKET SYSTEM

## Band-It® Banding

For installation of "Band-It" Banding, you will also need the following: Band-It Banding tool, hammer, tin snips, buckles.

Note: When installing with "Band-It" Banding, each band must wrap through each slot and around the pole twice (x2) on both top and bottom shoe.



1. Begin installation with the top bracket shoe. Secure it to the light pole with temporary tape to hold the shoe in place.



2. Band may be used from bulk roll as this completely eliminates waste of band. Slide buckle on band as shown, bringing end of band around objects to be clamped and again through buckle.

NOTE: The tension screw thread on your banding tool should be lubricated regularly.



3. Continue band around objects once more and again through buckle. Double banding develops a great deal more radial compression than single banding. Bend end of band under buckle.

NOTE: Double banding is required for Dekra-Lite Warranty.



4. Place band in open of tool nose and gripper block. Move into slot as far as possible, to avoid buckles sliding into tool nose. To tighten banding securely, apply tension by turning handle of tool.

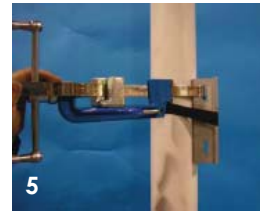

5. Once secure or tightened, roll tool over buckle, backing off with tension handle throughout entire rolling operations. Failure to back off with tension handle throughout entire course of rollover may result in breaking of band. There is no loss of tension as band release is used up in the bend.

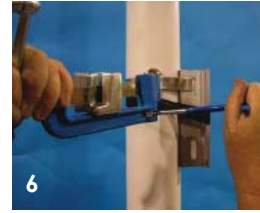

6. Pull cutting handle to cut the band. When applying 3/4" giant clamps, prior to cutting off clamp, release band gripper and push tool nose away from buckle approximately 1/4".



7. Lock down stubs by hammering down buckle ears, completing BAND-IT clamp. Two bands per shoe are required.



# WINDBREAKER BRACKET SYSTEM