

# BULB Lamp small / medium

## ABOUT

The BULB family are four hand blown glass lamps inspired by the simplicity of the pure geometric shapes: cone, cylinder, sphere and hemisphere. It can be used alone for a functional statement or in sets to create a warmer ambient. The BULB lamps are available in two different sizes and five different coloured fabric wires.

## INSTALLATION INSTRUCTIONS

We advise that the fixture should be installed by a qualified electrician to ensure proper wiring and installation. Save this manual for future reference.

## WARNING

To reduce any risk of injury, turn OFF the main power before installing the light fixture or making any electrical connection.

Assembly and repairs may only be carried out by a qualified electrician.

All liability for defects or damages caused by improper luminaire mounting; use of light source not indicated; incorrect feeding and external agents shall be rejected.

## WHAT DOES THIS BOX CONTAIN?

Inside this box you will find the handblown glass lamp, the fabric cable and the LED source to be connected.

It's not included the screws necessary to attach the mounting plate to the ceiling. Evaluate the compatibility of the plugs and fixing screws with the mounting surface.

### BULB small lamp

#### TECHNICAL SPECIFICATIONS

Type: G9  
Power Rating: 3,8 W  
Tension: 220-240V~/50-60Hz  
Colour Temperature: 2700K  
Light Output: 380 lumens  
Light Maintenance (L70): 15.000 h  
Energy Efficiency: A++

#### DIMENSIONAL CHARACTERISTICS

Light source recommended: Duralamp

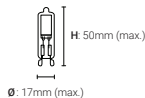

### BULB medium lamp

#### TECHNICAL SPECIFICATIONS

Type: G9  
Power Rating: 7 W  
Tension: 220-240V~/50-60Hz  
Colour Temperature: 2700K  
Light Output: 650 lumens  
Light Maintenance (L70): 15.000 h  
Energy Efficiency: A+

#### DIMENSIONAL CHARACTERISTICS

Light source recommended: Duralamp

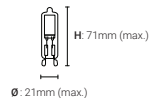

## CLEANING INSTRUCTIONS

Unplug the lamp from the outlet before performing any cleaning operation. Make sure the switch is off.

**Power cable:** To clean the power cable you should use a soft cloth slightly dampened with water – no detergents or abrasive agents.

**BULB lamp:** To recover the original whiteness, it should be cleaned with a soft damp sponge in lukewarm water with a mild detergent.

## LEGAL WARRANTY

3 years

Contact **MOR Design** in case of malfunction

**MOR Design** declares that all of its products are manufactured in accordance with the Policies 2014/35/EU, for Low-voltage Equipment and 2011/65/EU-RoHS2 + (EU) 2015/863, on restrictions of the use of certain hazardous substances in electrical and electronic equipment.

The symbol of the rubbish bin with the prohibition sign indicates that this item should be separated from domestic waste. It should be handed in for recycling in accordance with local environmental regulations for waste disposal. By separating a marked item from household waste, you are helping to reduce the volume of waste sent to incinerators or landfills, thereby minimizing the potential negative impact on public health and the environment.



# 1. ELECTRICAL CONNECTION AND CEILING POSITIONING

**1.** Loosen the screws from the *ceiling cover* and remove the *mounting plate* from the inside.

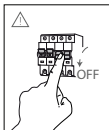
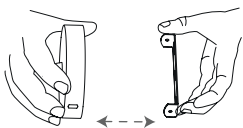
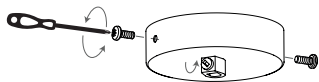

**2.** Mark the position of the holes on the ceiling and do the necessary drillings.

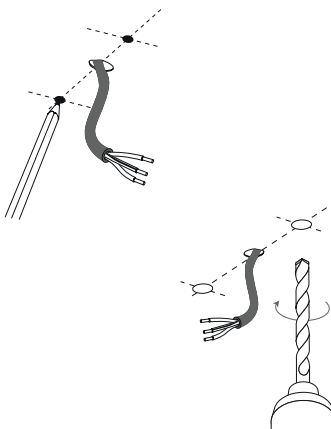

**3.** Run the electric cable through the middle hole of the *mounting plate*. Fix it on the ceiling (screws not included).

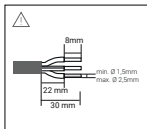
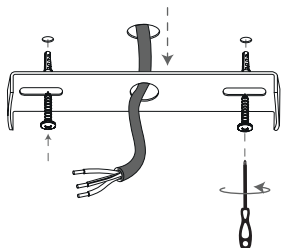

**4.** Make some tests with the lamp in order to make sure the length cable intended. Note that it is necessary to cut the cable, leaving around 5cm extra to make the connection.

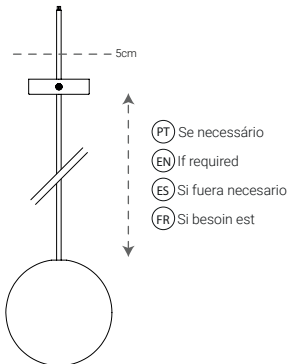

- 5.** Cut the cable, leaving around 5 cm to make the electrical connection.

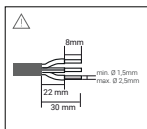
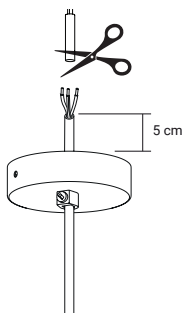

- 6.** Make the electrical connection.

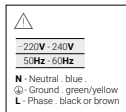
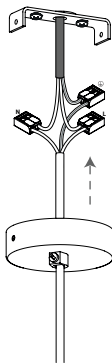

~220V - 240V

50Hz - 60Hz

N - Neutral, blue

⓪ - Ground, green/yellow

L - Phase, black or brown

- 7.** Bring up the *ceiling cover* and fix it with the provided screws.

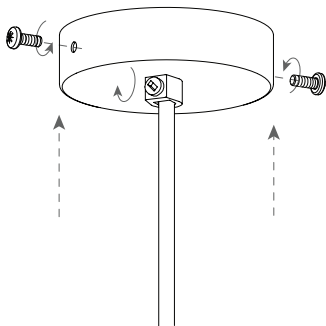

## 2. PLACEMENT OF THE LED BULB INSIDE THE LAMP

**8.** Hold the cable and bring up the *rubber cap*.

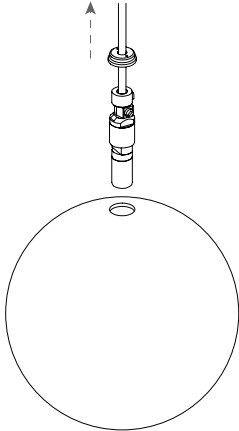

**9.** Put the LED module inside the lamp.

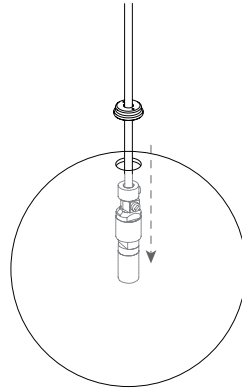

**10.** Squeeze the *rubber cap* and put it inside the glass lamp.

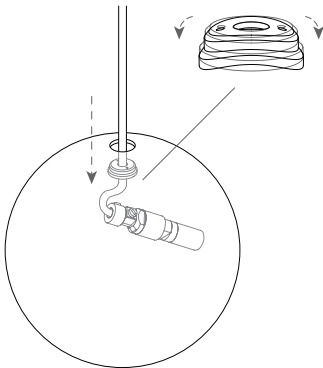

**11.** Pull up the cable until the *rubber cap* is well fixed to the hole in the lamp.

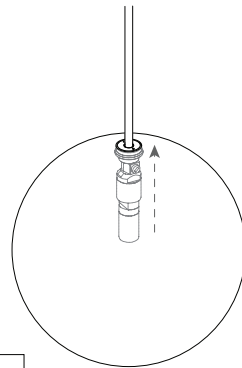

### 3. MAINTENANCE | REPLACEMENT OF THE LED LAMP

**12.** Pull the cable up so that the *rubber cap* stays fix on the glass. Then, pull the cable down.

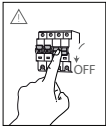
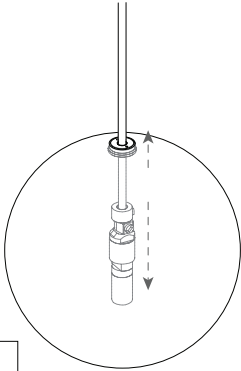

**13.** Use a flat head screwdriver as a lever and remove the *rubber cap* from inside the glass.

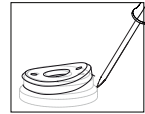
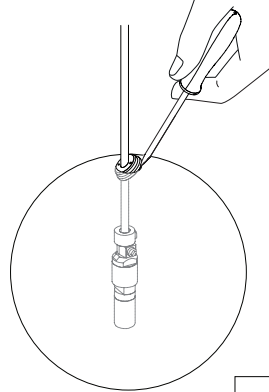

**14.** Bring the *rubber cap* out of the glass.

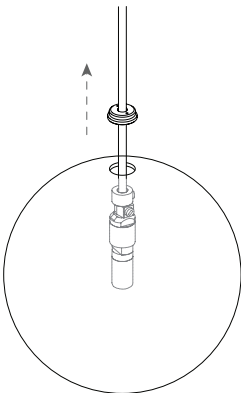

**15.** Pull out the LED lamp and change for the new one.

