

Radio Overview

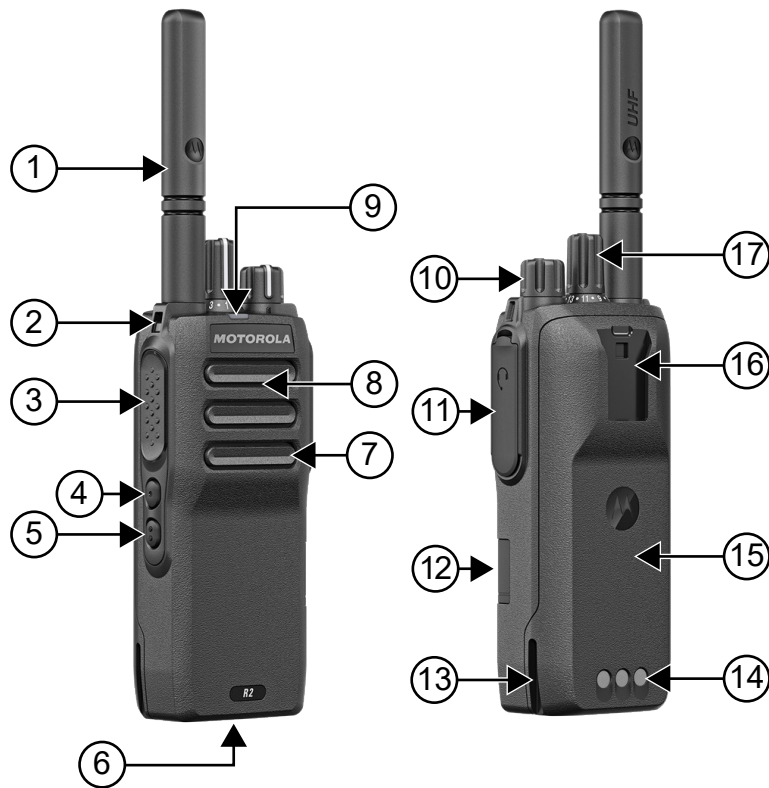

Table 4: Radio Overview

Label	Name	Description
1	Antenna	Provides the needed RF amplification when transmitting or receiving.
2	Lanyard Hole	Allows you to attach lanyard to your radio.
3	Push-to-Talk (PTT) button	Allows you to execute voice operations (for example, Group Call and Private Call).
4	1-Dot Programmable Feature button	Programmable button of an assignable radio function.
5	2-Dot Programmable Feature button	Programmable button of an assignable radio function.
6	Battery Latch (at the bottom of the radio)	Locks and unlocks the battery.
7	Microphone	Allows your voice to be sent when PTT or voice operations are activated.

Label	Name	Description
8	Speaker	Outputs all tones and audio that are generated by the radio.
9	LED Indicator	Provides operating status.
10	On/Off/Volume knob	Allows you to turn the radio on or off and adjust volume.
11	Audio Jack with Dust Cover	Allows you to connect audio accessories to your radio.
12	Micro USB with Dust Cover	Allows you to connect programming cable USB to your radio.
13	Charging Rail	Provides guidance for the placement during charging.
14	Charging Contacts	Charging point for the battery.
15	Battery	Provides power source to your radio.
16	Belt Clip Slot	Allows you to attach belt clip.
17	Channel Selector Knob	Allows you to select channel.

Programmable Buttons

You can program the programmable buttons as shortcuts to the following radio functions through programming software.



NOTE: Contact your dealer for more information.

Table 5: Assignable Radio Functions

Function	Description
AF Suppressor	Allows you to suppress howling in the received audio when detected.
All Alert Tones	Allows you to toggle all tones and alerts to on or off.
Analog Scrambling	Allows you to toggle the Analog Scrambling feature to on or off.
Analog Scrambling Code	Allows you to toggle the Analog Scrambling Code feature to on or off.
Channel Announcement	Allows you to play zone and channel announcement voice messages in the current channel.
Emergency Off	Allows you to terminate an outgoing emergency call.
Emergency On	Allows you to set up an emergency call.
Flexible Rx List	Allows you to enable or disable a dynamic Rx list. Provides user the flexibility to add or remove talkgroup members.
Home Channel Reminder Silence	Mutes the Home Channel Reminder.
Home Channel Reset	Sets a new home channel.
Manual Site Search	Allows you to start the manual site search.

Function	Description
Mic AGC	Allows you to toggle the internal microphone automatic gain control (AGC) to on or off.
Monitor	Allows you to monitor a channel.
Mute Mode	Allows you to turn Mute Mode on or off.
Nuisance Delete	Allows you to temporarily remove an unwanted channel from the scan list, except the Selected Channel. The nuisance deleted channel will be restored into the scan list, for instance, when radio is powered off and back on again (not applicable in Capacity Plus).
One Touch Access	Allows you to direct access to the predefined call features.
Permanent Monitor	Allows you to monitor a selected channel for all radio traffic until function is disabled (not applicable in Capacity Plus).
Power Level	Allows you to toggle the transmit power to high or low.
Privacy	Allows you to toggle the privacy to on or off.
Repeater/Talkaround	Allows you to toggle between using a repeater and directly communicating with another radio.
Ring Alert Type	Allows you to direct access the Ring Alert Type setting.
Scan	Allows you to toggle the scan to on or off.
Site Lock	Allows you to enable the site lock to search only in current site or disable the site lock to search in other sites as well.
Tight/Normal Squelch	Allows you to toggle between tight or normal squelch (applicable to Analog mode only).
TX Interrupt Remote Dekey	Allows you to stop an on-going voice call by dekeying the transmitting radio or terminate the repeater call hang time in order to free up the channel. This button can also be used to end a Remote Monitor session.
Trill Enhancement	Allows you to toggle the trill enhancement to on or off.
Unassigned	Indicates that the button function has not yet assigned.
Voice Announcement	Allows you to toggle the voice announcement to on or off.
Voice Operating Transmission (VOX)	Allows you to toggle the VOX to on or off.
Zone Toggle	Allows you to switch between 4 zones.

LED Indications

The LED Indicator shows the operational status of your radio.

A qualified technician can permanently disable the LED indication by preprogramming it.

Table 6: LED Indications

Indication	Status
Blinking Red	<ul style="list-style-type: none"> The radio has failed the self-test upon powering up.

Indication	Status
Solid Yellow	<ul style="list-style-type: none"> The radio is transmitting in low battery state. The radio has moved out of range if Auto-Range Transponder System is configured.
Blinking Yellow	<ul style="list-style-type: none"> The radio is monitoring a conventional channel. Indicates fair battery capacity when the programmed Battery Indicator button is pressed.
Double Blinking Yellow	<ul style="list-style-type: none"> The radio has yet to respond to a Call Alert. The radio has Flexible Receive List enabled.
Solid Green	<ul style="list-style-type: none"> The radio is actively searching for a new site. The radio has yet to respond to a Group Call Alert. The radio is locked.
Blinking Green	<ul style="list-style-type: none"> The radio is powering up. The radio is transmitting. Indicates full battery capacity when the programmed Battery Indicator button is pressed.
Double Blinking Green	<ul style="list-style-type: none"> The radio is receiving a call or data. The radio is detecting activity over the air.
	The radio is receiving a privacy-enabled call or data.

Getting Started

Charging the Battery

Your radio is powered by a Lithium-Ion (Li-Ion) battery.

Prerequisites: Turn off your radio when charging.

Procedure:

- Charge your battery only in non-hazardous areas. After battery is charged, allow your radio to rest for at least 3 minutes.
- To comply with warranty terms and avoid damage, charge the battery using a Motorola Solutions authorized charger.
- Charge a new battery 14 to 16 hours before initial use for best performance.
Batteries charge best at room temperature.

Attaching or Detaching the Battery

Attaching the Battery

Procedure:

- 1 Align the battery with the rails on the back of the radio.
- 2 Press the battery firmly, and slide upwards until the latch snaps into place.
- 3 Slide battery latch into lock position.

Detaching the Battery

Prerequisites: Ensure that your radio is turned off.

Procedure:

- 1 Move the battery latch into the unlock position.
- 2 Press and hold the battery latch downwards fully.
- 3 Hold and slide the battery down and off the rails.

Attaching or Detaching the Antenna

Attaching the Antenna

Procedure:

- 1 Set the antenna in the receptacle.
- 2 Turn the antenna clockwise.

Detaching the Antenna

Procedure:

- 1 Turn the antenna counterclockwise.
- 2 Remove the antenna from the receptacle.

Unfastening the Audio Jack Dust Cover

Procedure:

- 1 Pull out and rotate the audio jack dust cover counterclockwise.

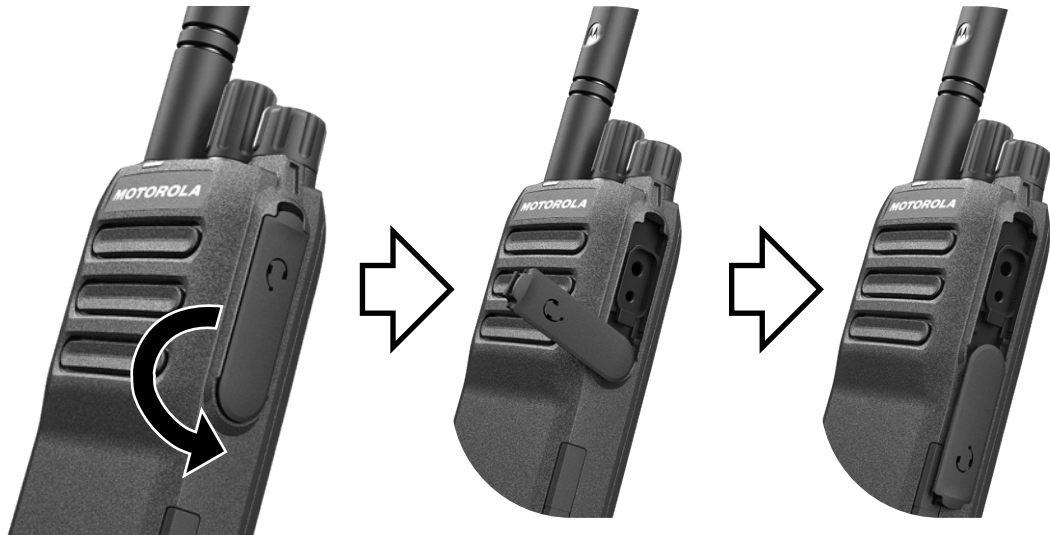

NOTE: You can connect your audio jack accessory to the radio through the Audio Jack connector.

Turning the Radio On or Off

Turning the Radio On

Procedure:

Turn the **On/Off/Volume** knob clockwise until a click sounds.

If your radio is turned on, your radio shows the following indications:

- A tone sounds.



NOTE: If the Tones/Alerts function is disabled, no tone sounds.

- The green LED illuminates.



NOTE: If your radio fails to turn on although your battery is charged and properly attached, contact your dealer for more information.

Turning the Radio Off

Procedure:

Turn the **On/Off/Volume** knob counterclockwise until a click sounds.

Adjusting the Volume

Procedure:

- 1 Perform one of the following actions:
 - To increase the volume, turn the **On/Off/Volume** knob clockwise.
 - To decrease the volume, turn the **On/Off/Volume** knob counterclockwise.



NOTE:

Your radio can be programmed to have a minimum volume offset where the volume level cannot be lowered past the programmed minimum volume.

Using the Belt Clip

Attaching the Belt Clip

Procedure:

- 1 Align the grooves on the clip with the grooves on the battery.
- 2 Slide the belt clip downward until you hear a click sound.

Removing the Belt Clip

Procedure:

- 1 Lift up the release latch to unlock the belt clip.
- 2 Slide the clip upward to remove the belt clip.

Using the Carry Case

Inserting the Radio into the Carry Case

Procedure:

- 1 Unsnap the front button of the carry case strap.
- 2 Insert the radio into your carry case downward with the speaker facing out.
- 3 Snap the front button of the carry case strap.

Removing the Radio from the Carry Case

Procedure:

- 1 Unsnap the front button of the carry case strap.
- 2 Slide the radio upward and away from the carry case.