

NOTICE
The regulations of the people's Republic of China on radio administration stipulates that units and individuals that set up and use radio transmitting equipment within the territory of the people's Republic of China must go to the corresponding radio administration institution to apply for the establishment of a station and obtain a radio station license before they can use it.

To the user:
Thank you for choosing our FM walkie-talkie wireless interphone. This walkie-talkie has novel design, reasonable and beautiful process structure and stable performance, it is designed to meet the needs of users for walkie-talkies with convenient operation and excellent performance. In order to make you fully understand the performance of this machine, please read this manual carefully before use.

Check the contents of the package.....	01
Installing / removing the battery.....	03
Installing / removing the antenna.....	04
Seat charging.....	05
Line charging.....	06
Familiar with this machine.....	07-08
Key introduction.....	09
Interface icon description.....	10
Menu navigation.....	11-13
Basic operation.....	14-15
Technical indicators.....	16
Warranty card.....	17

The use of this wireless interphone must comply with the laws and regulations of the local government. Improper use will violate the law, and will be subject to sanctions, and even imprisonment.
The maintenance and adjustment of this walkie-talkie is only authorized to the maintenance personnel with contract authorization. To avoid problems caused by electromagnetic interference or electromagnetic compatibility, please turn off the walkie-talkie in places with the sign of "please turn off the walkie-talkie", such as hospitals and other health care and medical places. When taking the plane, please turn off the interphone when the crew requires it to be turned off.
In the car with airbag, do not put the interphone in the area that may be involved in airbag deployment.
Please turn off the interphone before entering the flammable and explosive environment.
Don't keep firing for too long. The walkie-talkie may overheat and burn people, or even damage the walkie-talkie.
Do not use interphone with damaged antenna. The damaged antenna may cause slight burn if it contacts the skin.
If you wear a portable walkie-talkie on your body, please make sure that the antenna is at least 5cm away from your body when the walkie-talkie is transmitting.
If you find any peculiar smell or smoke on the interphone, please turn off the power immediately and contact the nearest authorized dealer.

Parts	Numbers
Walkie-talkie	1
Antenna	1
Lithium battery pack	1
Charger	1
Hang rope	1
Instruction Manual	1
Clip	1

Note: For more information about optional accessories, please contact the dealer

Product inspection
Install or remove the battery string.
1. Align the battery with the bayonet and put it into the host, as shown in Figure 2. Fasten the screws on the battery clockwise, as shown in Figure 3.
Note: If the battery needs to be removed, loosen the screw counterclockwise to remove the battery, as shown in Figure 4 and 5.

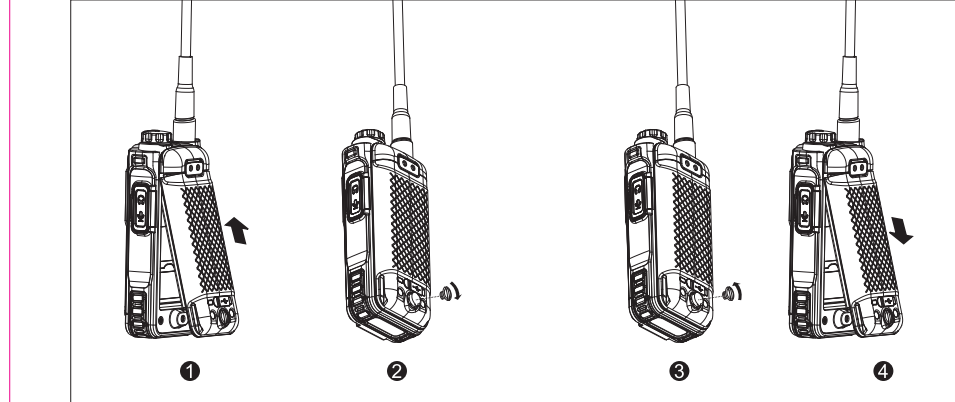

Install/remove the antenna
Hold the bottom of the antenna and screw it clockwise into the antenna seat at the top of the intercom until screwed tight. (see Figure 3).
To remove the antenna, turn counter clockwise to remove the antenna. (see Figure 4).



Before using the prepared
Charger Charging Procedure for charging
Please use our designated charger to charge the battery. The indicator light of the charger can show the charging status.
The charging indicator shows the charging status of the box.
Indicator light Charging status
Steady green Standby (no load)
Steady red Is charging
Steady green The battery

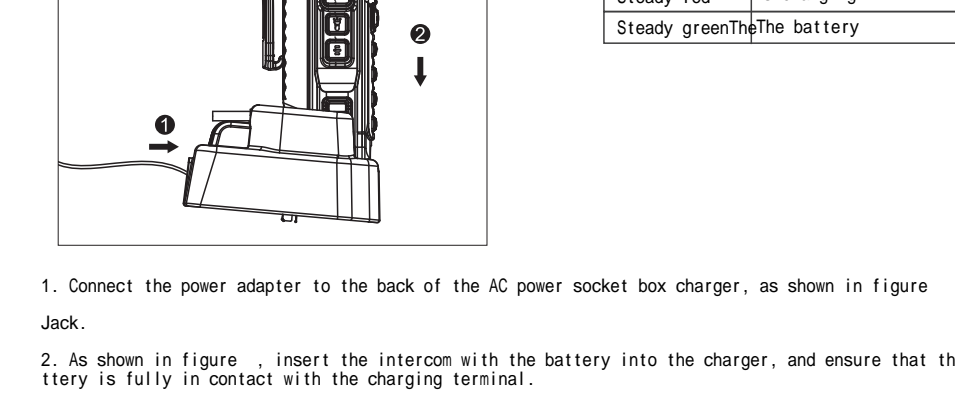

Line charge
Charging Procedure
Please use our designated charging line to charge the battery. The indicator light of the charger can show the charging status.
The charging indicator shows the charging status of the box.
Indicator light Charging status
Steady green Standby (no load)
Steady red Is charging
Steady green The battery

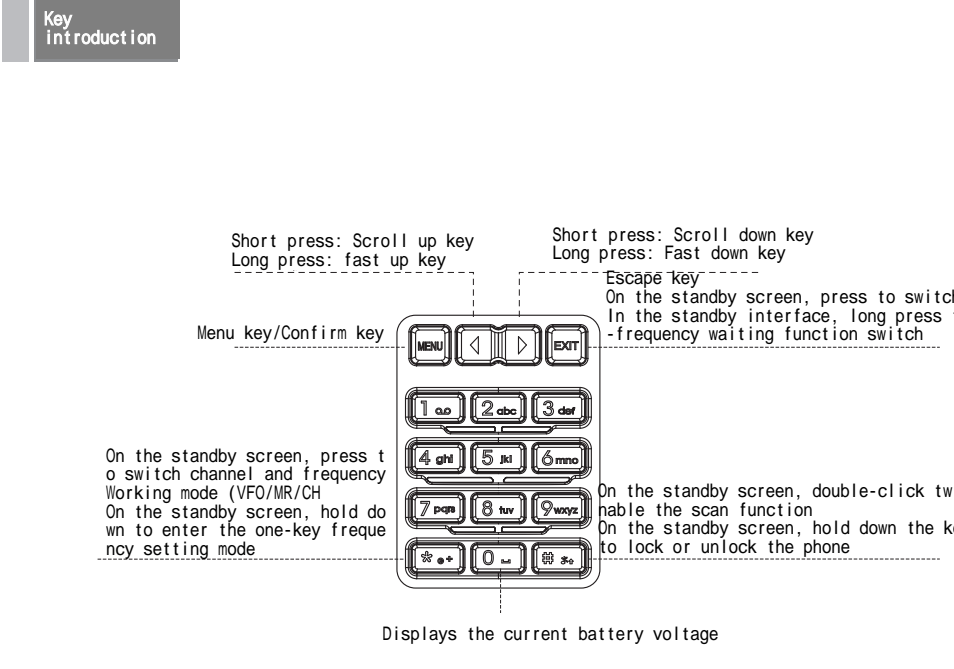
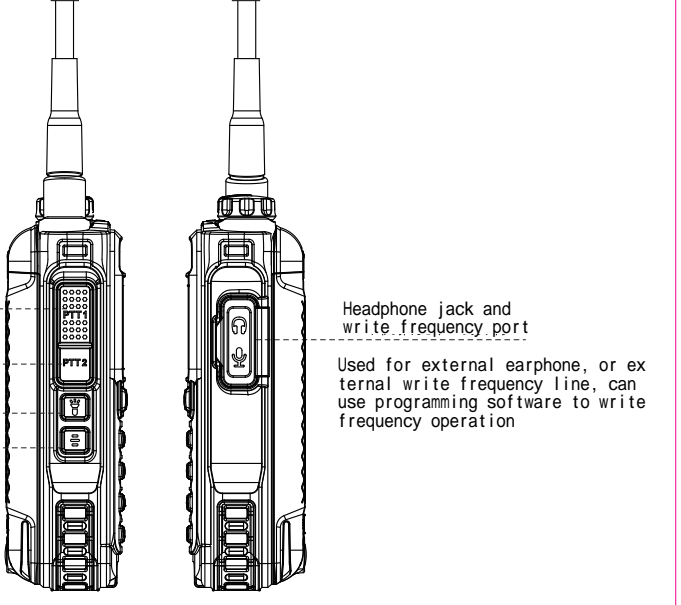
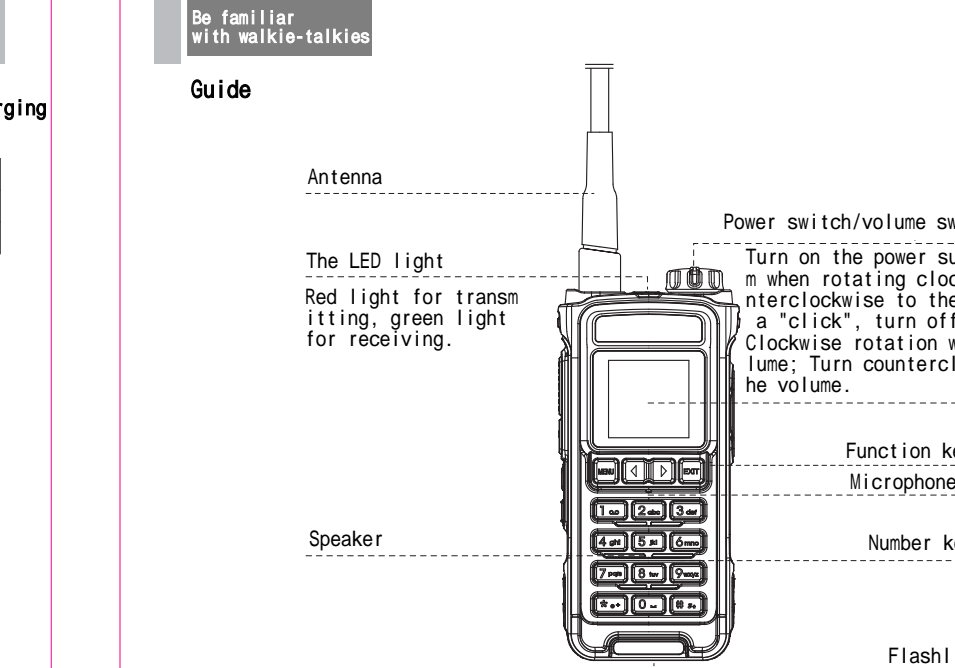
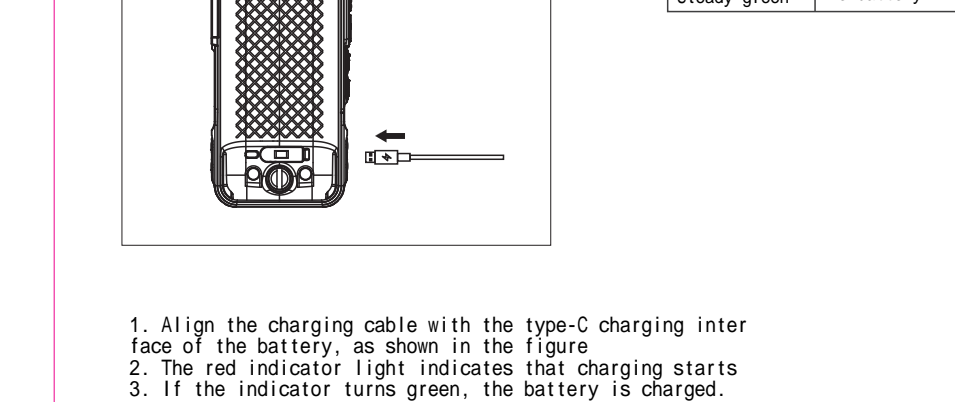

Icon	Instructions
L	The current transmitted power is low
H	The current transmitted power is high power
M	The current transmitted power is medium power
CT	This symbol indicates that the current subtone is an analog subtone
DCS	This symbol indicates that the current subtone is an analog subtone
Channel	Indicates that the dual-band waiting function has been set and activated at the same time. The dual-band waiting function can wait at the frequency points of the two bands display on the screen at the same time. The 'short' appears when the keypoint is 'release', and can be removed by holding down the key, or double-click a second time.
PTT	It means that the voice control (transmitting) function is started. When the sound pressure level is low, the microphone enables the dual-band, the transmitter is started.
N	This symbol appears when the channel operates in narrowband mode. When the transmitting battery power, then the battery is about to run out, the battery power 'low' battery is displayed. The battery only displays the outer frame, A/B segment pointer, indicating the current operating frequency point.

Level-1 menu	Level-2 menu	Level-3 menu	Menu Functions
1. Intercom Settings	1. Noise level	OFF, Level 1-9	Noise level
	2. Transmission power	High power, Medium power, Low power	High power: Transmission power; Medium power: Subtone; Low power: Subtone
	3. Channel Broadcast	Broadcast	Channel bandwidth is 25K
	4. In case of busy send off	Turn on	Channel is occupied also allowed to launch
	5. Launch time out	OFF	Channel is occupied also prohibited to launch
	6. Scrubler	Turn on	Channel is occupied also prohibited to launch
2. Voice control Settings	1. Power saving mode	OFF	Power saving mode
	2. Dual-frequency waiting	OFF	Dual-frequency waiting
	3. Voice prompt	OFF	Voice prompt

Level-1 menu	Level-2 menu	Level-3 menu	Menu Functions
3. Advanced Settings	4. Automatic backlight	Normally on	Backlight normally on
	5. Prompt	OFF	No analog subtone is activated
	6. Channel name display	Turn on	Enables the operation prompt tone
	7. Menu exit time	5s, 10s, 15s, 20s	Time when the menu automatically exits
	8. Automatic lock function	OFF	Turn off automatic keyboard lock
	9. Language Select	Chinese	Display Chinese
	10. Radio monitor	Turn on	Radio monitoring function
4. Sub-audio Setting	1. Receive analog subtones	67.0Hz...254.1Hz	Receive analog subtones
	2. Transmitting analog subtone	67.0Hz...254.1Hz	Transmitting analog subtone

Level-1 menu	Level-2 menu	Level-3 menu	Menu Functions
4. Sub-Display Settings	3. Receive digital sub-tone	DCS2N...D754H	Digital subtone mark sequence
	4. Transmitting digital subtone	DCS2N...D754H	Digital subtone flag sequence
5. Frequency mode (displayed in frequency mode)	1. Step frequency	None	In frequency mode, change the step value of frequency when pressing the Up/Down key
	2. Frequency difference	Add frequency	In frequency mode, the transmitting frequency and the receiving frequency difference
	3. Reducing the frequency	Reducing the frequency	In frequency mode, the transmitting frequency and the receiving frequency difference
	4. Frequency difference	Frequency difference	In frequency mode, the transmitting frequency and the receiving frequency difference

Startup and shutdown
If need to turn on, please turn clockwise (power switch/volume) knob until "click" sound; if need to turn off, turn counterclockwise until "click" sound.
Turn (power switch/volume) knob clockwise to increase volume, counterclockwise to decrease volume.
Frequency/channel mode switching
Press the keyboard [F2] to switch frequency/channel mode.
Double frequency waiting
In the standby interface (the keyboard is not locked), press key [F2] to switch to segment A/B.
In the standby interface, long press and hold the * key to enter the one-key frequency. With the red light flashing, another has been entered when the display interface. Subtone display digital and complete and the indicator light is not flashing indicating the code breaking success. You can directly intercom, press the menu key can directly save the current channel. If you want to break again to press reset. To break the next channel, press the up/down key to enter the breaking function again (step by step).
Scan function
On the standby screen (the keyboard is unlocked), hold down key [F2] to lock the keyboard, hold down key A again to open the keyboard.
On the standby screen (the keyboard is unlocked), press the key [F2] twice to enter the scanning function, and press [F2] to exit the scanning function.

Battery voltage
Long button [F2] displays current battery voltage.
The radio
1. Hold down the side key [F2] to turn on the radio mode. Hold down the key again to turn off the radio.
2. When entering the radio mode, you can press the up/down key to search (or double click the # key to start automatic search). In order to enter the required frequency band and more quickly next time, you can add shortcut keys to the required frequency band. (Operation steps: press MENU key to enter the MENU under the current radio -- select channel storage press MENU key to enter a channel saved by the up/down key, if you want to delete some channels, select delete channel operation).
One-key frequency (Optional) Key frequency
In the standby interface, long press and hold the * key to enter the one-key frequency. With the red light flashing, another has been entered when the display interface. Subtone display digital and complete and the indicator light is not flashing indicating the code breaking success. You can directly intercom, press the menu key can directly save the current channel. If you want to break again to press reset. To break the next channel, press the up/down key to enter the breaking function again (step by step).
If breaking code is complete, hold down [F2] to exit this function and return.

The whole part	
Frequency range	136-148MHz/400-480MHz
Rated voltage	DC7.4V(battery)
Rated power	500mW
Antenna configuration	Loaded antenna
Antenna impedance	50
Working mode	Same frequency simplex or different frequency simplex
Ground mode	Negative pole
Transmitting part	
Output power	5-10W
Modulation method	FM
Modulation frequency	<50Hz
Modulation deviation	<5kHz
Modulation rate	<1000Hz
Modulation current	1200mA
Receiving part	
Sensitivity	<0.16uV(25dB SINAD)
Minimum sensitivity	<0.2uV
Intermediate frequency	500KHz
Audio power	<1000mW
Receiving current	20mA
Noise waiting	20mA

Warranty card
Model: _____ Purchase date: _____
Serial number: _____
Seller: _____ Contact number: _____
User name: _____ Contact number: _____
Address: _____ Zip Code: _____
Warranty description:
1. This warranty card is kept by the customer as a warranty certificate, and will not be replaced if lost.
2. This card must be stamped and dated by the sales point to take effect.
3. This card is not allowed to be altered. Please confirm that the serial number of the warranty card is consistent with the number of the purchased machine, otherwise it will be invalid.
4. The warranty period is one year. The charger, battery, lanyard, antenna and feeder are consumables and are not covered by the warranty.
5. Users can choose the following ways to obtain maintenance services:
a. At the place of original purchase.
b. Our company has a special local maintenance point.

《中华人民共和国无线电管理条例》规定：在中华人民共和国境内设置、使用无线电台(站)和设置无线电台(站)设备的单位和个人，必须到相应的无线电管理机构申办设台手续，领取电台执照后方可使用。

为了使用户对操作方便且性能优异的对讲机的需要而设计的。

检查包装内物品.....	
安装/卸下电池.....	
安装/卸下天线.....	
座充充电.....	
座充充电.....	
熟悉本机.....	07
按键介绍.....	
界面图标说明.....	
菜单导航.....	11
基本操作.....	14
技术指标.....	
保修卡.....	

- 使用无线电设备时必须遵守我国政府的有关规定，不得使用频率和功率，且须接受管制如有甚可资遵守。
- 此许可证之颁发及续发只给有合约授权的接收人使用。
- 为免造成无线电电磁干扰起见，请贴有“请关闭对讲机”标志的场合关闭对讲机。例如医院和其它保健医疗场所、医院飞行时、对讲机进入重要天气观测站时，请关闭对讲机。
- 在带有安全气氛的环境下，请勿将对讲机造成气态泄漏可引发火灾的歧义范围内。
- 在进入易燃、易爆环境前请关闭对讲机。
- 请持续保持发射过去，对讲机可能会造成火灾危险，甚至引发火灾。
- 请勿使用天线已损坏的对讲机，损坏了的天线连接或损坏可能导致接收器故障。
- 请勿将对讲机长时间暴露在阳光下或阳光下造成过热。
- 如果非便携模式对讲机在待机中，请关闭对讲机以节省电力，天线至少应离身体5厘米。
- 如果万一发现对讲机存在任何安全隐患，请马上关闭电源，并通知经销商或维修商。

使用本产品时无须对零件、在装箱前、箱盖处、

请检查本产品产品包装是否有无损坏迹象。

请小心打开包装底盖，确认箱内是否有下表列出的物品。若您发现本产品及其附件在搬运中有任何的损坏，请立即与经销商联系。

主机附件

配件	数量
对讲机	1
天线	1
锂电池组	1
充电器	1
挂绳	1
使用说明书	1
夹子	1

如需了解更多信息或社会信息，请访问www.hioki.com。

1. 如图 ① 所示将电池对准卡口放入主机内。
2. 如图 ② 所示将电池上的螺丝顺时针旋紧。
注：如需卸下电池，逆时针拧松螺丝即可卸下电池，如图 ③ ④ 所示。

安装/卸下天线

要安装天线时，按顺时针方向将天线旋入对讲机顶部的天线座中，直至旋紧为止。（见图3）

要卸下天线时，向逆时针方向旋转即可。（见图4）

充电操作

请使用我司指定的充电器对电池进行充电；充电器的显示屏显示充电状态。

线充充电
充电操作步骤
 请使用我司指定的充电线对电池进行充电；充电器的指示灯可显示充电状态。

Diagram illustrating the components of the mobile phone:

- 天线 (Antenna)
- LED指示灯 (LED Indicator Light)
- 发射灯红亮, 接收灯绿亮 (Transmit light red, Receive light green)
- 扬声器 (Speaker)

[illegible]

足* 电池只显示外框。

设备单	二进制单		二进制单	功能说明
显示	编号	变量	变量	
对讲设备	1	静音功能	静音/静音	静音功能
	2	发射功率	功率/功率	功率设置
	3	信道频率	频率/频率	信道频率设置
	4	信道带宽	带宽/带宽	信道带宽设置
	5	通信距离	距离/距离	通信距离设置
	6	发射频率	频率/频率	发射频率设置
声控设备	1	灵敏度	灵敏度/灵敏度	灵敏度设置
	2	灵敏度	灵敏度/灵敏度	灵敏度设置
离位设备	1	报警方式	报警/报警	报警方式设置
	2	报警时间	时间/时间	报警时间设置
	3	报警提示	提示/提示	报警提示设置

视图单	二视图单	三视图单	功能说明
显示	编号	显示	
高级设置	4	自动灯光	开关
	5	亮度	调节亮度并控制光源的开关
	5	显示亮度	亮度
	6	亮度调节指示	亮度调节指示
	7	亮度调节指示	亮度调节指示
	8	亮度调节指示	亮度调节指示
	8	亮度调节指示	亮度调节指示
	9	亮度调节指示	亮度调节指示
	10	亮度调节指示	亮度调节指示
	10	亮度调节指示	亮度调节指示
声音设置	1	接收器指示灯	开关
	2	发射器指示灯	开关

一、级菜单	二、级菜单	三、级菜单	功能说明
显示	显示	显示	
交互设置菜单	3	接收数字信息 0002H...0734H	数字信息交互菜单 交互频率选择菜单
		发码 发码	无音信号
		发码数字信息 0003H...0734H	数字信息交互菜单
	1	步速频率 5.0234Hz 6.2342Hz 19.0004Hz 25.0004Hz 50.0004Hz	在频率菜单下，按“上”、“下”键时，更改频率的步速值
频率菜单模式	频率能力	无频	在频率菜单下，按频率等于接收频率时，无音信号
		减频	在频率菜单下，发频率等于接收频率时，发报警信息
	2	频率频率 00.000...49.990	在频率菜单下，发频与接收的频率之差 发频率等于接收

① 短按时间（电源开关/音量）旋钮听到“嘟”声，如需关机，逆时针旋转旋钮至“睡眠”。

② 短转（电源开关/音量）旋钮可增大音量，逆时针可减小音量。

操

③ 长按时间/频率/信道模式切换。

④ 按A级触点
返回默认频道

⑤ 无无线上锁）短按 A 键可为 A/B 级切换

⑥ 无无线上锁）长按 B 键双频守候开启，再次长按此键则关闭双频守候

⑦ 无无线上锁）长按 C 键为键盘上锁，再次长按此键则键盘解锁

⑧ 无无线上锁）连续按下 D 键进入扫描功能，按 E 键退出扫描功能

锂电池充电小时
长按 **Q** 键显示当前锂电池电压

改密码
长按 **Q** 键，开启收音机模式，再次长按此键关闭收音机。
长按 **Q** 键 3 秒以上可进入当前下键所对应的菜单（双击 **Q** 键=开/关自动搜索），为更改进入菜单，可以长按所需频道并双击该键，（提示步骤：在当前的收音机频道上需要，选择该频道按MENU键进入，通过上下键保存所需的数据，如些数据清除则删除该频道进行操作）。

睡眠键（可选）
长按“睡眠”键，伴随红灯闪烁，另一台一起发射，可保持同步。
长按“睡眠”键，伴随红灯闪烁，另一台一起发射，可保持同步。

在收音显示窗口和指示灯不在闪烁表示解码成功，就可以直接对讲，按菜单键 **Q** 键，从菜单键选择下一项位，调频下一信道，按一下上翻键/下翻键 再次进入下一项位。（步骤依次类推）。

如要调频成功，长按 **Q** 键退出此频道并返回主界面。

整体部分	
频率范围	136~174MHz/400~480MHz
额定电压	DC7.4(电池)
天线频率	1295~1300MHz
天线阻抗	40Ω
工作方式	间歇发送或连续工作
接收方式	负频

发射部分		接收部分	
输出功率	5~10W	灵敏度	<0.16V(25dB SINAD)
调制方式	调频	静噪灵敏度	<0.2V
最大频偏	±45kHz	互调抑制比	50dB
信道选择性	4~6dB	阻塞抑制比	>2000W
附加频率	每信道接收6dB	接收电压	≤100mA
发射电流	≤1200mA	静噪电压	20mA

● 以上数据仅供参考，以实际仪器为准

机 型: _____ 购买日期: _____

序列号: _____

销售员: _____ 联系电话: _____

用户名: _____ 联系地址: _____

地 址: _____ 邮 编: _____

保修说明:

1. 本保修卡由顾客保存作为保修凭证, 遗失不补。

2. 本卡必须由销售点盖章及填写日期方能生效。

3. 本卡不得涂改, 请确认保修卡列号与购买商品码相符, 否则无效。

4. 保修期限为两年, 充电器、挂绳、挂线及挂绳线消耗品, 属非保修范围。

5. 用户可选择下列途径获得维修服务:

a. 至原购处办理。

b. 我司在当地特约维修点。