

MEMORISM

ROTARY SHAVER

Model: Blizz RS3



USER MANUAL

Please read this manual carefully before use and keep it for future reference.

CONTENTS

Introduction	01
Important Safety Instructions	01
Parts and Accessories	03
LED Display	04
Specification	05
Charging	05
Shaving	06
Cleaning and Maintenance	07
Battery Disposal	08
Limited Warranty	09

Introduction

Congratulations on your purchase and welcome to Memorism!

To fully benefit from the support that Memorism offers, please register your product at www.mymemorism.com/register

Important Safety Instructions

1. Close supervision is required when this product is used by, on, or near children, or persons with limited physical, sensory, or mental capabilities, or invalids.
2. Make sure the appliance is switched off before opening the shaving unit.
3. Make sure the appliance is switched off before cleaning.
4. Do not immerse the appliance in water.
5. Do not place or store the appliance where it can fall or be pulled into a tub or sink. Do not place or drop the appliance into water or other liquid.
6. Do not use the appliance if it is not working properly, if it has been dropped or if it has been immersed in any liquid.
7. Keep the charging port and appliance dry.

8. Do not press hard or knock the shaving head with hard objects, otherwise, it will damage the shaving head and may scratch your skin.
9. This appliance is waterproof, which means it can be washed under the sink. However, we recommend that you do not leave it in water or damp places for extended amounts of time.
10. A shaver should not be used by others especially with those who have any kind of skin disease.
11. Always put the protective cap on the shaver to protect the shaving heads when you are traveling.

Parts and Accessories

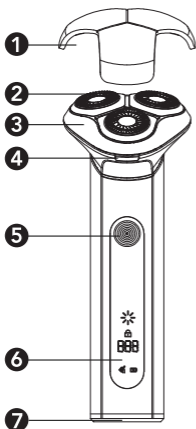

- 1** Protective Cap
 - 2** Shaving Blade
 - 3** Shaving Head
 - 4** Shaving Head Release
 - 5** On / Off Button
 - 6** LED Display
 - 7** Charging Port
- 8** USB Cable
 - 9** Cleaning Brush

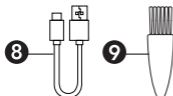

LED Display



Status Display

When the shaver is working, the light will circle around the display.

When the shaver is charging, the light will fully illuminate.



Travel Lock

This icon flashes to indicate that the shaver is locked. Press for 3 seconds to lock / unlock the shaver.



Available Time

It shows the available operating time left on the battery.



Cleaning Reminder

After using the shaver for more than 30 minutes, it will flash for 5 seconds to remind you to clean. It will flash again after another 30 minutes of operation.

Charging Reminder

When the available operating time is less than 10 minutes, it will flash to remind you to charge the shaver.

When the shaver is charging, this light will stay on.

Specification

Product Name: Rotary Shaver

Product Model: RS3

Charging Time: 180 minutes

Operating Time: 200 minutes (on full charge)

Power Input: 5V 1A

Operating Temperature Range: 41°F-95°F

Size: 6.22 x 2.38 x 2.1 inch

Weight: 7.02 oz

Charging

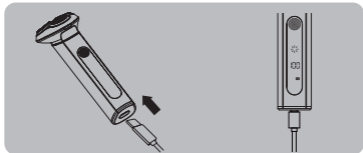

When the Battery icon flashes, it means the shaver is running low on power and you should charge the device.

1. Make sure the shaver is switched off before charging.
2. Connect the USB port to the charger.
3. Plug the Type-C charging port into the charging port on the bottom of the product.

- The number of available time displays will increase while charging. At the same time, the battery icon will stay illuminated. When the number shows 200, the shaver is fully charged.
- Remove the cable to stop charging.

Note:

- Do not overcharge the shaver as this may shorten the service life of the product.*
- If the battery is dead and you need to shave, you can plug it into the charging cable and use the shaver while it is charging. We don't recommend this for daily use, though.*

Shaving

- Press the button to power on the shaver.
- Move the shaver unit against the beard growth direction. Make circular movements to shave.
- Both dry and wet shaving are available. Shaving dry usually works best. We recommend that you wash your face before and after shaving.

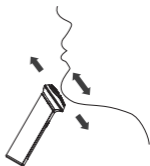

4. After shaving, press the button again to turn off the shaver.
5. Clean the shaver and cover it with the cap to prevent damage to the shaver heads.
6. When a shaver head is damaged, do not shave with it to avoid damaging your skin. Contact customer support if you need a new shaving head.

Cleaning and Maintenance



1. Make sure the shaver is switched off and unplugged before cleaning.
2. Press the shaving head release button to remove the shaving head.
3. Clean the shaving unit and hair chamber with the cleaning brush to remove any hair. You can also rinse the inside and outside of the shaving unit and hair chamber under the sink for 30 seconds. Even though it is waterproof, **DO NOT submerge the shaver body in water.**

4. Clean the shaver unit after each use for better shaving performance.
5. We recommend putting the protection cap on the shaver for storage.
6. For maximum shaving performance, replace the shaving head once per year.

Battery Disposal

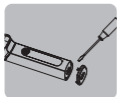

1. The batteries in this product contain substances that might pollute the environment. Please remove the battery and bring it to a designated recycling plant if you want to discard the shaver.
2. Before removing the battery, the shaver must be powered off and it should be ensured that the battery is dead. If there is residual power left, turn the shaver on and let it run until it stops working.
3. Open the bottom shell of the shaver. Open the front shell to remove the battery.
4. After the battery is removed, do not attempt to charge the device.



Limited Warranty

Memorism warrants Rotary Shaver RS3 for 1 year from the date of purchase. For more information, please visit www.mymemorism.com/warranty.

What's covered?

Defects due to faulty materials and / or workmanship of the product

What's not covered?

1. Damage caused by the owner when attempting to fix or altering the product by himself or herself.
2. Damage caused by misuse, abuse, neglect, alterations or unauthorized repair.
3. Natural depreciation.

Warranty Period

Warranty becomes effective from the date of original purchase and will last for 1 year.

Who's covered?

This limited warranty is only effective for the original purchaser. It is non-transferable.

How to request warranty services?

To obtain the benefit of this warranty, please email support@mymemorism.com. Our customer service team will address your issue as soon as possible!

MEMORISM



www.mymemorism.com
support@mymemorism.com

6945 Speedway Blvd Ste, H102 Las Vegas, NV 89115